



TRUECONTACTLESS™

DRIVE-THRU AND CURBSIDE PICKUP

**THRIVE THROUGH THE
DRIVE-THRU™**

FAST KITCHEN CONCEPT

MODULAR DRIVE-THRU AND CURBSIDE PICKUP

ROXBOX CONTAINERS

QUALITY / INNOVATIVE / AGILE

WE ARE TEAM ROXBOX

CONTAINERS & MODIFICATIONS

We are a Denver-based manufacturing company that is the leading provider of custom shipping container solutions in the Rocky Mountain region. With over two decades of experience in the shipping container industry, ROXBOX has become the subject matter experts in developing creative solutions for the nation's modular needs. Our dedication to product development and innovation has resulted in a broad product line ranging from mobile infrastructure, off-grid disaster relief, and mobile healthcare facilities. If it can be built with a container, ROXBOX will deliver it!

- COMMERCIAL PROJECTS
- KITCHENS
- MODULAR BUILDINGS
- HEALTHCARE
- BARS
- CANNABIS
- EXPERIENTIAL MARKETING
- OFFICES
- BITCOIN MINING
- SOLAR-POWER
- COLD STORAGE
- LAST MILE DELIVERY
- WASTEWATER TREATMENT



X



FASTKITCHEN



IN THE WORDS
OF MONTELL JORDAN...

—
“THIS IS
HOW WE
DO IT”



OUR PROCESS

ALL PROJECTS ARE UNIQUE, BUT GENERALLY SPEAKING THIS IS OUR PHASED APPROACH

PHASE 1

DESIGN + PLANNING

- **FEASIBILITY ANALYSIS**
Project feasibility, derive a game plan and analyze critical risks
- **CREATE A DESIGN**
Renderings and schematic drawings (Includes 2 rounds of revisions)
- **QUOTE**
Comprehensive cost analysis based for your unit or units
- **VALUE-ENGINEERING**
Action items we can take to help reduce your cost
- **NON-REFUNDABLE DEPOSIT**
\$TBD
- **ANTICIPATED TIMELINE**
Typical project is ~ 3 to 4 weeks

PHASE 2

PERMITTING + ENGINEERING

- **PERMIT PAYMENT**
Project dependent quote + allowance to complete an approved permit set
- **SUBMITTAL**
We would take those drawings and manage the submission of the permit set to any State & local health/building/fire departments for approval and feedback and make correlating adjustments
- **STAMPS**
Architectural, structural and civil engineering stamps
- **MEP REVIEWS**
Mechanical, electrical and plumbing review and stamps
- **SUB COORDINATION**
Managing and coordinating with other contractors and subcontractors
- **ANTICIPATED TIMELINE**
TBD on department's timeline

PHASE 3

CONSTRUCTION + PRODUCTION

- **DOWNPAYMENT**
60% downpayment (plus cost of any equipment including container) to begin production
- **PRODUCTION SCHEDULING**
After approval of final design and drawings, we move you into our production schedule
- **RETAINER**
We take 25% upon completion of 50% of your project, then the remainder upon delivery and or installation
- **ANTICIPATED TIMELINE**
Timeline is determined upon current production schedule and downpayment completion date

PHASE 4

DELIVERY + INSTALLATION

- **DELIVERY**
Delivery, installation, hook-ups, final inspections, etc. We will help coordinate delivery, the local General Contractor should be completed onsite work
- **FINAL PAYMENT**
We take final 15% upon installation and after any necessary final inspections
- **ANTICIPATED TIMELINE**
Typical project is ~ 1 to 3 weeks





MEASURABLE EMPLOYEE SAFETY

TrueContactless™ drive-thru sanitizes shared surfaces & aerosols with UV(c) light radiation. By creating a COVID-impassable barrier to the outside, employees are not exposed to guests whatsoever, reducing possible spread to others



MULTIPLY DRIVE-THRU REVENUE

Vastly improve speed, convenience, and customer flows with additional drive-thru lanes — having two, three or more dedicated lanes multiplies single location revenues instead of forcing you to open additional store locations

BETTER CUSTOMER EXPERIENCES

Adapt to your customers in realtime with smart interactions, customer preferences, data-fueled insights, multi-lingual, and American Sign Language (ASL) communication — all without hiring additional employees or retraining teams



ROXBOX X HUM-DINNER

Modular kitchens combined with contactless drive-thru technology creates an innovative restaurant concept with significant ROI opportunities.

Each custom design concept is COVID-safe and creates multiple drive-thru lanes for maximum revenue generation.



CONTAINER KITCHEN

- Fully customizable so you can design your perfect kitchen!
- Built to local health code. Completely hygienic space that is simple to keep clean.
- Rapidly deployable without the need for special construction, equipment, or skills. Off the truck and working in **20 minutes**.
- Designed to be upgraded with virtually any customization you need - like added doors, extra windows, drive through windows and seating.
- Designed to work as a permanent or temporary kitchen for many applications including as a ghost or cloud kitchen.
- A perfect way to add modern aesthetic appeal to a temporary structure's overall look.



*PRODUCT SHOWN WITH OPTIONS



ADDITIONAL INFORMATION

CONTAINER
40' New High-Cube Shipping Container

MODIFICATIONS

- Metal framing throughout the container
- [FRP, Stainless Steel or Trusscore] wall coverings
- 3" Spray foam insulation throughout container [walls, ceiling, underneath floor]
- [2] 9' x 4.5' service windows with awnings
- Interior and exterior bar tops & [1] ADA compliant service counter
- [1] Steel door
- Egress push bar on cargo door [interior access only]
- Coin-flex tile floor
- Mini-split for heat and cooling
- Water storage option: fresh & grey-water
- Full installation of electrical and plumbing
- Exterior Paint and branding
- Classified as a mobile kitchen

STARTING AT
\$100,000

THE BEERCAN

- The BeerCan mobile or permanent taproom made from a 20' shipping container is our most popular shipping container modification.
- The temperature-controlled walk-in cooler keeps upwards of 26 kegs at the perfect drinking temperature 24/7 allowing a quick 5 minute set up time and you're pouring ice cold Beer.
- No more tents, jockey-boxes or ice buckets, your kegs stay cold for as long as you need them. Take it to festivals and expand your current capacity when your BeerCan is not on the road.
- The permanent or mobile BeerCan can be run on-grid or by a generator/solar-power, making it perfect for any event, beer garden, or patio. The only requirement for mobile is the appropriate electrical connection for the container
- This eye-catching mobile taproom is functional, sustainable, and undeniably BADASS!



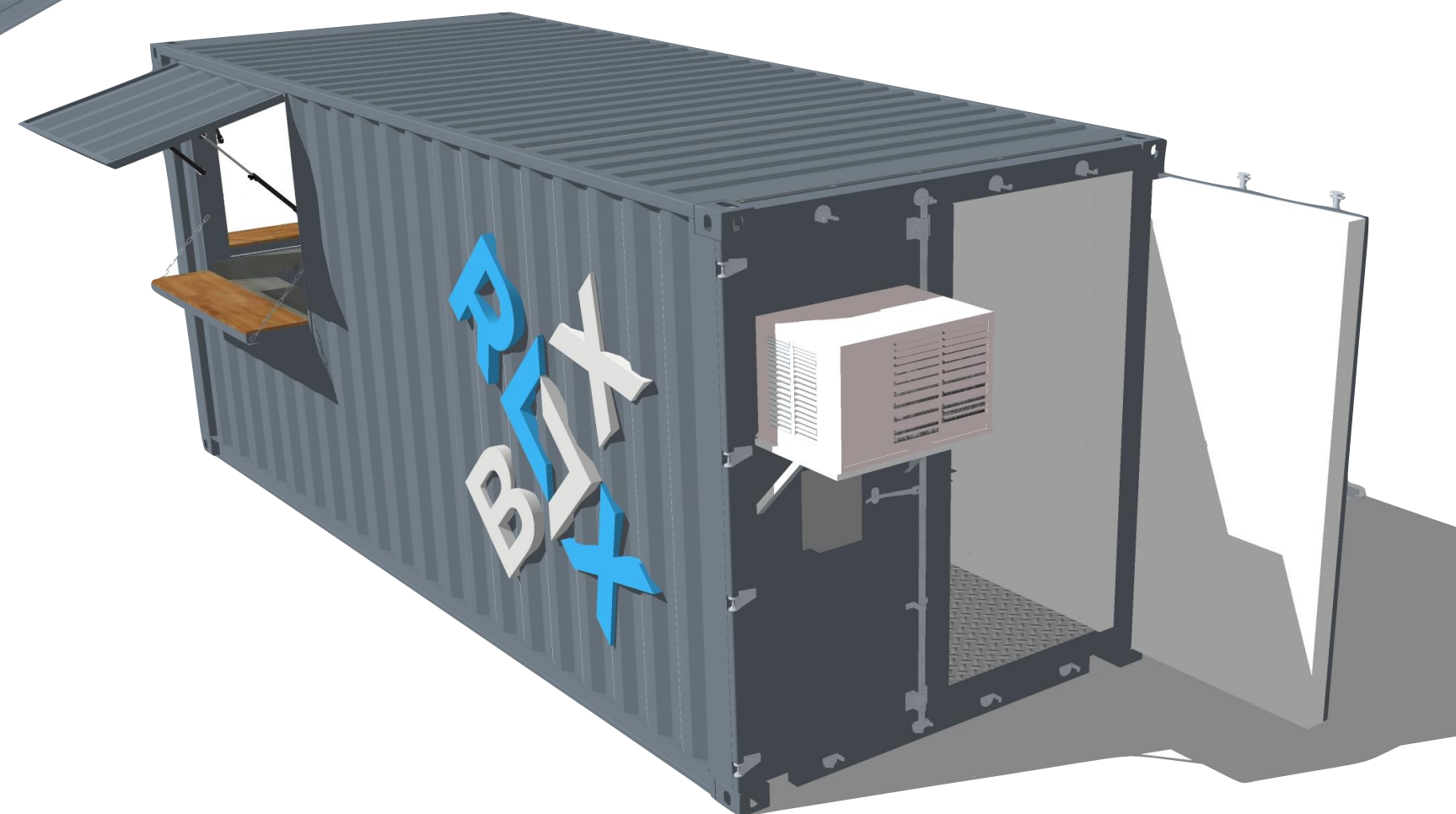
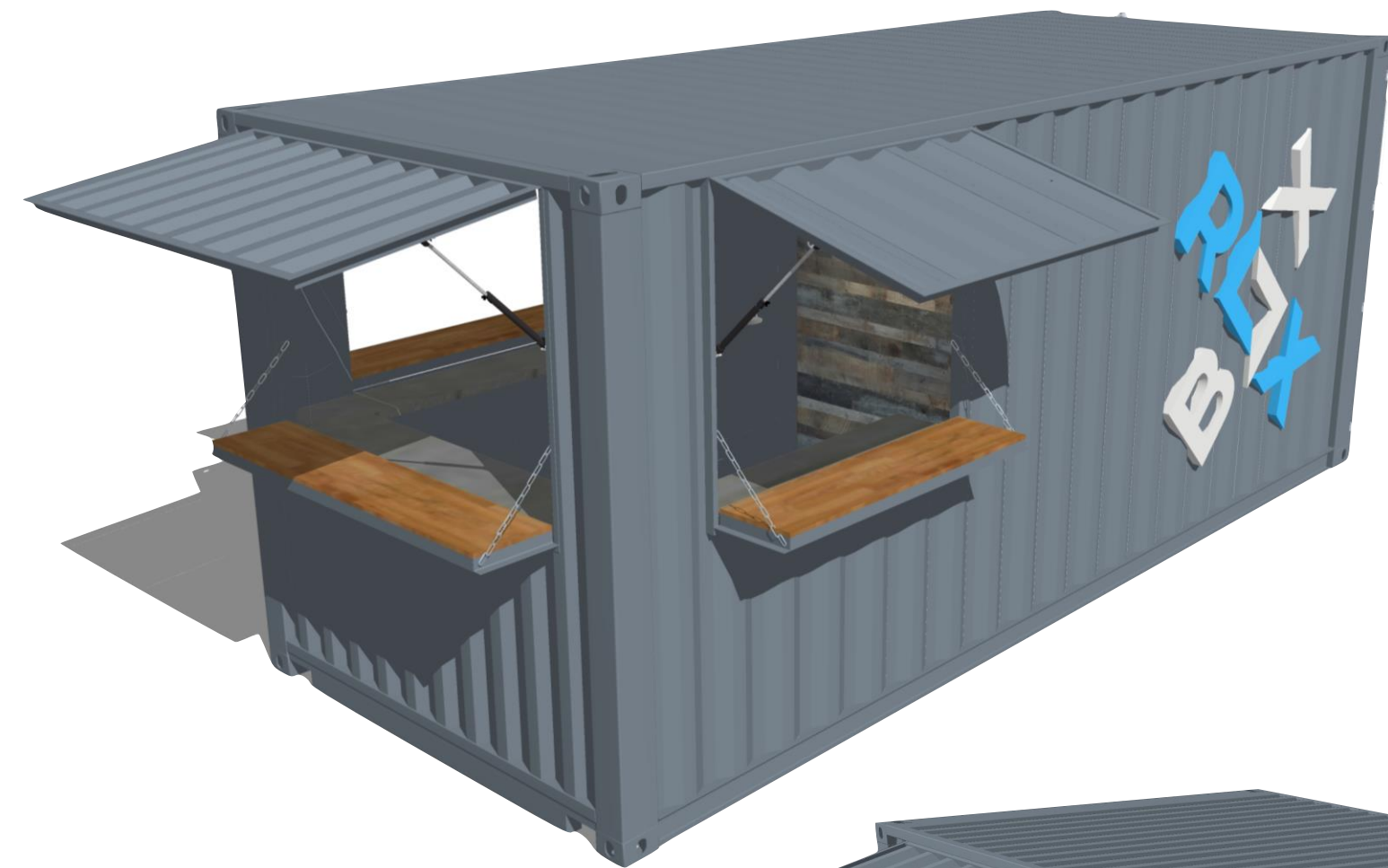
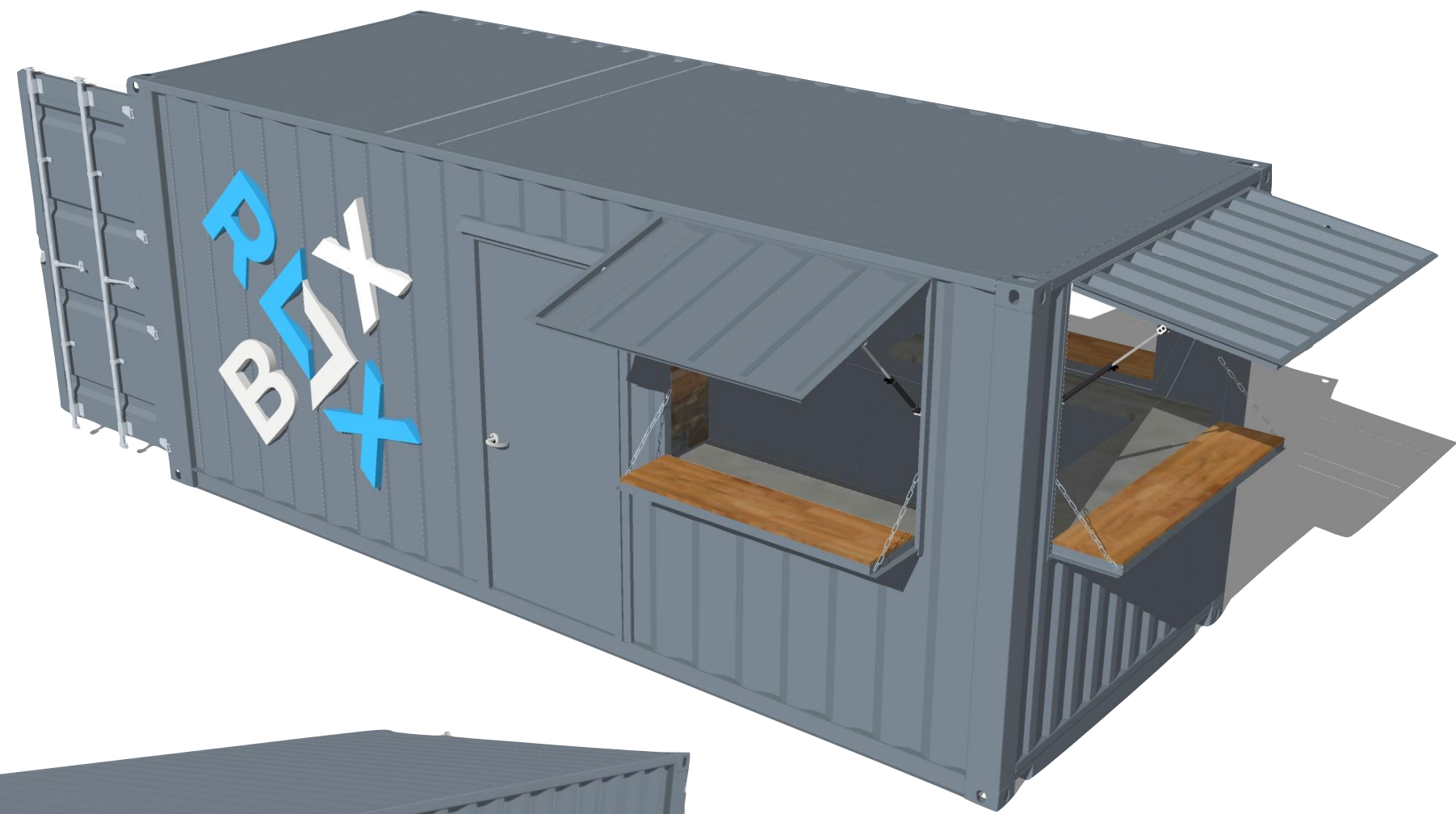

ADDITIONAL INFORMATION

CONTAINER

20' One-Trip Shipping Container

MODIFICATIONS

- [3] 6' x 4.5' service windows with interior bar tops
- [1] 5' x 8' walk-in cooler
- [6-25] Beer Tap System
- Electrical with outlets
- Spray Foam insulation
- [1] Exterior steel door
- Trusscore Wall & ceiling covering in cooler
- Epoxy flooring with non-slip additive
- Interior & exterior paint
- Optional rooftop deck with side railings [+\$15,000]
- Other customization available

STARTING AT

\$45,000

THE BARCAN + RETAIL BOX

- The BarCan mobile or permanent bar made from a [20' shipping container](#) is the best way to serve beer and spirits!
- This open-air patio is a great way to engage your guests and triple your serving capacity.
- An experience in and of itself, this shipping container bar creates engaged guests that will make your brand the talk of the town (and social media). Set-up beer Pong on your roof-top deck and watch as guests create viral content around your custom shipping container bar.
- The BarCan can also be modified to double as a mobile or permanent stage and/or retail unit.
- Container can be modified to fit a wide-array of needs for retail and/or office units. Fully customizable and master craftsmanship ensure an engaging experience.



*PRODUCT SHOWN WITH OPTIONS



ADDITIONAL INFORMATION

CONTAINER
20' One-Trip Shipping Container

- MODIFICATIONS**
- 16' x 7' Fold down deck
 - [3] 6' x 2' Distressed wood & steel
 - Signs affixed to the top of the container
 - [6] Tap draft tower
 - Keg & gas storage with sliders and insulated tap counter
 - Man door
 - Epoxy or coin-flex floors
 - Interior paint
 - Exterior paint

STARTING AT
\$45,000

THE PATIOBOX

- PatioBox is a containerized patio solution designed to give businesses a covered and heated (or cooled) patio. Designed in response to COVID-19 and to help restaurateurs have expanded space, ROXBOX worked closely with regulators to design a functional, cool, and compliant outdoor space. Available for rent or purchase, the 4 PatioBox models can help numerous businesses expand their space while adhering to social distancing requirements.

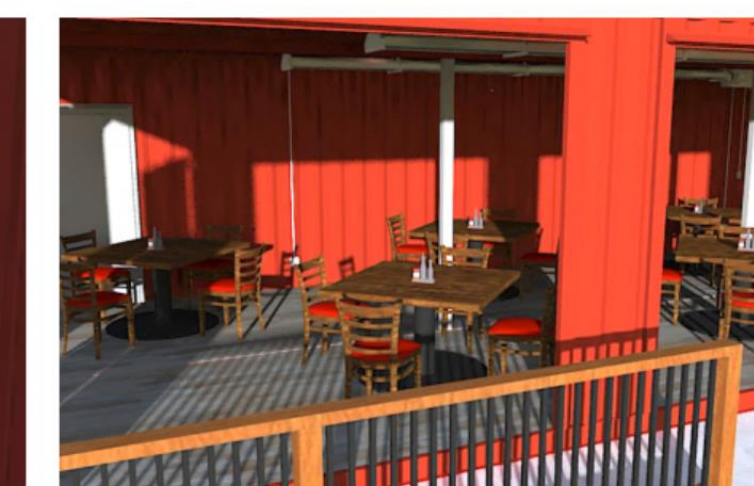

SOLAR CONTAINERS

Offering a greener, cleaner, and dependable mobile generator alternative that will provide significant savings on operating costs. Real-time performance monitoring and analytics are also obtainable. Providing live reporting and power contribution to reducing carbon emissions, cost savings, as well as system health and uptime.

HELIOS, a ROXBOX subsidiary – has formulated a strategic partnership with the innovative Australian company Black Stump Technologies. This collaboration brings this proven solar technology half-way around the world to the United States. We are excited to be the exclusive US producer and want to be doing our part in reducing the world's dependence on fossil fuels.



HELIOS SUITE

- REFRIGERATORS
- FREEZERS
- ICE MAKERS
- GENERATORS
- ATMOSPHERIC WATER GENERATORS
- DEPLOYABLE HEALTH
- MORGUES

INDUSTRY DEPLOYMENT

- INFRASTRUCTURE
- CONSTRUCTION & MINING
- DEFENSE
- SITE POWER
- GOVERNMENT
- DISASTER RELIEF
- AGRICULTURE & AQUACULTURE
- EVENTS
- FIRST RESPONDERS

POTENTIAL USES

- COLD STORAGE & PRE-COOLING
- VACCINE DISTRIBUTION
- SITE POWER
- ENERGY ACCESS
- FOOD DISTRIBUTION
- SUPPLY CHAIN
- OFF-GRID ECOSYSTEMS

SOLAR REFRIGERATORS & FREEZERS

HELIOS solar refrigerators and freezers are energy independent and reliable replacements for diesel generators. **HELIOS** reduces emissions and allows individuals, businesses, and communities to go green and reduce their carbon footprint while saving significant operations and fuel costs.

The **HELIOS** solar array is secured away and transported like a standard ISO Hi-Cube shipping container. With simple push button operation, within **10 minutes** **HELIOS** is set and the solar panels deployed. Every **HELIOS** unit is calibrated to the specific use-case and requires no special tools or training.

SOLAR REFRIGERATORS & FREEZERS

✓ CONTINUOUS IMPROVEMENT

Energy usage patterns logged and analyzed remotely

✓ NO UTILITIES INVOLVEMENT

100% off grid for remote sites, or if operating in hybrid mode using grid, our mobile refrigerators and cool rooms are classified as an appliance requiring no input or approvals from power companies

✓ ALIGNED REPORTING FOR SUSTAINABILITY

Aligned with Corporate Sustainable Reporting (CSR) and with the United Nations (UN) Sustainable Development Goals

✓ EASY OPERATING

No special tools or training. Working within 10 minutes of delivery with remote control and calibration

✓ COST SAVINGS

Significant savings over diesel alternative

✓ CARBON EMISSION REDUCTIONS

Immediate carbon emissions reductions and improved environmental footprint

✓ UNINTERRUPTIBLE POWER SUPPLY

24 hours a day via solar array and smart battery system, with hybrid GRID and generator connection options

✓ PROVEN

Deployed across sites in urban Victoria Australia, deserts of Woomera Australia and highlands of Papua New Guinea

CUSTOM USAGE

Every unit is calibrated to the exact function for each use

RENEWABLE GENERATORS

HELIOS renewable generators can power **100%** of energy requirements via integrated solar array, battery bank and (bio) diesel generator working as a cohesive system **24/7**



RENEWABLE GENERATOR BENEFITS



CONTINUOUS IMPROVEMENT

Energy usage patterns logged and analyzed remotely



NO UTILITIES INVOLVEMENT

100% off grid for remote sites, or if operating in hybrid mode using grid, our mobile refrigerators and cool rooms are classified as an appliance requiring no input or approvals from power companies



MONITORING AND ANALYTICS

In real-time providing the ability to report your savings and contribution to the grid, make adjustments, and operate remotely.



EASY OPERATING

No special tools or training. Working within 10 minutes of delivery with remote control and calibration



POSITIVE REPORTING

Aligned Corporate Sustainable Reporting (CSR) and with the United Nations (UN) Sustainable Development Goals



COST SAVINGS

Significant savings over diesel alternative. Can be combined in-series for larger power output.



CARBON EMISSION REDUCTIONS

Immediate carbon emissions reductions and improved environmental footprint



UNINTERRUPTIBLE POWER SUPPLY

Renewable energy 24 hours a day via solar array and smart battery system, with hybrid grid and generator connection options



PROVEN

Deployed across sites in urban Victoria Australia, deserts of Woomera Australia and highlands of Papua New Guinea



NO SITE DISRUPTION

Renewable Generator deployed and operating in under 30 minutes

CONTACT

Anthony Halsch – CEO
anthony@roxboxcontainers.com
303.358.9670

Davin Burkhardt – CGO
davin@roxboxcontainers.com
303.775.5107

Beau Bergman – COO
beau@roxboxcontainers.com
412.302.5621

INFO@ROXBOXCONTAINERS.COM //
ROXBOXCONTAINERS.COM

ROXBOX

CONTACT

Kevin Bessy – CEO
kevin@humdinner.ca
343.988.6238

Dwight Corcoran – COO
Dwight@humdinner.ca
705.930.0886

INFO@HUMDINNER.CA
HUMDINNER.CA

