

**BASEMENT STRUCTURAL PLAN**  
SCALE: 1:75

### POST AND BEAM SCHEDULE

DESIGNATION	MEMBER TYPE	MEMBER SIZE	MEMBER GRADE
B1	BEAM	3-PLY LVL 44x406	3100Fb-2.0E
B2	BEAM	2-PLY LVL 44x406	3100Fb-2.0E
B3	BEAM	2-PLY 38x235	SPF No.2
P1	STEEL POST	*RED JACK 3.0 BY MITEK (No.T2JPHD)	
P2	GANG STUD	3-PLY 38x89	SPF No.2
P3	WOOD POST	**PSL 178x178 (7"x7")	1.8E
P4	WOOD POST	(SEE P4 DETAIL)	SPF No.2
P5	GANG STUD	3-PLY 38x140	SPF No.2
C1	STEEL COLUMN	HSS 127x127x6.4mm (SEE DETAIL 1 ON S4)	

\* INSTALL WITH T2TP527 TOP PLATE, AND FIX BASE PLATE IN CONCRETE FOOTING WITH APPROPRIATE SCREWS.  
 \*\* INSTALL WITH SIMPSON STRONG TIE CONNECTORS: ECCU (WITH ROTATED STRAP CUSTOM TO FIT) AT TOP, AND REFER TO FLOOR PLAN FOR CONNECTION TYPE AT BASE.

NOTES:  
 - WALL SILL PLATE SHALL BE INTERRUPTED AT BASE OF POST SO THAT IT BEARS DIRECTLY ON CONCRETE WITH SPECIFIED BASE PLATE (EXCEPT POST ABOVE FOUNDATION POCKET; SILL PLATE TO REMAIN).  
 - ALL INSTALLATIONS AS PER MANUFACTURER'S INSTRUCTIONS.

### P4 DETAIL

SCALE: 1:16

NOTE: BUILT-UP POST TO BE COMPLETED WITH TOP PLATES AND SILL PLATE AS PER WALL SCHEDULE.

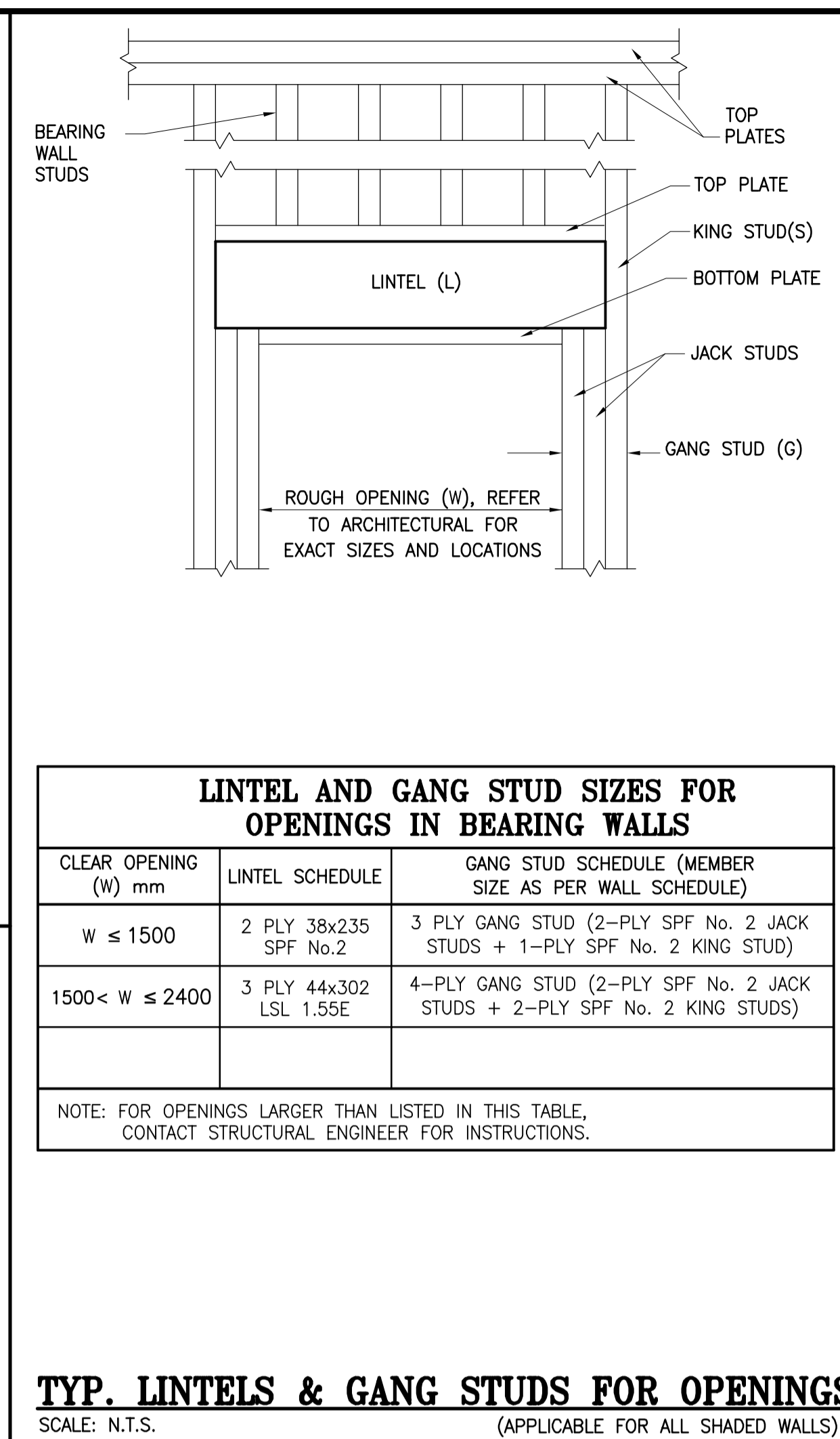

COPYRIGHT PROTECTED:  
 Copyright for the design and drawings prepared by or on behalf of the Architect belong to the Architect. These drawings and specifications are instruments of the Architect's service and shall remain the property of the Architect.

Submissions or distribution of the aforementioned to meet official regulatory requirements or for other purposes in connection with the Project is not to be construed as publication in derogation of the Architect's reserved rights.

Except for reference purposes, the drawings and specifications shall not be used for additions or alterations to the Project or on any other project.

### GENERAL NOTES

- CONTRACTOR SHALL VERIFY ALL DIMENSIONS, LOCATIONS, ELEVATIONS AND/OR CONSTRUCTION DETAILS. REPORT ANY DISCREPANCIES TO THE CONSULTANT. DO NOT SCALE ON THESE STRUCTURAL DRAWINGS.
- STRUCTURAL DRAWINGS ARE TO BE READ IN CONJUNCTION WITH STRUCTURAL SPECIFICATIONS ON DRAWING S6.
- REFER TO ARCHITECTURAL DRAWINGS FOR FINISHES, AS WELL AS WALL OPENING DIMENSIONS AND LOCATIONS.
- THE TYPICAL DETAILS ON THESE STRUCTURAL DRAWINGS ARE DIAGRAMMATIC AND INDICATE GENERAL ARRANGEMENT. REFER TO WRITTEN ANNOTATIONS AND SCHEDULES FOR EXACT ARRANGEMENT.

### SPECIFIC NOTES

- NO SHEATHING REQ. ON THIS WALL, ONLY GYPSUM AS PER ARCH.
- CONNECT END OF BEAMS TO P4 POST WITH HGA10 CONNECTOR BY SIMPSON STRONG TIE.
- POSITIONED GANG STUD UNDER GIRDER TRUSS.

NO. ISSUED FOR TENDER 2022/03/04  
 NO. REVISION DATE

A A DETAIL NUMBER  
 B B REFERENCE DWG NO.

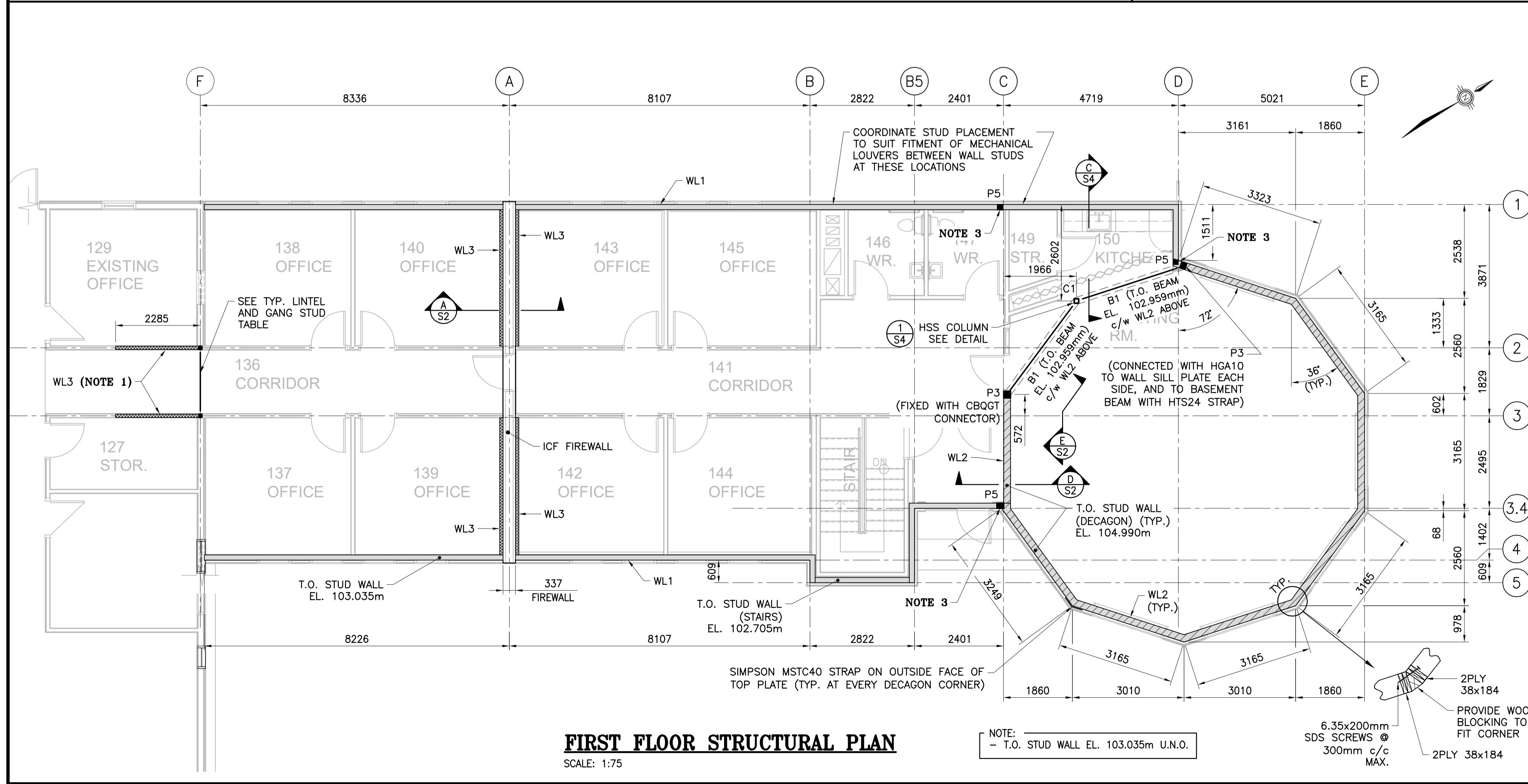

**FIRST FLOOR STRUCTURAL PLAN**  
SCALE: 1:75

### MINIMUM SHEATHING REQUIREMENTS

MATERIAL: CONSTRUCTION SHEATHING PLYWOOD IN ACCORDANCE WITH CAN/CSA 0151, AND OSB IN ACCORDANCE WITH CAN/CSA 0325. REFER TO NATIONAL BUILDING CODE OF CANADA, PART 9.

ROOFS: 16mm THICK 5-PLY T&G PLYWOOD (OR 15.5mm THICK OSB 2R40 WITH "H" CLIPS), U.N.O. ORIENTED AT 0° (EXTERIOR TYPE) WITH STAGGERED PATTERN. NAIL SHEATHING AS PER NATIONAL BUILDING CODE, PART 9, REQUIREMENTS.

WALLS: U.N.O., 12.7mm PLYWOOD SHEATHING OR 12.5mm OSB SHEATHING (2R32) ON ONE SIDE (U.N.O.) FOR ALL BEARING WALLS (EXTERIOR TYPE FOR EXTERIOR WALLS) WITH LONG DIMENSION LAID HORIZONTALLY AND ENDS STAGGERED 1220mm c/c. NAILED AS PER NATIONAL BUILDING CODE, PART 9, REQUIREMENTS.

FLOOR: 18.25mm (3/4") STABLEDGE T&G OSB SUBFLOOR SCREWED & GLUED WITH LONG DIMENSION LAID PERPENDICULAR TO JOIST ENDS STAGGERED @ 1220mm c/c. SCREW AS PER NATIONAL BUILDING CODE PART 9 REQUIREMENTS.

### WALL FRAMING

- WL1 38x140mm SPF No.2 OR BETTER STUDS SPACED AT 406mm c/c MAX. SILL PLATE TO BE 38x140mm SPF No.2 OR BETTER. TOP PLATE TO BE 2-38x140mm SPF No.2 OR BETTER.
- WL2 38x184mm SPF No.2 OR BETTER STUDS SPACED AT 406mm c/c MAX. c/w BLOCKING @ PANEL EDGES. SILL PLATE TO BE 38x184mm SPF No.2 OR BETTER. TOP PLATE TO BE 2-38x184mm SPF No.2 OR BETTER.
- WL3 38x89mm SPF No.2 OR BETTER STUDS SPACED AT 406mm c/c MAX. SILL PLATE TO BE 38x89mm SPF No.2 OR BETTER. TOP PLATE TO BE 2-38x89mm SPF No.2 OR BETTER.

NOTE: STUD SPACING ARE MINIMUM STRUCTURAL REQUIREMENTS. CONTRACTOR TO MODIFY (CLOSER) AS REQUIRED TO SUIT ARCHITECTURAL FINISH.

### DESIGN LOADS

(LOADS ARE NOT FACTORED)

ROOF DL: (EXCLUDING ROOF TRUSSES) 1.25kPa.  
 TOP CHORD = 0.3kPa, BOTTOM CHORD = 0.95kPa.  
 SOFFIT EXTENSIONS = 0.5kPa, EXCLUDING STRUCTURAL MEMBERS.)

ROOF SL: 3.48kPa, UNO.  
 SNOW DRIFTS IN VALLEYS AND UNBALANCED LOADING SHALL BE CONSIDERED BY THE TRUSS DESIGNER.

FLOOR DL: 2.3kPa, UNO. (INCLUDING 1.0kPa FOR PARTITION WALLS, AND EXCLUDING FLOOR JOISTS SELF WEIGHT).

FLOOR LL: 4.8kPa, UNO.

ROOF LL: 1.0kPa, UNO.

ATTIC LL: 0.5kPa, UNO.

ALL: L/360

ROY CONSULTANTS  
 13, rue Cocteau Street  
 Edmundston (NB) E3V 1W7  
 T / 506.7332300  
 F / 506.548.2207

125-21

architects

TCFSA Administration  
**Building Addition**

Tobique First Nation, NB

- STRUCTURAL -  
**PLANS AND DETAILS**

SCALE: AS SHOWN  
 October, 2021

A2135 **S1**

PLOT DATE: 2022-03-04