

# LANDSHARK

BY **TMF TECH**

**LS 2150**



**NEXT GENERATION MULCHING TECHNOLOGY**

## General Specifications:

Mfg..... TMF Tech  
Model..... LS2150  
Class..... Forestry & Vegetation Management  
Power Input..... Hydraulic  
Power Requirements..... 110 hp to 175 hp

Weight..... 1135 kg [2,500 lbs]  
Length..... 914 mm [36 in]  
Width..... 1854 mm [73 in]  
Height..... 1650 mm [65 in]

Cutting Width..... 1525 mm [60 in]  
Push Bar..... Fixed

## Optional:

Gate..... Hydraulic (Optional)  
Push Bar..... Hydraulic (Optional)

## Instrumentation & Control (Optional):

Drum Bearings Temperature  
Overhung Load Adapter Temperature  
Hydraulic Motor Temperature

In-Cab Display..... 4 in  
Drum rpm Readout..... On-Screen  
Drum Speed Control..... On-Screen Adjustable  
Shift Pressure..... On-Screen Adjustable

## Hydraulic:

Type..... 2 Speed  
Number of Motors..... 1  
Max Pressure..... 6,000 psi  
Min Flow Rate..... 121 l/min [32 gpm]  
Max Flow Rate..... 197 l/min [52 gpm]

## Cutting Tool:

- Carbide Reversible

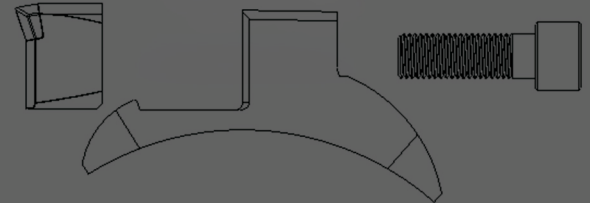

- Chipping Reversible

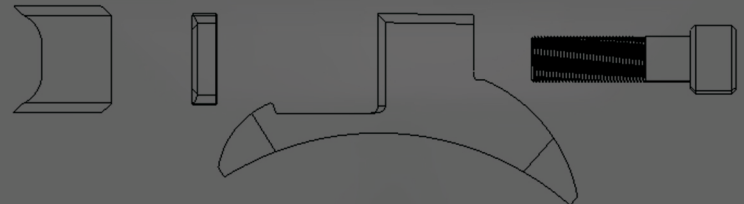

Note: The specifications for a basic vehicle are given on the basis of adequate skills, ability of the operator and under ideal conditions.

**North American Authorized Distributor:**

**TMF TECH**  
250 Exportation Street, Suite 100  
Tracadie Sheila, NB E1X 1A2 Canada  
Tel. 1.506.393-8500 Fax. 506.393.8501  
[tmftech.ca](http://tmftech.ca)