

WDHA DRESSAGE & SPORT HORSE SHOW

June 20 and 21, 2019

Washington County Fair Park
West Bend, WI

Recognized by Arabian Horse Association
Licensed by US Equestrian Federation
Recognized by United States Dressage Federation
Recognized by Western Dressage Assoc. of America
WDCTA SE Chapter Approved (**Open Breed Western Dressage only**)
CSDEA Approval

Local Member Competition

Offering:

Arabian/Half-Arabian/Anglo-Arabian Dressage (Intro Level through Grand Prix), Sport Horse In-Hand and Under Saddle, Show Hack, Dressage Seat Equitation, Dressage Seat Medal Class, Sport Horse Showmanship, Sport Horse Under Saddle Walk/Trot 10 and under NEW!! Arabian Western Dressage; Non-Arabian Western Dressage; Arabian Opportunity Classes in Traditional Dressage, Sport Horse and Western Dressage areas

AHA Region 10 Qualifying Classes

WDHA Dressage & Sport Horse Show
Entries close: June 1, 2019 (Postmark)

No late entries in Dressage.
Late entries for Sport Horse Classes may be accepted after June 10, 2019 based upon space availability and payment of post-entry fees.
See information located on page 3



www.wdhaarabian.com

New for this year!!!

Online entries with payment options.

Payments may be made using:

- Credit Card
- Checking account by supplying routing information
- Fill out entry, print and mail with your check

See information on Page 4

**REGION 10 DRESSAGE
AND
SPORT HORSE CLASSES**
June 22 and June 23, 2019

Dressage Classes
Training Level through Intermediate I
Sport Horse In-Hand and Under Saddle,
Show Hack

Region 10 Championship Classes
Entries close: June 1, 2019
(Postmark)



www.region10arabians.com

Welcome to the WDHA Dressage and Sport Horse Show

This show is licensed/approved by:
 US Equestrian Federation / United States Dressage Federation 317948
 Arabian Horse Association 191014528
 Western Dressage Association of
 America 19-149
 WDCTA SE Chapter Approved
 (Open Breed Western Dressage only)
 Central States Dressage & Eventing
 Association (CSDEA)

Judges:

Dressage Judge	Anne Cizadlo, "S", FL
Sport Horse In-Hand/Under Saddle/Equitation/Western Dressage	Renee Johnson, "r", "R", CA
Ring Steward	TBA
Technical Delegate/Steward	Mr Val Bastinelli, "R/C2", "r/TD", PA

Show Officials

Show Manager Show	Candy Ziebell, 262.363.3640
Secretary	Anne Sushko, 563.556.5261
Photographer	Darcie Strobach, Highland Photography
Veterinarian (On-Call)	Fredonia Veterinary Clinic, Fredonia, WI
Farrier	On Call: Chris Adickes 414.339.4663
Barn Manager	Duane Ziebell
EMT	Carol DeGroot
Announcer	Kristin Urban

Fees

Arabian Dressage Classes:		
--Intro through 2 nd Level	30.00	AHA 9-90 Fee & Post-Recognition Fee (9-90 fee \$5, Post-Recognition \$5) 10 .00
--3 rd Level and 4 th Level	35.00	AHA Single Event 35.00
--FEI Levels:	40.00	USEF Fees (\$15 D&M, \$8 USEF) 23.00
Offered as Option Classes		
See Information later in Prize list		Stalls/Tack Stalls 85.00
Equitation, Dressage Seat Medal, Showmanship	30.00	Stall Deposit fee (separate check) See info on page 5 25.00
Sport Horse In-Hand/Under Saddle and Show Hack	30.00	Office Fee 30.00
		NSF Return Check Fee 50.00
Arabian Western Dressage		
--Intro through 2 nd Level	30.00	Late Entry Fee (Per class. See Page 5) 10.00
Open Breed Western Dressage		
--Intro through 2 nd Level	30.00	Camping – Info later in prize list
--3 rd and 4 th	35.00	Option Classes: See Page 5 35.00
Opportunity Classes	30.00	Team Competition Each member of team 5.00

Thank you

to some of our Sponsors
for their generous donations

Lynch Buick GMC of West Bend

for generously lending two new vehicles to be used as our judges
booths.

Elite Sporthorses of Saskatchewan, Canada

for generously donating a beautiful browband.

SmartPak

for their generous donation of gift certificates.

Purina Animal Nutrition of Fond du Lac – Courtesy of Ashlie Yancy

For the generous donation of four bags of Purina feed

Aislinn Brander

for the generous donation of an artwork bag

ENTRIES: BRING THE ORIGINAL COGGINS ON THE DAY OF THE SHOW!! Wisconsin requires a negative **COGGINS TEST**, dated within the current calendar year. Original report form or a health certificate with date of Coggins test must be presented prior to horse being unloaded at the show. **Coggins must be legible. The State of Wisconsin requires a health certificate for all horses entering the state. For clarification, use horse's show name on the Coggins test and not his stable name.** Send photocopy with entry form.

Equine Influenza & Herpes Virus Vaccine Documentation—Within Last 6 Months: Documentation of administration within the last 6 months for the Equine Influenza & Herpes Virus vaccines must be sent in with stall request form. A copy will also need to be presented and left in the Show Office if not sent in with stall request form. **Horses will not be allowed off of trailers without proper documentation.** GR 845 (BOD 01/17/15 Effective 12/01/15)

COPIES: Send copies of all association cards and certificates with your entry. Per USEF, you are now **required** to send a copy of your US Equestrian Federation or USCTA card with your entry. Please include a copy of both sides of registration papers with your entry.

Arabian owners/riders/handlers: Current **Competition Level Membership** is required for all owners, trainers, riders, drivers & handlers or a Single Event Membership must be purchased for \$35 per person. **Single membership is not applicable to regional classes.**

AHA Member Statement: Each competitor (this includes at least one recorded owner and all trainers, drivers, riders, halter handlers, coaches, and the person(s) signing the entry blank) in an Arabian Horse Association recognized Arabian division, at the time of entry into a competition, must submit a copy of a valid AHA membership/competition card, join AHA or pay an AHA single event membership fee per competitor. When an agent signs for the owner at an AHA recognized competition, both the owner and agent must be members of AHA or pay the AHA single event membership. Single event membership is not acceptable at AHA regional or national competitions. Exhibitors in walk-trot classes are exempt from AHA membership requirements at qualifying competitions, but must have an AHA membership with competition card at AHA regional and national competitions. Exhibitors in lead line classes or parents/guardians signing for minors are exempt from AHA membership requirements (BOD 5/12)

Western Dressage: Both Arabian and Open Breed competitors must be members of USEF and AHA (if applicable). WDAA membership is optional unless you are going for Lifetime Registration with WDAA, and then membership is necessary. All classes are recognized by WDAA.

Opportunity Classes: Entries into these classes do not have to be members of any of the organizations (USEF, USDF, AHA). These entries are for those at a schooling show level or those people who wish to come and join their friends who are competing and get a taste of the show atmosphere. The only fees associated with these classes are the following: Class Fee, Office Fee, and stall fees. They will also be responsible for any of the miscellaneous fees (camping, etc) should they use them. The classes are conducted in accordance to USEF rules and guidelines. These entries cannot crossover to the recognized classes.

ONLINE ENTRIES: To enter online using credit card, checking account, or filling out and printing to mail in the conventional method, please go to:

www.horseshowoffice.com >> Events >> scroll down to our show WDHA Dressage & Sport Horse Show or the dates (June 20-21, 2019) >> click on the link to enter online. The link will guide you through the process. If you have any questions, please call Anne Sushko at 563.556.5261.

Entry Fees: To be accepted, entries must be complete, correct and received by the closing date. Entries must be accompanied by full payment in order to be processed. An entry form must be completed and fees paid for every horse on the show grounds. Entries must be signed by the owner/agent, the trainer, and by all riders/handlers. **Juniors may not sign the entry form.** Exhibitors are responsible for their own errors and those of their agents in the preparation of entry blanks. Exhibitor numbers will not be released until all entries are complete. Make checks payable to **WDHA**. Mail all entries to: **Anne Sushko, 563.556.5261, (gandasushko@hotmail.com), 1942 Clifford St, Dubuque, IA 52002 (Late entries may be permitted in Sport Horse classes after the deadline but no later than June 10, 2019, space/time permitting and payment of a late entry fee. Late fee is charged PER CLASS, in addition to the regular class fee. i.e. Class fee \$25 + \$10 late fee = \$35 for class)**

Option Classes: Option Classes may be purchased from the list provided for \$75.00, which includes one (1) entry into that class. (i.e. Prix St Georges Option fee \$35 + class fee \$40 = \$75). Any other entries into that particular class will be at the cost of the class. The cost for the class is listed in the fee list. Option classes will only be available on Thursday and are listed on Thursday's class list.

Refunds: Class entry fees and AHA 9-90/Post-Recognition fees will be given if written verification of unsoundness by a veterinarian is in possession of the Show Secretary **before the commencement of the show.** Stall fees and other related show fees will not be refunded.

Arenas: 2 competition arenas (150' x 300', 150' x 300') with sand footing. Warm-up ring is 75' x 150' and gravel footing. For your protection, **No** grass warm up is available. Tests so approved by US Equestrian Federation may be held in a small arena.

Stabling: Stalls are 10x10 in size. Stabling will be available **after 12:00 noon on Wednesday, June 20, 2018.** All horses must have a stall. There will be no showing out of a trailer. Please be considerate of your stall neighbors when arriving at the grounds. Do not change your stall location unless you check with the barn manager.

Stalls are box stalls with fixed fronts. Anyone bringing a stallion is responsible for bringing suitable equipment to close off the stall, if necessary. Stabling requests will be honored, when possible, but are not guaranteed. If you wish to be stabled with specific people, it is recommended that all entries be mailed together. Those making no requests will be considered as having no preference.

NEW--Stall Deposit. A separate check for \$25.00 is to be left in the show office to cover stall cleaning should you decide not to clean your stall. Your check will be returned to you once the barn manager has checked your stall. This check will only be deposited if your stall is not cleaned. **FACILITY REQUIRES ALL STALLS TO BE STRIPPED WHEN LEAVING.**

THERE IS TO BE NO SMOKING IN THE BARN.

Bedding: No bedding is available on the grounds.

Camping fees: \$30 + Tax per night. All camping is to be arranged with Washington County Fair Park. (262.677.5060) Fees are to be paid directly to the facility. Facility office is noted on map. **You must contact facility for camping arrangements and payment. DO NOT SEND CAMPING FEES WITH ENTRY.** There is to be **no camping in areas that are not designated as camping.** This is monitored by the Washington County Sheriff's Department. There are 133 campsites. Each site is 35' in length. There are water hook ups as well as electric hookups. Each electric hook up has two 50W, one 30W, and one 20W connections. There is an on-site dumping station with two drive ups. There are also seasonal shower facilities. **See map for location.** Fires are not permitted unless agreed upon by Fair Park & Conference Center management. Pets are allowed, but they must be leashed and waste cleaned up.

PARKING: All vehicles (other than camping vehicles and horse trailers) **MUST** park in the parking lot to the south of the competition rings per the Facility. **See location on map.**

DOGS and OTHER ANIMALS: Please do **NOT** bring them. If you must, keep them on a **short leash** attached to a responsible adult. Waste must be cleaned up.

EXHIBITORS: Entering a horse in classes differing by more than one level (dressage) is prohibited.

PROTECTIVE HEAD GEAR. Effective April 1, 2013: From the time horses are officially admitted to the competition grounds by competition management, anyone mounted on a horse **at any time** on the competition grounds, including non-competing riders, riders on non-competing horses, and those competing in all classes and tests, including Para-Equestrian tests, must wear protective headgear as defined by this rule and otherwise in compliance with GR801. **Please see the complete rule, USEF DR120.6, on page 11 of this prize list.**

NSF CHECK POLICY. There will be a \$50 penalty each time a check is presented to our bank and returned due to insufficient funds. Violators will be reported to US Equestrian Federation. Guaranteed funds will be required of violators in the future.

RIDE TIMES: Every attempt will be made to have the ride times posted on the WDHA website, www.wdha.net, as well as emailed to a **valid email address** that is provided on the entry form no later than **THREE (3) days** prior to the start of the show. This is subject to any late entries. For those who may be entering late, please be aware that you may not receive your ride times until you check in.

WARNING: Under the Equine Activity Liability Act, each participant who participates in an equine activity expressly assumes the risks of engaging in and legal responsibility for injury, loss, or damage to person or property resulting from the risk of equine activities.

"EVERY CLASS OFFERED, HEREIN, WHICH IS COVERED BY THE RULES AND SPECIFICATIONS OF THE CURRENT FEDERATION RULE BOOK WILL BE CONDUCTED AND JUDGED IN ACCORDANCE THEREWITH." BOD 1/16/05 Effective 12/1/05

GR811 - Horse ID Number (HID): All horses competing in Federation licensed competitions (except those activities enumerated in GR1401.9, items 1-9) must be properly identified and must obtain a Horse ID Number from The Federation. An identification number for each horse must be entered on all entry forms for licensed competitions. Only one Horse ID Number will be issued per horse, and must remain with the horse throughout its career. Anyone knowingly applying for a duplicate Horse ID Number for an individual horse may be subject to disciplinary action. The Federation must be notified of any change of ownership and/or competition name of the horse. Owners are requested to notify the Federation of corrections to previously submitted information, e.g., names, addresses, breed registration, pedigree, or markings. (BOD 1/16/05 Effective 12/1/05)

1. Federation life recording numbers are the same as Horse ID Numbers.
2. Applications for Horse ID Numbers are available from the Federation office, and/or can be downloaded from the Federation website or from competition management. Competition management is responsible for notifying exhibitors of this requirement in their prize lists.
3. There will be no charge for Horse ID Numbers that are issued via the internet to members of USEF or its affiliates for: 1) horses that are life recorded, registered or otherwise identified or listed with a USEF discipline affiliate, or 2) horses registered with a USEF breed affiliate. Horses not meeting the above criteria must have a completed Horse Identification Form submitted with the application for a Horse ID Number before a number will be issued. Horse ID Numbers issued via mail will be charged \$10. (BOD 1/16/05 Effective 12/1/05)

GENERAL INFORMATION

(Please read for information regarding classes, etc)

~~ Exhibitors ... Did you know ... ~~

--- That if you place 1 - 6 in any Sport Horse class (In-hand or Under Saddle), you may be qualified for your corresponding Regional Championship class based on points given. See the AHA Handbook for point schedule.

--- That if you place 1 – 6 in any Dressage class or have two required scores (Training through Intermediate I), you may be qualified for the corresponding Regional Championship class based on points given. See the AHA Handbook for point schedule.

--- A 1st or 2nd place earned in a class can be used as qualification for the corresponding Regional class.

--- Qualifications for Yearlings and 2-year-olds will be waived at the National Shows. If qualifications for National classes are waived, qualifications for that same Regional class will also be waived. (See COMP 1201.10)

ATTENTION EXHIBITORS: Minors who do not have a valid driver's license which allows them to operate a motorized vehicle in the state in which they reside will not be permitted to operate a motorized vehicle of any kind including, but not limited to, golf carts, motorcycles, scooters, or farm utility vehicles on the competition grounds of licensed competitions. Minors who have a valid temporary license may operate the above described motorized vehicles as long as they are accompanied by an adult with a valid driver's license. The parent(s), legal guardian(s), or individual who signs the entry blank as a parent or guardian of a minor operating a motorized vehicle in violation of this rule are solely responsible for any damages, claims, losses or actions resulting from that operation. Violations of this rule will be cause for sanctions against the parent(s), guardian(s) and/or trainer(s) who are responsible for the child committing the offense. Penalties may include exclusion of the child, parent(s), guardian(s) and/or trainer(s) from the competition grounds for the remainder of the competition and charges being filed against any of the above individuals in accordance with Chapter 6. Wheelchairs and other mobility assistance devices for individuals with disabilities are exempt from this rule.

Awards: High Point awards for: Purebred Arabian Open; HA/AA Open; Amateur to Ride (PB/HA/AA); PB/HA/AA Junior to Ride. High Percentage Dressage Ride, sponsored by Dah-Ban Arabians. A High Point award for Highest Percentage Western Dressage – Arabian as well as Non-Arabian will be given.

PREMIUMS: Ribbons through 6th place.

High Point Awards

The high point awards given at the show, Purebred Arabian Open, HA/AA Open, PB/HA/AA Junior to Ride and Amateur to Ride are given to the highest scoring ride in each of these categories. There will be no duplication of awards (i.e. highest JTR cannot win highest ATR or Open award). The High Percentage Dressage Ride sponsored by Dah-Ban Arabians will be awarded to the highest overall dressage score and **MAY** duplicate a previously given high point award. This is the only award that may possibly duplicate another award.

Back by popular demand ... Team Competition!!

Once again, we will be having a fun Team Competition along with our regular classes on Thursday and Friday.

There is a small fee of **\$5.00 per person on each team** to enter and no special rides to do. You just ride your normal classes, and we do all the work! All entries for the Team Competition must be made **before the start of classes on Friday, JUNE 21, 2019**. They can also be sent with your show entry. If you do not have a team, but would like to be on one, please indicate this on your entry form and we can match you with someone who might need another member. Entry forms will be available in the Show Office.

Here are your rules:

1. All teams must consist of three members – two (2) Dressage entrants **AND** one (1) Sport Horse In-hand/Under Saddle entrant. Team members can be juniors as well as adults. An entrant cannot use scores from two areas for one team. However, an entrant **MAY** be on two teams, competing in different areas on both teams. (i.e. Team 1 doing Dressage and Team 2 doing Sport Horse In-hand). Fees must be paid for both teams.
2. Dressage riders must ride two tests. These will be averaged together and that average used to figure final score.
3. Sport Horse In-hand/Under Saddle need do only one class. The highest score/placing will be used. Under Saddle classes will be given a percentage based on their placing in the class (i.e. 1st = 60; 2nd = 50; 3rd = 40; 4th = 30; 5th = 20; 6th = 10)
4. The two Dressage averages will be added to the scores received in the Sport Horse classes to achieve a final score.
5. Final scores will be ranked highest to lowest and placed accordingly. Results will be announced Friday after all team riders entered are finished and scores tabulated.
6. Name your team! Have fun and be creative with your names. Anything goes!

LIFE, SENIOR ACTIVE AND JUNIOR ACTIVE MEMBERS SHALL BE ELIGIBLE TO PARTICIPATE IN ALL CLASSES AT REGULAR COMPETITIONS, EVENTING COMPETITIONS AT THE PRELIMINARY LEVEL OR ABOVE AND COMBINED DRIVING COMPETITIONS AT THE ADVANCED LEVEL, DRESSAGE, REINING AND VAULTING COMPETITIONS AND ENDURANCE RIDES. A NON-MEMBER MAY PARTICIPATE AS A HANDLER, RIDER, DRIVER, OWNER, LESSEE, AGENT, COACH OR TRAINER AT REGULAR COMPETITIONS, EVENTING COMPETITIONS, DRESSAGE COMPETITIONS, REINING COMPETITIONS AND COMBINED DRIVING COMPETITIONS UPON PAYMENT OF A \$30.00 SHOW PASS FEE. PARTICIPANTS IN THE FOLLOWING CLASSES ARE EXEMPTED FROM THE REQUIREMENTS OF THIS RULE: 1) LEADLINE; 2) EXHIBITIONS; 3) GAMES AND RACES; 4) CLASSES FOR 4-H MEMBERS; 5) WALK-TROT (EXCEPTION PERFORMANCE FR 218) AND ACADEMY CLASSES (ACADEMY CLASSES ARE CLASSES LIMITED TO HORSES USED REGULARLY IN A LESSON PROGRAM); 6) USDF INTRODUCTORY LEVEL TESTS, PAS DE DEUX AND QUADRILLE CLASSES; 7) NRHA ENDORSED REINING COMPETITIONS. 8) OPPORTUNITY CLASSES, 9) CITIZENS OF OTHER NATIONS WHO HAVE PROOF, IN ENGLISH, OF CURRENT MEMBERSHIP IN GOOD STANDING OF THEIR OWN NATIONAL FEDERATION; 10) USEA BEGINNER NOVICE DIVISION; AND 11) ASSISTANT HANDLERS IN DRESSAGE SPORT HORSE BREEDING CLASSES.

Exhibitors!

New for this year to the WDHA Dressage and Sport Horse show are Western Dressage Classes, for both Arabian/Half-Arabian/Anglo-Arabian as well as All-Breeds. These classes are all recognized by the Western Dressage Association of America.

With this recognition, along with our Dressage judge being a "R" Western Dressage judge, those who are involved with the WDAA Horse Lifetime Points & Awards Program (WHL PAP), will be able to earn double points.

More information on the program can be found at:
<http://westerndressageassociation.org/wdaa-horse-lifetime-points-and-awards-program/>

To learn more about WDAA, go to:
www.westerndressageassociation.org



WDHA Futurity & Open Show

The WDHA Futurity & Open show will be held September 21-22, 2019, at the Sunnyview Expo Center in Oshkosh, WI. For more information, please check the WDHA website at www.wdhaarabianhorse.com

Classes not necessarily in order of go

Thursday Classes

Arabian/HA/AA Dressage

100	1382	Intro A
101	1382	Intro B
102	1382	Intro C
103	792	Training Level Test 1 ATR
104	792	Training Level Test 1 JTR
105	790	Training Level Test 2
106	792	Training Level Test 3 ATR
107	801	First Level Test 1 ATR
108	801	First level Test 1 JTR
109	797	First Level Test 2
110	801	First Level Test 3 ATR
111	1810	Second Level Test 1 ATR
112	1807	Second Level Test 2
113	1810	Second Level Test 3 ATR
114	818	Third Level Test 1 ATR
115	815	Third Level Test 2
116	818	Third Level Test 3 ATR
117	823	Fourth Level Test 1
118	823	Fourth Level Test 2
119	823	Fourth Level Test 3

Arabian/HA/AA Western Dressage

500	2201	WDAA Intro Level Test 1
501	2201	WDAA Intro Level Test 3
502	2301	WDAA Basic Level Test 2
503	2301	WDAA Basic Level Test 4
504	2401	WDAA First Level Test 1
505	2401	WDAA First Level Test 3
506	2501	WDAA Second Level Test 2
507	2501	WDAA Second Level Test 4

Arabian/HA/AA Opportunity Classes - Dressage

10	Arabian/HA/AA Intro A Opportunity
11	Arabian/HA/AA Intro C Opportunity
12	Arabian/HA/AA Training Level Test 1 Opportunity
13	Arabian/HA/AA Training Level Test 3 Opportunity

Arabian/HA/AA Opportunity Western Dressage

15	WDAA Intro 1 Opportunity
16	WDAA Intro 3 Opportunity
17	WDAA Basic Level Test 2 Opportunity
18	WDAA Basic Level Test 3 Opportunity

Arabian/HA/AA Sport Horse

300	39	Arabian Sport Horse Yearling filly
301	39	Arabian Sport Horse Mares
302	43	Arabian Sport Horse Mares ATH
303	2800	Arabian Sport Horse Geldings
304	2748	Arabian Sport Horse Geldings ATH
305	46	Arabian Sport Horse Yearling Colt
306	53	Arabian Sport Horse Yearling Gelding
307	46	Arabian Sport Horse Stallion
308	479	HA/AA Sport Horse Mares ATH
309	498	HA/AA Sport Horse Geldings ATH
310	494	HA/AA Sport Horse Geldings
311	490	HA/AA Sport Horse Mares JTH
312	492	HA/AA Sport Horse Geldings JTH
313	484	HA/AA Sport Horse Stallion
314	339	Arabian Sport Horse U/S ATR
315	341	Arabian Sport Horse U/S Junior Horse
316	335	Arabian Sport Horse U/S
317	777	HA/AA Sport Horse U/S
318	773	HA/AA Sport Horse U/S JTR
319	351	Arabian Sport Horse Show Hack ATR
320	1050	HA/AA Sport Horse Show Hack
321	429	Dressage Equitation JTR
322	1695	Sport Horse Showmanship ATH

Open Breed Western Dressage

(No Arabian Crossover)

700	WDAA Intro Level Test 1
701	WDAA Intro Level Test 3
702	WDAA Basic Level Test 2
703	WDAA Basic Level Test 4
704	WDAA First Level Test 1
705	WDAA First Level Test 3
706	WDAA Second Level Test 2
707	WDAA Second Level Test 4
708	WDAA Third Level Test 1
709	WDAA Third Level Test 3
710	WDAA Fourth Level Test 2
711	WDAA Fourth Level Test 4

Thursday Option Classes Available

Arabian/HA/AA Entries Only

106.1	792	Training Level Test 3 JTR
110.1	8010	First Level Test 2 JTR
120.1	882	Prix St Georges
121.2	1816	FEI TOC (Intermediate I, II, or Grand Prix)

Classes not necessarily in order of go

Friday Classes

Arabian/HA/AA Dressage

200	1382	Intro A
201	1382	Intro B
202	1382	Intro C
203	792	Training Level Test 1
204	792	Training Level Test 2 JTR
205	790	Training Level Test 2 ATR
206	792	Training Level Test 3
207	801	First Level Test 1
208	797	First Level Test 2 ATR
209	801	First Level Test 3
210	1807	Second Level Test 1
211	1810	Second Level Test 2 ATR
212	1807	Second Level Test 3
213	815	Third Level Test 1
214	818	Third Level Test 2 ATR
215	815	Third Level Test 3
216	823	Fourth Level Test 1
217	823	Fourth Level Test 2
218	823	Fourth Level Test 3

Arabian/HA/AA Western Dressage

600	2201	WDAA Intro Level Test 2
601	2201	WDAA Intro Level Test 4
602	2301	WDAA Basic Level Test 1
603	2301	WDAA Basic Level Test 3
604	2401	WDAA First Level Test 2
605	2401	WDAA First Level Test 4
606	2501	WDAA Second Level Test 1
607	2501	WDAA Second Level Test 3

Arabian/HA/AA Opportunity Dressage

20	Arabian/HA/AA Intro B Opportunity
21	Arabian/HA/AA Training Level Test 2 Opportunity
22	Arabian/HA/AA First Level Test 1 Opportunity

Arabian/HA/AA Opportunity Western Dressage

24	WDAA Intro Level Test 2 Opportunity
25	WDAA Basic Level Test 1 Opportunity

Arabian/HA/AA Sport Horse

400	50	Arabian Sport Horse Stallion ATH
401	475	HA/AA Sport Horse Yearling Filly
402	494	HA/AA Sport Horse Yearling Gelding
403	484	HA/AA Sport Horse Yearling Colt
404	475	HA/AA Sport Horse Mares
405	385	Arabian Sport Horse Mares JTH
406	387	Arabian Sport Horse Geldings JTH
407	488	HA/AASport Horse Stallion ATH
408	779	HA/AA Sport Horse Junior Horse
409	1066	Arabian Sport Horse U/S JTR
410	1095	HA/AA Sport Horse U/S ATR
411	347	Arabian Sport Horse Show Hack
412	1054	HA/AA Sport Horse Show Hack ATR
413	429	Dressage Equitation JTR
414	434	Dressage Seat Medal JTR
415	1548	Sport Horse U/S Walk/Trot 10 & Under
416	NQ	Leadline Age 2 to 6

Open Breed Western Dressage

(No Arabian Crossover)

800	WDAA Intro Level Test 2
801	WDAA Intro Level Test 4
802	WDAA Basic Level Test 1
803	WDAA Basic Level Test 3
804	WDAA First Level Test 2
805	WDAA First Level Test 4
806	WDAA Second Level Test 1
807	WDAA Second Level Test 3
808	WDAA Third Level Test 2
809	WDAA Third Level Test 4
810	WDAA Fourth Level Test 1
811	WDAA Fourth Level Test 3



WDHA Dressage & Sport Horse Show

June 20-21, 2019

Entry Deadline: June 1, 2019

SEND TO:
Anne Sushko
1942 Clifford St
Dubuque, IA 52002
PH: 563.556.5261

PLEASE TYPE OR PRINT ONLY ONE HORSE PER ENTRY FORM. All entries must be complete. Enclose correct fees, copies of horse registration papers, purchase contract (if applicable), USEF/EC membership cards, amateur certification (if applicable), AHA Competition level membership cards for each rider, driver, handler, trainer and owner.

Horse's Name		Reg. No.		DOB MM/DD/YY	Sex	Color	Sweepstakes Yes No
Sire		Dam		Horse USEF ID#		Horse USDF ID#	
Rider 1	Classes /						TOTAL FEES
	Entry Fees						\$
Name		DOB MM/DD/YY	Amateur Certificate Yes No		Junior/Amateur Relationship to horse owner		
AHA#		USEF/EC#	USDF#		US Citizen: Yes No		
Address		City		State	Zip		
Rider 2	Classes						TOTAL FEES
	Entry Fees						\$
Name		DOB MM/DD/YY	Amateur Certificate Yes No		Junior/Amateur Relationship to horse owner		
AHA#		USEF/EC#	USDF#		US Citizen: Yes No		
Address		City		State	Zip		
Rider 3	Classes						TOTAL FEES
	Entry Fees						\$
Name		DOB MM/DD/YY	Amateur Certificate Yes No		Junior/Amateur Relationship to horse owner		
AHA#		USEF/EC#	USDF#		US Citizen: Yes No		
Address		City		State	Zip		

Each person signing this entry form acknowledges that he/she has read the front and reverse of this Entry Form and agrees to the applicable terms, conditions, waivers ALL OWNERS, TRAINERS, RIDERS, DRIVERS & HANDLERS MUST SIGN ON THE BACK. Minor entrants must also have parent/guardian signature(s) on the back, releases, indemnification and consent as set forth herein. Each person agrees that the information is accurate to the best of his/her knowledge.

THE FOLLOWING MUST BE SENT WITH YOUR ENTRIES
Photo copies of AHA, USEF/EC, Membership cards for each Rider/Driver/Handler/Trainer/Owner,
Horses Registration papers & Purchase contract if applicable and Stall Reservation Forms

OWNER INFORMATION Owner name as it appears on registration papers/purchase contract

Name _____
 AHA# _____ USEF/EC# _____ USDF# _____
 Farm/Ranch _____ USEF Farm# _____
 Current Address _____ Phone _____
 City _____ ST _____ Zip _____
 E mail _____

TRAINER INFORMATION (must be filled out, if there is no trainer, owner may write same in trainer information)

Name _____
 AHA# _____ USEF/EC# _____ USDF# _____
 Address _____ Phone _____
 City _____ ST _____ Zip _____
 E mail _____

ADDITIONAL INFORMATION Camper Plate # _____ Camper make _____

Send Acknowledgement to Owner _____ Trainer _____
 Email Acknowledgement to (Print) _____
 Stable with _____

Total Class Fees _____ \$ _____
 Office Fee (per horse) @ _____ \$ 30.00
 USEF Fee @ _____ \$ 23.00
 15 Drug 8 Admin
 AHA Resolution 9-90 @ _____ \$ _____
 Box Stalls _____ \$85.00 _____ \$ _____
 Tack Stall _____ \$85.00 _____ \$ _____

Show Pass/Single Event Fees:
 AHA Single Event Fee @35.00 _____ \$ _____
 USEF Show Pass Fee @ 45.00 _____ \$ _____

Other Fees
 Late Fee -\$10 per class + class fee _____ \$ _____
 Team Competition \$5 each _____ \$ _____
 Class Sponsorship \$25 each class _____ \$ _____
 Misc _____ \$ _____
 Misc _____ \$ _____
 Stall Cleaning Deposit \$25 (separate ck) \$ _____
 Misc _____ \$ _____

TOTAL FEES DUE _____ \$ _____

<p><u>ALL ENTRY FORMS MUST BE PROPERLY SIGNED ON BACK</u></p> <p>Make Checks payable to WDHA Mail to: Anne Sushko 1942 Clifford St Dubuque, IA 52002</p>	OFFICE USE ONLY	
	Office Use Total \$	
	Paid \$	
	Check Number	
Date Rcvd		

AHA ENTRY AGREEMENT

I have read the rules concerning competitions as printed in the Arabian Horse Association (AHA) Handbook / Directory and Competition Prize List and agree to be bound by and subject to those Rules.

AHA ASSUMPTION OF RISK, RELEASE AND INDEMNIFICATION This document waives very important legal rights. Read it carefully before signing.

In consideration for AHA permitting me to participate in this Competition, and by signing the entry blank, I agree as follows:
I AGREE that I choose to participate voluntarily in this Competition, as a rider, driver, handler, lessee, owner, agent, coach, trainer, junior exhibitor, or as a parent or guardian of a junior exhibitor. **I AM FULLY AWARE AND ACKNOWLEDGE THAT HORSE SPORTS AND PARTICIPATION IN THIS COMPETITION INVOLVE SERIOUS RISK OF HARM INCLUDING, BUT NOT LIMITED TO, RISKS OF ACCIDENT, SERIOUS BODILY INJURY, INCLUDING DEATH, BROKEN BONES, HEAD INJURIES, TRAUMA, PAIN, AND SUFFERING, AND PROPERTY DAMAGE. I ASSUME ALL RISKS OF HARM TO ME, MY HORSE OR MY PROPERTY.**
I AGREE for myself, my heirs, executors, administrators, successors and assigns to release AHA, the Competition, the facilities leased by the Competition and the owner(s) of the facilities, and all of their respective officers, officials, directors, employees, agents, personnel, volunteers, affiliated organizations and insurers (collectively, the "Released Parties") from any and all claims for damage, loss, or injury to myself, other persons, horses or other property belonging to me to the fullest extent permitted by law that arises out of or relates in any way to the Competition and my participation in the Competition INCLUDING, BUT NOT LIMITED TO, DAMAGES, LOSS, OR INJURY RESULTING FROM ANY ACTS, FAILURE TO ACT, NEGLIGENCE OR NEGLECT OF OTHER ENTRANTS, THE RELEASED PARTIES, THEIR CONTRACTORS OR INVITEES, as well as for theft, vandalism, fire, other casualty damage, or damage arising out of any defects in the premises.
I AGREE to indemnify and hold harmless (that is pay all losses, damages, attorneys fees and costs of) the Released Parties from and against any and all claims, demands, penalties, actions, losses, costs, damages, injuries, liabilities and obligations (including attorneys fees) of whatsoever kind and nature, which may be asserted against or incurred by any of them as a result of (1) my participation in the Competition or (2) any act, failure to act, or neglect (a) by me, my agents, employees, riders, handlers, trainers, coaches, drivers, contractors or invitees, or (b) by any animal owned or exhibited by me or in my custody or control.
I AGREE and represent that I am qualified and eligible to enter and/or participate in the Competition, and every horse I am entering is qualified and eligible as entered.
I AGREE to accept AS FINAL any decision of AHA, the Show Commission or Show Officials concerning my qualification or the qualification of my horse to enter the Competition or any results of the Competition, except to the extent that the Rules of AHA, the Competition, CEF or USA Equestrian permit a protest or hearing of such decisions. Should a hearing be requested, I agree to accept AS FINAL the decision of the particular hearing body. I agree to release, hold harmless and not to sue AHA, the Competition Sponsor, their officers, directors, employees, volunteers or members concerning any decision of AHA, the Competition, its Show Commission, Show Officials or any hearing body that relates to my qualifications or my horse(s)' qualifications to enter the Competition or any results of the Competition.
I AGREE that AHA has the sole right to control, sell, supervise or give away (or assign to others the right to do so) the exclusive rights to broadcast, televise, reproduce, transmit and disseminate all or part of this event, and I agree that AHA may use or assign, in any way AHA sees fit, photographs, films, videos, audios, cablecasts, or other likenesses of me and my horse taken during the course of the Competition for the promotion, coverage or benefit of the Competition or AHA. Those likenesses shall not be used to advertise a product and they may not be used in such a way which implies endorsement of any company, product, product category or service. I hereby expressly and irrevocably waive and release any rights in connection with such use, including any claim to compensation, invasion of privacy, right of publicity, or to misappropriation.
 By signing below as a parent or guardian of a junior exhibitor, I consent to the child's participation and agree to all of the above provisions, and further agree to assume all of the obligations of this AHA Assumption of Risk, Release and Indemnification personally and on behalf of the child.
 This AHA Assumption of Risk, Release and Indemnification is governed by the Laws of the State of Colorado and is intended to be interpreted as broadly as possible. I agree that exclusive jurisdiction and venue (place) for any legal action against AHA, its officers, directors, employees, volunteers or agents shall be in the local district courts or the federal court of the State of Colorado. If any part of this agreement is determined to be unenforceable, all other parts shall remain effect.

Federation entry agreement

By entering a Federation-licensed Competition and signing this entry blank as the Owner, Lessee, Trainer, Manager, Agent, Coach, Driver, Rider, Handler, Vaultor or Longeur and on behalf of myself and my principals, representatives, employees and agents, I agree that I am subject to the Bylaws and Rules of The United States Equestrian Federation, Inc. (the "Federation") and the local rules of this Competition. I agree to be bound by the Bylaws and Rules of the Federation and of the competition. I will accept as final the decision of the Hearing Committee on any question arising under the Rules, and agree to release and hold harmless the competition, the Federation, their officials, directors and employees for any action taken under the Rules. I represent that I am eligible to enter and/or participate under the Rules, and every horse I am entering is eligible as entered. I also agree that as a condition of and in consideration of acceptance of entry, the Federation and/or the Competition may use or assign photographs, videos, audios, cable - casts, broadcasts, internet, film, new media or other likenesses of me and my horse taken during the course of the competition for the promotion, coverage or benefit of the competition, sport, or the Federation. Those likenesses shall not be used to advertise a product and they may not be used in such a way as to jeopardize amateur status. I hereby expressly and irrevocably waive and release any rights in connection with such use, including any claim to compensation, invasion of privacy, right of publicity, or to misappropriation. The construction and application of Federation rules are governed by the laws of the State of New York, and any action instituted against the Federation must be filed in New York State. See GR908.4.

Federation release, assumption of risk, Waiver, and indemnification this document waives important legal rights. read it carefully before signing.

I AGREE in consideration for my participation in this Competition to the following: **I AGREE** that the "Federation" and "Competition" as used herein includes the Licensee and Competition Management, as well as all of their officials, officers, directors, employees, agents, personnel, volunteers and Federation affiliates.
I AGREE that I choose to participate voluntarily in the Competition with my horse, as a rider, driver, handler, vaultor, longeur, lessee, owner, agent, coach, trainer, or as parent or guardian of a junior exhibitor. I am fully aware and acknowledge that horse sports and the Competition involve inherent dangerous risks of accident, loss, and serious bodily injury including broken bones, head injuries, trauma, pain, suffering, or death. ("Harm").
I AGREE to hold harmless and release the Federation and the Competition from all claims for money damages or otherwise for any Harm to me or my horse and for any Harm of any nature caused by me or my horse to others, even if the Harm arises or results, directly or indirectly, from the negligence of the Federation or the Competition.
I AGREE to expressly assume all risks of Harm to me or my horse, including Harm resulting from the negligence of the Federation or the Competition. **I AGREE** to indemnify (that is, to pay any losses, damages, or costs incurred by) the Federation and the Competition and to hold them harmless with respect to claims for Harm to me or my horse, and for claims made by others for any Harm caused by me or my horse while at the Competition. I have read the Federation Rules about protective equipment, including GR801 and, if applicable, EV114, and I understand that I am entitled to wear protective equipment without penalty, and I acknowledge that the Federation strongly encourages me to do so while WARNING that no protective equipment can guard against all injuries. If I am a parent or guardian of a junior exhibitor, I consent to the child's participation and **AGREE** to all of the above provisions and **AGREE** to assume all of the obligations of this Release on the child's behalf I represent that I have the requisite training, coaching and abilities to safely compete in this competition. **I AGREE** that if I am injured at this competition, the medical personnel treating my injuries may provide information on my injury and treatment to the Federation on the official USEF accident/injury report form.

BY SIGNING BELOW, I AGREE to be bound by all applicable Federation Rules and all terms and provisions of this entry blank and all terms and provisions of this Prize List. If I am signing and submitting this Agreement electronically, I acknowledge that my electronic signature shall have the same validity, force and effect as if I affixed my signature by my own hand. BOD 1/23/11 Effective 12/1/11

Owner ** Mandatory	Print Name	Signature
Trainer or Custodian of horse @ show ** Mandatory	Print Name	Signature
Rider 1 ** Mandatory	Print Name	Signature
Rider 2 ** Mandatory if there is a 2 nd rider	Print Name	Signature
Rider 3 ** Mandatory if there is a 3 rd rider	Print Name	Signature
Coach - (if applicable) USEF #	Print Name	Signature
Print Minor Name Here	Print Parent/Guardian Name Here	Signature
Print Minor Name Here	Print Parent/Guardian Name Here	Signature
***** EMERGENCY PHONE NUMBER FOR EXHIBITOR		

MUST BE SIGNED IN AT LEAST 3 PLACES BY ADULTS ONLY
AHA or USEF/EC Membership is not required for Parents/Guardians signing for minors.

WDHA DRESSAGE & SPORT HORSE SHOW
STALL REQUEST FORM
WASHINGTON COUNTY FAIR PARK
WEST BEND, WI
(Please type or print)

Owner: _____ Phone No: _____

Address: _____

Stable with: _____

I have: Stallion _____ Mare _____ Gelding _____ Tack _____

Number of Stalls: _____ at \$ 85 /stall

Stalls will be available on Wednesday, June 19, 2019, no earlier than 12 NOON.

Number of Tack Stalls: _____ at \$ 85 /stall

Check in no earlier than 2 p.m.

Total Stabling Fee: _____ Enclosed

Arrival Time: _____ Departure Time: _____

Please be sure to include this form with your entries. **Stalls will be assigned according to postmark date.** If you wish to be stabled with a specific group of people, it is recommended that entries be mailed together.

Bedding will **NOT** be available for purchase on the grounds. If you need bedding, please call Show Secretary for local stores that sell bedding.

Mail your stall request along with your entry forms to:

Anne Sushko
1942 Clifford St
Dubuque, IA
52002

Class Sponsorship Form

Want to have your name in the program? Sponsor a class or two! WDHA would greatly appreciate your support for our Dressage and Sport Horse show. We hope you are willing to sponsor a class for \$25.00. Please fill out the information below if you wish to sponsor a class.

Name: _____

Address: _____

Class # Preference: _____
(Please list a first and second choice)

Mail to Show Secretary: Anne Sushko, 1942 Clifford St, Dubuque, IA 52002

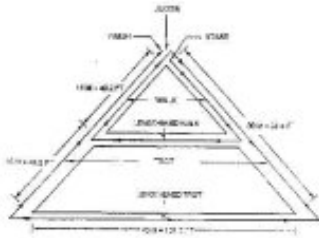

For complete rules and regulations regarding the equipment, dress, and conduct of classes, please see the following, found in the United States Equestrian Federation Rule Book.

Please also consult the Arabian Horse Association Handbook and the United States Dressage Federation website for further rules and regulations.

Dressage: See USEF rules listed in Arabian/Half-Arabian/Anglo-Arabian Division, Chapter AR, Subchapter AR-16, AR172-AR173, as well as Chapter DR, Subchapter DR-1 beginning with DR101.

Sport Horse In-Hand, Under Saddle, Show Hack: Sport Horse In-Hand classes will be conducted on the triangle. (See example above.) See USEF rules listed in Chapter AR, Subchapter AR-17 beginning with AR174 for further information. Please note correct appointments/attire for these classes.

Dressage Seat Equitation and Medal Class: See USEF rules GR 101, GR 127, GR 1306, DR 132, DR 133, AR 246, AR 247. Also, AHA rules COMP 708, COMP 709.

Sport Horse Showmanship: See USEF rule Chapter AR, Subchapter AR-17, AR184.

Sport Horse Under Saddle Walk/Trot 10 and Under: See USEF rule Chapter AR, Subchapter AR-31, AR260.

Western Dressage Classes: Please see USEF rule Chapter WD for further explanation of all Western Dressage Classes. See also Chapter AR-27, AR221.

Opportunity Classes: Please see USEF rule GR821.

PROTECTIVE HEAD GEAR.

USEF DR120.6. From the time horses are officially admitted to the competition grounds by competition management, anyone mounted on a horse at any time on the competition grounds, including non- competing riders, riders on non-competing horses, and those competing in all classes and tests, including Para-Equestrian tests, must wear protective headgear as defined by this rule and otherwise in compliance with GR801. Any rider violating this rule at any time must immediately be prohibited from further riding until such headgear is properly in place. Protective headgear is defined as a riding helmet which meets or exceeds ASTM (American Society for Testing and Materials)/SEI (Safety Equipment Institute) standards for equestrian use and carries the SEI tag. The harness must be secured and properly fitted. Unless jackets are waived, while in the competition ring, exhibitors wearing protective headgear must wear a short, dark jacket, dark tailcoat (only permitted for tests above Fourth Level), or Armed Services or police uniform (if eligible), dark hat covers (where applicable) and must otherwise conform to DR120 (see GR801).

BOD 1/19/13 Effective 4/1/13.

Exhibitors – Please be sure to check out the Equitation and Dressage Seat Medal classes that have been added as well as filling out the Dressage classes with every test for each level both days! Be sure to check out the new classes that have been added this year!

Exhibitors – If you are Sweepstakes eligible, remember to join the Point Program with AHA prior to the show. See their website for more information.

Calling all Volunteers!!

Do you have an extra hour or two where you would like to learn the 'behind the scenes' stuff about your show? Well, we would sure like to teach you! We have plenty of things that could use your help in order to make your show run without a hitch. You don't have to be a rocket scientist or even a genius to help us out...just an enthusiastic exhibitor, groom, family member or even a spectator. We promise it won't be painful <G> but will be lots of fun. Check with the Show Manager for more details on how you can expand your education as well as helping out your fellow exhibitors.

Directions to Facility

FROM THE SOUTH: Take Highway 45 (Jackson) north to Pleasant Valley Road. Exit east on PV. Entrance to the Fair Park will be on the left. Once you have entered the grounds, please turn left on Circle Road and go to Entrance Gate #11. This will bring you into the grounds by the Camping Area. This is also the gate to use for after-hours. Follow along the camping area turning left on Ken Miller Drive. Take this to the Gehl Drive and the grassy trailer parking area. You will NOT be able to park along the side of the barns or between the barns and the arena to offload horses, equipment, etc. This must be done from the trailer parking area. Please be considerate to other exhibitors when unloading and when parking your trailer.

FROM THE NORTH: Take Highway 41 to County Highway 60. Go east on Highway 60 (Slinger) to Highway 45 (Jackson). Travel north one (1) mile on Highway 45. Exit east on PV. Entrance to the Fair Park will be on the left. Once you have entered the grounds, please turn left on Circle Road and go to Entrance Gate #11. This will bring you into the grounds by the Camping Area. This is also the gate to use for after-hours. Follow along the camping area turning left on Ken Miller Drive. Take this to the Gehl Drive and the grassy trailer parking area. You will NOT be able to park along the side of the barns or between the barns and the arena to offload horses, equipment, etc. This must be done from the trailer parking area. Please be considerate to other exhibitors when unloading and when parking your trailer.

FROM THE WEST: Take I-94 toward Milwaukee to Exit 294 (Machine Shed) for Highway 164. Take Highway 164 north to Highway 60 in Slinger. Turn right (east) onto Highway 60 to Highway 45 in Jackson. Travel north one (1) mile on Highway 45. Exit east on PV. Entrance to the Fair Park will be on the left. Once you have entered the grounds, please turn left on Circle Road and go to Entrance Gate #11. This will bring you into the grounds by the Camping Area. This is also the gate to use for after-hours. Follow along the camping area turning left on Ken Miller Drive. Take this to the Gehl Drive and the grassy trailer parking area. You will NOT be able to park along the side of the barns or between the barns and the arena to offload horses, equipment, etc. This must be done from the trailer parking area. Please be considerate to other exhibitors when unloading and when parking your trailer.

Facility Map (Camping area is on the North side of facility)

- | | | | |
|-------------------------|----------------------|---------------------|-------------------------|
| 1 – Pleasure Horse Barn | 2 – Draft Horse Barn | 3 – Warm up Arena | 4 – Competition ring #1 |
| 5 – Competition Ring #2 | 6 – Facility Office | 7 – Vehicle Parking | 8 – Trailer Parking |
| 9 – Camping Area | | | |

CIRCLE DRIVE

Gate 11

Camping Area

Shower

6+ HORSE PARKING

Equestrian Complex

PARKING

→ entrance off PN

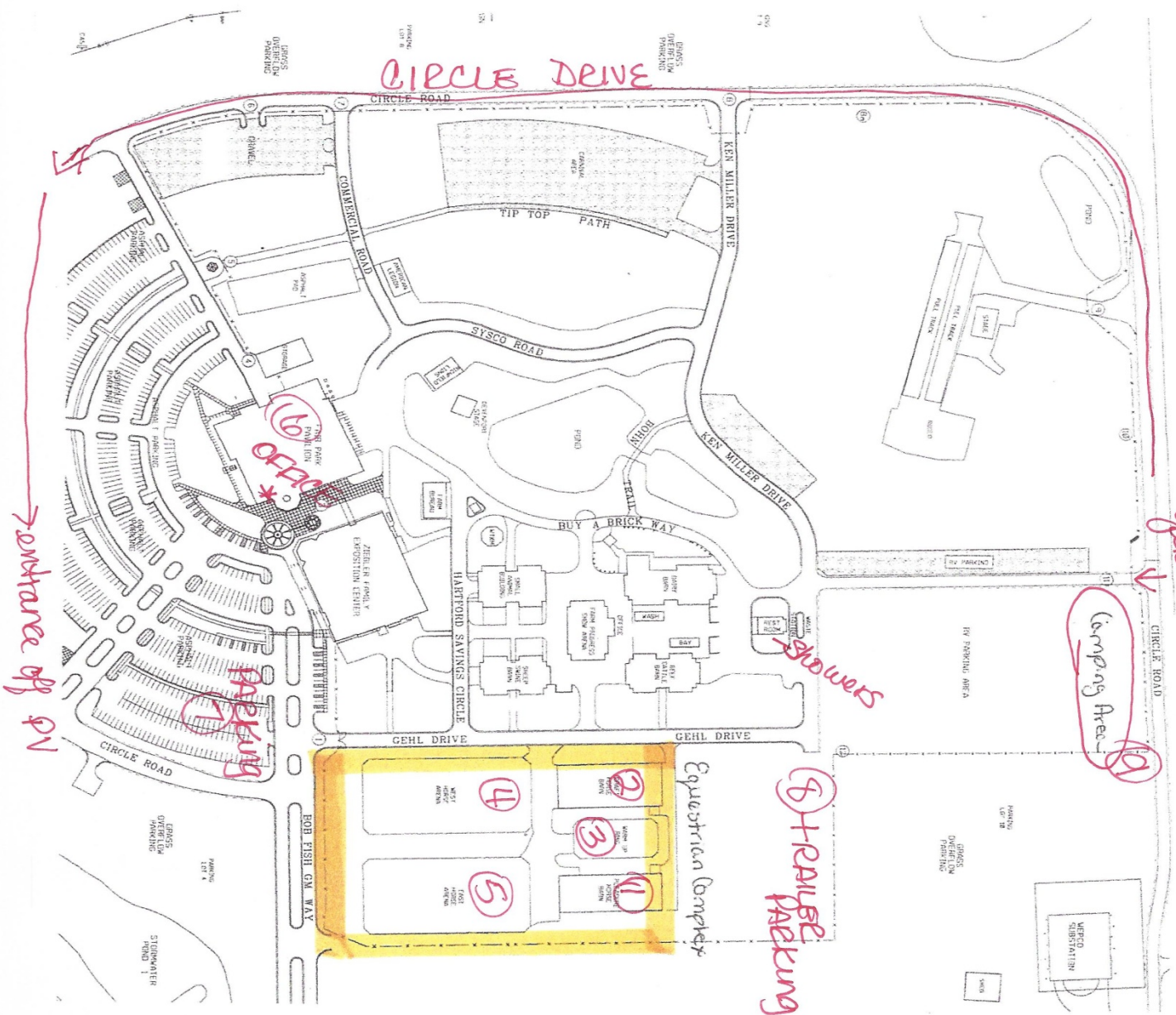
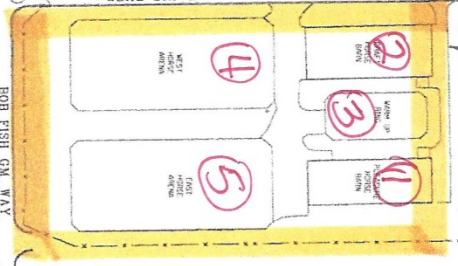

Hotel Information

Country Inn & Suites, 2000 Gateway Court, West Bend, WI. 262.334.9400.
www.countryinns.com

Hampton Inn & Suites, 1975 S 18th Avenue, West Bend, WI 262.438.1500
www.westbendsuites.hamptom.inn.com

Hilton Garden Inn, 11600 West Park Avenue, Milwaukee, WI 414.577.5003

Comfort Inn & Suites, W227 N16890 Tillie Lake Court, Jackson, WI 262.677.1133
www.comfortinn.com/hotel-jackson-wisconsin-WI102

Arabian Horse Association Show Recognition

Competition Sponsor: Wisconsin Desert Horse Assn Dressage & Sport Horse Show

AHA Recognition Show/Recording Number: 191014528

The Arabian Horse Association is a major equine association serving members in the United States and Canada. It registers and maintains a database of more than one million Arabian, Half-Arabian and Anglo-Arabian horses and administers more than \$3 million in annual prize money. AHA produces championship events, recognizes over 500 Arabian horse shows and distance rides annually and provides activities and programs that promote breeding and ownership. For information about Arabian, Half-Arabian and Anglo-Arabian horses, call 303-696-4500, e-mail info@ArabianHorses.org or visit ArabianHorses.org.



Join AHA through your local club for the following great member benefits:

- Subscription Arabian Horse Life magazine
- Reduced rate for competition privileges across a variety of disciplines for local, regional and national AHA-approved shows and rides
- Peace of mind with 1 million in personal liability insurance through Equisure
- Preferred rates on horse registrations and transfers
- Preferred rates on ArabDataSource, the world's largest online Arabian horse resource
- No annual fee, low interest rate Bank of America affinity credit card
- Numerous opportunities to participate in award recognition and prize money programs
- Show circuits for AHA members at local, regional and national levels

Contact your local club: _____

The Judges & Stewards Commissioner is responsible for handling written and signed complaints relating to judges' and stewards' conduct when filed by exhibitors, show officials, AHA members or others, and when accompanied by a ten dollar (\$10.00) filing fee [Resolution 5-90]. Other comments, compliments, questions, inquiries are encouraged when appropriate (no filing fee required). Write: Judges & Stewards Commissioner, PO Box 440949, Aurora, CO 80044-0949; (303) 696-4537.



USEF Competition Name: WDHA Dressage and Sport Horse Show

USEF#: 317948

Competition Division(s) and Rating(s): Arabian/Half-Arabian/Anglo-Arabian, Jr Exhibitor, Western Dressage & Open Breed Western Dressage

ATTENTION COMPETITORS



USEF SAFE SPORT TRAINING REQUIREMENT

Starting January 1, 2019, if you are a USEF Competing Member 18 years of age or older you are required to complete the core Safe Sport Training within 30 days of activating your membership.

If you do not complete the training, you are ineligible to participate in all USEF activities including competitions.

TAKE the SAFE SPORT TRAINING at USEF.org by logging into your member dashboard.

#youarenotalone



USDF Membership Benefits: USDF is dedicated to education, the recognition of achievement, and promotion of dressage. For details on member benefits, including educational programs, awards, and other opportunities, refer to the *USDF Member Guide* or the USDF website at www.usdf.org.

**This
competition
is recognized
by USDF
for 2019**

Membership Requirements for USEF-licensed/USDF-recognized Competitions: Owners and riders, including foreign riders and owners who are not residents of the US, wishing to participate in a USEF-licensed/USDF-recognized competition as a rider or owner/lessee, must have either a USDF Group Membership (GM), Participating Membership (PM), or have a USDF Non-Member (NM) identification number and pay the USDF Non-Member (NM) fee. (Note: USDF Business Members can own horses but cannot compete as riders with their USDF Business Membership.) Individuals cannot compete at a USEF-licensed/USDF-recognized competition with a USDF Education Membership.

Horses competing at USEF-licensed/USDF-recognized competitions must have either a USDF Horse Identification (HID) number or a USDF Lifetime Horse Registration (LHR). Proper credentials or verification certificates must be presented to the competition secretary.

Riders and owners wishing to participate in a USEF-licensed/USDF-recognized competition, and not able to present the competition secretary with verification of a USDF membership or NM identification, and USDF LHR or USDF HID, must complete a USDF Competition Affidavit Form and pay the \$5 affidavit filing fee. A copy of a completed affidavit form from another competition may also be used for verification purposes for up to 60 days. (Exception: Affidavits cannot be used at Great American Insurance Group/USDF Regional Dressage Championships.)

Exceptions:

- Horses competing only in Individual Breed Classes (IBCs) at DSHB competitions, sires and dams of horses in DSHB group classes, where those sires or dams are not actually competing in the same competition, horses competing only in breed restricted dressage or DSHB classes at Regular Competitions (e.g. all Arabian, all Friesian, or all Morgan classes), or in USDF Introductory Level tests, pas de deux or quadrille, are exempt from this requirement. Also exempt are horses ridden in leadline, exhibitions, games and races, classes for 4-H members, walk-trot, academy, and opportunity classes.
- Riders and owners/lessees competing only in classes which are exempt from the USDF HID requirements are also exempt from the USDF NM identification number and NM fee requirements. Also exempt are handlers of horses competing in DSHB In-Hand or Group classes.

Memberships Defined

Participating Membership (PM): A membership issued to an individual directly by USDF. The membership year is December 1 through November 30. PMs are available for 1-year (\$90), 5-years (\$360), or life (\$1,800). A USDF Youth Participating Membership (YPM) is available for individuals who have not reached their 21st birthday by December 1 of the current membership year (\$72). A PM allows the member to compete at USEF-licensed/USDF-recognized competitions and to participate as a rider and/or owner/lessee for all Adequan®/USDF Year-End Awards and the Great American Insurance Group/USDF Regional Dressage Championship program.

Group Membership (GM): A membership issued to an individual by USDF when the member name and dues are submitted to USDF through an affiliate Group Member Organization (GMO). The GM year begins December 1 and ends November 30. A GM allows the member to compete at USEF-licensed/USDF-recognized competitions and participate in the USDF Rider Awards program.

Business Membership (BM): A membership that runs December 1 through November 30 and is issued to a business or organization directly by USDF. The USDF BM (\$240) offers a wider variety of advertising benefits. BMs satisfy requirements of horse ownership only.

Education Membership (EM): A membership issued to an individual directly by USDF. This online education only membership expires 12 months after the date joined. This membership type does NOT allow an individual to compete at a USEF-licensed/USDF-recognized competition.

Non-Member (NM) Identification Number: For each USDF NM owner/lessee and USDF NM rider there will be a USDF NM fee of \$35 per competition that must be collected by the show secretary and submitted to USDF, along with the USDF Report of Fees document and the \$5 affidavit fee and Competition Affidavit Form if the person cannot provide a copy of their USDF NM card. Owners/lessees or riders exempt from the NM number requirements are also exempt from paying the USDF NM fee. If there are multiple owners of a horse and all are NMs, only one of the owners must pay the NM fee. If the horse has at least one owner who is a current USDF PM, GM, or BM there is no NM fee assessed. Competition management will be invoiced for all applicable USDF NM fees not received with the USDF post-competition paperwork, along with a report listing all USDF NMs. Competition management is then required to submit the NM fees within 30 days to the USDF. An individual with a USDF NM identification number is not eligible for any USDF membership benefits. Once a USDF NM number has been assigned, a USDF NM card can be obtained from the USDF website.

Horse Identification (HID) Number: A one-time tracking number for horses (\$35). Scores earned by a horse with an HID number will be recorded, but will NOT be counted towards Adequan®/USDF Year-End Awards. A horse with an HID number is not eligible to compete in Great American Insurance Group/USDF Regional qualifying or championship classes. An HID number can be upgraded to a Lifetime Horse Registration (LHR) for a fee of \$80. If a horse has a USDF LHR it does not need an HID number. An HID number is a one-time fee that does not need to be renewed.

Lifetime Horse Registration (LHR): A horse with an LHR (\$115) is eligible for Adequan®/USDF Year-End Awards, and eligible to compete in Great American Insurance Group/USDF Regional qualifying and championship classes, assuming requirements for the owner and rider are met. If a horse has an LHR it does not need an HID number. An LHR does not need to be renewed.

How to Join USDF

Applications for USDF Participating Membership (PM), Business Membership (BM), Horse Identification (HID) number, and Lifetime Horse Registration (LHR) may be found in the following locations:

- On the USDF website: www.usdf.org. You can submit the application online or download the form and fax or mail it to the USDF office.
- In the show office at USEF-licensed/USDF-recognized competitions classified by USEF as Dressage Competitions, and Regular Competitions which are open to all breeds.
- By calling or writing the USDF office at (859) 971-2277, 4051 Iron Works Parkway, Lexington, KY 40511

The effective date of membership is the date the form and correct fees are received in the USDF office or, if applying at a competition, the date accepted by the competition secretary, provided the application is signed and dated by the competition secretary, member, and/or horse owner on that same day.



USDF Statement on Animal Welfare

The United States Dressage Federation, Inc. (USDF), a federation of over 100 independent organizations throughout the United States with a membership of nearly 30,000 members, supports the concept of ethical treatment of animals.

Dressage is a classical method of training horses, based upon the horse's natural responses, as carried out in a gradual, planned program during which the horse's athletic abilities are improved in a systematic manner. As a result, the horse becomes capable, comfortable, and responsive in partnership with the rider without the use of force. Dressage competition at various levels of achievement is the ultimate test of the training program to determine whether the desired harmony between horse and rider has been achieved.

The rules pertaining to dressage competition prohibit the use of artificial appliances, training aids, and drugs, which would force the horse to submit. Instead, the emphasis is upon training and a cooperative partnership with the rider. Major competitions are carefully monitored to assure that there is no unnecessary force or harshness displayed.

Unlike other horse sports in which horses enter training at a relatively immature state, dressage training is usually not seriously begun until the horse is three or four. The top levels of achievement require five or more years of progressive training and it is not unusual to see horses in international competition in their late teens. This, in itself, places a premium on good care and soundness throughout the horse's life.

While supporting the concept of animal welfare in its broadest form, the United States Dressage Federation, Inc., also recognizes that it is unrealistic to ascribe human emotions and responses to the horse which in its wild state is a creature of flight, living a hard and precarious existence. Under domestication, the horse is assured of ample food, water, and shelter, as well as protection against infectious diseases and damaging parasites, thus leading a longer and healthier life with a high rate of survival.

As an educational organization, USDF has numerous programs, which teach people how to pursue the accepted, humane training methods. A program of certifying instructors also emphasizes protecting the horse's welfare in pursuit of dressage training.

United States Dressage Federation
4051 Iron Works Parkway, Lexington, KY 40511
Phone: 859-971-2277, Fax: 859-971-7722, usdressage@usdf.org, www.usdf.org



Wisconsin Desert Horse Association

An Affiliate Club of the Arabian Horse Association

(Please note your application cannot be processed without complete information)

For Office Use:

Name (A) _____ Date: _____

Name (B) _____ Phone (H) _____

Farm Name _____ Phone (C) _____

Address _____

City _____ State _____ Zip _____

Email _____

Membership Type New _____ Renewal _____

Level 1 and 2 memberships include AHA membership. WDHA will forward your AHA membership fee to AHA on your behalf. Please allow up to two (2) weeks for processing. \$10 of the Adult membership fee are WDHA club dues.

Types of Memberships

Level 1 - Adult consists of AHA Membership and WDHA voting and club privileges including the value added programs (High Point, Futurity/Maturity, etc). Youth (18 years and under)

_____ YOUTH - \$20 Date of Birth _____ Current AHA Number _____

_____ ADULT - \$60 Current AHA Number _____

_____ ADULT 3-year Membership (No Competition card) \$165 Current AHA Number _____

Level 2 - Consists of everything listed in Level 1 plus *Competition Card. Youth (18 years and under)

_____ YOUTH - \$45 Date of Birth _____ Current AHA Number _____

_____ ADULT - \$95 Current AHA Number _____

_____ FAMILY - \$190 Includes 2 adult memberships with AHA/WDHA voting privileges and competition card

(A) Current AHA Number _____ (B) Current AHA Number _____

_____ ADULT 3-year Membership w/Competition Card \$270 Current AHA Number _____

Associate Memberships

Associate membership is offered to a rider/trainer/handler and/or non-owners only. Club privileges are not included at the associate level.

_____ YOUTH \$10

_____ ADULT \$25

_____ FAMILY \$40 (A) Date of Birth _____ (B) Date of Birth _____

*Required to compete at AHA Recognized events and participate in AHA Achievement Award Programs

Make Checks Payable to WDHA and Mail to: Gail Rentmeester
5254 H.E. Townline Road
Green Bay, WI 54311
Phone: 920.536.0447



Amended 03/18/2018