

# POT FEEDER

## GENERAL WATER SYSTEMS

THIS DRAWING IS FOR SPATIAL CONSIDERATION ONLY, AND SUBJECT TO CHANGE W/O PREVIOUS NOTICE, DO NOT PRE-PLUMB TO THESE DIMENSIONS

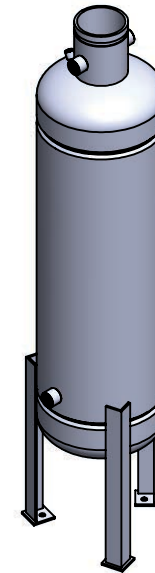
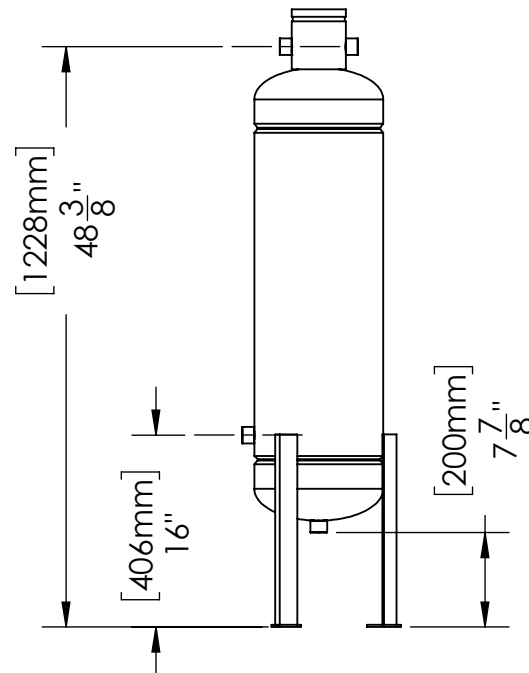
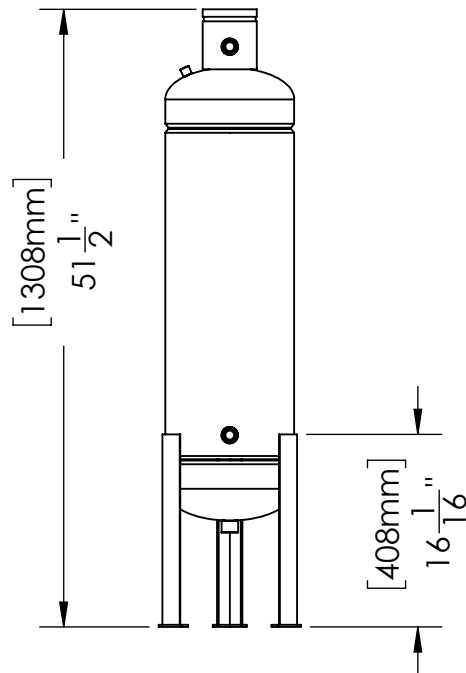
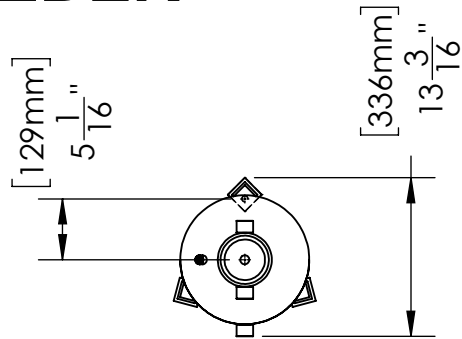

### DB-12-GE-316-Z

Operating Point	More than 5000 Gallon System Volume		
Pot Feeder - Size & Style	Dome Bottom 12 Gallon Grooved End		
Construction	316 Stainless Steel (Welded)		
PROCESS INLET			
Connection - Type & Size	NPT 3/4"		
PROCESS OUTLET			
Connection - Type & Size	NPT 3/4"		
PRESSURE - Maximum Operating			
Vessel	450 psi (31.0 bar)		
TEMPERATURE - Maximum Operating			
System	34°F - 250°F (1°C - 121°C)		
WEIGHTS	DRY	SHIPPING	OPERATING
lbs (kg)	174	176	270

PREPARED BY:  
HECTOR J. GUZMAN

REV

A

RELEASED BY:

TIM BOYLEN

DATE:

1/23/2024



General Water Systems | 1525 East 6th Street | CA | 92879  
www.gwslp.com | info@gwslp.com | 951.278.8992

\*UNLESS OTHERWISE SPECIFIED -  
ALL DIMENSIONS ARE IN INCHES

**DB-12-GE-316-Z**