

POT FEEDER

GENERAL WATER SYSTEMS

THIS DRAWING IS FOR SPATIAL CONSIDERATION ONLY, AND SUBJECT TO
CHANGE W/O PREVIOUS NOTICE, DO NOT PRE-PLUMB TO THESE DIMENSIONS

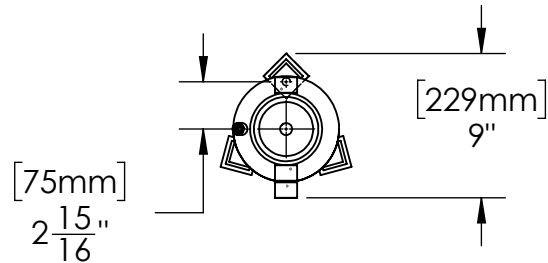

DB-2-GE-CS-Z				
Operating Point		Up to 500 Gallon System Volume		
Pot Feeder - Size & Style		Dome Bottom 2 Gallon Grooved End		
Construction		Carbon Steel (Welded)		
PROCESS INLET				
Connection - Type & Size		NPT 3/4"		
PROCESS OUTLET				
Connection - Type & Size		NPT 3/4"		
PRESSURE - Maximum Operating				
Vessel		450 psi (31.0 bar)		
TEMPERATURE - Maximum Operating				
System		34°F - 250°F (1°C - 121°C)		
WEIGHTS		DRY	SHIPPING	OPERATING
lbs (kg)		55	57	71

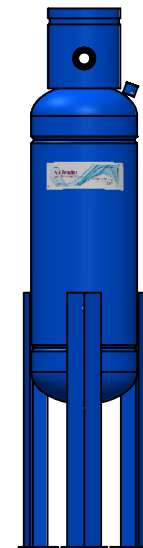
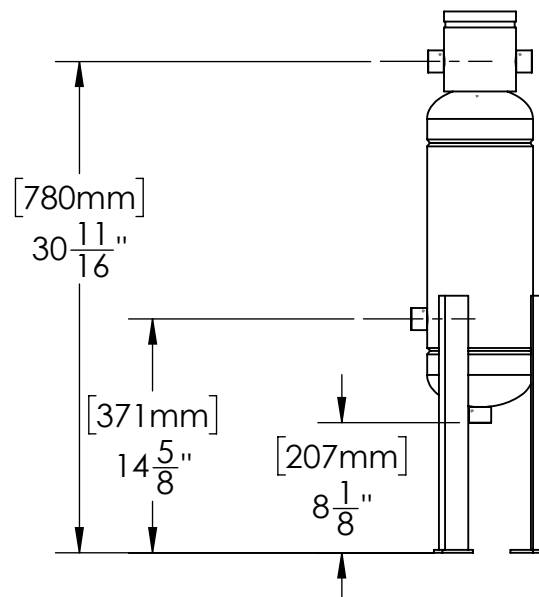
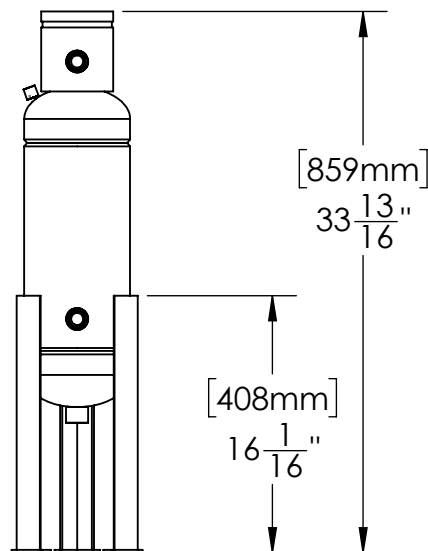

PREPARED BY:
HECTOR J. GUZMAN

REV

A



RELEASED BY:

TIM BOYLEN

DATE:

9/9/2023

General Water Systems | 1525 East 6th Street | CA | 92879

www.gwslp.com | info@gwslp.com | 951.278.8992

*UNLESS OTHERWISE SPECIFIED -
ALL DIMENSIONS ARE IN INCHES

DB-2-GE-CS-Z