



ASL Series Magnetic Lock, Deadbolt Lock, Strike Lock

ASL150:



1. Magnetic lock for sliding door.
2. Power supply DC12V or AC110V/220V.
3. **Holding fore: 80KG/175LBS •**
4. Build-in photo couplers input contact and adapter.
5. Adjustable width (59mm~89mm) for use of different sliding doors' slots.
6. Input of DC12V to the reader when AC current is used with maximum of 200mA overload protection.
7. All-in-one design for easy installation. The lock itself would not have any residual magnetism.
8. The lock itself is equipped with release switch and indicator for better maintenance of the sliding doors.
9. Built-in photo coupler connects with egress delay circuit push button point for easy installation.

ASL180/R:



1. Compact size magnetic lock, widely adaptation.
2. Power supply: DC12V.
3. **Holding Force: 150KG/300LBS.**
4. Fail-safe type (Power to lock).
5. ASL180: W/O monitor output.
6. ASL180R: Built-in monitor output.

Specifications:

Model No.	ASL-150	ASL-180R	ASL-180
Type	For Sliding Door	Fail-safe type (Power to lock)	Fail-safe type (Power to lock)
Operating voltage	DC 12V AC110V/220V (Optional)	DC 12V DC 24V (Optional)	DC 12V DC 24V (Optional)
Power consumption	150mA-DC12V	360mA-DC12V 180mA-DC24V	360mA-DC12V 180mA-DC24V
Holding Force	80KG/175LBS	150KG/300LBS	150KG/300LBS
Dimensions	Lock body: 115(L)x89(W)x56(H)mm Armature: 57(L)x116(W)x38(H)mm	168mm(L) x 36mm(W) x 21mm(D)	168mm(L) x 36mm(W) x 21mm(D)
Weight	1100g	1000g	1000g
Note	With release switch and indicator	With monitor output	W/O monitor output

ASL200/S/T/D:

1. Magnetic door lock.
2. Power supply: DC 12V or DC 24V (Optional).
3. **Holding Force: 250KG/600LBS.**
4. Fail-safe type (Power to lock).
5. Options: Lock status sensor, timer and door.
6. Low power consumption, high efficiency.
7. ASL-200: Built-in indicator & monitor output.
8. ASL-200S: W/O indicator & monitor output.
9. ASL-200T: Built-in time delay, indicator & monitor output.
10. ASL-200D: Double lock, built-in indicator & monitor output

Specifications:

Model No.	ASL-200	ASL-200S	ASL-200T	ASL-200D
Type	Fail-safe type (Power to lock)	Fail-safe type (Power to lock)	Fail-safe type (Power to lock)	Fail-safe type (Power to lock)
Operating voltage	DC 12V DC 24V (Optional)	DC 12V DC 24V (Optional)	DC 12V DC 24V (Optional)	DC 12V DC 24V (Optional)
Power consumption	500mA-DC12V 250mA-DC24V	500mA-DC12V 250mA-DC24V	500mA-DC12V 250mA-DC24V	500mA-DC12V 250mA-DC24V
Holding Force	250KG/600LBS	250KG/600LBS	250KG/600LBS	250KG/600LBS
Dimensions	250mm(L) x 43mm(W) x 27mm(D)	250mm(L) x 43mm(W) x 27mm(D)	250mm(L) x 43mm(W) x 27mm(D)	500mm(L)x43mm(W)x27mm(D)
Weight	2000g	2000g	2100g	4000g
Note	With indicator & monitor output	W/O indicator & monitor output	With time delay, indicator & monitor output	With indicator & monitor output

ASL220/S/T/D:



1. Magnetic door lock.
2. Power supply: DC 12V or DC 24V (Optional).
3. **Holding Force: 500KG/1200LBS.**
4. Fail-safe type (Power to lock).
5. Options: Lock status sensor, timer and door.
6. Low power consumption, high efficiency.
7. ASL-220: Built-in indicator & monitor output.
8. ASL-220S: W/O indicator & monitor output.
9. ASL-220T: Built-in time delay, indicator & monitor output.
10. ASL-220D: Double lock, built-in indicator & monitor output

Specifications:

Model No.	ASL-220	ASL-220S	ASL-220T	ASL-220D
Type	Fail-safe type (Power to lock)	Fail-safe type (Power to lock)	Fail-safe type (Power to lock)	Fail-safe type (Power to lock)
Operating voltage	DC 12V	DC 12V	DC 12V	DC 12V
	DC 24V (Optional)	DC 24V (Optional)	DC 24V (Optional)	DC 24V (Optional)
Power consumption	500mA-DC12V	500mA-DC12V	500mA-DC12V	500mA-DC12V
	250mA-DC24V	250mA-DC24V	250mA-DC24V	250mA-DC24V
Holding Force	500KG/1200LBS	500KG/1200LBS	500KG/1200LBS	500KG/1200LBS
Dimensions	267mm(L)x67mm(W)x40mm(D)	267mm(L)x67mm(W)x40mm(D)	267mm(L)x67mm(W)x40mm(D)	534mm(L)x67mm(W)x40mm(D)
Weight	4800g	4800g	4900g	9600g
Note	With indicator & monitor output	W/O indicator & monitor output	With time delay, indicator & monitor output	With indicator & monitor output

AGL200/220:



1. Waterproof
2. Magnetic door lock.
3. Power supply: DC 12V or DC 24V (Optional).
4. Holding Force: **AGL200-500KG/1200LBS.**

AGL220-250KG/600LBS

5. Fail-safe type (Power to lock).
6. Stainless Steel Case.
7. Threaded conduit fitting.
8. Built-in lock status sensor
9. **Suitable for outdoors.**

Specifications:

Model No.	AGL-200	AGL-220
Type	Fail-safe type (Power to lock).	Fail-safe type (Power to lock)
Operating voltage	DC 12V DC 24V (Optional)	DC 12V DC 24V (Optional)
Power consumption	500mA-DC12V 250mA-DC24V	500mA-DC12V 250mA-DC24V
Holding Force	250KG/600LBS	500KG/1200LBS
Dimensions	204mm(L)x42mm(W)x37.5mm(D)	202mm(L)x64mm(W)x39mm(D)
Weight	2000g	5000g
Note	Waterproof (built-in lock status sensor)	Waterproof (built-in lock status sensor)

ABR180/200/220:

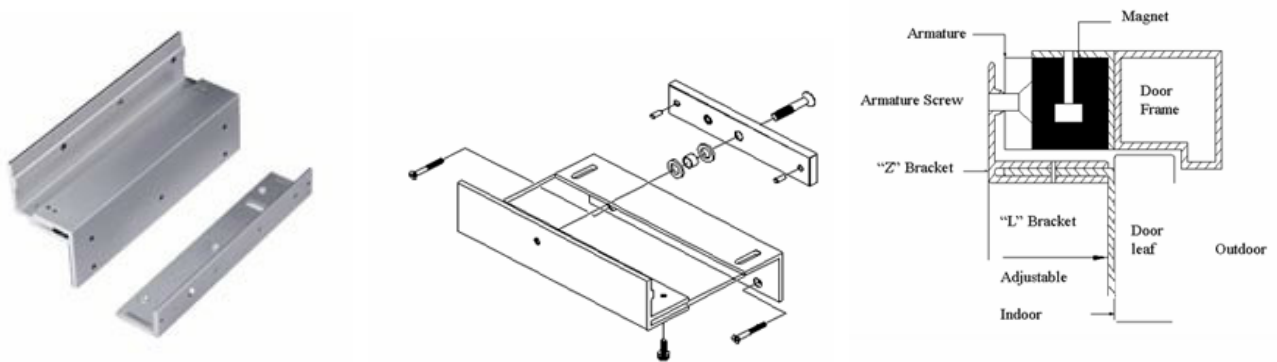

1. L & Z bracket.
2. Suitable for in-swing door.
3. ABR-180: To used with ASL-180 magnetic lock.
4. ABR-200: To used with ASL-200 magnetic lock.
5. ABR-220: To used with ASL-220 magnetic lock.

Specifications:

Model No.	ABR-180	ABR-200	ABR-220
Type	To use with ASL-180 Suitable for in-swing door	To use with ASL-200 Suitable for in-swing door	To use with ASL-220 Suitable for in-swing door
Dimensions	L: 167.5x40x25(mm) L: 167.5x40x25(mm) F: 167.5x40x25(mm)	L: 250x48x30(mm) L: 250x55x45(mm) F: 250x65x46(mm)	L: 267x71x40(mm) L: 267x82x65(mm) F: 267x70x67(mm)
Weight	400g	1200g	1800g
Note	L & Z Bracket	L & Z Bracket	L & Z Bracket

AEB200/220:

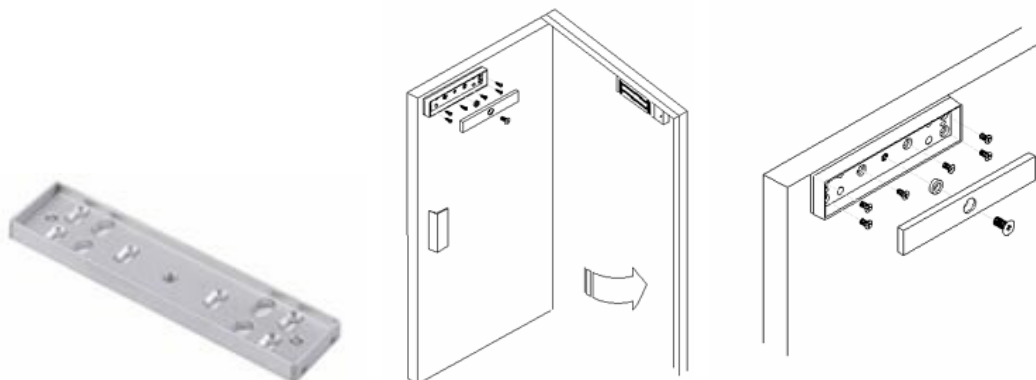

1. Especially for the use of ASL-200/220 armature.
2. Suitable for 90° out-swing door.
3. Sturdy built for durability.
4. Simple and easy installation, with screw position adjustable function.

AUB200/220:

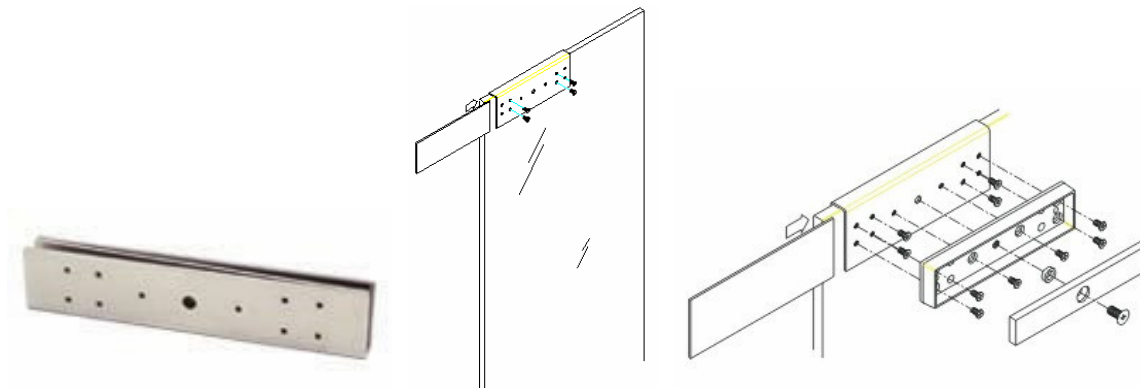

1. U bracket.
2. To be used with AEB-200/220 armature plate housing.
3. Suitable for glass (thickness of 9mm-12mm).
4. Stainless steel built for durability.
5. Rubber plate and steel plate for strong holding

Specifications:

Model No.	AEB-200	AUB-200	AEB-220	AUB-220
Type	To use for ASL-200 armature Suitable for 90° out-swing door	Used with AEB-200 armature plate Suitable for glass (9-12mm)	To use for ASL-220 armature Suitable for 90° out-swing door	Used with AEB-220 armature plate Suitable for glass (9-12mm)
Dimensions	193x45x12.7(mm)	193X46.5X16(mm)	195x72x19(mm)	195X72.5X16(mm)
Weight	153g	590g	260g	860g
Note	Armature Plate Housing	U Bracket (Glass Holder)	Armature Plate Housing	U Bracket (Glass Holder)

ASL100:



1. Deadbolt lock.
2. Power Supply: DC 12V
3. Fail-safe type (Power to lock), MOV surge protection.
4. Build-in door sensor and lock position, N.C. & N.O.
5. Built-In Delayed Egress Control Point, and door will therefore lock automatically when door is not opened within 5 seconds.
6. Suitable for 180-degree swing door.
7. Compact size, with round corner design easy to install.
8. Operation delay time: 0 sec., 2.5sec., 5sec., 9sec.

ASL120:



1. Deadbolt lock.
2. Power Supply: DC 12V
3. Fail-secure type (Power to open), MOV surge protection.
4. Build-in door sensor and lock position, N.C. & N.O.
5. Built-In Delayed Egress Control Point, and door will therefore lock automatically when door is not opened within 5 seconds.
6. Suitable for 180-degree swing door.
7. Compact size, with round corner design easy to install.
8. Operation delay time: 0 sec., 3sec., 5sec., 9sec.
9. Oval Cylinder will unlock when power cut occurred.
10. Build-in CPU for door position detection and currency control to avoid error action.

ASL130:



1. All Purpose (power to lock and power to unlock switchable) Deadbolt lock.
2. Power Supply: DC 12V
3. MOV surge protection.
4. Build-in door sensor and lock position, N.C. & N.O.
5. Built-In Delayed Egress Control Point, and door will therefore lock automatically when door is not opened within 5 seconds.
6. Suitable for 180-degree swing door.
7. Compact size, with round corner design easy to install.
8. Operation delay time: 0 sec., 3sec., 5sec., 9sec.
9. Oval Cylinder will unlock when power cut occurred.
10. Build-in CPU for door position detection and currency control to avoid error action.

Specifications:

Model No.	ASL-100	ASL-120	ASL-130
Type	Fail-safe type (Power to lock)	Fail-secure type (Power to open)	Fail-safe/secure type (Switchable)
Operating voltage	DC 12V	DC 12V	DC 12V
Power consumption	Operation current: 900mA Holding current: 330mA	Operation current : 900mA Holding current: 320mA	Operation current : 880mA Holding current: 250mA
Dimensions	Face plate : 200(L)x32(W)x40(D)mm Strike plate: 90(L)x26(W)x2(D)mm Bolt:16(Throw)x15.5mm(Diameter)	Face plate : 200(L)x32(W)x40(D)mm Strike plate: 90(L)x26(W)x2(D)mm Bolt:17(Throw)x15.5mm(Diameter)	Face plate : 200(L)x25(W)x50(D)mm Strike plate: 90(L)x26(W)x2(D)mm Bolt:17(Throw)x15.5mm(Diameter)
Weight	860g	1100g	800g
Door sensor	N.C & N.O Output	N.C & N.O Output	N.C & N.O Output

ASL300/F:



1. Strike lock.
2. Power Supply: DC 12V
3. ASL300- Fail-secure type (Power to unlock).
4. ASD300F- Fail-safe type (Power to lock).
5. Suitable for wooden, aluminum and hollow metal doors.
6. To be used with auxiliary lock

ASL320/F:



1. Strike lock.
 2. Power Supply: DC 12V
 3. ASL320- Fail-secure type (Power to unlock).
 4. ASD320F- Fail-safe type (Power to lock).
 5. Suitable for wooden, aluminum and hollow metal doors.
- To be used with auxiliary lock

Specifications:

Model No.	ASL-300	ASL-300F	ASL-320	ASL-320F
Type	Fail-secure type (Power to unlock)	Fail-safe type (Power to lock)	Fail-secure type (Power to unlock)	Fail-safe type (Power to lock)
Operating voltage	DC 12V	DC 12V	DC 12V	DC 12V
Power consumption	400mA	360mA	400mA	360mA
Dimensions	160mm(L) x 25mm(W) x 31mm(D)	160mm(L) x 25mm(W) x 31mm(D)	124mm(L)x32mm(W)x38mm(D)	124mm(L)x32mm(W)x38mm(D)
Weight	300g	300g	450g	450g
Note	Suitable for Wooden door (To be used with auxiliary lock)	Suitable for Wooden door (To be used with auxiliary lock)	Suitable for Aluminum door (To be used with auxiliary lock)	Suitable for Aluminum door (To be used with auxiliary lock)

ABR100:

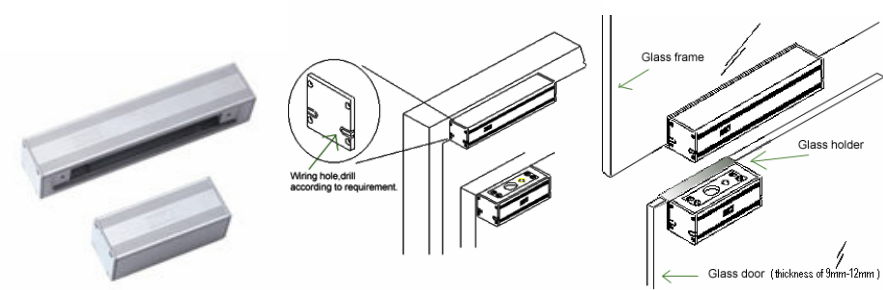

- 1. To be used with ASL-100 Deadbolt Lock.
- 2. To be used with AUB-100 glass holder.
- 3. Suitable for 90° or 180° door.
- 4. Sturdy built for durability.
- 5. Simple installation without drilling any holes.

AUB100:

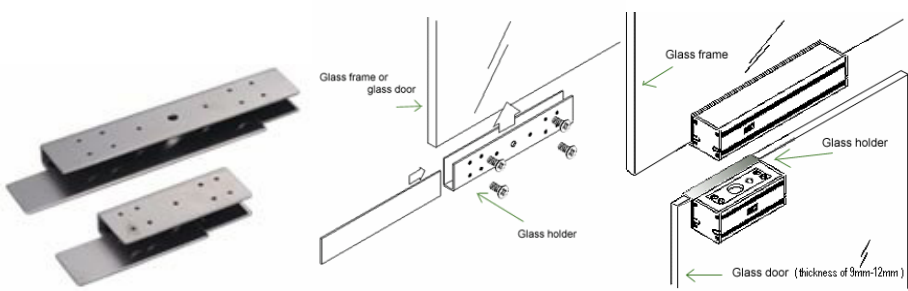

- 1. U bracket.
- 2. To be used with ABR-100 to install ASL-100 Deadbolt Lock.
- 3. Stainless steel built for durability.
- 4. Rubber plate and steel plate for strong holding
- 5. Dimensions of large glass holder: 195x46x16 (mm).
- 6. Dimensions of small glass holder: 120.5x46x16 (mm).

ABR100C:



1. To be used with ASL-100 Dead Bolt Lock.
2. Suitable for glass (thickness of 9mm-12mm).
3. Stainless steel built for durability.
4. Rubber plate and steel plate for strong holding
5. Dimensions of large glass holder: 90X27X40 (mm).

Specifications:

Model No.	ABR-100	AUB-100	ABR-100C
Type	Used with ASL-100 Dead Bolt Lock Suitable for 90° or 180° door	Used with ABR-100 Suitable for glass (9-12mm)	Used with ASL-100 Dead Bolt Lock Suitable for glass (9-12mm)
Dimensions	230x45x46(mm)	195x46x16 (mm)	90X27X40 (mm)
Weight	860g	1000g	300g
Note	Surface Mount Bracket	U Bracket (Glass Holder)	Bracket (Glass Holder)

Other Accessories:

ASD-30:



Specifications:

Model No.	ASD-30
Type	Armored Door Loop
Dimensions	Internal diameter: 7mm External diameter: 9mm Length: 300mm
Weight	866g
Note	Stainless

ASD-20S/40S/60S:



Specifications:

Model No.	ASW-20S	ASW-40S	ASW-60S
Type	Push Button	Push Button	Push Button
Material	Plate: Iron	Plate: Iron	Plate: Iron
	Button (Made in Taiwan): Steel	Button (Made in Taiwan): Steel	Button (Made in Taiwan): Steel
Dimensions	115X39X26(mm)	85X85X26(mm)	115X70X26(mm)
Weight	250g/3 pcs box	250g/2 pcs box	250g/2 pcs box
Note	Single pole N.O. momentary action	Single pole N.O. momentary action	Single pole N.O. momentary action

Specifications (French Stainless):

Model No.	ASW-20	ASW-40	ASW-60
Type	Push Button	Push Button	Push Button
Material	Stainless Waterproof Push Button	Stainless Waterproof Push Button	Stainless Waterproof Push Button
	Plate: Iron	Plate: Iron	Plate: Iron
Holding Force	Button (Made in France): Stainless	Button (Made in France): Stainless	Button (Made in France): Stainless
Dimensions	115X39X26(mm)	85X85X26(mm)	115X70X26(mm)
Weight	250g/3 pcs box	250g/2 pcs box	250g/2 pcs box
Note	Single pole N.O. momentary action	Single pole N.O. momentary action	Single pole N.O. momentary action
	(IP54), -20℃~55℃	(IP54), -20℃~55℃	(IP54), -20℃~55℃