



ChillBox™ 115V-Series

DX Cooling / Hot Water Heating

WMF-00 Series (1.5 to 3.0 Tons Capacities)

Compatible With R410A (For Servicing Existing Equipment Only), & R32, R454B



WMF-00 Series Shown Above with Panels Removed

ChillBox™ WMF-00 Series are built with the following standard features:

- Direct Drive Blower
- 3 Speed Air-Over Motor
- Sturdy Constructed Cabinet
- Built-In Filter Rack
- Door Safety Switch
- Air Purge Valve
- Non-Corrosive Hardware
- Standard Bolt on Piston Design (Field Option TXV)
- 304 Stainless Steel Drain Pan with Primary and Secondary 3/4" Stainless NPT Drain Fittings
- 2 lb. Thermal Acoustic, Anti-Microbial Duct Insulation
- Multi-Function Micro-Processor Circuit Board
- Circulating Water Pump with Check Valve
- Can Be Field Configured For R32, R454B with Refrigerant Sensor Kit

Warranty: 1 Year Parts / 2 Year Coils (When Registered)

EXACT FOOTPRINT REPLACEMENT FOR THE FOLLOWING MANUFACTURER'S EQUIPMENT / First Co. RAQ-Series Units

*In Keeping with Its Policy of Continuous Progress and Improvements, JRJ Manufacturing Reserves the Right to Make Changes Without Notice and Incurring Obligation.
The customer is responsible for confirming which fan coil models are compatible with select out-door unit(s) and which expansion valves (if any) are required.*



ChillBox™ WMF-00 Series Features / Options / Accessories

In Keeping with Its Policy of Continuous Progress and Improvements, JRJ Manufacturing Reserves the Right to Make Changes Without Notice and Incurring Obligation. The customer is responsible for confirming which fan coil models are compatible with select out-door unit(s) and which expansion valves (if any) are required.

Multi-Function Micro-Processor Circuit Board

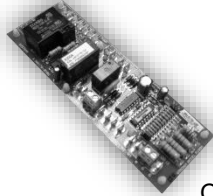

- **Automatic Pump Timer:** The circulation pump automatically energizes for 60 seconds every 6 hours (4 times daily) to purge the water from the hot water coil and piping (The pump cycle is skipped when the compressor is operating).
- **Blower-On:** (Heating Mode) Pre-Heats the hot water coil for 45 seconds.
- **Blower-Off:** (Heating & Cooling Mode) Blower continues to operate for 45 seconds after the thermostat is satisfied for increased efficiency.
- 120 Volt / 24 Volt Controls

Optional Features:

- (Field Installed) Freeze Protection (Energizes the circulation pump if temperature falls below 40°F)
- (Field Installed) Condensate Overflow Switch

Bolt On Thermal Expansion Valve (Optional / Field Installed)



- Field Installable, Available for 1.5 to 3 Ton (See Chart for Part Number)
- Approved for both cooling only (non-heat pump) or heat pump applications.
- Non-Bleed Type (Hard Start Kit May Be Needed)
- Mounts Inside the Cabinet.

NOTE:

The TXV must be compatible with the A2L refrigerant used. If A2L refrigerants are used, the equipment must be equipped with a Refrigerant Detection Sensor (RDS). Failure to install the RDS may result in equipment damage, damage to property and / or death. Warranty will be void.

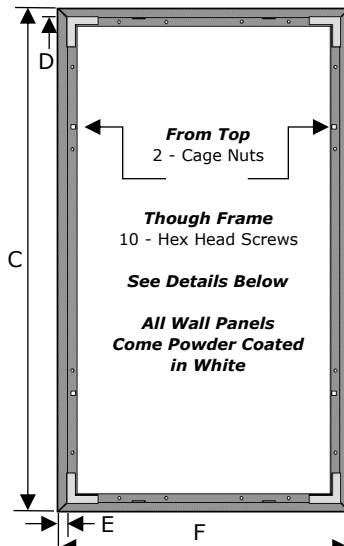
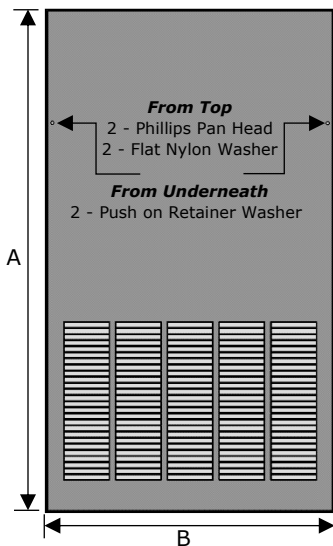

Field Installed TXV's	
	JRJ Part #
R410A*	VL001X-SP
R32**	VL001X-SP
R454B**	VL001X-SP
*For Servicing Existing Equipment Only	
**A2L Refrigerant Safety Group, Refrigerant Detection System (RDS) Required, (JRJ Part# KTA2L01)	

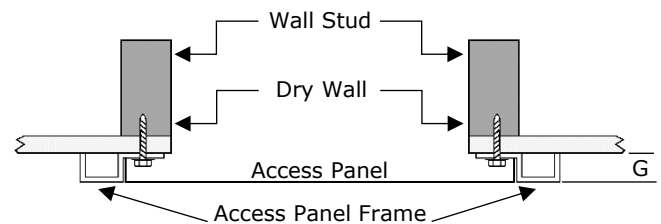

Replaces Models: First Co. 961 & 962

WMP-61(L/S)-00					
A	41"	J	--	S	--
B	22"	K	--	T	--
C	42-7/8"	L	--	U	--
D	13/16"	M	--	V	--
E	13/16"	N	--	W	--
F	24"	O	--	X	--
G	11/16"	P	--	Y	--
H	--	Q	--	Z	--
I	--	R	--		

Representative Drawing Only. Some Models May Vary in Appearance.



Recommended Wall Panel	
WMF-2415-00 = WMP-61*-00	
WMF-3615-00 = WMP-62*-00	
*Available In: L = Louvered Wall Panel / S = Solid Wall Panel	

Warranty - 1 Year Parts
2 Year Coils (When Registered)

WMP-62(L/S)-00					
A	46"	J	--	S	--
B	26"	K	--	T	--
C	47-15/16"	L	--	U	--
D	13/16"	M	--	V	--
E	13/16"	N	--	W	--
F	28"	O	--	X	--
G	11/16"	P	--	Y	--
H	--	Q	--	Z	--
I	--	R	--		

ChillBox™ WMF- 00 Series Dimensional Data



In Keeping with Its Policy of Continuous Progress and Improvements, JRJ Manufacturing Reserves the Right to Make Changes Without Notice and Incurring Obligation.
The customer is responsible for confirming which fan coil models are compatible with select out-door unit(s) and which expansion valves (if any) are required.

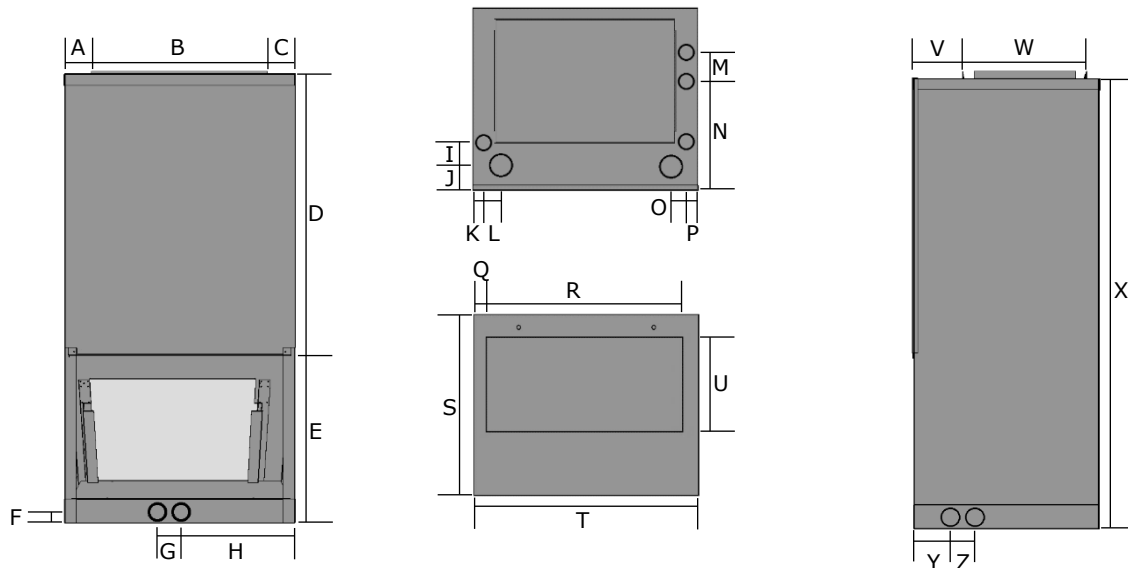

Representative Drawing Only. Some Models May Vary in Appearance.

WMF-2415-00					
A	2"	J	2-1/2"	S	16"
B	16"	K	1"	T	20"
C	2"	L	2"	U	--
D	24-1/4"	M	12-1/2"	V	--
E	14-3/4"	N	9"	W	15-1/4"
F	7/8"	O	2-3/8"	X	39"
G	2"	P	1-1/8"	Y	3"
H	10"	Q	1"	Z	4-3/4"
I	5-1/8"	R	18"		

Model	Weight	Filter Size
WMF-2415-00	95 lbs	16" x 16" x 1"
WMF-3615-00	105 lbs	18" x 20" x 1"



Listing # E114799
Complies With UL 1995
Fifth Edition Heating &
Cooling Equipment

WMF-3615-00					
A	1-3/4"	J	2-1/4"	S	21"
B	20"	K	7/8"	T	24"
C	2-1/2"	L	1-3/4"	U	--
D	27-1/2"	M	14-7/8"	V	4-1/4"
E	16-1/2"	N	11-3/8"	W	20-1/4"
F	7/8"	O	2-5/8"	X	44"
G	--	P	1-1/4"	Y	3"
H	--	Q	1"	Z	4-3/4"
I	5"	R	22"		

Electrical Data						
Model	Motor HP (120V)	Speed	AMPS Motor Pump		Min. Circuit Ampacity	Max. Breaker / Fuse Size
WMF-2415-00	1/3	Medium	6.5	0.57	9	15
WMF-3615-00	1/3	High	6.5	0.57	9	15

Pipe Size			
Model	Liquid Line	Suction Line	All WMF-50 Series Units
WMF-2415-00	3/8" OD	5/8" OD	Heating output will not exceed output of water heater.
WMF-3615-00	3/8" OD	7/8" OD	Heat BTUH is calculated at 70°F entering air temperature.
			180°F data is supplied for boiler applications.
			Approved for installation with 0" clearance to combustible materials.
			All water connections are 7/8" OD

ChillBox™ WMF-00 Series Capacity Data



In Keeping with Its Policy of Continuous Progress and Improvements, JRJ Manufacturing Reserves the Right to Make Changes Without Notice and Incurring Obligation.
The customer is responsible for confirming which fan coil models are compatible with select out-door unit(s) and which expansion valves (if any) are required.

1.5 Ton Capacity

DX Coil Is Compatible with Most Major Brands of Split Condensing Units.						
Model Number	Heating and Cooling Performance					Blower Data
WMF-2415-00 With TXV (Field Installed)	Nominal Cooling (BTUH)	Ft. Water (Coil Only)	Heating Capacity @ 3.5 GPM Entering Water Temperature			CFM vs. External Static Pressure
	18,000	1.8	120°F	140°F	180°F	0.05 0.1 0.15 0.2 0.25 0.3
			24,600	35,000	54,800	710 690 660 640 610 590

Exact Footprint Replacement for the First Co. 18RAQ

2.0 Ton Capacity

DX Coil Is Compatible with Most Major Brands of Split Condensing Units.						
Model Number	Heating and Cooling Performance					Blower Data
WMF-2415-00	Nominal Cooling (BTUH)	Ft. Water (Coil Only)	Heating Capacity @ 3.5 GPM Entering Water Temperature			CFM vs. External Static Pressure
	24,000	1.8	120°F	140°F	180°F	0.05 0.1 0.15 0.2 0.25 0.3
			24,600	35,000	54,800	890 860 840 820 790 760

Exact Footprint Replacement for the First Co. 24RAQ

2.5 Ton Capacity

DX Coil Is Compatible with Most Major Brands of Split Condensing Units.						
Model Number	Heating and Cooling Performance					Blower Data
WMF-3615-00 With TXV (Field Installed)	Nominal Cooling (BTUH)	Ft. Water (Coil Only)	Heating Capacity @ 3.5 GPM Entering Water Temperature			CFM vs. External Static Pressure
	30,000	1.8	120°F	140°F	180°F	0.05 0.1 0.15 0.2 0.25 0.3
			29,700	41,200	65,400	1260 1240 1210 1180 1140 1100

Exact Footprint Replacement for the First Co. 30RAQ

3.0 Ton Capacity

DX Coil Is Compatible with Most Major Brands of Split Condensing Units.						
Model Number	Heating and Cooling Performance					Blower Data
WMF-3615-00	Nominal Cooling (BTUH)	Ft. Water (Coil Only)	Heating Capacity @ 3.5 GPM Entering Water Temperature			CFM vs. External Static Pressure
	36,000	1.8	120°F	140°F	180°F	0.05 0.1 0.15 0.2 0.25 0.3
			29,700	41,200	65,400	1400 1370 1330 1300 1270 1230

Exact Footprint Replacement for the First Co. 36RAQ