

FALL SAVINGS 2022



Step Drill Sets High Speed Steel & TiN Coated

- 3-piece sets includes 12, 20 and 30mm diameter step drills
- Supplied in indexed metal case

HSS Series 470 | Code 754709

204.⁸⁴

TiN Series 475 | Code 754715

222.⁵⁹

Gold-P Drill Set High Speed Steel & TiN Coated

- 1/16" x 1/2" by 64ths
- 135° split point
- Straight shank
- Right hand spiral wide flutes
- Supplied in indexed metal case



Code 883345

146.²⁵

TAP MAGIC Cutting Fluids 16 oz. bottles

EP-XTRA	ALUMINUM	XTRA-THICK	PROTAP	AQUEOUS	ECO-OIL
					
Code 219202	Code 219210	Code 219238	Code 219218	Code 219225	Code 219232
15.⁸⁸	15.⁹¹	19.¹¹	15.⁹³	14.⁹²	16.³⁴
Ozone-friendly formula that provides outstanding performance on all cuts and all metals	Cutting fluid of choice for work on aluminum, brass, copper, and other soft metals	Heavyweight champion for hard metals – inconel, titanium, stainless... any metal up to 45 HRC	Eco-friendly, biodegradable and can be applied to any and all cutting operations and metals	Eco-friendly, non-corrosive, water-based formula that is easy to clean up and biodegradable	Meets the requirements of NSF's H1 Food Grade certification. Biodegradable with natural oil base that's low in odor and smoke

YOUR AUTHORIZED KAR DISTRIBUTOR:

Megasource Inc.

9335 Route Transcanadienne,
St. Laurent, Quebec H4S 1V3

514-956-9191 | 514-333-9189

ventes@megasourceinc.ca

www.megasourceinc.ca



FALL SAVINGS

CNC Spotting Drills

HSS-E Cobalt - Uncoated & RED-X Coated



- 90° angle
- 118° point geometry for improved penetration rates while reinforcing the point
- Double ended for cost savings
- Available in 4-Piece sets or sold individually
- RED-X coating provides increased speeds and feeds and allows machining up to 55 HRC

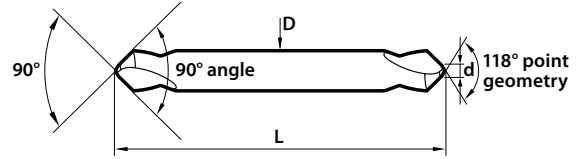

Individual Spotting Drills

4-Piece Sets
(includes 1 of each individual size)

HSS-E Cobalt Code 540090 **70.38**
RED-X Coated Code 540095 **100.36**

D (Inch)	d (Inch)	L (Inch)	90° Series 019 HSS-E COBALT		90° Series 0919 RED-X COATED	
			Code	Price	Code	Price
3/16	1/16	2	540091	11.37	540096	14.98
1/4	3/32	2	540092	12.07	540097	17.07
3/8	9/64	3	540093	18.88	540098	30.65
1/2	3/16	4	540094	29.23	540099	39.91

Countersink Sets

High Speed Steel TiN Coated | Inch | 60°, 82° & 90°



With Hole
5-Piece Sets

60° TiN | Code 601291
82° TiN | Code 601292
90° TiN | Code 601293



278.23/ea.



Single Flute
6-Piece Sets

60° TiN | Code 601227
82° TiN | Code 601228
90° TiN | Code 601229

195.90/ea.

Combined Drill & Countersinks

High Speed Steel TiN Coated | 82° & 90° | Plain Type



Size	Ø Body (Inch)	Ø Point (Inch)	Point Length (Inch)	Overall Length (Inch)	82° Series 154 HSS M2		90° Series 155 HSS M2	
					Code	Price	Code	Price
1	1/8	3/64	1/16	1-1/4	540511	13.55	540521	13.55
2	3/16	5/64	7/64	1-7/8	540512	14.32	540522	14.32
3	1/4	7/64	9/64	2	540513	14.91	540523	14.91
4	5/16	1/8	5/32	2-1/8	540514	15.59	540524	15.59
5	7/16	3/16	1/4	2-3/4	540515	23.95	540525	23.95
6	1/2	7/32	19/64	3	540516	35.77	540526	35.77
7	5/8	1/4	5/16	3-1/4	540517	51.87	540527	51.94
8	3/4	5/16	13/32	3-1/2	540518	81.11	540528	81.81

SAVINGS START NOW



End Mills



Micrograin Solid Carbide | Uncoated & TiAlN-Futura Coated | 4 Flute | Center Cut

- Suitable for cutting hardened and high alloy steels, steel casting, chill casting, malleable cast iron, CrNi-steels, brass, copper, aluminum with a high percentage of silicon and abrasive plastics



Tolerance: 0/-0.0012



Ø Cutter (Inch)	Ø Shank (Inch)	LONG LENGTH						EXTRA LONG LENGTH					
		LOC (Inch)	OAL (Inch)	UNCOATED		TIALN-FUTURA		LOC (Inch)	OAL (Inch)	UNCOATED		TIALN-FUTURA	
				Code	Price	Code	Price			Code	Price	Code	Price
1/8	1/8	3/4	2-1/4	932892	11.66	934580	15.86	1	3	932744	14.03	934620	18.72
3/16	3/16	3/4	2-1/4	932895	13.26	934900	17.35	1-1/8	3	932747	15.91	934911	20.60
1/4	1/4	1-1/8	3	932898	16.29	934582	21.00	1-1/2	4	932750	19.63	934622	26.07
5/16	5/16	1-1/8	3	932901	28.40	934583	36.87	1-5/8	4	932753	34.05	934623	44.31
3/8	3/8	1-1/8	3	932904	35.09	934901	52.16	1-3/4	4	932756	42.16	934912	52.16
7/16	7/16	2	4	932907	65.79	934585	77.67	3	6	-	-	934625	111.03
1/2	1/2	2	4	932910	68.04	934586	78.07	3	6	932762	91.98	934626	127.81
5/8	5/8	2-1/4	5	932913	136.77	934902	151.35	3	6	932765	164.19	934913	183.37
3/4	3/4	2-1/4	5	932916	177.28	934588	197.91	3	6	932768	212.67	934628	240.04
1	1	2-1/4	5	932919	355.27	934589	381.98	3	6	932771	426.25	934629	458.59



Deburring Sets



Standard, Heavy Duty & Glo-Burr

Mango IIB + 2
Extra Close
Standard B

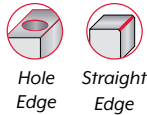

Code 550602 **11.22**

INCLUDES: 2 HSS standard B blades - B10, B20 | Mango IIB ergonomic handle with safety lock

Mango IIE + 3
Extra Close
Heavy Duty E

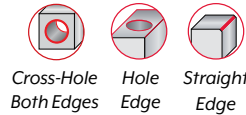

Code 550603 **13.93**

INCLUDES: 3 HSS heavy duty E blades - E100, E200, E300 | Mango IIE ergonomic handle with safety lock

Glo-Burr Sets
Standard B / Heavy Duty E



- Easy-to-grip, strong, yet lightweight
- Pocket clip and blade storage in handle
- Deburrs steel, aluminum, copper, and plastics
- Glo-Burr B with B10 (holds other B blades)
- Glo-Burr E with heavy duty E100 blade (holds other E blades)

Glo-Burr B Sets
6.38 /ea.

Glo-Burr E Sets
6.82 /ea.

B SET CODES: Green 550962 | Blue 550963 | Yellow 550961 | Red 550960

E SET CODES: Green 550967 | Blue 550968 | Yellow 550966 | Red 550965

SHAVIV B12 Modified Blade

Special Blade for Plastics

SIMILAR TO B25 BLADE!
MORE AGGRESSIVE CUT!

HSS | Short-nosed
Fits B handles/holders



19.99 /box of 100
Code 550830 (individual)

SHAVIV Blade Set

Multi-Purpose
Standard B Blades

Code 551001

40.76



INCLUDES: 5 pair of B blades: B10P (2), B11P (2), B12P (2), B20P (2), and B30P (2)

SHAVIV Exclusively Available at **KAR** in Canada

FALL SAVINGS

Calipers



Electronic Standard Model



OPTIONAL ACCESSORY: SPC cable

- Resolution: 0.0005"/0.01mm
- Buttons: on/off, zero, inch/mm
- Auto power off, move digital unit to turn power on
- Battery CR2032
- Data output
- Stainless steel construction
- Supplied in fitted storage case

0-6 Inch/0-150mm
Accuracy: $\pm 0.0010''$
Code 817000

59.19

0-8 Inch/0-200mm
Accuracy: $\pm 0.0015''$
Code 817001

81.70

0-12 Inch/0-300mm
Accuracy: $\pm 0.0015''$
Code 817002

143.37

Dial Calipers



- Graduations: 0.001"
- One revolution equals: 0.1"
- Shock proof dial indicator
- Supplied in fitted storage case

0-6 Inch/0-150mm
Accuracy: $\pm 0.0015''$
Code 816028

71.19

0-8 Inch/0-200mm
Accuracy: $\pm 0.0020''$
Code 816030

94.28

0-12 Inch/0-300mm
Accuracy: $\pm 0.0020''$
Code 816032

172.52

INSIZE Exclusively Available at **KAR** in Canada

SAVE NOW AT KAR

on these featured essentials for the Red Seal Machinist's toolbox!

Magnetic Stands

with Flex Arm | For Dial Test Indicators



Dial Test Indicators

- Jeweled bearing
- Carbide contact point
- Two measuring directions
- Anti-magnetic body
- Supplied with two clamps: 5/32" and 3/8" diameters
- Supplied in fitted storage case



FLEX ARM STAND
Code 282892
62.51

- Applicable holding stem \varnothing : 3/8", 8mm, 4mm
- Magnetic force: 176lbf/80kgf

Range (Inch)	Graduation (Inch)	Accuracy (Inch)	Dial Reading	ØA (Inch)	L (Inch)	DIAL TEST INDICATORS	
						Code	Price
0.03	0.001	± 0.001	0-15-0	1.181	0.500	282858	81.09
	0.0005	± 0.0005				816170	106.05
0.008	0.0001	± 0.0001	0-40-0	1.457	0.563	816172	141.31
	0.001	± 0.001				282859	83.75
0.03	0.0005	± 0.0005	0-15-0	1.457	0.500	282860	85.70
	0.001	± 0.001				282861	141.86



Offer ends
December 30, 2022



←INSIZE→ TOOLS THAT MEASURE UP

Welding Gage

With Adjustable Scale

- Adjustable scale to compensate for pointer wear
- Stainless steel
- Supplied in storage pouch



Code 877031

69.19

Edge Finder

With Hardened Shank & Contact Point



Shank: Ø3/8"
Contact Point: Ø0.2"
Accuracy: ±0.0003"
Code 816383

51.46

Small Hole Gage Set ←INSIZE→



- For small holes, slots, grooves, etc.
- Satin chrome finish
- Supplied in storage pouch

4 Gages
0.125 to 0.5 Inch
Code 816204

30.81

Measurement	Range Inch (mm)	Accuracy	Graduation Inch (mm)
Crown height	0-1 (0-25)	±0.02"	1/16 (1)
Fillet weld leg height	0-1 (0-25)	±0.02"	1/16 (1)
Misalignment (high-low)	0-1 (0-25)	±0.02"	1/16 (1)
Undercut depth	0-1/8 (0-2)	±0.02"	1/16" (1)
Fillet weld throat size	0-3/4 (0-20)	±0.02"	1/16 (1)
Angle of preparation	0-60°	±1°	5°
Length	0-2 (0-60)	±0.02"	1/16" (1)
45° angle	-	±1°	-

Thread Plug Gages



- Supplied with GO and NO-GO end
- Class 6H
- ISO1502 standard



- Supplied with GO and NO-GO end
- Class 2B
- ANSI B1.2 standard

Size (mm)	METRIC	
	Code	Price
M2 x 0.4	284053	58.09
M2.2 x 0.45	284054	62.36
M2.5 x 0.45	284055	57.11
M3 x 0.5	284056	57.11
M3.5 x 0.6	284057	61.37
M4 x 0.7	284058	41.65
M5 x 0.8	284059	41.65
M6 x 1	284060	41.65
M7 x 1	816680	37.60
M8 x 1.25	284061	41.65
M9 x 1.25	816681	37.60
M10 x 1.5	284062	49.81
M11 x 1.5	816682	45.22
M12 x 1.75	284063	56.97
M14 x 2	284064	59.66

Size (mm)	METRIC	
	Code	Price
M16 x 2	284065	60.04
M18 x 2.5	284066	65.17
M20 x 2.5	284067	65.29
M22 x 2.5	284068	66.78
M24 x 3	284069	77.21
M27 x 3	284070	77.21
M30 x 3.5	284071	89.32
M33 x 3.5	284072	92.65
M39 x 4	284074	124.34
M42 x 4.5	284075	165.75
M45 x 4.5	284076	169.23
M48 x 5	284077	179.68
M52 x 5	284078	189.15
M56 x 5.5	284079	203.12
M60 x 5.5	284080	216.32

Size	AMERICAN STANDARD	
	Code	Price
4-40 UNC	816651	64.52
6-32 UNC	816652	58.99
8-32 UNC	816653	58.99
10-32 UNF	816654	64.52
1/4-20 UNC	816655	58.12
1/4-28 UNF	816656	61.28
5/16-18 UNC	816657	58.12
5/16-24 UNF	816658	58.12
3/8-24 UNF	816660	64.52
7/16-20 UNF	816661	64.31
1/2-13 UNC	816662	70.11
1/2-20 UNF	816663	67.79
9/16-18 UNF	816664	67.79
5/8-11 UNC	816665	92.92
5/8-18 UNF	816666	70.77
3/4-10 UNC	816667	94.17
3/4-16 UNF	816668	78.36

Thread Plug Gages are supplied with a manufacturer inspection certificate

For more INSIZE TOOLS THAT MEASURE UP, see KAR's "INSIZE | 2022 TOP 50+ BEST SELLERS" 8-Page brochure online at KAR.ca/promotions or pick up your copy at your local KAR Distributor

FALL SAVINGS

Quick Change Tooling For Morse Taper Spindles



- For use on radial drills, boring mills, or any machine with Morse taper spindles
- Interchangeable with Jahrl

Holder - Model 060201



- Max rotation speed 2000 RPM
- Max concentricity achieved by taper coupling
- 10 mm clearance between workpiece and tool is sufficient
- Rotation in either direction
- Equally effective in vertical or horizontal position

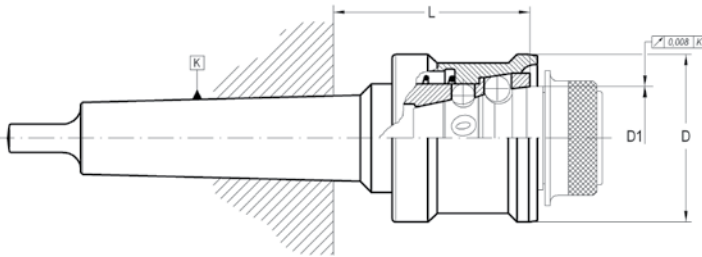

QC Holder M3
Code 369400

473.⁶⁶

QC Holder M4
Code 369401

473.⁶⁶

QC Holder M4
Code 369402

645.⁶⁴

QC Holder M5
Code 369403

1122.⁶²

K	D1 (mm)	L (mm)	D (mm)	QC HOLDER	
				Code	Price
M3	40	77	63	369400	
M4	40	78	63	369401	
M4	51.5	95	83	369402	
M5	68.7	116	100	369403	

Adapters - Model 069901

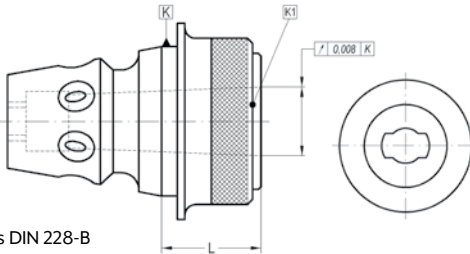

- For tapered Morse Taper tools DIN 228-B

K (mm)	K1 (mm)	L (mm)	QC ADAPTERS	
			Code	Price
40	M1	25	369411	
	M2	29	369412	204. ⁵¹ /ea.
	M3	44	369413	
51.5	M1	34	369421	
	M2	34	369422	240. ⁰⁸ /ea.
	M3	34	369423	
	M4	55	369424	272. ⁶¹
68.7	M1	34	369431	
	M2	34	369432	317. ⁹⁵ /ea.
	M3	34	369433	
	M4	43	369434	
	M5	70	369435	379. ⁶⁷ /ea.

CNC Bar Pullers Compact & Heavy Duty



Compact Bar Pullers

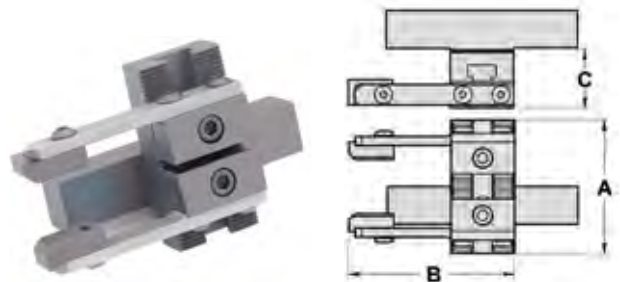

- Great for use with small CNC lathes - compact design minimizes tool interference
- Very easy to setup and use
- Unit can pull round, square, and hex stock
- Flexible heat-treated steel fingers provide strong gripping force
- Each compact bar puller includes one set of serrated jaws and one blank spindle bushing

Order insert holder and insert separately.

Additional sizes and shank styles are available.

Contact your KAR distributor for more information.

Shank (Inch)	Gripping Range (Inch)	A (Inch)	B (Inch)	C (Inch)	COMPACT	
					Code	Price
3/4 sq.	1/8 - 2-1/4	2-5/8			217051	1155. ⁶⁶
1 sq.	1/8 - 2-1/4	2-5/8	3-1/4	1-3/16	217052	1155. ⁶⁶
1 sq.	1/8 - 3	2-5/8			217053	1230. ⁸⁸

Heavy Duty Bar Pullers

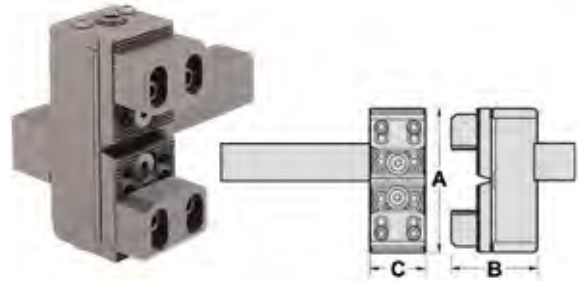

- Gripping range from 1/8" to 6-1/2"
(extra capacity jaws sold separately)
- Gripping force is easily adjusted by altering spring pressure
- Jaws have two gripping surfaces: one side is serrated for increased gripping power, the other side is smooth to help prevent marking
- Smooth side is also used when pulling small diameter stock
- Very easy to set up and use
- Each unit comes with one set of standard jaws and one blank spindle bushing

Shank (Inch)	Gripping Range (Inch)		A (Inch)	B (Inch)	C (Inch)	HEAVY DUTY	
	Standard Jaws	Extra Capacity Jaws				Code	Price
3/4 sq.			3-7/8	2-9/16	1-1/2	217058	1902. ⁷⁵
1 sq.	1/8 - 2-1/4	1-7/8 - 3-3/4	3-7/8	2-9/16	1-1/2	217059	2020. ⁷⁸
1 sq.	1/8 - 4-7/8	1-7/8 - 6-1/2	6-3/4	2-3/4	1-3/4	217062	2552. ⁵⁷

SAVINGS START NOW



Simple Indexing Spacers

Machine Mount | Horizontal/Vertical



Masking Plates

Model CC-6
Code 277080
1256.00

Model CC-8
Code 277082
1747.98

- Mount on milling machines, drilling machines and other machine tools where an indexing facility is required
- Designed for use in horizontal or vertical positions
- Large center through hole suitable for large and long workpieces
- May be used with 3-jaw chuck
- Rapid indexing and easy operation, sharp for mass production
- Simple index includes 3-jaw chuck, masking plates 2, 3, 4, 6, 8 and 12
- Using the key guide block the center can be corrected quickly and accurately

Model	Dividable Number	Ø Inner Jaw	Ø Outer Jaw	Ø Turret Hole	Ø Chuck Hole	Weight
CC-6	2, 3, 4, 6, 8, 12, 24	55 - 145 mm	3 - 160 mm	44 mm	44 mm	29.5 kg
CC-8	2, 3, 4, 6, 8, 12, 24	65 - 200 mm	4 - 200 mm	63 mm	58 mm	51.5 kg

For more dimensions and details visit www.kar.ca

3-Jaw Self-Centering Lathe Chucks

Universal | Plain Back Mounting | 2-Piece Hard Reversible Jaws

- Semi-steel body, medium duty
- 3 pinion design

Each chuck is provided with:

- 1 set of hard master jaws
- 1 set of hard top reversible jaws
- 1 chuck wrench
- 1 set of mounting bolts
- 2 hex keys
- Eye bolts with 10-32" chucks
- Adapters required for plain back mounting

Chuck Diameter (Inch)	RPM Max	M Thread	Bolt Length (Inch)	No. of Bolts Required
6	3000	M10 x 1.5	0.98	6
8	2500	M10 x 1.5	0.98	6
10	2000	M12 x 1.75	1.18	6
12	1500	M16 x 2	1.18	6
16	1000	M16 x 2	1.57	6



gator chucks™
BY FUERDA

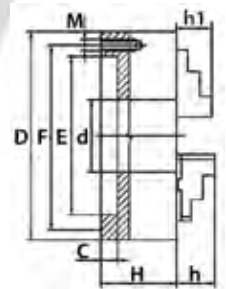

Ø 6 Inch
Code 410009

581.70

Ø 8 Inch
Code 410010

781.25

Ø 10 Inch
Code 410003

1044.47

Ø 12 Inch
Code 410007

1549.75

Ø 16 Inch
Code 410008

2326.72

D Chuck Diameter (Inch)	d Hole (Inch)	Maximum Hole Enlargements (Inch)	Model	C (Inch)	E (Inch)	F (Inch)	H (Inch)	h (Inch)	h1 (Inch)	Code
6	1.65	1.93	PS3-6"A	0.16	4.92	5.51	2.54	1.69	1.26	410009
8	2.17	2.82	PS3-8"A	0.16	6.30	6.93	2.95	1.77	1.14	410010
10	2.99	3.58	PS3-10"A	0.20	7.87	8.82	3.35	2.09	1.34	410003
12	4.06	4.33	PS3-12"A	0.20	10.24	11.26	3.70	2.24	1.69	410007
16	5.35	5.75	PS3-16"A	0.20	12.99	14.25	4.13	2.69	2.16	410008

KAR OFFERS THE GATOR CHUCK COMPLETE LINE! Ask your local Distributor for more details!



FALL SAVINGS



Chuck Stop Sets

Standard & Deluxe

3-Piece Standard Set
15, 20 and 25mm stops
Code 355985

382.63

5-Piece Deluxe Set
15, 20, 25, 30 and 35mm stops
Code 355986

665.38

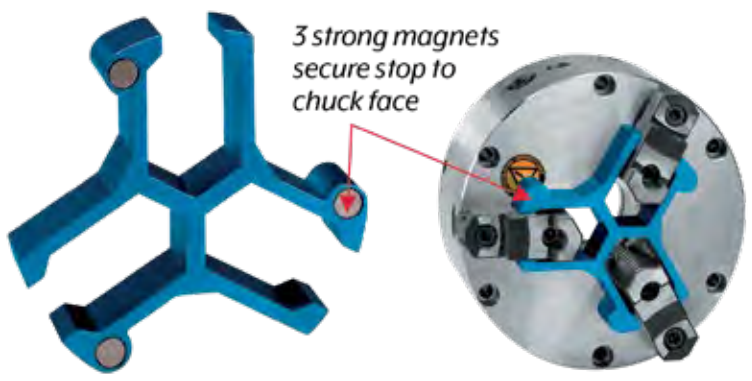

Dead Centers with Nut

Solid Centers | Alloy Steel

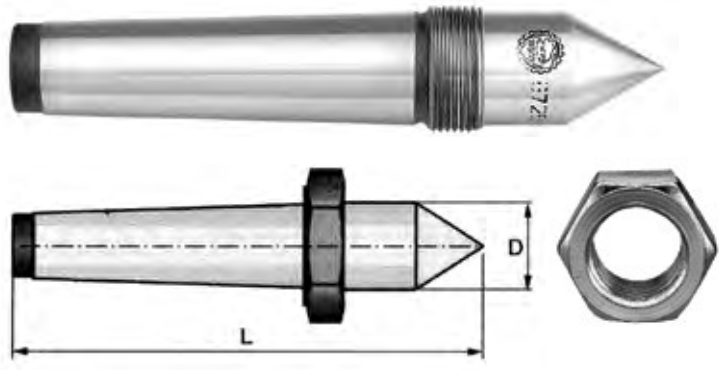

Morse Taper	L (Inch)	D (Inch)	Spare Nut Reference		DEAD CENTER WITH NUT	
			Size (Inch)	Spare Nut Code	Code	Price
1	3.54	0.48	0.94	826335	826323	86. ⁷¹
2	4.41	0.71	1.26	826336	826324	101. ⁸¹
3	5.43	0.95	1.61	826337	826325	124. ⁴⁴
4	6.89	1.24	2.17	826338	826326	179. ⁰⁸
5	8.54	1.76	-	-	826327	256. ³⁹
6	11.42	2.51	3.94	826340	826328	522. ²²

Live Centers

High Speed Steel | Main Line Type N | Standard 60°



MAIN-LINE: Reliable top of the range live center for CNC and conventional lathes, and grinding machines

- Surface-hardened body
- Ground tapers conform to DIN228AT3
- Through-hardened spindle constructed from high-grade steel
- Spindle mounted by two needle bearings
- Thrust ball bearings to accommodate axial loads
- Over-pressure security through disc springs
- Reliable lip seal
- Continuous lubrication provided by a high quality grease



BODY AND SPINDLE MODELS

ST | Standard for normal loads
SU | Super for heavy duty loads and low turning rates

MORE DIMENSIONS: <https://tinyurl.com/2d5hjphn>
KAR OFFERS MORE ROTOR LIVE CENTERS & ACCESSORIES!
Ask your local Distributor for more details!

MT1 STANDARD Code 100101	MT2 STANDARD Code 100102	MT2 SUPER Code 100112	MT3 SUPER Code 100113	MT4 STANDARD Code 100104	MT5 SUPER Code 100115	MT6 STANDARD Code 100106
723.93	625.61	719.46	804.37	813.29	1501.50	1783.04



KAR Industrial Inc.
www.kar.ca

Toronto.....1-800-387-3127
Montréal.....1-800-363-7862
Edmonton.....1-866-440-4326

Offer valid until December 30th, 2022
*Products shown may not be exactly as illustrated Code 000319