

WHY STEPSTUDS™

StepStuds™ provide a level of protection, durability, and cost savings not possible with plastic waterproofing or conventional drywall track.

- Superior **G90-coated steel** design defends against corrosion
- **Tall, rigid construction** provides stability and moisture protection
- **Air vent and drainage** systems prevent mold and mildew growth

Made with flood remediation in mind, StepStuds™ are designed to drastically minimize repair costs and eliminate the need for complete drywall replacement, saving time and money.



MEET MIKE

Founder & CEO Michael Cox is a carpenter by trade. Michael's lifelong reputation for quality craftsmanship and his attention to detail have continually served him well.

Mike invented StepStuds™ as a response to repeated flood remediation experiences on the job. He knew there had to be a better way—so he created it himself!



MICHAEL COX, FOUNDER & CEO

GET IN TOUCH

Interested in learning more about StepStuds™? Connect with Mike directly:



michael.cox@stepstuds.com



1-833-STEPSTUDS (1-833-783-7788)



Keeping the
'Dry' in Drywall

StepStuds™

STEPSTUDS.COM

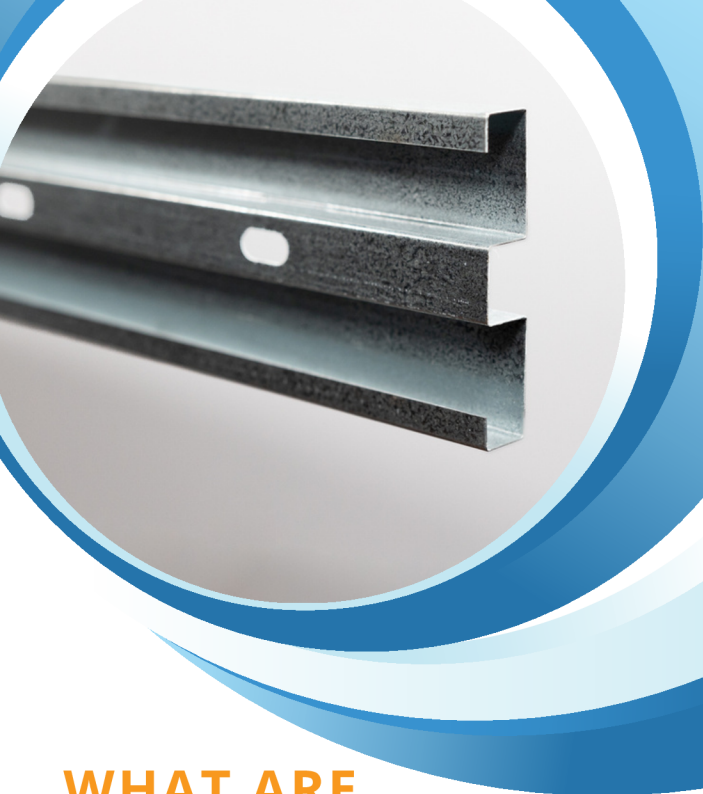

WHAT ARE STEPSTUDS™?

StepStuds™ are a completely new category of metal studs in the construction tech industry that lift drywall up off the floor to keep it dry. They are easy to install, ventilation prevents mold and mildew growth, and durable materials eliminate the need for costly drywall replacement when a water intrusion or flood occurs.

OUR MISSION

We aim to deliver an innovative and permanent cost-saving solution to wet drywall, mold, mildew, and costly flood repairs by utilizing our new installation technology called StepStuds™.

STEPSTUDS™ TECHNOLOGY

Our patented horizontal base stud technology is made in the U.S.A., engineered for compliance, and easily installs in minutes—the perfect solution for drywall protection from floods and water intrusions.



Horizontal Base Stud installed at floor level lifts drywall away from moisture, keeping it dry



Pre-punched Drain Hole System on both top and bottom short edges



Pre-punched Air Vent System creates air movement



Easy install saves thousands of dollars in flood remediation labor and materials

WWW.STEPSTUDS.COM

THE COMPLETE STEPSTUD™ SYSTEM

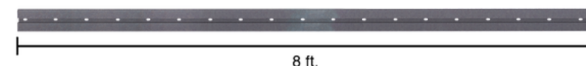

StepStuds™ come in 8' lengths for ease of shipping, carrying, and work site mobility.

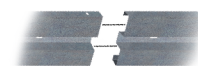

StepStud™ Extender slides completely into the back of the StepStud™ to form a quick 15' wall extension.

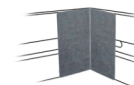

StepStud™ Corners cover up open ends on outside corners and stabilize inside corners.



StepStud™ Spline connects two outer pieces together for greater stability.

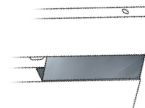

StepStud™ Spacer U-shaped spacer bar forms a solid-face-front if preferred.

WE'RE ON A MISSION TO PREVENT WET DRYWALL, MOLD AND MILDEW. STEPSTUDS™ OFFER:

- 75% Reduction in labor & material costs
- 50% Faster room/area turnaround
- Elimination of mold and mildew growth
- Proven system that keeps drywall dry!