

Step 3

Measure and make a sketch.

You don't have to be a professional designer to plan your new CORIAN countertop. A pencil and measuring tape is all you need to do it yourself. The sample floorplan below shows you how to draw your kitchen countertop, sinks and backsplashes to scale. Remember: each 1/4" square on the grid equals one foot in your kitchen.

1 - Mark the location of all sinks, cooktops, free-standing stoves and refrigerators.

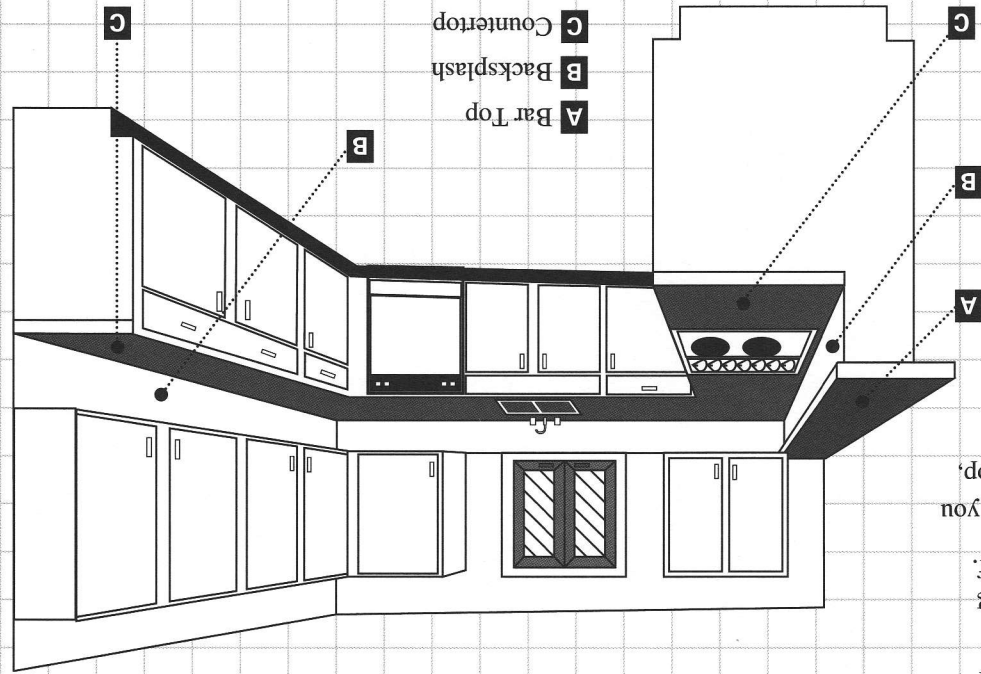

2 - Write down your measurements (in inches) on the floorplan.

3 - Be sure to include the height of backsplashes required.

4 - Indicate the length and width of bar tops and windowsills.

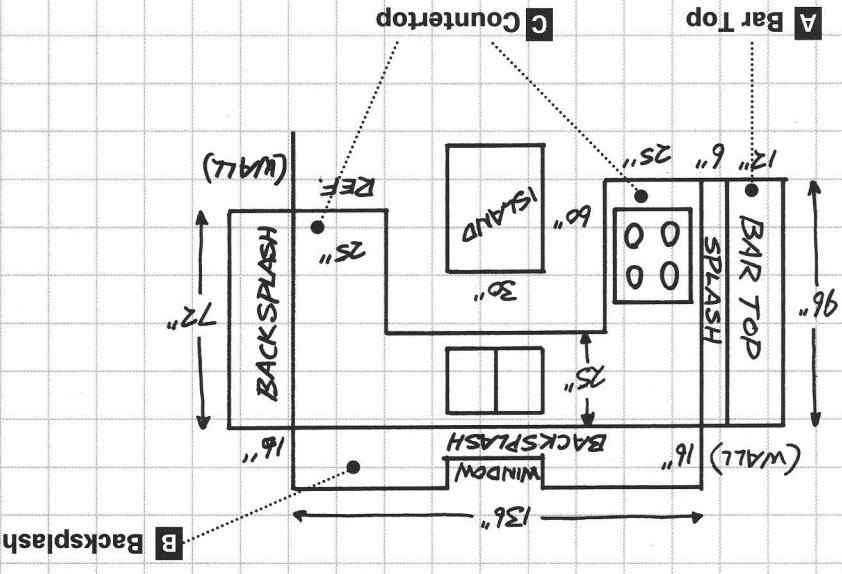

SAMPLE FLOORPLAN