

Blindspace TrackTrim®  
for SILENT GLISS 5100 Curtain Track

MOTOR BOX TTSG51MB1F

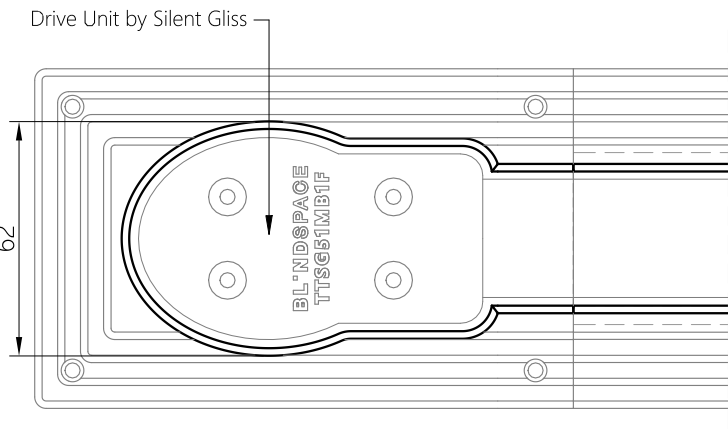

TRACK PROFILE TT1F/TT2F

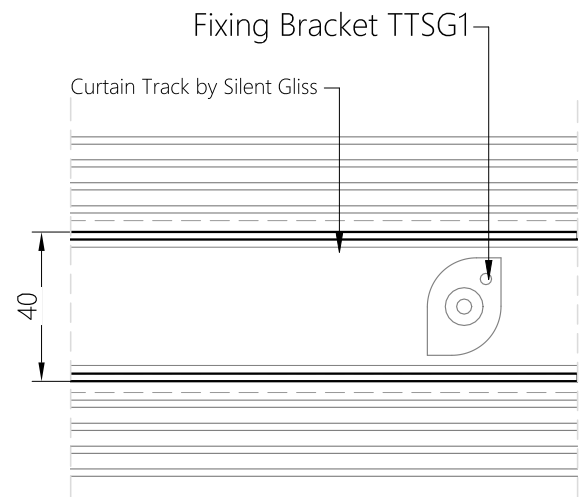

RETURN BOX TTSG51RB1F

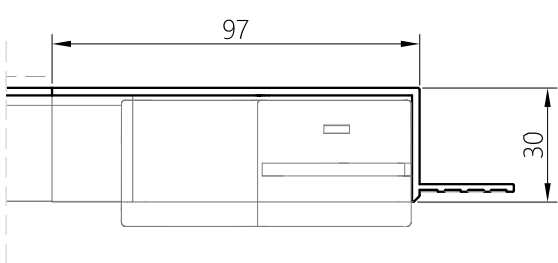
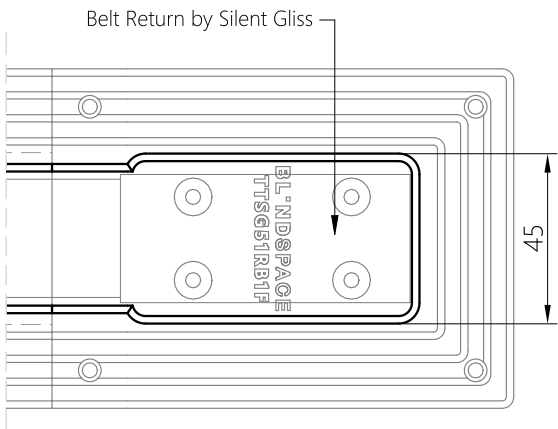

FIXING BRACKET

TTSG1 - Fixing Bracket

SECTION A-A TT1F PROFILE

TT1F – Track with Screw Channel, possible Screw-Through Fixing

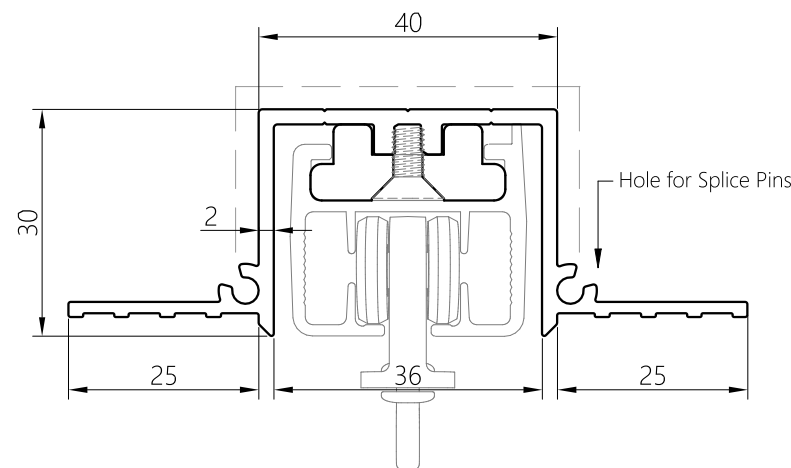

SECTION A-A TT2F PROFILE (OPTIONAL)

TT2F – Track for Screw-Through Fixing

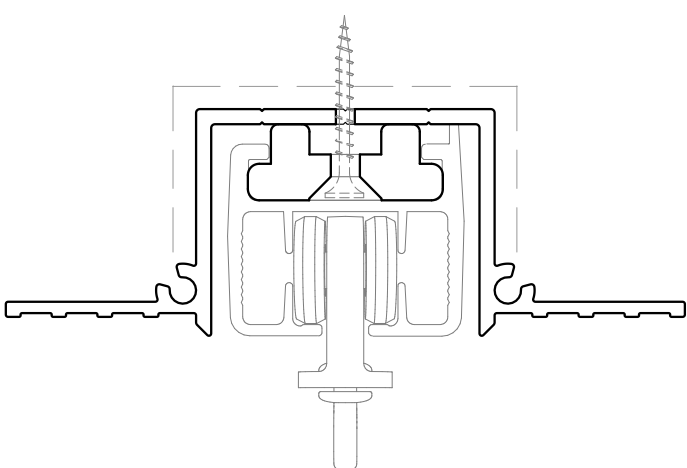

|                      |  |
|----------------------|--|
| Product              | Blindspace TrackTrim   |
| Description          | Recessed profiles to house curtain tracks.   |
| Curtain size         | Please see size chart and supplier details for curtain such as max. length and weight.   |
| Finishes             | White to be plastered in and decorated at site to match ceiling.   |
| Material             | Track EN 6063 T6, End set PLA Thermoplastic Polyester  |
| Optional accessories | Curve Sections for bent tracks<br>Long Splice Pins for joining   |
| Track length         | 2000mm<br>Cut to size for shorter lengths.<br>Spliced together for longer lengths.   |
| Installation         | <p>Please refer to Sample Installation Drawings available both in PDF and DWG at <a href="http://blindspace.com">blindspace.com</a></p> <p>Tracks to be fixed with countersunk screws every 200mm through back (and both flanges when available) into appropriate backing. Scrim tape to be used on flanges. Finished plaster level to be flush with chamfered edge. Allow 3mm recess space for ease of installation, shown in dash line around tracks</p> |
| Print date           | 2023/01/02   |
| Page size            | ISO A3 420x297   |
| Print file           | blindspace tracktrim with sg 5100.dwg  |