

SPEEDFRAC

BALL ACTIVATED FRAC SLEEVE

Casing Size (in)	Maximum OD (in.)	Minimum Seat ID (in.)	Maximum Temp (°F)	Maximum Working Pressure
3.50	4.380	0.908	300	10,000
4.50	5.600	0.908	300	10,000
5.50	7.000	0.908	300	10,000

FEATURES:

- Field proven, ball actuated frac sleeve
- Large exit ports for maximum flow
- Drillable cast iron non-rotational seats
- Full drift ID after drills out
- Short slim-hole design eliminates need for pup joints
- Available for 10K and 15K applications
- P110 material construction
- Variable set opening pressure
- Standard LTC threaded connections

The **SPEEDFRAC Ball Activated Frac Sleeve** is designed for horizontal completions and serves as a single point of entry into the formation allowing communication between formation and casing. Generally run in multiples, the frac sleeve is closed and is not affected by differential casing pressure until the ball has seated. The frac sleeve is installed in the closed position and only activated mechanically by pumping a corresponding sized frac ball from the surface down to the sleeve ball seat. Once actuated, the inner sleeve valves are locked open to prevent closure during well production.



Office Location:

Dynamic Oilfield Services, LLC • 4245 Matlock Road • Bowling Green, KY 42104
Managing Partner: Patrick Parson • Phone (270) 991-1004
www.dynamicofs.com • Email: patrick@dynamicofs.com

SPEEDFRAC

BALL ACTIVATED 4-1/2" FRAC SLEEVE SPECIFICATIONS

MAXIMUM OD	5.60 inches
MINIMUM DRILL OUT ID	4.00 INCHES
BODY MATERIAL	P-110
BALL SEAT MATERIAL	Cast Iron
PRESSURE RATING	10,000 psi
PRESSURE VALUE/SHEAR PIN	450 psi
NUMBER OF SHEAR SCREWS	10
EXIT FLOW AREA OF PORTS	15.88 in ²
MAXIMUM # OF BALL SEATS	*29
TORQUE RATING	16,000 ft-lb
THREAD CONNECTION	4-1/2" LTC std.

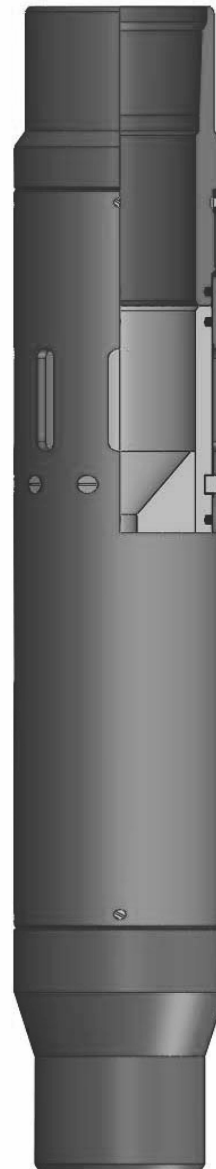

Office Location:

Dynamic Oilfield Services, LLC • 4245 Matlock Road • Bowling Green, KY 42104
 Managing Partner: Patrick Parson • Phone (270) 991-1004
 www.dynamicofs.com • Email: patrick@dynamicofs.com