

# Heavy - Duty Lever Lock Series

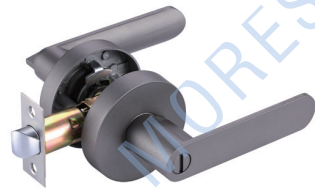

B8802

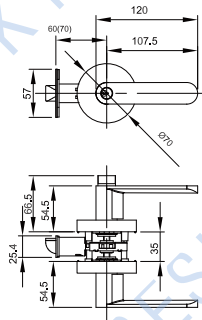

- Material: Zinc alloy
- Function: Entrance/ Privacy/ Passage/ Dummy
- Finish: Satin nickel/ Oil rubbed bronze/ Antique brass/ Antique copper/ Satin chrome/ Chrome plated/ Antique nickel/ Polished brass
- Standard door thickness: 35-50mm
- Special door thickness: 45-55mm
- Suitable for: Wooden door and steel door



B8803

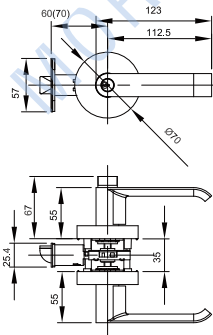

- Material: Zinc alloy
- Function: Entrance/ Privacy/ Passage/ Dummy
- Finish: Satin nickel/ Oil rubbed bronze/ Antique brass/ Antique copper/ Satin chrome/ Chrome plated/ Antique nickel/ Polished brass
- Standard door thickness: 35-50mm
- Special door thickness: 45-55mm
- Suitable for: Wooden door and steel door



B8805

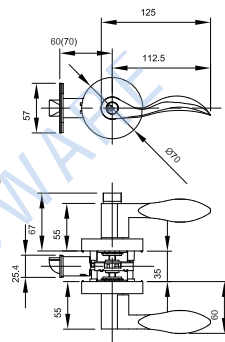

- Material: Zinc alloy
- Function: Entrance/ Privacy/ Passage/ Dummy
- Finish: Satin nickel/ Oil rubbed bronze/ Antique brass/ Antique copper/ Satin chrome/ Chrome plated/ Antique nickel/ Polished brass
- Standard door thickness: 35-50mm
- Special door thickness: 45-55mm
- Suitable for: Wooden door and steel door



B8806

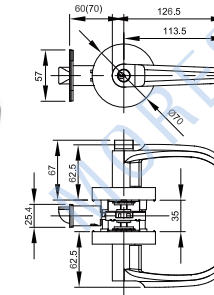

- Material: Zinc alloy
- Function: Entrance/ Privacy/ Passage/ Dummy
- Finish: Satin nickel/ Oil rubbed bronze/ Antique brass/ Antique copper/ Satin chrome/ Chrome plated/ Antique nickel/ Polished brass
- Standard door thickness: 35-50mm
- Special door thickness: 45-55mm
- Suitable for: Wooden door and steel door

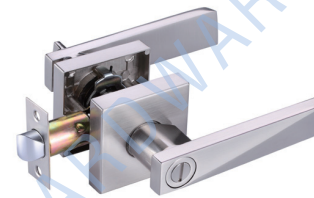

A8807

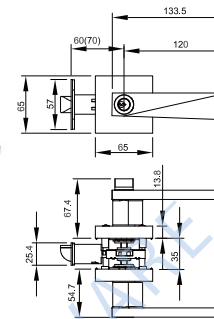

- Material: Zinc alloy
- Function: Entrance/ Privacy/ Passage/ Dummy
- Finish: Satin nickel/ Oil rubbed bronze/ Antique brass/ Antique copper/ Satin chrome/ Chrome plated/ Antique nickel/ Polished brass
- Standard door thickness: 35-50mm
- Special door thickness: 45-55mm
- Suitable for: Wooden door and steel door

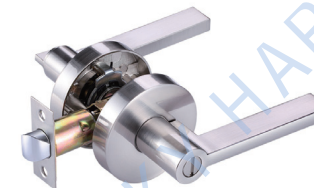

B8808

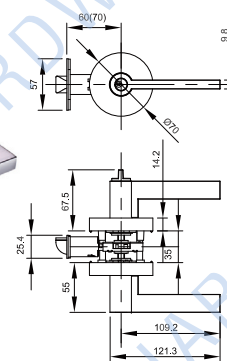

- Material: Zinc alloy
- Function: Entrance/ Privacy/ Passage/ Dummy
- Finish: Satin nickel/ Oil rubbed bronze/ Antique brass/ Antique copper/ Satin chrome/ Chrome plated/ Antique nickel/ Polished brass
- Standard door thickness: 35-50mm
- Special door thickness: 45-55mm
- Suitable for: Wooden door and steel door

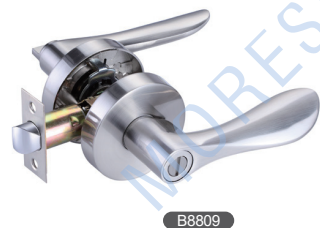

B8809

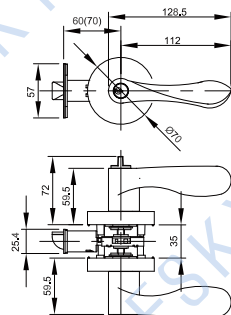

- Material: Zinc alloy
- Function: Entrance/ Privacy/ Passage/ Dummy
- Finish: Satin nickel/ Oil rubbed bronze/ Antique brass/ Antique copper/ Satin chrome/ Chrome plated/ Antique nickel/ Polished brass
- Standard door thickness: 35-50mm
- Special door thickness: 45-55mm
- Suitable for: Wooden door and steel door



A8812

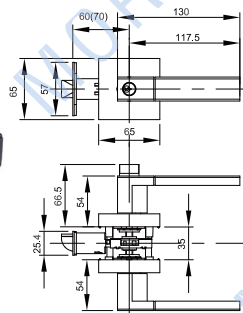

- Material: Zinc alloy
- Function: Entrance/ Privacy/ Passage/ Dummy
- Finish: Satin nickel/ Oil rubbed bronze/ Antique brass/ Antique copper/ Satin chrome/ Chrome plated/ Antique nickel/ Polished brass
- Standard door thickness: 35-50mm
- Special door thickness: 45-55mm
- Suitable for: Wooden door and steel door



A8813

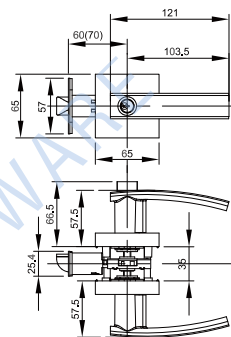

- Material: Zinc alloy
- Function: Entrance/ Privacy/ Passage/ Dummy
- Finish: Satin nickel/ Oil rubbed bronze/ Antique brass/ Antique copper/ Satin chrome/ Chrome plated/ Antique nickel/ Polished brass
- Standard door thickness: 35-50mm
- Special door thickness: 45-55mm
- Suitable for: Wooden door and steel door



A8815

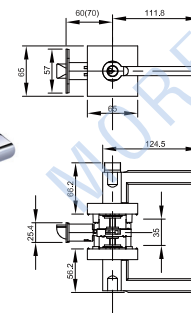

- Material: Zinc alloy
- Function: Entrance/ Privacy/ Passage/ Dummy
- Finish: Satin nickel/ Oil rubbed bronze/ Antique brass/ Antique copper/ Satin chrome/ Chrome plated/ Antique nickel/ Polished brass
- Standard door thickness: 35-50mm
- Special door thickness: 45-55mm
- Suitable for: Wooden door and steel door



B8818

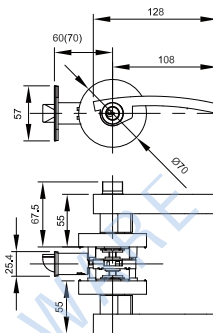

- Material: Zinc alloy
- Function: Entrance/ Privacy/ Passage/ Dummy
- Finish: Satin nickel/ Oil rubbed bronze/ Antique brass/ Antique copper/ Satin chrome/ Chrome plated/ Antique nickel/ Polished brass
- Standard door thickness: 35-50mm
- Special door thickness: 45-55mm
- Suitable for: Wooden door and steel door

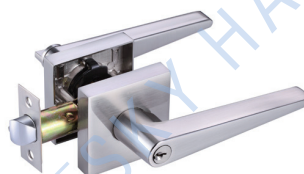

A8819

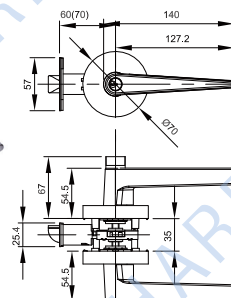

- Material: Zinc alloy
- Function: Entrance/ Privacy/ Passage/ Dummy
- Finish: Satin nickel/ Oil rubbed bronze/ Antique brass/ Antique copper/ Satin chrome/ Chrome plated/ Antique nickel/ Polished brass
- Standard door thickness: 35-50mm
- Special door thickness: 45-55mm
- Suitable for: Wooden door and steel door



A8815

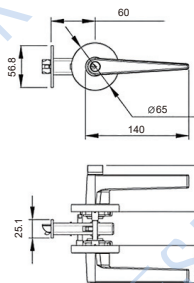

- Material: Zinc alloy
- Function: Entrance/ Privacy/ Passage/ Dummy
- Finish: Satin nickel/ Oil rubbed bronze/ Antique brass/ Antique copper/ Satin chrome/ Chrome plated/ Antique nickel/ Polished brass
- Standard door thickness: 35-50mm
- Special door thickness: 45-55mm
- Suitable for: Wooden door and steel door



B8820

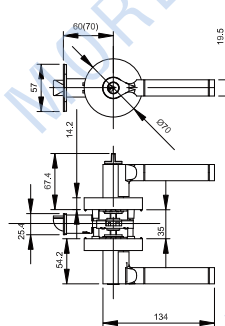

- Material: Zinc alloy
- Function: Entrance/ Privacy/ Passage/ Dummy
- Finish: Satin nickel/ Oil rubbed bronze/ Antique brass/ Antique copper/ Satin chrome/ Chrome plated/ Antique nickel/ Polished brass
- Standard door thickness: 35-50mm
- Special door thickness: 45-55mm
- Suitable for: Wooden door and steel door



B8822

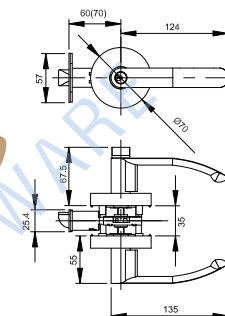

- Material: Zinc alloy
- Function: Entrance/ Privacy/ Passage/ Dummy
- Finish: Satin nickel/ Oil rubbed bronze/ Antique brass/ Antique copper/ Satin chrome/ Chrome plated/ Antique nickel/ Polished brass
- Standard door thickness: 35-50mm
- Special door thickness: 45-55mm
- Suitable for: Wooden door and steel door



B8823

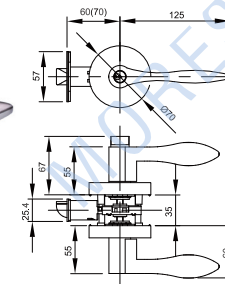

- Material: Zinc alloy
- Function: Entrance/ Privacy/ Passage/ Dummy
- Finish: Satin nickel/ Oil rubbed bronze/ Antique brass/ Antique copper/ Satin chrome/ Chrome plated/ Antique nickel/ Polished brass
- Standard door thickness: 35-50mm
- Special door thickness: 45-55mm
- Suitable for: Wooden door and steel door

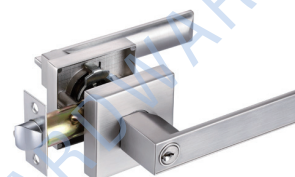

A8827

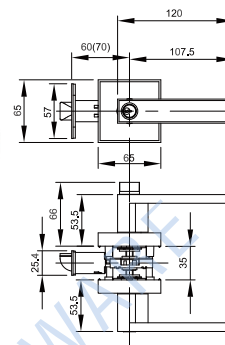

- Material: Zinc alloy
- Function: Entrance/ Privacy/ Passage/ Dummy
- Finish: Satin nickel/ Oil rubbed bronze/ Antique brass/ Antique copper/ Satin chrome/ Chrome plated/ Antique nickel/ Polished brass
- Standard door thickness: 35-50mm
- Special door thickness: 45-55mm
- Suitable for: Wooden door and steel door

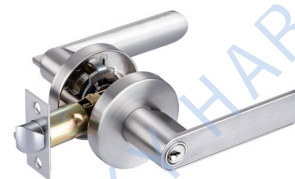

A8828

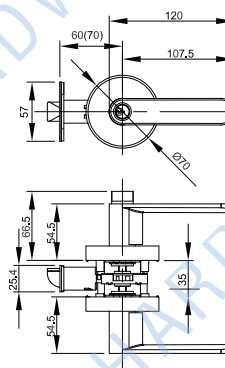

- Material: Zinc alloy
- Function: Entrance/ Privacy/ Passage/ Dummy
- Finish: Satin nickel/ Oil rubbed bronze/ Antique brass/ Antique copper/ Satin chrome/ Chrome plated/ Antique nickel/ Polished brass
- Standard door thickness: 35-50mm
- Special door thickness: 45-55mm
- Suitable for: Wooden door and steel door

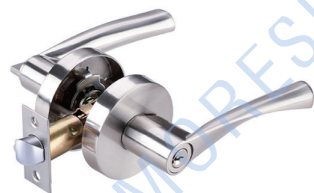

B8829

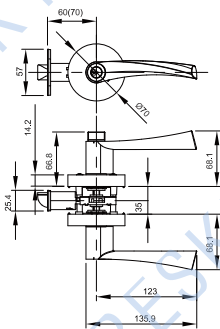

- Material: Zinc alloy
- Function: Entrance/ Privacy/ Passage/ Dummy
- Finish: Satin nickel/ Oil rubbed bronze/ Antique brass/ Antique copper/ Satin chrome/ Chrome plated/ Antique nickel/ Polished brass
- Standard door thickness: 35-50mm
- Special door thickness: 45-55mm
- Suitable for: Wooden door and steel door



E8832

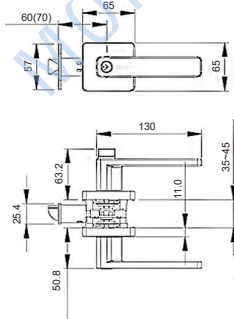

- Material: Zinc alloy
- Function: Entrance/ Privacy/ Passage/ Dummy
- Finish: Satin nickel/ Oil rubbed bronze/ Antique brass/ Antique copper/ Satin chrome/ Chrome plated/ Antique nickel/ Polished brass
- Standard door thickness: 35-50mm
- Special door thickness: 45-55mm
- Suitable for: Wooden door and steel door



F8832

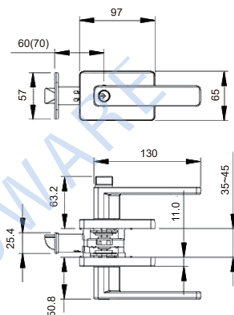

- Material: Zinc alloy
- Function: Entrance/ Privacy/ Passage/ Dummy
- Finish: Satin nickel/ Oil rubbed bronze/ Antique brass/ Antique copper/ Satin chrome/ Chrome plated/ Antique nickel/ Polished brass
- Standard door thickness: 35-50mm
- Special door thickness: 45-55mm
- Suitable for: Wooden door and steel door

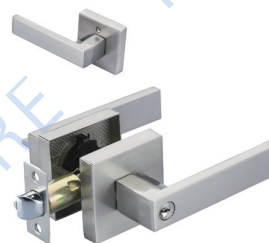

9910

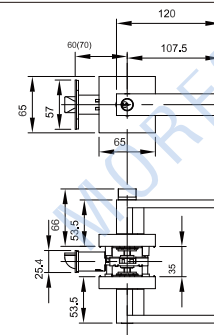

- Material: Zinc alloy
- Function: Entrance/ Privacy/ Passage/ Dummy
- Feature: Screw left-right structure
- Finish: Satin nickel/ Oil rubbed bronze/ Antique brass/ Antique copper/ Satin chrome/ Chrome plated/ Antique nickel/ Polished brass
- Standard door thickness: 35-50mm
- Special door thickness: 45-55mm
- Suitable for: Wooden door and steel door



6601

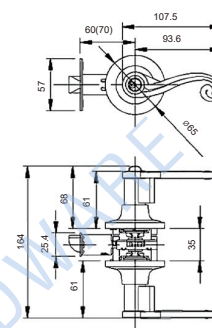

- Material: Zinc alloy/ Steel
- Function: Gate lock / Privacy lock / Passage lock / Single side lock
- Finish: Satin nickel/ Polished brass/ Antique brass/ Antique copper/ Satin chrome/ Chrome Plated/ Oil rubbed bronze/ Antique nickel
- Standard door thickness: 35-45mm
- Special door thickness: 45-55mm
- Suitable for: Wooden door and steel door

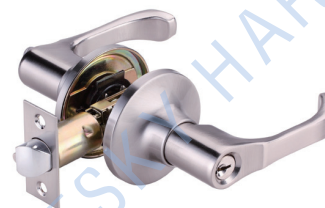

6602

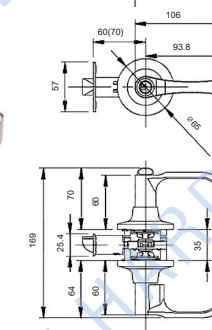

- Material: Zinc alloy/ Steel
- Function: Gate lock / Privacy lock / Passage lock / Single side lock
- Finish: Satin nickel/ Polished brass/ Antique brass/ Antique copper/ Satin chrome/ Chrome Plated/ Oil rubbed bronze/ Antique nickel
- Standard door thickness: 35-45mm
- Special door thickness: 45-55mm
- Suitable for: Wooden door and steel door



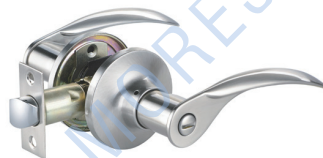

6603

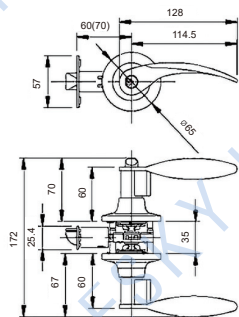

- Material: Zinc alloy/ Steel
- Function: Gate lock / Privacy lock / Passage lock / Single side lock
- Finish: Satin nickel/ Polished brass/ Antique brass/ Antique copper/ Satin chrome/ Chrome Plated / Oil rubbed bronze/ Antique nickel
- Standard door thickness: 35-45mm
- Special door thickness: 45-55mm
- Suitable for: Wooden door and steel door

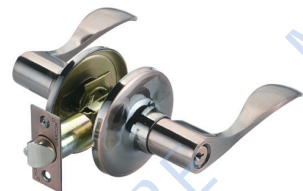

6605

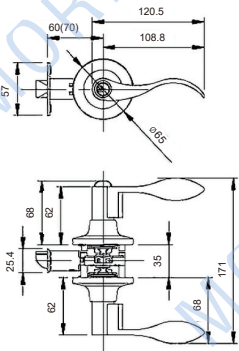

- Material: Zinc alloy/ Steel
- Function: Gate lock / Privacy lock / Passage lock / Single side lock
- Finish: Satin nickel/ Polished brass/ Antique brass/ Antique copper/ Satin chrome/ Chrome Plated / Oil rubbed bronze/ Antique nickel
- Standard door thickness: 35-45mm
- Special door thickness: 45-55mm
- Suitable for: Wooden door and steel door



6607

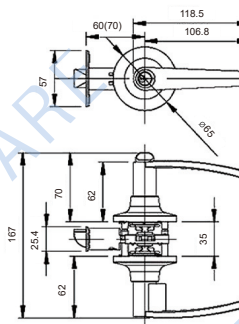

- Material: Zinc alloy/ Steel
- Function: Gate lock / Privacy lock / Passage lock / Single side lock
- Finish: Satin nickel/ Polished brass/ Antique brass/ Antique copper/ Satin chrome/ Chrome Plated / Oil rubbed bronze/ Antique nickel
- Standard door thickness: 35-45mm
- Special door thickness: 45-55mm
- Suitable for: Wooden door and steel door



6608

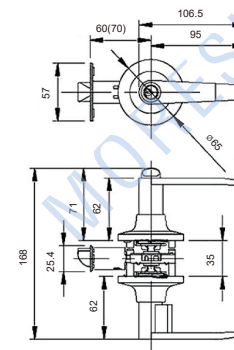

- Material: Zinc alloy/ Steel
- Function: Gate lock / Privacy lock / Passage lock / Single side lock
- Finish: Satin nickel/ Polished brass/ Antique brass/ Antique copper/ Satin chrome/ Chrome Plated / Oil rubbed bronze/ Antique nickel
- Standard door thickness: 35-45mm
- Special door thickness: 45-55mm
- Suitable for: Wooden door and steel door



6610

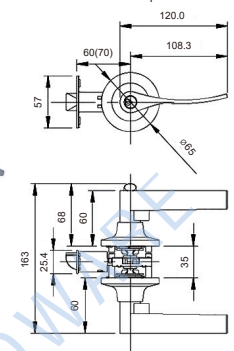

- Material: Zinc alloy/ Steel
- Function: Gate lock / Privacy lock / Passage lock / Single side lock
- Finish: Satin nickel/ Polished brass/ Antique brass/ Antique copper/ Satin chrome/ Chrome Plated / Oil rubbed bronze/ Antique nickel
- Standard door thickness: 35-45mm
- Special door thickness: 45-55mm
- Suitable for: Wooden door and steel door

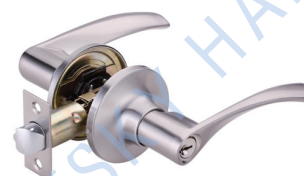

6611

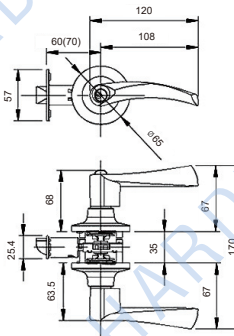

- Material: Zinc alloy/ Steel
- Function: Gate lock / Privacy lock / Passage lock / Single side lock
- Finish: Satin nickel/ Polished brass/ Antique brass/ Antique copper/ Satin chrome/ Chrome Plated / Oil rubbed bronze/ Antique nickel
- Standard door thickness: 35-45mm
- Special door thickness: 45-55mm
- Suitable for: Wooden door and steel door



6613

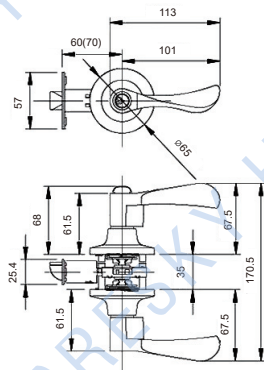

- Material: Zinc alloy/ Steel
- Function: Gate lock / Privacy lock / Passage lock / Single side lock
- Finish: Satin nickel/ Polished brass/ Antique brass/ Antique copper/ Satin chrome/ Chrome Plated / Oil rubbed bronze/ Antique nickel
- Standard door thickness: 35-45mm
- Special door thickness: 45-55mm
- Suitable for: Wooden door and steel door



6615

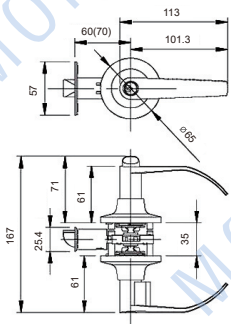

- Material: Zinc alloy/ Steel
- Function: Gate lock / Privacy lock / Passage lock / Single side lock
- Finish: Satin nickel/ Polished brass/ Antique brass/ Antique copper/ Satin chrome/ Chrome Plated / Oil rubbed bronze/ Antique nickel
- Standard door thickness: 35-45mm
- Special door thickness: 45-55mm
- Suitable for: Wooden door and steel door



6616

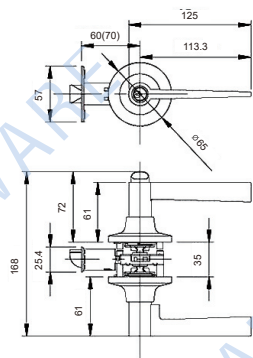

- Material: Zinc alloy/ Steel
- Function: Gate lock / Privacy lock / Passage lock / Single side lock
- Finish: Satin nickel/ Polished brass/ Antique brass/ Antique copper/ Satin chrome/ Chrome Plated / Oil rubbed bronze/ Antique nickel
- Standard door thickness: 35-45mm
- Special door thickness: 45-55mm
- Suitable for: Wooden door and steel door



6617

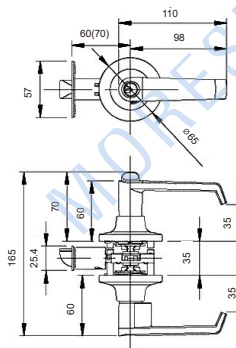

- Material: Zinc alloy/ Steel
- Function: Gate lock / Privacy lock / Passage lock / Single side lock
- Finish: Satin nickel/ Polished brass/ Antique brass/ Antique copper/ Satin chrome/ Chrome Plated / Oil rubbed bronze/ Antique nickel
- Standard door thickness: 35-45mm
- Special door thickness: 45-55mm
- Suitable for: Wooden door and steel door



6618

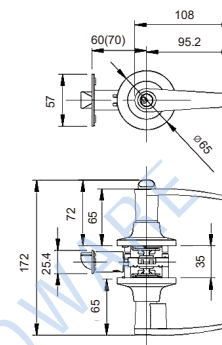

- Material: Zinc alloy/ Steel
- Function: Gate lock / Privacy lock / Passage lock / Single side lock
- Finish: Satin nickel/ Polished brass/ Antique brass/ Antique copper/ Satin chrome/ Chrome Plated / Oil rubbed bronze/ Antique nickel
- Standard door thickness: 35-45mm
- Special door thickness: 45-55mm
- Suitable for: Wooden door and steel door

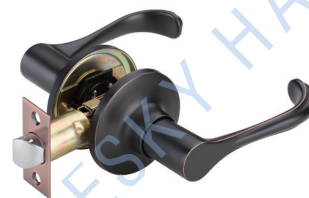

6619

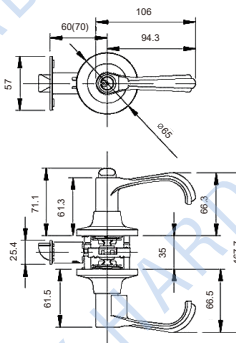

- Material: Zinc alloy/ Steel
- Function: Gate lock / Privacy lock / Passage lock / Single side lock
- Finish: Satin nickel/ Polished brass/ Antique brass/ Antique copper/ Satin chrome/ Chrome Plated / Oil rubbed bronze/ Antique nickel
- Standard door thickness: 35-45mm
- Special door thickness: 45-55mm
- Suitable for: Wooden door and steel door

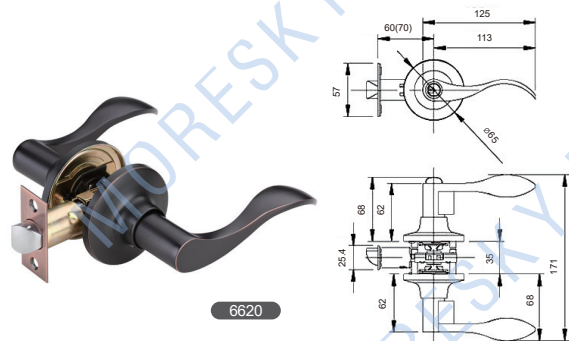

6620

- Material: Zinc alloy/ Steel
- Function: Gate lock / Privacy lock / Passage lock / Single side lock
- Finish: Satin nickel/ Polished brass/ Antique brass/ Antique copper/ Satin chrome/ Chrome Plated/ Oil rubbed bronze/ Antique nickel
- Standard door thickness: 35-45mm
- Special door thickness: 45-55mm
- Suitable for: Wooden door and steel door

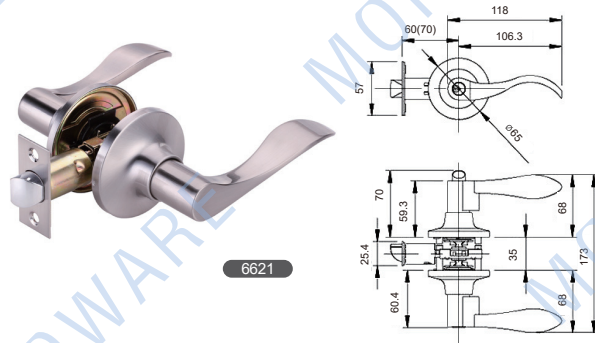

6621

- Material: Zinc alloy/ Steel
- Function: Gate lock / Privacy lock / Passage lock / Single side lock
- Finish: Satin nickel/ Polished brass/ Antique brass/ Antique copper/ Satin chrome/ Chrome Plated/ Oil rubbed bronze/ Antique nickel
- Standard door thickness: 35-45mm
- Special door thickness: 45-55mm
- Suitable for: Wooden door and steel door

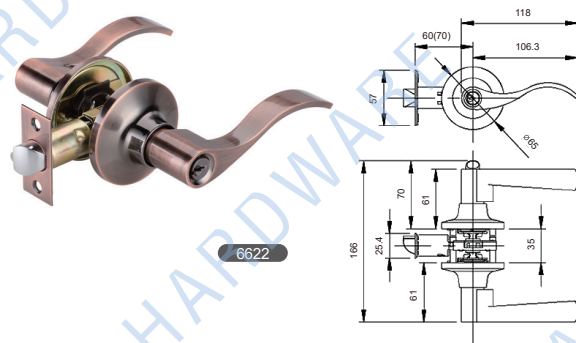

6622

- Material: Zinc alloy/ Steel
- Function: Gate lock / Privacy lock / Passage lock / Single side lock
- Finish: Satin nickel/ Polished brass/ Antique brass/ Antique copper/ Satin chrome/ Chrome Plated/ Oil rubbed bronze/ Antique nickel
- Standard door thickness: 35-45mm
- Special door thickness: 45-55mm
- Suitable for: Wooden door and steel door

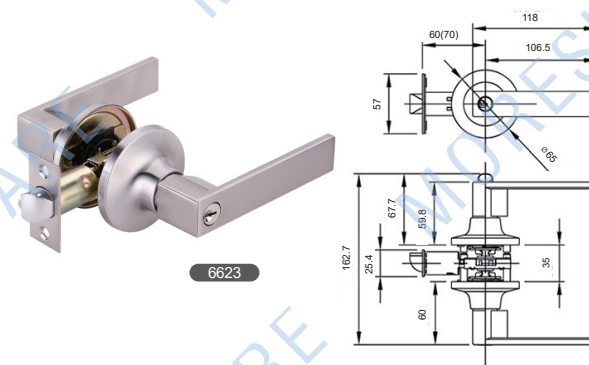

6623

- Material: Zinc alloy/ Steel
- Function: Gate lock / Privacy lock / Passage lock / Single side lock
- Finish: Satin nickel/ Polished brass/ Antique brass/ Antique copper/ Satin chrome/ Chrome Plated/ Oil rubbed bronze/ Antique nickel
- Standard door thickness: 35-45mm
- Special door thickness: 45-55mm
- Suitable for: Wooden door and steel door

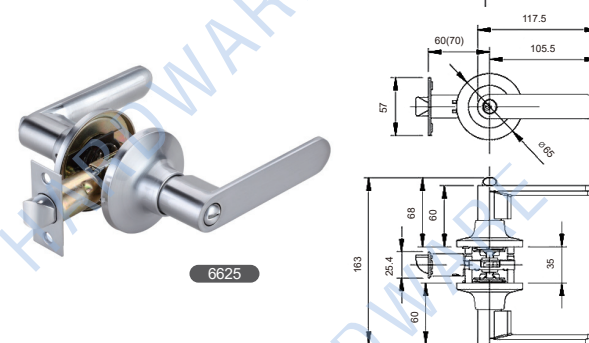

6625

- Material: Zinc alloy/ Steel
- Function: Gate lock / Privacy lock / Passage lock / Single side lock
- Finish: Satin nickel/ Polished brass/ Antique brass/ Antique copper/ Satin chrome/ Chrome Plated/ Oil rubbed bronze/ Antique nickel
- Standard door thickness: 35-45mm
- Special door thickness: 45-55mm
- Suitable for: Wooden door and steel door

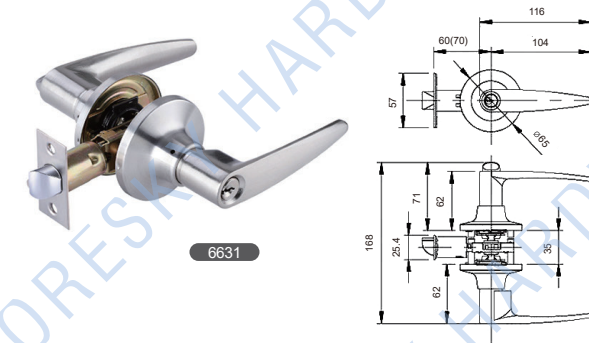

6631

- Material: Zinc alloy/ Steel
- Function: Gate lock / Privacy lock / Passage lock / Single side lock
- Finish: Satin nickel/ Polished brass/ Antique brass/ Antique copper/ Satin chrome/ Chrome Plated/ Oil rubbed bronze/ Antique nickel
- Standard door thickness: 35-45mm
- Special door thickness: 45-55mm
- Suitable for: Wooden door and steel door



## Cylindrical Lever Lock Series

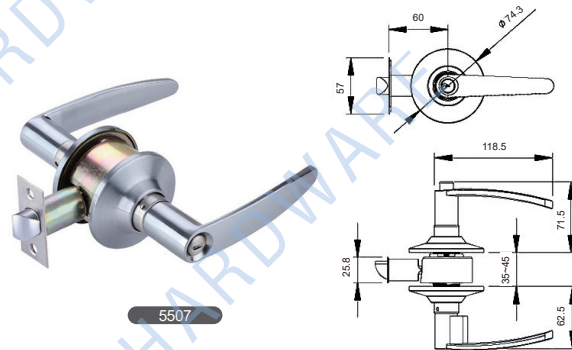

5507

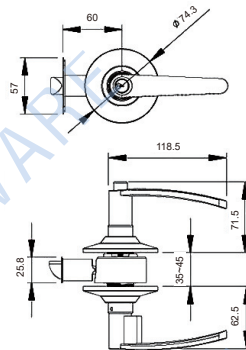

- Material: Zinc alloy/ Steel
- Function: Entrance / Privacy / Passage / Dummy
- Finish: Polished brass/ Antique brass/ Antique copper/ Satin nickel / Satin chrome/ Chrome Plated / Oil rubbed bronze / Antique nickel
- Standard door thickness: 35-45mm
- Special door thickness: 45-55mm
- Suitable for: Wooden door and steel door



5508

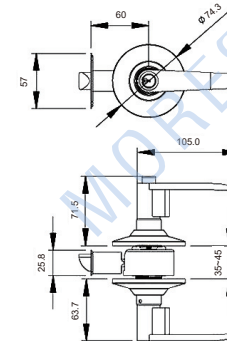

- Material: Zinc alloy/ Steel
- Function: Entrance / Privacy / Passage / Dummy
- Finish: Polished brass/ Antique brass/ Antique copper/ Satin nickel / Satin chrome/ Chrome Plated / Oil rubbed bronze / Antique nickel
- Standard door thickness: 35-45mm
- Special door thickness: 45-55mm
- Suitable for: Wooden door and steel door



5509

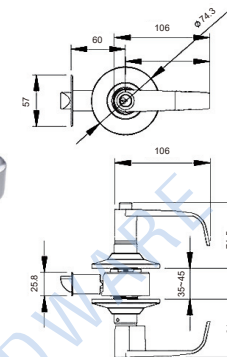

- Material: Zinc alloy/ Steel
- Function: Entrance / Privacy / Passage / Dummy
- Finish: Polished brass/ Antique brass/ Antique copper/ Satin nickel / Satin chrome/ Chrome Plated / Oil rubbed bronze / Antique nickel
- Standard door thickness: 35-45mm
- Special door thickness: 45-55mm
- Suitable for: Wooden door and steel door



5530

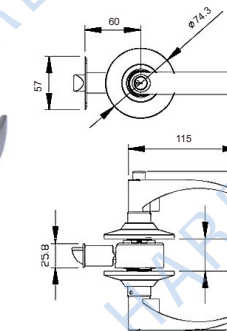

- Material: Zinc alloy/ Steel
- Function: Entrance / Privacy / Passage / Dummy
- Finish: Polished brass/ Antique brass/ Antique copper/ Satin nickel / Satin chrome/ Chrome Plated / Oil rubbed bronze / Antique nickel
- Standard door thickness: 35-45mm
- Special door thickness: 45-55mm
- Suitable for: Wooden door and steel door



# Auto-Release Lever Lock Series

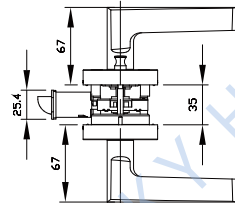
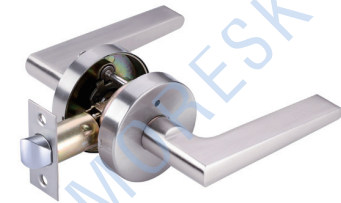

- Material: Zinc alloy
- Function: Privacy/ Passage/ Dummy
- Finish: Polished brass/ Antique brass / Antique copper / Satin nickel / Satin stainless steel/ Satin chrome / Chrome Plated / Oil rubbed bronze / Antique nickel
- Standard door thickness: 35-45mm
- Special door thickness: 45-55mm
- Suitable for: Wooden door and steel door

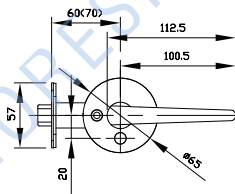

B9161

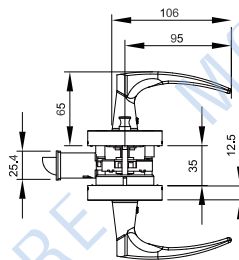

- Material: Zinc alloy
- Function: Privacy/ Passage/ Dummy
- Finish: Polished brass/ Antique brass / Antique copper / Satin nickel / Satin stainless steel/ Satin chrome / Chrome Plated / Oil rubbed bronze / Antique nickel
- Standard door thickness: 35-45mm
- Special door thickness: 45-55mm
- Suitable for: Wooden door and steel door

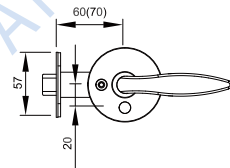

B9162

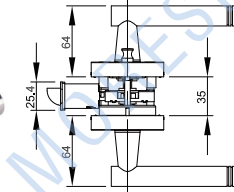

- Material: Zinc alloy
- Function: Privacy/ Passage/ Dummy
- Finish: Polished brass/ Antique brass / Antique copper / Satin nickel / Satin stainless steel/ Satin chrome / Chrome Plated / Oil rubbed bronze / Antique nickel
- Standard door thickness: 35-45mm
- Special door thickness: 45-55mm
- Suitable for: Wooden door and steel door

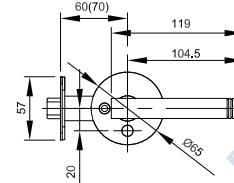
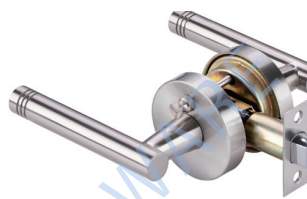

B9163

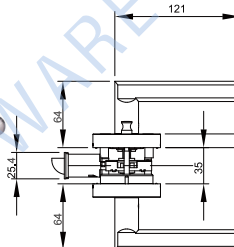
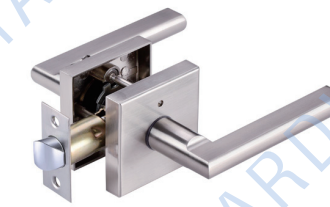

- Material: Zinc alloy
- Function: Privacy/ Passage/ Dummy
- Finish: Polished brass/ Antique brass / Antique copper / Satin nickel / Satin stainless steel/ Satin chrome / Chrome Plated / Oil rubbed bronze / Antique nickel
- Standard door thickness: 35-45mm
- Special door thickness: 45-55mm
- Suitable for: Wooden door and steel door

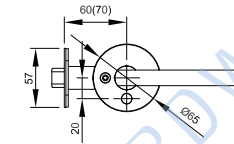
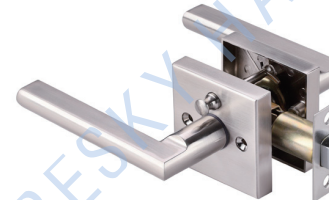

A9165