

0 100' 200'  
SCALE: 1" = 100'

- ★ Owner financing available
- ★ Cash - no owner financing
- ★ Owner financing available - Special rate doesn't apply - Check for available rate.

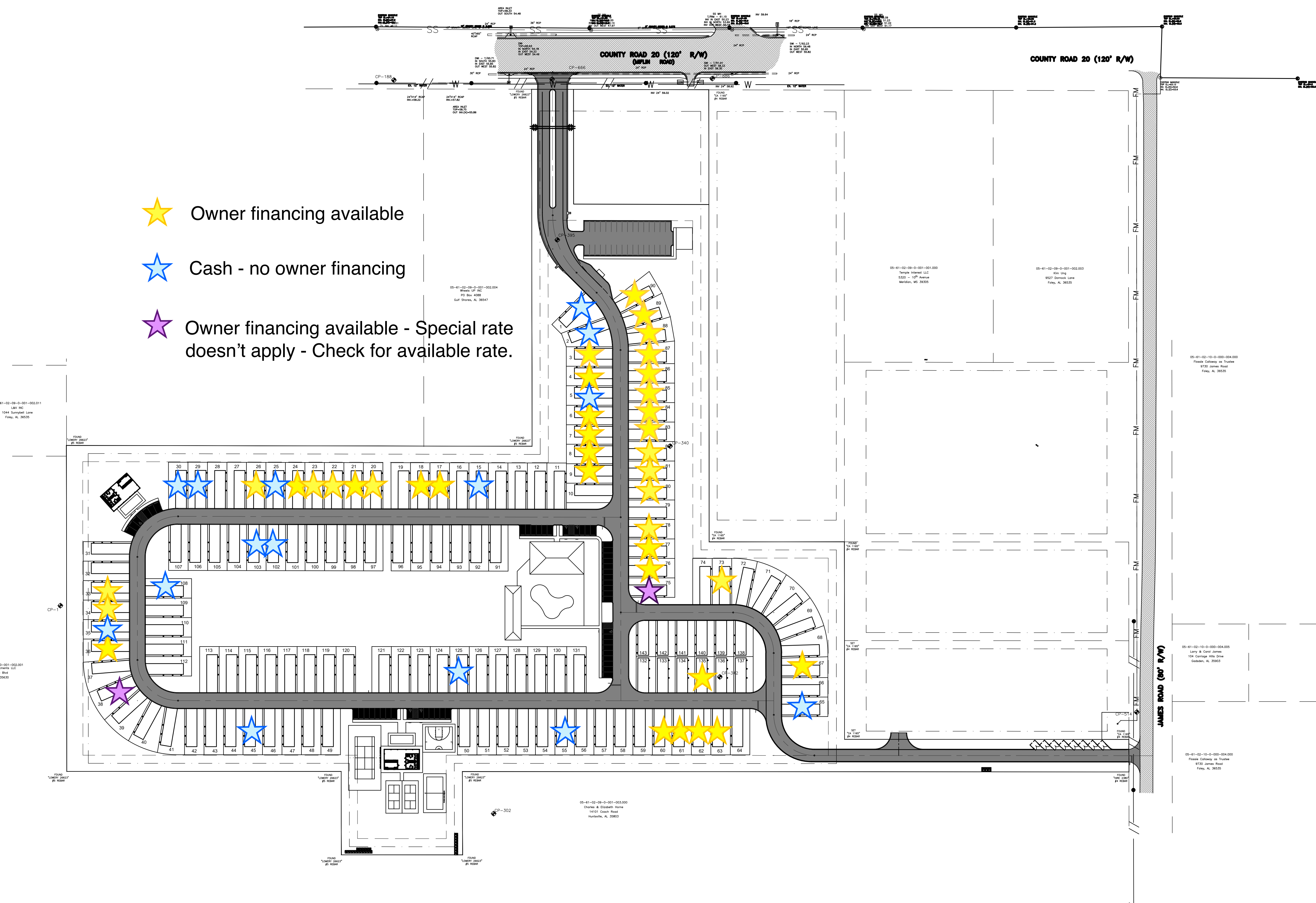

**NOTES:**

1. SEE SHEET C2.0 FOR ALL GENERAL NOTES.

**TOTAL SITE DATA:**

- |                                 |                             |
|---------------------------------|-----------------------------|
| 1. ZONING:                      | PUD                         |
| 2. LOT SIZE:                    | 25.29± AC. (1,101,749 S.F.) |
| 3. PERCENTAGE OF OPEN SPACE:    | 25%                         |
| 4. PROPOSED # OF PARKING SPOTS: | 180                         |
| 5. REQUIRED # OF PARKING SPOTS: | 126                         |

THE SITE IS LOCATED IN ZONE X PER THE LATEST FIRM PUBLISHED BY FEMA.

**ISSUED FOR REVIEW**

| REVISIONS |                      |         |
|-----------|----------------------|---------|
| A         | ISSUED FOR REVIEW    | 1/25/21 |
| B         | LOT RE-CONFIGURATION | 5/13/21 |
|           |                      |         |
|           |                      |         |
|           |                      |         |



LIEB ENGINEERING COMPANY  
1290 MAIN STREET, SUITE E  
DAPHNE, AL 36526  
PH: (251) 978-9779

NOT VALID WITHOUT THE DATED SIGNATURE AND SEAL OF AN ALABAMA LICENSED ENGINEER.  
ALABAMA LICENSED ENGINEER: CHRISTOPHER JAY LIEB, P.E. LICENSE NUMBER 31204  
ALABAMA CERTIFICATE OF AUTHORIZATION NUMBER: 4938

|             |              |           |         |
|-------------|--------------|-----------|---------|
| JOB NUMBER  | DRAWN BY:    | DATE:     | SCALE:  |
| 2019-048    | JLG          | 11/9/2020 | 1"=100' |
| CHECKED BY: | APPROVED BY: | ENGR:     |         |
| CJL         | CJL          | CJL       |         |

|                     |  |
|---------------------|--|
| GRAND RIVIERA       |  |
| OVERALL SITE PLAN   |  |
| FOLEY, AL           |  |
| OWNER: STACEY RYALS |  |
| SHEET NUMBER        |  |
| 3 OF 12             |  |



C3.0 B

5/13/2021