



0 100' 200'  
SCALE: 1" = 100'

-  Owner financing available
-  Cash - no owner financing
-  Owner financing available - Special rate doesn't apply - Check for available rate.

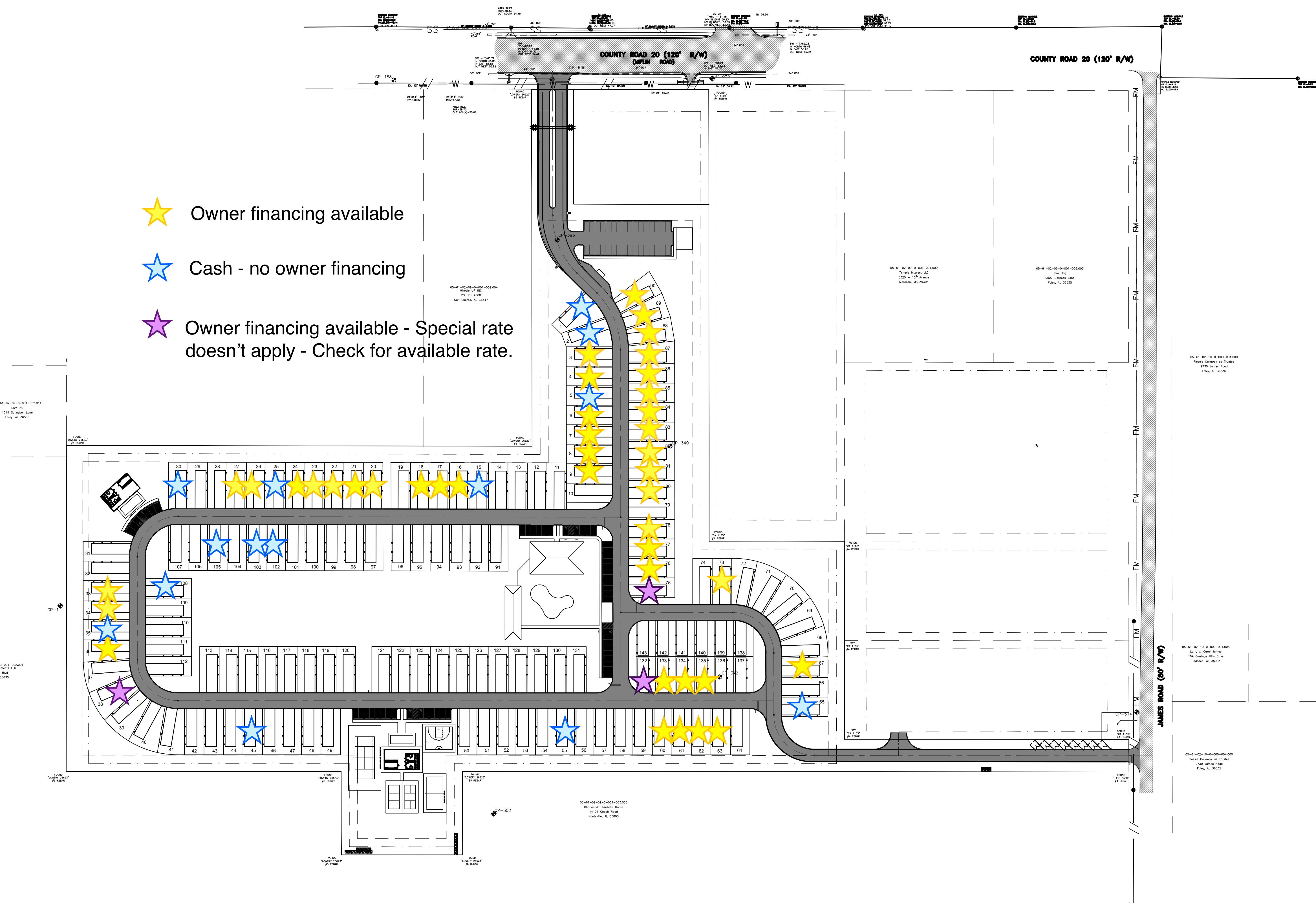

**NOTES:**

1. SEE SHEET C2.0 FOR ALL GENERAL NOTES.

**TOTAL SITE DATA:**

1. ZONING: PUD
2. LOT SIZE: 25.29± AC. (1,101,749 S.F.)
3. PERCENTAGE OF OPEN SPACE: 25%
4. PROPOSED # OF PARKING SPOTS: 180
5. REQUIRED # OF PARKING SPOTS: 126

THE SITE IS LOCATED IN ZONE X PER THE LATEST FIRM PUBLISHED BY FEMA.

ISSUED FOR REVIEW

REVISIONS			
A	ISSUED FOR REVIEW	1/25/21	
B	LOT RE-CONFIGURATION	5/13/21	



LIEB ENGINEERING COMPANY  
1290 MAIN STREET, SUITE E  
DAPHNE, AL 36526  
PH: (251) 978-9779

NOT VALID WITHOUT THE DATED SIGNATURE AND SEAL OF AN ALABAMA LICENSED ENGINEER.  
ALABAMA LICENSED ENGINEER: CHRISTOPHER JAY LIEB, P.E. LICENSE NUMBER 31204  
ALABAMA CERTIFICATE OF AUTHORIZATION NUMBER: 4938

JOB NUMBER: 2019-048  
DRAWN BY: JLG DATE: 11/9/2020 SCALE: 1"=100'  
CHECKED BY: CJL APPROVED BY: CJL ENGR: CJL

GRAND RIVIERA  
OVERALL SITE PLAN  
FOLEY, AL  
OWNER: STACEY RYALS

SHEET NUMBER: 3 OF 12

C3.0 B

5/13/2021

