

# NXG SOLUTIONS

**ONE STOP | INNOVATIVE SOLUTIONS FOR NEXT-GENERATION...**

## **NXG: BEHIND MIRROR SMART RESTROOM SERIES**

High quality units for integration behind the mirror for super efficient use of space and minimalistic look - elevate your restrooms with an all-in-one solution for modern needs. All accessories are #304 stainless steel grade, to provide durable & secure usage at demanding public amenities, stylish, enhance the ambiance of the application area and suitable for all high traffic areas. Easy installation and simple maintenance & refill.

Maximizes LEED Rating.

- Vandal Proof
- Smart Space Savings
- Essential for Green Buildings: Lesser carbon footprint as compared to regular products



## NXG: WASH STATIONS {BEHIND MIRROR}

### NXG-WS-2 (Hand Dryer, Soap Dispenser & Paper Dispenser)

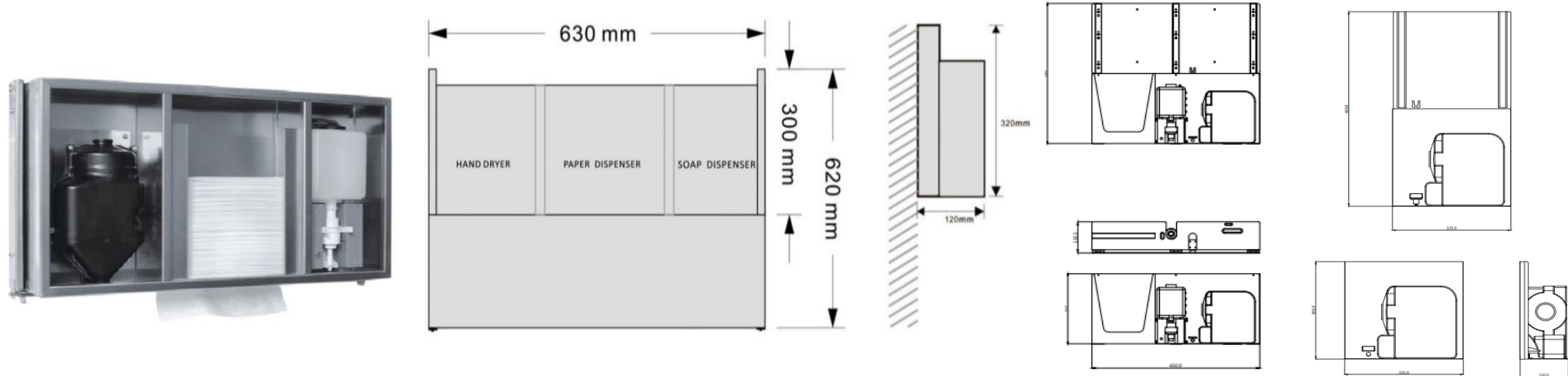

#### TECHNICAL PARAMETERS: WS-2 (Three in One Combination)

**Body Material:** SS 304 with Both Sided Pulldown Sliding Rail & Bottom Snap Lock System

**Voltage:** AC220-240V

**Frequency:** 50/60Hz

**Rated Power:** 1000 W

**Drying Time:** 18-20sec

**Noise Level In Db(at 1m):** 70

**Capacity:** Soap-1000 ml / Paper-300-400 Napkins

**Water Splash Proof:** IPX1

**\*Soap Dispenser LED Indicator—Red for work and twinkling for Low Battery**

## NXG-WS-3 PAPER DISPENSER WITH AUTOMATIC SENSOR SOAP DISPENSER

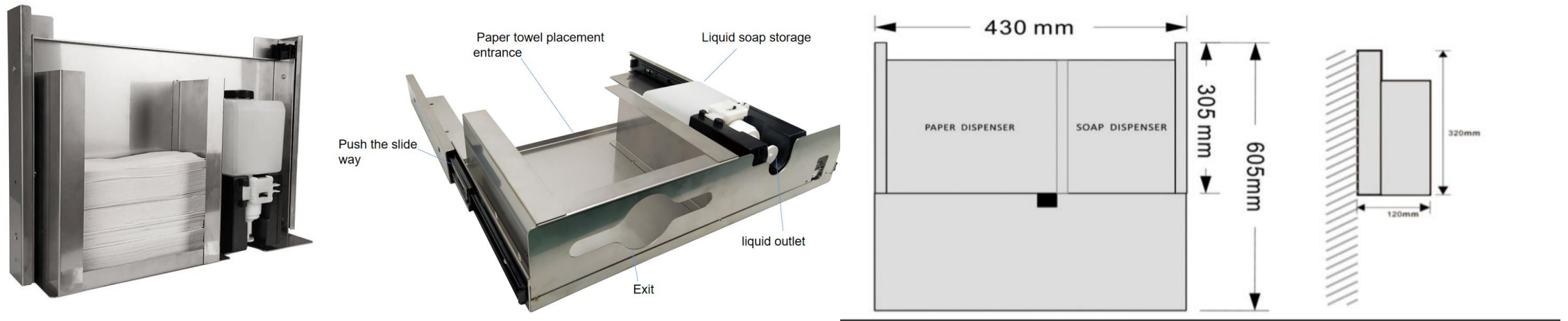

### TECHNICAL PARAMETERS: WS-3 (Two in One Combination)

**Body Material:** SS 304 with Both Sided Pulldown Sliding Rail & Bottom Snap Lock System

**Power Supply Mode:** Power Adapter/4 AA Batteries

**Capacity:** Soap-1000 ml / Paper-300-400 Napkins

**\*Soap Dispenser LED Indicator—Red for work and twinkling for Low Battery**

## NXG - BEHIND MIRROR-PAPER AND AUTOMATIC SENSOR SOAP DISPENSER

### Behind Mirror Cabinet Manual SS Paper Towel Dispenser

NXG-BMP (BIG)



485mm  
120mm  
310mm

NXG-BMP (SMALL)



190mm  
90mm  
268mm

1. 201 or 304 Stainless Steel (choose-options)
2. Holds N/Z-fold Paper Napkins - Capacity: 300 or 700 Sheets
3. Easy to fill/install with mounting holes
4. Special paper outlet design to avoid wastage

### Behind Mirror Cabinet HDPE Auto-Soap Dispenser

NXG-BMS (AUTO)

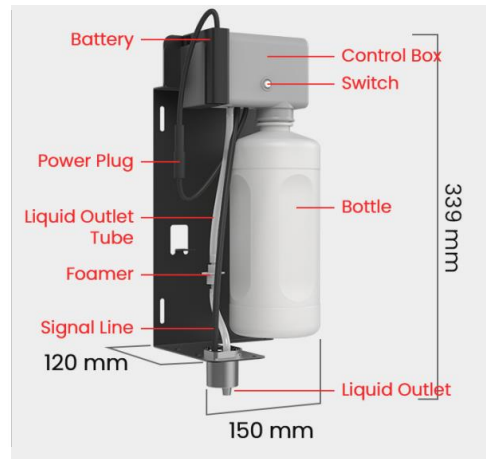

1. 304 Stainless Steel Backplate – HDPE Translucent Bottle
2. Capacity: 1000ML (High Traffic)
3. Dual Mode Operations (AC or DC with extra cost )
4. Three Level Adjustments for Soap Volumes (0.2,0.4,0.6 ml)
5. Easy to fill / install with mounting holes

# NXG SOLUTIONS

ONE STOP | INNOVATIVE SOLUTIONS FOR NEXT-GENERATION....



## Team of Professional/Skilled Members:-

Committed with Our Company's Philosophy of "Embracing Innovations + Sustainable Environment".  
Abide by The Enterprise Spirit of "Focusing on The Intelligence + Excellent Quality & Caring Services".

Best Regards With An Anticipations Of Healthy Associations

NXG SOLUTIONS ([www.nxgs.in](http://www.nxgs.in))

HO: C2C/2/55 ; ANAK PURI , NEW DELHI - 110058 (INDIA) OPP. ORCHID HOSPITAL

\* Paras Malhotra (Founder-Creative Director) M: +91-9999342223 E: [paras@nxgs.in](mailto:paras@nxgs.in)

\* Kamal Malhotra (Consulting Director-Projects) M: +91-9911897731 E: [kamal@nxgs.in](mailto:kamal@nxgs.in)

**\* Let's Go-Green.....**

