

PLANNING APPROVAL _____
REGISTRATION _____

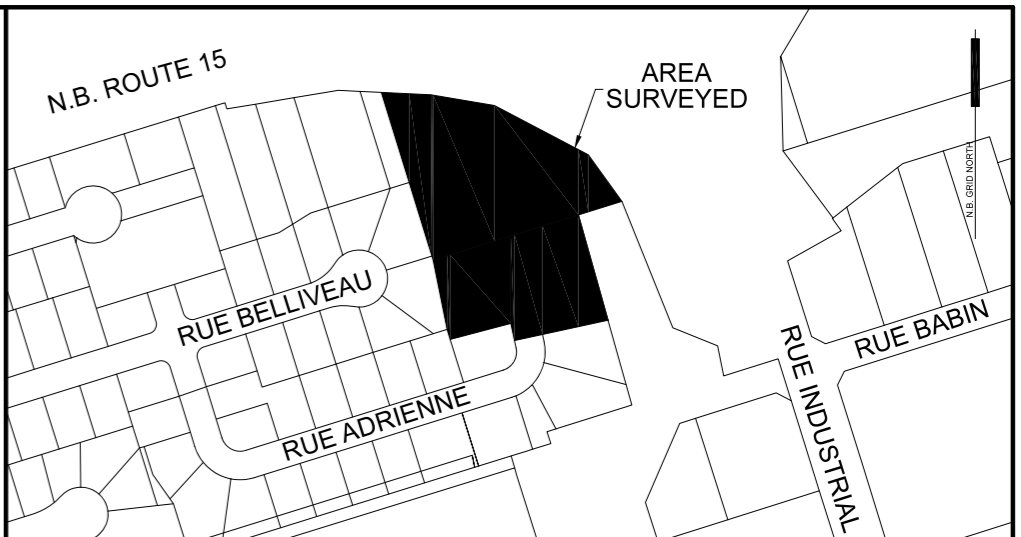

LOCATION MAP
NOT TO SCALE

LEGEND:

LAND DEALT WITH BY THIS PLAN SHOWN THUS _____

UTILITY EASEMENT _____

STANDARD SURVEY MARKER PLACED (SMPL) _____

STANDARD SURVEY MARKER FOUND (SMFD) _____

CALCULATED COORDINATE POINT _____

IRON PIPE FOUND _____

TABULATED COORDINATE REFERENCE _____

PROPERTY IDENTIFICATION NUMBER _____

REGISTRATION _____

DOCUMENT _____

- NOTES:**
- ALL COMPUTATIONS PERFORMED AND COORDINATES SHOWN ON THIS PLAN ARE BASED ON THE NEW BRUNSWICK STEREOGRAPHIC DOUBLE PROJECTION AND THE NAD83 (CSRS) ELLIPSOID AS REALIZED BY SERVICE NEW BRUNSWICK'S ACTIVE CONTROL SYSTEM
 - ALL DISTANCES SHOWN ARE GRID DISTANCES CALCULATED USING A COMBINED SCALE FACTOR UTILIZING GEOID MODEL HT2.0.
 - DIRECTIONS ARE N.B. GRID AZIMUTHS ESTABLISHED USING GNSS.
 - CERTIFICATIONS IS NOT MADE AS TO LEGAL TITLE, NOR TO ZONING.
 - THE PLAN NUMBERS AND DOCUMENT NUMBERS REFERENCED TO ON THIS PLAN ARE THOSE OF THE COUNTY REGISTRY OFFICE.
 - FIELD SURVEY WAS COMPLETED ON NOVEMBER 17, 2021.

PURPOSE OF PLAN

- TO AMEND LOT 18-1000, PLAN 37834968
- TO AMEND PARCEL E, PLAN 37734887
- TO AMEND TEMPORARY TURN-AROUND, PLAN XXXXXXXX
- TO CREATE LOTS 24-21 TO 24-30 FOR RESIDENTIAL BUILDING PURPOSES.
- TO CREATE A PORTION OF RUELLE ADRIENNE COURT 18.00m WIDE (PUBLIC), PURSUANT TO SECTION 88(6)(a) OF THE COMMUNITY PLANNING ACT, 2017
- TO CREATE PUBLIC UTILITY EASEMENT SHOWN, PURSUANT TO SECTION 5, DESIGNATED EASEMENT REGULATION 84-217, OF THE COMMUNITY PLANNING ACT, 2017.

N.B. GRID NAD83 (CSRS)

POINT	NORTHING	EASTING	DESC.
15	7457506.387	2636624.231	SMFD
104	7457654.175	2636614.057	SMFD
105	7457647.433	2636654.147	SMFD
106	7457616.386	2636713.157	SMFD
107	7457587.049	2636734.357	SMFD
133	7457549.958	2636615.491	SMFD
152	7457500.004	2636626.223	SMFD
155	7457510.089	2636664.389	SMFD
159	7457512.170	2636725.561	SMFD
160	7457503.193	2636684.311	SMFD
167	7457499.385	2636666.723	SMFD
171	7457526.644	2636679.208	SMPL
172	7457535.318	2636719.062	SMPL
173	7457558.465	2636712.563	SMPL
174	7457550.129	2636674.260	SMPL
175	7457560.204	2636675.052	CALC
176	7457565.874	2636677.112	CALC
177	7457571.865	2636678.888	SMPL
178	7457589.718	2636671.538	SMPL
179	7457593.810	2636658.437	SMPL
180	7457588.263	2636645.892	SMPL
181	7457616.675	2636594.851	SMPL
182	7457576.775	2636640.198	SMPL
183	7457571.670	2636608.773	SMPL
184	7457543.181	2636657.111	CALC
185	7457556.161	2636650.370	SMPL
186	7457548.628	2636615.756	SMPL
187	7457525.094	2636620.478	SMPL
188	7457533.540	2636659.286	SMPL
189	7457559.340	2636647.087	CALC
190	7457574.341	2636659.546	RAD PT
191	7457552.848	2636704.136	RAD PT
192	7457536.262	2636627.920	RAD PT
305	7457655.671	2636582.789	SMFD
704	7457578.493	2636706.939	SMFD
28155	7456492.126	2628800.998	MON

CURVE TABLE

CURVE	RADIUS	ARC LENGTH	CHORD LENGTH	CHORD AZIMUTH	RADIUS POINT
C12	30.000	14.776	14.627	332°33'21"	192
C13	30.000	4.574	4.570	314°04'41"	192
C14	19.500	19.555	18.746	158°26'20"	190
C15	19.500	13.065	12.822	206°21'43"	190
C16	19.500	13.870	13.580	245°56'00"	190
C17	19.500	14.171	13.862	287°07'50"	190
C18	19.500	20.197	19.307	337°37'21"	190
C19	19.500	6.276	6.249	16°30'53"	190
C20	30.000	16.198	16.001	190°16'01"	191
C21	30.000	3.706	3.703	171°15'39"	191



6 TRITES ROAD
RIVERVIEW, NB
(506) 857 0022

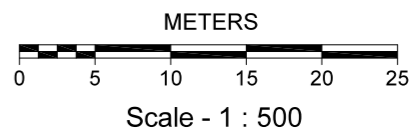

TENTATIVE SUBDIVISION PLAN
VILLA DIEPPE
SUBDIVISION
UNIT 21, PHASE 2

AMENDING SUBDIVISION PLANS 37834968, 37734887, XXXXXXXX
NORTH END OF RUE ADRIELLE
CITY OF DIEPPE
PARISH OF MONCTON
COUNTY OF WESTMORLAND
PROVINCE OF NEW BRUNSWICK

PROPERTY INFORMATION:

PID 70636253
REGISTERED OWNER: DM DÉVELOPPEMENTS DEVELOPPEMENTS LTÉE/LTD.
LAND TITLES: 2018-03-06
DOC. 43958504
REGISTERED: 2023-06-16
PARCEL C, PLAN 37834968

PID 70635362
REGISTERED OWNER: DM DÉVELOPPEMENTS DEVELOPPEMENTS LTÉE/LTD.
LAND TITLES: 2018-01-19
DOC. 43958504
REGISTERED: 2023-06-16
PARCEL C, PLAN 37734887

PID XXXXXXXX
REGISTERED OWNER: XXXXXXXX
LAND TITLES: XXXXXXXX
DOC. XXXXXXXXXX
REGISTERED: XXXXXXXX
LOT XXXXXXXX, PLAN XXXXXXXX

OWNER'S STATEMENT:

I (WE), THE UNDERSIGNED, DO HEREBY CERTIFY THAT I (WE) AM (ARE) THE REGISTERED OWNER(S) OF THE PROPERTY(IES) BEING SUBDIVIDED HERON AND DO HEREBY GRANT APPROVAL TO THIS PLAN, AS OUR INTERESTS APPEAR.

SURVEYOR'S STATEMENT

I, THE UNDERSIGNED, DO HEREBY CERTIFY THAT THIS PLAN IS CORRECT, TO THE BEST OF MY KNOWLEDGE AND BELIEFS.

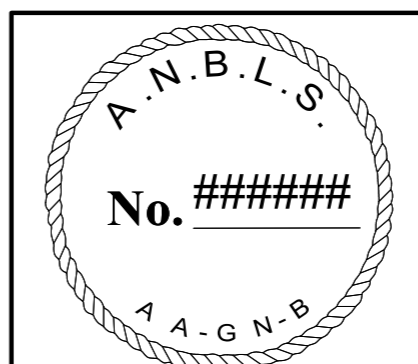

SURVEYED BY JARET T. GUIMOND, N.B.L.S. #387

COPYRIGHT PROTECTED

REV.	Revision:	Job No. ##-###
0	Date: ???# ##, 202#	Initials: ??? /???
	File: #####SD	