

① Distance Between Jetty (EST) - Present Conditions  
 NOT to Scale

NOTE  
 NO OSPREY POLES WERE OBSERVED  
 WITHIN 500-FT OF THE SITE

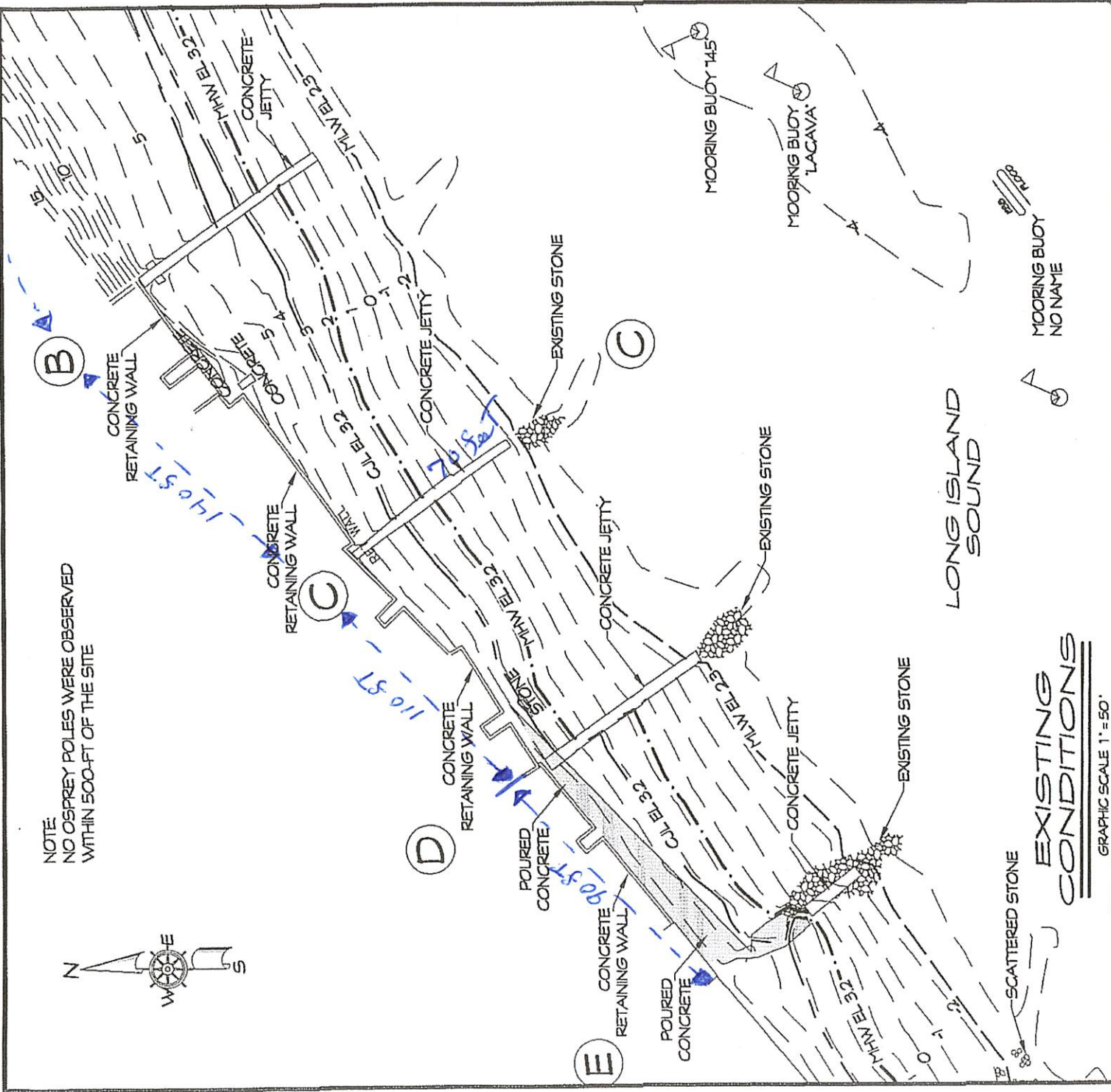

EXISTING  
 CONDITIONS

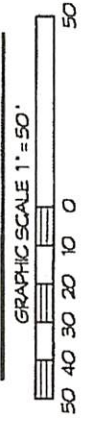

**DRAFT**  
**DR 9-3-21**

PROJECT: GROINS RESTORATION

LOCATION: CHAPMAN BEACH - TOWN OF WESTBROOK  
 MIDDLESEX COUNTY, CONNECTICUT  
 WATERWAY: LONG ISLAND SOUND  
 DATE: SEPTEMBER 2, 2021  
 APPLICANT: CHAPMAN BEACH ASSOC.

AGENT: SHEET 2 OF 4  
**DOCKO, INC.**  
 Keith B. Neilson, PE  
 Mystic, CT 06355  
 860 572 8939 FAX 860 572 7569  
 EMAIL: office@docko.com

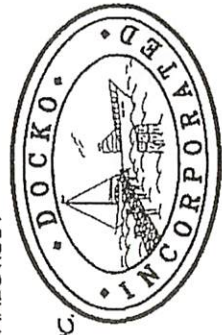

DWG 21-07-3189

② Distances Between Jetty (EST) if Jetty C is Decommissioned  
 NOT to scale

① Distances Between Jetty (EST) if Jetty C is Decommissioned  
 NOT to scale

NOTE:  
 NO OSPREY POLES WERE OBSERVED  
 WITHIN 500-FT OF THE SITE

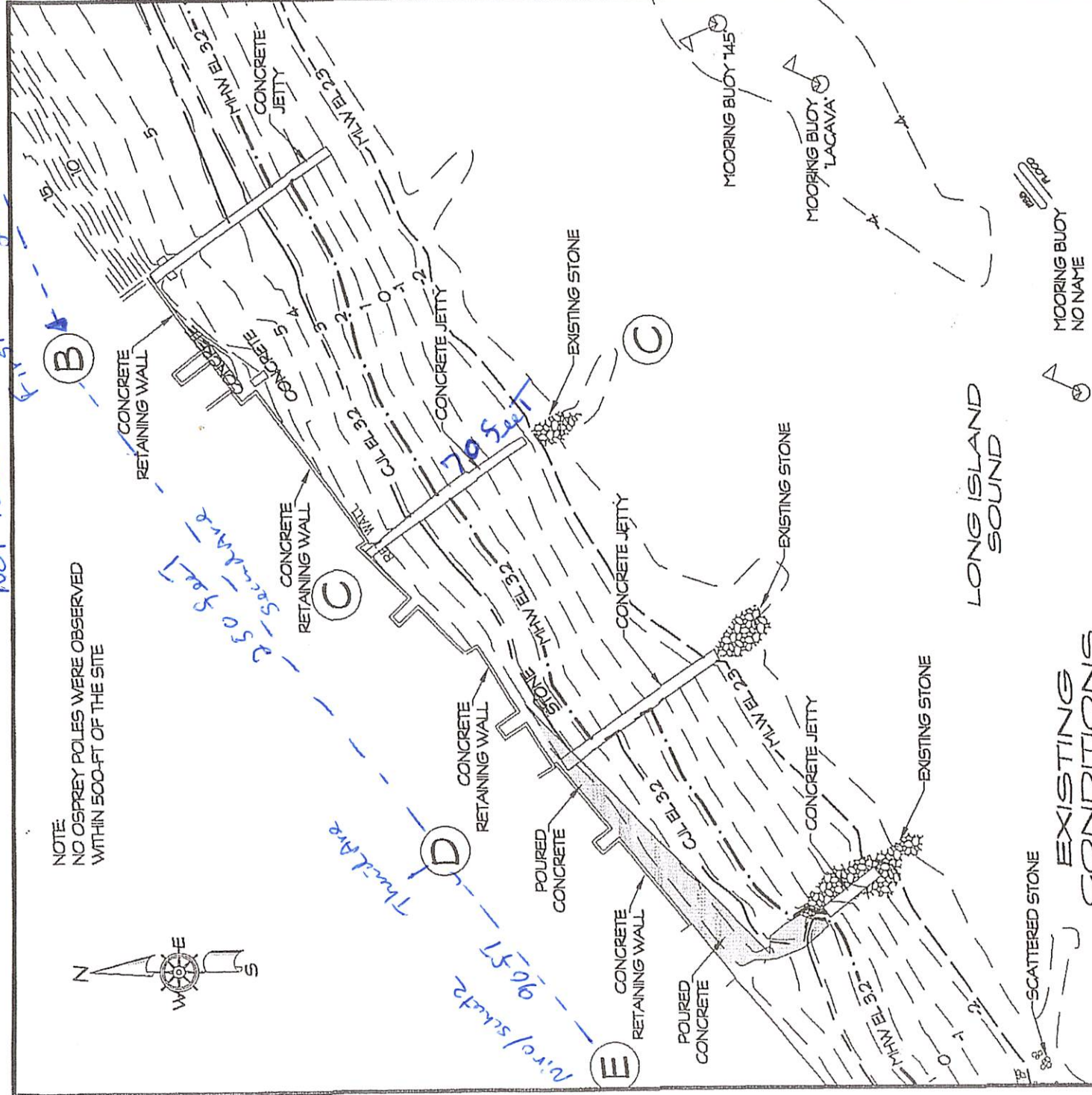
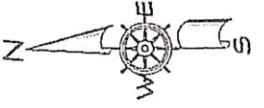

LONG ISLAND SOUND

EXISTING CONDITIONS

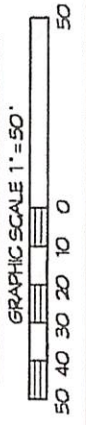

MOORING BUOY  
 NO NAME

**DRAFT**  
**DR 9-3-21**

PROJECT: GROINS RESTORATION

LOCATION: CHAPMAN BEACH - TOWN OF WESTBROOK  
 MIDDLESEX COUNTY, CONNECTICUT  
 WATERWAY: LONG ISLAND SOUND  
 DATE: SEPTEMBER 2, 2021  
 APPLICANT: CHAPMAN BEACH ASSOC.

AGENT: SHEET 2 OF 4  
**DOCKO, INC.**  
 Keith B. Neilson, PE  
 Mystic, CT 06355  
 860 572 6939 FAX 860 572 7569  
 EMAIL: office@docko.com



DWG 21-07-3189

③ Lengths of Jetty B, D, E  
 is DEEP will allow Tridle off of 70 set from Jetty C, Add 20 set

NOTE:  
 NO OSPREY POLES WERE OBSERVED  
 WITHIN 500-FT OF THE SITE

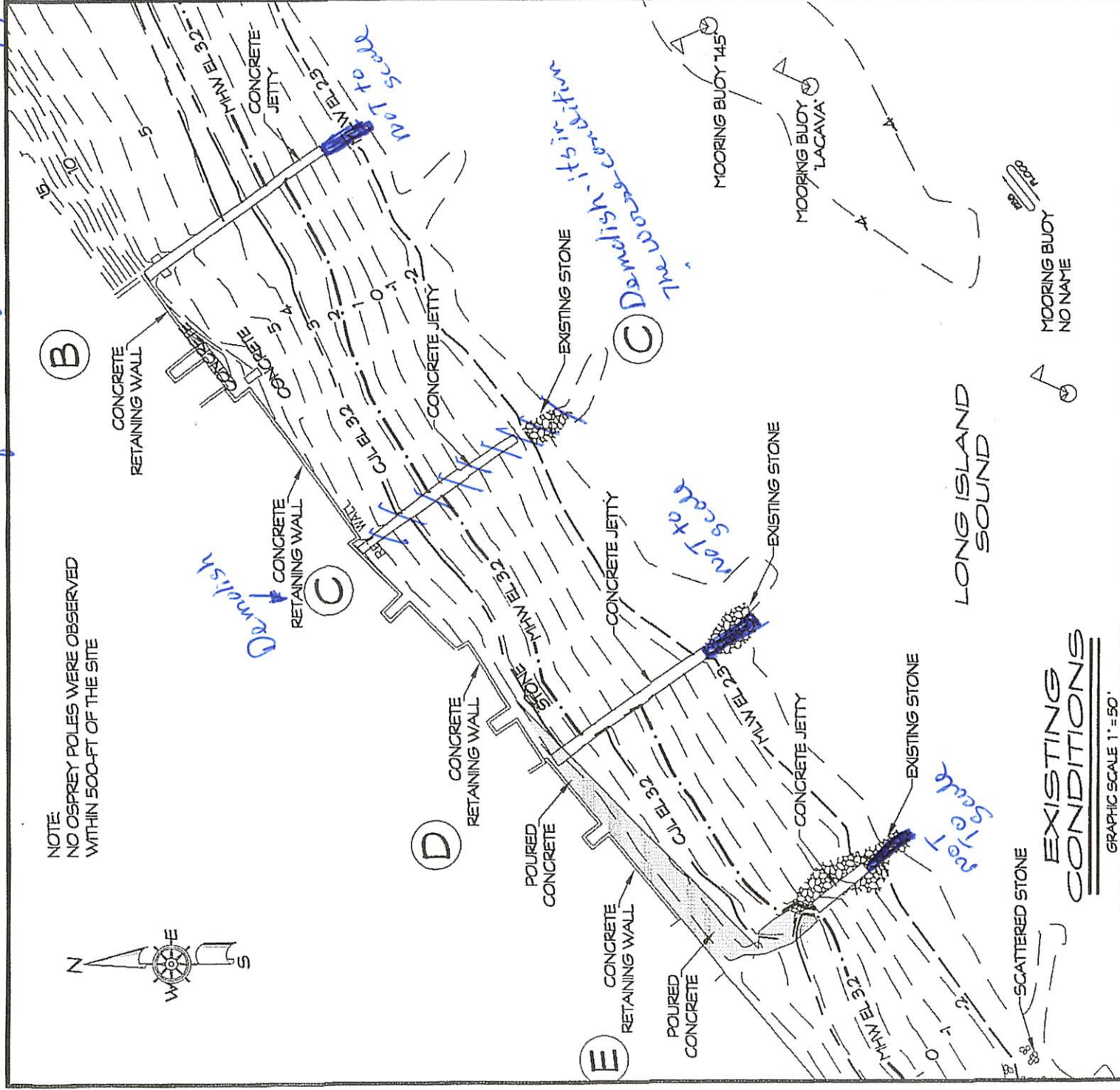
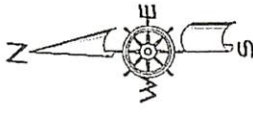

EXISTING  
 CONDITIONS

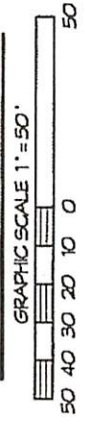

LONG ISLAND  
 SOUND

MOORING BUOY  
 NO NAME

**DRAFT**  
**DR 9-3-21**

PROJECT: GROINS RESTORATION

LOCATION: CHAPMAN BEACH - TOWN OF WESTBROOK  
 MIDDLESEX COUNTY, CONNECTICUT  
 WATERWAY: LONG ISLAND SOUND  
 DATE: SEPTEMBER 2, 2021  
 APPLICANT: CHAPMAN BEACH ASSOC.

AGENT: SHEET 2 OF 4  
**DOCKO, INC.**  
 Keith B. Neilson, PE  
 Mystic, CT 06355

860 572 8939 FAX 860 572 7569  
 EMAIL: office@docko.com

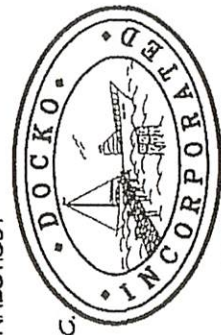

DWG 21-07-3189