



# 1922 | COMMERCIAL FURNITURE CO<sup>®</sup>

PROJECT PORTFOLIO

1922 | COMMERCIAL FURNITURE CO<sup>®</sup>

STORE FEATURING HOSPITALITY FURNITURE  
CUSTOM MILLWORK DESIGN

1 DRAWER NIGHTSTAND  
30" W X 16" D X 28" T

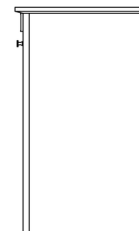
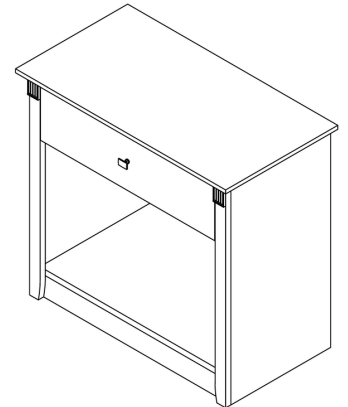
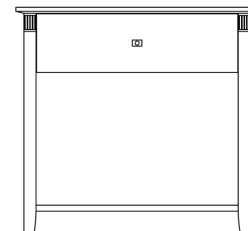

# FOREST, VIRGINIA





F O R E S T , V I R G I N I A



F O R E S T , V I R G I N I A

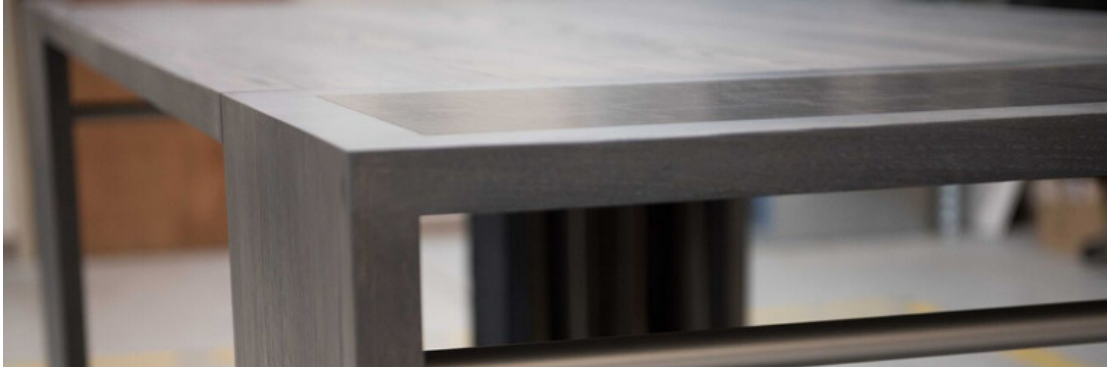



F O R E S T , V I R G I N I A



# MYRTLE BEACH, SOUTH CAROLINA





MYRTLE BEACH, SOUTH CAROLINA

# CONTRACT PROCUREMENT SOLUTIONS

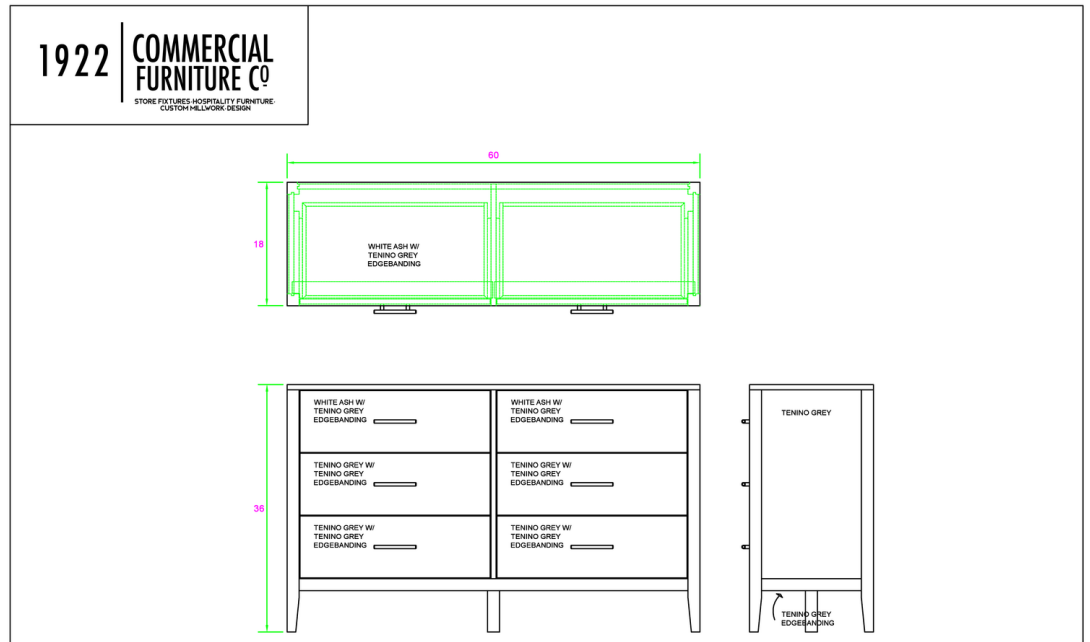

# MIAMI, FLORIDA





MIAMI, FLORIDA

# SOUTHERN HOSPITALITY



**HOLLOMAN,  
NEW MEXICO**





# HOLLOMAN, NEW MEXICO

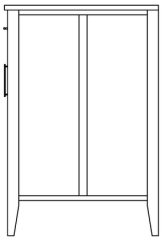
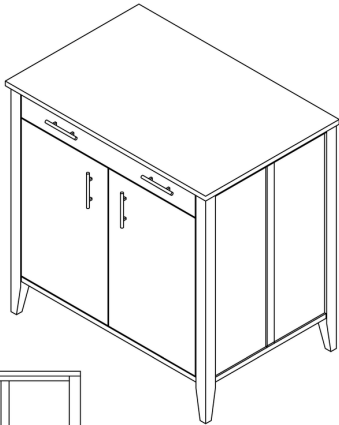

TUSCON, ARIZONA





AMHERST, VIRGINIA

# 1922 COMMERCIAL

OUR PROCESS



A M H E R S T , V I R G I N I A

# 1922 COMMERCIAL





**HOSPITALITY FURNITURE & CUSTOM  
WOODWORK BY**

---

**1922 | COMMERCIAL  
FURNITURE CO**

---

W: [1922COMMERCIAL.COM](http://1922COMMERCIAL.COM)  
E: [SALES@1922COMMERCIAL.COM](mailto:SALES@1922COMMERCIAL.COM)  
P: 434-381-1005