

Connect Wallet

Setup Guide

A quick reference for setting up your wallet securely and correctly.

Estimated time 2–3 minutes	What you need A secure place to store your 12-word phrase	Important Do not share your recovery phrase or reuse your account password
--------------------------------------	---	--

Step 1: Start Wallet Setup

Click the “Begin Wallet Setup” button to launch the setup process. The opening screen explains the wallet benefits, including rewards access, security, and fast transactions.

- Review the intro screen before continuing.
- Select “Begin Wallet Setup” to move into wallet creation.

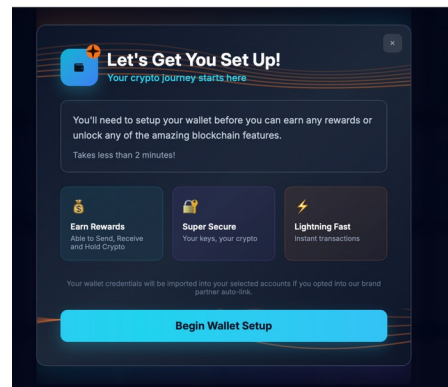

Screen example

Step 2: Create Your Wallet Passcode

Create a strong wallet passcode. This passcode is used to access and approve transactions in your Connect Wallet.

- Use at least 8 characters.
- Include 1 uppercase letter, 1 lowercase letter, 1 number, and 1 symbol.
- Do not use spaces.
- Do not make your wallet passcode the same as your account password.

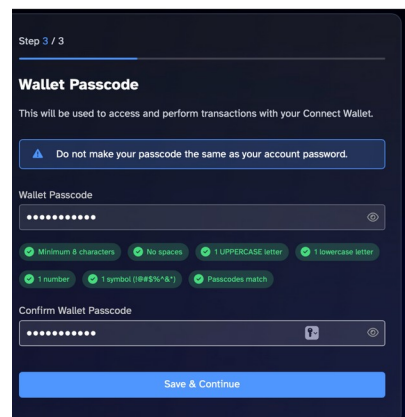

Screen example

Step 3: Secure Your 12-Word Recovery Phrase

Your 12-word recovery phrase is the key to your wallet. Store it in a safe, offline location. It is the only way to recover your wallet if you forget your passcode.

- Write the words down in the exact order shown.
- Store the phrase somewhere private and secure.
- Do not save it where others can access it.

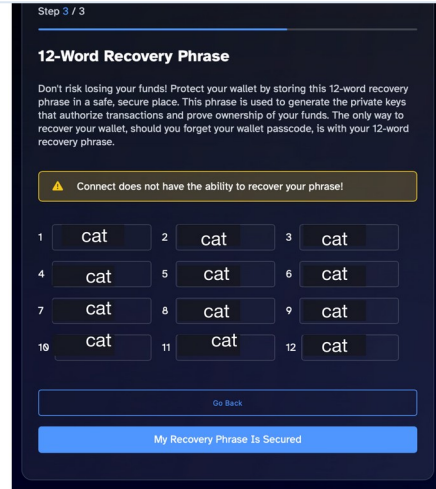

Screen example

Step 4: Confirm Your Recovery Phrase

Complete the confirmation screen by entering the 12 words in the same order they were originally presented. This step verifies that your phrase has been saved correctly.

- Enter each word in the correct numbered box.
- Read the warning message carefully before confirming.
- Only continue once you are sure your phrase is stored safely.

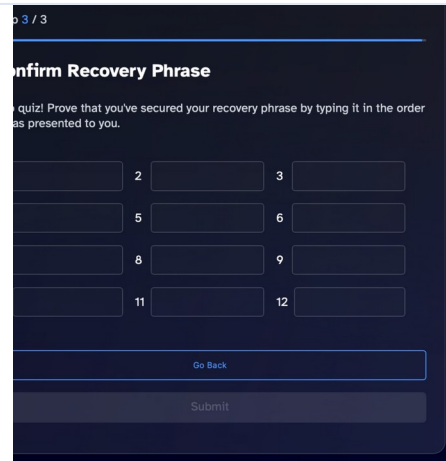

Screen example

Step 5: Finish Setup

Once the phrase is confirmed, the wallet setup is complete. You will see a confirmation message letting you know your wallet is ready.

- Select "Save And Continue" to finish.
- Your Connect Wallet is now ready to use.

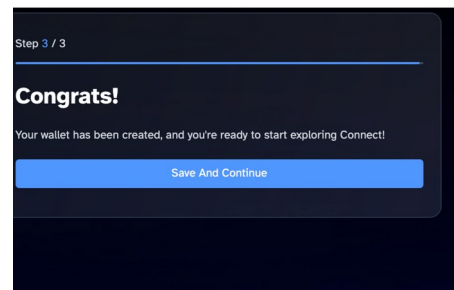

Screen example

Security Checklist

<input type="checkbox"/>	I wrote down my 12-word recovery phrase in the correct order.
<input type="checkbox"/>	I stored my recovery phrase in a safe location.
<input type="checkbox"/>	I created a wallet passcode that is different from my account password.
<input type="checkbox"/>	I completed setup and reached the final confirmation screen.

Important Reminder

If you lose your recovery phrase, you may lose access to your wallet. Keep it private, store it securely, and never share it with anyone.

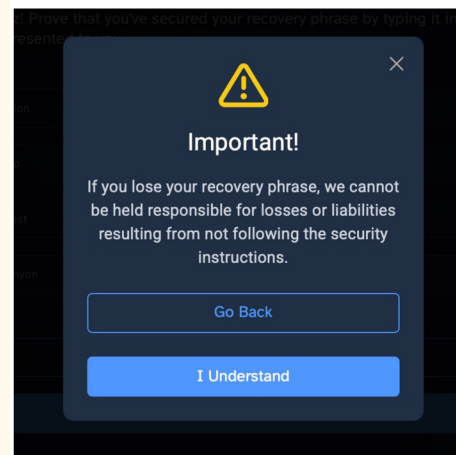

Keep your recovery phrase private. Anyone with access to it may be able to access your wallet.