

INSTRUCTIONS

FLUSHER FIXIT*

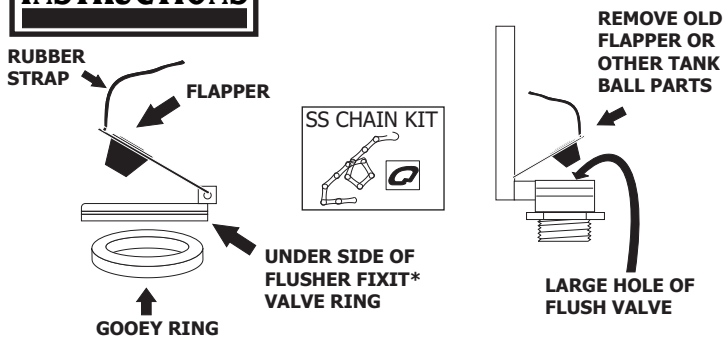

OUTSIDE OF TOILET

1. SHUT OFF WATER SUPPLY TO TOILET, THEN FLUSH AND DRAIN TANK
 2. CHECK GOOEY RING:
 - a. IF NOT PREASSEMBLED IN PACKAGE, REMOVE ONE PAPER SHEET FROM THE GOOEY RING AND MOUNT IT TO THE UNDERSIDE OF THE FLUSHER FIXIT VALVE RING.
- NOTE: A CONTINUOUS UNINTERRUPTED 360° CONTACT IS NEEDED**
3. CONNECT THE LIFT STRAP OF CHAIN TO THE FLAPPER TANK BALL.
 - a. FOR RUBBER STRAPS: REMOVE STRAP FROM FLAPPER, LOOP IT THROUGH THE FRONT HOLE ON FLAPPER AND THEN BACK THROUGH THE STRAP HOLE LIKE A NOOSE.
 - b. FOR MODELS WITH OPTIONAL CHAIN KIT: REMOVE STRAP FROM FLAPPER, INSTALL CHAIN TO PLASTIC ADAPTER AND THE ADAPTER TO THE FLAPPER.

OUTSIDE OF TOILET

1. REMOVE OLD TANK BALL ASSEMBLY (OR FLAPPER), AND ANY LIFT WIRES AND GUIDES.
2. CLEAN AND REMOVE OIL FROM OLD FLUSH VALVE SEAL SURFACE. DRY SEAL SURFACE COMPLETELY.

NOTE: USE STEEL WOOL ON BRASS FLUSH VALVES
3. REMOVE PAPER COVER FROM GOOEY RING. MOUNT ASSEMBLY OVER LARGE HOLE ON FLUSH VALVE, THEN LIGHTLY PRESS ON SO THE FLAPPER IS POINTING IN THE SAME DIRECTION AS THE OLD FLAPPER WAS OR IN THE SAME DIRECTION AS THE FLUSH ARM.
4. CONNECT THE STRAP OR CHAIN TO THE FLUSH ARM ASSEMBLY.

NOTE: THE FLUSH ARM MUST MOVE FREELY
5. FIRMLY PRESS DOWN ON THE FLUSHER FIXIT™ RING FORCING THE GOOEY RING TO SEAL.
6. NOW TEST AND CHECK:
 - a. TURN ON WATER, FILL TANK AND CHECK FOR LEAKS.
 - b. IF LEAK OCCURS, RE-SEAT THE GOOEY RING AND CHECK FOR PROPER 360° CONTACT, CHECKING THE FLAPPER FOR PROPER ALIGNMENT.
 - c. ADJUST THE STRAP AS FOLLOWING:
 - d. SHORT ENOUGH SO THE TOILET FLUSHES.
 - e. LONG ENOUGH SO THE FLAPPER SEALS AFTER FLUSH IS COMPLETED.

INS-FLO02-6305