

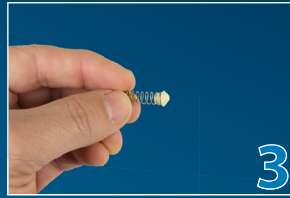

Hi-Flow™ Dosing Delivery System

NOZZLE FITTING INSTRUCTIONS

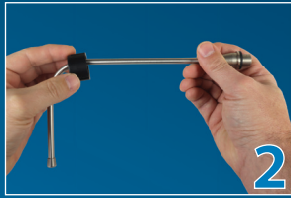

1. Remove front-end cap from the barrel end.
2. Place nozzle through the opening of the front-end cap.
3. Ensure the check ball is seated in the outlet spring.
4. Slide outlet spring into the cavity of the nozzle.
5. Screw the black cap tightly onto the barrel head while positioning the nozzle at the desired angle.



OPERATING INSTRUCTIONS

1. Depress handle to move piston to the desired volume to dispense, 2ml - 12ml. Turn the adjustment ring to lock piston in place.
2. Remove product shipping cap and set aside.
3. Insert the straw provided into the double stepped barbed cap with the beveled end down. With straw attached, tighten cap securely on the container to avoid leakage.
4. Connect one end of the delivery tube to the inlet of the instrument and the other end to the barbed cap. Ensure both ends of the delivery tube are secure.
5. Hold the instrument in a vertical position with the nozzle pointing upward. Direct the opening away from you and cover it with an absorbent material. Slowly squeeze and release the handle until air is expelled from the barrel and product starts to come out.
6. Prime the instrument by expelling a dose of product into a waste container or absorbent material.
7. The instrument is ready for use.
8. When the instrument is filled with product for continued use, store at room temperature.

CLEANING INSTRUCTIONS

Use vinyl, neoprene or nitrile gloves while using or cleaning the instrument and accessories. Do not use latex gloves.

The dosing instrument should be disassembled and cleaned following the instructions below after every 14-day dosing period. It does not need to be cleaned daily while in use.

1. Replace the product shipping cap on the product container to prevent spillage.
2. Wash the instrument tubing and cap with hot soapy water. Clean off residual product and flush with clean water. Expel the water by flushing with air.
3. Remove the barrel from the instrument body. Place two or three drops of vegetable oil or silicone oil on the O-ring.
4. Re-attach the barrel to the instrument and store the assembly in a cool dry place.
5. Periodically check instrument function by squeezing the handle. If the instrument becomes difficult to squeeze, contact MAI Animal Health for a parts kit.

MAI Animal Health - UNITED STATES
1.800.447.0687
sales@maianimalhealth.com

MAI Animal Health - EUROPE
+44 (0) 1225 791 184
sales.uk@maianimalhealth.com

MAI Animal Health - AUSTRALIA
+61 (0) 2 6372 6622
sales.au@maianimalhealth.com

MAI Animal Health - NEW ZEALAND
+64 (0) 9 444 2115
sales.nz@maianimalhealth.com