

BASE CABINET SPECIFICATIONS - HARMONY SLATE

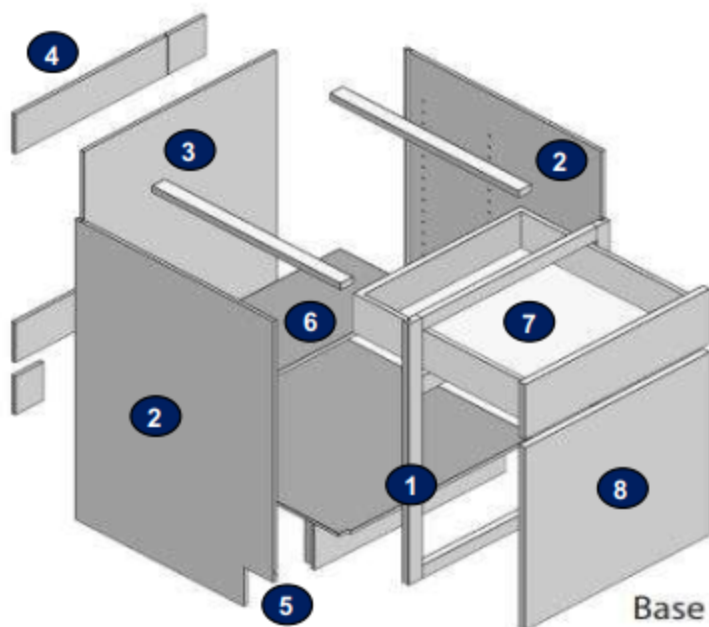

Cabinet Construction

- 1** Cabinet fronts
 - 3/4" solid wood
 - Front stiles are pocket drilled and assembled with 1 1/4" screws for durability
- 2** Side Panels
 - 3/8" particle board, matching vinyl covered on both sides
 - Natural maple vinyl interior on stained product
 - Matching white vinyl interior on painted product
 - Glued and stapled in 3/8" dado in the cabinet's front frame
- 3** Back Panels
 - 3/8" particle board, vinyl covered on inside only
 - Natural maple vinyl interior on stained product
 - Matching white vinyl interior on painted product
 - Glued and nailed in 3/8" dado and stapled to the hang rail and cabinet bottom
- 4** Hanging Rails
 - 3/4" x 1 1/2" all wood
 - Installed on sides and back
- 5** Standard toe kick: 4 1/2" high x 4" deep
- 6** Shelves
 - Adjustable 1/2" MDF
 - Bullnose, foil-covered front edges on stained product
 - Bullnose, painted shelves on painted product
- 7** Drawers
 - 1/2" MDF
 - Dovetail construction
 - Drawers glide smoothly on self-adjusting ball bearing nylon guides
 - 1/2" Solid Wood Drawers on Cabinets 27"-36"
- 8** Doors: See Door Construction Specifications on page 2

Finish

All cabinet front and door surfaces receive stain or paint and a catalyzed clear finish. Our finish provides a deep, rich wood tone that is resistant to household chemicals, water, food stains, and mild acids

Hinges

Hidden, self-closing 6-way adjustable hinges