

BASE CABINET SPECIFICATIONS - QUINCY WHITE

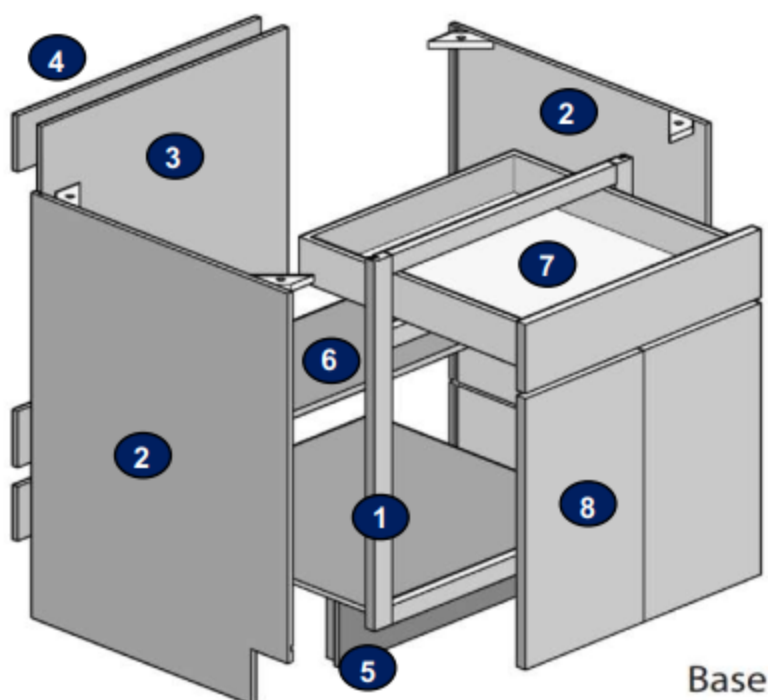

Cabinet Construction

- 1** Cabinet fronts
 - Front stiles are pocket drilled and assembled with 1 1/4" screws for durability
- 2** Side Panels
 - 3/8" particle board, matching vinyl covered on both sides
 - Glued and stapled in 3/8" dado in the cabinet's front frame
- 3** Back Panels
 - 3/8" particle board, vinyl covered on inside only
 - Glued and nailed in 3/8" dado and stapled to the hang rail and cabinet bottom
- 4** Backer Rails
 - Particleboard
 - Installed at both top and bottom
- 5** Toe Kick
 - Standard Base: 4 1/2" H x 4" D
 - Vanity Base: 4 1/2" H x 3 5/8" D
- 6** Shelves
 - Adjustable 1/2" MDF
 - Bullnose, foil-covered front edges
 - Shelves are held in place with self-locking clips on the sides and center stile (if applicable)
- 7** Drawers
 - 1/2" MDF
 - Dovetail construction
 - Drawers glide smoothly on self-adjusting ball bearing nylon guides
- 8** Doors: See Door Construction Specifications on page 2

Finish

Our laminate provides a surface that is resistant to household chemicals, water, food stains, and mild acids.

Hinges

Hidden, self-closing 6-way adjustable hinges