

# WALL CABINET SPECIFICATIONS - QUINCY WHITE

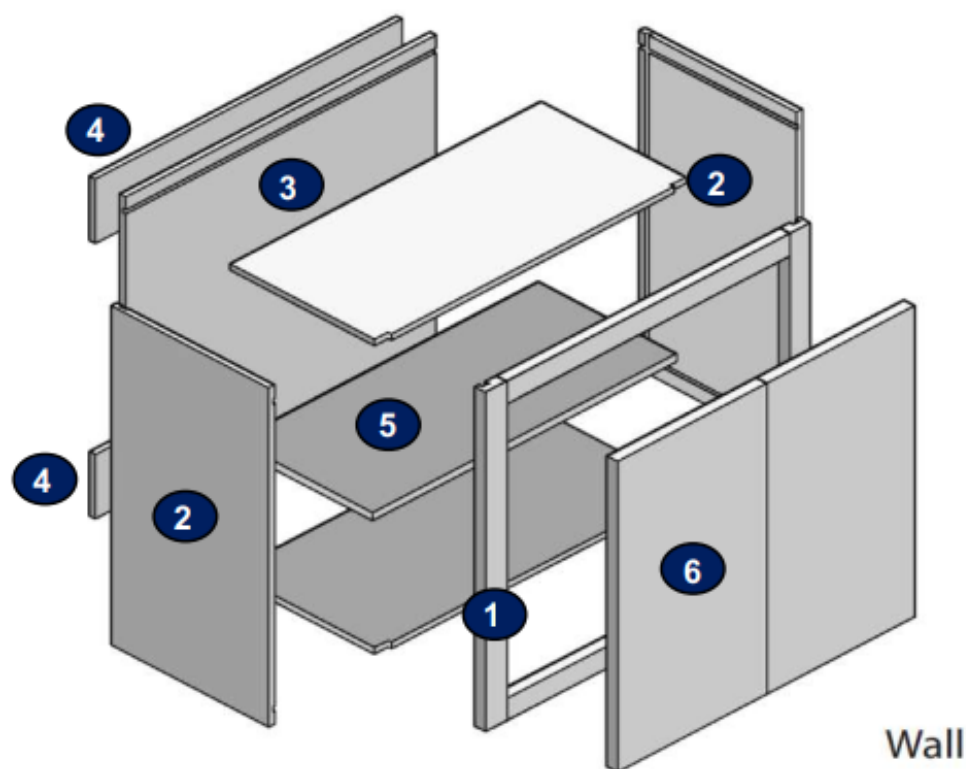

## Cabinet Construction

- 1** Cabinet fronts
  - Front stiles are pocket drilled and assembled with 1 1/4" screws for durability
- 2** Side Panels
  - 3/8" particle board, matching vinyl covered on both sides
  - Glued and stapled in 3/8" dado in the cabinet's front frame
- 3** Back Panels
  - 3/8" particle board, vinyl covered on inside only
  - Glued and nailed in 3/8" dado and stapled to the hang rail and cabinet bottom

- 4** Backer Rails
  - Particleboard
  - Installed at both top and bottom
- 5** Shelves
  - Adjustable 1/2" MDF
  - Bullnose, foil-covered front edges
  - Shelves are held in place with self-locking clips on the sides and center stile (if applicable)
- 6** Doors: See Door Construction Specifications on page 2

## Finish

Our laminate provides a surface that is resistant to household chemicals, water, food stains, and mild acids.

## Hinges

Hidden, self-closing 6-way adjustable hinges