



## ***TecWRAP™ At-Grade Insulated Foundation Wrap (R = 1) Installation Instructions ALERT***

THIS IS A COMPOSITE PRODUCT OF RUBBERIZED FABRIC BONDED TO FOAM BACKING. **IT CAN BE PULLED APART WITH SUFFICIENT FORCE! DO NOT PULL PRODUCT APART\***. LONG TERM STRENGTH OF TECHBREAKER IS FROM MECHANICAL FASTENERS ATTACHED THROUGH THE TECWRAP (AND THROUGH OPTIONAL INSULATING FOAM) INTO THE CONCRETE/CMU FOUNDATION. \*If this occurs, a Contact Cement or Foam Adhesive can reassemble the separation.

NOTE: TECWRAP IS NOT A WATERPROOFING PRODUCT! IF REQUIRED APPLY WATERPROOFING PRODUCTS PRIOR TO TECWRAP INSTALLATION.

PLEASE READ ALL INSTRUCTIONS BEFORE BEGINNING INSTALLATION!!

This installation guideline is provided to help prevent installation errors and problems. These are intended to be recommendations and do not serve as a step-by-step installation checklist as installation conditions can vary widely. Blue Hills Tech LLC, the manufacturer, and our distributors and dealers shall not be held responsible for installation actions either taken or not taken. Many details of product installation are borne of assumption of general construction knowledge to an experienced installer and thus are not included in these guidelines. Selection of an experienced installer is always recommended for best results and is the sole responsibility of the property owner and architect, if applicable. Blue Hills Tech LLC does not accept any responsibility for product failure resulting from or associated with improper site environmental conditions.

## **INSTALLATION INSTRUCTIONS**

### **1. PRODUCT**

TecWRAP™ is an at grade 'groundbreaker' foundation insulation wrap with a rubberized surface bonded to thin foam backing in 18" x 25' rolls. TecWRAP can be either applied directly to the foundation or applied over foam. CHECK AND COMPLY WITH LOCAL BUILDING CODES.

### **2. STORAGE**

On the jobsite TecWRAP packages and rolls should be kept off the ground, stored on a flat dry surface and with covered with a breathable waterproof tarpaulin.

### 3. PREPARATION

- a. Make sure foundation is clean and free of obstructions for installation of TecWRAP. Use wire brush to clean surface.
- b. Make sure surface is as smooth as possible and dry.

### 4. INSTALLATION

- a. TecWRAP is intended to be installed over poured concrete and CMU foundations at ground level. If waterproofing is required apply prior to TecWRAP installation.
- b. Create a sufficient trench to bury the bottom of the TecWRAP and have room to attach fasteners below grade surface.
- c. Determine TecWRAP locations and if trimming is required prior to installation. If wrap must be trimmed cut rubberized covering with a sharp utility knife. When TecWRAP needs to be attached or spliced cut back sufficient foam (4-6") and remove the foam from the covering to form a flap, which can be attached with a contact cement-type adhesive or heat bonded to the adjacent TecWRAP.
- d. Fasteners engineered to attach to concrete are required (typical-Tapcon-type). Pre drill through the TecWRAP into concrete (to avoid tears of fabric) for fastening. A minimum of 1" thread engagement into the concrete is required for concrete-compatible screws. Advance testing of the pull out resistance is recommended. Fasten every 12" O.C. top and bottom. No matter what mechanical fastening method in use, always follow the fastener manufacturers' directions and instructions.
- e. Install panel so top flap and top fasteners will be covered by siding when finished. Attach fasteners at top through TecWRAP (and additional foam if used) and into concrete. Staple or nail top flap into sill plate or framing if accessible. Attach fasteners 12" O.C at top and at bottom through TecWRAP and into concrete that is below grade. Optionally foam adhesive can be used as in addition to fasteners to attach additional foam to TecWRAP and between foam and foundation (Note: fasteners still must be used 12" O. C. top and bottom).
- f. The end flaps with foam removed (see c. above) are attached to the previously installed panel or at an inside or outside corner with these adhesive methods:
  - commercial roofing heat sealer or heat gun to bond rubber together
  - solvent-based contact cement
  - spray or caulking gun applied adhesive—check for compatibilityAttach flap at far end top and bottom to adjoining TecWRAP with mechanical fasteners after adhering flap to panel per above.
- g. Backfill with earth to cover bottom fasteners. Siding/wall covering should be applied over dry insulation wrap as soon as possible.

### 4. FASTENERS

Concrete/CMU Foundations - Use Tapcon screws or equal. Pre drill for fastening. A minimum of 1" thread engagement into the concrete is required. Advance testing of the pull out resistance is recommended.



[info@bluehillstech.net](mailto:info@bluehillstech.net)

[www.bluehillstech.net](http://www.bluehillstech.net)

Blue Hills Tech LLC © 2023

Typical Installation Cutaway—Shown: TecWRAP With Optional XPS Foam Attached

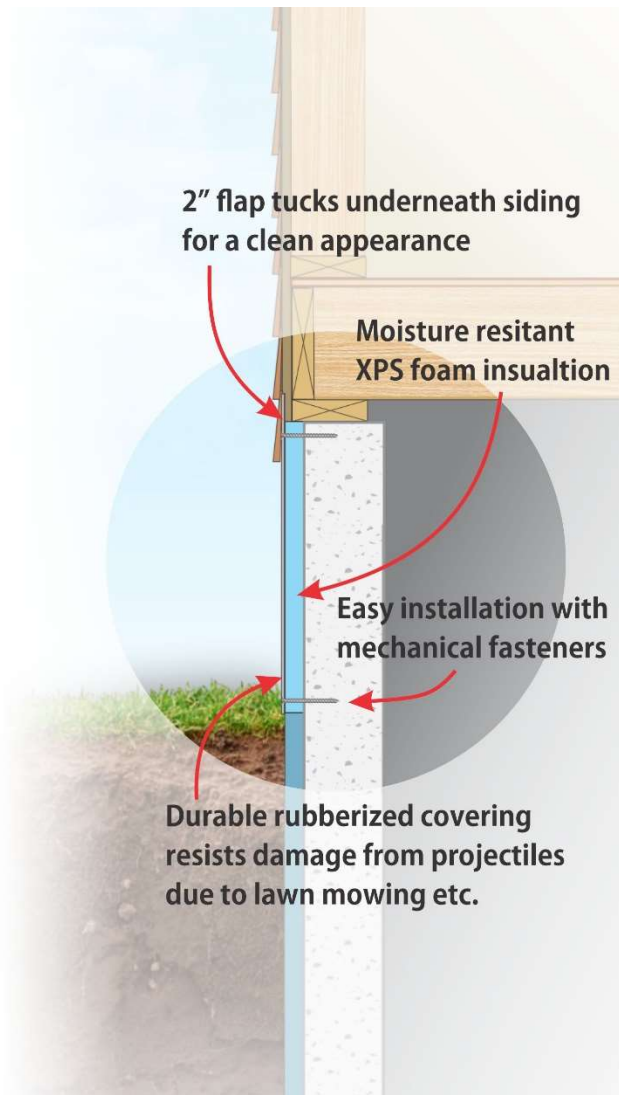

2" flap tucks underneath siding for a clean appearance

Moisture resistant XPS foam insulation

Easy installation with mechanical fasteners

Durable rubberized covering resists damage from projectiles due to lawn mowing etc.