

Calculation of 10 manholes

No.	Area	Volume	Remarks
1	10.00	10.00	
2	10.00	10.00	
3	10.00	10.00	
4	10.00	10.00	
5	10.00	10.00	
6	10.00	10.00	
7	10.00	10.00	
8	10.00	10.00	
9	10.00	10.00	
10	10.00	10.00	

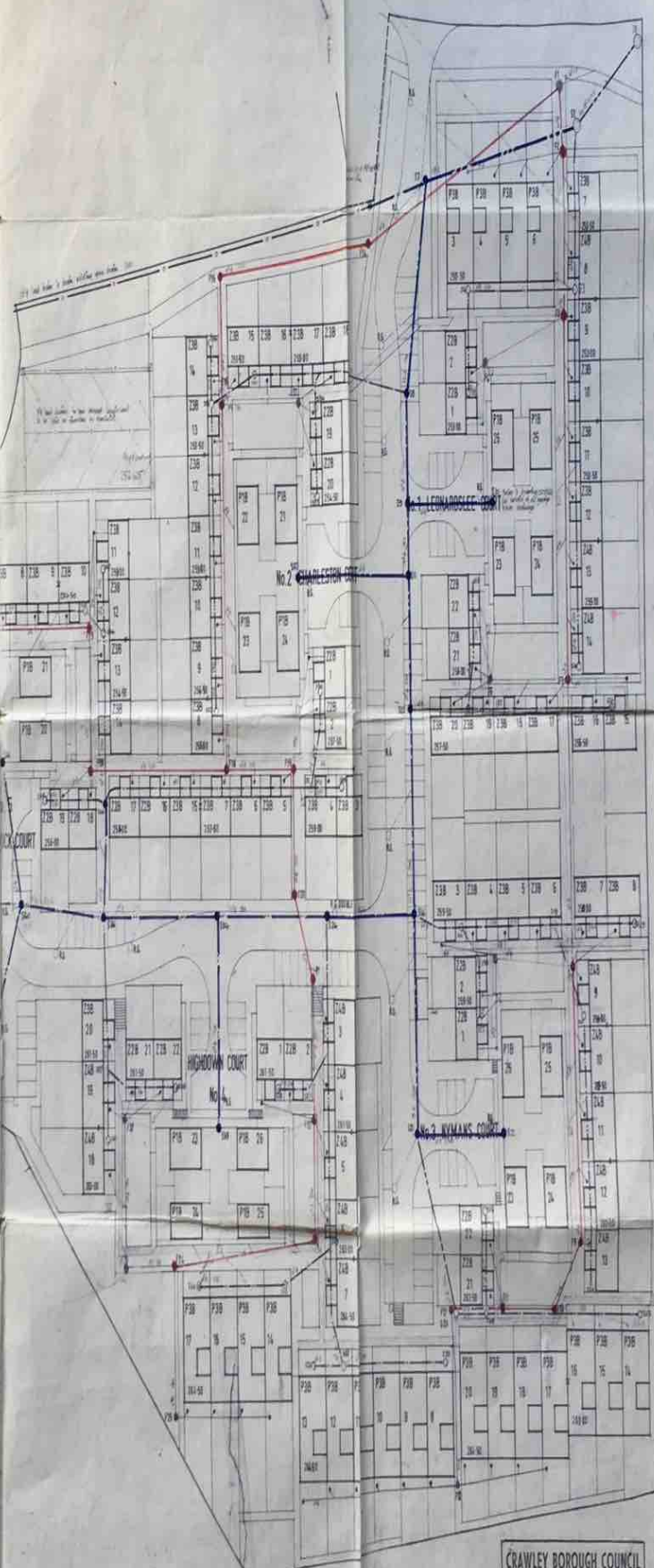

**SCHEDULE OF MANHOLES
FOUL AND SURFACE**

No.	Location	Size	Depth	Remarks
M1	Seewick Court	150	1.5	
M2	Seewick Court	150	1.5	
M3	Seewick Court	150	1.5	
M4	Seewick Court	150	1.5	
M5	Seewick Court	150	1.5	
M6	Seewick Court	150	1.5	
M7	Seewick Court	150	1.5	
M8	Seewick Court	150	1.5	
M9	Seewick Court	150	1.5	
M10	Seewick Court	150	1.5	

No.	Location	Size	Depth	Remarks
M11	Seewick Court	150	1.5	
M12	Seewick Court	150	1.5	
M13	Seewick Court	150	1.5	
M14	Seewick Court	150	1.5	
M15	Seewick Court	150	1.5	
M16	Seewick Court	150	1.5	
M17	Seewick Court	150	1.5	
M18	Seewick Court	150	1.5	
M19	Seewick Court	150	1.5	
M20	Seewick Court	150	1.5	

No.	Location	Size	Depth	Remarks
M21	Seewick Court	150	1.5	
M22	Seewick Court	150	1.5	
M23	Seewick Court	150	1.5	
M24	Seewick Court	150	1.5	
M25	Seewick Court	150	1.5	
M26	Seewick Court	150	1.5	
M27	Seewick Court	150	1.5	
M28	Seewick Court	150	1.5	
M29	Seewick Court	150	1.5	
M30	Seewick Court	150	1.5	

No.	Location	Size	Depth	Remarks
M31	Seewick Court	150	1.5	
M32	Seewick Court	150	1.5	
M33	Seewick Court	150	1.5	
M34	Seewick Court	150	1.5	
M35	Seewick Court	150	1.5	
M36	Seewick Court	150	1.5	
M37	Seewick Court	150	1.5	
M38	Seewick Court	150	1.5	
M39	Seewick Court	150	1.5	
M40	Seewick Court	150	1.5	

1. Manhole depth to be as specified on drawings. If not specified, manhole depth shall be 1.5m.

2. All manhole openings shall be 1.5m diameter.

3. Manhole frames shall be made of cast iron or equivalent material.

4. Manhole covers shall be made of cast iron or equivalent material.

5. Manhole frames and covers shall be painted with a protective paint.

6. Manhole frames and covers shall be set in concrete.

7. Manhole frames and covers shall be set in concrete to a depth of 100mm below ground level.

8. Manhole frames and covers shall be set in concrete to a depth of 100mm below ground level.

9. Manhole frames and covers shall be set in concrete to a depth of 100mm below ground level.

10. Manhole frames and covers shall be set in concrete to a depth of 100mm below ground level.

11. Manhole frames and covers shall be set in concrete to a depth of 100mm below ground level.

12. Manhole frames and covers shall be set in concrete to a depth of 100mm below ground level.

13. Manhole frames and covers shall be set in concrete to a depth of 100mm below ground level.

14. Manhole frames and covers shall be set in concrete to a depth of 100mm below ground level.

15. Manhole frames and covers shall be set in concrete to a depth of 100mm below ground level.

16. Manhole frames and covers shall be set in concrete to a depth of 100mm below ground level.

17. Manhole frames and covers shall be set in concrete to a depth of 100mm below ground level.

18. Manhole frames and covers shall be set in concrete to a depth of 100mm below ground level.

19. Manhole frames and covers shall be set in concrete to a depth of 100mm below ground level.

20. Manhole frames and covers shall be set in concrete to a depth of 100mm below ground level.

21. Manhole frames and covers shall be set in concrete to a depth of 100mm below ground level.

22. Manhole frames and covers shall be set in concrete to a depth of 100mm below ground level.

23. Manhole frames and covers shall be set in concrete to a depth of 100mm below ground level.

24. Manhole frames and covers shall be set in concrete to a depth of 100mm below ground level.

25. Manhole frames and covers shall be set in concrete to a depth of 100mm below ground level.

26. Manhole frames and covers shall be set in concrete to a depth of 100mm below ground level.

27. Manhole frames and covers shall be set in concrete to a depth of 100mm below ground level.

28. Manhole frames and covers shall be set in concrete to a depth of 100mm below ground level.

29. Manhole frames and covers shall be set in concrete to a depth of 100mm below ground level.

30. Manhole frames and covers shall be set in concrete to a depth of 100mm below ground level.

31. Manhole frames and covers shall be set in concrete to a depth of 100mm below ground level.

32. Manhole frames and covers shall be set in concrete to a depth of 100mm below ground level.

33. Manhole frames and covers shall be set in concrete to a depth of 100mm below ground level.

34. Manhole frames and covers shall be set in concrete to a depth of 100mm below ground level.

35. Manhole frames and covers shall be set in concrete to a depth of 100mm below ground level.

36. Manhole frames and covers shall be set in concrete to a depth of 100mm below ground level.

37. Manhole frames and covers shall be set in concrete to a depth of 100mm below ground level.

38. Manhole frames and covers shall be set in concrete to a depth of 100mm below ground level.

39. Manhole frames and covers shall be set in concrete to a depth of 100mm below ground level.

40. Manhole frames and covers shall be set in concrete to a depth of 100mm below ground level.

CRAWLEY BOROUGH COUNCIL
K. J. Sullivan M.I.C.E., M.I.M.E.E.
CHIEF TECHNICAL OFFICER

CRAWLEY BOROUGH COUNCIL
Drawing No. 6056/10/543

CRAWLEY BOROUGH COUNCIL
B. C. Vine M.I.C.E., M.I.M.E.E.
BOROUGH ENGINEER

Drawings vested in Crawley Borough Council

**GENERAL DRAINAGE LAYOUT
WITH SERVICE ZONES**

Scale: 1:100

Drawn by: [Signature]

Checked by: [Signature]

Date: 08/3/10