

## 5800SS1 Wireless Shock Sensor - Installation Guide

### GENERAL INFORMATION

The 5800SS1 is a wireless shock sensor intended for use in systems that support 5800 series devices. Each transmitter has its own unique serial number, assigned during manufacture, which must be "enrolled" in the control panel before the device can be used with the system. Refer to the control panel's Installation and Setup Guide for programming details.

One 5800SS1 is required for each pane of glass protected. (Do not use more than one sensor per pane.)

### Types of Glass Protection

- Tempered
- Ordinary Plate
- Sealed Insulated

Not for use in UL installations.

**Note:** It is not necessary to remove the case cover during installation.

### ENROLLING THE 5800SS1

You must enroll the 5800SS1 serial number in the control panel using zone programming. Refer to the control panel's Installation and Setup Guide for detailed programming procedures. Before programming, perform the following:

1. To cause the transmitter to transmit, remove the "PULL TO CONNECT BATTERY" tab (see Figure 1). (For additional transmissions, lightly tap on the base of the sensor with a screwdriver.)

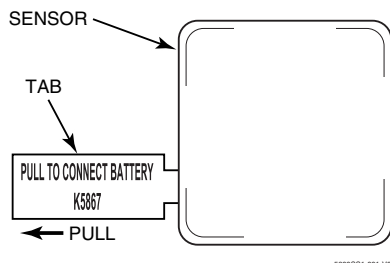

Figure 1

2. When programming the shock sensor, note the following:
  - Input Type = 3 (Supervised RF)
  - Loop Number = 1
3. When prompted for the serial number, you can transmit by lightly tapping on the base of the sensor with a screwdriver (pause 2 seconds between taps) or by manually entering the serial and loop number.

### MOUNTING

1. Before the transmitter is permanently mounted, determine the optimum mounting location. For best sensitivity, the sensor should be mounted one-inch from the corner edge of the window frame (see Figure 2).

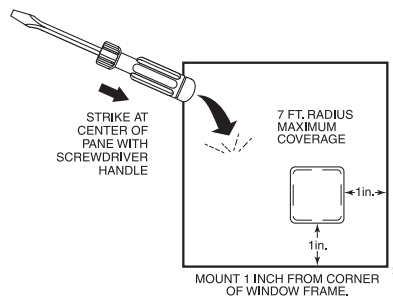

Figure 2

2. Conduct Go/No Go tests (see control's instructions) to verify adequate signal strength from the mounting location to the Alarm System receiver.

Verify range by taping (with masking tape) the sensor in the approximate mounting location and tapping at the base to initiate a fault transmission. The panel (in the Go/No Go test mode) should respond to the transmissions. If not, find a more suitable mounting location, possibly on the opposite corner of the window.

3. After successful testing. Clean the glass, where the sensor will be mounted, with a mixture of water and isopropyl alcohol.
4. Once the glass has dried, remove the tape backing paper and firmly press the sensor in the desired mounting location.
5. Verify operation by striking the center of the glass with the handle of a large screwdriver. Always check the alarm panel keypad to verify that the correct zone has tripped.
6. Apply optional "WARNING" label to the outside glass surface opposite the tape side of the 5800SS1.

## REPLACING THE BATTERY

1. Using a screwdriver, carefully remove the sensor's cover.
2. Check the battery polarity orientation before installing (see Figure 3).
3. Insert the battery securely in the sensor.
4. Snap the sensor cover back in place.

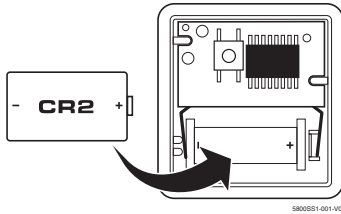

Figure 3

## SPECIFICATIONS

### Glass Coverage:

Plate, Sealed Insulated, and Tempered glass, with thicknesses between 3/32" (2.38mm) and 1/4" (6.35mm) and up to 7 ft (2.134m) distance from mounting location. One sensor is required for each separate pane of glass.

Not for use in UL installations.

### Dimensions:

1.6" H x 1.6" W x 0.8" D (40.64 mm x 40.64 mm x 20.32 mm)

### Power:

Single 3V Panasonic CR2, or Duracell DLCR2 Lithium Battery

### WARNING

Risk of fire, explosion, and burns. Do not recharge, disassemble, heat above 212° F (100° C) or incinerate. Dispose of used batteries properly. Keep away from children.

### FCC / IC STATEMENT

This device complies with Part 15 of the FCC Rules, and RSS-210 of IC. Operation is subject to the following two conditions: (1) This device may not cause harmful interference (2) This device must accept any interference received, including interference that may cause undesired operation.

Cet appareil est conforme à la partie 15 des règles de la FCC & de RSS-210 des Industries Canada. Son fonctionnement est soumis aux conditions suivantes: (1) Cet appareil ne doit pas causer d'interférences nuisibles. (2) Cet appareil doit accepter toute interférence reçue y compris les interférences causant une réception indésirable.

### FEDERAL COMMUNICATIONS COMMISSION STATEMENTS

The user shall not make any changes or modifications to the equipment unless authorized by the Installation Instructions or User's Manual. Unauthorized changes or modifications could void the user's authority to operate the equipment.

### TO THE INSTALLER

Regular maintenance and inspection (at least annually) by the installer and frequent testing by the user are vital to continuous satisfactory operation of any alarm system.

The installer should assume the responsibility of developing and offering a regular maintenance program to the user as well as acquainting the user with the proper operation and limitations of the alarm system and its component parts. Recommendations must be included for a specific program of frequent testing (at least weekly) to ensure the system's proper operation at all times.

**FOR WARRANTY INFORMATION AND DETAILS REGARDING THE LIMITATIONS OF THE ENTIRE ALARM SYSTEM REFER TO THE INSTALLATION INSTRUCTIONS FOR THE RECEIVER/CONTROL USED WITH THIS DEVICE.**

# Honeywell



K0011V2 12/13 Rev. B

2 Corporate Center Drive, Suite 100  
P.O. Box 9040, Melville, NY 11747  
Copyright © 2011 Honeywell International Inc.

<http://www.honeywell.com/security>