



# MT series Electric actuators

## SPECIFICATION DATA



## FEATURES

- For On-Off or Modulating Control.
- Manual override non-clutch design.
- Irreversible worm gear.
- Visual mechanical position indicator for accurate visual reference of valve position.
- 2 aux. limit switches standard.
- Enclosure to IP67 to Nema 4X
- Full alloy construction to ISO12944-6 C3
- Full metal gear train lubricated for life

## SPECIFICATIONS

Power Supply	24vac/24vdc, 240Vac, 415vac 50Hz
Running time	See tables
Travel Angle	90° ± 5°
Input (Modulating)	4~20mA, 1~5V, or 0(2)~10V select by DIP-switch
Feedback (Modulating)	4~20mA or 0(2)~10V select by DIP-switch
Enclosure	IP67
Ambient Temperature	-30°C to +65°C
Indicator	Continuous Position Indicator
Manual Override	Non-clutch design
Worm Gear	Permanently lubricated and self-locking
Space Heater	15W 220V Anti-condensation
Material	Aluminum Alloy
External Coating	Dry powder coating
Stall Protection	Built-in thermal protection
	Cut off at 125 ± 5°C
	Reset at 95 ± 5°C

### General

The MT series quarter-turn electric actuator. All MT models are equipped with standard On-Off or modulating (4~20mA, 1~5V, or 0(2)~10V select by DIP-switch) control. All models of MT also provide feedback output signal via 2 x dry contacts for On-Off version; 0~5V, 0~10V, 4~20mA (selected by DIP-switch) for modulating version, Auxiliary Switch is optional.

### Options

- 75% or 50% duty cycle.
- Modbus.
- Special coatings and colours.
- IP68 enclosure rated to 7m submergence for 72hrs.
- Modulating controller 4-20Ma input and output.
- Spring return (MT-SY Series).
- Anti-condensation heater.
- Manual override for MT-A.
- Local/ remote control.
- Torque switches.
- Potentiometer.
- Position transmitter 4-20Ma output.
- Adjustable speed board.
- EX approved version for hazardous areas.
- Grade 316 Stainless Steel available



www.fluidflo.com.au  
 info@fluidflo.com.au  
 ABN 28480253276

FRECALL 1800 46 47 03

## TECHNICAL DATA

Model	Torque (Nm)	Speed AC Sec/90°	Speed DC Sec/90°	Power (Watts)	Manual override	Mounting Flange (ISO5211)	Weight (Kg)
MT-1	35	13	15	10	Nut	F03/F05	2
MT-A	50	24	20	10	N/A	F05/F07	3
MT-AM	50	24	20	10	Nut	F05/F07	3
MTM-F	65	7	6	60	Handwheel	F07/F10	11
MT-2	90	17	15	40	Handwheel	F07/F10	11
MBM-2	120	9	8	40	N/A	F07	5.5
MTM-G	120	8	7	60	Handwheel	F07/F10	11
MT-3	150	26	22	40	Handwheel	F07/F10	11
MTM-H	300	24	21	60	Handwheel	F07/F10	17
MT-4	400	18	16	80	Handwheel	F10/F12	20
MT-5	500	25	22	80	Handwheel	F10/F12	20
MT-6	650	31	28	80	Handwheel	F10/F12	20
MT-7	1000	55	46	80	Handwheel	F12 or F14	32
MT-8	1500	55	46	90	Handwheel	F12 or F14	32
MT-9	2000	70	58	80	Handwheel	F14 or F16	71
MT-10	2500	70	58	80	Handwheel	F14 or F16	71
MT-11	3000	70	58	220	Handwheel	F14 or F16	72
MT-12	3500	70	58	220	Handwheel	F14 or F16	72
MT-13	4500	104	95	300	Handwheel	F16/F25	106

Contact Fluidflo for wiring diagrams, operation manuals and additional specifications

## DIMENSIONS

Model MT-1

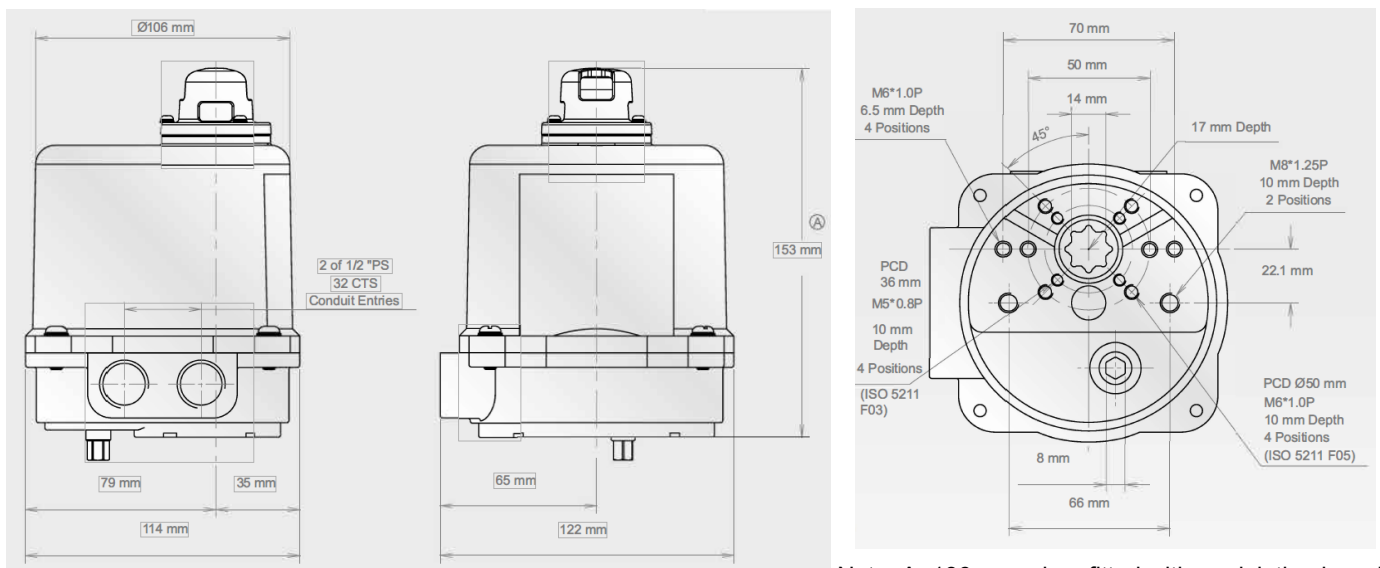

Note: A=186 mm when fitted with modulating board

# DIMENSIONS

## MT-A

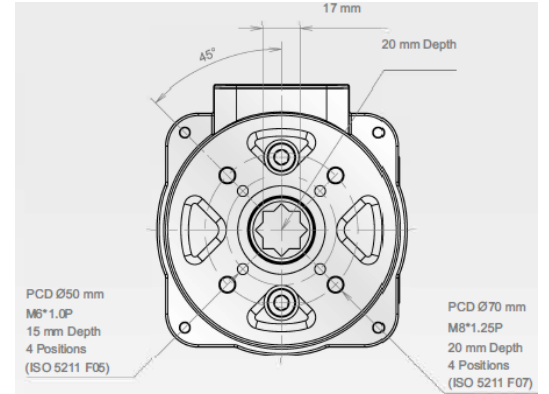
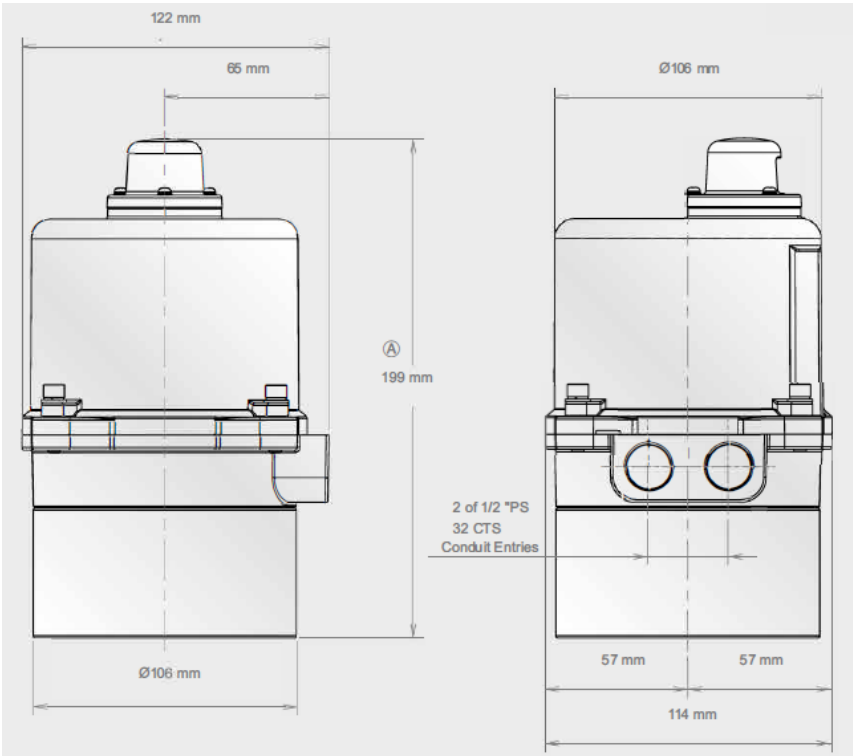

Note: Dimension A=232 mm when fitted with modulating board  
No mechanical stops or manual override

## MT-AM

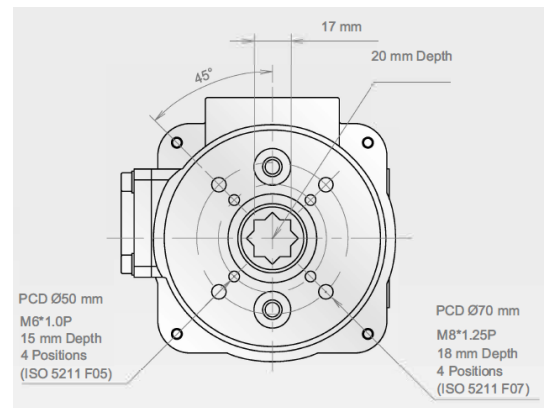
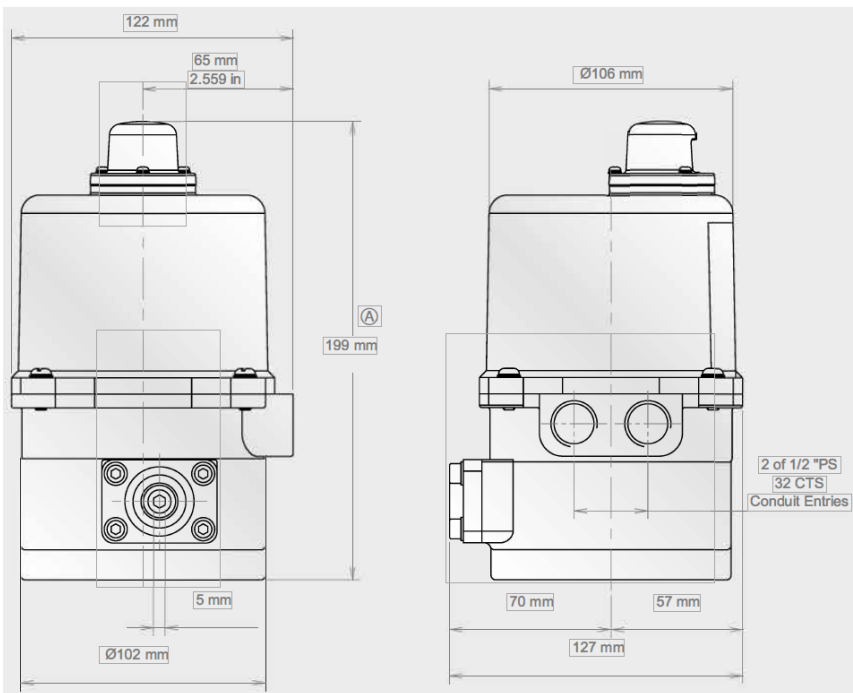

Note: Dimension A=232mm when fitted with modulating board

# DIMENSIONS

## MTM-F/G

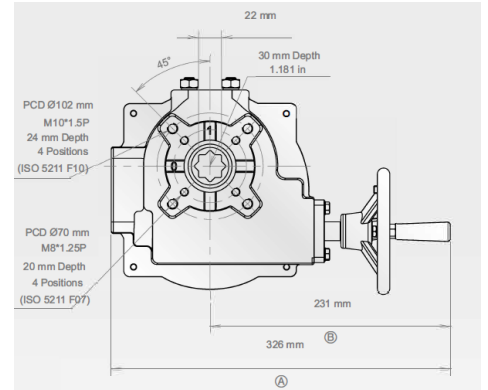
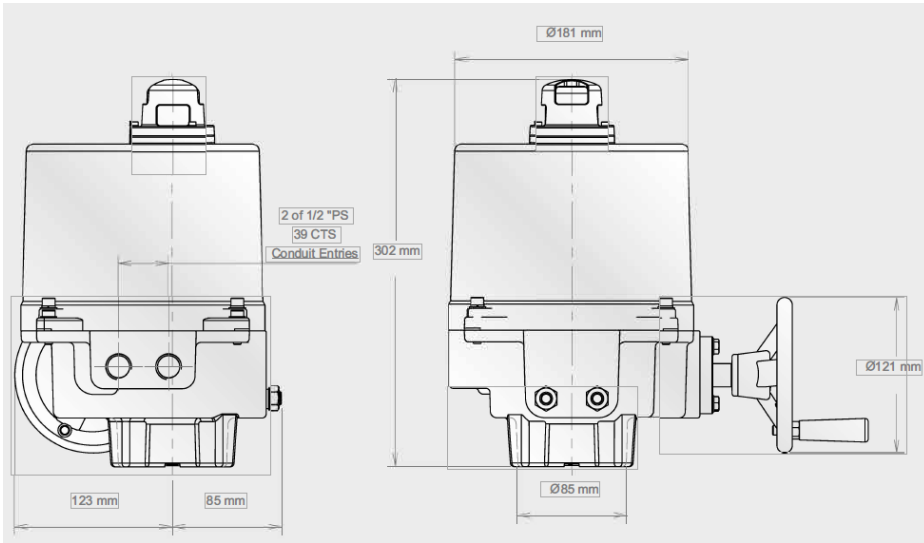

Note: A=363mm and B=268mm when fitted with torque switches

## MT-2/3

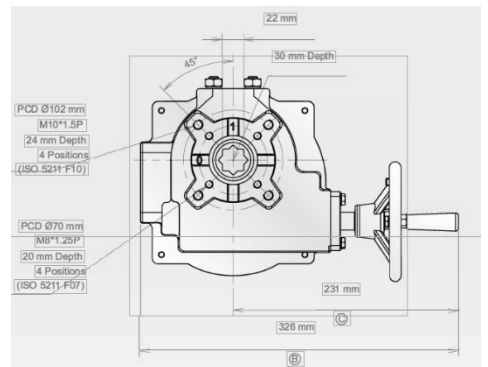
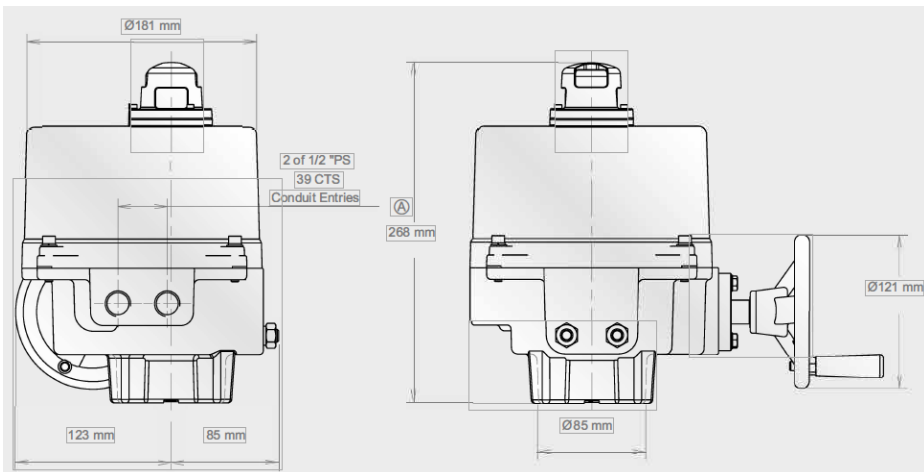

Note: For 75% DC duty cycle A=302mm, B=363mm and C=268mm

## MTM-H

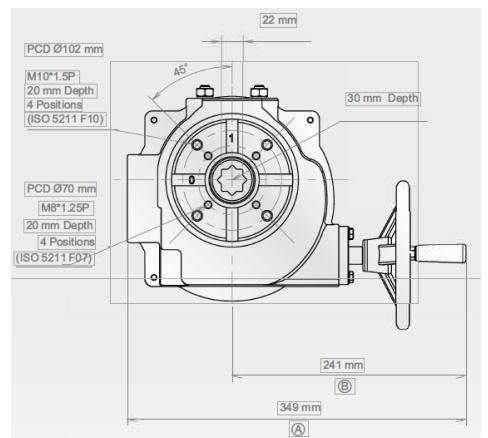
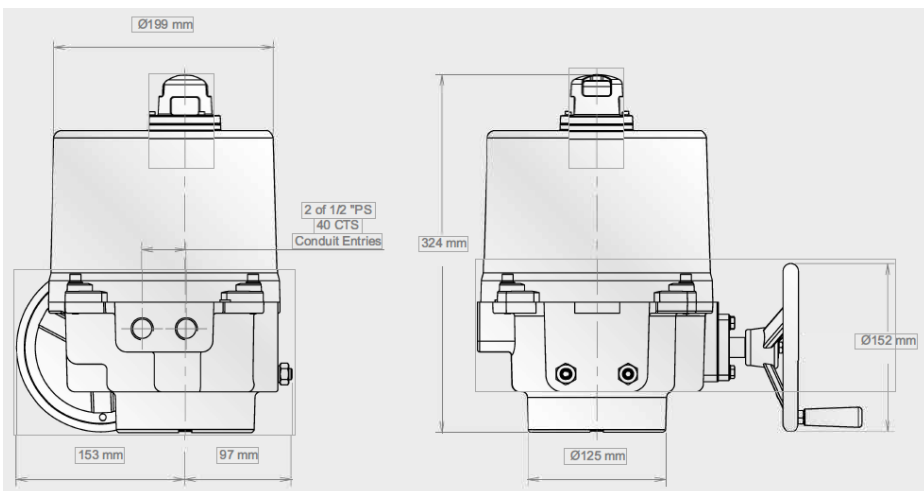

Note: A=400mm & B=292mm when fitted With torque switches

## DIMENSIONS

**MBM-2**

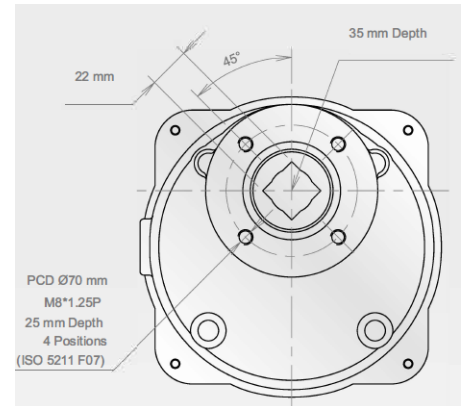
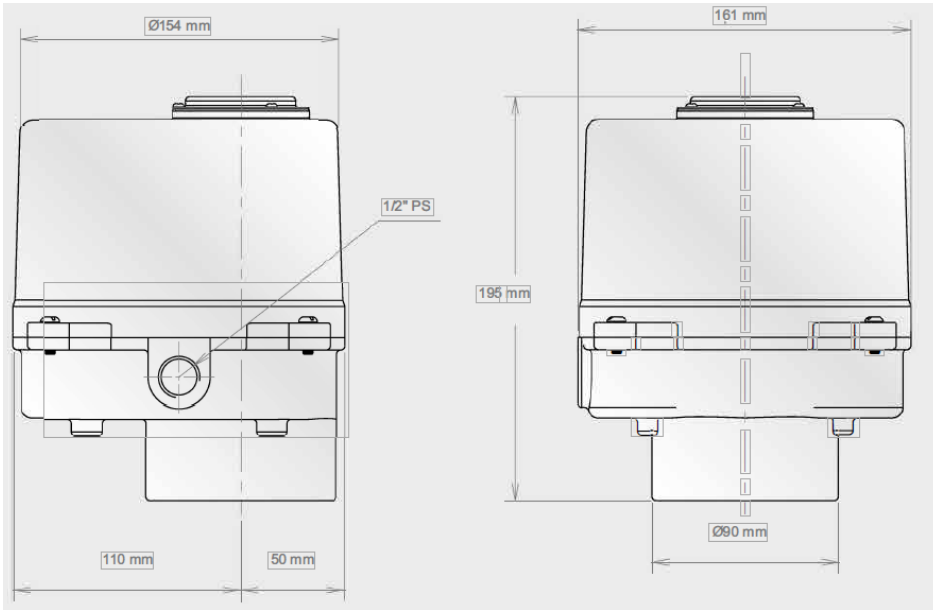

Note: MBM2 has ABS cover, no manual override, mechanical stops or certificates

**MT-4/5/6**

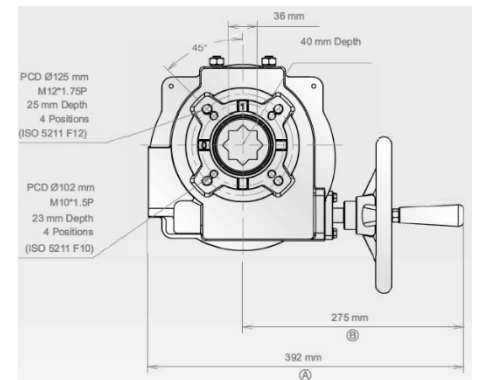
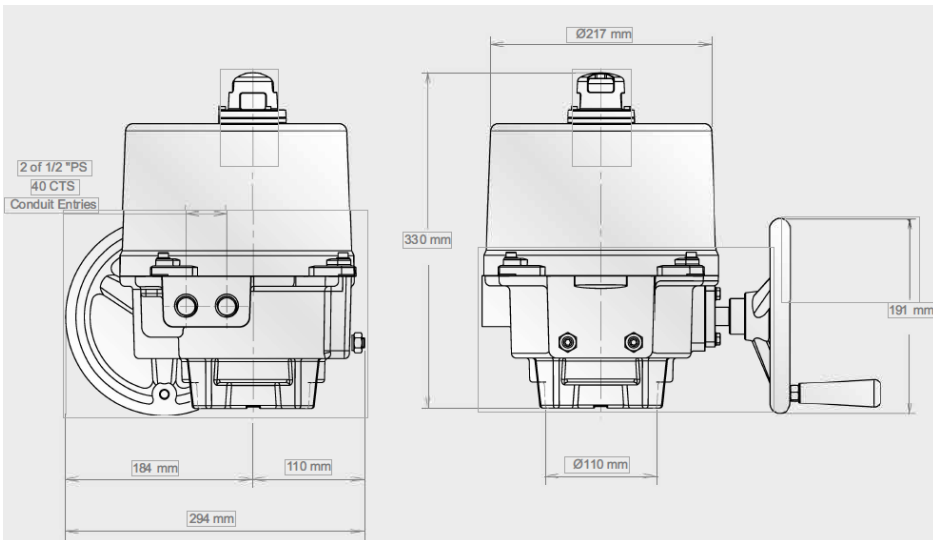

Note: A=458 and B=341 when fitted with torque switch or torque switches.

**MT-7/8**

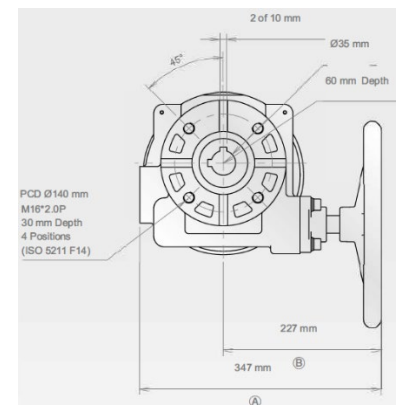
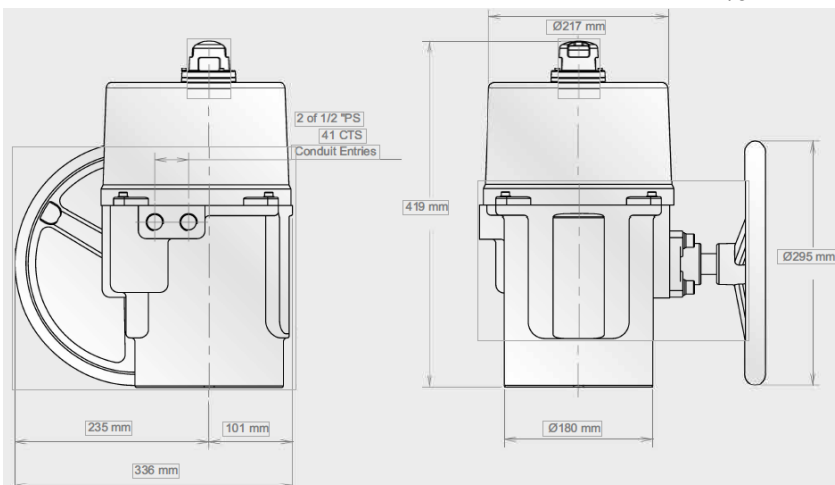

Note: A=435mm and B=315 mm when fitted with torque switches

# DIMENSIONS

MT-9/10/11/12

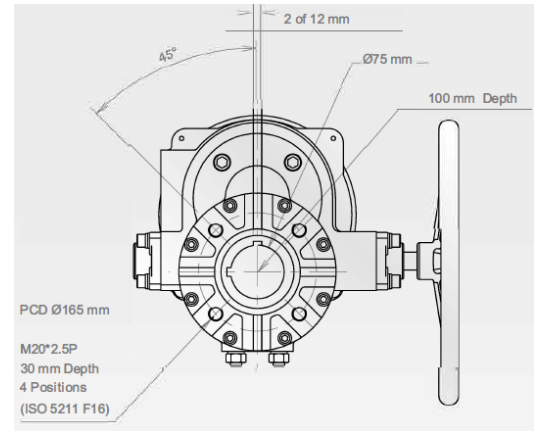
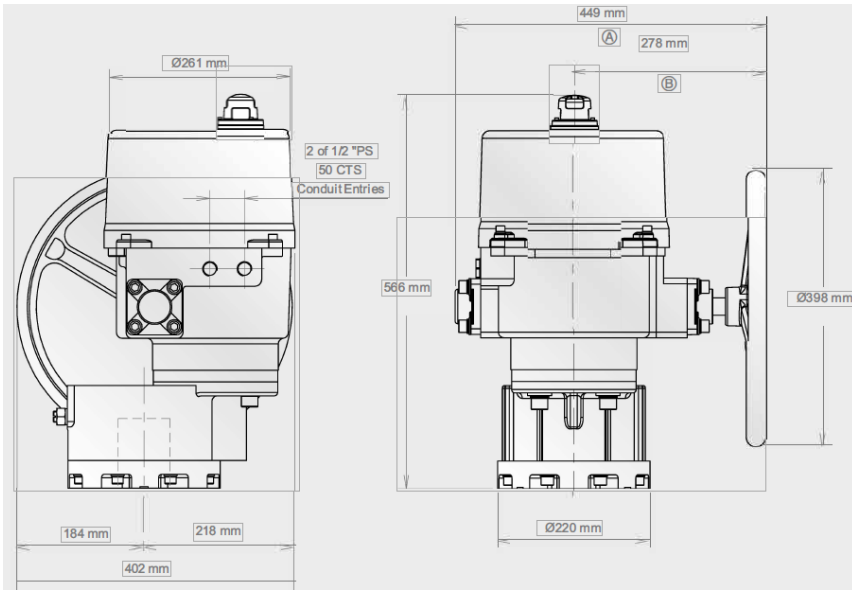

Note: A=459 mm and B=288 mm when fitted with torque switches. F14 base optional

MT-13

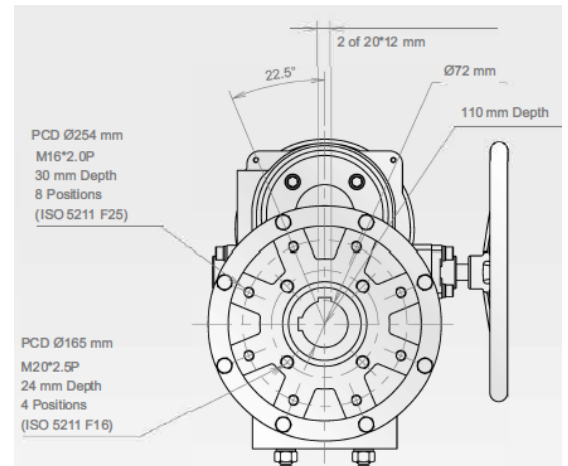
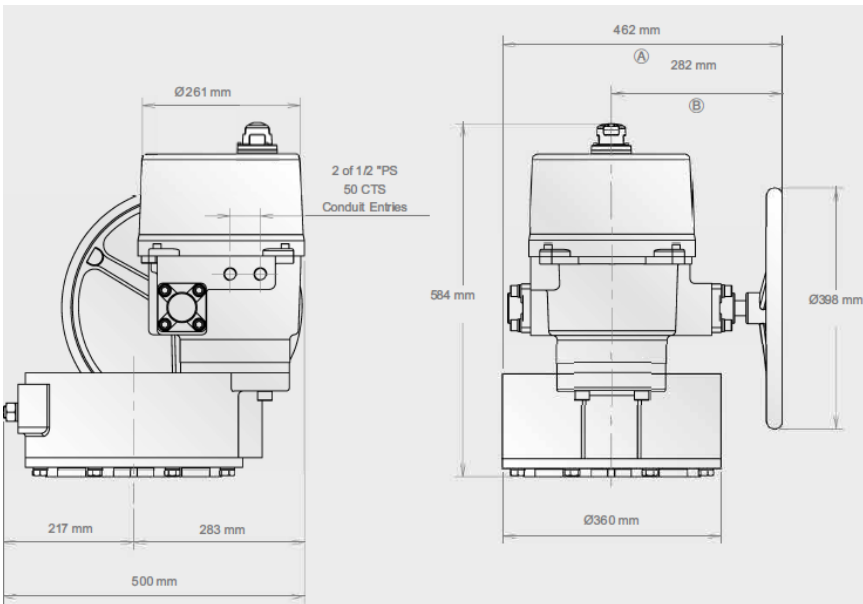

Note: A=472 mm and B=292 mm when fitted with torque switches.

MTE Explosion proof

MTSE-Spring return

Local Controls

