

中国声学行业领导品牌

LEEYIN丽音®
Leeyin Acoustics

2018^{Version}
Restore To the Most Authentic Voice

CENTENARY
LIYIN ACOUSTIC
SPACE CREATOR

100
YEARS

LEEYIN丽音®
Leeyin Acoustics

广东丽音声学科技有限公司
GUANGDONG LIYIN ACOUSTICS TECHNOLOGY CO.,LTD

Office Add:Room 401,Libao Decoration Center,No.277 Baogang Road,Haizhu District,Guangzhou,China

Factory Add:Datougang Road Hecun Xizi Industrial Zone,Lishui Town,Nanhai District ,Foshan,China

Free sales hotline: 400-865-3338

Tel:86-20-34371917

Fax:86-20-34385113

Email: export@gzliyiny.com

Postcode: 510240

Web:www.acousticmaterial.net



GUANGDONG LIYIN ACOUSTICS TECHNOLOGY CO.,LTD



LEEYIN[®]

COMPANY INTRODUCTION

Guangdong Liyin Acoustics Technology Co., Ltd was established on March 2006. The Group contain two brands which is LEEYIN ACOUSTICS and BLUE OCEAN ACOUSTICS where separately locates in the central area of Guangzhou Pearl River Delta and Foshan. With develop rapidly, our group has expanded our factory to 10,000 square meters with a 200 employees and has a strong production capacity of 1,000,000 square meters acoustics materials annually.

Our Company Have Four Departments

Acoustic Product Department

International Acoustics Department

Gymnasium Acoustics Department

Home Theater Acoustics Department

P. 01

ACOUSTIC SOLUTION

Starting from simply manufacturing and selling of acoustic materials,Leeyin Group has become a professional leading enterprise integrated with research,production,selling,project design and construction,changing from acoustic material manufacturer to acoustic space creator.Since 2010,with the mission of” Create an internationally competitive company,create a centenary developing international brand and Build a stage for its stuff to realize self-value of their lives” ,our company start expanding the products from acoustic material to other building materials.

At present,Leeyin group produces and supplies acoustic sound absorption materials,vibration damping products,movable partitions,laminated MDF boards,laminated PB Boards and MDF Slatwall,etc...With excellent quality,Leeyin products are well received in both China demestic market and oversea markets such as Europe,Americas,Asia,Africa and some other countries.

Leeyin Group is strict on every step of production to ensure the best quality.We provide full-scale quality management system and passed ISO9001:2008 not long after the company was established.

P. 02

Leeyin® 13/3 Wooden Groove Acoustic Panel

Product Overview

Leeyin 13/3 is a powerful union between architecture and acoustical performance. Utilizing 3mm grooves in a high recycled content.

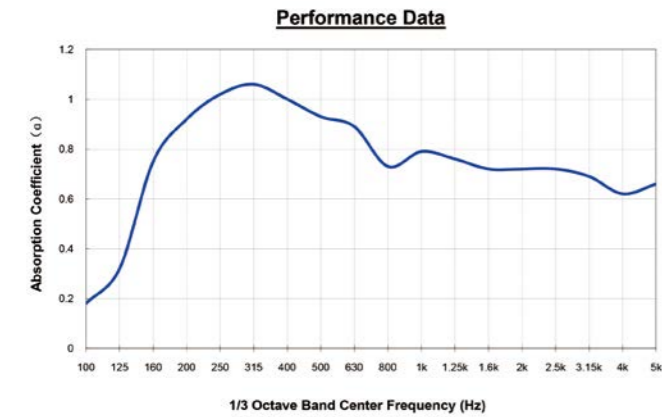

Technical Characteristics

- Basic Material: Normal MDF, E1MDF, FRMDF, Mgo Combination Board etc.
- Front Finish: Melamine, Natural Wood Veneer, Laminate, Paint, etc.
- Back Finish: Black Fleece.
- Standard Size: L2440xW133mm, L2440xW197mm (alternate lengths and widths are available)
- Standard Thickness: 12/15/18mm
- Formaldehyde Emission: Can meet both China & EU Standard Class E1
- Flame Retardant: Can meet China Standard Class B, BS476 Part 7 Class 1, etc.
- Pattern: 13/3; 14/2; 28/4; 59/5; 6/2; 5/3; 4/3



13/3 Wooden Groove Acoustic Panel

Frequency(Hz)	100	125	160	200	250	315	400	500	630	800	1000	1250	1600	2000	2500	3150	4000	5000	NRC
Sound absorption coefficient(a)	0.18	0.32	0.75	0.92	1.02	1.06	1	0.93	0.89	0.73	0.79	0.76	0.72	0.72	0.72	0.69	0.62	0.66	0.85

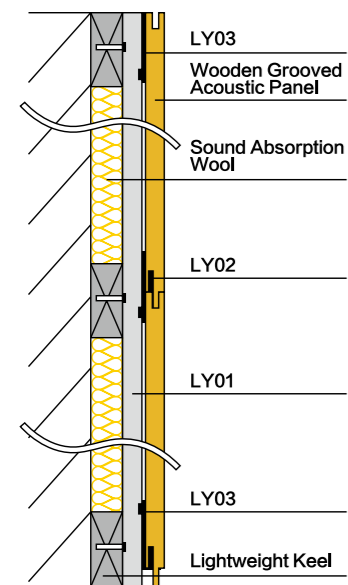

Cross-Section Structure

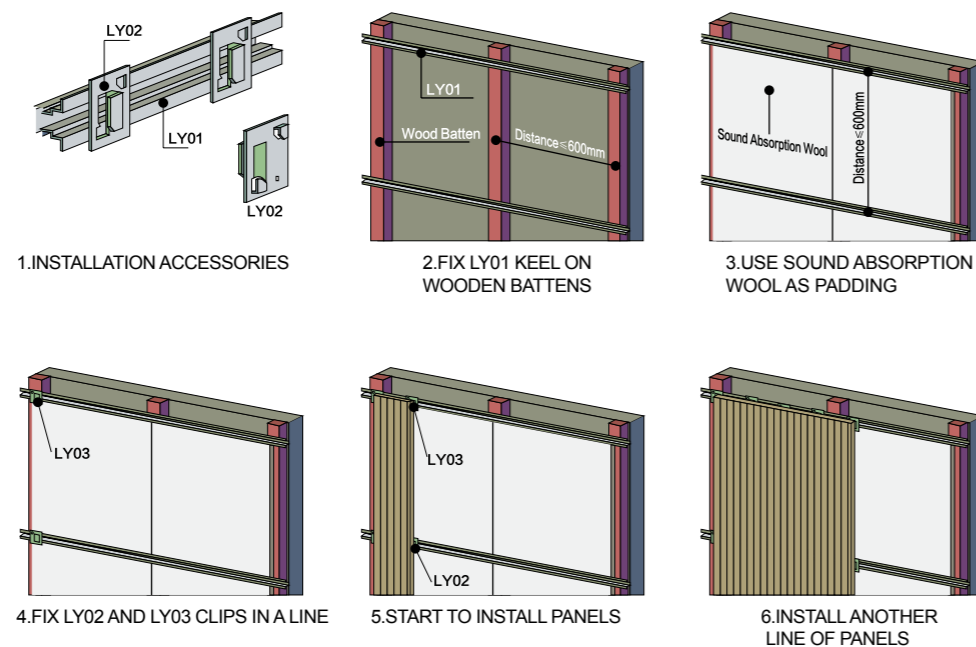

INSTALLATION: LIGHTWEIGHT STEEL KEEL SYSTEM

Leeyin® 14/2 Wooden Groove Acoustic Panel

Product Overview

Leeyin 14/2 is a powerful union between architecture and acoustical performance. Utilizing 3mm grooves in a high recycled content.

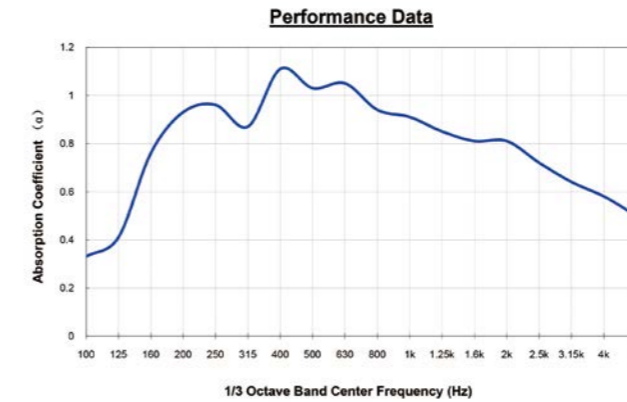

Technical Characteristics

- Basic Material: Normal MDF, E1MDF, FRMDF, Mgo Combination Board etc.
- Front Finish: Melamine, Natural Wood Veneer, HPL, Paint, etc.
- Back Finish: Black Fleece.
- Standard Size: 2440x133mm, 2440x197mm
- Standard Thickness: 12/15/18mm
- Formaldehyde Emission: Can meet both China & EU Standard Class E1
- Flame Retardant: Can meet China Standard Class B, BS476 Part 7 Class 1, etc.
- Pattern: 13/3; 14/2; 28/4; 59/5; 6/2; 5/3; 4/3



14/2 Wooden Groove Acoustic Panel

Frequency(Hz)	100	125	160	200	250	315	400	500	630	800	1000	1250	1600	2000	2500	3150	4000	5000	NRC
Sound absorption coefficient(a)	0.33	0.41	0.76	0.93	0.96	0.87	1.11	1.03	1.05	0.94	0.91	0.85	0.81	0.81	0.72	0.64	0.58	0.5	0.90

Application:

Auditorium, Conference rooms, Office, Gymnasiums, Schools, Lecture Center, etc.



Leeyin® 28/4 Wooden Groove Acoustic Panel

Product Overview

Leeyin 28/4 is a powerful union between architecture and acoustical performance. Utilizing 3mm grooves in a high recycled content.

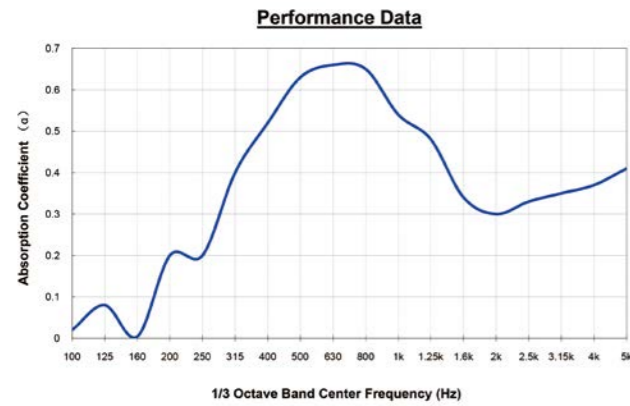

Technical Characteristics

- Basic Material: Normal MDF, E1MDF, FRMDF, Mgo Combination Board etc.
- Front Finish: Melamine, Natural Wood Veneer, Laminate, Paint, etc.
- Back Finish: Black Fleece.
- Standard Size: L2440xW133mm, L2440xW197mm (alternate lengths and widths are available)
- Standard Thickness: 12/15/18mm
- Formaldehyde Emission: Can meet both China & EU Standard Class E1
- Flame Retardant: Can meet China Standard Class B, BS476 Part 7 Class 1, etc.
- Pattern: 13/3; 14/2; 28/4; 59/5; 6/2; 5/3; 4/3



28/4 Wooden Groove Acoustic Panel

Frequency(Hz)	100	125	160	200	250	315	400	500	630	800	1000	1250	1600	2000	2500	3150	4000	5000	NRC
Sound absorption coefficient(a)	0.02	0.08	0.04	0.20	0.20	0.40	0.52	0.63	0.66	0.65	0.54	0.48	0.34	0.3	0.33	0.35	0.37	0.41	0.40

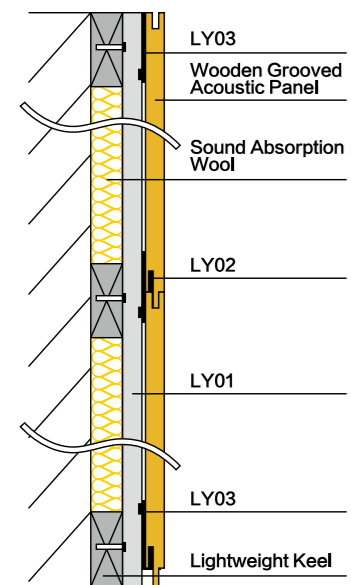

Cross-Section Structure

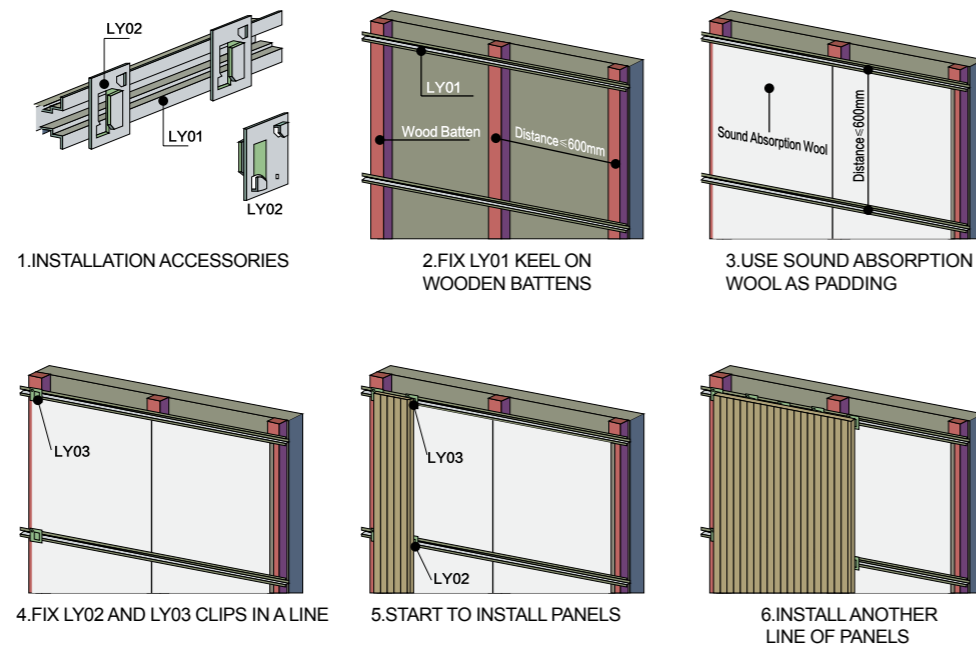

INSTALLATION: LIGHTWEIGHT STEEL KEEL SYSTEM

Leeyin® 6/2 Wooden Groove Acoustic Panel

Product Overview

Leeyin 6/2 is a powerful union between architecture and acoustical performance. Utilizing 3mm grooves in a high recycled content.

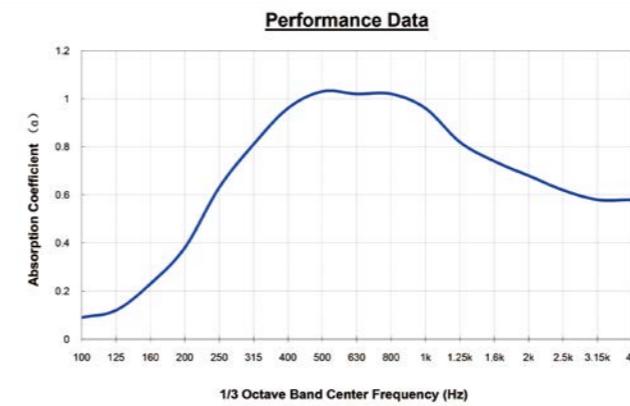

6/2 Wooden Groove Acoustic Panel

Frequency(Hz)	100	125	160	200	250	315	400	500	630	800	1000	1250	1600	2000	2500	3150	4000	NRC
Sound absorption coefficient(a)	0.09	0.12	0.23	0.38	0.63	0.81	0.96	1.03	1.02	1.02	0.96	0.82	0.74	0.68	0.62	0.58	0.58	0.80

Application:

Auditorium, Conference rooms, Office, Gymnasiums, Schools, Lecture Center, etc.



Leeyin® 16/16/6 Wooden Perforated Panel

Product Overview

16/16/6 panel is a simple union between perforations in a high recycled content. 16/16/6 focuses the sound absorption spectrum in the mid range frequencies while maintaining some of the higher frequencies.

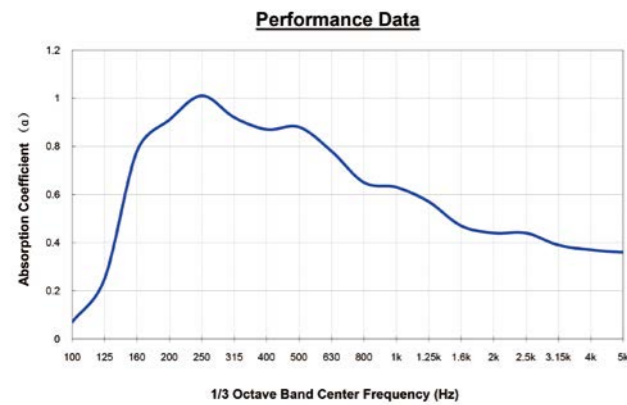

Technical Characteristics

- Basic Material: Normal MDF, E1MDF, FRMDF, Mgo Combination Board etc.
- Front Finish: Melamine, Natural Wood Veneer, Laminate, Paint, etc.
- Back Finish: Black Fleece.
- Standard Size: L600xW600mm, L1200xW600mm (alternate lengths and widths are available)
- Standard Thickness: 12/15/18mm
- Formaldehyde Emission: Can meet both China & EU Standard Class E1
- Flame Retardant: Can meet China Standard Class B, BS476 Part 7 Class 1, etc
- Pattern: 32/32/8; 32/32/6; 16/16/6; 16/16/6; 16/16/3; 8/8/3; 8/8/1; 10/10/1



16/16/6 Wooden Perforated Panel

Frequency(Hz)	100	125	160	200	250	315	400	500	630	800	1000	1250	1600	2000	2500	3150	4000	5000	NRC
Sound absorption coefficient(a)	0.07	0.25	0.78	0.91	1.01	0.92	0.87	0.88	0.78	0.65	0.63	0.57	0.47	0.44	0.44	0.39	0.37	0.36	0.75

Installation System I (with gap)

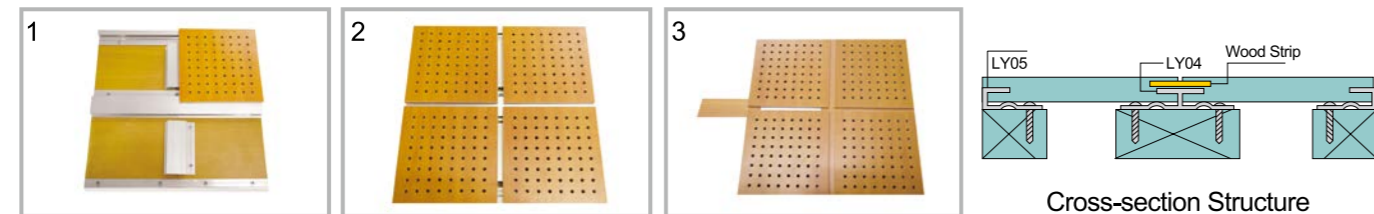

Installation System II (without gap)

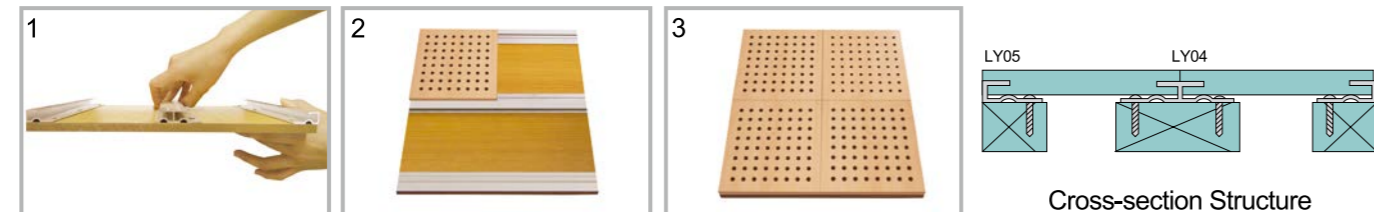

Installation for ceiling

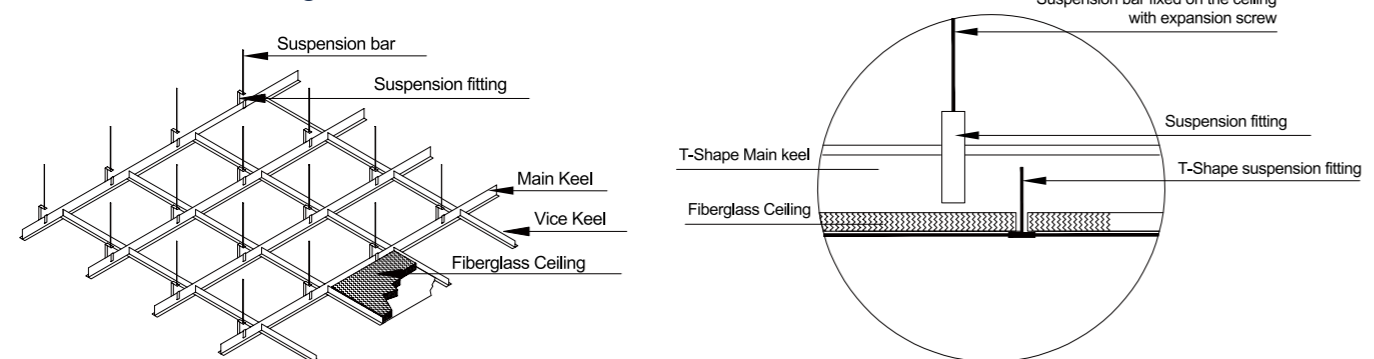

Leeyin® 32/32/8 Wooden Perforated Panel

Product Overview

32/32/8 panel is a simple union between perforations in a high recycled content. 32/32/8 focuses the sound absorption spectrum in the mid range frequencies while maintaining some of the higher frequencies.

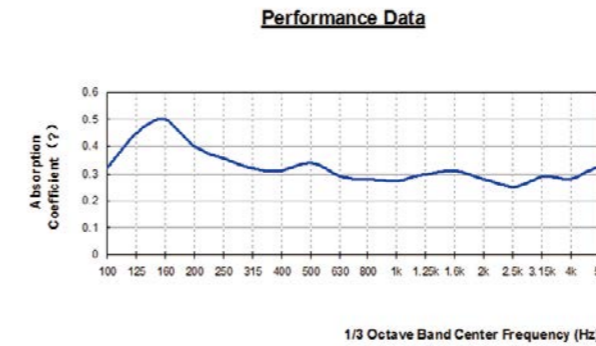

Technical Characteristics

- Basic Material: Normal MDF, E1MDF, FRMDF, Mgo Combination Board etc.
- Front Finish: Melamine, Natural Wood Veneer, Laminate, Paint, etc.
- Back Finish: Black Fleece.
- Standard Size: L600xW600mm, L1200xW600mm (alternate lengths and widths are available)
- Standard Thickness: 12/15/18mm
- Formaldehyde Emission: Can meet both China & EU Standard Class E1
- Flame Retardant: Can meet China Standard Class B, BS476 Part 7 Class 1, etc.
- Pattern: 32/32/8; 32/32/6; 16/16/6; 16/16/6; 16/16/3; 8/8/3; 8/8/1; 10/10/1

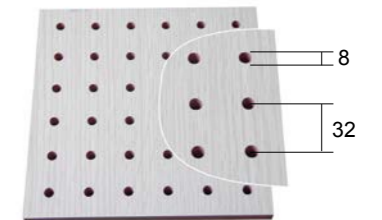

Leeyin 32/32/8 Wooden Perforated Panel

Frequency(Hz)	100	125	160	200	250	315	400	500	630	800	1k	1.25k	1.6k	2k	2.5k	3.15k	4k	5k	NRC
Sound absorption coefficient(a)	0.32	0.45	0.5	0.4	0.36	0.32	0.31	0.34	0.29	0.28	0.27	0.3	0.31	0.28	0.25	0.29	0.28	0.33	0.30

Application:

Auditorium, Conference rooms, Office, Gymnasiums, Schools, Lecture Center, etc.



Leeyin® 10/10/1 Wooden Perforated Panel

Product Overview

10/10/1 panel is a simple union between perforations in a high recycled content. 10/10/1 focuses the sound absorption spectrum in the mid range frequencies while maintaining some of the higher frequencies.

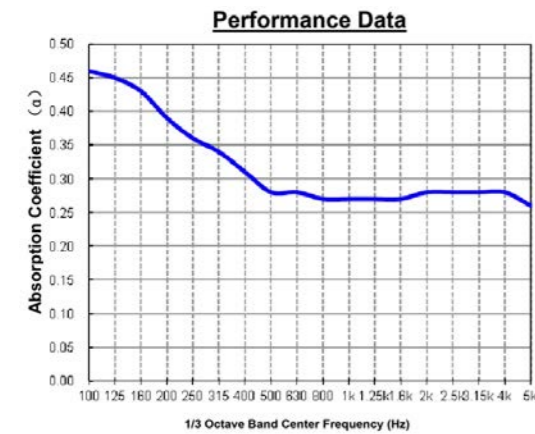

Technical Characteristics

- Basic Material: Normal MDF, E1MDF, FRMDF, Mgo Combination Board etc.
- Front Finish: Melamine, Natural Wood Veneer, Laminate, Paint, etc.
- Back Finish: Black Fleece.
- Standard Size: L600xW600mm, L1200xW600mm (alternate lengths and widths are available)
- Standard Thickness: 12/15/18mm
- Formaldehyde Emission: Can meet both China & EU Standard Class E1
- Flame Retardant: Can meet China Standard Class B, BS476 Part 7 Class 1, etc.
- Pattern: 32/32/8; 32/32/6; 16/16/6; 16/16/6; 16/16/3; 8/8/3; 8/8/1; 10/10/1

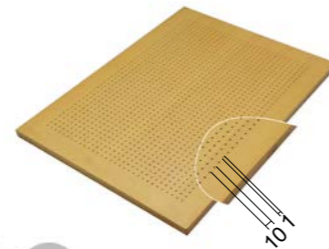

Leeyin 10/10/1 Wooden Perforated Panel

Frequency (Hz)	100	125	160	200	250	315	400	500	630	800	1000	1250	1600	2000	2500	3150	4000	5000	NRC
Sound absorption coefficient (α)	0.39	0.40	0.42	0.44	0.47	0.48	0.49	0.50	0.53	0.55	0.58	0.51	0.46	0.42	0.37	0.32	0.28	0.24	0.50

Installation System I (with gap)

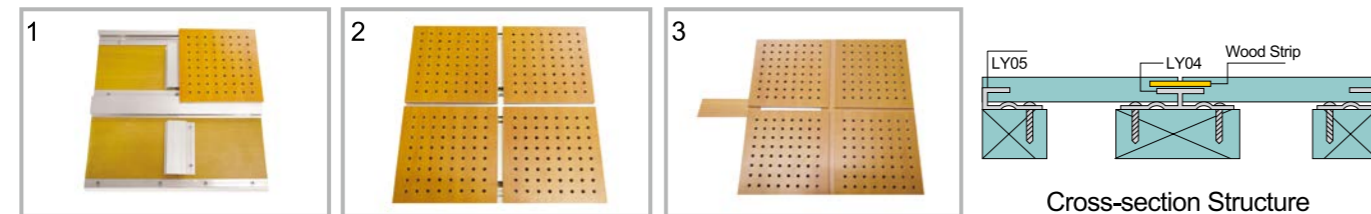

Installation System II (without gap)

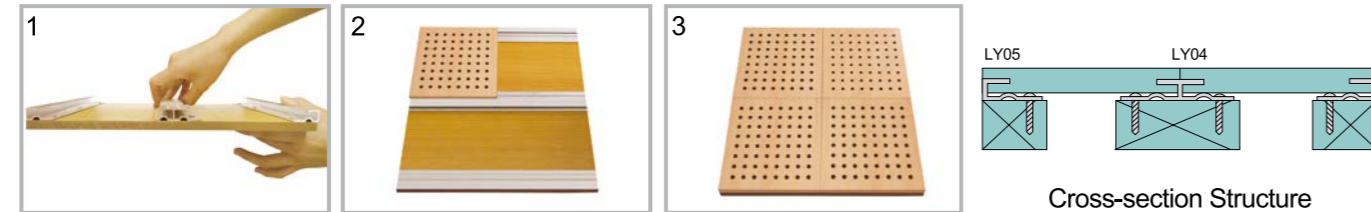

Installation for ceiling

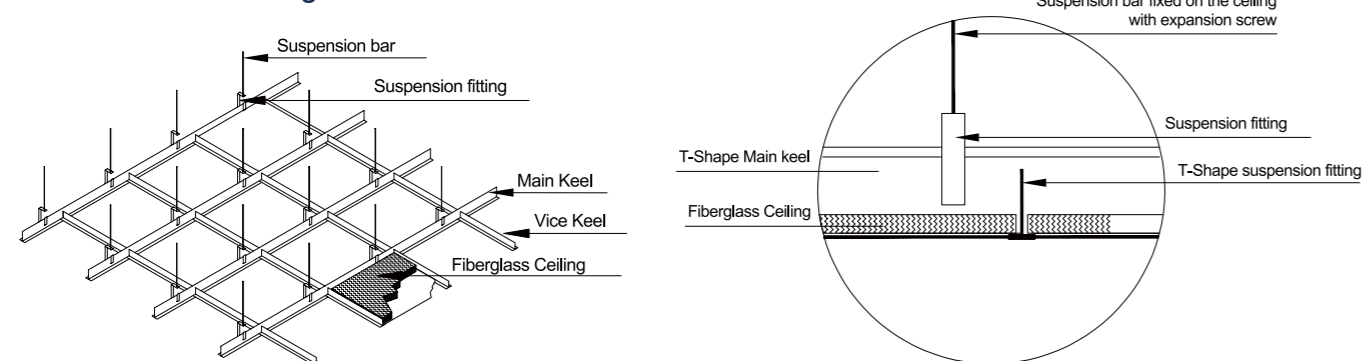

Leeyin® 8/8/1 Wooden Micro-Perforated Panel

Product Overview

8/8/1 panel is a simple union between perforations in a high recycled content. 16/16/6 focuses the sound absorption spectrum in the mid range frequencies while maintaining some of the higher frequencies.

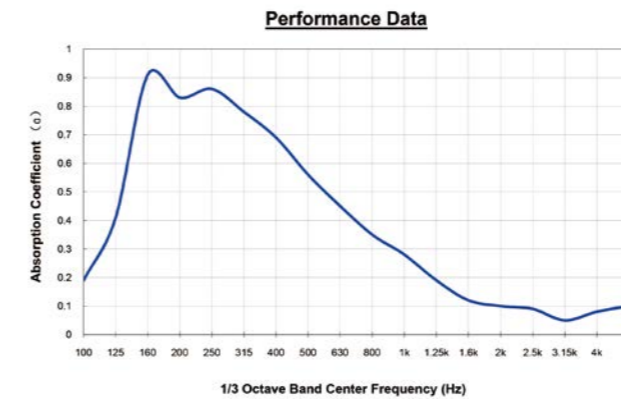

8/8/1 Wooden Micro-Perforated Panel

Frequency (Hz)	100	125	160	200	250	315	400	500	630	800	1000	1250	1600	2000	2500	3150	4000	5000	NRC
Sound absorption coefficient (α)	0.19	0.41	0.91	0.83	0.86	0.78	0.69	0.56	0.45	0.35	0.28	0.19	0.12	0.1	0.09	0.05	0.08	0.1	0.45

Application:

Auditorium, Conference rooms, Office, Gymnasiums, Schools, Lecture Center, etc.

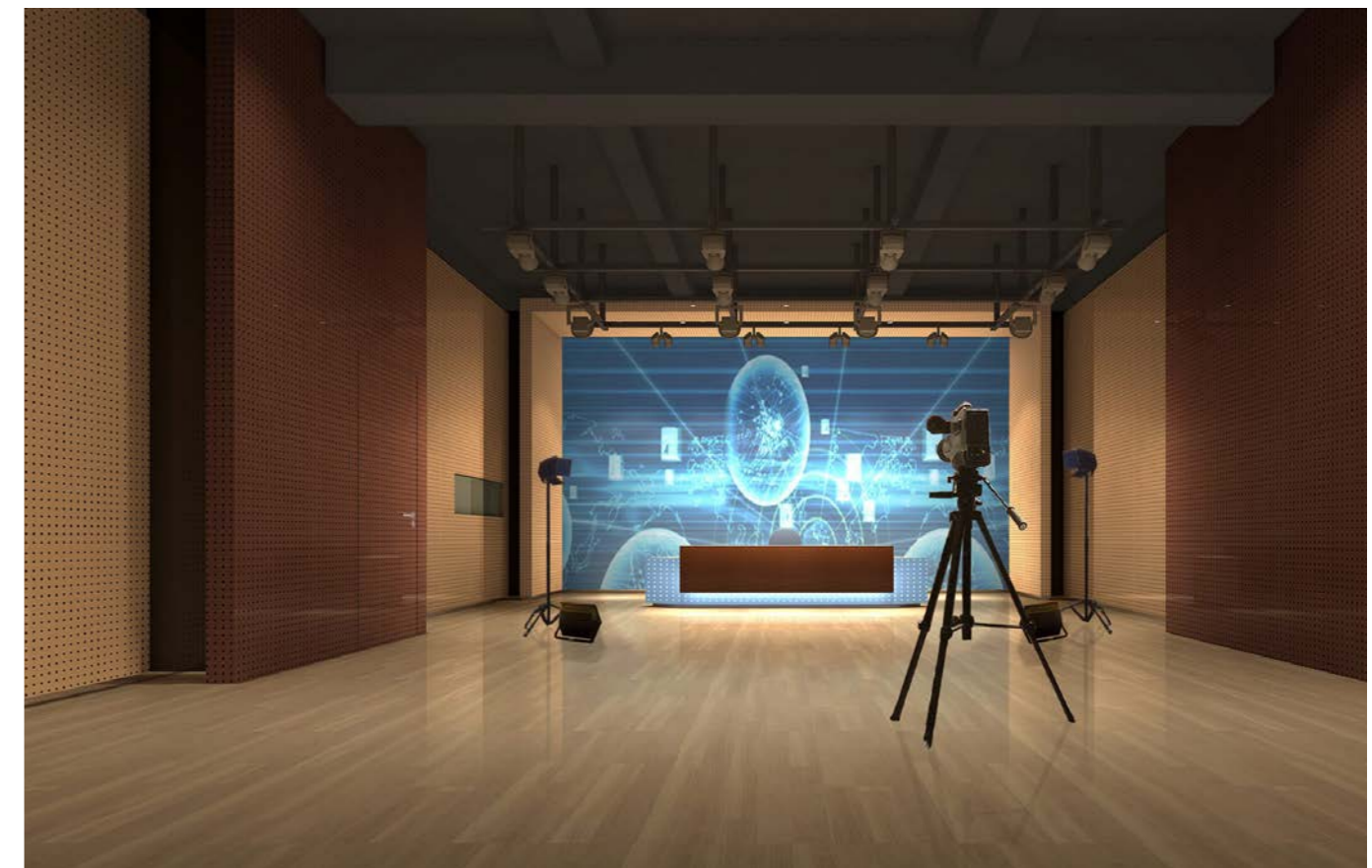

Leeyin® Pattern Wooden Acoustic Panel

Wooden Perforate Acoustic Panel is a kind of wooden acoustic panels with holes and both front and back side. The holes can be drilled from the surface directly to the back or the holes in the surface are small while on the back are big. The diameters of the holes on two sides are different. It is widely used for walls and ceilings.

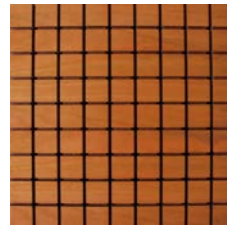

Cross Grooves

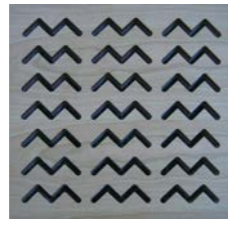

M Pattern

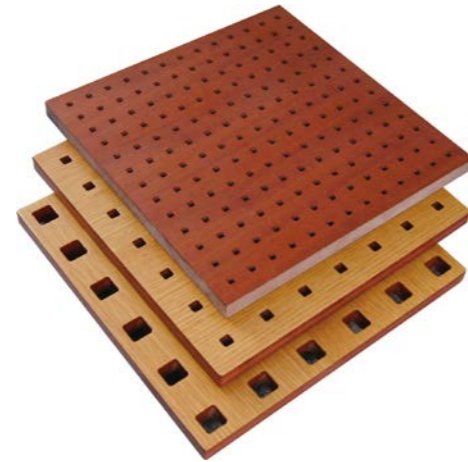

Square Holes

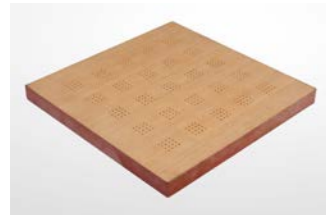

Group Square Holes



Animal Shapes



U Pattern

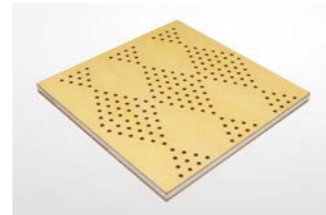

Rhombus Pattern



Long Slots



Leeyin® Sound Diffuser

Sound diffusion is the efficacy by which sound energy is spread evenly in a given environment. A perfectly diffusive sound space has certain key acoustic properties which are the same anywhere in the space. A non-diffuse sound space would have considerably different reverberation time as the listener moved around the room. Acoustic diffusers can not only as sound diffusion, but also remove coloration and echoes. Sound diffusers are often used in combination with other materials such as sound absorbers, bass traps, ceiling clouds or other provisions to achieve the desired results for the application. They are often used in music training rooms, recording rooms, churches, multi-functional rooms, theatres, concert halls and so on.



1D QRD Diffuser
600x600mm



2D QRD Diffuser
600x600mm



Circle Pyramid Diffuser
600x600mm



Triangular Oblique Pyramid Diffuser
600x600mm



Mosaic Diffuser
600x600mm



Conical Diffuser
600x600mm



Pyramid Diffuser
600x600mm



Polyhedral Cone Diffuser
600x400mm



Diffuser for Hong Kong Academy Report Hall



Leeyin® Wooden Decorative Panel

If no perforation is made on the panel, wooden perforated acoustic panel becomes wooden decorative panel with no sound absorption effect. Wooden decorative panel is widely used as wall panel in hotels, exhibition halls, offices, traffic stations, hospitals, etc.

Specifications

- Structure: Base Material, Finish & Back Finish
- Basic Material: E1 MDF, Fr MDF, MgO Combination Board etc
- Front Finish: Melamine, Natural Wood Veneer, Paint, etc
- Back Finish: Black Fleece
- Standard Size: 600x600, 1200x1200, 2440x1200mm
- Standard Thickness: 12/15/18mm
- Formaldehyde Emission: Can Meet Both China & EU Standard Class E1
- Flame Retardant: Can Meet China Standard Class B, Bs476 Part 7 Class 1 etc



Leeyin® Noise Barrier

Noise barrier is mainly used in the construction site, help to prevent noise propagation to the neighborhood and reduce the work area noise. It not only provides workers with a better environment, but also avoids complaints from nearby people, especially when your project is in the city center. Based on strict acoustic principle, Leeyin noise barrier is of high quality and stability and the performance will not degrade because of the changes in the rain or the sun. It's perfect for your construction site noise control.

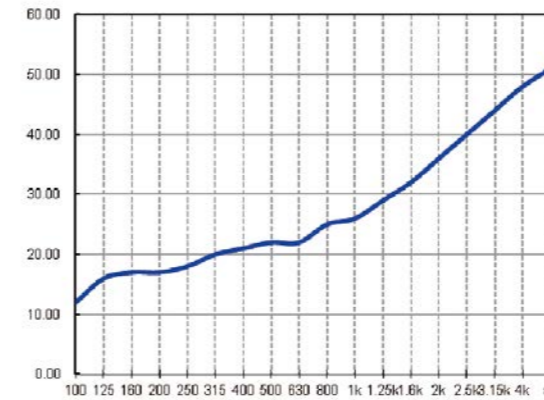

Leeyin Noise Barrier

Frequency(Hz)	100	125	160	200	250	315	400	500	630	800	1000	1250	1600	2000	2500	3150	4000	5000	STC
STC	12	16	17	17	18	20	21	22	22	25	26	29	32	36	40	44	48	51	27

Features:

- Standard Size: 2400x1000mm or Customized,
- Thickness: 18mm&15mm
- WaterProof
- Fireproof & Non-Fireproof
- Weight: 5.8kg/m²
- Type: Roll
- Colour: Glue, Green
- Application : Construction Site , Factory, etc



Leeyin® Movable Partition Walls

LEEYIN movable partition walls have unparalleled quality, design flexibility, acoustic performance and lasting durability. Proudly manufactured in the Guangzhou, LEEYIN movable partition walls with aluminum frame have the most widespread application. The partition is constituted by a set of flat panel whose width ranges from 700mm to 1200mm. The panel is provided with various specifications and characteristics to satisfy most requirements of design and budget. Its thickness can be 65mm, 80mm or 100mm. Additionally, each model comes with different grades of sound insulation as well as single or paired hinges. LEEYIN movable partition walls can be designed with the industry's most comprehensive range of dimensions, performance options, and decorative finishes. Increasingly, efficient space utilisation becoming a must for offices, hotels, exhibition centres, studios and so on

Features:

- 1、Hanging on ceiling
- 2、Excellent Quality
- 3、Stable and secure
- 4、Energy efficient
- 5、Heatproof & fireproof
- 6、Elegant appearance
- 7、Easy to collect
- 8、Various applications



Pattern 65 Fabric Surface



Pattern 80 Melamine Surface



Pattern 100 Solid Wood

Basic Board	Hoisting Weight (kg/m ²)	Sound Insulation Coefficient Appr(db)	Frame Material	Track Loading Weight(Kg/m)	Retractable Range of top/bottom(mm)	(mm)		
						(Min/Max) Width	(Min/Max) Height	Thickness
MgO Board	24	32	Aluminium	225	22.5	500~1200	2000~3500	65
MDF Board	24							
Melamine Board	24							
MgO Board	33	40	Aluminium	450	22.5	500~1200	2000~5200	80
MDF Board	32							
Melamine Board	32							
MgO Board	42	50	Aluminium	675	22.5	500~1200	2000~9000	100
MDF Board	38							
Melamine Board	38							

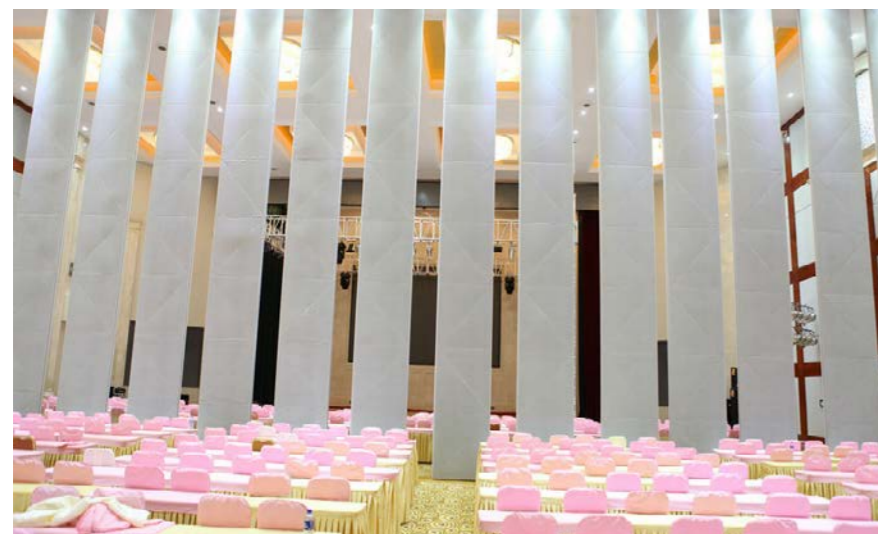

Leeyin® Movable Partition Installation System

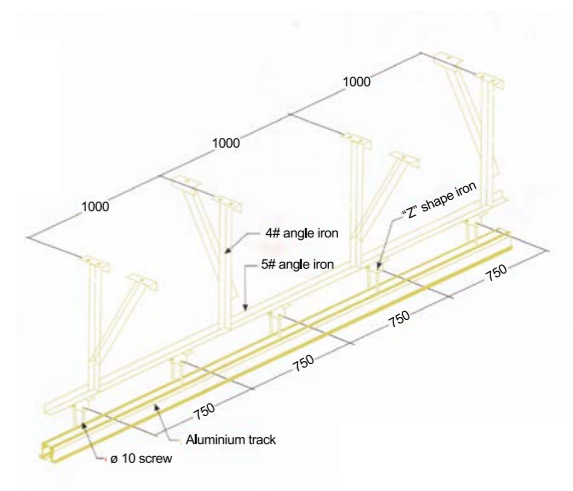
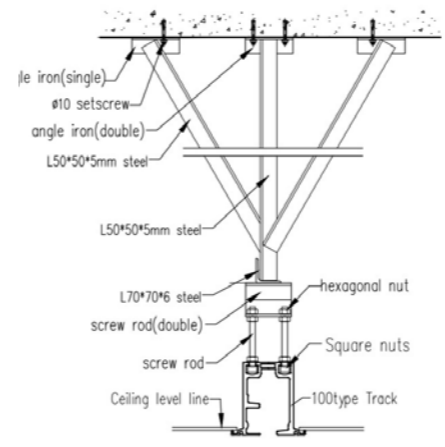
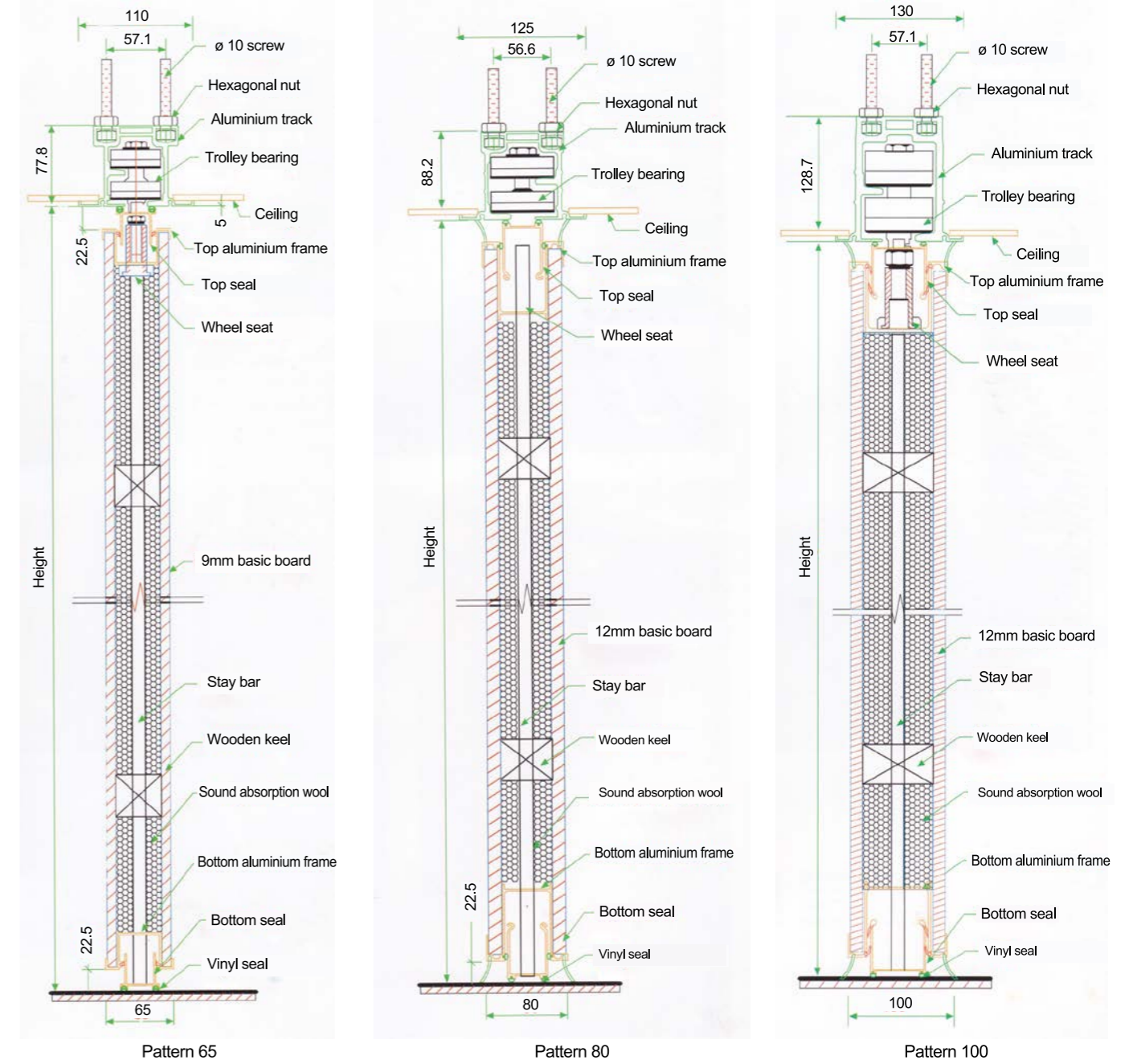

Leeyin® Movable Partition

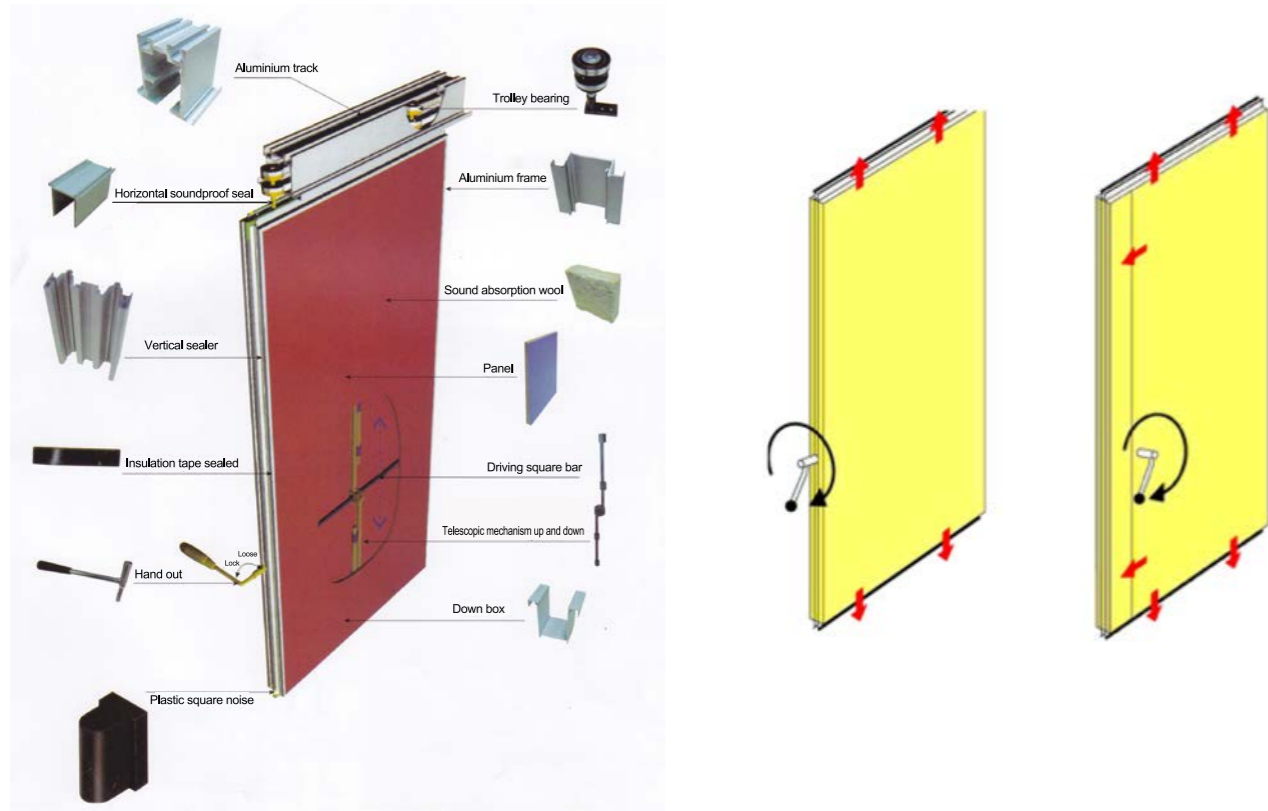

Partition Element

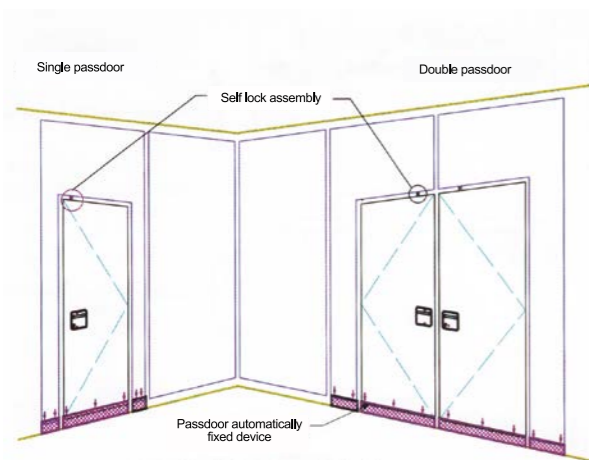

The sealing device on board of the passedoor can automatically open when the wicket is opened, and automatically seaf when the wicket is closed without handle operation needed prociding customers with excellent sound insulation effect.

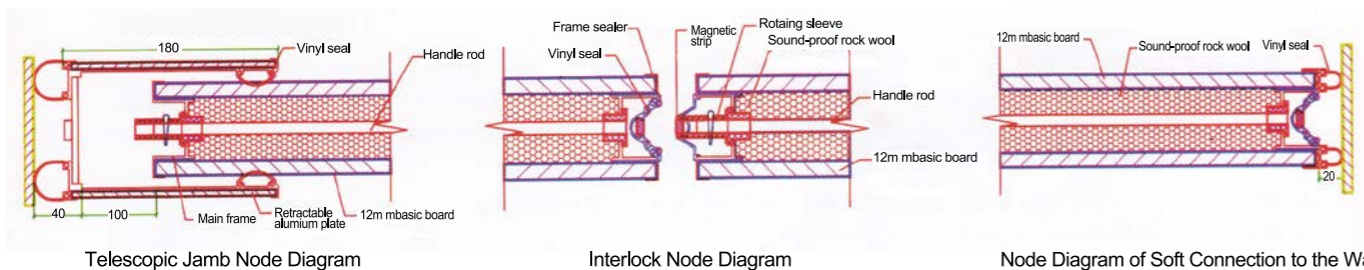

Telescopic Jamb Node Diagram

Interlock Node Diagram

Node Diagram of Soft Connection to the Wall

Leeyin® Movable Partition

Stacking Partitions Options

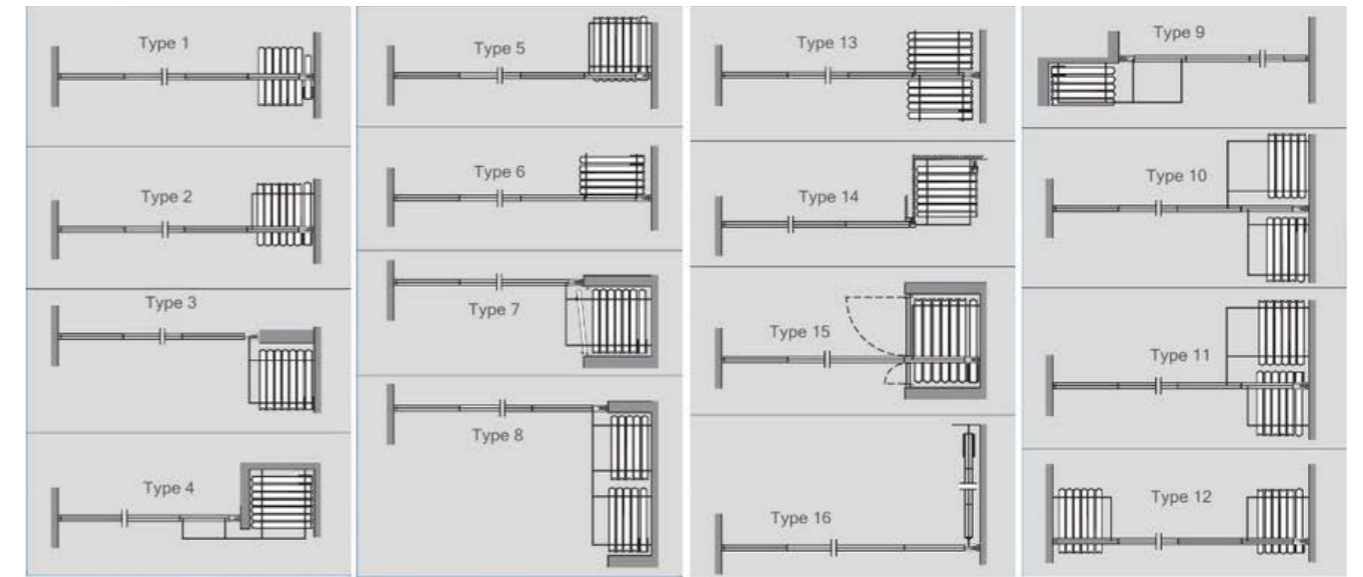

3D Wall-Stacking Example



Leeyin® Fabric Wrapped Acoustic Panel

Fabric acoustic panels have excellent acoustic performance in both mid and high frequency sound. They are decorative and easy to install. The fabrics on the surface are available in different types and a wide range of colors and patterns. Customers can also provide their own fabrics and designs, and the panels can be made into different shapes.

Specifications

- Structure: infill material, finish and frame
- Infill material: glass wool (default), polyester wool, melamine foam, etc
- Finish: fabric
- Frames: resin frame, MDF frame, aluminium frame
- Standard size: 600mmx600mm, 1200mmx600mm
- Standard thickness: 25mm, 50mm
- Acoustic principle: Porous absorption
- Flame retardant: non-fireproof(default), fireproof(available)



performance data

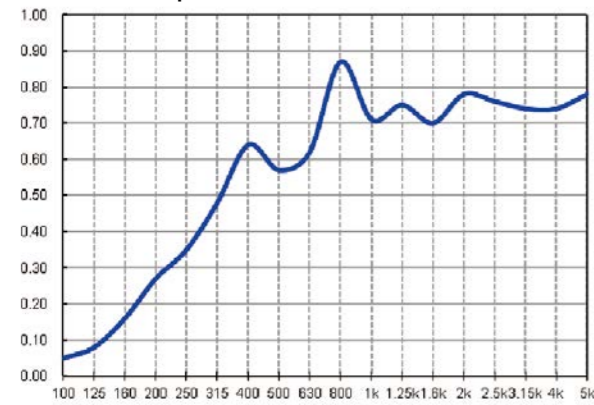

Edge Types

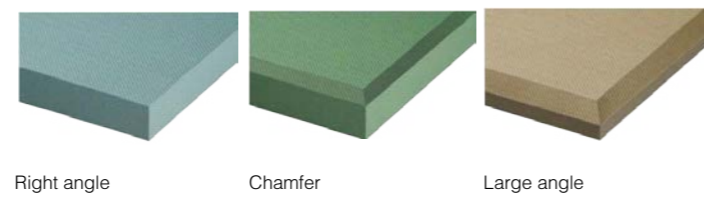

Leeyin Fabric Wrapped Acoustic Panel

Frequency(Hz)	100	125	160	200	250	315	400	500	630	800	1000	1250	1600	2000	2500	3150	4000	5000	NRC
Sound absorption coefficient(a)	0.05	0.08	0.16	0.27	0.35	0.48	0.64	0.57	0.62	0.87	0.71	0.75	0.70	0.78	0.76	0.74	0.74	0.78	0.60



Leeyin® Suspending Absorber For Ceiling

Suspended absorbers have similar structure with fabric acoustic panel. They are mainly made up of fabric, glass wool and MDF(or metal frame). A variety of styles are available.

There are pyramid style, cross style, arc style, barrel style, etc. Because of the high acoustic absorption performance, they are often used as suspended ceiling in various of projects

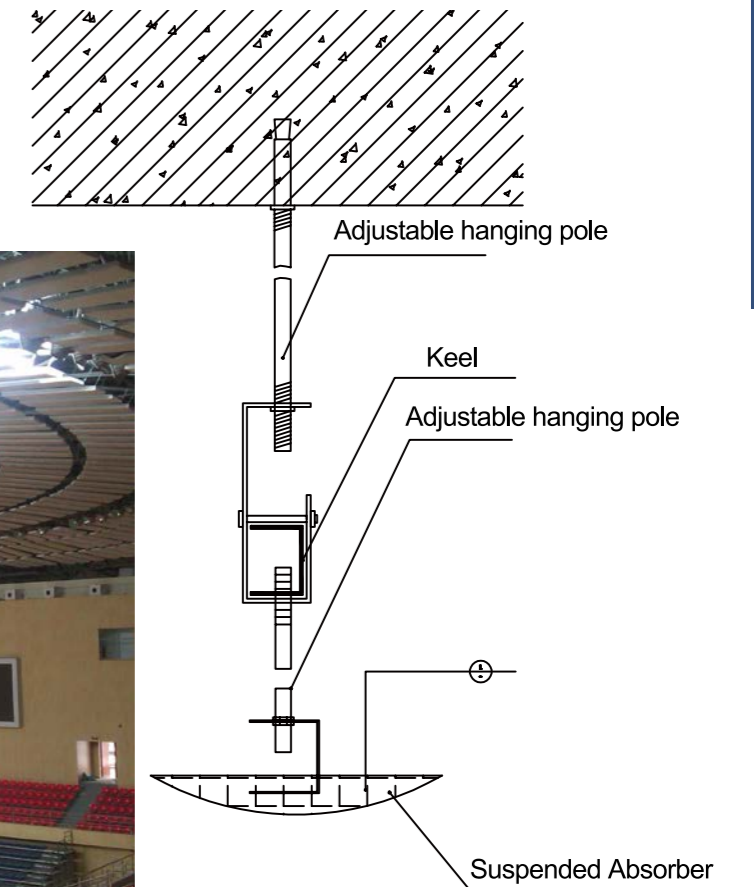

Installation:

Use expansion screws, hanging poles etc.



Application:

Gymnasium, theater, factory, etc

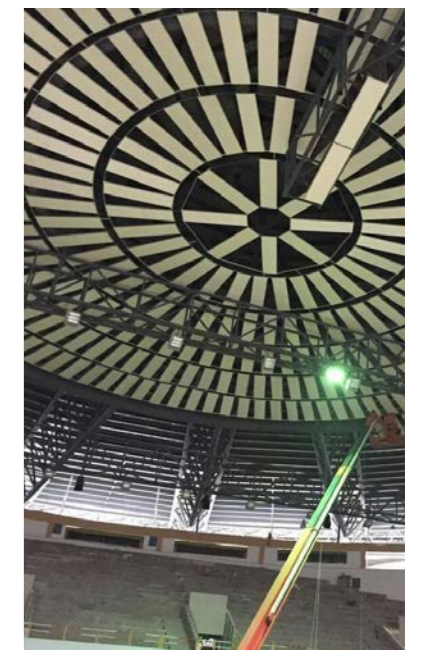
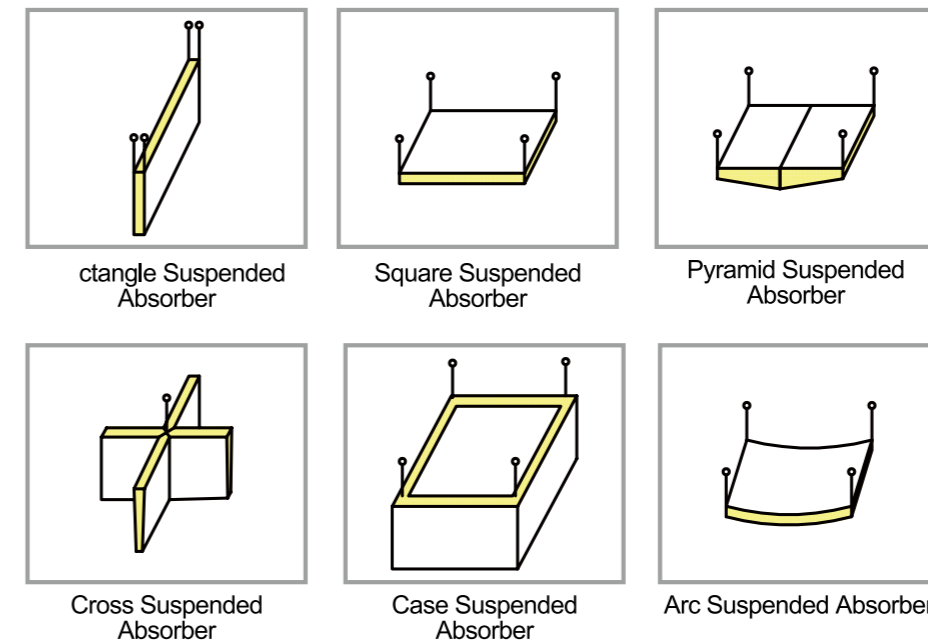

Leeyin® Polyester Fiber Acoustic Panel

Polyester fiber panel is made of 100% polyester fiber. It is a good acoustic and decorative material with characteristics of environmental friendly, heat insulation, mildew proof, easy cutting, easy removal and simple installation etc. There are varieties of patterns and colors and can be used to meet different styles and requirements.

Specifications:

Material: polyester fiber
 Standard thickness: 9mm/12mm
 Size per piece: 1220mmx2420mm
 Fire retardant: available
 Customization: color, pattern,size, thickness,etc, are available for customization.
 Installation: use glue,nail or velcro



Features:

- Made of 100% polyester fiber.
- With excellent sound absorbing performance. The NRC can be up to 0.94.
- Easy to cut by knife
- Easy to install by glue or nail
- Good physical stability, will not inflate or shrink due to the change of temperature
- Soft and natural texture. It will not get broken under huge impact of high elasticity.
- Easy dust removal and easy maintenance by vacuum cleaner or feather duster.
- Can customize 3D polyester panel

Leeyin Polyester Fiber Acoustic Panel

Frequency(Hz)	100	125	160	200	250	315	400	500	630	800	1000	1250	1600	2000	2500	3150	4000	5000	NRC
Sound absorption coefficient(a)	0.11	0.15	0.18	0.26	0.37	0.47	0.58	0.69	0.84	0.95	0.95	1.10	1.13	1.02	0.99	0.91	0.91	1.13	0.75



Edges: square or beveled



Leeyin® Polyester Fiber Acoustic Panel



Leeyin® Wood Wool Acoustic Panel

Wood wool acoustic panel is made of wood fiber, cement and minerals under high temperature and high pressure. There are countless pores inside of the panel, which can absorb noise. It is not only with great acoustic and decoration properties, but also is environmental friendly and human friendly.

Different painted colors are available by request

Specification:

Standard size:
1220mmx2440mm, 1200mmx600mm, 600mmx600mm, etc
Standard thickness: 15mm/20mm/25mm
Fire retardant: B1
Density(Kg/m3): 300 ~ 330
Thickness Expansion (Immersion in water 24hrs) <2%
Thermal conductivity 0.108 kcal/m x r x °C
Thermal conductivity 0.108 kcal/m x r x °C
Moisture proof: can be used in humidity up to 90%.
Heat resistance: The product can be used in temperature up to 200 degree.
Impact resistance: with good property of impact resistance, can be used in all kinds of ball room and gymnasium.



Performance Data

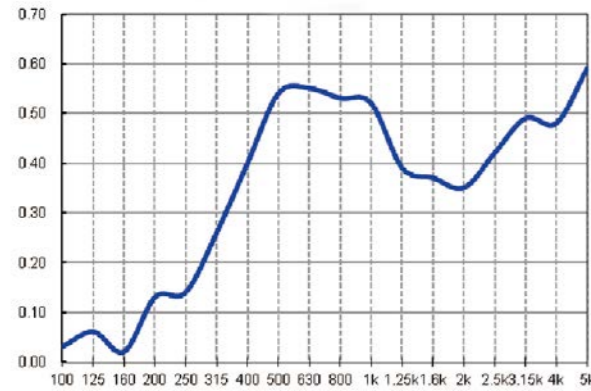

Leeyin Wood Wool Acoustic Panel

Frequency(Hz)	100	125	160	200	250	315	400	500	630	800	1000	1250	1600	2000	2500	3150	4000	5000	NRC
Sound absorption coefficient(a)	0.03	0.06	0.02	0.13	0.14	0.26	0.40	0.54	0.55	0.53	0.52	0.39	0.37	0.35	0.42	0.49	0.48	0.59	0.40

Customized Model:

Hexagon Wood Wool Panel



Application:

It is widely used in conference room, office, hotel lobby, theater, etc.



Leeyin® Mass Loaded Vinyl



Leeyin Mass Loaded Vinyl is a good sound blocking material that resists the passage of sound waves and reduces the transmission of airborne noise. It is widely used in places that need soundproofing.

Specifications:

Material: PVC, etc
Standard thickness: 1.2mm, 2mm, 3mm
Standard size per roll: 1m x 10m, 1.2m x 5m
Customization: thickness can be 1.2~5mm, maximum width is 1.3m, length can be customized.

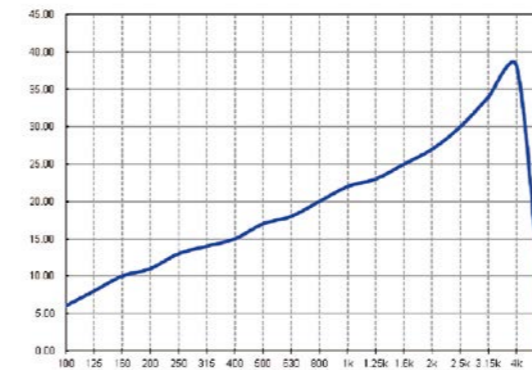

Leeyin Mass Loaded Vinyl

Frequency(Hz)	100	125	160	200	250	315	400	500	630	800	1000	1250	1600	2000	2500	3150	4000	5000	STC
STC	6	8	10	11	13	14	15	17	18	20	22	23	25	27	30	34	38	20	20

Installation

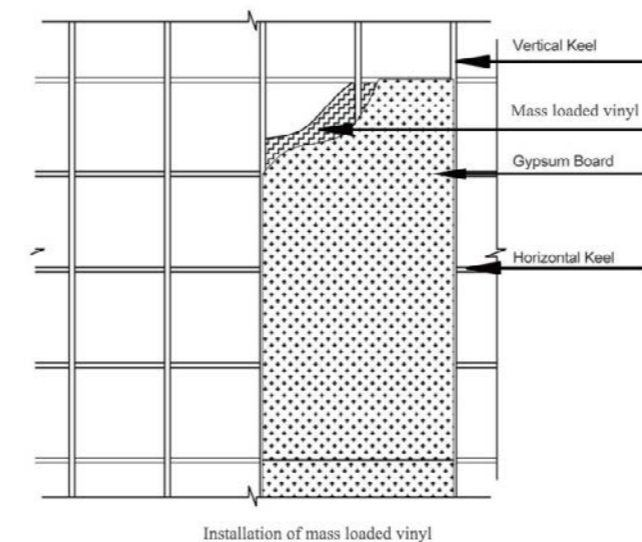

Leeyin® Fiberglass Ceiling

Fiberglass ceiling is made of fiberglass and acoustic transparent wrappage. The fiberglass ceiling has good noise absorption effect and good decoration effect.

Application

Fiberglass ceiling can be widely used in office, shopping mall, hall, classroom, etc. This ceiling material can absorb noise with the fiberglass in it.



Features

- Easy to install, light weight
- Good noise absorption effect
- Good decoration effect
- environment friendly, human friendly
- Size: 600x600mm, 600x1200mm
- Color: white, black, grey, etc.

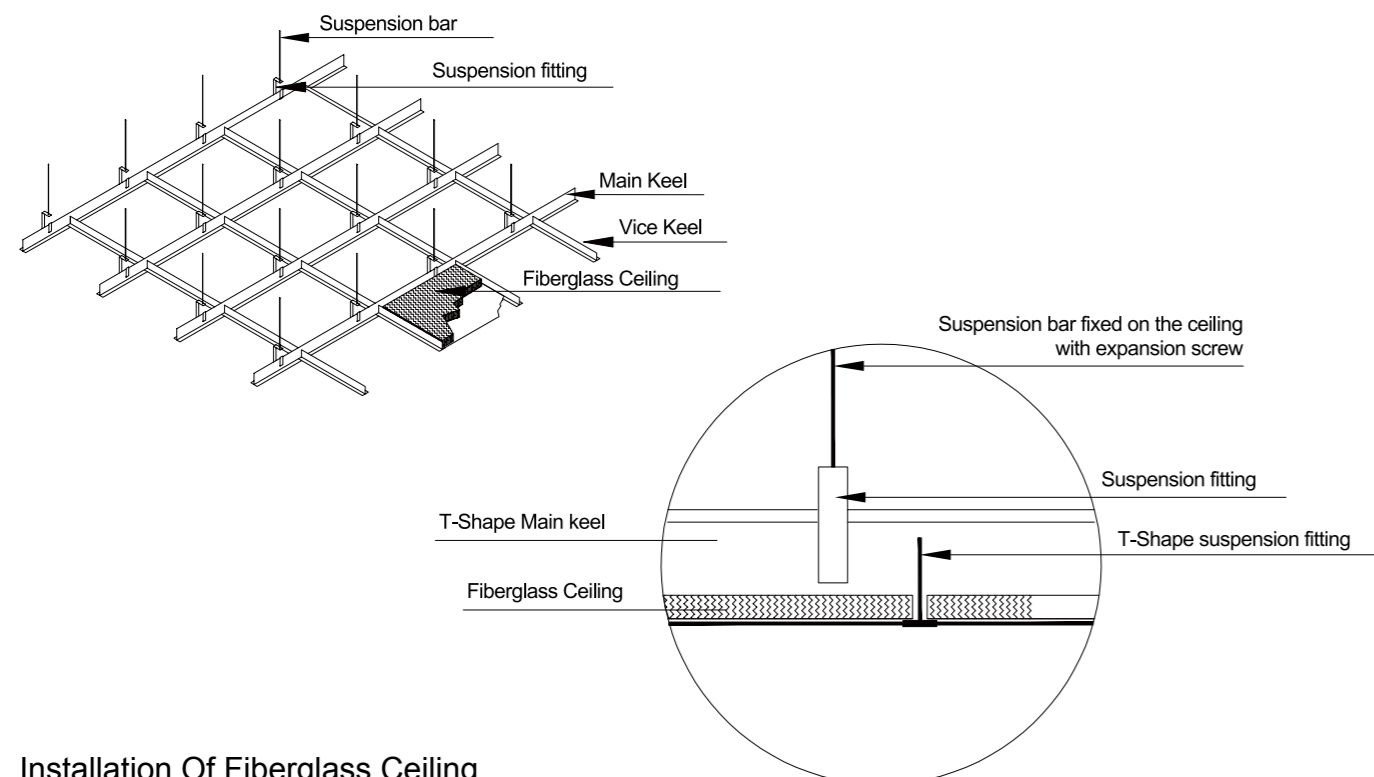
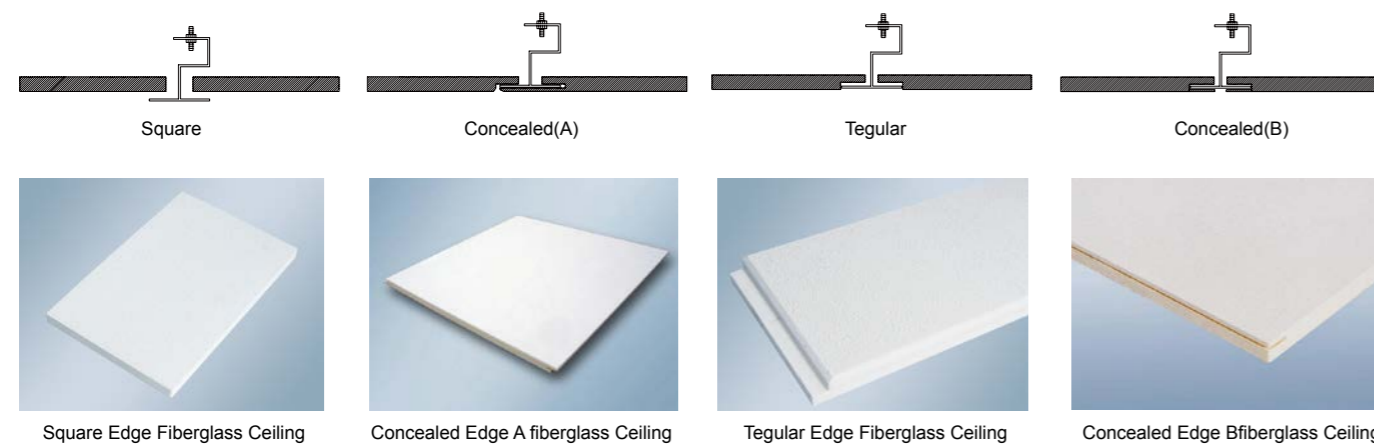

Installation Of Fiberglass Ceiling

Leeyin® Mgo Sound Insulation Board

The basic board materials are the environment-friendly board materials which are made in one product modeling by using the modern new technology after many years of research and technical innovation. The materials has a wide scope of application. It can replace the wooden board. That is, it can be applied in the indoor partition wall and ceiling decoration in office buildings, hotels and malls etc, and also be used in such industries as furniture manufacturing, fireproofing doors and ventilation pipes and other industries where board materials are needed.

Specifications :

1. Thickness(mm): 3-20
 2. General Size(mm) 915 x 1830/1220 x 2300/1220 x 2440/1220 x 3000
 3. Color: White/Grey
 4. Type: Normal/Fire proof reinforce
- *Other special size can be made according to the customer's requirement



Features :

- 100% free of asbestos, no smoke or poison in case of fire, creating a green and healthy living space.
- Superstrong heat insulation performance, which saves cold and hot energy.
- Good fireproofing performance, with incombustibility reaching Grade GB8624-2006A1.
- Fast and convenient construction, which improves working efficiency.
- The basic materials have high strength, good stability and good flexibility without and deformation.
- Superior sound insulation performance, which ensures peaceful and environment.
- Water resistant and moisture resistant, free from the impact of condensed bead or moist air.
- The board is light, ageing-resistant and has a long performance life.
- Protection against mould, bacterium, insects and termites.

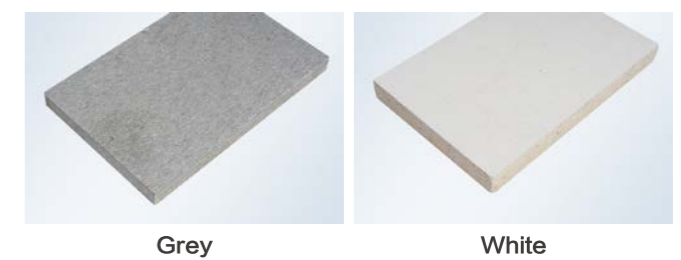
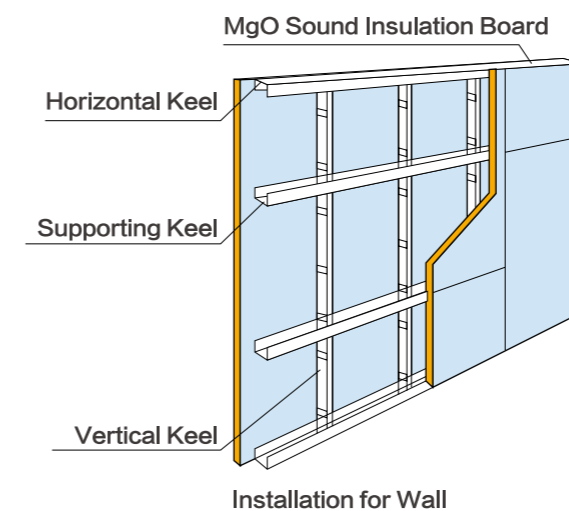
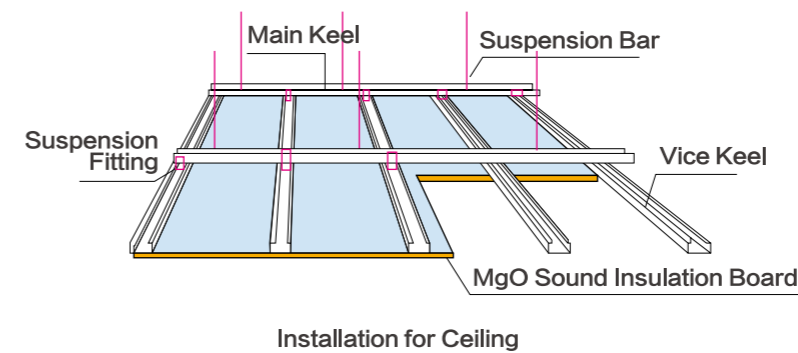

QPLAN® Art Acoustic Panel

In the advent of newer and refined technology, interior designs look beyond traditional designs, and look toward personalisation in sound-absorbing panels. QPLAN art panels incorporates bold innovation and designs in traditional sound-absorbing panels. Each QPLAN art panel is manufactured with precision, carefully processed and selected with a combination of technology and craftsmanship; best for personalised use

Features:

- Unique specifications
- Personalized customization
- Effectively shorten and adjust the indoor reverberation time
- Eliminate echo to improve hearing conditions
- Effectively reduce the resonant frequency on the sound absorption coefficient



Product Display

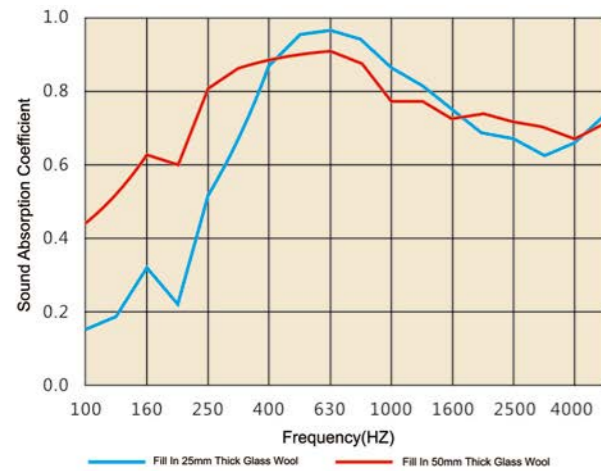

Specification

Finish: Melamine Wood Veneer HPL Painting
 Core Material: Eco-friendly MDF, Fireproof MDF, Solid Wood, Bamboo Board
 Size: 1215x300mm
 Thickness: 12/15/18mm
 Formaldehyde Emission: Meet class E1/E0, GB18580
 Flame Retardant: Meet class A1/A2/B/C, GB8624

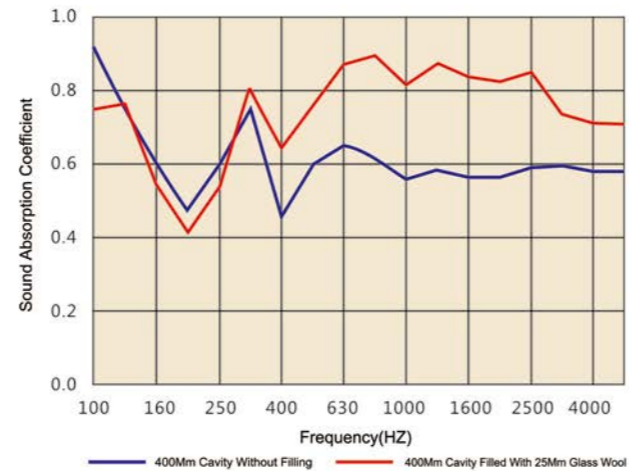

QPLAN® Art Acoustic Panel

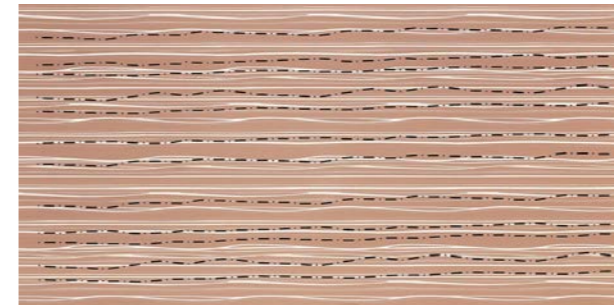

LYE001

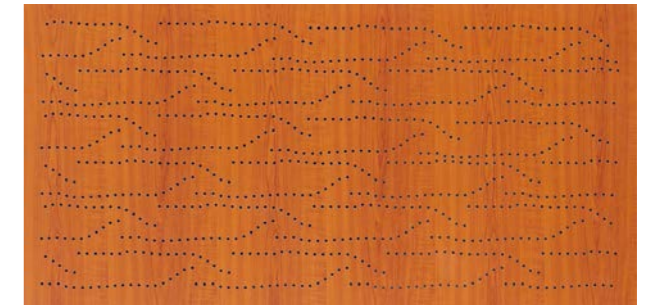

LYE002

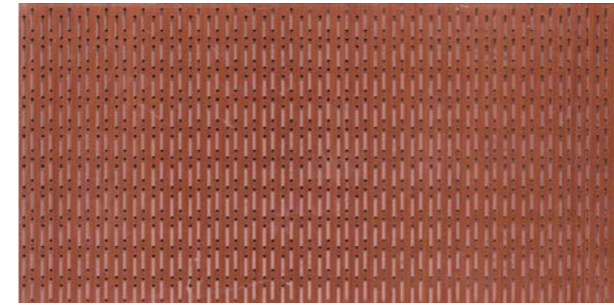

LYE003

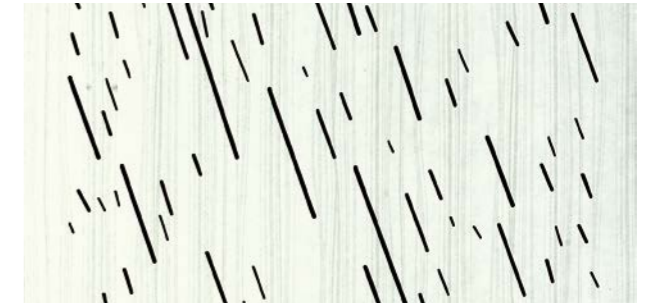

LYE004

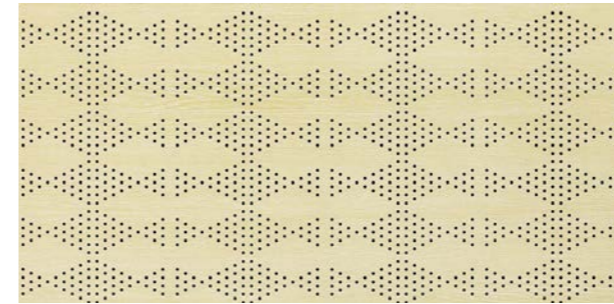

LYE005

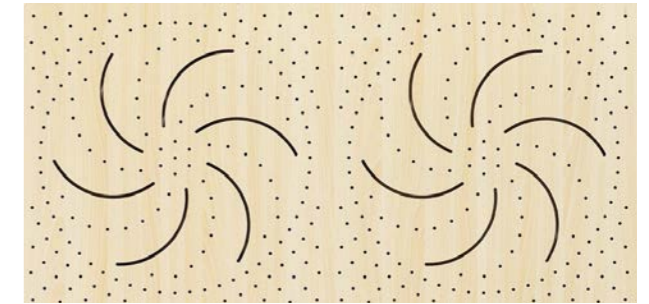

LYE006

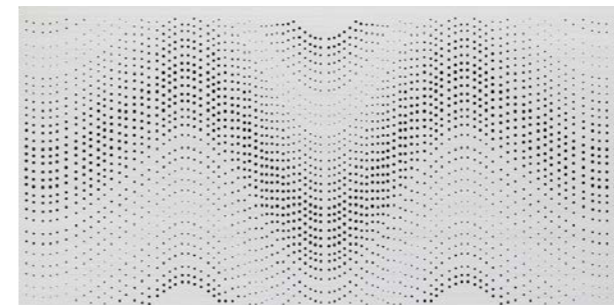

LYE007

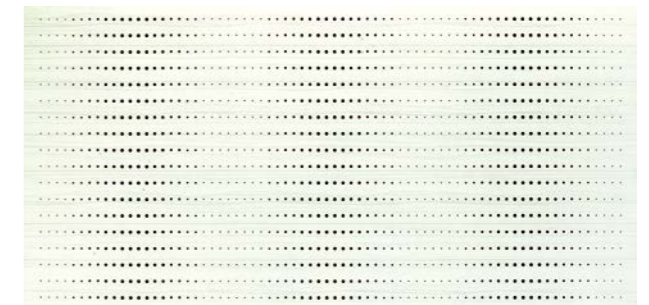

LYE008

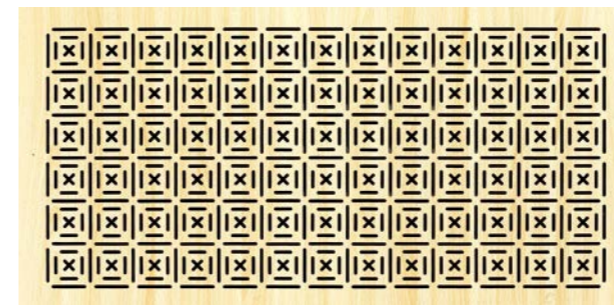

LYE009

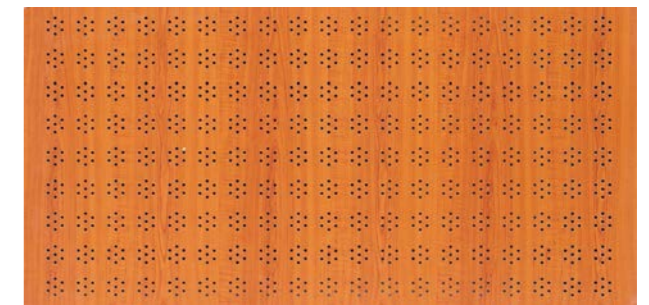

LYE010

QPLAN® Art Acoustic Panel

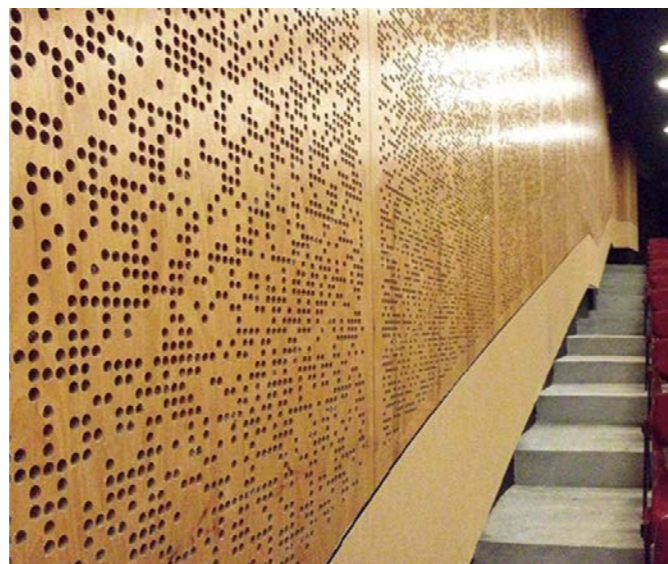
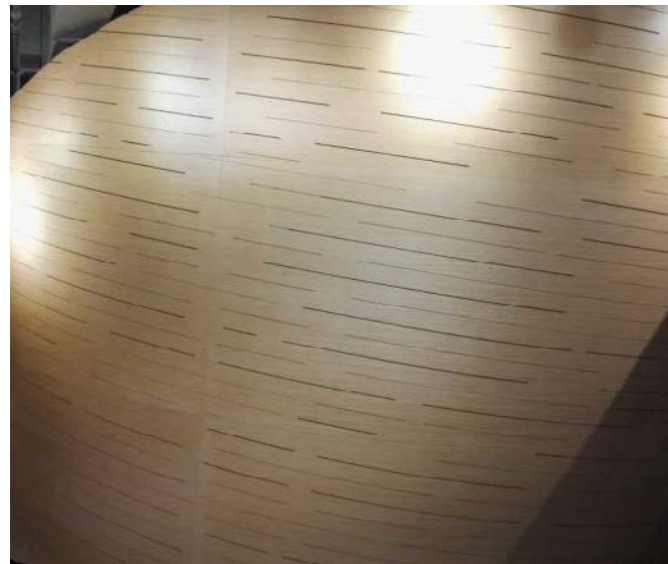

QPLAN® Soundproof Door

With the continuous improvement of people's living standards, the acoustic requirements for living environment are getting higher and higher. Due to the gaps within the door itself, it is a weak link in the architectural acoustic structure. In order to provide more comfortable and privacy space, most of the hotels and family rooms are now using soundproof doors. Leeyin soundproof doors are perfect solution for all kinds of noise pollution and sound quality control problems, and always in the industry's leading position.

All kinds of standard and non-standard soundproof doors are rated for noise level in the factory. The noise door kit includes: door, door frame, seal, decorative accessories and hardware accessories (According to customer requirements). You are rest assured to order and use.

Product Specifications

Door frame specifications: 910x2100mm, 1500x2100mm

Door thickness: 45-90mm

Acoustic performance: Rw 25 - Rw 45 (STC 25 - STC 45)

Hardware accessories: self-drop seal for bottom of the door, the strip for door side, door locks, door closers (optional)

Finishes: natural veneer, technology veneer, HPL, environmental protection paint, powder coating, etc.

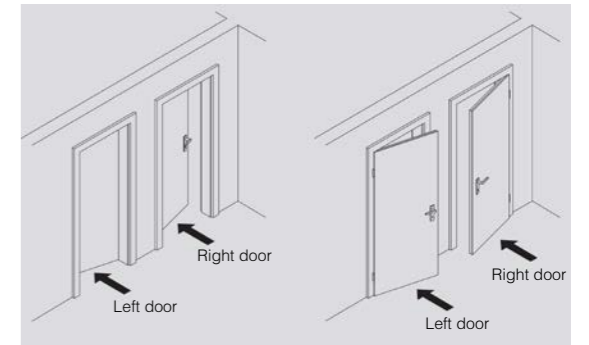

Application

Industry: generator room, refrigeration room, pump room and so on.

Business: recording studio, piano practicing room, KTV room, conference room and so on.

Family: home theater, HIFI audio-visual room, study room, piano room and so on.



QPLAN® Elevator room noise Reduction system

Noise Source For Elevator

- 1.The operation of elevator tractor will cause the vibration noise.
- 2.The friction between elevator and the cage guide during the ascending and descending period will cause the vibration noise.

Noise Reduction Solution

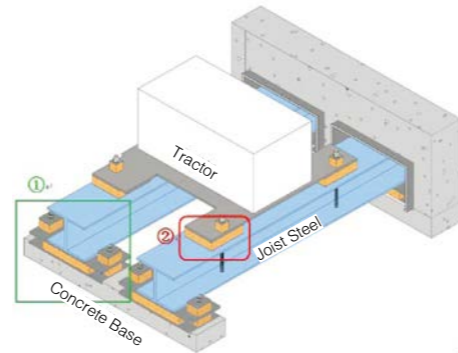
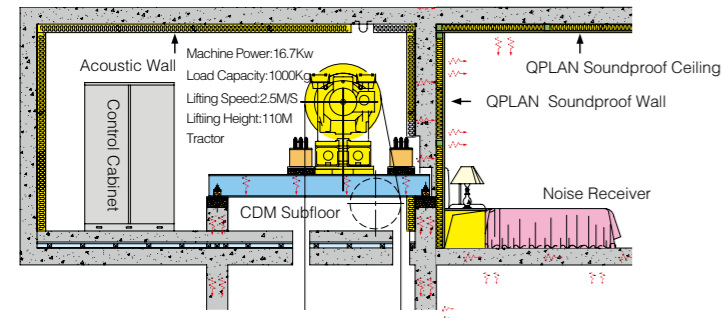

The elevator noise reduction system is the soundproof solution targeting at solving the elevator tractor vibration noise. Based on the structure and operation characteristics of the tractor,the solution applies double vibration isolation method to reduce the vibration noise. The first vibration isolation is between the joist steel and the concrete base. The second vibration isolation is between the joist steel and the tractor. After the double vibration isolation,the vibration noise is controlled effectively.

The first vibration isolation
The second vibration isolation

The vibration isolation system includes three components
1.Isolator
2.Stabilizer
3.Washer



QPLAN® Elevator room noise Reduction system

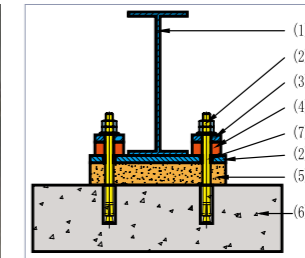

The First Vibration Isolation

Icon
(1)joist steel
(2)embedded bolt
(3)15mm steel plate
(4)stabilizer
(5)isolator
(6)concrete base
(7)washer

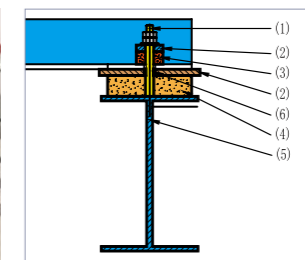

The Second Vibration Isolation

Icon
(1)embedded bolt
(2)15mm steel plate
(3)stabilizer
(4)isolator
(5)concrete base
(6)washer

After The Elevator Room Noise Reduction System Of Traction Machine Vibration And Noise Improvement

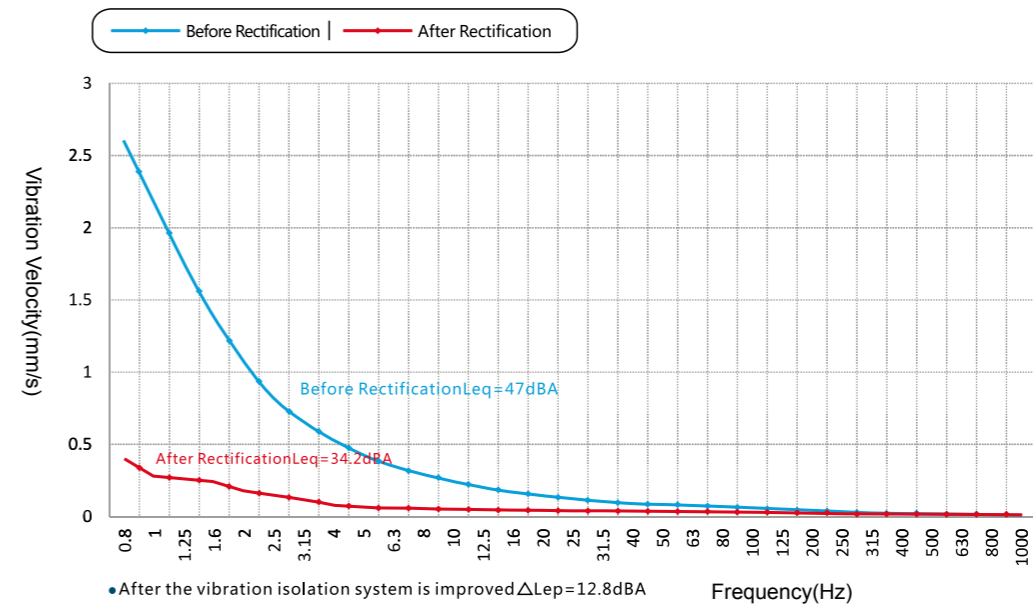

QPLAN® Sound Insulation Wall System

Product Feature

- Excellent soundproofing
- Stable structure
- Low nature frequency
- Simple usage, convenient installation

Product Performance Data

Frequency(Hz)	125	250	500	1000	2000	4000
Thickness Brick Wall	43	45	46	52	60	70
Qplan Sound Insulation Wall System	52	55	58	52	80	79

Test Standard

180mm Thickness Test Data	Qplan Sound Insulation Wall System	Improvement
STC=52	STC=65	△STC=13

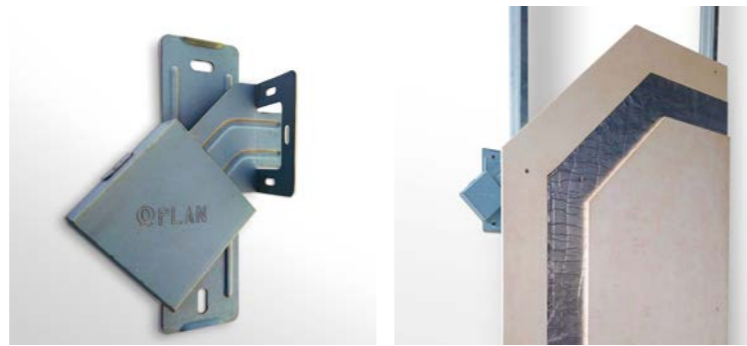
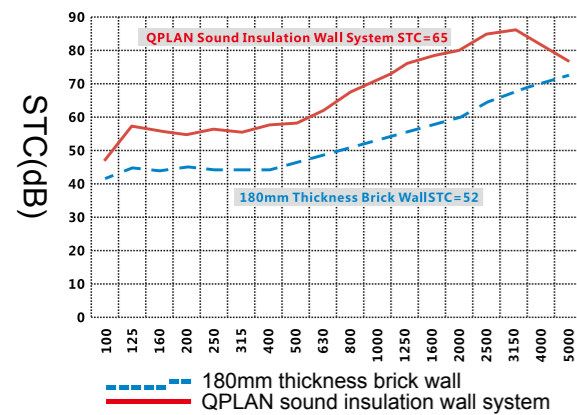

Qplan Sound Insulation Ceiling System

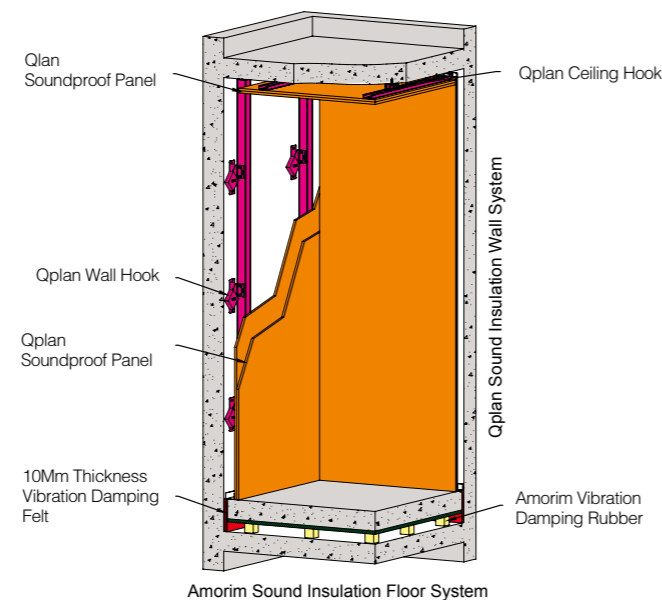

Amorim Sound Insulation Floor System

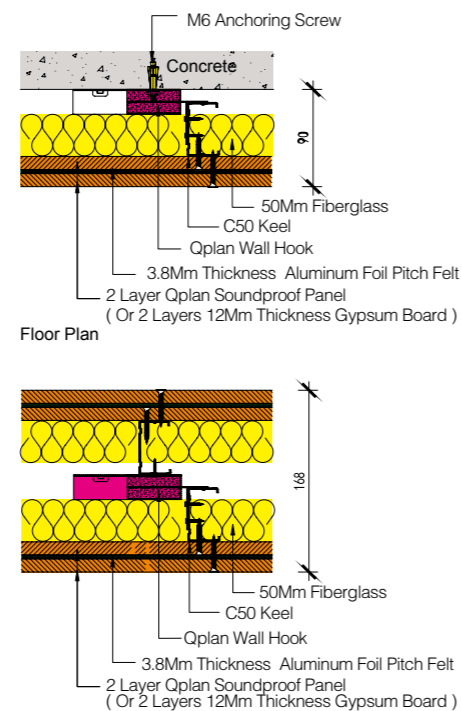

Double Wall Floor Plan

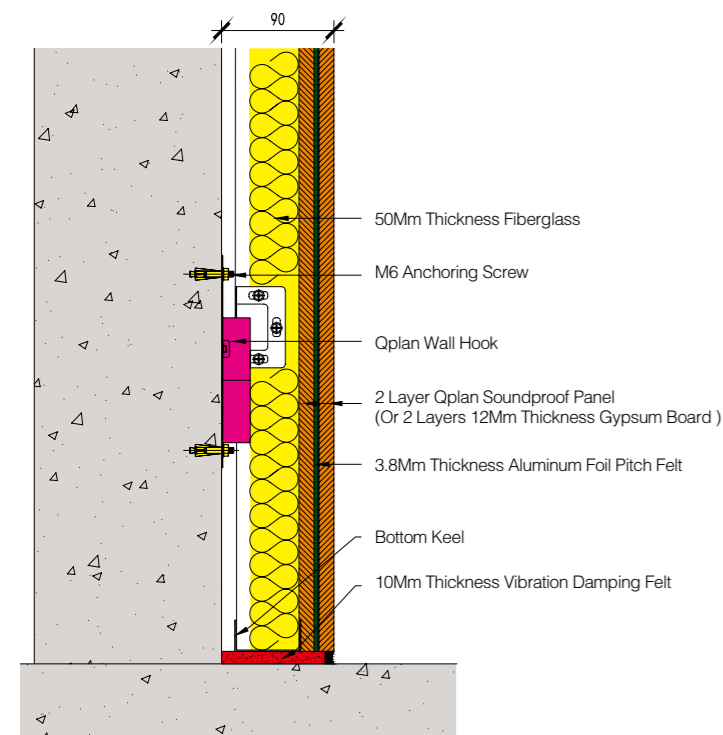

Section Plan

QPLAN® Sound Insulation Ceiling System

Qplan sound insulation ceiling system can improve floor structure noise transmission problem, and increase STC sound insulation level of the floating floor insulation system. The soundproof ceiling system is used in conjunction with the floating floor to maximize the STC sound insulation level. The minimum installation space of sound insulation ceilings is less than 80mm. They are mainly used for home bedroom, plant, conference rooms, multi-function hall, KTV, office and other places that need noise reduction.

Features

- Stable Mechanical properties
- Excellent damping performance
- Anti rust, durable, green
- Effectively reduce air and impact noise
- Saving installation space
- convenient construction
- Self-locking design

Product Performance Parameters

Project	Test Standard	Test Results	
		QPLAN Sound Insulation Ceiling System(50mmCavity)	
STC	ASTM E90-09	69	
IIC	ASTM E4920-09	60	

Test Standard

Content	Sound Insulation Coefficient(dB)						
	125	250	500	1000	2000	4000	STC
Qplan Sound Insulation Ceiling System(50MmCavity)	51	57	68	72	74	80	69

Test Report Passed Hoklas Certification. Equivalent To Cnas Certification
The Measurement Is Based On "Astm E90-09"

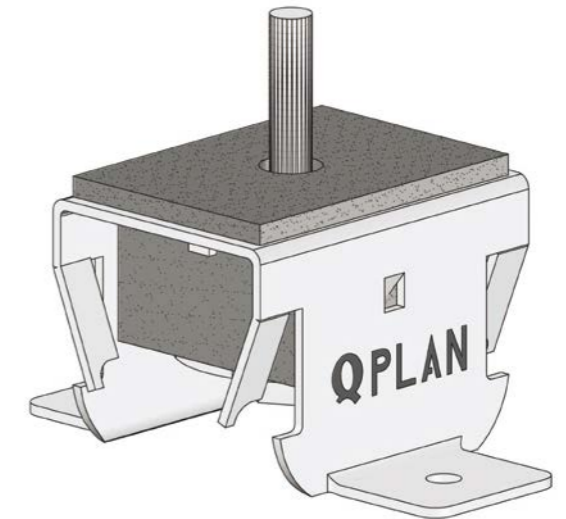



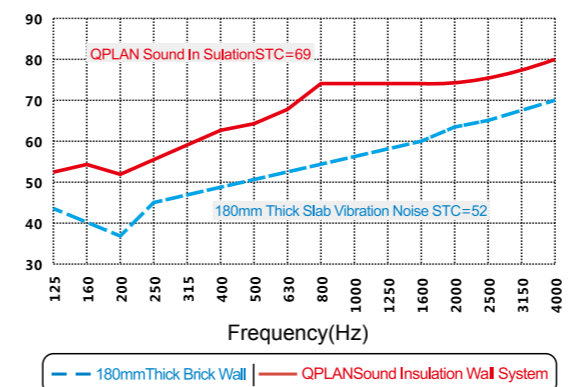
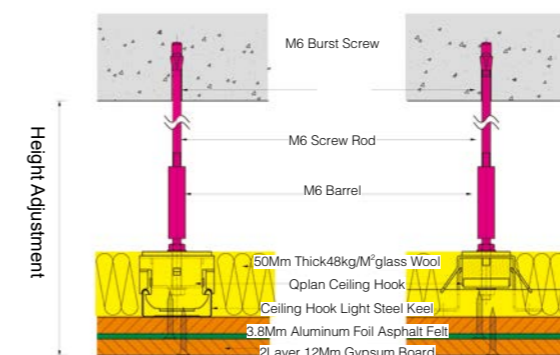





Adjustable Space Installation Drawing







Leeyin® Accessory Products

Comprehensive Accessories For Acoustic Products

	Item Picture	Name	Width (mm)	Height (mm)	Thickness (mm)	Function
Wooden Groove Panel Installation System		LY-01 Clip	24	17	1	Light steel keel or wood batten to connect with LY-02 or LY-03
		LY-02 Clip	41	50	1	The Clip that connect two pieces of Groove Panel
		LY-03 Clip	41	44	1	For side closing
Wooden Perforated Panel Installation System		LY-04 Clip	12	48	2	Light steel keel or wood batten to connect two pieces of perforated panel
		LY-05 Clip	12	13	1	Light steel keel or wood batten to close side of perforated panel
		LY-08 Clip	41	54	2	Usually used in pair, one to connect the base board, the other to connect the perforated panel
Others Keel System		LY-11	40	26	1	Clip to connect decorated panel or perforated panel
		LY-12	41	50	1	Clip to close side of decorated panel or perforated panel

Leeyin® Accessory Products

	Item Picture	Name	Width (mm)	Height (mm)	Thickness (mm)	Function
Others Keel System		LY-13	48	12	1	Light Steel Keel
		LY-14	30	25	1	Triangle keel to install the fabric panel
						Cross Keel
						Used with light steel keel for ceiling tiles and wall panel installation

Strips



"U"Type Aluminium Strip

Wood Strip

Aluminium Strip

Edge Banding



"L"Type Aluminium Edge Strip

"L"Type Wood Edge Strip

Pvc Edge Strip



Edge Strip



Hitom Angle Edge Strip



1/4 Circle Edge Strip

Leeyin® Projects

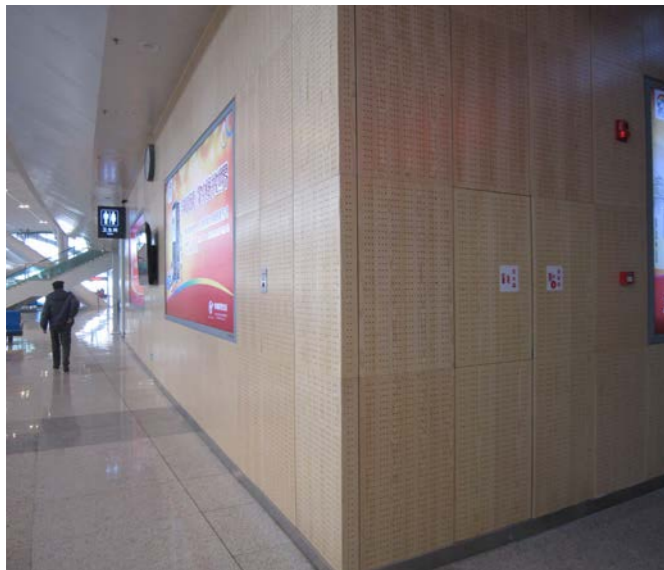

Leeyin® Projects

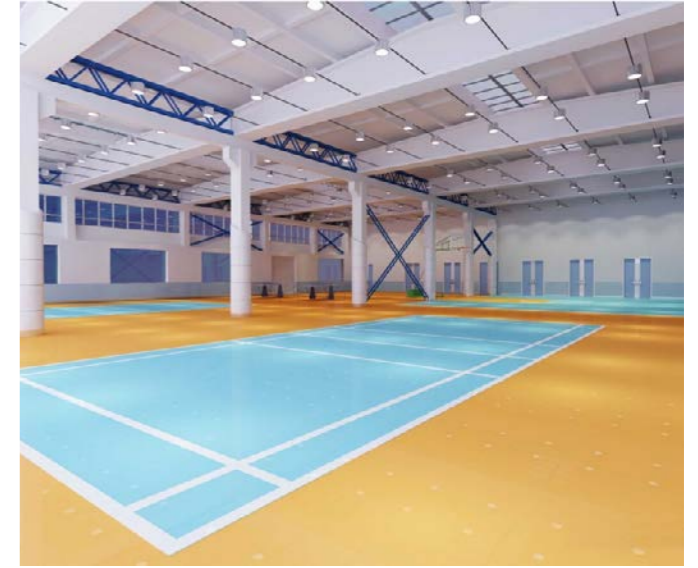

Leeyin® Projects

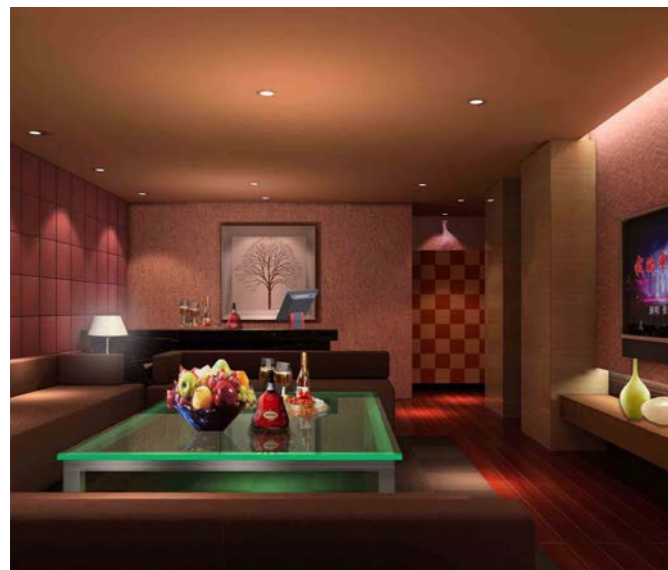

Leeyin® Projects

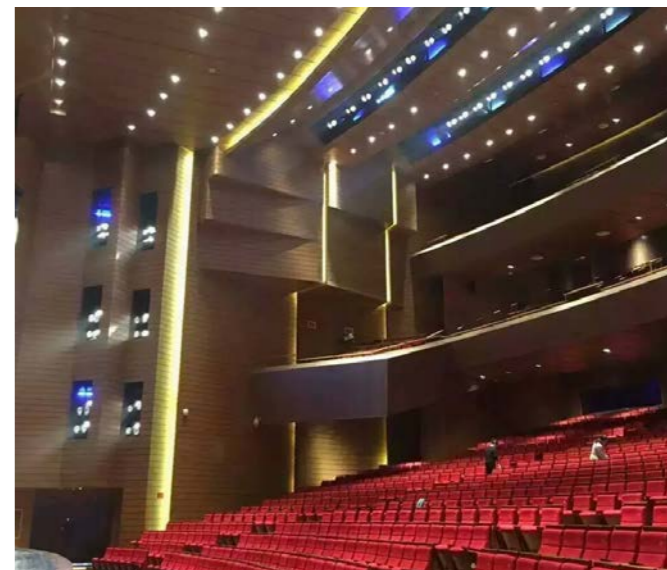
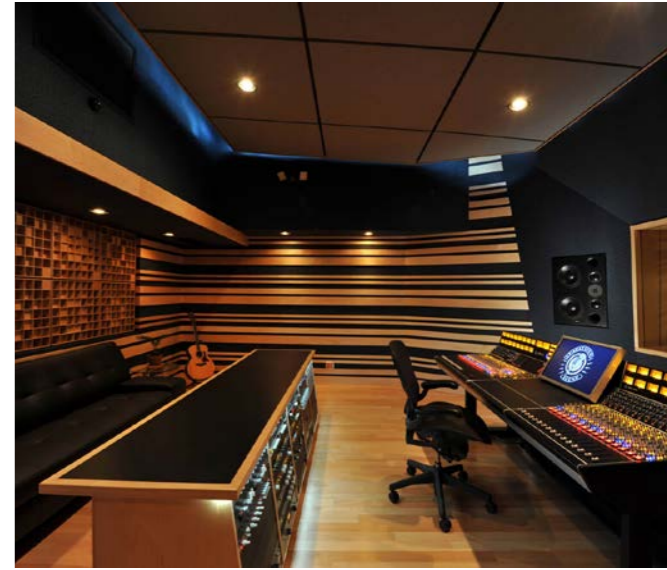

Acoustic Wall & Ceilings

Leeyin® Projects

Armenian Government Employee Restaurant
 Sudanese Oil Department Conference Hall
 Thailand Theater
 Indian Library
 Indian Airport Office
 Turkish Cinema
 America Cinema
 Baylor Library
 Angola Theater
 Saudi Auditorium
 Malaysian Government Lecture Hall
 Turkish Cesars Temple Hotel
 African Burundi National Capital Lecture Hall
 Israel Condor Cesaria
 DMCI project-OHANA AV
 Iglesia Kristo-Recording Studio
 Myanmar Yangon Cinema
 Philippine Manila Polo Club
 Nigerian court
 Long Island Hotel in Bengal
 Turkey Caesar Hotel
 Indian Jaipur Hotel
 Manila office in the Philippines

Jerusalem Government Office
 Bangkok University
 Zhongqiao Overseas Chinese bilingual gymnasium
 Shantou Chenghai Theater
 Guangzhou Bank
 Guangzhou Luogang City Music Hall
 Guangzhou Wanda Plaza
 Shenzhen Nanshan District Cultural Center
 Guangzhou Communications Bank
 Guangdong Opera House
 Huizhou Jiazhao Industry Center
 Shenzhen Peking University HSBC College multi - function hall
 Dongguan City, Dongguan Hotel
 Guangzhou Si Zhe Theater
 Heming Language School
 Guangzhou Art City Square
 Shenzhen Apple shop
 Guangzhou Tobacco Building
 Foshan Library
 Shenzhen Nanshan Style Center
 Shenzhen Software Industrial Zone
 Zhanjiang Gymnasium
 GF Financial Center



Leeyin® Projects

Guangzhou Tianhe Church
 Guangzhou East Germany Plaza
 Green lean operation center
 Zuohua City Middle School Gymnasium
 Zhuhai City Exhibition Center
 Henan Province Xinyang Conference Center
 Henan Province Xinyang flowers library
 Xuchang Convention and Exhibition Center, Henan Province
 Henan Sanmenxia Art Center
 Henan Foreign Language Middle School
 Henan Xingmei Theater
 Xingyang Party School
 Guangxi Guilin Office
 Guangxi Guilin a courtyard two museums
 Guangxi Liuzhou Wenchang Conference Center
 Guilin Medical College
 Hunan Provincial Communications Technology College
 Hunan Provincial Health Department
 Wuyang Railway Line in Hunan Province
 Hunan Yueyang Sports Center
 Changsha, Hunan new radio and television center
 Jiangnan University, Hubei Province

Wuhan Railway Station in Hubei Province
 Wenzhou Grand Theater, Zhejiang Province
 Nanchang Convention and Exhibition Center
 Yichun Sports Center
 Jiangxi Education Bureau
 Yichun Art Center
 Yichun Yuanzhou District Administrative Center
 Jiangxi Dongxiang Sports Center
 Tengzhou City, Shandong Province Radio and Television Bureau
 Shandong Province Finance Bureau office
 Shandong Province Convention and Exhibition Center
 Shandong Zouping Radio and TV Building
 Shandong Dongxiang Sports Center
 Yantai Wu Cai Art Center
 Shandong Jining Gymnasium
 Xi'an Xiaqiao Economic Development Zone office
 Xi'an University of Finance and Economics
 Xi'an Qin Han Tang multi - function hall
 Lanzhou Grand Theater
 Lanzhou City Office
 Zhejiang Province Cultural and Art Center

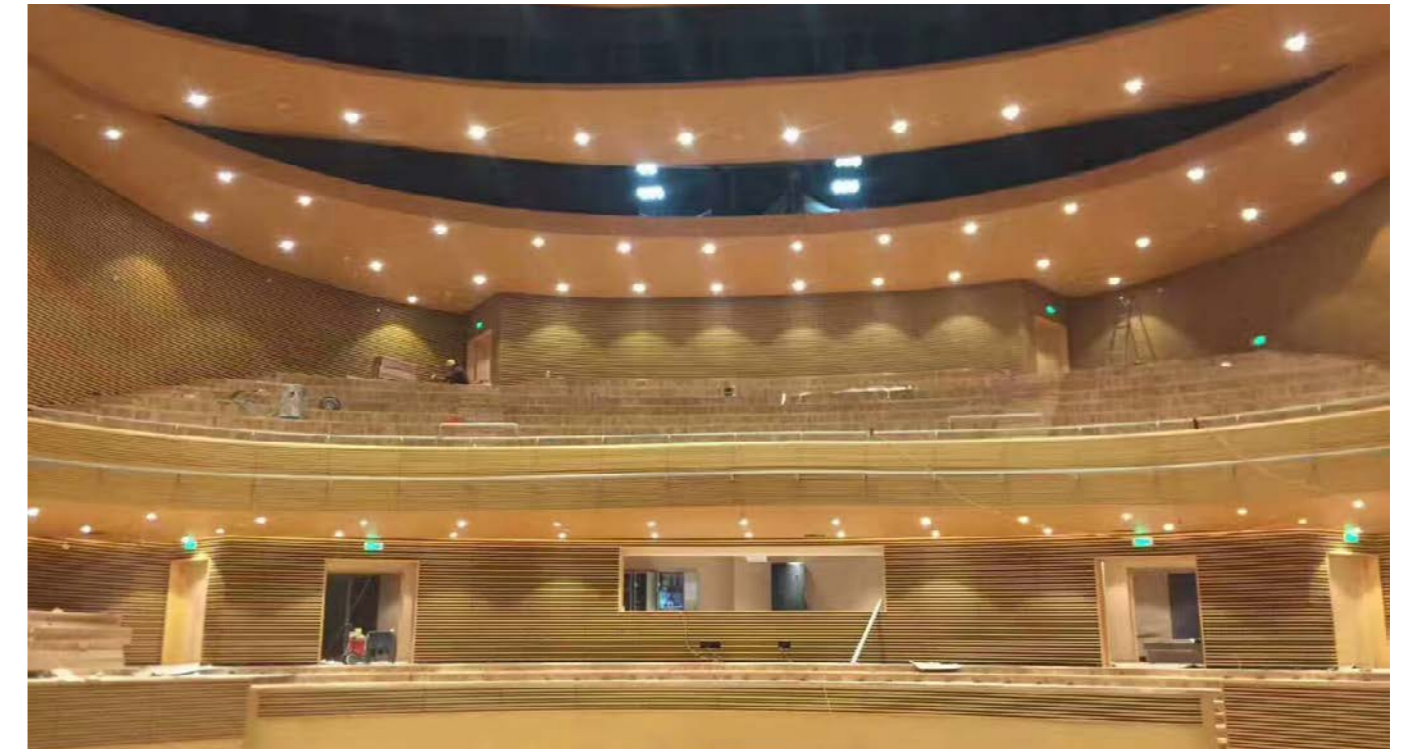

营业执照
(副本)
编号: 90512015003200-2-0
统一社会信用代码: 91440105786058879J

名称: 广东丽音声学科技有限公司
类型: 有限责任公司(自然人投资或控股)
住所: 广州市海珠区宝岗大道277号宝岗大厦四楼自编401室(仅作办公用途)
法定代表人: 刘伟华
注册资本: 壹仟万元整
成立日期: 2006年03月17日
营业期限: 2006年03月17日至长期
经营范围: 研究和试验发展(具体经营项目请登录广州市商事主体信息公示平台查询。依法须经批准的项目,经相关部门批准后方可开展经营活动。)

登记机关: 广州市海珠区工商行政管理局
2017年08月22日

证书号第6116437号

实用新型专利证书

实用新型名称: 八阶扩散体
发明人: 刘伟华
专利号: ZL 2016 2 1123013.9
专利申请日: 2016年10月14日
专利权人: 广州丽音建筑材料有限公司
授权公告日: 2017年05月03日

本实用新经过程本局依照中华人民共和国专利法进行初步审查, 决定授予专利权, 颁发本证书并在专利登记簿上予以登记。专利权自公告之日起生效。
本专利的专利权期限为十年, 自申请日起算, 专利权人应当依据专利法及其实施细则规定缴纳年费。本专利的年费应当在每年10月14日前缴纳, 未按照规定缴纳年费的, 专利权自应当缴纳年费期满之日起终止。
专利法记载专利登记时的法律状况, 专利权的转移、质押、无效、终止、恢复和专利权人的姓名或名称、国籍、地址变更等事项记载在专利登记簿上。

局长: 申长雨
2017年05月03日

Test Report No.: SDHGR13010004FM Date: Jan.07, 2013 Page 1 of 6
GUANGZHOU LIYIN BUILDING MATERIAL CO.,LTD
ROOM 401, LIBAO DECORATION CENTER, NO. 277 BAOGANG ROAD, HAIZHU DISTRICT, GUANGZHOU

The following sample(s) was / were submitted and identified on behalf of the client as:
Sample Description : PET ACOUSTIC PANEL
SGS Ref No. : AJD201207379
Sample Receiving Date : Dec.26, 2012
Test Performing Date : Dec.26, 2012 to Jan.07, 2013
Test Requested : EN 13501-1:2007+A1:2009 Fire classification of construction products and building elements—Part 1: Classification using data from reaction to fire tests, class B.
Test Result(s) : For further details, please refer to the following page(s)

Signed for and on behalf of SGS-CSTC Co., Ltd.
Jack Yao
Approved signatory

Test Report No.: SDHGR13010004FM Date: Jan.07, 2013 Page 2 of 6

I. Test conducted
This test is conducted as per EN 13501-1:2007+A1:2009 Fire classification of construction products and building elements — Part 1: Classification using data from reaction to fire tests. And the test methods are as following:
1. EN 13823:2010 Reaction to fire tests for building products - Building products excluding floorings exposed to the thermal attack by a single burning item.
2. EN ISO 11925-2:2010 Reaction to fire tests — Ignitability of building products subjected to direct impingement of flame — Part 2: Single-flame source test.

II. Details of classified product
a) **Nature and end use application**
The product "PET acoustic panel" is defined as a decorative sheet. Its classification is valid for the following end use application:
For wall material.
b) **Description**
The details of the product given above have been prepared from information provided by the sponsor of the test.

Color	Silver grey
Thickness	About 6.7mm
Mass per unit area	About 2.4kg/m ²

Mounting and fixing:
Calcium silicate board, with its density approximate 900kg/m³, thickness 9mm, is as the substrate, the test specimens are fixed mechanically to be substrate with no cavity behind it. No joint is the long wing of the specimen.

III. Test results

Test method	Parameter	Number of tests	Results
EN 13823	FIGRA (W/s)	3	80.1
	LFS < edge of specimen		Yes
	THR _{500s} (MJ)		6.0
	SMOGR _A (m ² /s ²)		13.9
	TSP _{500s} (m ³)		32.3
	Flaming particles or droplets		No

To be continued...

证书号第6116438号

实用新型专利证书

实用新型名称: 一种架空管道的吸声板
发明人: 刘伟华
专利号: ZL 2016 2 0984376.4
专利申请日: 2016年08月25日
专利权人: 广州丽音建筑材料有限公司
授权公告日: 2017年05月03日

局长: 申长雨
2017年05月03日

证书号第6116439号

实用新型专利证书

实用新型名称: 一种墙体隔音装置
发明人: 刘伟华
专利号: ZL 2016 2 1123013.9
专利申请日: 2016年10月14日
专利权人: 广州丽音建筑材料有限公司
授权公告日: 2017年05月03日

局长: 申长雨
2017年05月03日

证书号第6116440号

实用新型专利证书

实用新型名称: 一种墙体隔音装置
发明人: 刘伟华
专利号: ZL 2016 2 1123013.9
专利申请日: 2016年10月14日
专利权人: 广州丽音建筑材料有限公司
授权公告日: 2017年05月03日

局长: 申长雨
2017年05月03日

Test Report No.: SDHGR13010004FM Date: Jan.07, 2013 Page 4 of 6

Annex A
Classes of reaction to fire performance for construction products excluding floorings and linear pipe thermal insulation products

Class	Test method(s)	Classification criteria	Additional classification
A1	EN ISO 1182 ^a and EN ISO 1716	FIGRA < 80 W/s and LFS < no support flaming and THR _{500s} < 6.0 MJ and SMOGR _A < 13.9 m ² /s ² and TSP _{500s} < 32.3 m ³	-
A2	EN ISO 1182 ^a or EN ISO 1716	FIGRA < 80 W/s and LFS < no support flaming and THR _{500s} < 6.0 MJ and SMOGR _A < 13.9 m ² /s ² and TSP _{500s} < 32.3 m ³	-
B	EN 13823 and EN ISO 11925-2 ^b Exposure=30s	FIGRA < 200 W/s and LFS < edge of specimen and THR _{500s} < 6.0 MJ	Smoke production ^c and Flaming droplets/particles ^d
C	EN 13823 and EN ISO 11925-2 ^b Exposure=30s	FIGRA < 200 W/s and LFS < edge of specimen and THR _{500s} < 6.0 MJ	Smoke production ^c and Flaming droplets/particles ^d
D	EN 13823 and EN ISO 11925-2 ^b Exposure=30s	FIGRA < 200 W/s and LFS < edge of specimen and THR _{500s} < 6.0 MJ	Smoke production ^c and Flaming droplets/particles ^d
E	EN ISO 11925-2 ^b Exposure=15s	FIGRA < 200 W/s	Flaming droplets/particles ^d

To be continued...

Test Report No.: SDHGR13010004FM Date: Jan.07, 2013 Page 5 of 6

IV. Classification and direct field of application
This classification has been carried out in accordance with EN 13501-1:2007+A1:2009.
a) Classification
The product "PET acoustic panel", classification is as following:

Fire behaviour	B	s	1	-	d	0
----------------	---	---	---	---	---	---

Reaction to fire classification: B-s1,d0
Remark: The classes with their corresponding fire performance are given in annex A.
b) Field of application
This classification for the submitted sample is valid for the following end use condition:
- With all substrates classified A1 and A2
- With mechanical fixing
- No joint
- No air gaps
This classification is valid for the following product parameters:
- Characteristics are described in § 8 of the test reports.
c) Remarks: The test results relate to the behaviour of the test specimens of a product under the particular conditions of the test. They are not intended to be the sole criterion for assessing the potential fire hazard of the product in use.
d) Warning:
This classification report does not represent type approval or certification of the product. The test laboratory has, therefore, play no part in sampling the product for the test, although it holds appropriate references to the manufacturer's factory production control that is aimed to be relevant to the samples tested and that will provide for their traceability.

To be continued...

Test Report No.: SDHGR13010004FM Date: Jan.07, 2013 Page 6 of 6

F No performance determined
*For homogeneous products and substantial components of non-homogeneous products.
*For any external non-substantial component of non-homogeneous products.
*Alternatively, any external non-substantial component having a PCS < 2.0 MJ/m², provided that the product satisfies the following criteria of EN 13823: FIGRA < 20 W/s, and LFS < edge of specimen, and THR_{500s} < 6.0 MJ and S1 and d0.
*For any internal non-substantial component of non-homogeneous products.
*For the product as a whole.
*In the last phase of the development of the test procedure, modifications of the smoke measurement system have been introduced; the effect of which needs further investigation. This may result in a modification of the limit values and/or parameters for the evaluation of the smoke production.
s1 = SMOGR_A < 30m²/s² and TSP_{500s} < 50m³; d2 = SMOGR_A < 180m²/s² and TSP_{500s} < 200m³; s3 = not s1 or d2.
d0 = No flaming droplet particles in EN 13823 within 600 s;
d1 = No flaming droplet particles persisting longer than 15 s in EN 13823 within 600 s;
d2 = not d0 or d1.
Ignition of the paper in EN ISO 11925-2 results in a d2 classification.
*Pass = no ignition of the paper (no classification);
*Fail = ignition of the paper (d2 classification).
*Under conditions of surface flame attack and, if appropriate to the end-use application of the product, edge flame attack.

To be continued...

Leeyin® Certification And Test Reports



ISO 9001-2008



SGS BS476 Part 7 1997 Class 1 Page 1

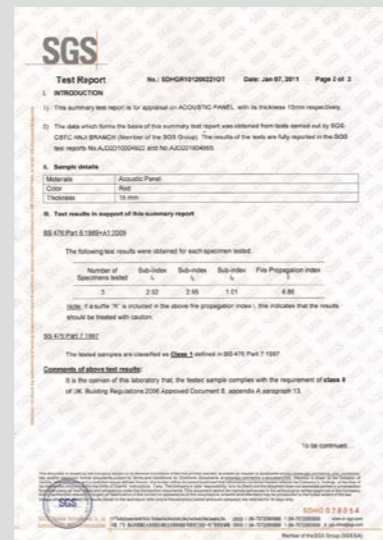

SGS BS476 Part 7 1997 Class 1 Page 2



CONCAP Page 1



Acoustics Test Report for Fabric Acoustic Panel Page 1

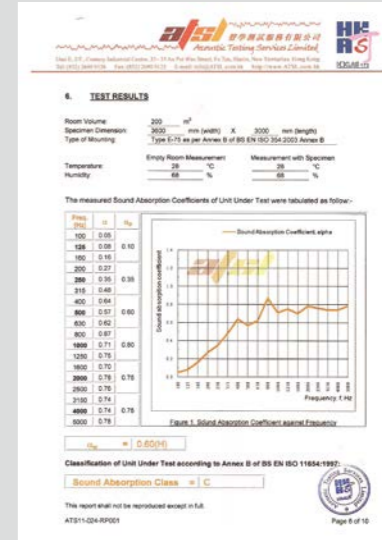

Acoustics Test Report for Fabric Acoustic Panel Page 2

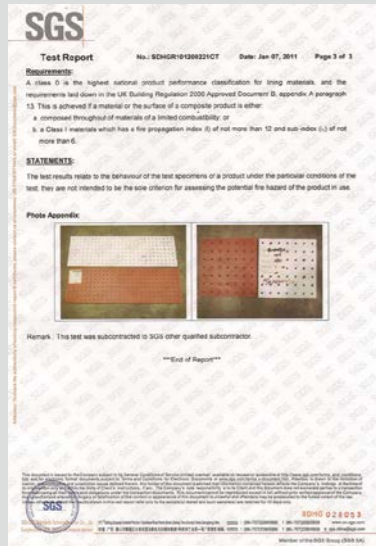

SGS BS476 Part 7 1997 Class 1 Page 3



SGS EN13986-2004 E1 Page 1



SGSEN13986-2004 E1 Page 2



Patent certificate

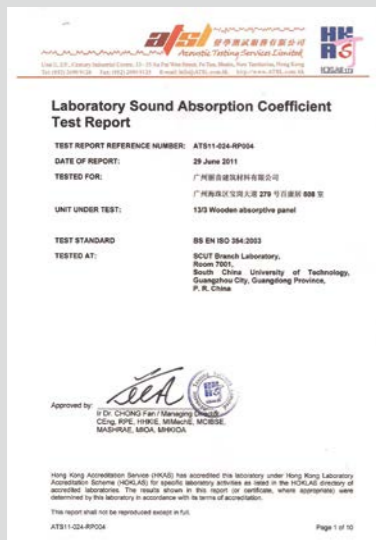

Acoustics Test Report for Pattern 13-3 Page 1

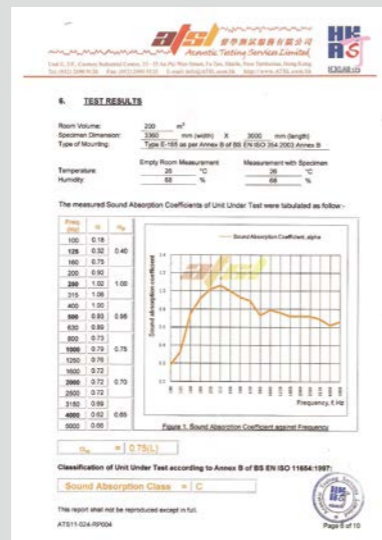

Acoustics Test Report for Pattern 13-3 Page 2



CONCAP Page 1

