

SRD761 Designing Urban Environment

Project 1b: Big & small - *perceptions of size & scale*

Scott Kennedy

800438217

Understanding self through size & scale: “Me, myself, and someone else”

Step 1: *Da Vinci's Renaissance subject*

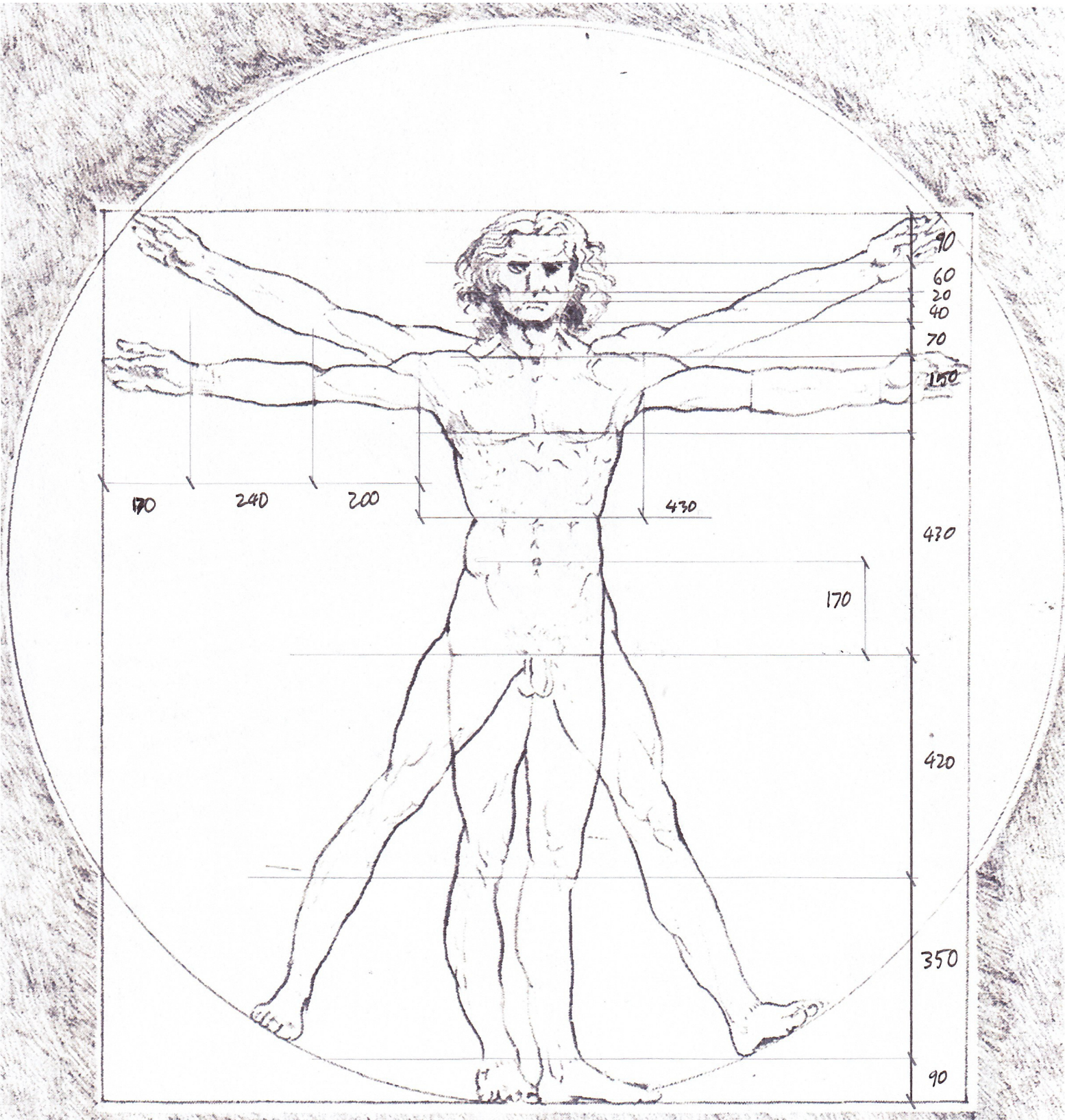

The universal man with my own measurements, at 1:10

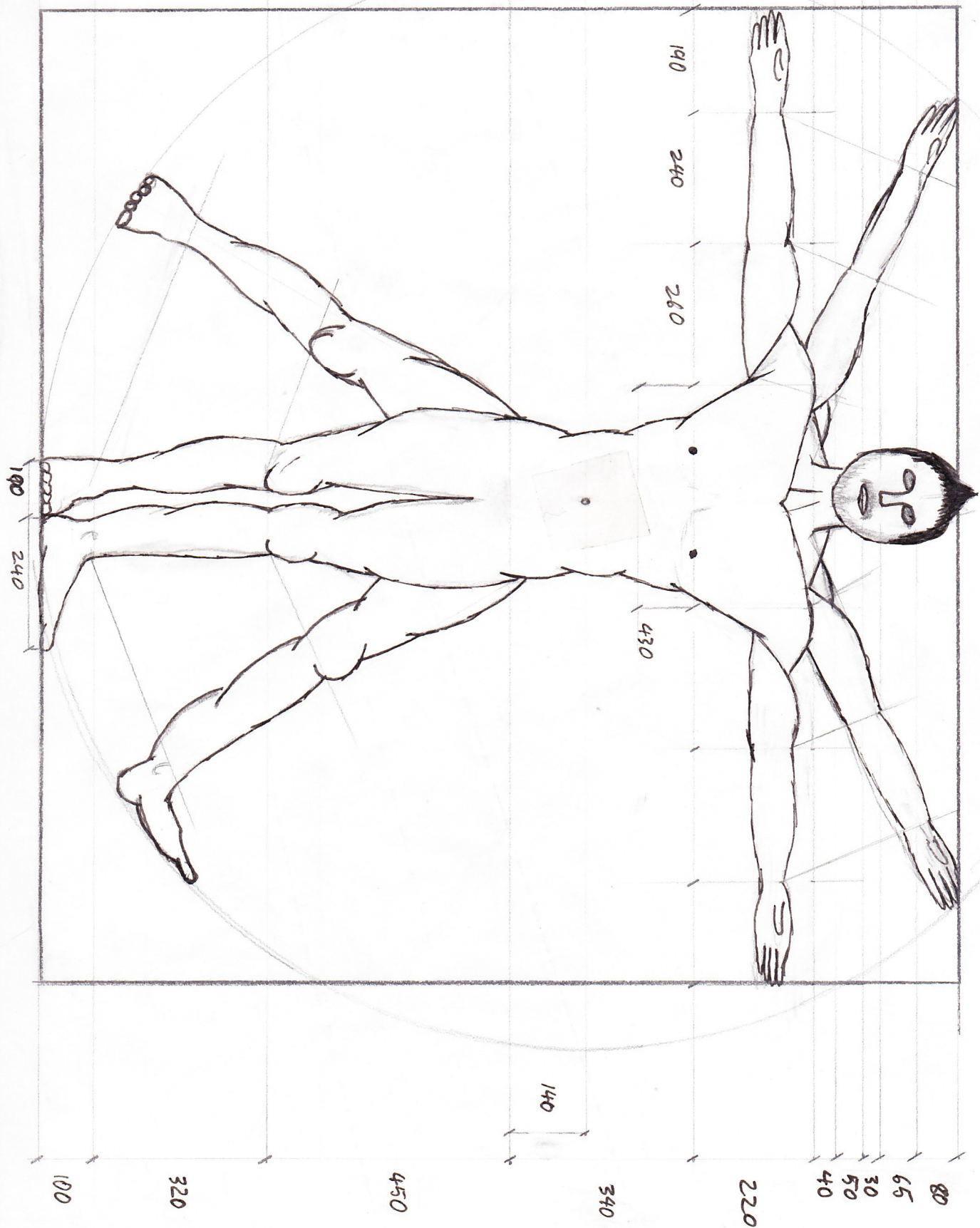

My proportions and measurements, at 1:10

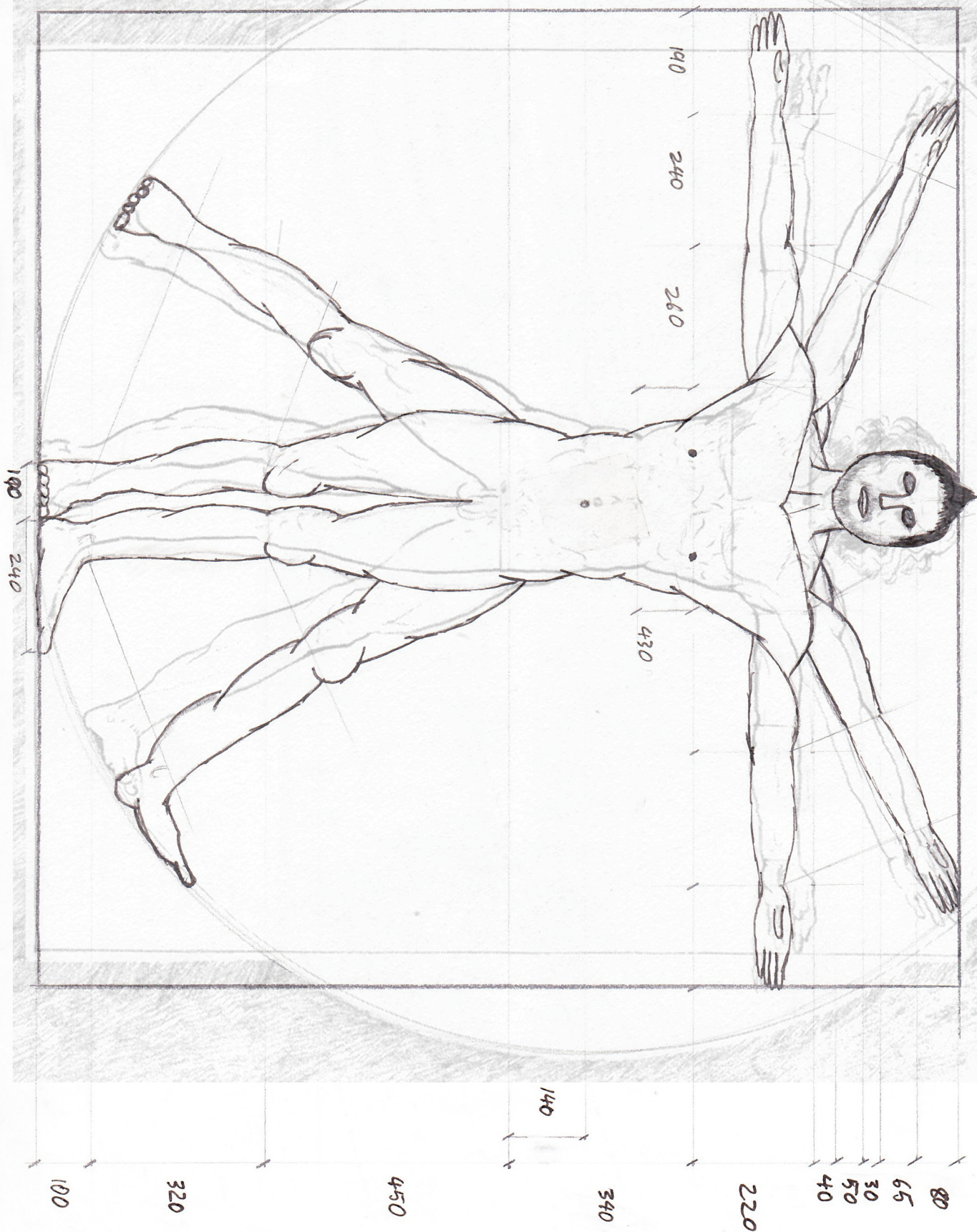

My proportions and measurements juxtaposed against the Universal man, at 1:10

Step 2: Denominator of Le Corbusier's Module

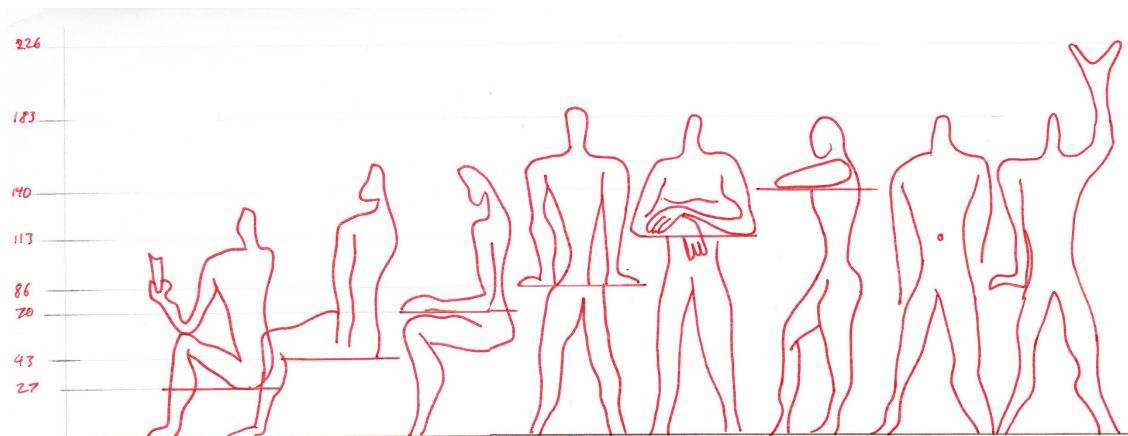

Le Corbusier's Le Modular

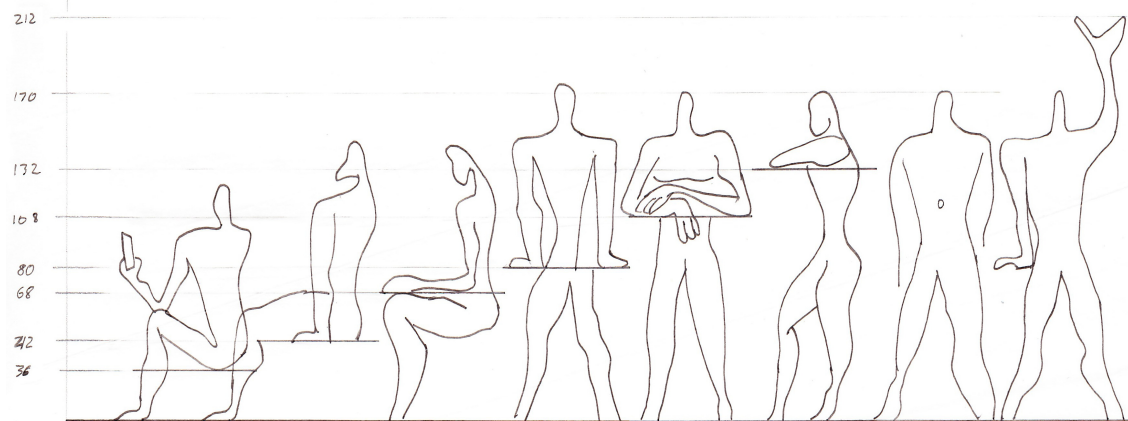

Le Modular with my own measurements and proportions

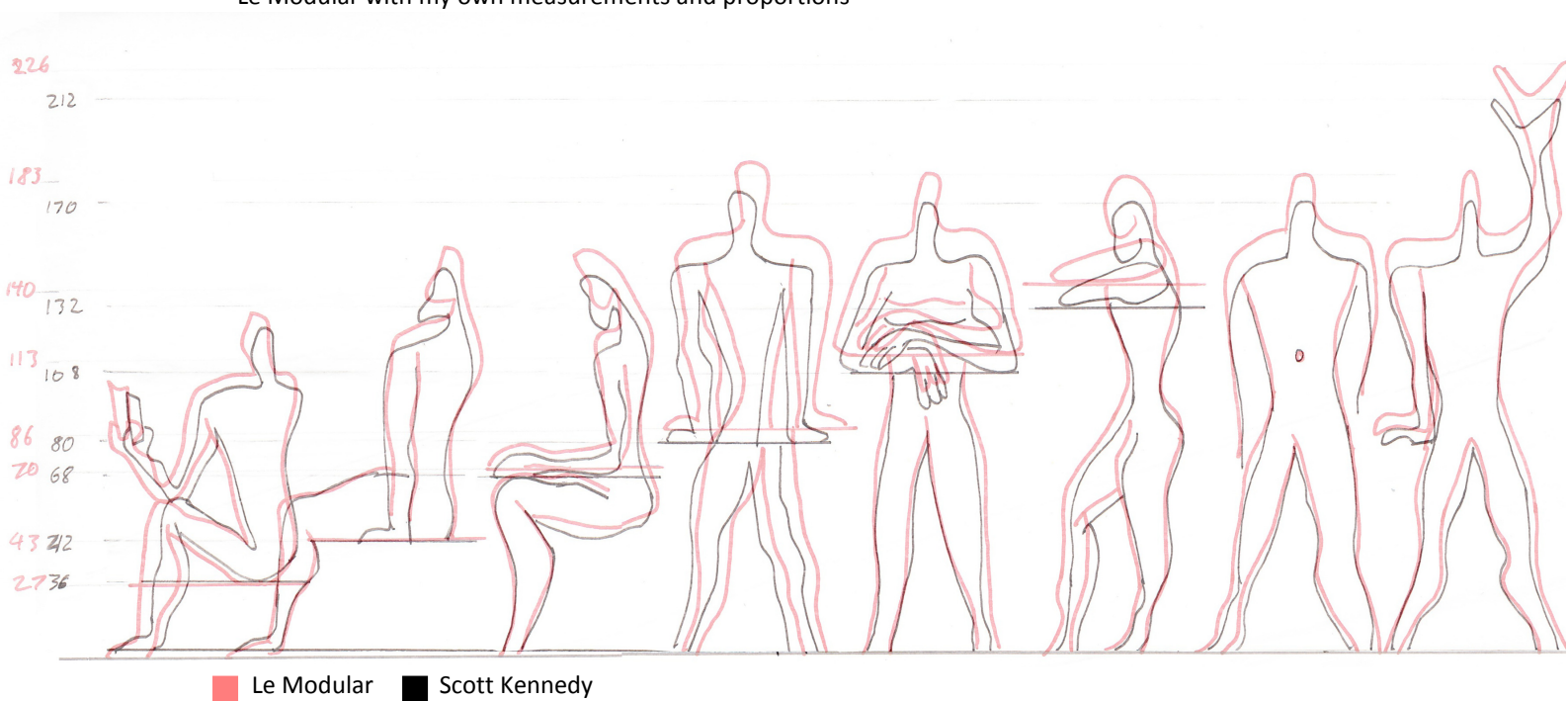

Le Modular vs Scott Kennedy.

Step 3: Someone else

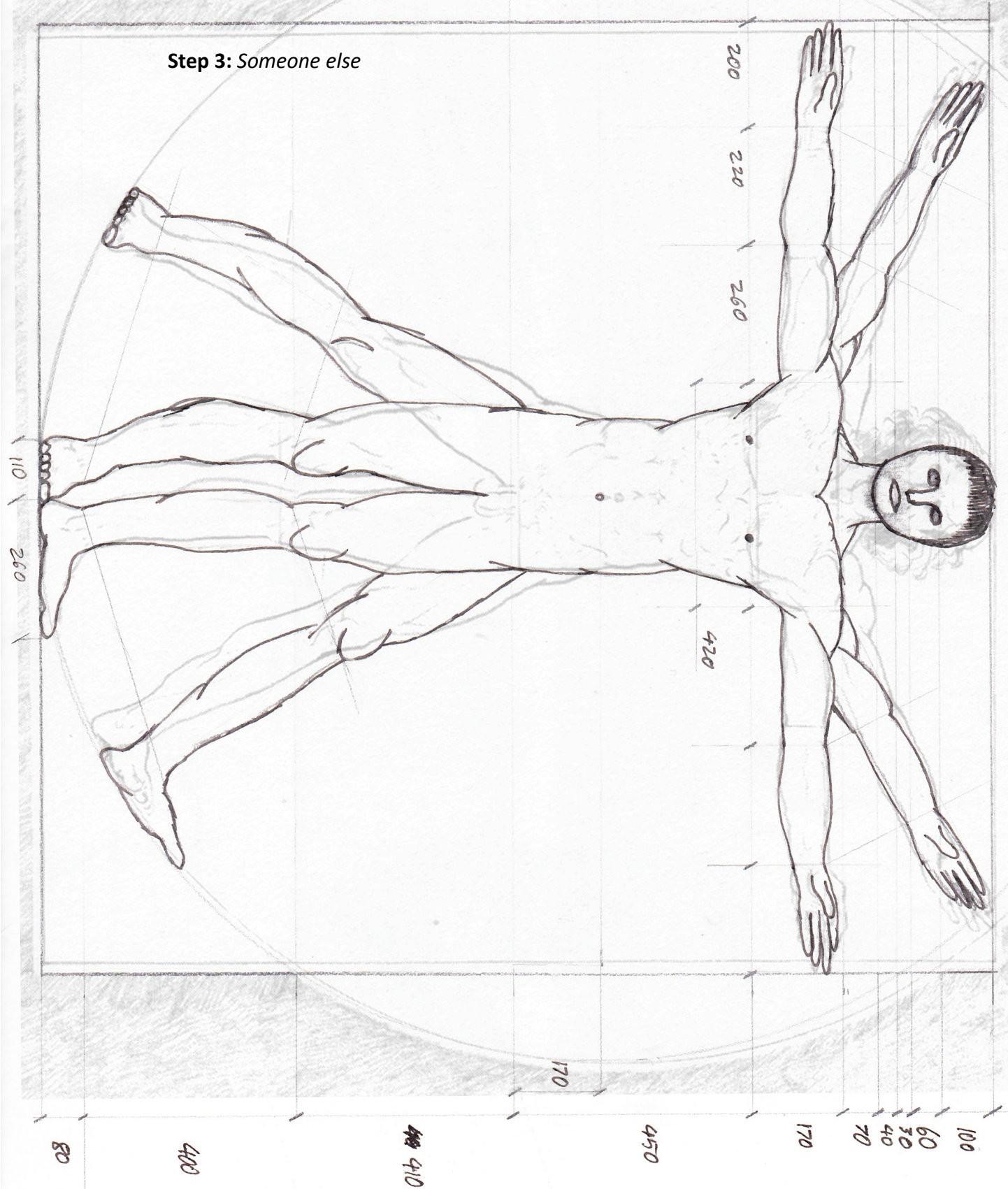

A friend's proportions and measurements juxtaposed against the Universal man, at 1:10

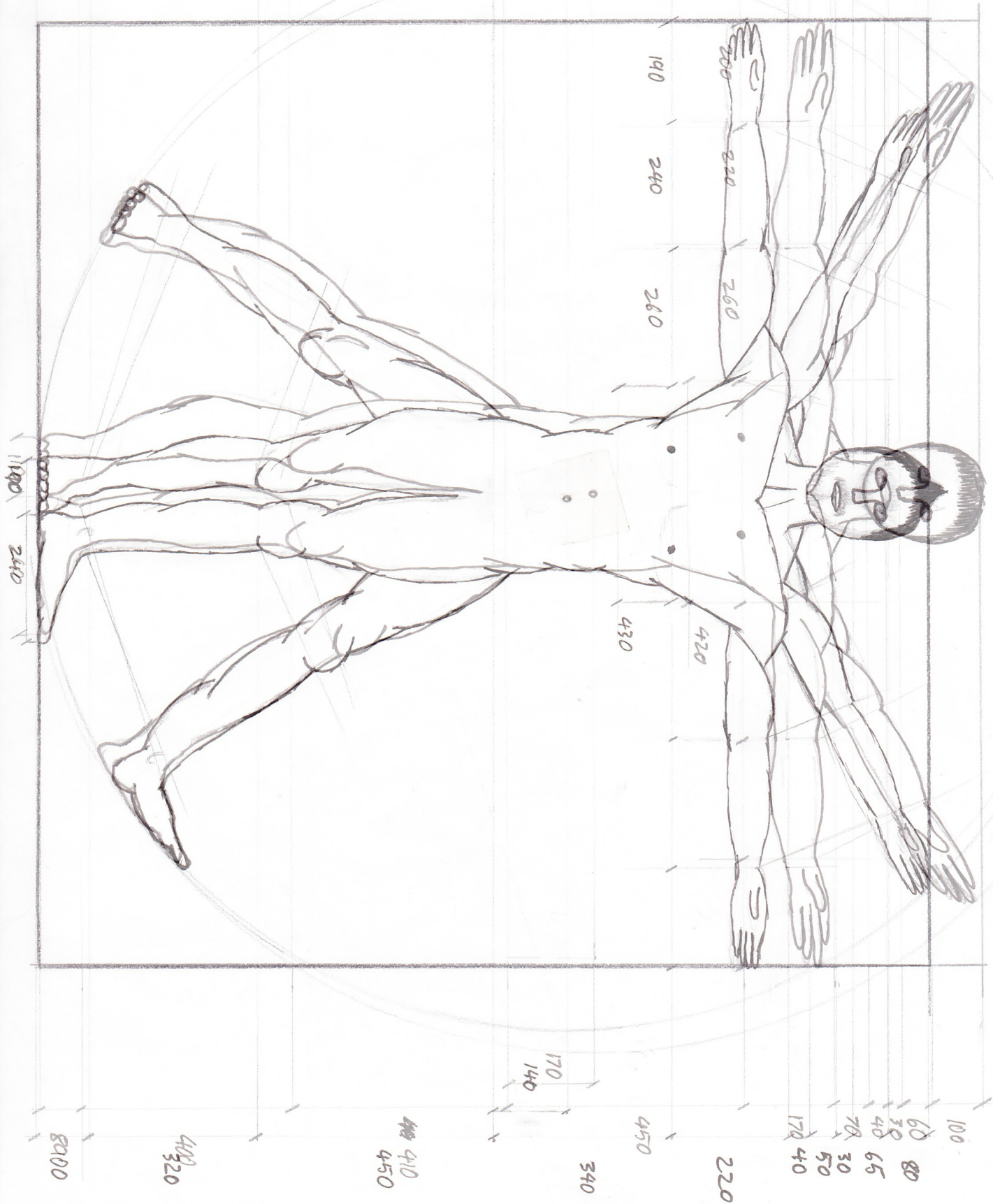

Comparison between proportions, at 1:10

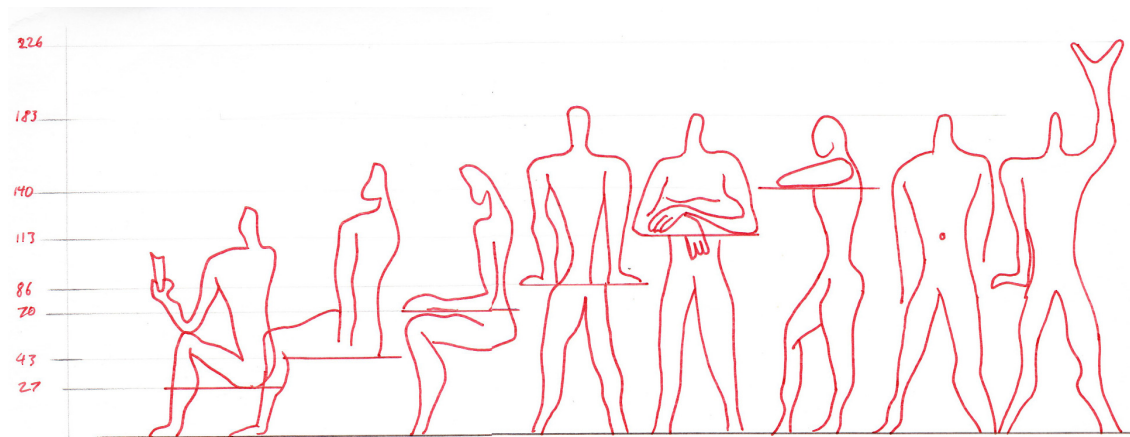

Le Corbusier's Le Modulor

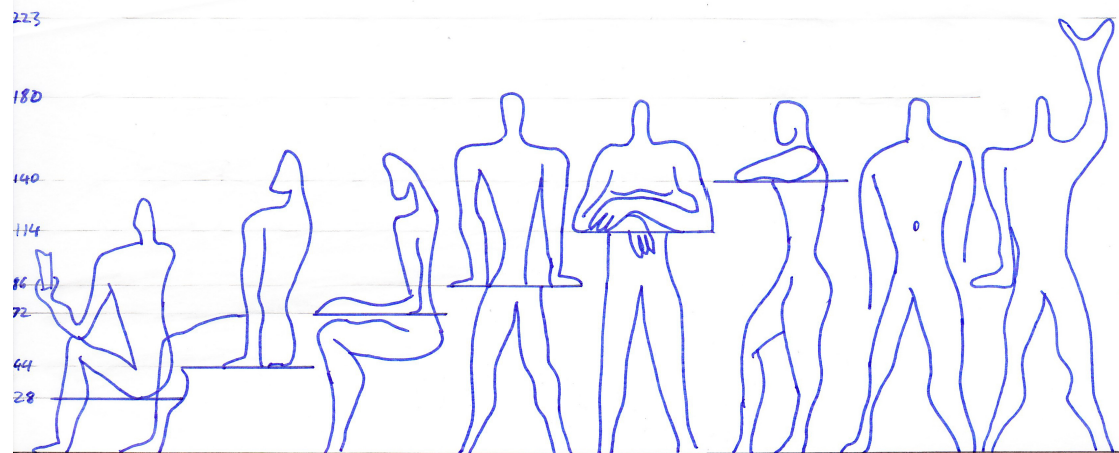

Le Modulor with my friends measurements and proportions

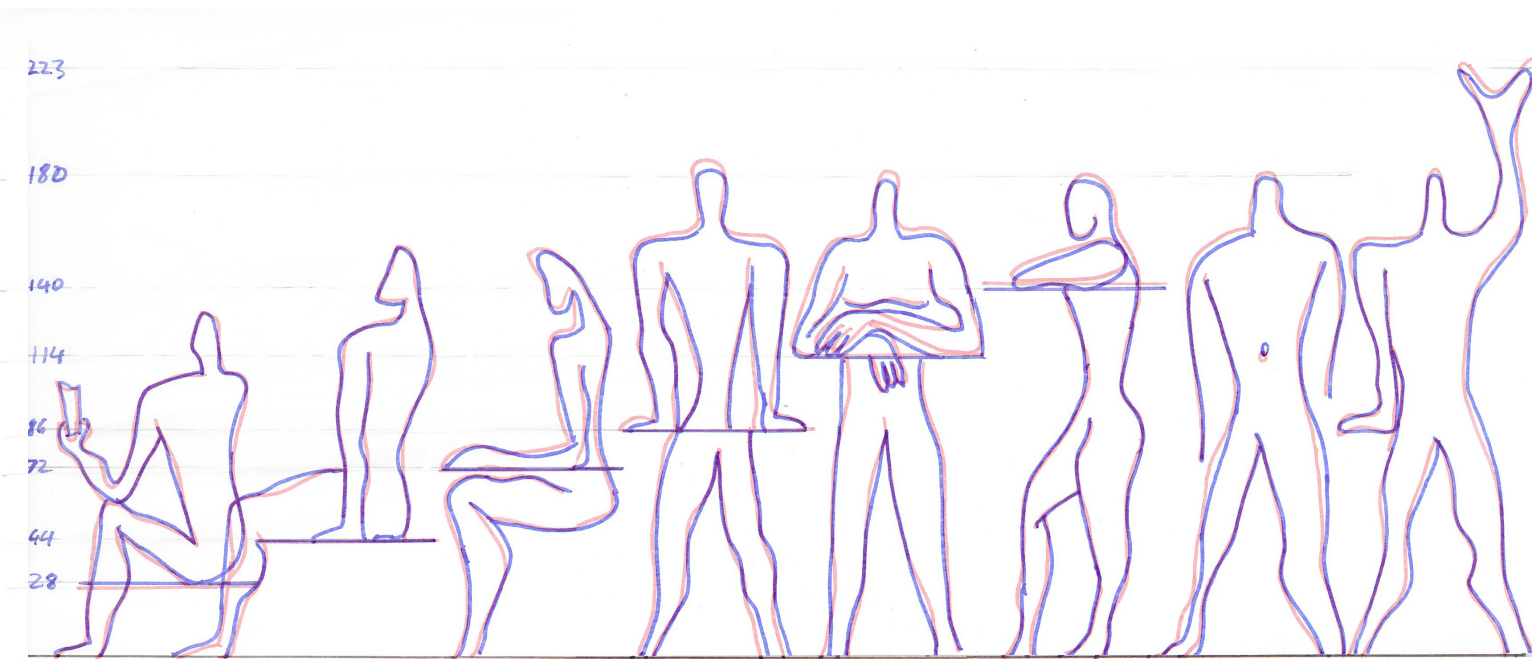

Le Modulor Ben Dolin

Le Modulor vs Ben Dolin

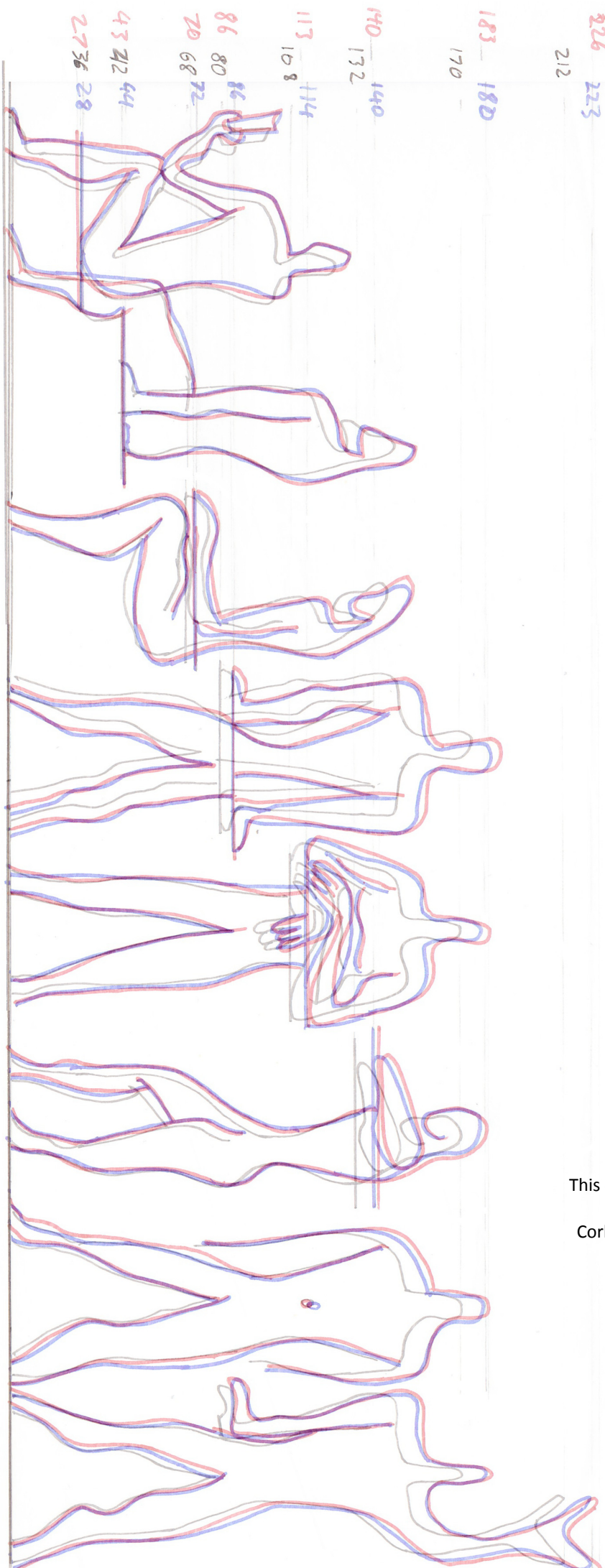

This comparison between my own proportions and measurements, my friend's (Ben Dolin) and Le Corbusier's Le Modular illustrates the differing dimension between all three participants.

Task 2

Understanding Place through Size and Scale: *“Measuring the props which help to condition public space”*

Step 1: Public space furniture



Step 2: 1:10 scaled sketches

The two items of public space furniture chosen for this assignment were a foldable reclining deck chair and a simple plastic chair.

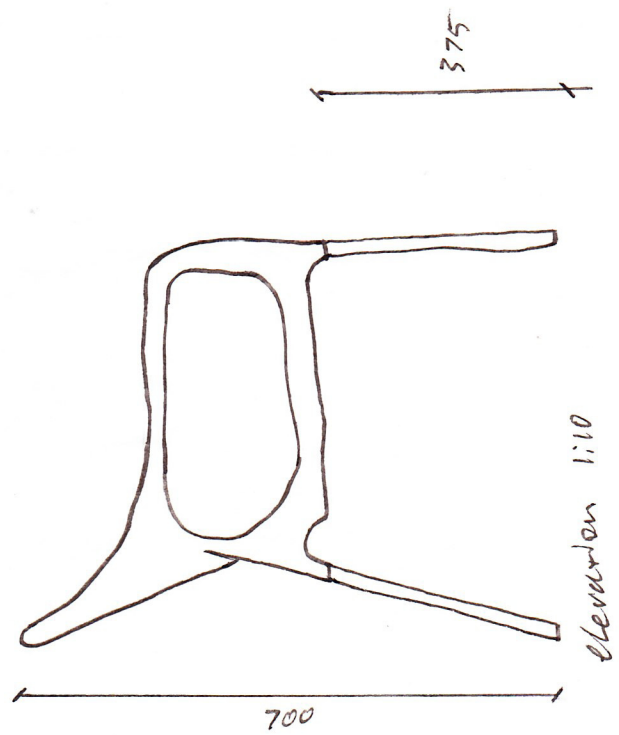
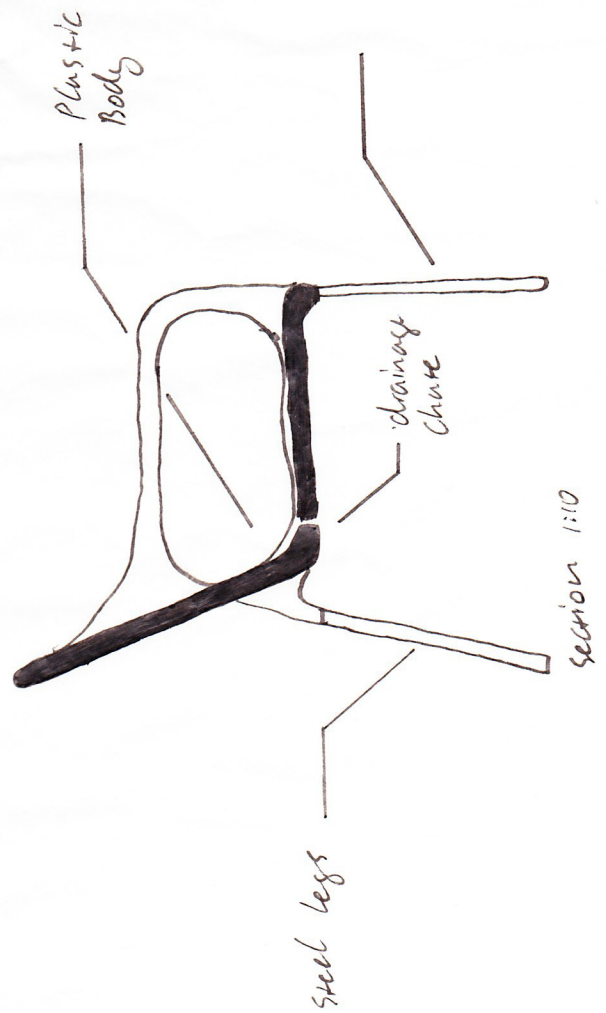
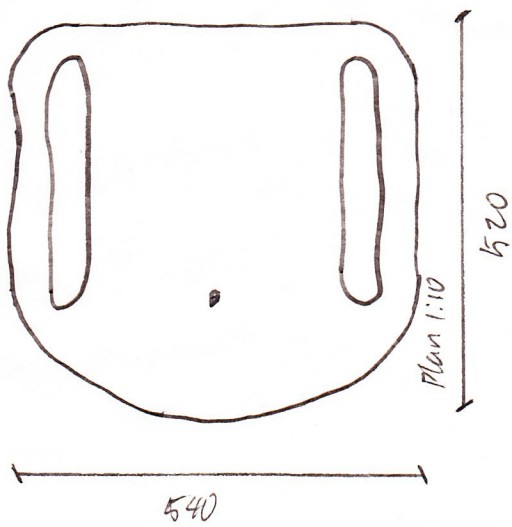

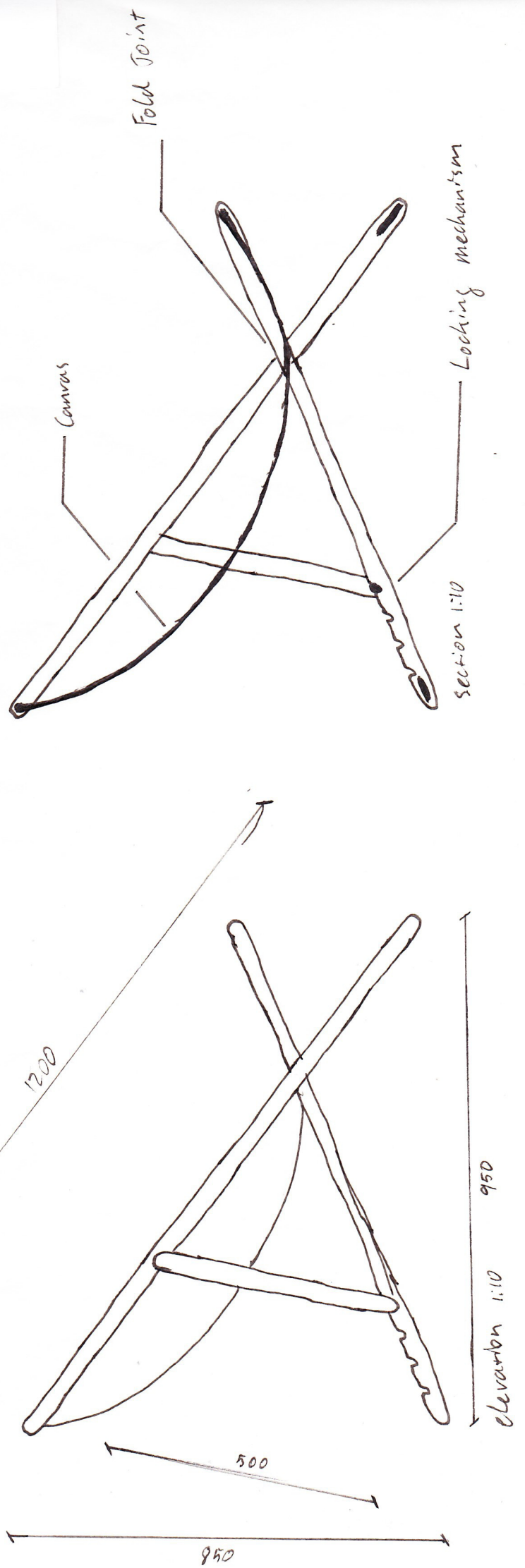
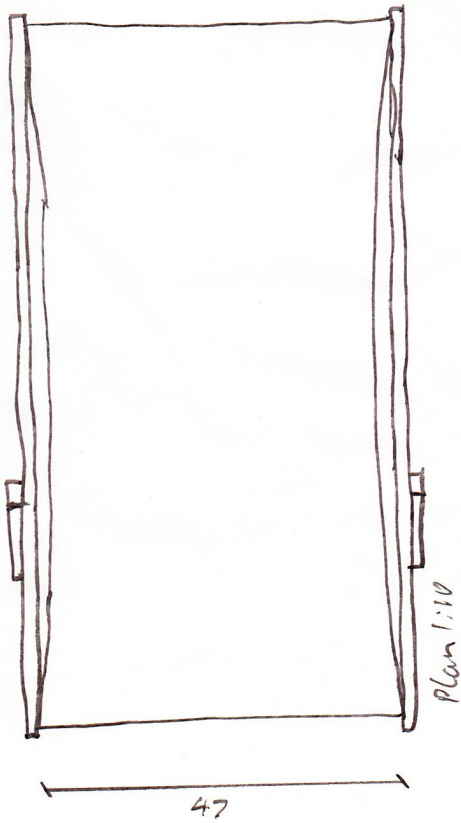

Fool Park

Step 3: Scaled sketch plan

Rubbish Bin

Disabled access ramp.

existing road

Planter
Box

Astro turf.

Umbrella above

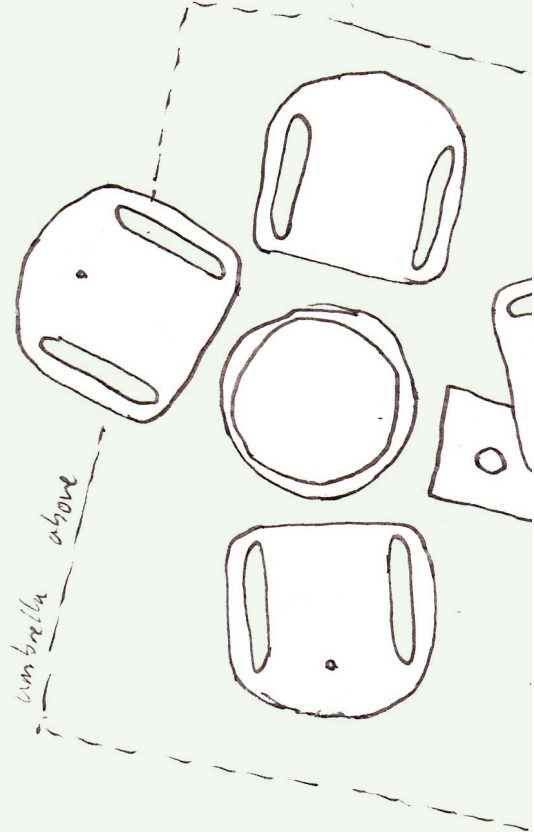
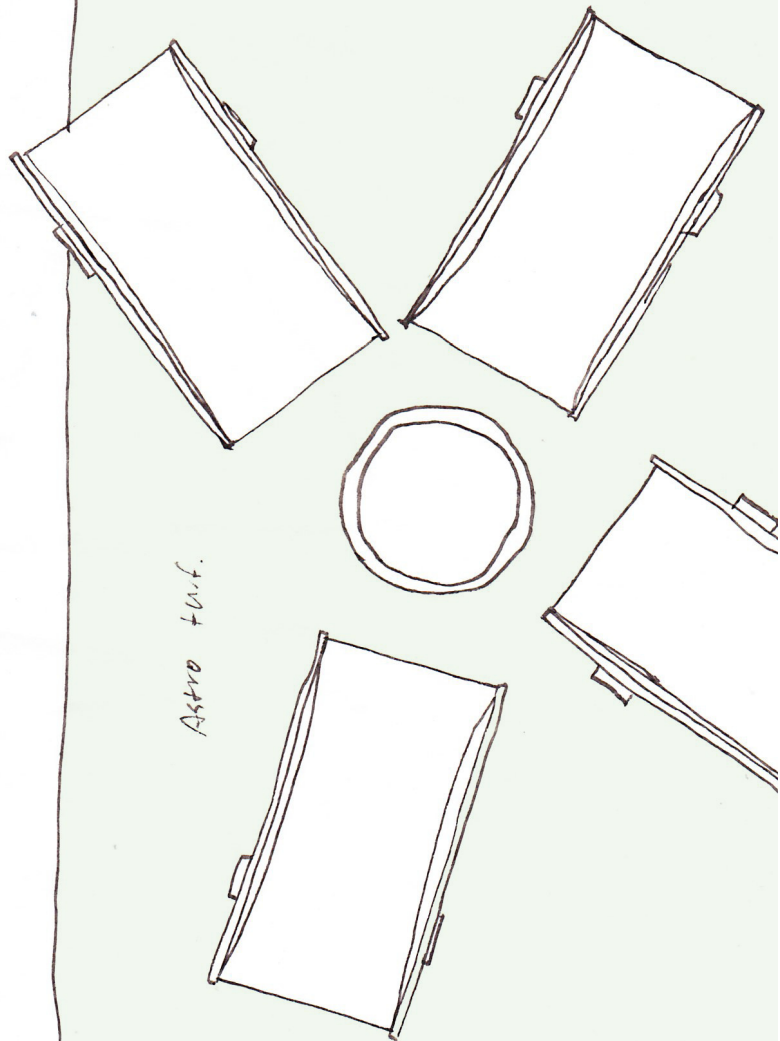
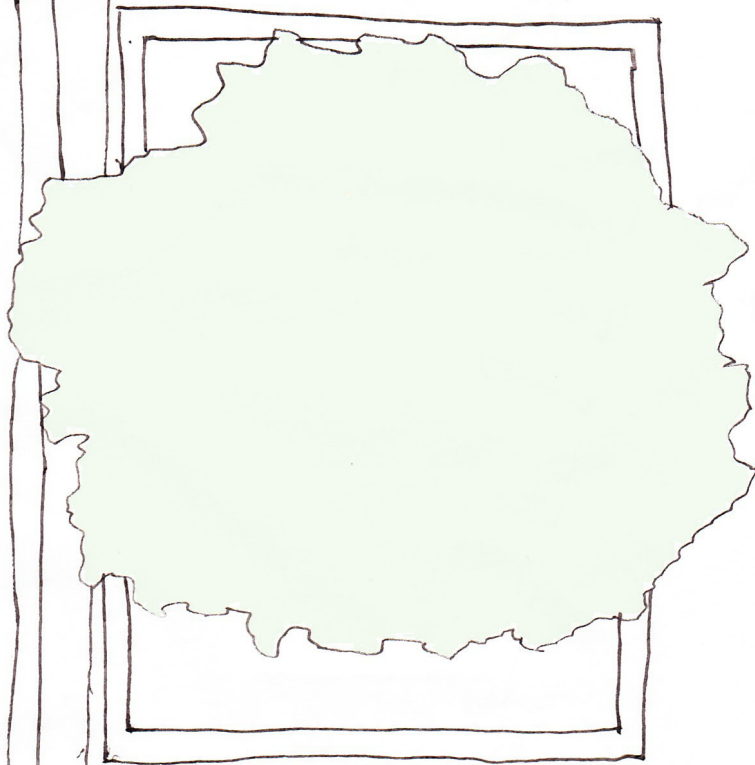

Step 4: Pallet



Step 5: The condition of place

What type of space is it?

It is commonly called a 'pop-up park' by the local population in Yarraville. It is a temporary urban park.

Does it get any sun or is it constantly in shade?

It occupies an entire block of Ballarat St in Yarraville. It therefore gets a large amount of sun between mid morning and mid afternoon, as Ballarat St run east-west.

Is it formal or casual?

It has the ability to be both. Usually families and small groups will congregate there for a period of time during late afternoon. However it has been used as a premier red carpet venue.

Is it passive or active?

It can be both as it is functional and yet does not need to be used to be aesthetically pleasing.

Does it promote social interaction of a familiar/private nature or is it immediate and very public?

It promotes positive social interaction. It is very public.

Does one feel sheltered or exposed?

It is quite exposed but the shop awnings are within very close proximity to the park so refuge from weather is easily attained.

Is it quite or noisy?

It can be both, depending upon the amount of people using the space.

Is it comfortable, if so for how long?

It is quite comfortable, especially in the folding deck chairs. If you have to leave the park it will most likely be due to a prior engagement, not discomfort.

Is it flexible, ie can one shift the seats with ease or is the arrangement fixed?

Yes, it can be arranged by any of the users in the space.

Understanding Place through Size and Scale: “Measuring the shape and articulation of public space.”

Cold space



Width of the pavement, extension of awnings, verandas, or balconies, if any
7000mm, no awnings, verandas or balconies

Depth of the curb
150mm

Heights of the building or surrounding buildings forming the space
6500mm

The paced distance across the road to the other side of the street or lane way.
19000mm

The location of any furnishings and landscaped features, such as trees, planter boxes
No furnishings

The size of openings & doorways & their distance from the property boundary to the foot path,
The only door here is set back 500mm from the property boundary and foot path

The size and location of windows, if any.
the windows in this space are very large and are quite overpowering. Most of them are obstructed from within the retail space. Additionally, about 50% of the viewable windows are empty

Warm space

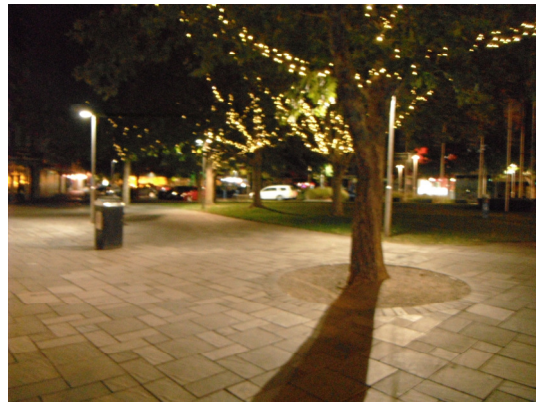

Width of the pavement, extension of awnings, verandas, or balconies, if any
14000mm, awnings 2500mm

Depth of the curb
No curb within this space

Heights of the building or surrounding buildings forming the space
Ranges from 3500mm – 5500mm

The paced distance across the road to the other side of the street or lane way.
From one end of the urban park to the other is 30000mm

The location of any furnishings and landscaped features, such as trees, planter boxes
There is a public bench chair in close proximity to a lamp and rubbish bin. Additionally there is a large amount of tree cover over the entire park and bench chair

The size of openings & doorways & their distance from the property boundary to the foot path,
The door ways in the space are recessed by 1000mm from the property boundary and foot path

The size and location of windows, if any.
Very large windows in this space, they look into the bar and beer garden and are quite inviting.

Step 1: Plans, Sections and elevations at 1:100

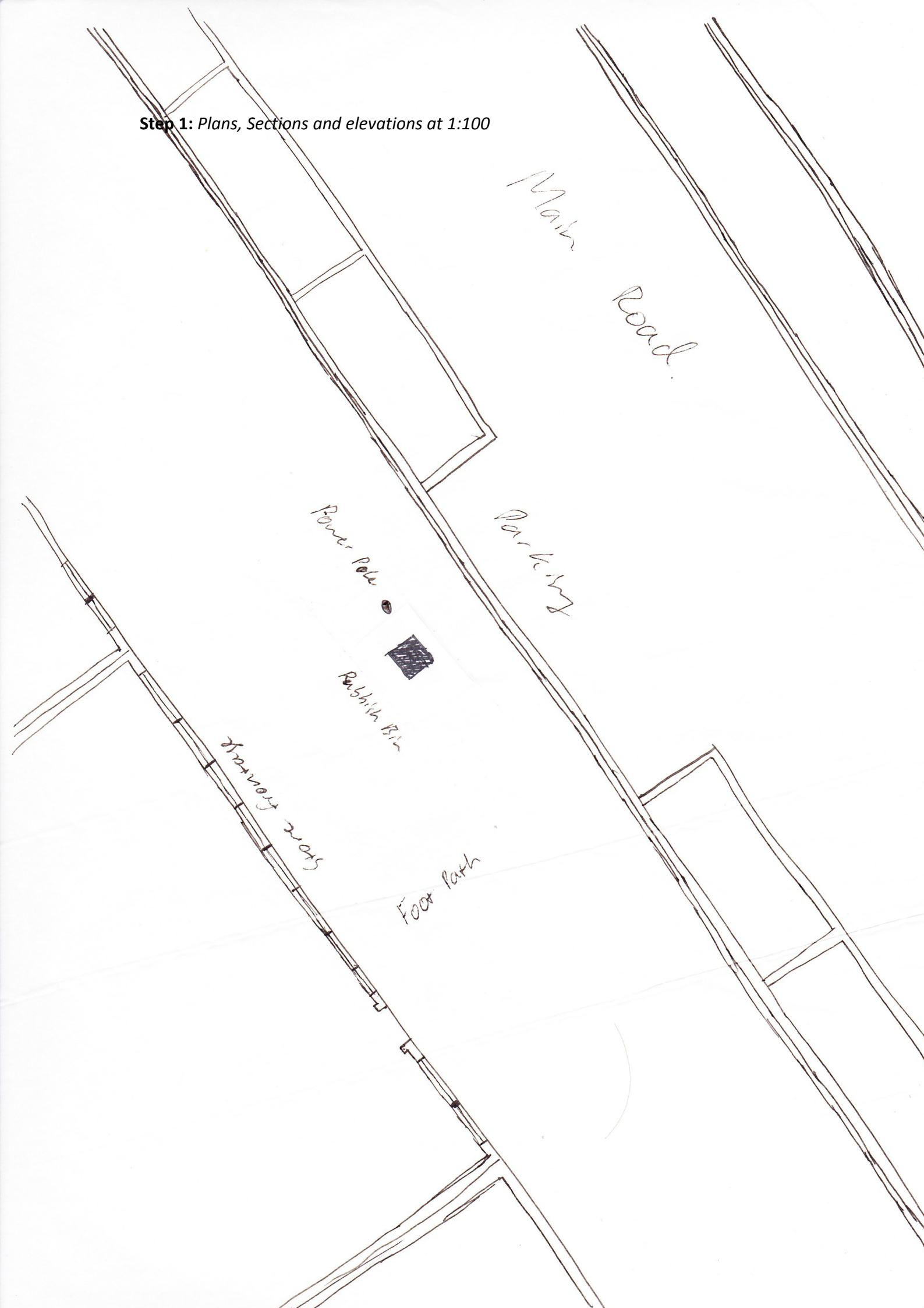

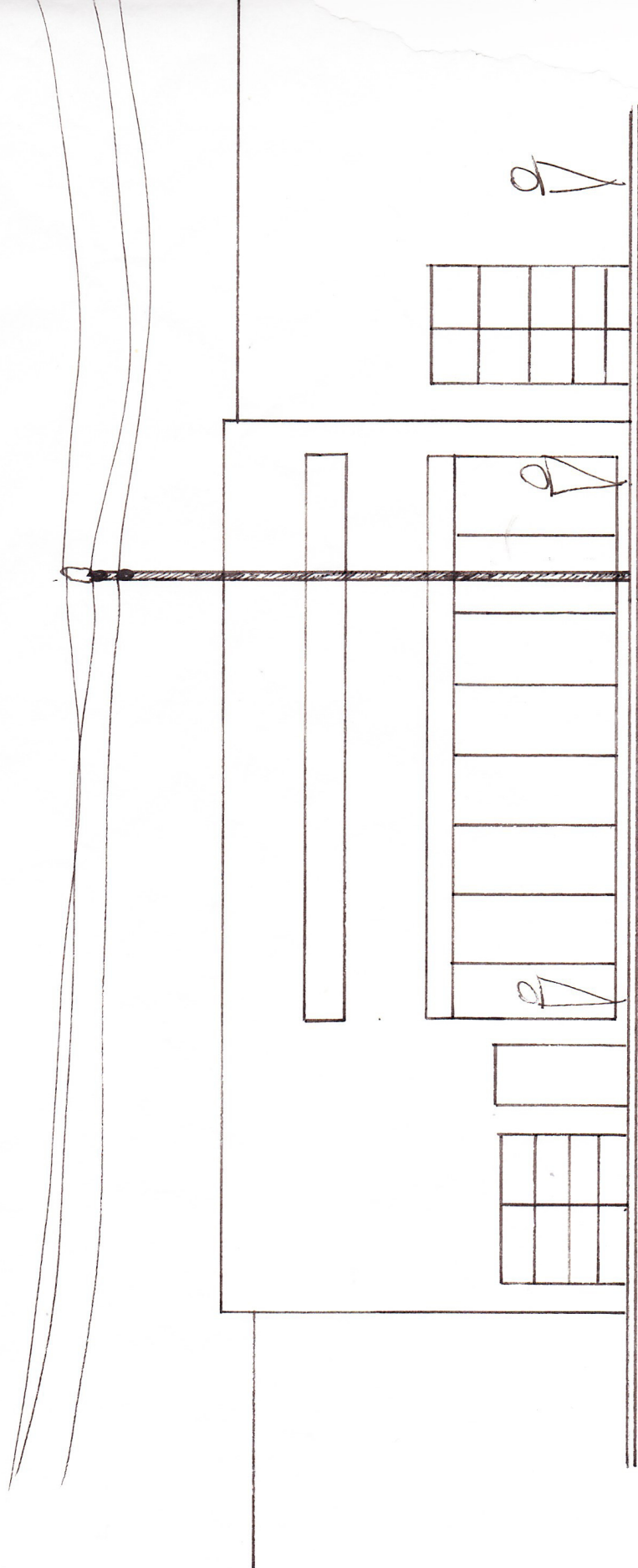

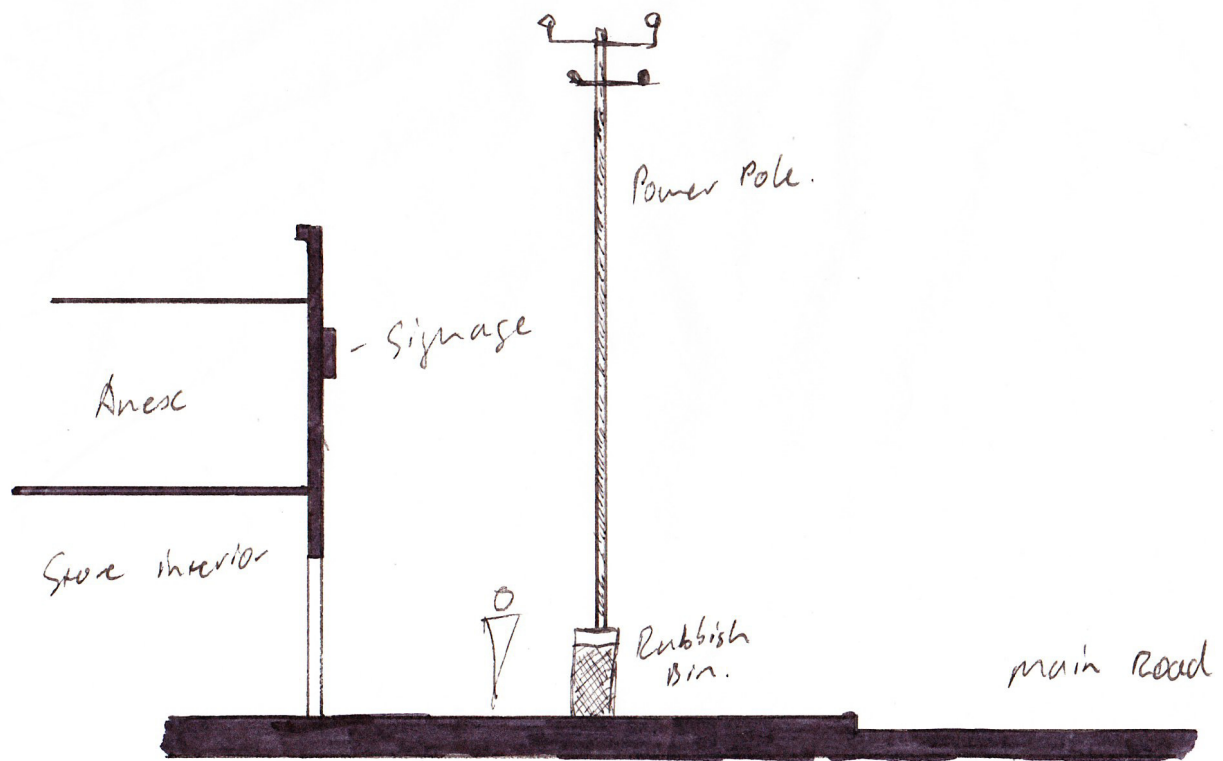

The reason why I felt this space was cold, are that it did not have any vegetation, had sheer walls directly next to the foot path and vehicular traffic is quite close to the foot path. All of these factors make this space not a nice place to spend much time in.

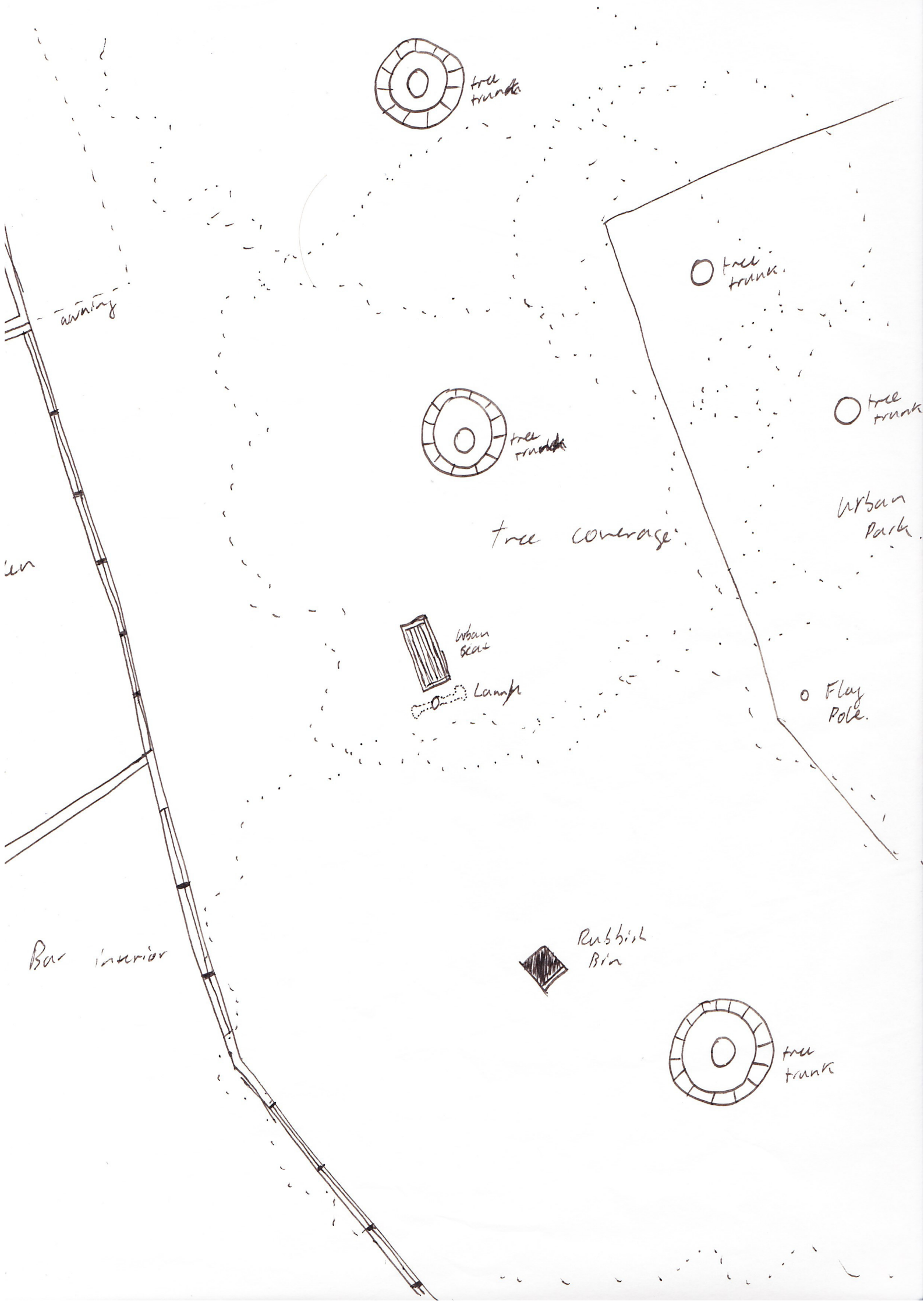

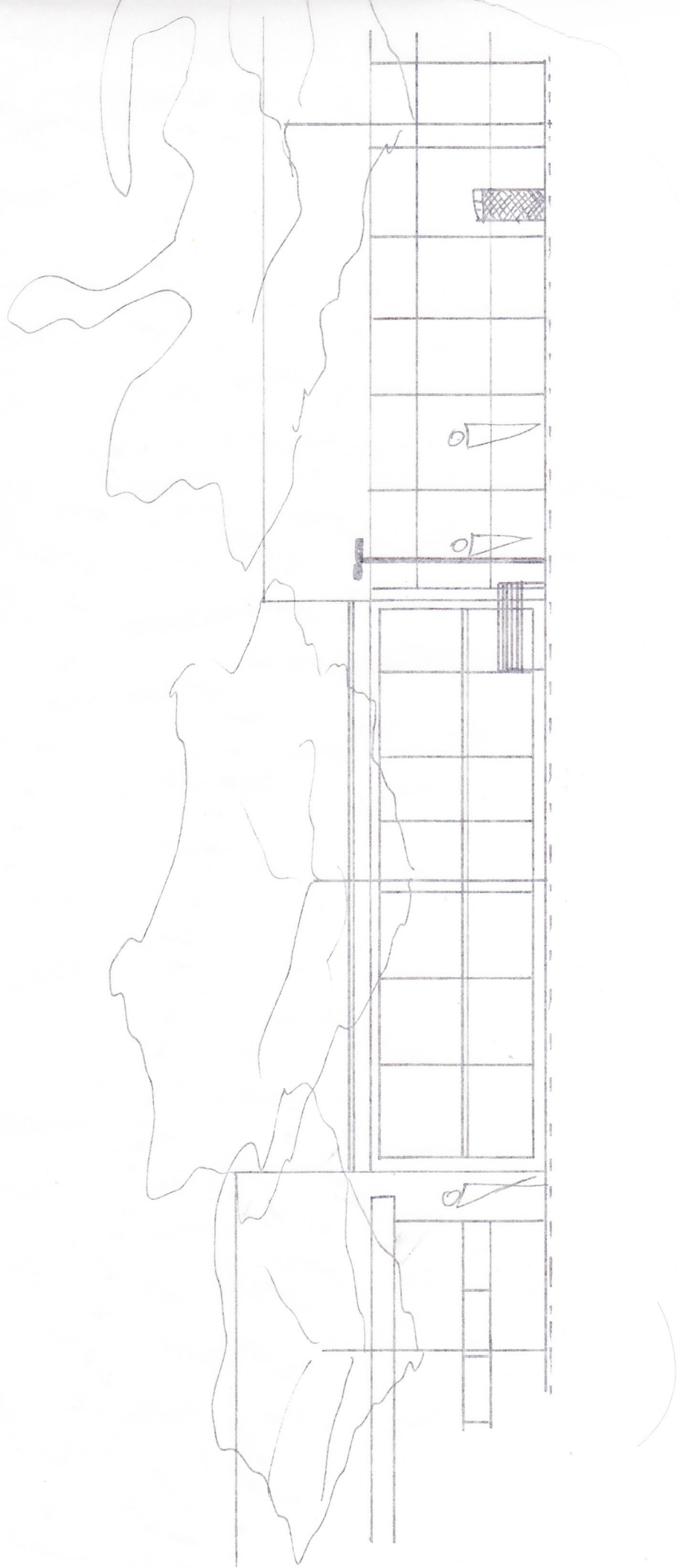

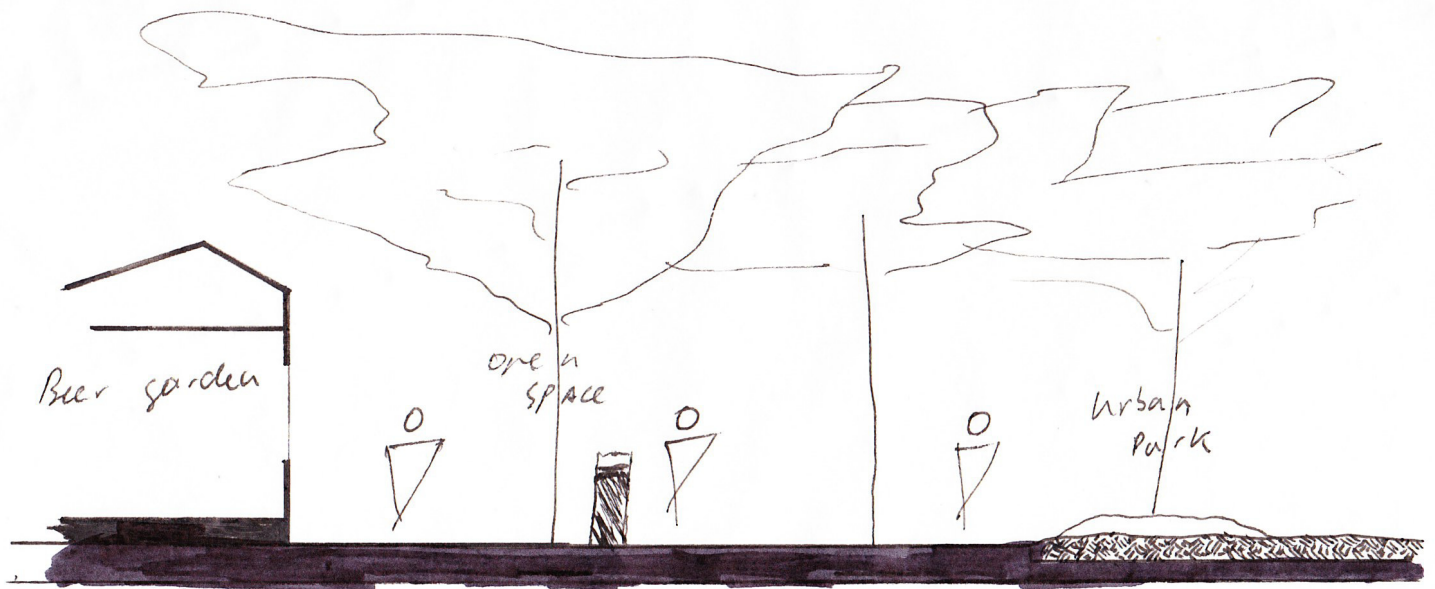

This urban space was chosen as a warm space as it contains large amounts of vegetation, has inviting views of a boutique beer hotel, has a wide thoroughfare and is well away from traffic. These factors make this space a very positive one, allowing people to enjoy the space.

Step 2: Generic scale

Cold Space

- The buildings directly adjacent to the space quite literally overshadow the footpath.
- The lack of any real props in and around the space create a sense of isolation
- The proportion of building to foot path creates a feeling that the main focus is the building not the movement of people.

Warm Space

- It is quite a large space.
- Large amount of high vegetation means that there is an overhead canopy which semi-encloses the space from the elements
- It acts as a thoroughfare to and from the main street and the station

Step 3: Human Scale

Cold Space

- Foot path pattern is quite off putting
- Proximity to vehicular traffic is quite confronting
- The lack of awnings or shelter from the elements creates a very uneasy feeling

Warm Space

- Interaction on the human scale through visual cue such as walking by someone or view patron at the bar
- Pattern on foot path juxtaposed with lawn is quite aesthetically pleasing
- Utilities such as seating, waste disposal and lighting are in close proximity with each other and create a cluster of usages.