

# For Lease

## High Exposure Retail / Office Semiahmoo - White Rock

### Location

Semiahmoo | Johnston Road  
1812 - 152 Street | White Rock

### McGladery Commercial

RE/MAX Commercial Advantage

### Contact

Rachel McGladery

604.290.8777

rachel@mcgladery.ca

Joshua McGladery

604.418.2690

joshua@mcgladery.ca

## Flagship head office with retail presence

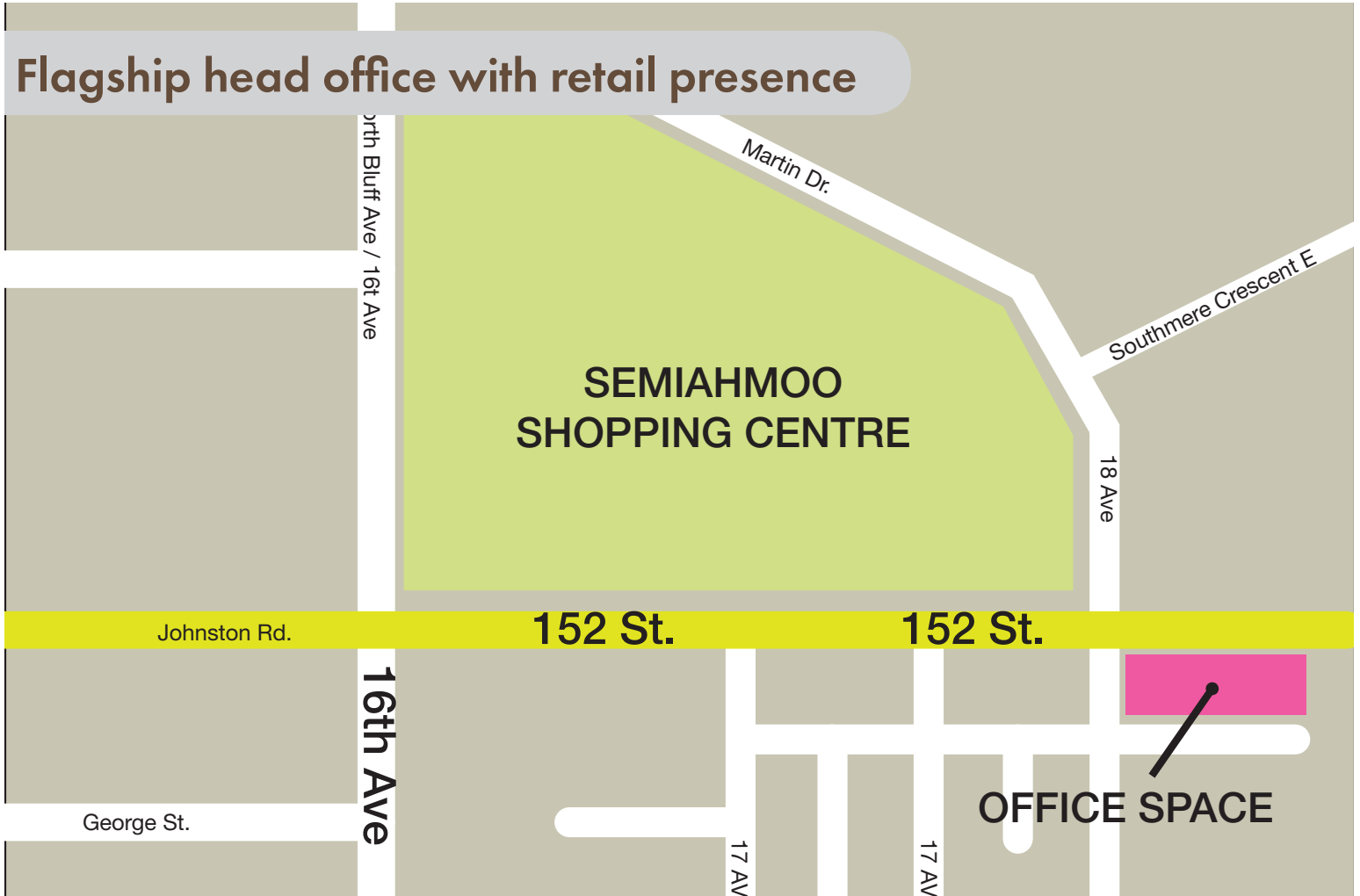

## HIGHLIGHTS

- In the heart on White Rock's main shopping district
- High exposure unit on 152 Street
- Ground floor retail also available
- Serving one of BC's most affluent markets

RE/MAX  
COMMERCIAL

#500-889 West Pender St. Vancouver



# For Lease

## Semiahmoo

White Rock

1812 - 152 Street

# 1812 PLAZA



## OPPORTUNITY

- Perfect for an executive head office
- Opportunity for additional retail space
- Great exposure
- Large windows allowing for ample signage
- Desirable location steps to Semiahmoo Shopping Centre
- Designated reserved parking in front of premises
- Private elevator

## LOCATION

Located at the high exposure corner of 18th Avenue and 152 Street in White Rock next to Semiahmoo Shopping Centre. Centrally located to capture the full Surrey demographic.

## DETAILS

<b>Address</b>	1812 - 152 Street, Surrey, BC
<b>Zoning</b>	C-8 allowing wide range of office & retail uses
<b>Parking</b>	Large surfaced customer parking lot
<b>Average household income</b>	\$95,000

## LEASE CHART

Unit	Size	Basic Rent	Ops & Taxes	Gross Rent
<del>101A</del>	<del>440 SQ. FT.</del>	<del>\$10</del>	<del>\$14.31</del>	<del>\$1,991.36</del>
203	3782 SQ. FT.	\$16	\$16.73	\$10,315.40

Rachel McGladery\*  
rachel@mcgladery.ca  
\* Personal Real Estate Corporation  
604.290.8777

Joshua McGladery  
joshua@mcgladery.ca  
604.418.2690

RE/MAX Commercial Advantage



Disclaimer: Although the information contained within is from sources believed to be reliable, no warranty or representation is made as to its accuracy being subject to errors, omissions, conditions, prior lease, withdrawal or other changes without notice and same should not be relied upon without independent verification. RE/MAX Commercial Advantage

# For Lease

**Semiahmoo**

White Rock

1812 - 152 Street

## 1812 PLAZA



### SITE PLAN

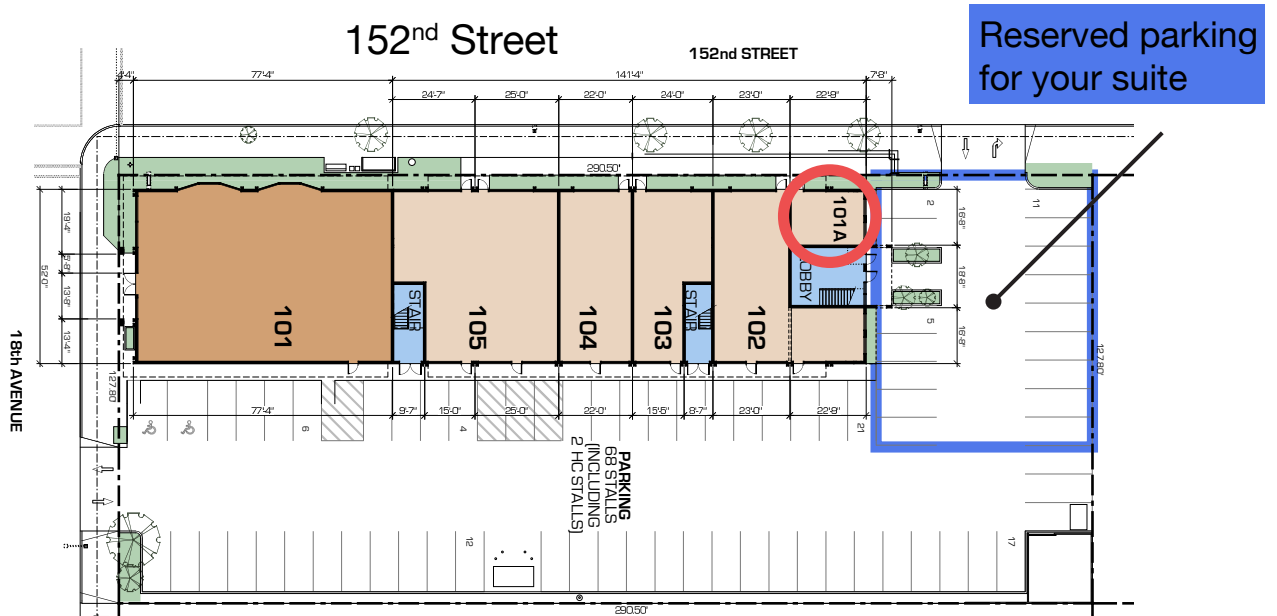

Rachel McGladery\*  
rachel@mcgladery.ca  
\* Personal Real Estate Corporation  
604.290.8777

Joshua McGladery  
joshua@mcgladery.ca  
604.418.2690

RE/MAX Commercial Advantage



Disclaimer: Although the information contained within is from sources believed to be reliable, no warranty or representation is made as to its accuracy being subject to errors, omissions, conditions, prior lease, withdrawal or other changes without notice and same should not be relied upon without independent verification. RE/MAX Commercial Advantage



# For Lease

**Semiahmoo**

White Rock

1812 - 152 Street

## 1812 PLAZA



### SUITE LAYOUT



Rachel McGladery\*  
rachel@mcgladery.ca  
\* Personal Real Estate Corporation  
604.290.8777

Joshua McGladery  
joshua@mcgladery.ca  
604.418.2690

RE/MAX Commercial Advantage



Disclaimer: Although the information contained within is from sources believed to be reliable, no warranty or representation is made as to its accuracy being subject to errors, omissions, conditions, prior lease, withdrawal or other changes without notice and same should not be relied upon without independent verification. RE/MAX Commercial Advantage

# For Lease

**Semiahmoo**

**White Rock**

1812 - 152 Street

## 1812 PLAZA



### LEASE PLAN

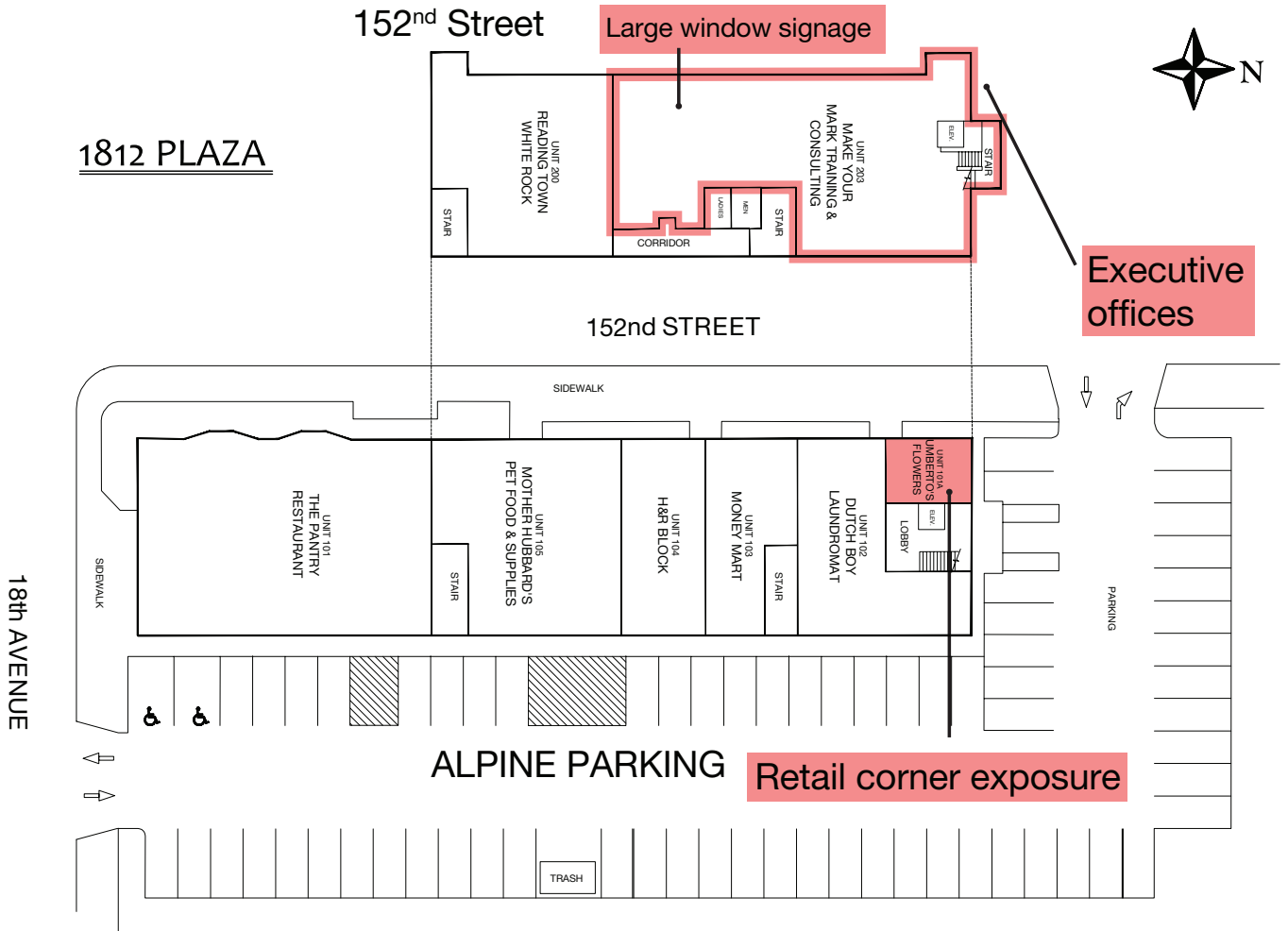

Rachel McGladery\*  
rachel@mcgladery.ca  
\* Personal Real Estate Corporation  
604.290.8777

Joshua McGladery  
joshua@mcgladery.ca  
604.418.2690

RE/MAX Commercial Advantage



Disclaimer: Although the information contained within is from sources believed to be reliable, no warranty or representation is made as to its accuracy being subject to errors, omissions, conditions, prior lease, withdrawal or other changes without notice and same should not be relied upon without independent verification. RE/MAX Commercial Advantage