

For Sale

Exclusive Retail Strata Units Grandview - South Surrey

McGladery Commercial

RE/MAX Commercial Advantage

Location

Grandview/Morgan Crossing | 24th Ave.
2388-156 Street | South Surrey

Contact

Rachel McGladery

604.290.8777

rachel@mcgladery.ca

Joshua McGladery

604.418.2690

joshua@mcgladery.ca

Rare Strata Sale



HIGHLIGHTS

- Gateway to South Surrey's Mega Shopping Destination
- High Exposure Retail Units
- Perfect for Medical & Dental Owners
- Serving one of BC's Most Affluent Markets

RE/MAX
COMMERCIAL

#500-889 West Pender St. Vancouver



For Sale

Grandview Centre South Surrey

2388 - 156 Street

24th Ave. Retail!



OPPORTUNITY

- This is the Place to Be!
- Own your Future!
- Be your own Billboard!
- Huge Windows and entry doors on both sides – catching maximum light & visibility
- Reach the Fraser Valley's most sought after demographic with this highly visible retail space – over 85,000 people within 5 km and growing!

LOCATION

Located at the high exposure corner of 24th Avenue and 156 Street in South Surrey at the Gateway to South Surrey's Mega Shopping Destination – Grandview Corners & Shops at Morgan Crossing. Quick access to King George Hwy, Hwy 99, 152 Street and White Rock.

Grandview is the new residential and commercial hub of South Surrey with significant new developments coming. This is the place to own your future.

DETAILS

| | |
|---|--|
| Address | #103 & 104 – 2388 156 Street, Surrey, BC |
| Future Strata | After offer acceptance Seller will commence strata registration process |
| Estimated Strata Completion & Closing Date | August 1, 2020 |
| Future Strata Units | #103 & 104 |
| Size | #103: 1,656 SF.* #104: 1,614 SF.* |
| Parking | Shared parking in common. Complex has 31 stalls in total with additional street parking. |
| Zoning | C-5 allowing wide range of office & retail uses |
| Traffic Counts | 18,000 + VPD |
| Asking | #103 = \$1,323,124 #104 = \$1,289,586 |

* subject to final survey

Rachel Mcgladery*
rachel@mcgladery.com
* Personal Real Estate Corporation
604.290.8777

Joshua Mcgladery
joshua@mcgladery.com
604.418.2690

RE/MAX Commercial Advantage



Disclaimer: Although the information contained within is from sources believed to be reliable, no warranty or representation is made as to its accuracy being subject to errors, omissions, conditions, prior lease, withdrawal or other changes without notice and same should not be relied upon without independent verification. RE/MAX Commercial Advantage

For Sale

Grandview Centre

South Surrey

2388 - 156 Street

24th Ave. Retail!



Expansive Windows and 16 Foot Ceilings

Rare Strata Sale

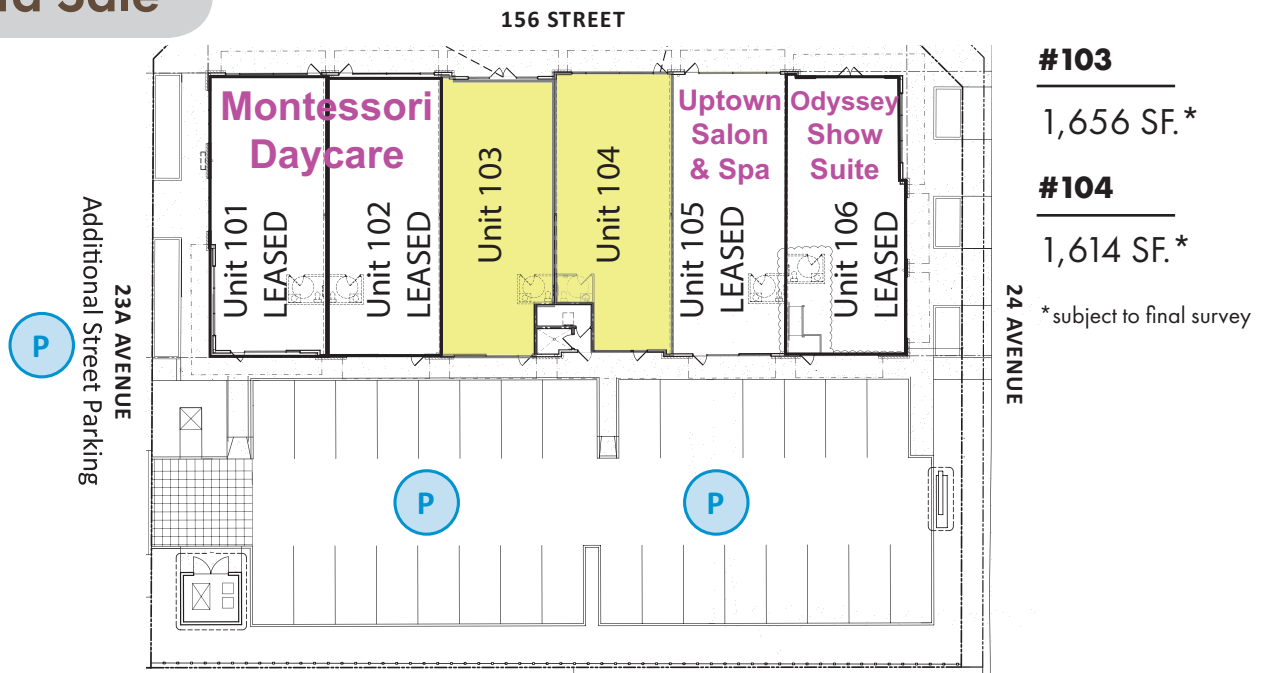

#103
1,656 SF.*

#104
1,614 SF.*

* subject to final survey



Rachel Mcgladery*
rachel@mcgladery.com
* Personal Real Estate Corporation
604.290.8777

Joshua Mcgladery
joshua@mcgladery.com
604.418.2690

RE/MAX Commercial Advantage



Disclaimer: Although the information contained within is from sources believed to be reliable, no warranty or representation is made as to its accuracy being subject to errors, omissions, conditions, prior lease, withdrawal or other changes without notice and same should not be relied upon without independent verification. RE/MAX Commercial Advantage