



AMPS Atlanta 2018 Club Project

M2/M3 Halftrack Family Part 2 – The Build Begins

Step 1

Assembly step 1 instructions has a few mistakes:

- The engine fan (part A35) is shown in the wrong location. This matters when trying to fit to the radiator assembly.
- Parts A3 and A4 are reversed in the instructions, as are A8 and A9.

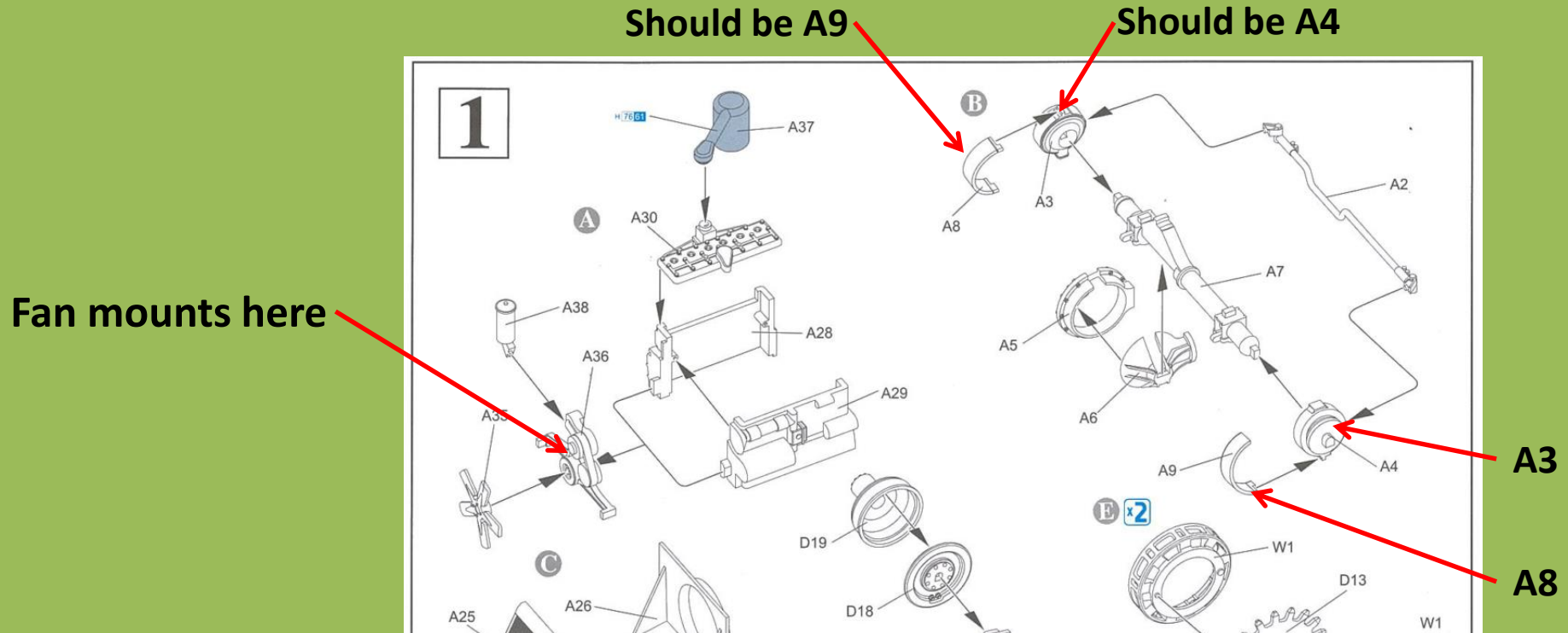

Step 1 Cont'd

Correct configuration of front axle.
Viewed from the front, hubs (part
A3 and A4) angle inward at the
top.



A4

A3

Not here

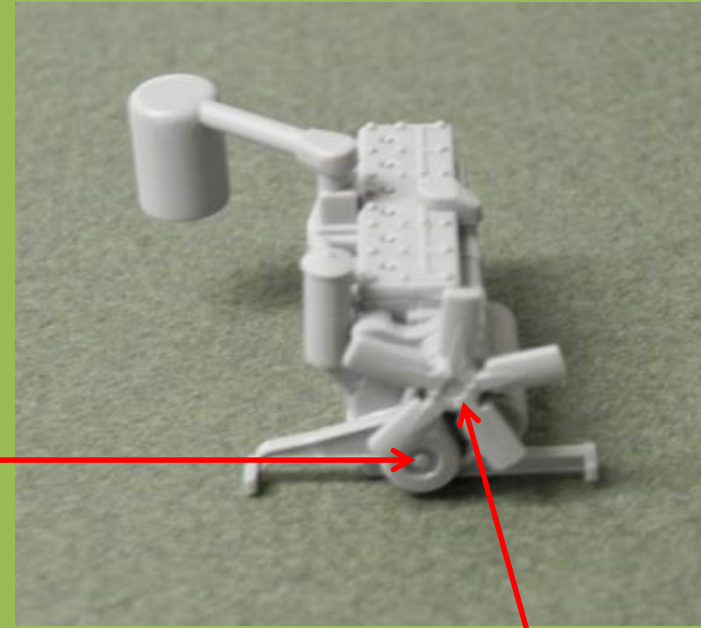

Front view of
assembled engine
with fan in correct
position.

- **Drive and idler sprockets are beautifully molded.**
- **They have some punch out marks on the front faces.**
- **These are easily removed by gently scraping with a #10 blade (shown).**
- **Also, some parting lines on the outside diameters.**

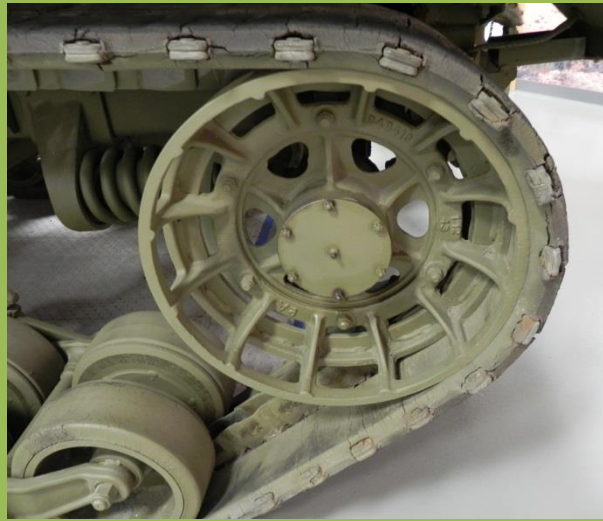

Punch out marks



Steps 2 & 3

- **Another minor issue with instructions.**
- **In step 2, part D34 is shown backwards.**
- **In step 3, it is shown correctly oriented.**

Backwards



2

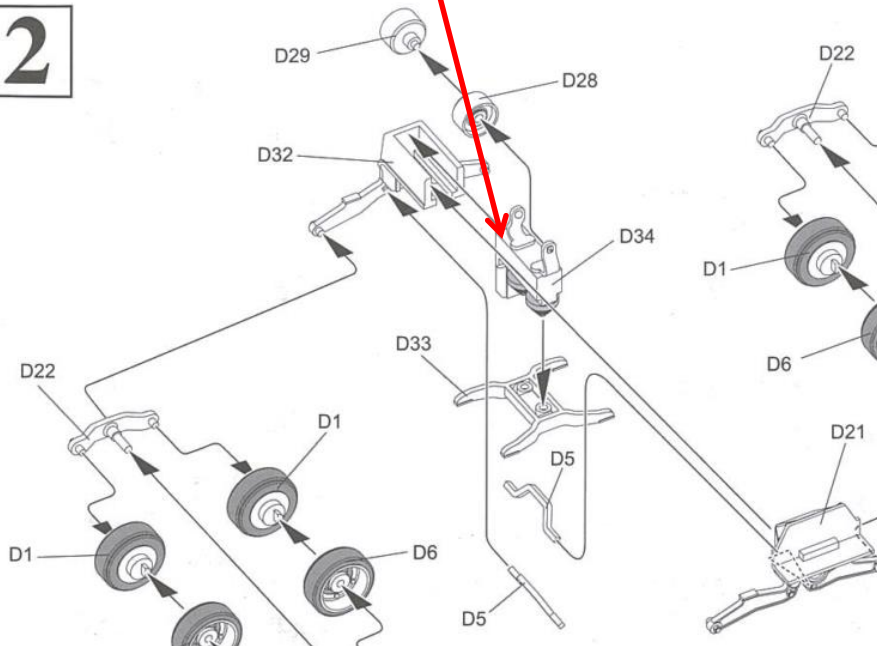

Correct Orientation



3

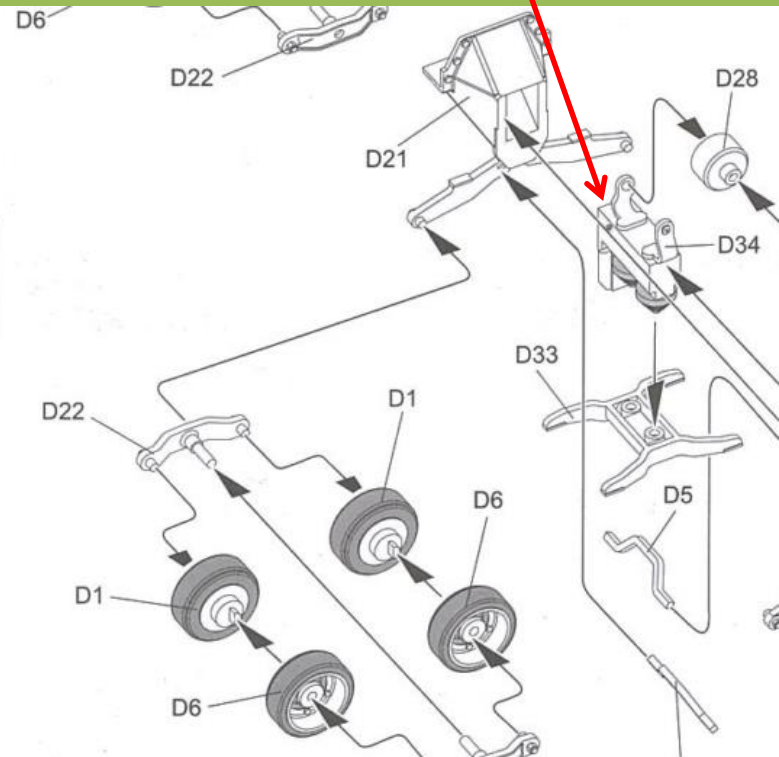

Rear Bogies

- **Note mounting bolts**

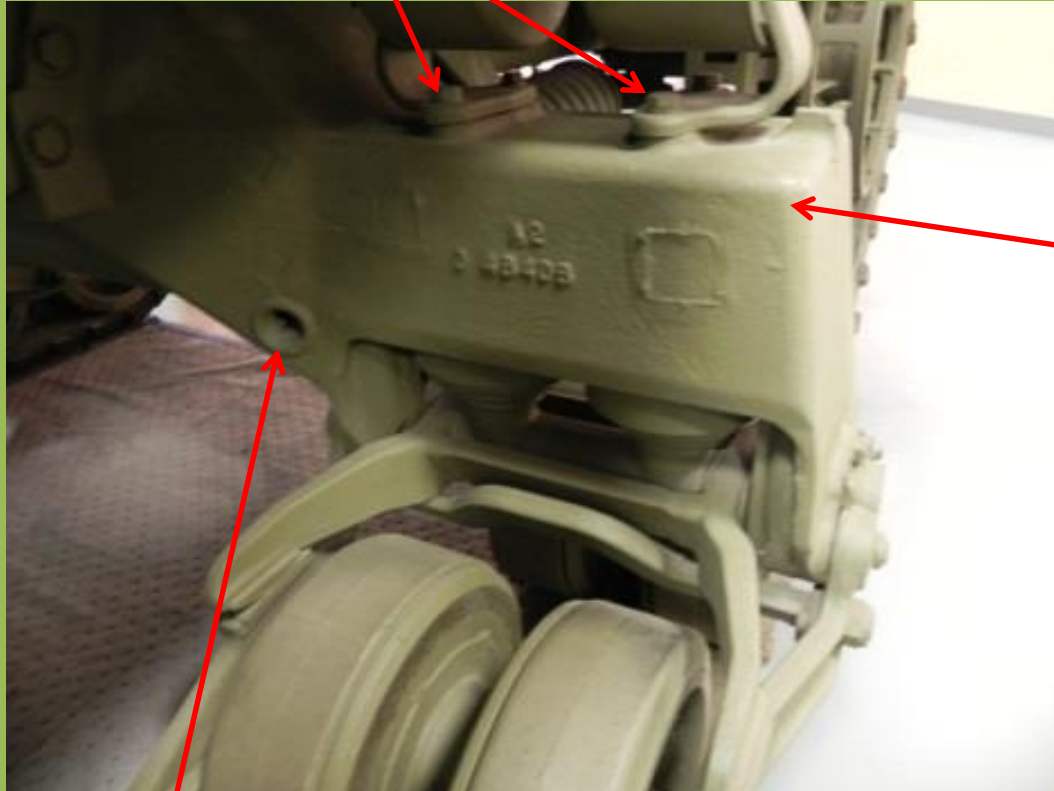

Note that housing is a single casting

Reinforced hole

Rear Bogies

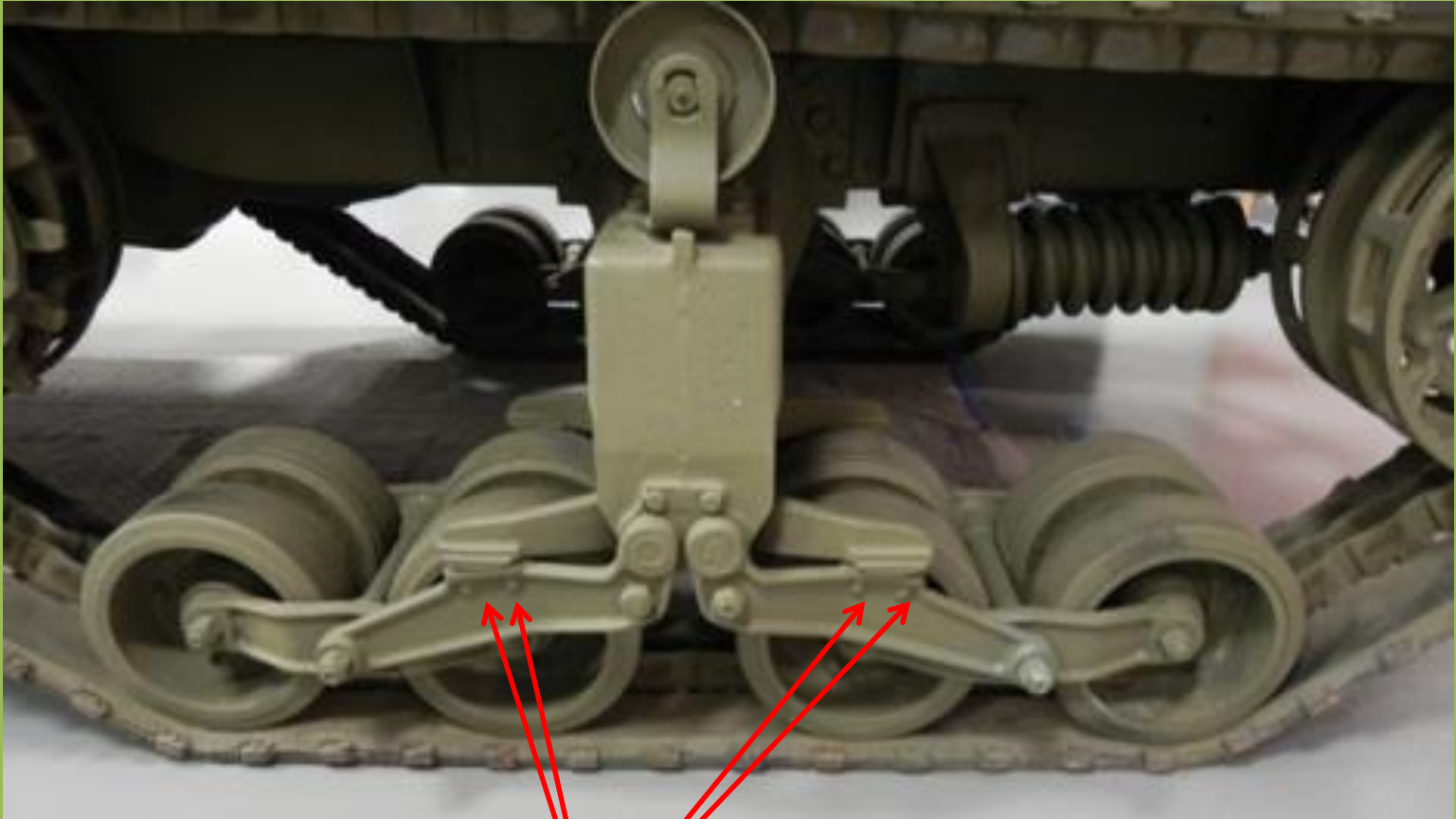

**These are missing
on the kit**

Rear Bogies



I chose to build this version with the reinforced hole in the bogie

Rear Bogies

- I built a simple jig to accurately place 0.025" holes in the bogies

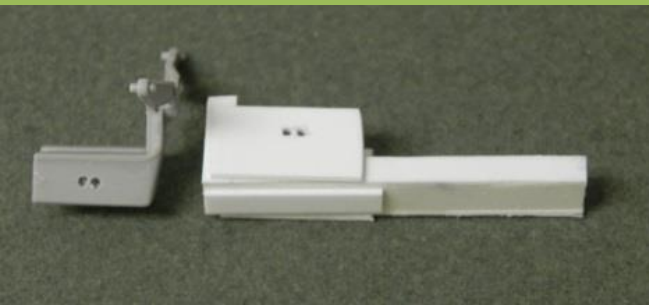
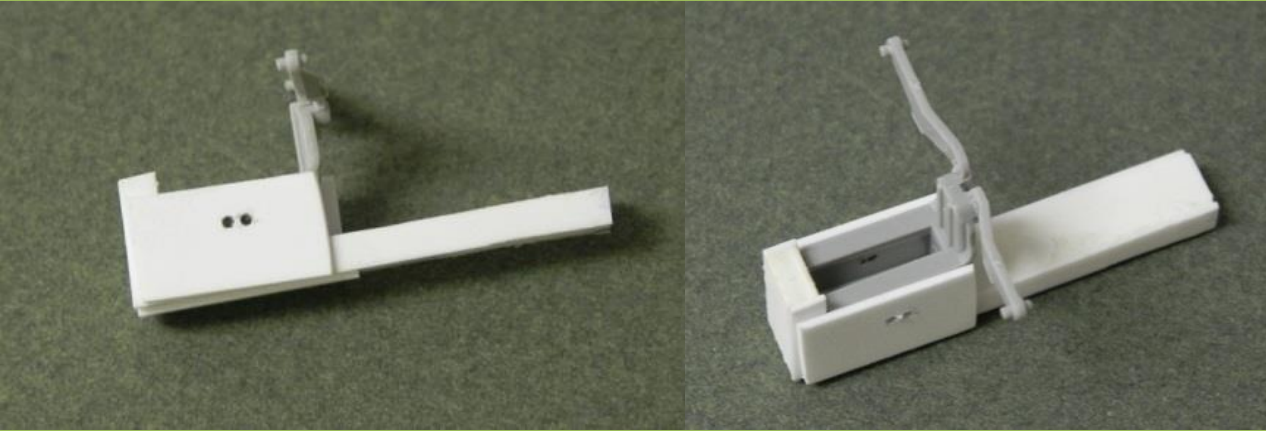

Then, I opened up the holes to 0.035" and cut out to one single oval hole

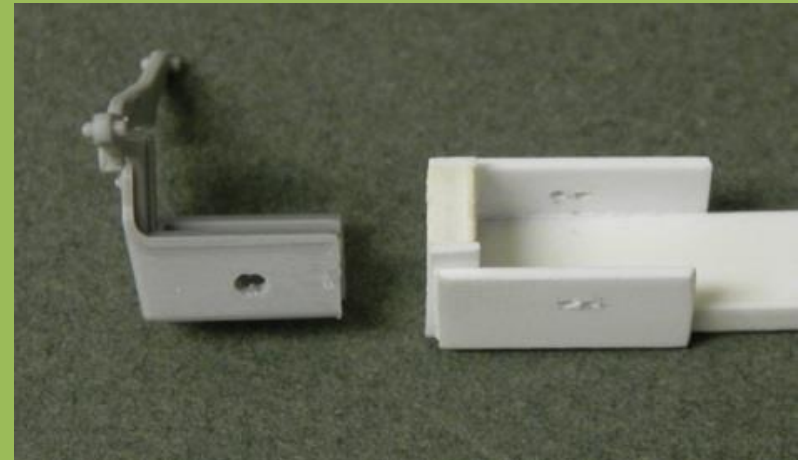

Rear Bogies

I made the reinforcing rings out of 0.010" wire wrapped around a couple of pieces of 0.035" plastic rod that was glued together

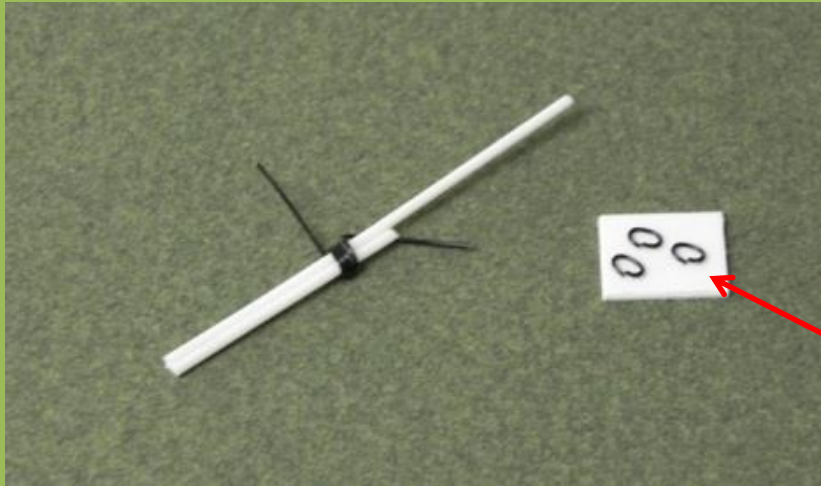

Flatten the resulting rings with the flat end of a pair of tweezers and reshape slightly by gently squeezing with tweezers

Cut through all wraps with a #11 blade

- Note that the same method was used to make the smaller round reinforcing rings on the bogies, only using 0.005" wire.

(Nearly) Completed Bogie

**Mounting bolt heads (Grandt Line 127
1-1/2" Hex Nut, Bolt with the bolt
sanded off**

**I filled these seams so the bogie
looks like a single casting**

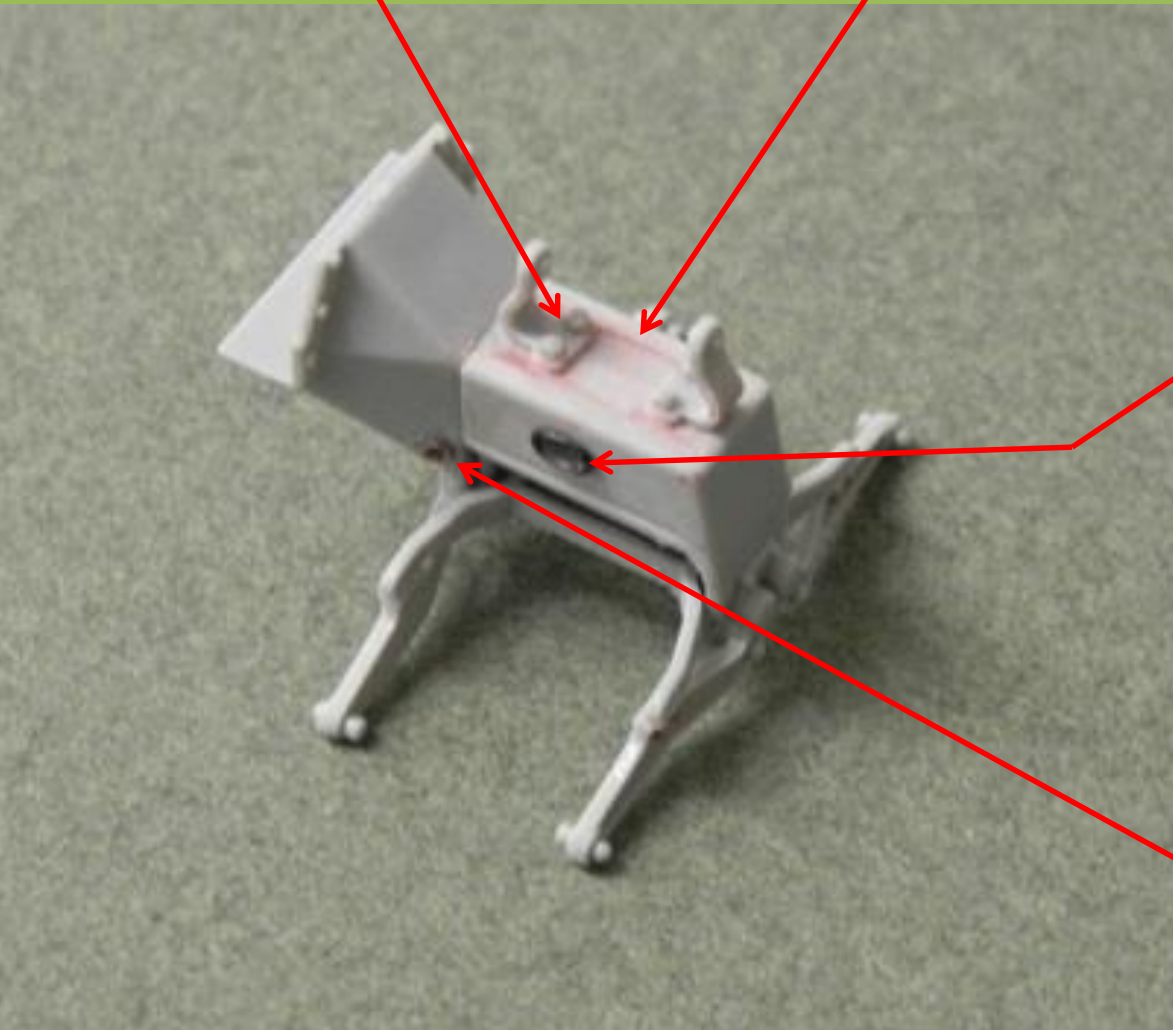

**Oval hole with reinforcing
ring (sanded flat on back
and glued with cyano
glue)**

**Smaller round hole
with reinforcing ring**

More of the Bogies

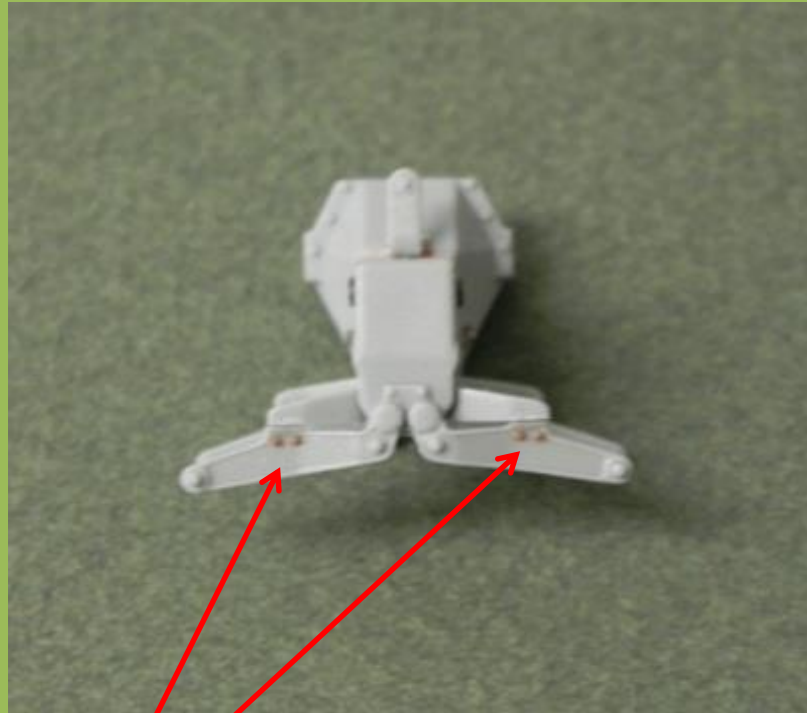

Added rivet heads.

These are Tichy Train Shop
0.020" Round Head Rivets

Bogie Wheels

There is a pretty pronounced seam where the wheels are joined. It may be visible on the completed model

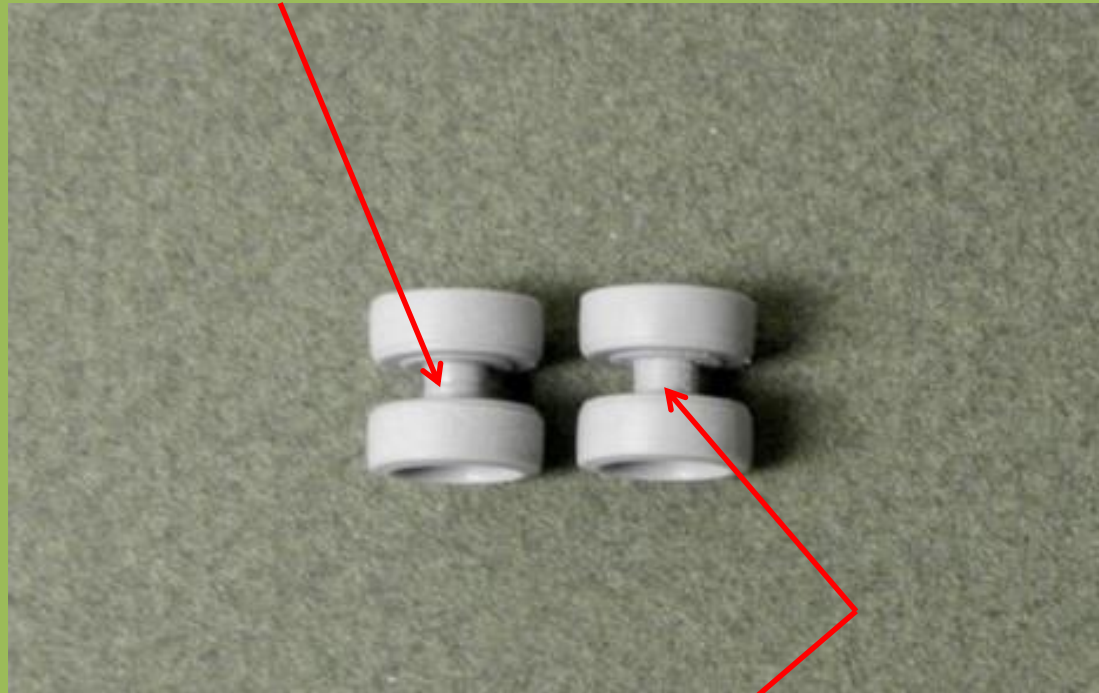

I applied some thin cyano glue (Dr. Mike's) around the joint, then lightly filed smooth

Completed Bogies

- I replaced the funky molded in connecting rods with 0.035" rod
- Original parts had a butt joint squarely in the middle that is difficult to clean up.

0.035" rod

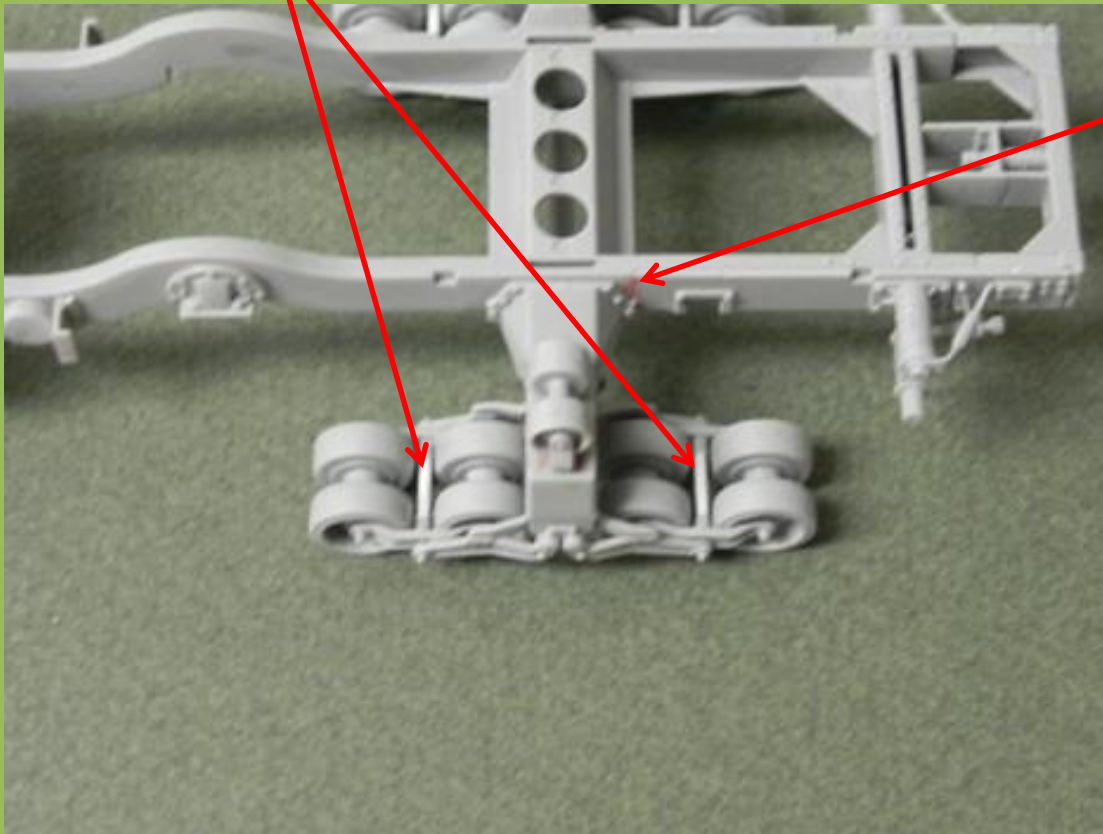

There is a joint in the frame assembly here that needs filling

Idler Springs

I will show you how I did these next time

Molded kit spring

0.125" tubing and
0.025" wire "spring"

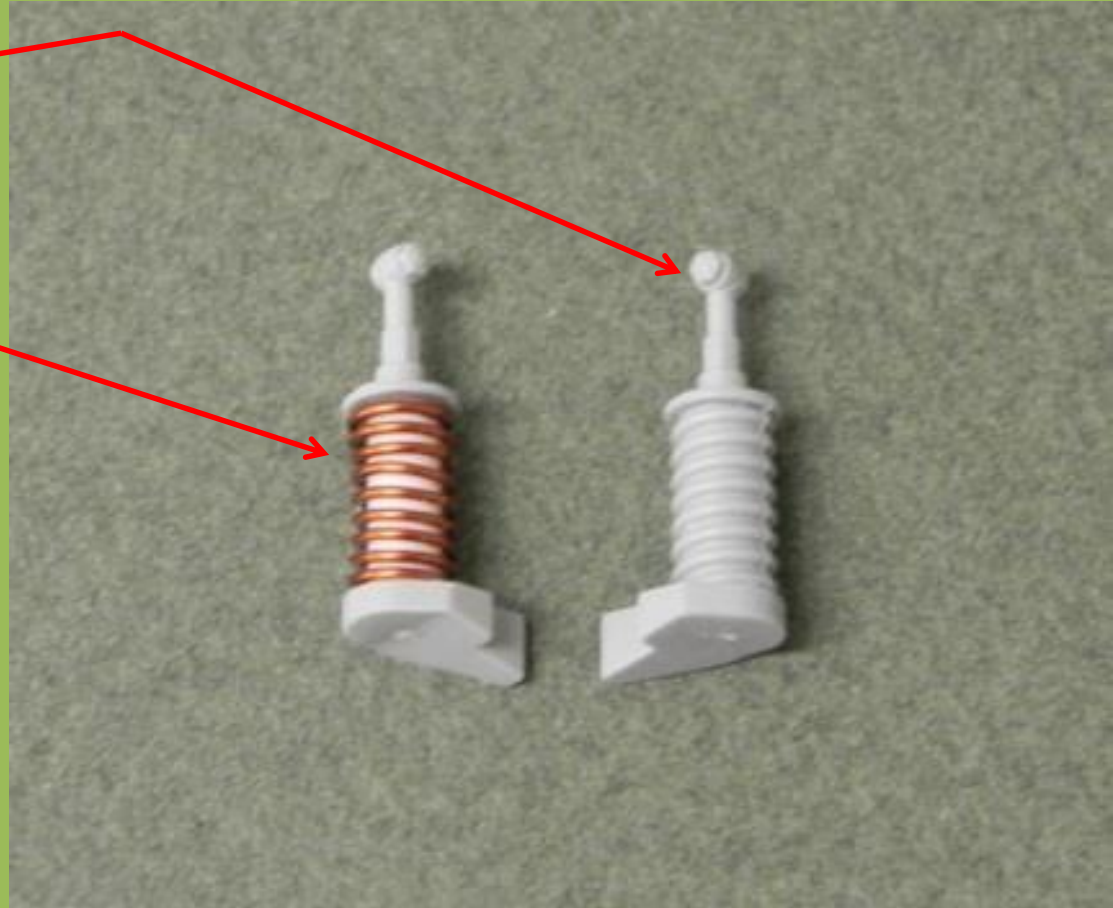

Steps 1-4

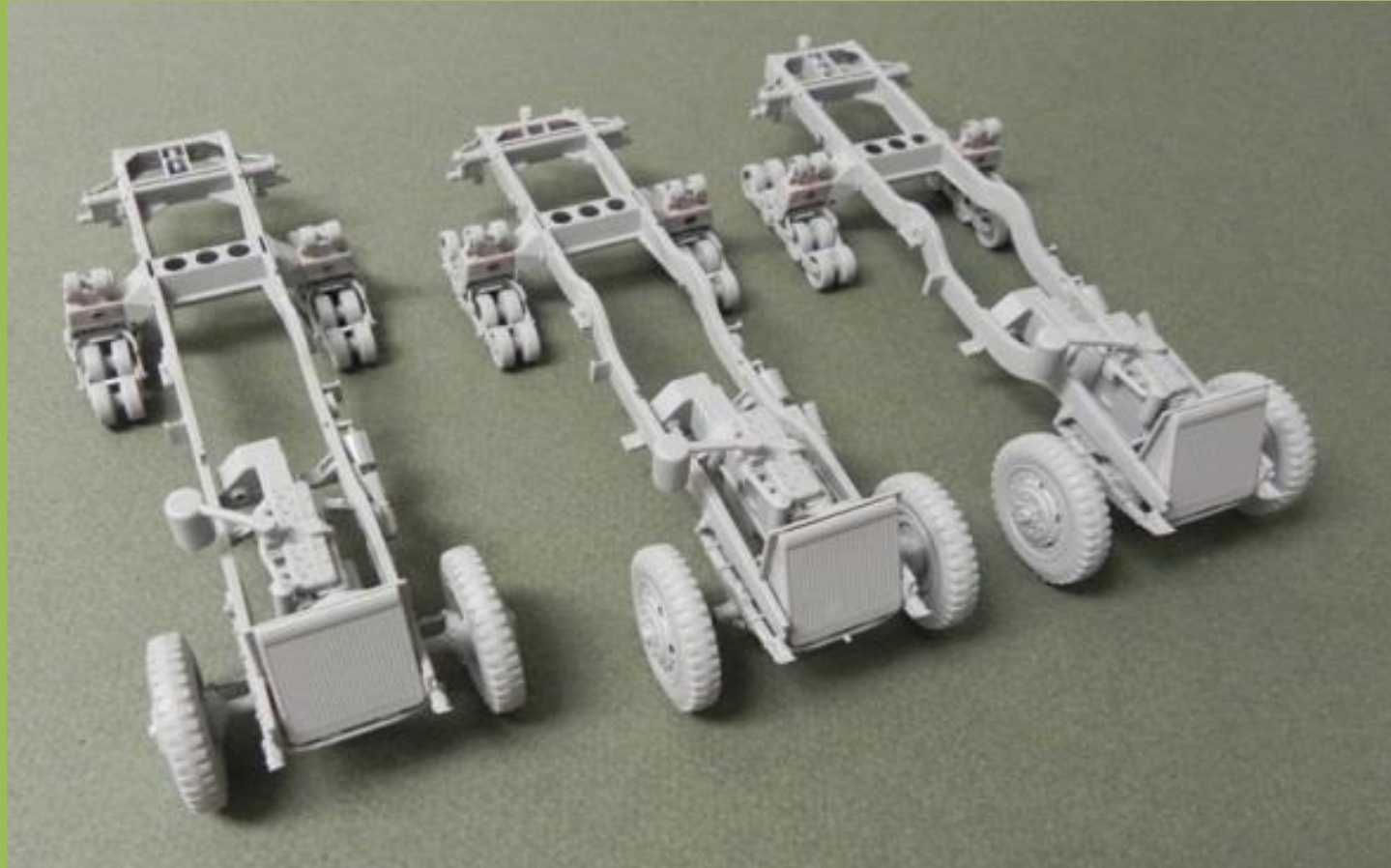

M3A1

M2A1

M3 GMC

Build Tips

- **I had saved a complete build log on the M2A1 from the AMPS website back in 2006. I think it was by Paul Fannin? It was quite helpful**
- **There was also an M2 HT “tweaks” list from Missing-Lynx by CW Cesafsky that was helpful as well.**
- **And thanks to Dave Black for pointers and reference photos on the M2A1.**

Build Schedule

These Will Vary Slightly For Each Version

- **August-Steps 1-4**
- **September-Steps 5-7**
- **October-Steps 8-12**
- **November-Steps 13-19**
- **December-Paint the Beasts**