

AMPS Atlanta 2023 Club Project



M113A1 ACAV (Vietnam)

PART 3

Sections 9 thru 16

AMPS Atlanta 2023 Club Project

*** **NOTE:** I have found that there is a good amount of warp page in this kit. I'm not sure if it is in all kits or just the one that I have, but I would caution you to dry fit everything. Also, there are some cases where locating tabs do not fit into the provided slots without some additional sanding.

With all this said, it is still a good kit, and is superior to other companies' kits at this time.

So now let's get into Part 3 of this build and get the exterior of the vehicle started.



AMPS Atlanta 2023 Club Project

On the inside rim of the actual Driver's hatch, there is a cushion that is not provided in the kit.

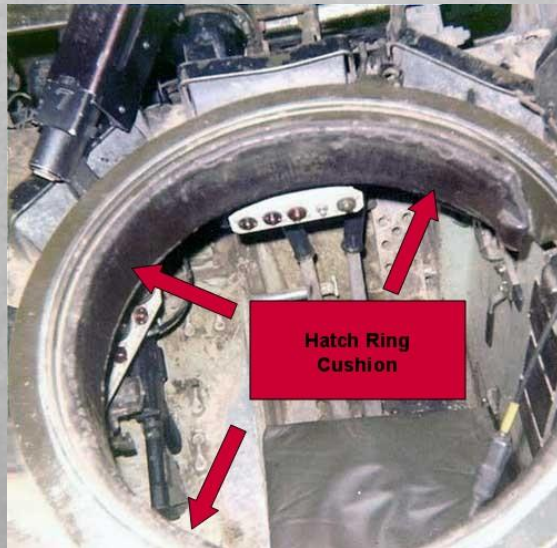

I used a piece of foam plastic from an egg carton, which does a good job of replication the cushion



Here it is mounted in the kit Driver's Hatch



*** Make sure to leave the space for the hatch lock.



AMPS Atlanta 2023 Club Project

Step 13: Cargo Hatch and Bilge Pump Pipe

Make sure you take time to dry fit
Part B6 on the Cargo Hatch

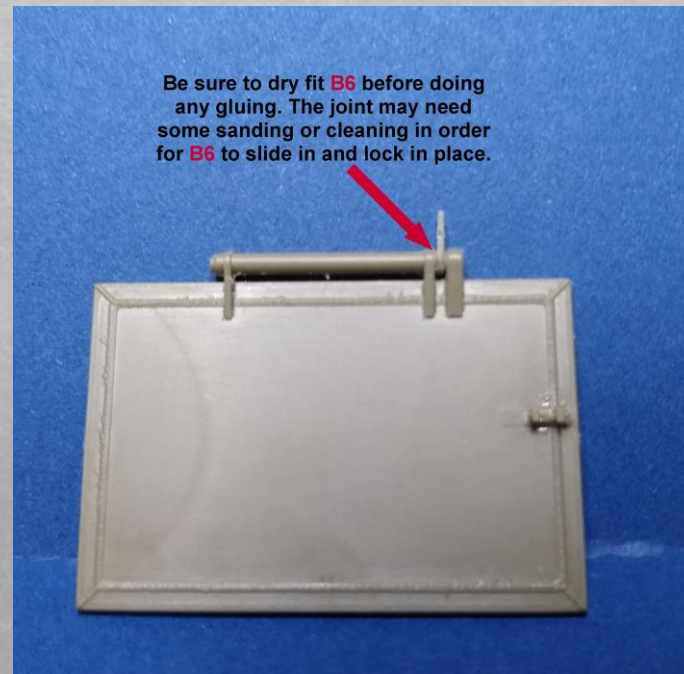

The Bilge Pump Pipe needs to be drilled out.

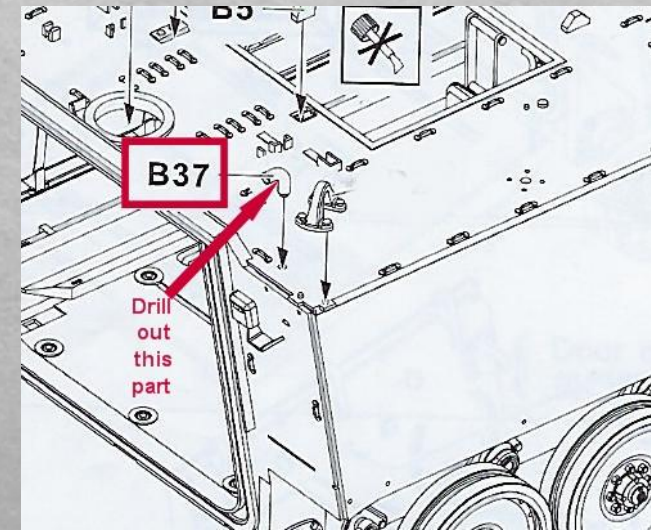

AMPS Atlanta 2023 Club Project

Section 15: Ramp Door

In the event that for some reason you decide to model the vehicle with the rear ramp up and the ramp door open, you will need to rotate parts **C32** & **C35** 180 degrees from what is shown in the instructions

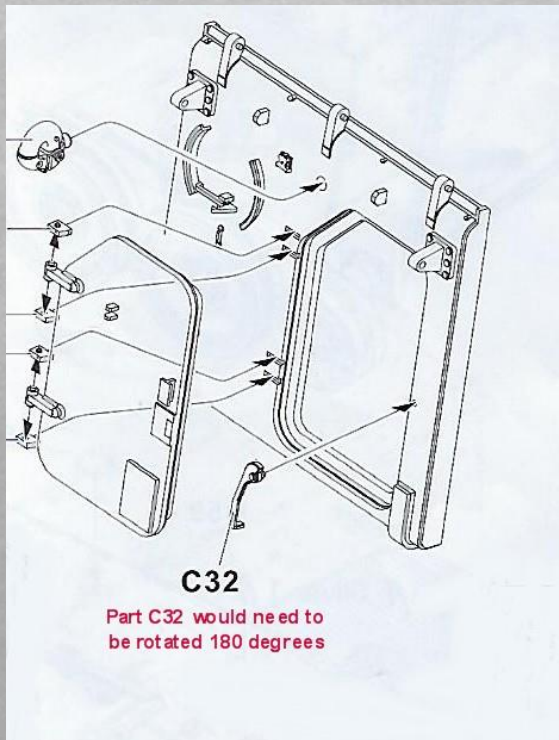

AMPS Atlanta 2023 Club Project

Instead of using the tow cable supplied in the kit (part J), I used Eureka LH-00 brass wire.

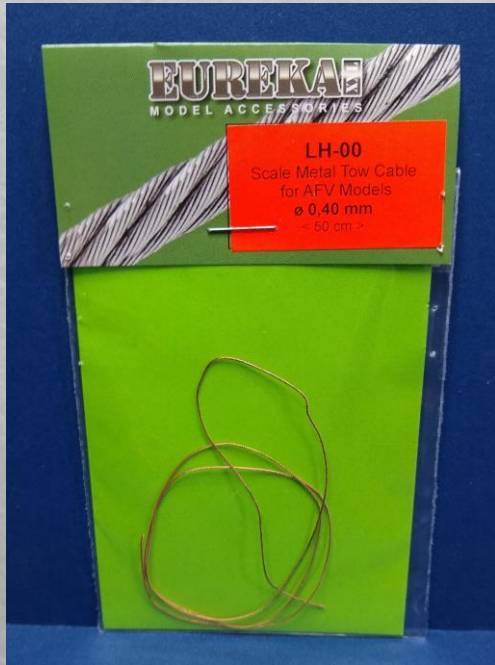

Eureka products are great, and I have used them before on other kits. This allows me to mount it on the rear ramp or elsewhere on the model.

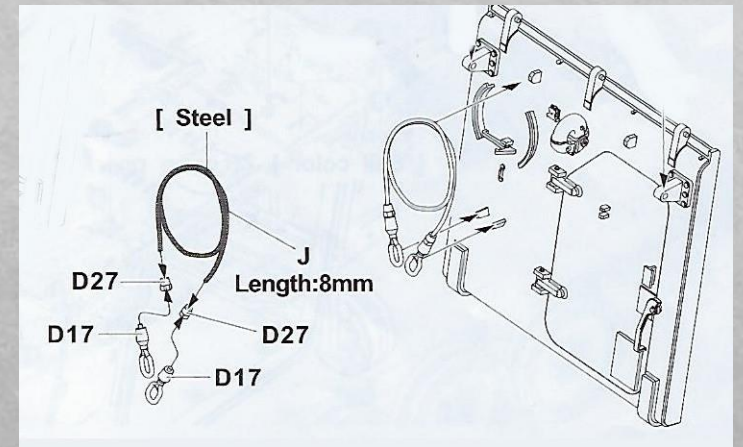

AMPS Atlanta 2023 Club Project

Section 10: Headlights, etc.

Parts E38, B41, H1, B20 are fragile and should be handled with care.

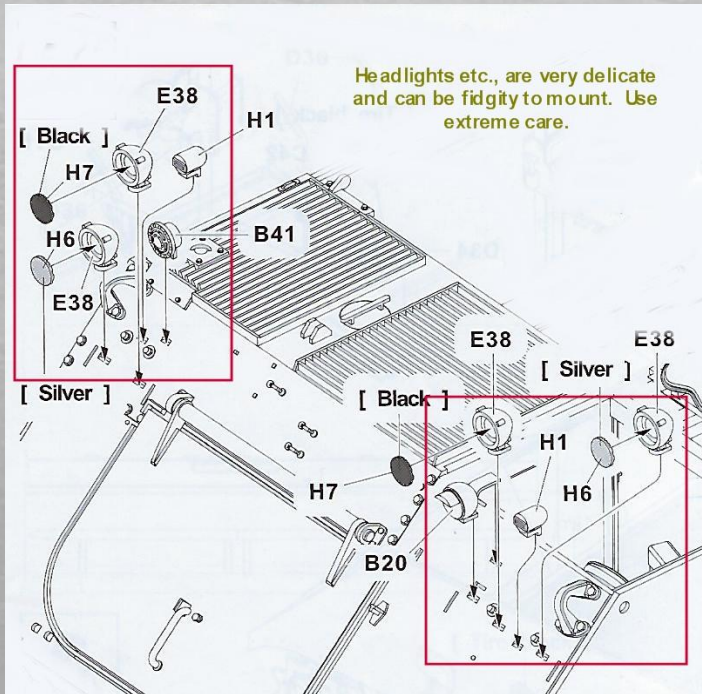

**Part H7 is shown on the instructions to be painted "Black." It should be a "Red Black" as it is the lens on the infrared light



Section 10: Headlight Guards

Parts B52, B53, B54 & B55 are small and delicate. **They can not be interchanged.** Best way to assemble them is to attach B54 & B55 to B62 before mounting to the model. Repeat for B52 & B53 to B61.

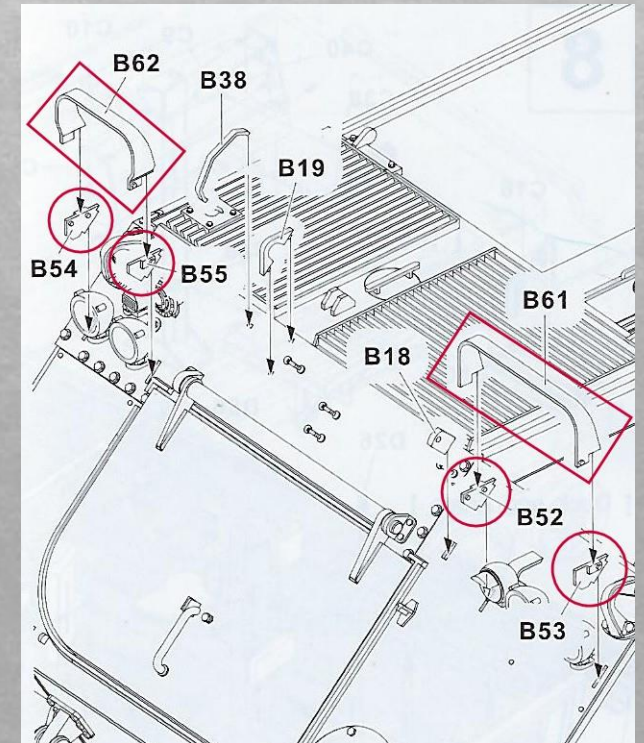

AMPS Atlanta 2023 Club Project

Section 10: Shovel Guard and Mount

Parts **B38** & **B19** are fragile, and care should be taken when working with them.

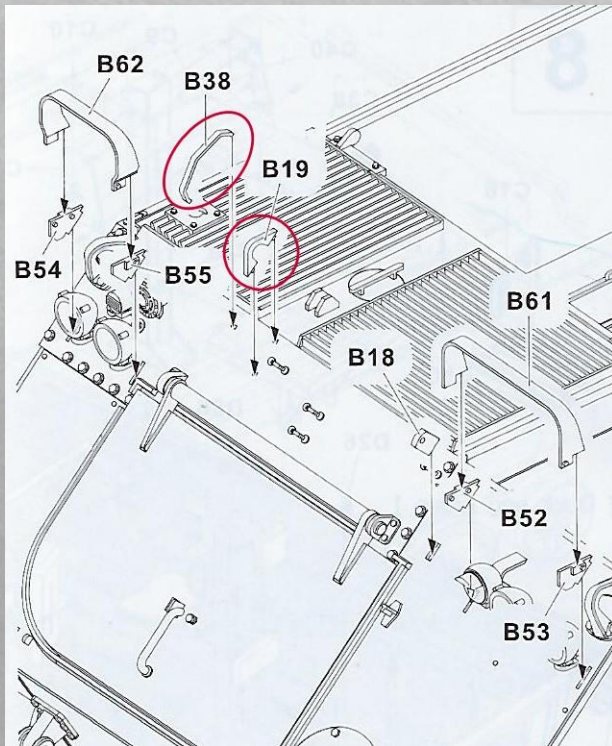

Section 16: Attaching the Ramp

Parts D-1 & D-2 are very small and tricky to work with. Use caution when assembling these hinges to attach the ramp to the hull.

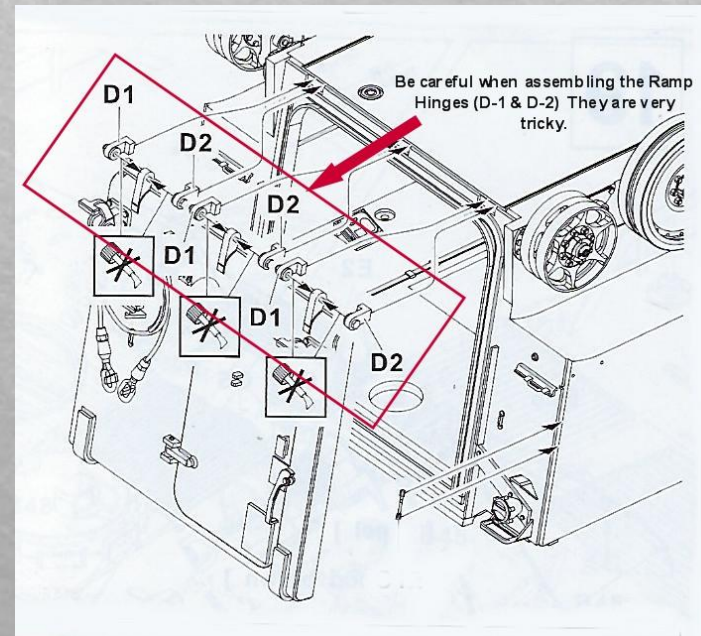

** I found that attaching the hinges to the ramp prior to attaching to the hull worked best.

AMPS Atlanta 2023 Club Project

Intentionally Omitted Kit Parts

Throughout Part 3 of this build you will notice that I have omitted kit parts from my build. I have done this because I know that they will not be seen or from personal experience and research I know they were stowed elsewhere. Here are some examples:

- Parts inside and outside the engine access door. There is no engine, so the door would not need to be opened and therefore no need for the parts.
- The outside handle for the engine door. Unless you plan to model the Trim Vane down, the handle will not be visible.
- All pioneer tools (shovel, ax, etc.) were never stored on the exterior but were usually stacked somewhere inside, usually in the sponsons under personal gear.

AMPS Atlanta 2023 Club Project



In Part 4, I will be finishing some of the exterior and covering the Armament (50 cal and 7.62 mm)
Instruction Sections 20, 21, 22, 23, 24, 27 & 28