

# AMPS Atlanta 2023 Club Project



## M113A1 ACAV (Vietnam)

### PART 4

Sections 20, 21, 22, 23, 24, 27 & 28

# Swim Shrouds

There are numerous examples of the swim shrouds attached or removed as illustrated in these pictures.



Removed



Attached



This is purely a personal preference as how you wish to present your model. They were removed extensively in Vietnam because 1. They did little swimming of the tracks and 2. They tended to collect brush, mud and other debris under them leading to throwing tracks.

I will be modeling my M113 with them removed.

# Trim Vain

The model gives you two choices for version of the M113 Trim Vain. It can be done as the simple plywood version or with the addition of the auxiliary float pod.

If you are doing the plain plywood version and you intend to have the Trim Vain open, you will need to use Decal #23.

If using the Float Pod, (open or closed) the decal is not needed

Part **G4** is only need if not using the Float Pod version.

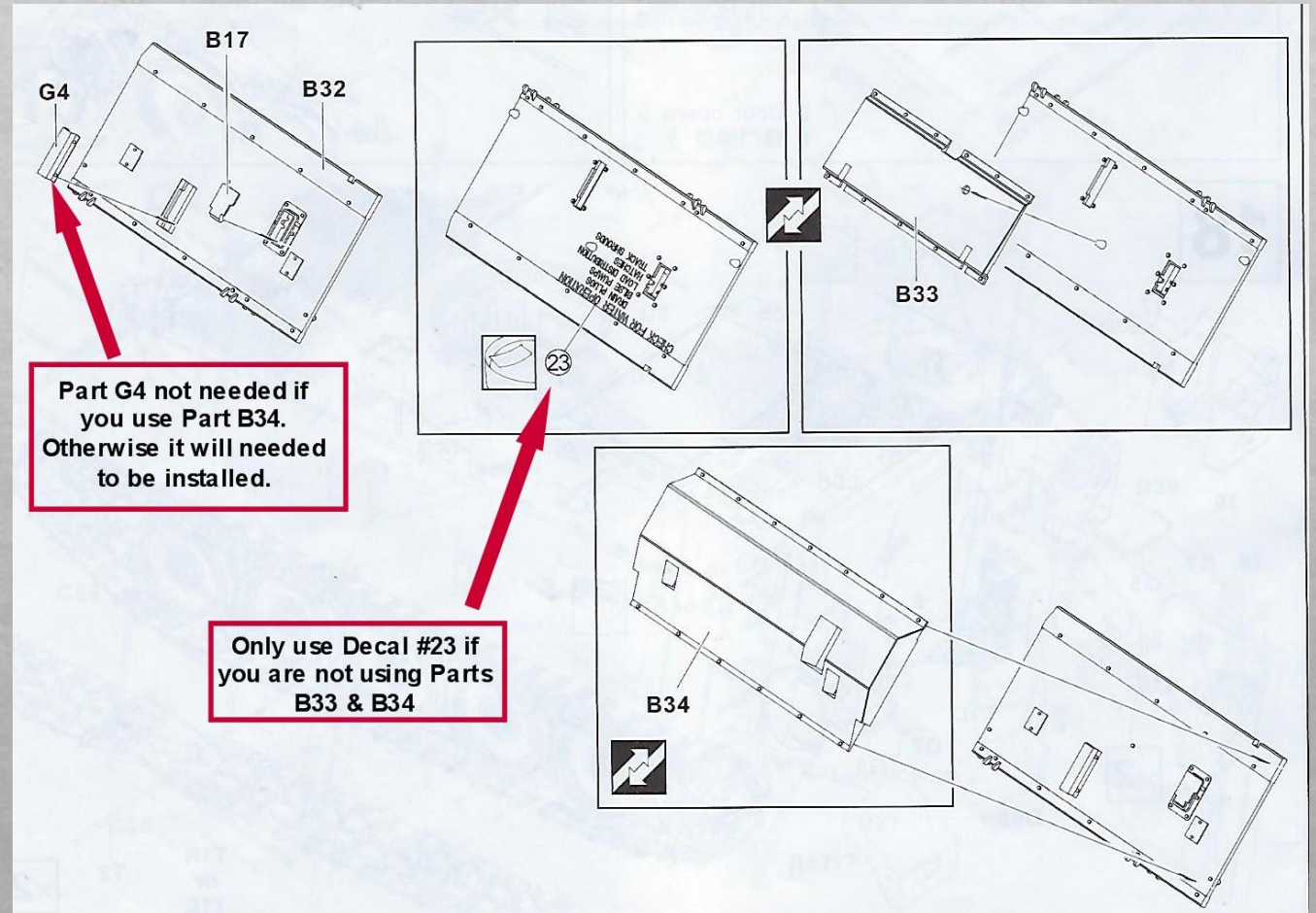

# Commander's Cupola & Added Armor

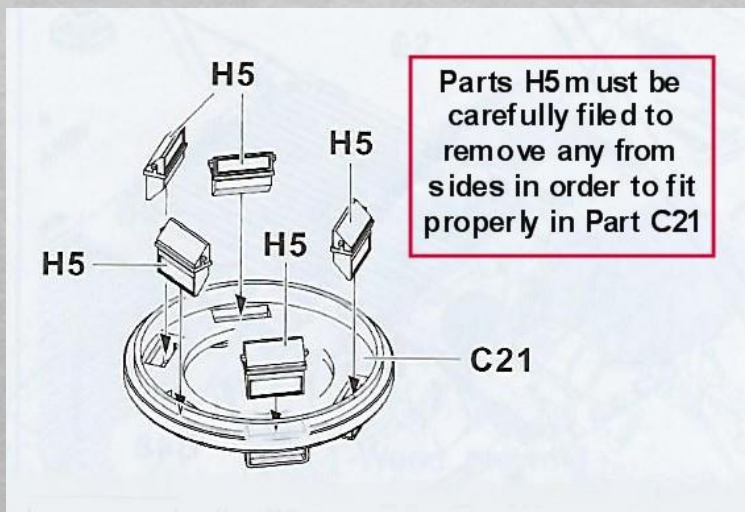

**\*\*** *There was a lot of cleaning of flash on the periscope guards on Part C21. This could just be on my kit, but check before trying to install Parts H5*

Care should be taken on Parts **C19** & **C20** when removing them from the sprue trees to not cutoff the small locating point

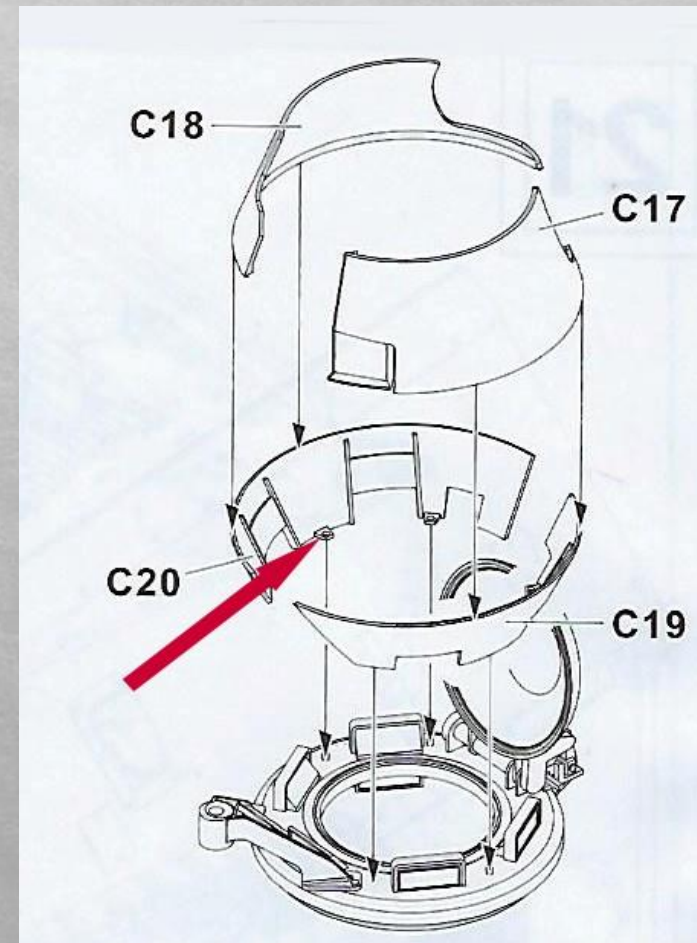

# M2 50 cal Mount and Armor

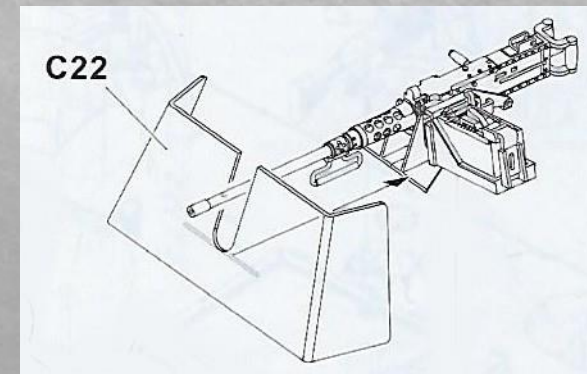
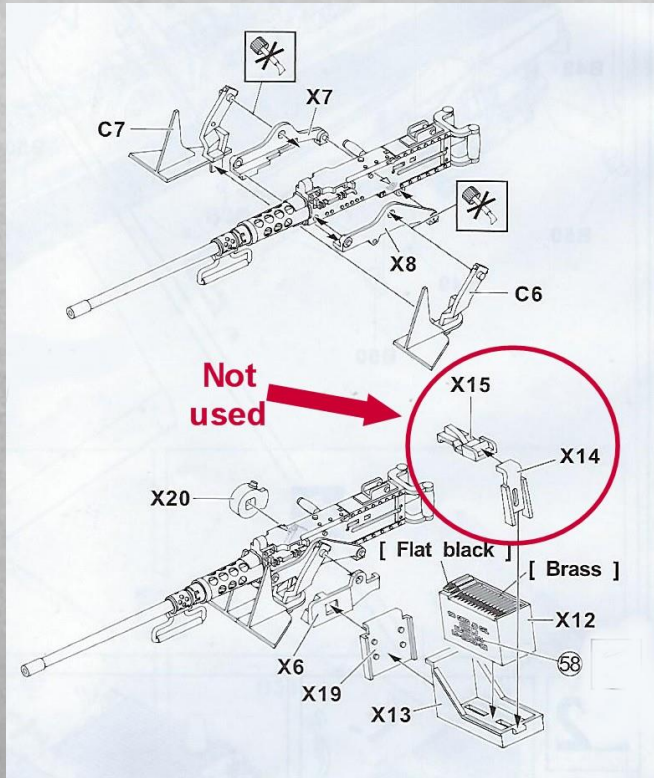

Be careful when assembling these parts. For the mount to function, these parts must fit tight and perfect.

I did not use **Parts X14 & X15**. In the real world, this apparatus got in the way of changing ammo cans quickly. I was glad I did not use them, because the gun shield is a little undersized and it would not go on the mount if they were used.

# M-60 Mounts and Armor



There are a lot of small and fragile parts in these assemblies. Also ammunition belts are missing so you may want to add those.

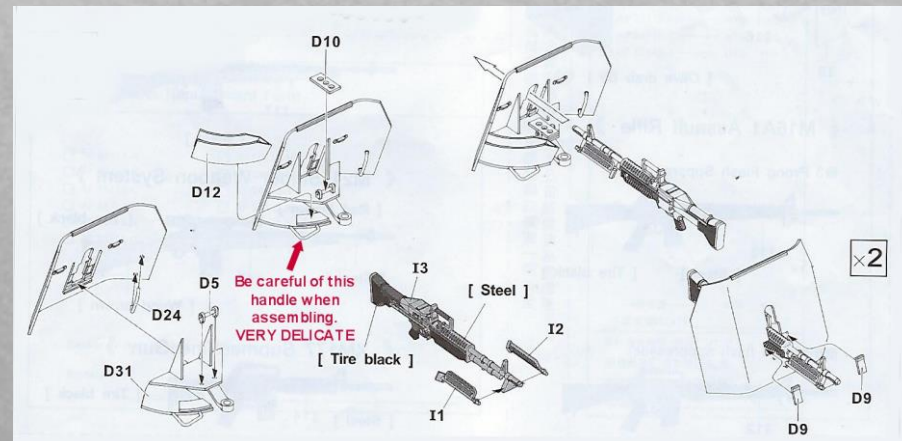

Be careful when assembling these parts. The handle on the gun mount is VERY delicate and can be broken off.

# Mounting Road Wheels, Drive Sprocket and Idler

I have waited until the end to mount the wheels etc. I did this because I was worried, I would damage them during the rest of the construction and assembly of the model. I am now ready to mount these parts.

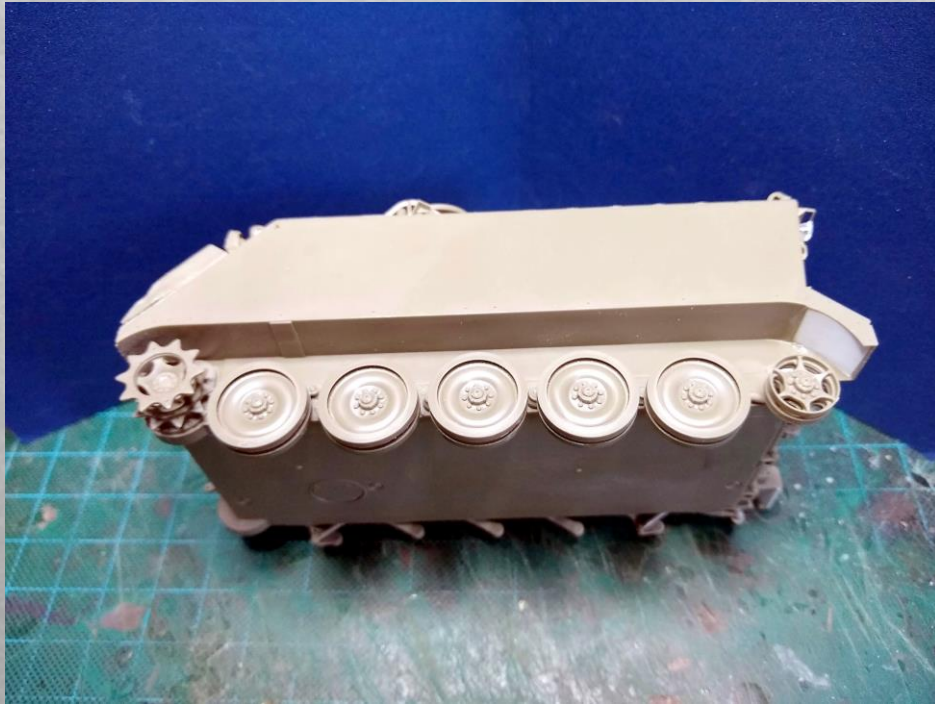

Double check alignment of the road wheels, drive sprocket and idler. I used a slow working glue which allowed me to make small corrections.

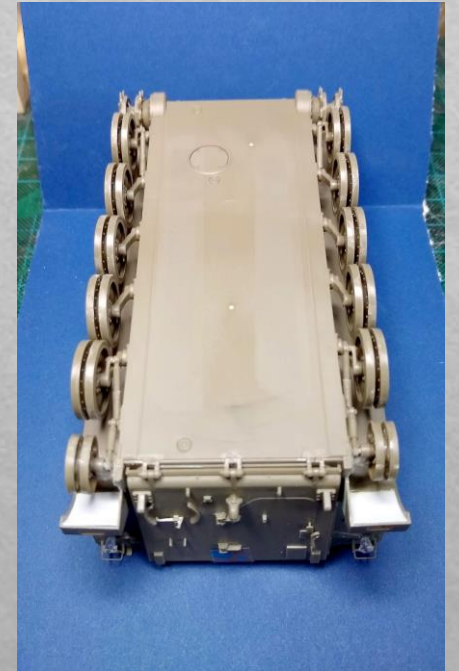

\*\* You can use the kit track or any number of aftermarket track kits. I will be using the AFV Club M113 track

