



# SONOMA CAST STONE

## CONCRETE INNOVATIONS

### Tank Options



Segment System

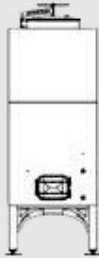

Tower  
1440



Square  
800

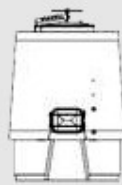

Conical  
830, 950, 1070, Elliptical



Square  
580



Egg



Amphora



NuBarrel



Tea Cup



Cast Concrete Top with Stainless 36"  
Pivotal Manway Door and 2" Tri-clover  
Fitting

Tower | Square | Conical



16" Top Manway  
with 2" Tri-clover Port

Egg | Amphora



Concrete Permanent Top with 18"  
Stainless Manway and 2" Tri-Clover  
Fitting

Option: NuBarrel



Concrete Permanent Top  
with 2" or 6" Tri-clover Fitting

Option: NuBarrel



Concrete Permanent Top  
with no Top Fittings or Ports  
(angled fill port only)

Option: NuBarrel



Pomace Door - Stainless Steel  
Rectangular

Tower | Square | Conical



**Pomace Door – Stainless Steel Oval**

Standard: Amphora  
Option: NuBarrel

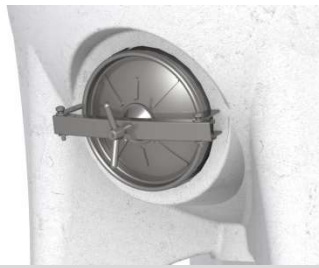

**Pomace Door – Stainless Steel Round**

Egg

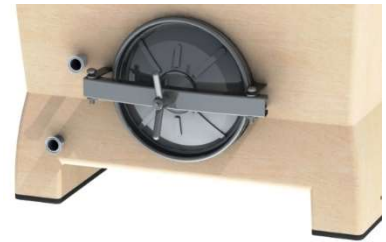

**Pomace Door – Stainless Steel**

NuBarrel



**Pomace Chute**

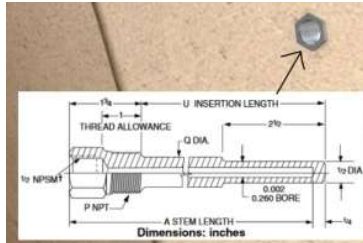

**Thermowell**

Tower | Square | Conical | Egg  
Amphora | NuBarrel | Tea Cup



**Sample Port – 1/2" FPT**  
(specify if special adaptor size is needed)

Tower | Square | Conical  
Egg | Amphora | NuBarrel

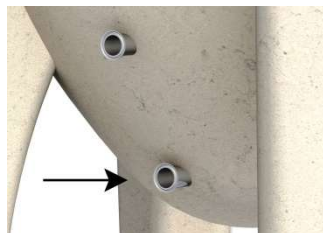

**Drain Port – 1-1/2" Tri-clover**  
(specify if special adaptor size is needed)

Standard: Amphora, NuBarrel, Tea Cup  
Option: Tower, Square, Conical, Egg

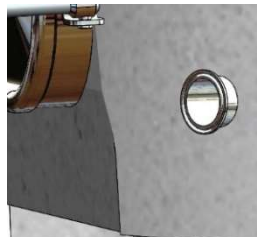

**Drain Port – 2" Tri-clover**  
(specify if special adaptor size is needed)

Standard: Tower, Square, Conical  
Option: Amphora, NuBarrel, Tea Cup



**Drain Port – 2" Tri-clover**  
(specify if special adaptor size is needed)

Egg



**Racking Port – 2" Tri-clover**  
(specify if special adaptor size is needed)

Standard: Tower, Square, Conical, Egg  
Option: Amphora, NuBarrel

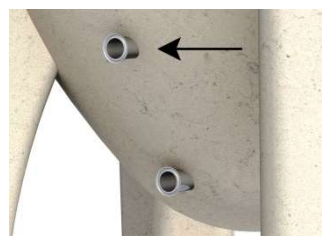

**Racking Port – 1-1/2" Tri-clover**  
(specify if special adaptor size is needed)

Standard: Amphora, NuBarrel  
Option: Tower, Square, Conical, Egg



**Racking Arm through Pomace door**  
(specify if special adaptor size is needed)

Egg



**Racking Arm in tank**

Egg



**Racking Arm in Tank**

Amphora

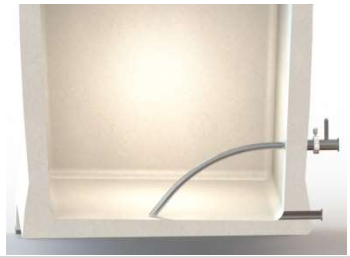

**Racking Arm**

NuBarrel



**Concrete Base – Legs**

Conical



**Stainless Steel or  
Powder Coated Base – Legs**

Conical



**Concrete Base – Legs**

Square



**Seismic Hold Down Plates, Stainless  
Not adjustable**

Egg | Amphora

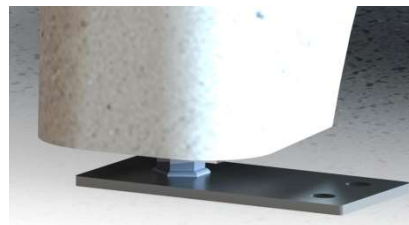

**Seismic Hold Down Legs, Stainless  
Adjustable (4)**

Egg | Amphora



**Seismic Hold Down Brackets**

NuBarrel



**Tank to Tank Hold Down Plates –  
Stainless (4)**

NuBarrel



**Glycol Heating/Cooling  
Embedded Coils**

Tower | Square | Conical  
Egg | Amphora



**Seed Screen  
with Mounting Tabs**

Tower | Square | Conical



**Pump-over Tube  
Through Manway Neck**

Tower | Square | Conical



**Pump-over Tube  
Embedded**

Tower | Square  
Conical (Only 830, 950 & 1070)

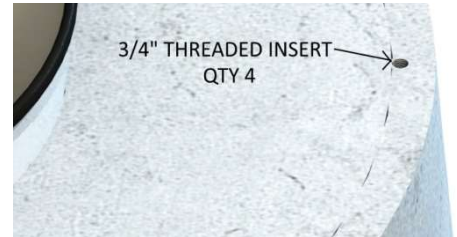

**Embedded Lifting Inserts (4)**

Tower | Square | Conical



**Lifting Inserts**

Tea Cup



**Turning Insert**

Tea Cup



**Sensor System**

NuBarrel



**Fill Port – 2" Tri-clover**  
(specify if special adaptor size is needed)

NuBarrel

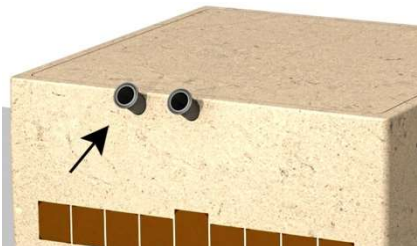

**Flavor and/or Sensor Port – 2" Tri-clover**  
(specify if special adaptor size is needed)

NuBarrel

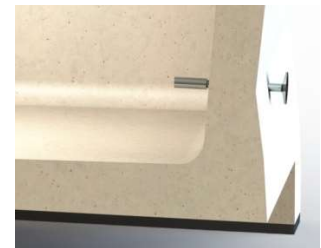

**Oxygen Emitter Insert**

NuBarrel



**Additive Sleeve for Oak Alternatives**  
(Chips, Rice, Beans)

NuBarrel



**Oak Stave Holder – Stainless**  
(wood not included)

NuBarrel



**Concrete Oak Anchor**

NuBarrel





**Tank Net Glycol Control System**  
(24 or 120 Volt-Tank Mount Included)

Tower | Square | Conical  
Egg | Amphora

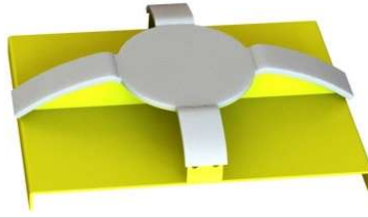

**Metal Transfer Pallet**  
(for Placing Tank)

Egg



**Metal Transfer Pallet**  
(for Placing Tank)

Amphora

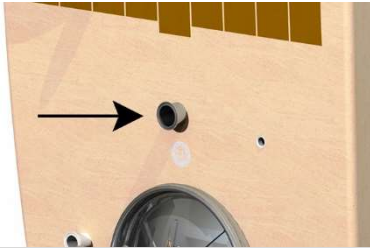

**Combination Cleaning and Sample Port - 2" Tri-clover**

NuBarrel

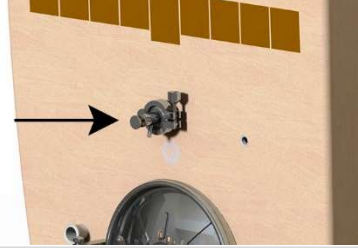

**Tri-clover Sample Valve – 2"**

NuBarrel