

## *Latitude 55*

### **Features/Advantages**

5 year hull and deck warranty  
Payments are held in trust and released when work is approved by an independent surveyor  
Equipped from standard to coastal to offshore ready  
Good visibility from both the Pilothouse and the flybridge  
Good deck and dock access Port & Starboard from the Pilothouse or the Cockpit  
Excellent dinghy access at water level  
Excellent access to the swim platform  
Superior dampened sea motion both pitching and rolling  
Model tested super fuel-efficient hull form  
Stability to 160 degrees, self-righting at all angles of heel  
No major down flooding points  
Watertight collision bulkhead forward with 2 additional watertight bulkheads  
Structure designed to the ABS Rules for Unrestricted Offshore Vessels  
Day tanks separate from fuel storage tanks  
Grey water and waste holding tanks  
Spacious interior larger than most 60 foot vessels  
Full standing, walk around engine room  
Fully protected prop  
Bi-foil skeg for greater efficiency  
Full length keel shoe  
Large, spacious galley with lots of storage and full size fridge/freezer  
Plenty of on deck storage  
High bulwarks and handrails for protection on deck  
Excellent access to the flybridge and boat deck  
Very good maneuverability  
Large freeing ports to clear water off decks  
Spacious main salon  
Three full size staterooms  
Two large w.c.s with showers plus dayhead  
Large pilothouse with settee/watch berth  
Engine room and aft deck surveillance cameras  
Bulbous bow for fuel efficiency and superior seakeeping  
Wide spray knockers to keep water off the decks  
Keel cooling  
Fixed stabilizer fins dampen roll even at anchor  
Ocean tested from Sitka, AK to San Francisco, CA  
Beautiful cherry interior, granite counters, and upholstered ceiling  
6'-6" headroom through the boat  
Super quiet - 59 decibels at idle, 68 db in Pilothouse at cruise

***Bray Yacht Design And Research Ltd.***

# ALTERNATE PROFILES

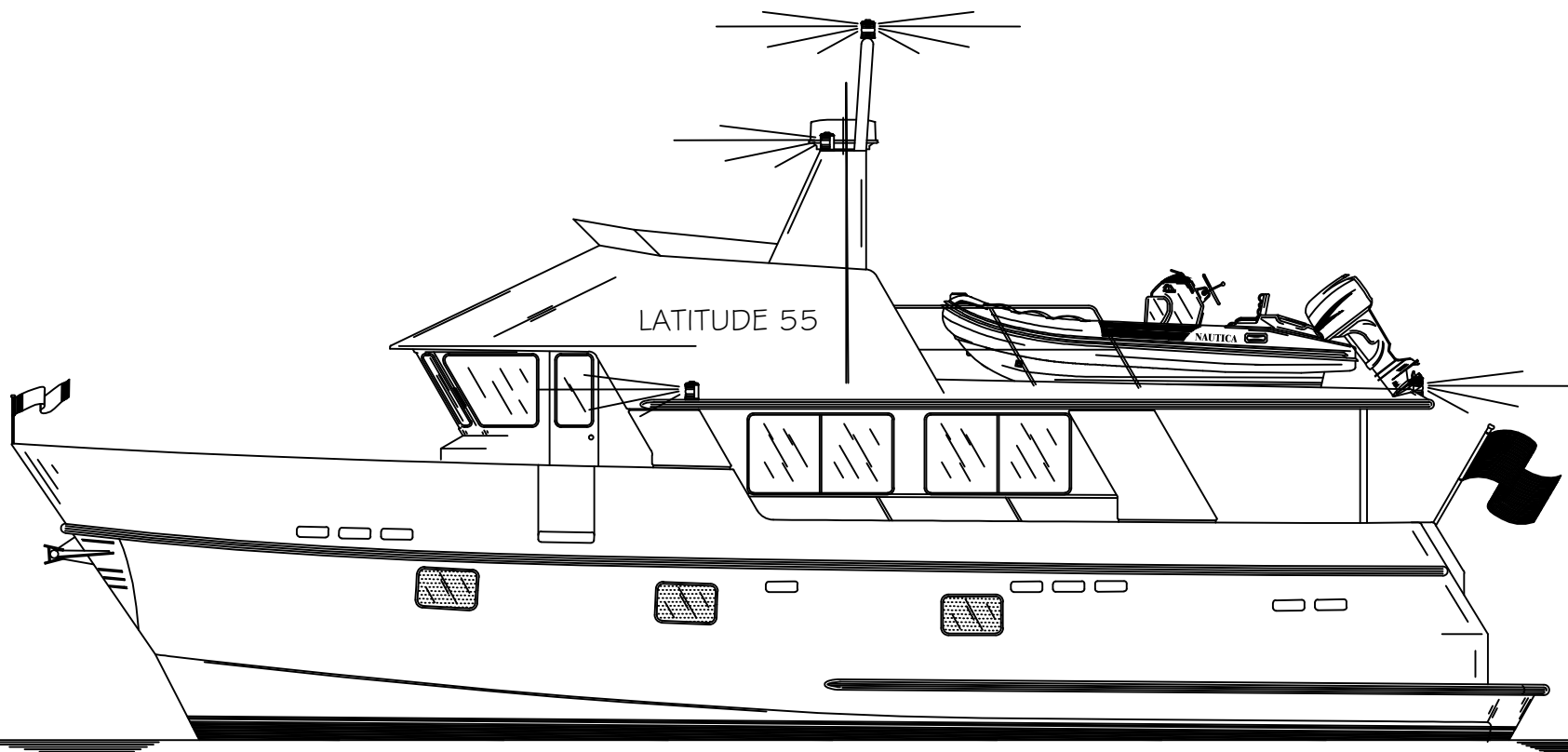
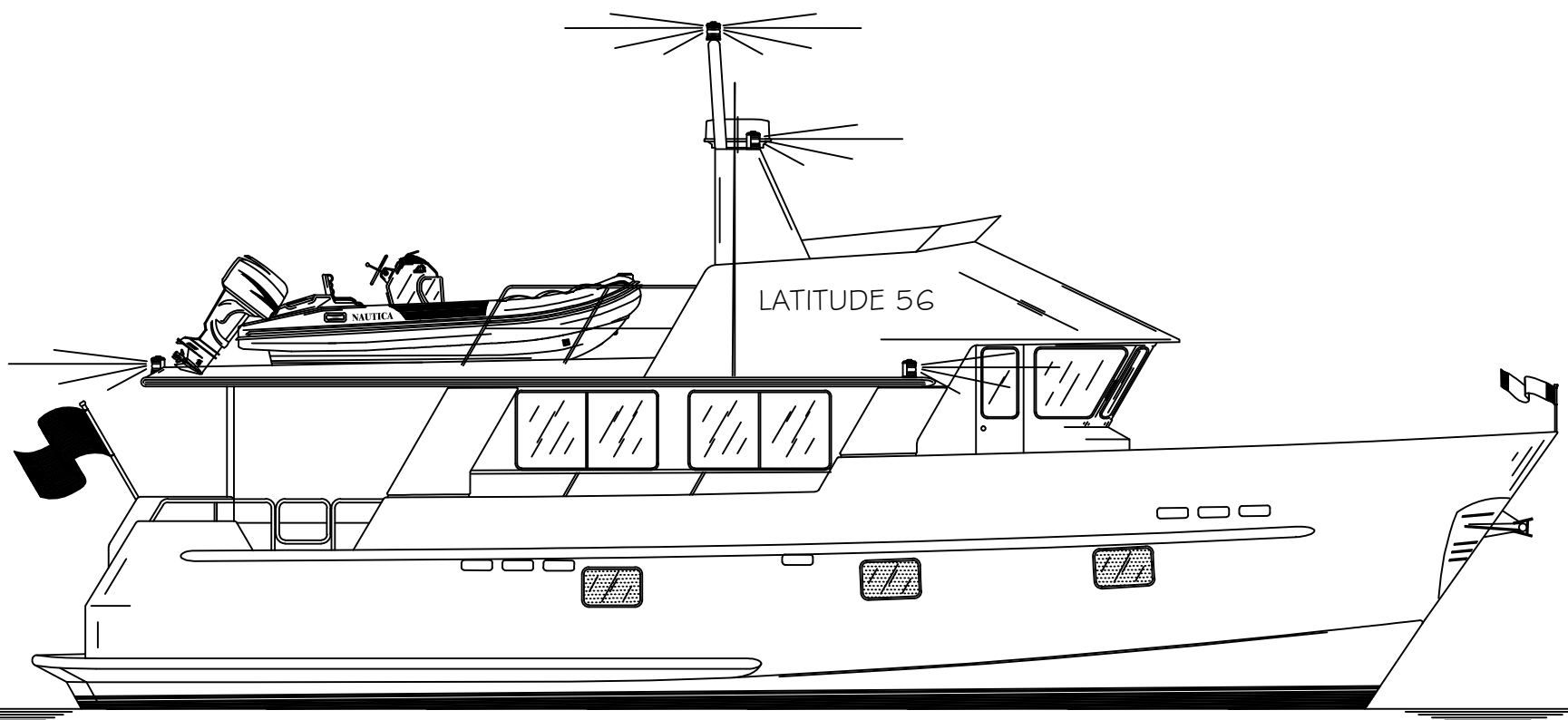

OUTBOARD PROFILES

LATITUDE 55  
"YACHT NAME"

LOA 55' - 0" BEAM 17' - 6"  
LWL 47' - 0" DRAFT 6' - 0"

SCALE: 1/2" = 1' - 0"

BRAY  
YACHT DESIGN  
AND RESEARCH

WORLD COPYRIGHT  
THIS DRAWING AND ALL ITS CONTENTS REMAIN  
THE PHYSICAL AND INTELLECTUAL PROPERTY  
OF BRAY YACHT DESIGN AND RESEARCH LTD.,  
AND SHALL NOT BE COPIED, DUPLICATED,  
GIVEN OUT, OR USED, WITHOUT THEIR PRIOR  
WRITTEN CONSENT.

REV. DATE: July / 09

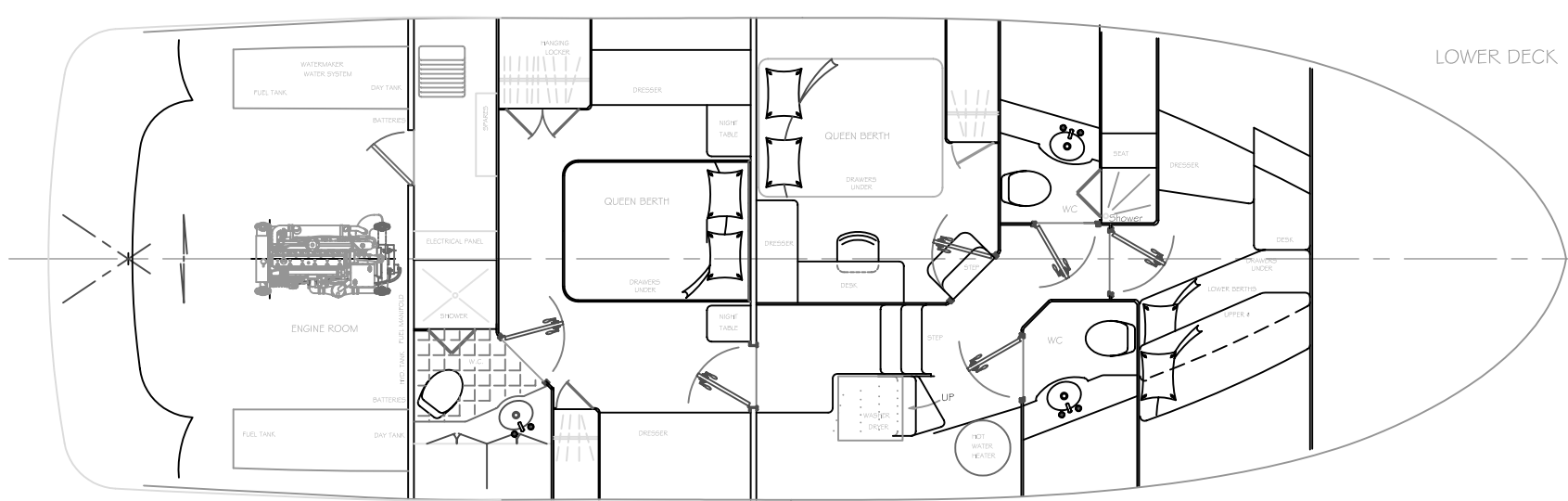
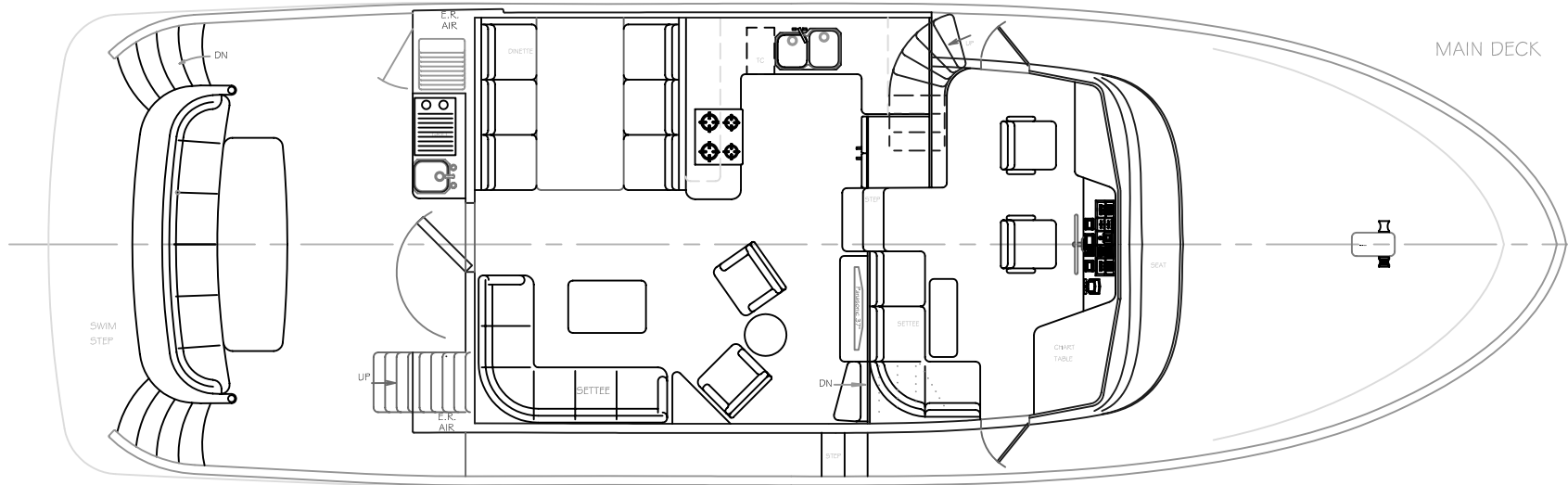
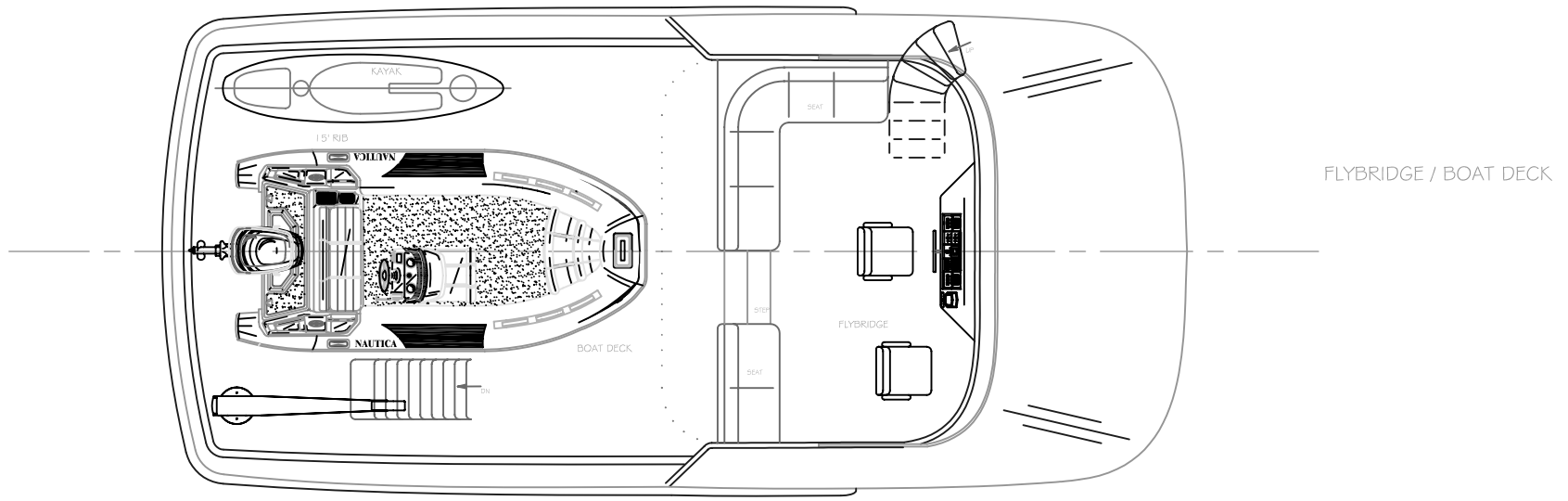

ACCOMMODATION

LATITUDE 55  
"YACHT NAME"

LOA 55' - 0"    BEAM 17' - 6"  
LWL 47' - 0"    DRAFT 5' - 0"  
SCALE: 1/2" = 1' - 0"

**BRAY  
YACHT DESIGN  
AND RESEARCH**

WORLD COPYRIGHT  
THIS DRAWING AND ALL ITS CONTENTS REMAIN  
THE PHYSICAL AND INTELLECTUAL PROPERTY  
OF BRAY YACHT DESIGN AND RESEARCH LTD.,  
AND SHALL NOT BE COPIED, DUPLICATED,  
GIVEN OUT, OR USED, WITHOUT THEIR PRIOR  
WRITTEN CONSENT.

REV. DATE: June / 09



## Latitude 55 Performance Prediction

Fuel Capacity = 1500 US Gal.  
 Engine = 330 HP @ 2500 rpm

| Speed       | EHP | SHP        | GPH   | Range | % HP | RPM |
|-------------|-----|------------|-------|-------|------|-----|
| <b>8</b>    | 24  | <b>40</b>  | 1.92  | 6250  | 12   |     |
| <b>9</b>    | 47  | <b>78</b>  | 3.76  | 3590  | 24   |     |
| <b>10</b>   | 90  | <b>150</b> | 7.2   | 2083  | 45   |     |
| <b>11</b>   | 167 | <b>278</b> | 13.36 | 1235  | 84   |     |
| <b>11.5</b> | 217 | <b>362</b> | 17.36 | 994   | 110  |     |
| <b>12</b>   | 258 | <b>430</b> | 20.64 | 872   | 130  |     |
| <b>13</b>   | 300 | <b>500</b> | 24    | 813   | 152  |     |

Range is based on 100% usable fuel with no generator run time  
 Weight is based on 75,000 lbs. (3/4 loaded) with no adjustment for fuel burn/weight reduction  
 No calculation for thruster tunnel drag  
 Based on BC Research Tank test predictions  
 Fuel consumption based on typical fuel curves  
 Speed and range are in nautical miles  
 These calculations are based upon the best information available. Actual sea trials will be required to confirm these predictions.

EHP = effective horse power  
 SHP - shaft horse power

GPH = US gallons per hour

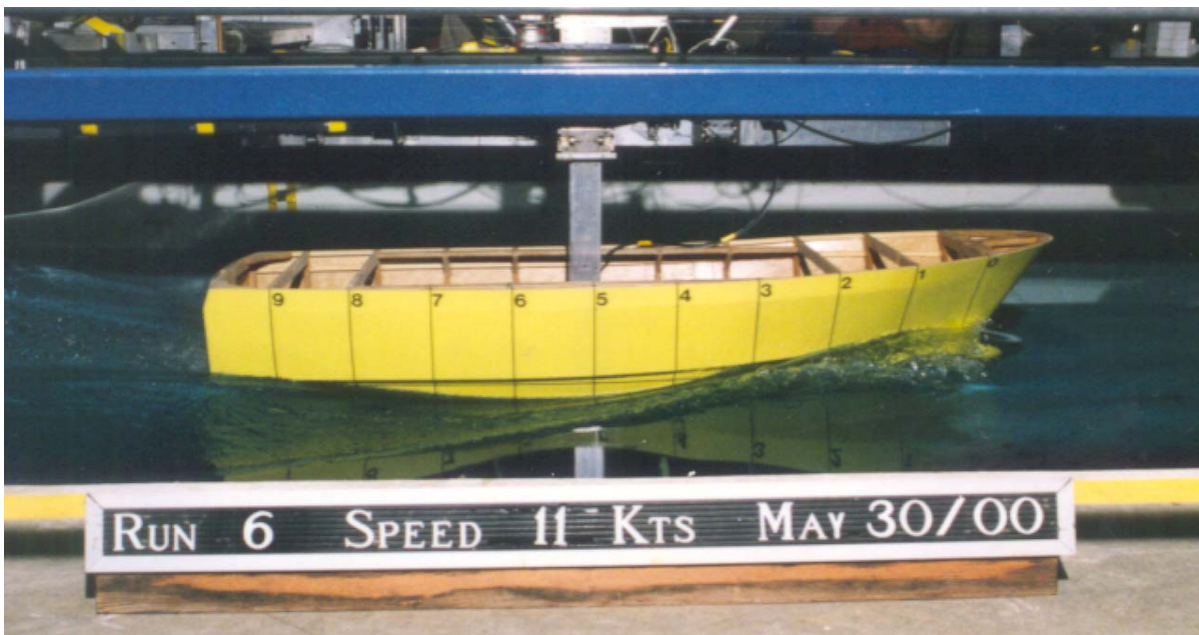

**Bray Yacht Design And Research Ltd.**