

Soil Map

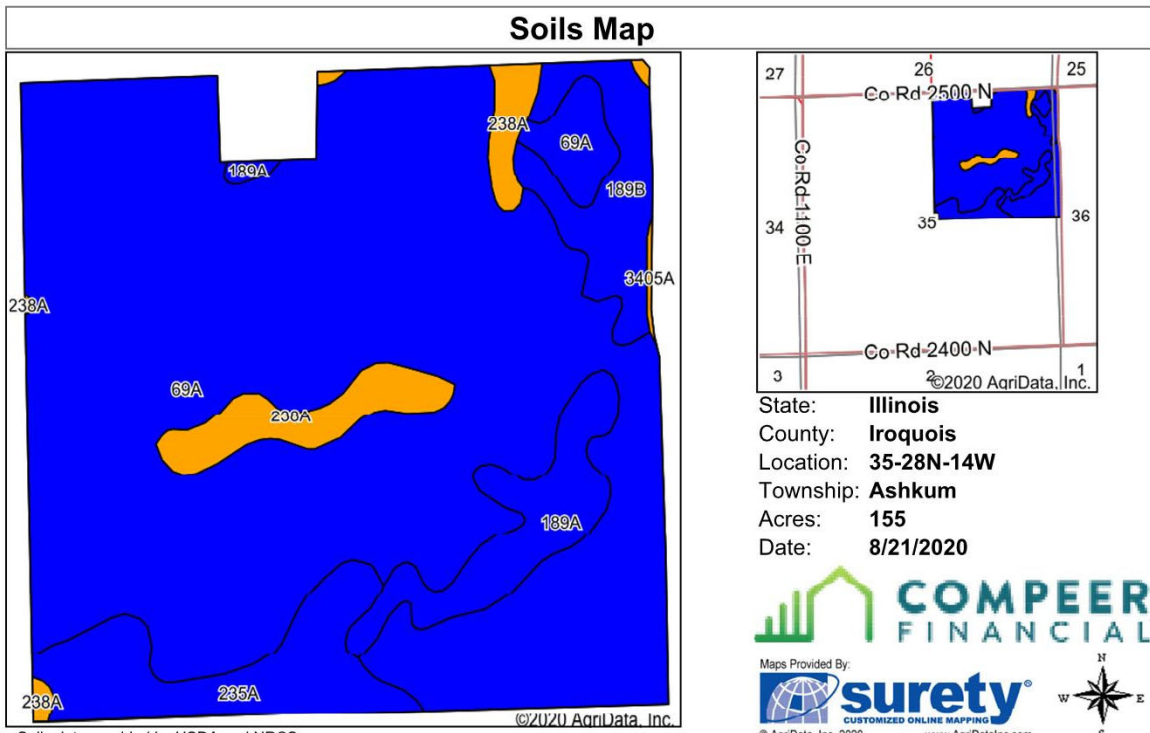

State: **Illinois**
 County: **Iroquois**
 Location: **35-28N-14W**
 Township: **Ashkum**
 Acres: **155**
 Date: **8/21/2020**



Area Symbol: IL075, Soil Area Version: 14

Code	Soil Description	Acres	Percent of field	Il. State Productivity Index Legend	Corn Bu/A	Soybeans Bu/A	Wheat Bu/A	Crop productivity index for optimum management
69A	Milford silty clay loam, 0 to 2 percent slopes	121.06	78.1%	■	171	57	68	128
235A	Bryce silty clay, 0 to 2 percent slopes	10.78	7.0%	■	162	54	64	121
189A	Martinton silt loam, 0 to 2 percent slopes	8.41	5.4%	■	173	57	70	130
**189B	Martinton silt loam, 2 to 4 percent slopes	7.33	4.7%	■	**171	**56	**69	**129
238A	Rantoul silty clay, 0 to 2 percent slopes	7.11	4.6%	■	144	49	56	109
3405A	Zook silty clay, 0 to 2 percent slopes, frequently flooded	0.31	0.2%	■	153	53	60	116
Weighted Average					169.2	56.4	67.3	126.8

Table: Optimum Crop Productivity Ratings for Illinois Soil by K.R. Olson and J.M. Lang, Office of Research, ACES, University of Illinois at Champaign-Urbana. Version: 1/2/2012 Amended Table S2 B811
 Crop yields and productivity indices for optimum management (B811) are maintained at the following NRES web site:
<http://soilproductivity.nres.illinois.edu/>
 ** Indexes adjusted for slope and erosion according to Bulletin 811 Table S3
 *c: Using Capabilities Class Dominant Condition Aggregation Method

Soils data provided by USDA and NRCS. Soils data provided by University of Illinois at Champaign-Urbana.