



# SmartH



# Hello, Smart Home



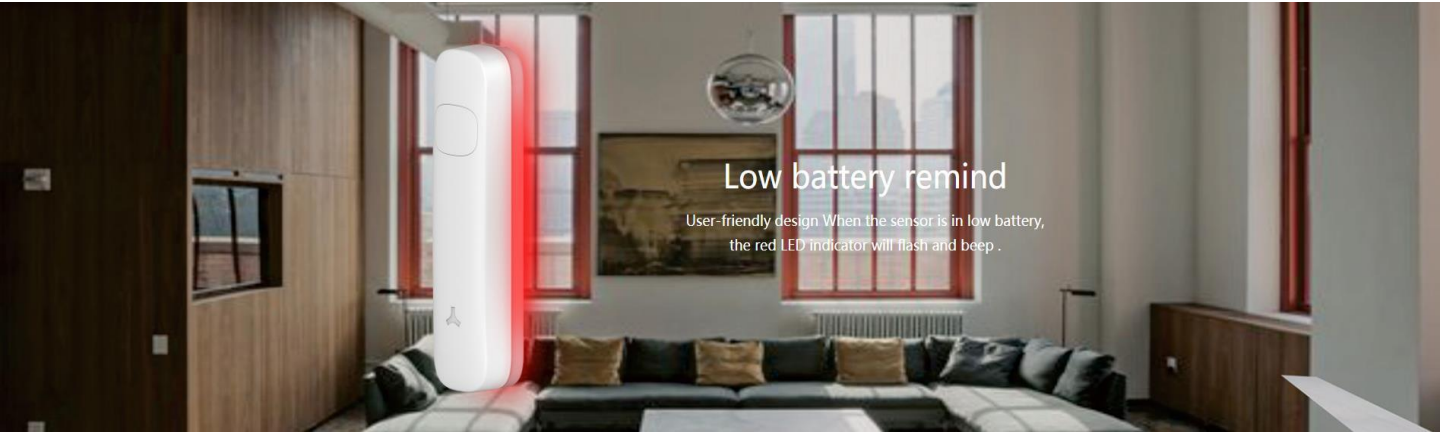

## Low battery remind

User-friendly design When the sensor is in low battery, the red LED indicator will flash and beep .

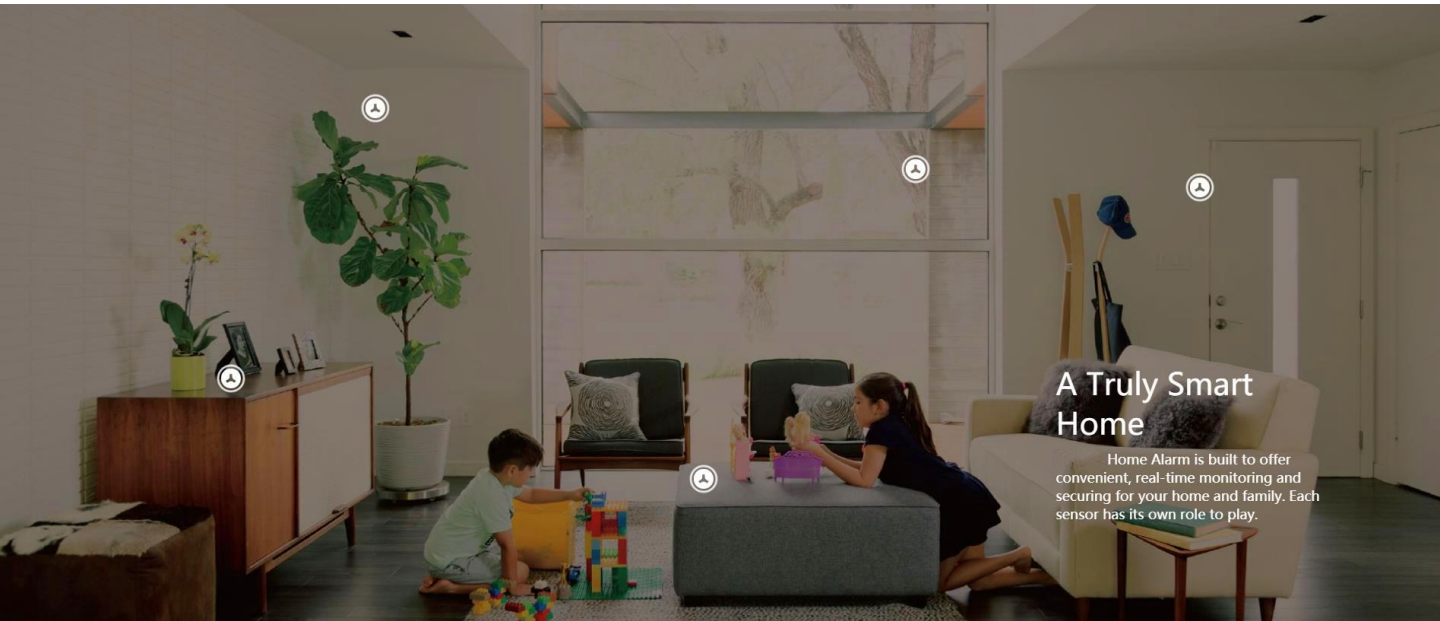

## A Truly Smart Home

Home Alarm is built to offer convenient, real-time monitoring and securing for your home and family. Each sensor has its own role to play.

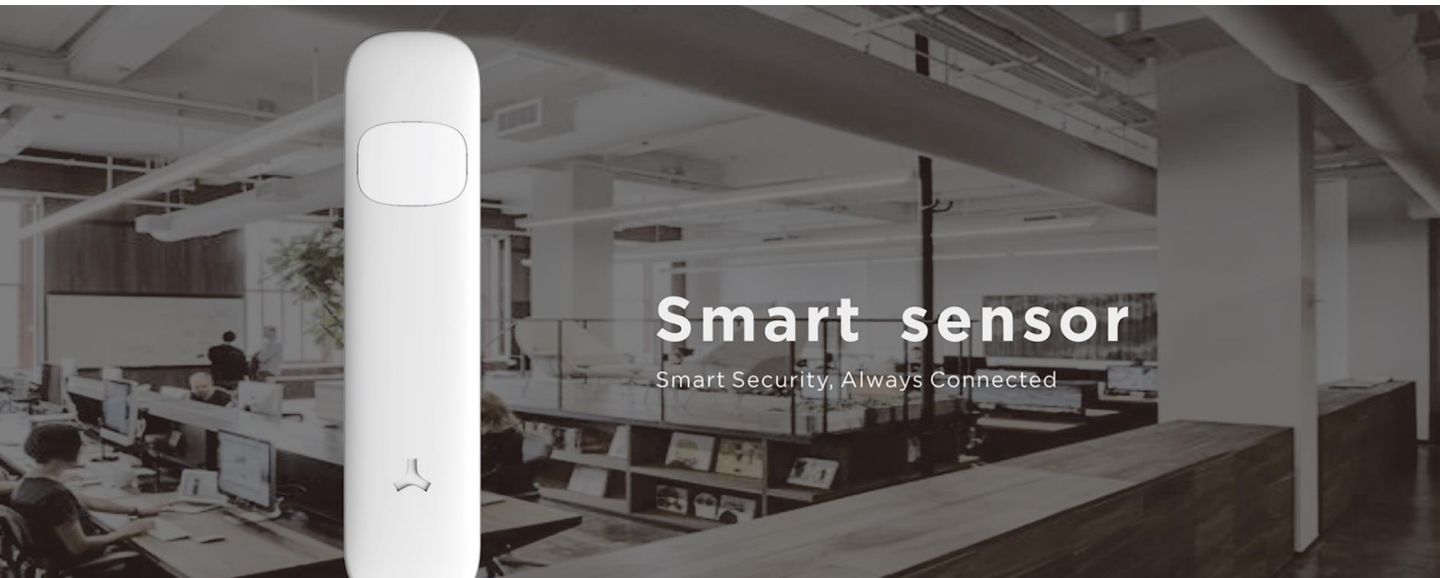

## Smart sensor

Smart Security, Always Connected

# Smart Alarm System

## User Manual



# Content

- 01 Product list
- 02 Features/Control Panel Appearance
- 03 Status LED Indication

## Quick Start Guide

- 05 Installation of The Control Panel
- 06 Using and Testing the Door Sensor
- 07 Using and Testing the Motion Detector

## Included Accessories

- 08 PIR Motion Detector
- 11 Door/Window Sensor

## Setup

- 13 Mobile App Setup
- 14 Add Device
- 16 Control the Alarm System
- 17 Alarm Notification
- 18 Accessories Enrollment/Delete
- 20 Zone Setup via App
- 21 Device Setup

## Mobile App

- 23 Other APP Settings
- 26 Alexa & Google Setting

## 30 Specification

## 33 Q & A

The Wi-Fi network security system is built to offer convenient, real-time monitoring and flawless home security. It protects your home 7/24. The control panel is the brain of security alarm system, which is able to communicate with all wireless sensors. If an intrusion is detected or if an abnormal amount of smoke is detected, it triggers an immediate alarm and send you notification by SMS, push notification and calls.

## Product List

Please remove all supplied contents from packaging as below. If there' re anything missing, please return to your place of purchase.



Control Panel



Door/Window Sensor

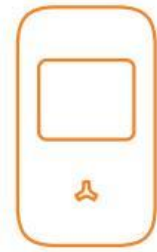

P.I.R. Motion Detector



Remote Control



Wall-mounted Bracket



Bracket for Motion Detector



Power Adapter



3M Double-sided Tape

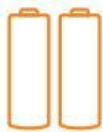

Batteries



Plastic Plugs & Screws



User Manual



## Features

---



Totally Wireless,  
DIY Installation



105dB Siren



24 Hours Protection



Entry/Exit Delay



Wi-Fi  
Support



FHSS Frequency-Hopping  
Spread Spectrum



Immediate  
Alerts



50 Zone Names



6 Hours  
Battery Back-up



10 Customizable  
Keyfob Name



Added on up to  
50pcs Sensors





iOS & Android App,  
Easy to Setup

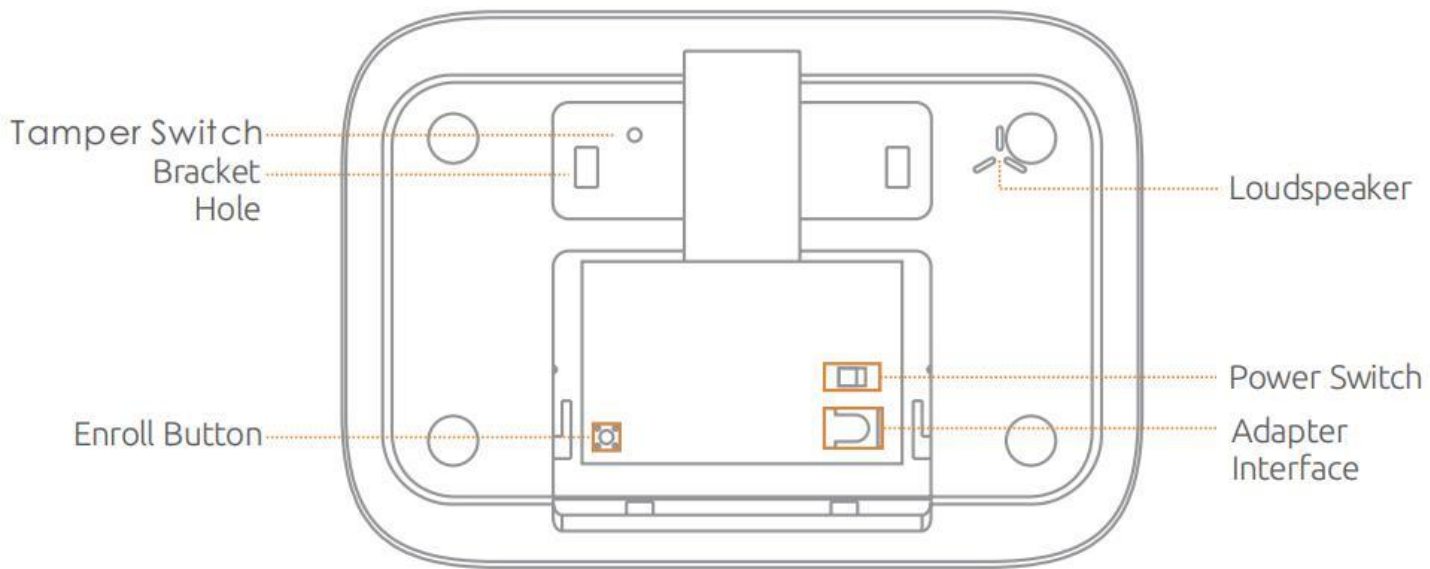
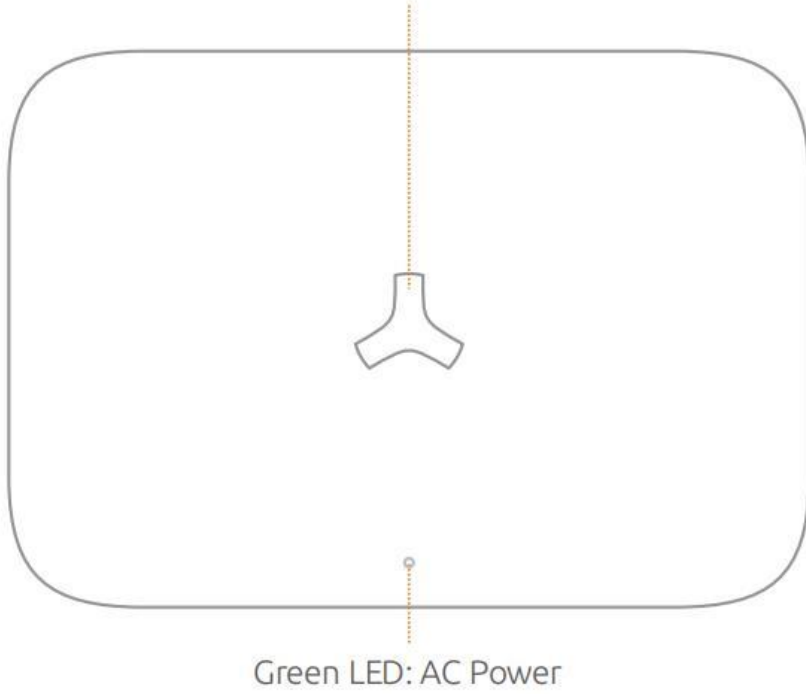

# Working Status of Control Panel Appearance

White LED: Arming / Disarming  
Red LED: Control Panel Status

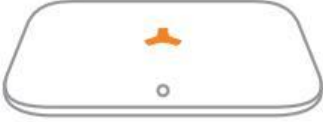

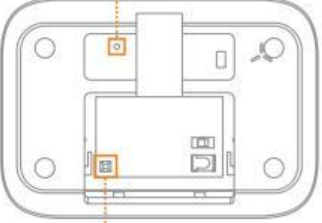
No	Name	Function
1	<p data-bbox="194 677 554 715">Status LED Indication</p> 	<p data-bbox="679 542 805 580"><b>Red LED</b></p> <p data-bbox="679 588 1129 626"><b>Normally on:</b> In enrolling status</p> <p data-bbox="679 634 1279 715"><b>Flashes quickly:</b> Connecting WiFi network in smart mode</p> <p data-bbox="679 723 1150 761"><b>Flashes once a second:</b> Alarming</p> <p data-bbox="679 769 1308 851"><b>Flashes once in 2 seconds:</b> Connecting WiFi network in AP mode.</p> <p data-bbox="679 901 833 940"><b>White LED</b></p> <p data-bbox="679 947 1158 986"><b>On:</b> System armed in away mode.</p> <p data-bbox="679 993 986 1031"><b>Off:</b> System disarmed</p> <p data-bbox="679 1039 1322 1077"><b>Flashes slowly:</b> Systems armed in stay mode.</p> <p data-bbox="679 1085 1172 1123"><b>Flashes quickly:</b> WiFi network lost.</p>
2	<p data-bbox="251 1251 496 1332">Power/Signal LED Indication</p> 	<p data-bbox="679 1307 833 1345"><b>Green LED</b></p> <p data-bbox="679 1352 879 1391"><b>On:</b> Power on</p> <p data-bbox="679 1398 886 1437"><b>Off:</b> Power off</p>
3	<p data-bbox="315 1612 432 1651">Button</p> <p data-bbox="187 1740 446 1778">Tamper Switch</p>  <p data-bbox="208 2122 401 2160">Enroll Button</p>	<p data-bbox="679 1646 901 1684"><b>Tamper Switch</b></p> <p data-bbox="679 1691 1158 1730"><b>Press once:</b> Trigger tamper alarm</p> <p data-bbox="679 1765 886 1803"><b>Enroll Button:</b></p> <p data-bbox="679 1811 1200 1849"><b>Press once:</b> start accessory enrolling</p> <p data-bbox="679 1857 1243 1939"><b>Press and hold for 5 seconds until one beep heard:</b> start setup with app</p> <p data-bbox="679 1946 1186 2028"><b>Press 7 times:</b> Delete all connected accessories.</p> <p data-bbox="679 2035 1243 2168"><b>Press 5 times:</b> Restore the system to default setting. Restoring operation will not delete the enrolled accessories.</p>



# Quick Start Guide

---

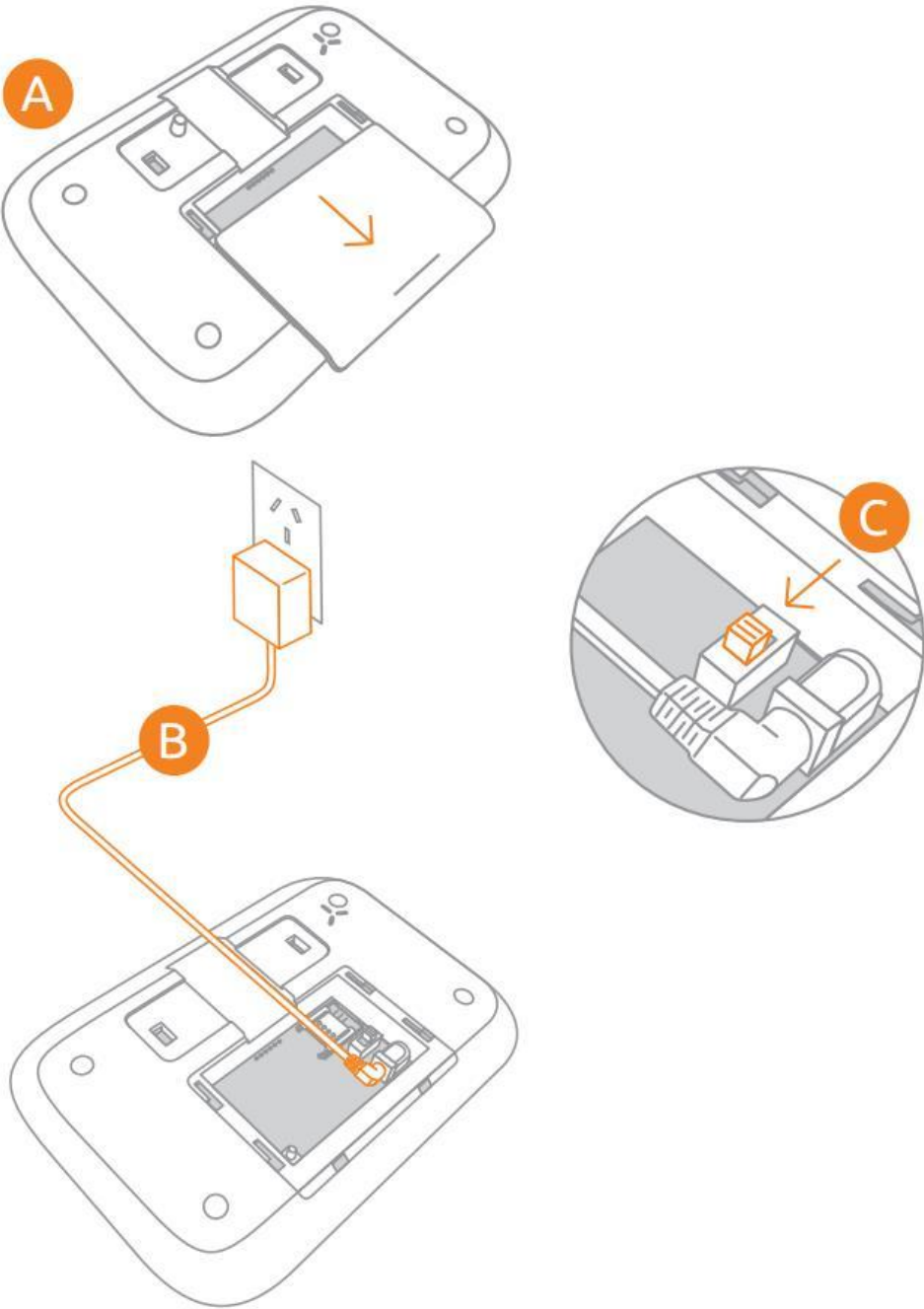

## 1. Installation of The Control Panel

- A. Gently open the battery bay cover.
- B. Insert power adapter's barrel plug to adapter socket.
- C. Slide the power switch to ON position.
- D. Test the enrollment of accessories.



## 2. Using and Testing the Remote Control(s)



- A. Press the panic button “  ”. A small display on the remote control will briefly light up. A loud alarm tone will immediately sound and the symbol on the control panel will flash red .
- B. Turn the alarm off again by pressing the disarm “  ” button.  
Congratulations!  
Your remote control( s ) are working!

## 3. Using and Testing the Door Sensor



- A. Pull out insulating strip.



- B. Arm the system with “  ” button.



- C. Now separate both parts of the sensor and hold them at least 2cm away from one another. A red light will briefly flash on the sensor



- D. As soon as the alarm sounds, disarm the control panel with “  ” on the remote control.  
Congratulations.  
The door sensor is now working!

## 4. Using and Testing the Motion Detector



- A. Carefully open the cover of the motion sensor by pressing the clip and pull out insulating strip.



- B. Fix the cover by the short screw.



- C. Arm the system with “” button.



- D. Now press the small, black button (program) on the rear of the motion sensor.



- E. As soon as the alarm sounds, disarm the control panel with “” on the remote control  
Congratulations.

The motion sensor is now working!



## Wireless P.I.R. Motion Detector

### Features

The passive infrared sensor with novel and beautiful style, perfect streamline can be easily installed. It is designed to detect human movement indoor. Adopted advanced fuzzy logic chip and intelligent analysis distinguish signal between body movement and interference to minimize false alarms. The built-in buzzer remind you low battery state and event of tamper alarm, which ensure your safety.

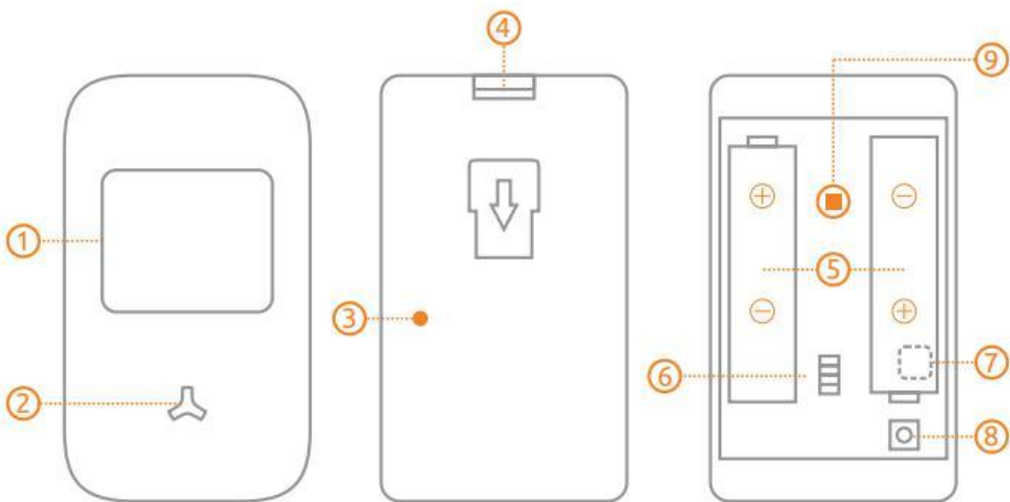

1. Detection Window
2. LED Indicator
3. Learning Button
4. Clip
5. Battery Compartment

6. Zone Jumper
7. Buzzer
8. Tamper Switch
9. Infrared Sensor

**Infrared Sensor:** Detects the infrared rays released by human body motion. Please do not touch the surface and keep it clean.

**Tamper Switch:** Once the case is opened, the tamper switch will be triggered, generating an alarm signal.

## Status Indicator

---



### LED flashed once:

Movement is detected.

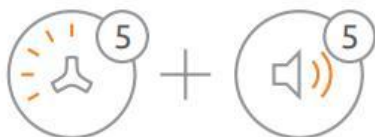

### LED flashes 5 times, and buzzer beeps 5 times:

Power on, tamper alarm, low battery indication. If it's in low battery state, please replace it only with 1.5V/AA LR6 Manganese Dioxide Cell (EXCELL, GP) immediately.

## Test Mode & Normal Operation

---

**TEST MODE:** After switching on (inserting the batteries), the motion detector beeps and flashes five times. This shows that the detector is only in test mode and will remain in that mode, until it has recognized a movement 20 times. In test mode, every movement triggers an alarm.

**NORMAL OPERATION:** Once the test mode has ended, the motion detector switches to normal operation and, after the first recognized movement, into sleep mode to save energy. The sleep mode ends after 7 seconds. This helps save considerable amounts of energy when the house or apartment is inhabited and people are constantly moving around. In case of an alarm, however, the first movement is enough to trigger an alarm.

### Walk Test:

1. When the power is on, the LED indicator flashes five times and buzzer beeps five times to enter working state.
2. Walk across detection area and watch the LED indicator to make sure it flashes once when detecting the movement. After one detection, it will detect once every one minute.



## Notice

1. Avoid mounting the detector close to places where heat changes fast or air stream flows frequently. (ie. Air conditioner, tube light, oven, waver, refrigerator etc.)
2. Avoid it facing to window which can be easily interfered by complicated environment. (ie. sunlight, crowds, or flowing cars etc.)
3. The product can reduce the possibility of accident, but the user is advised to take all necessary precautions for the safety and the protection of the property.

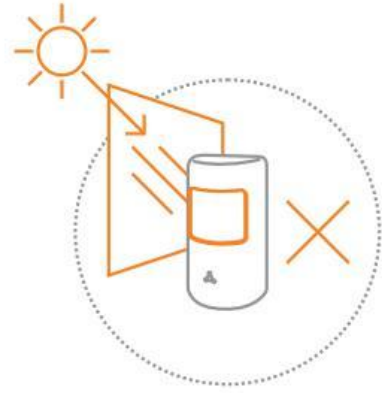

## Detection Area

Top View

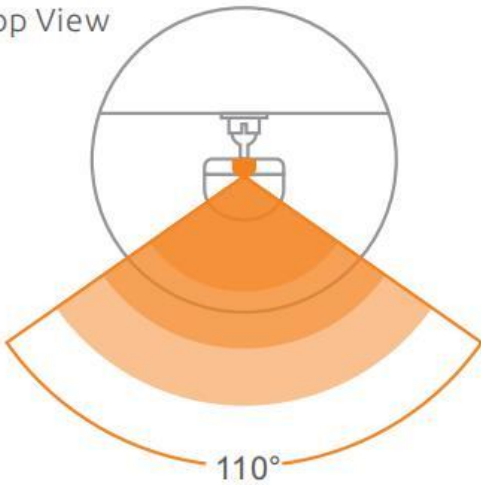

Side View

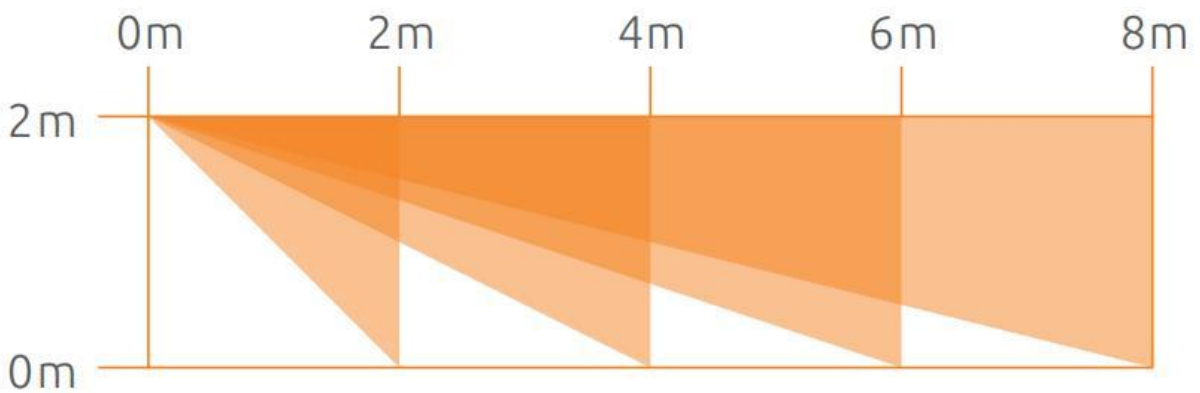
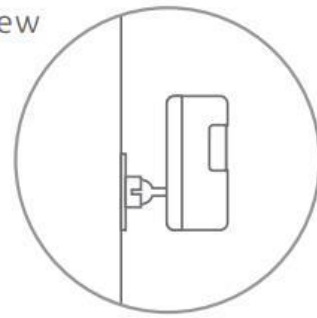



# Wireless Door/Window sensor

The Door/Window Sensor can be installed on doors, windows and any other objects that open and close.

The sensor transmits signal to control panel when the magnet mounted near the sensor is moved away.

The tamper protection ensures that sabotage attempts to move the sensor will result in an alarm activation.

### Vertical Installation

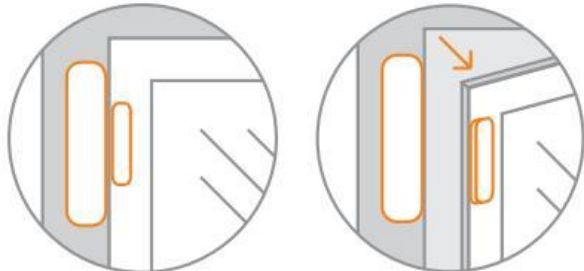

### Horizontal Installation

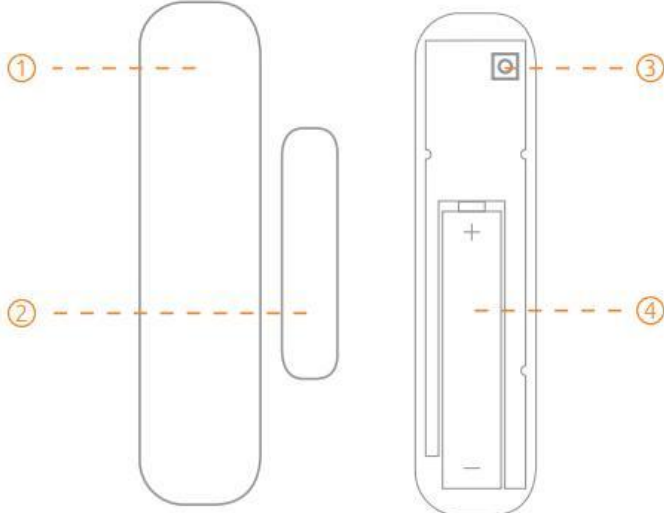
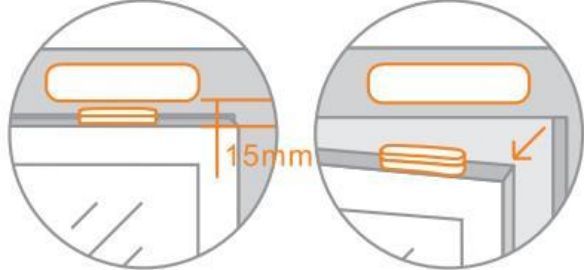

- 1. Transmitter
- 2. Open-close magnet
- 3. Tamper Switch
- 4. Battery Compartment

**Tamper Alarm:** Once intruder attempts to move the sensor, built-in buzzer beeps. The control panel will send tamper alarm message to user at the first time.

## Working Status:

---



### LED flashes once:

Door or window is opened.

and the transmitter sends signal to the control panel.

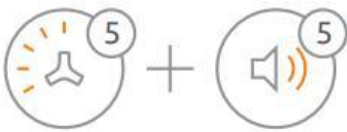

### LED flashes 5 times, and buzzer beeps 5 times:

Tamper alarm, low battery indication. If it's in low battery state, please replace it only with 1.5V/AA LR6 Manganese Dioxide Cell (EXCELL, GP) immediately.

## Installation:

---

1. Open the case and install the battery properly.
2. Sensor can be installed on door or window that open and close. Make sure the installed position have been already cleaned.
3. Remove the paper strip of the double-sided tape on the back of transmitter and magnet. Carefully mount the transmitter on the door frame and the magnet on the door.
4. Place the transmitter in the desired location, mount the magnet no more than 1cm away from the transmitter.
5. Avoid mounting sensors in areas with a large quantity of metal and electric wiring.



**Note!** The door sensor is set in Normal Zone1 as default. It will cause on immediate alarm if the magnet depart from the transmitter more than 2cm in arming state.





# Set Up Router

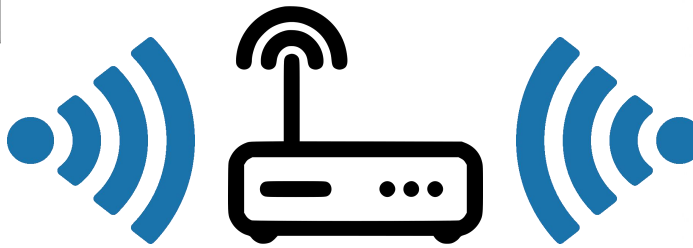
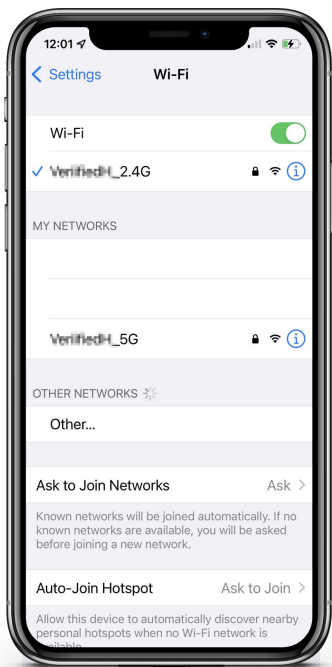

Please keep network available

2.4GHz

5GHz



The router supports the 2.4GHz WiFi (doesn't support the 5GHz), and is connected to the WiFi network. Please set the parameters of the router before connecting the WiFi network, and record the SSID and password of your WiFi.

# Ready to work

## Manually add Wi-Fi devices in EZ mode

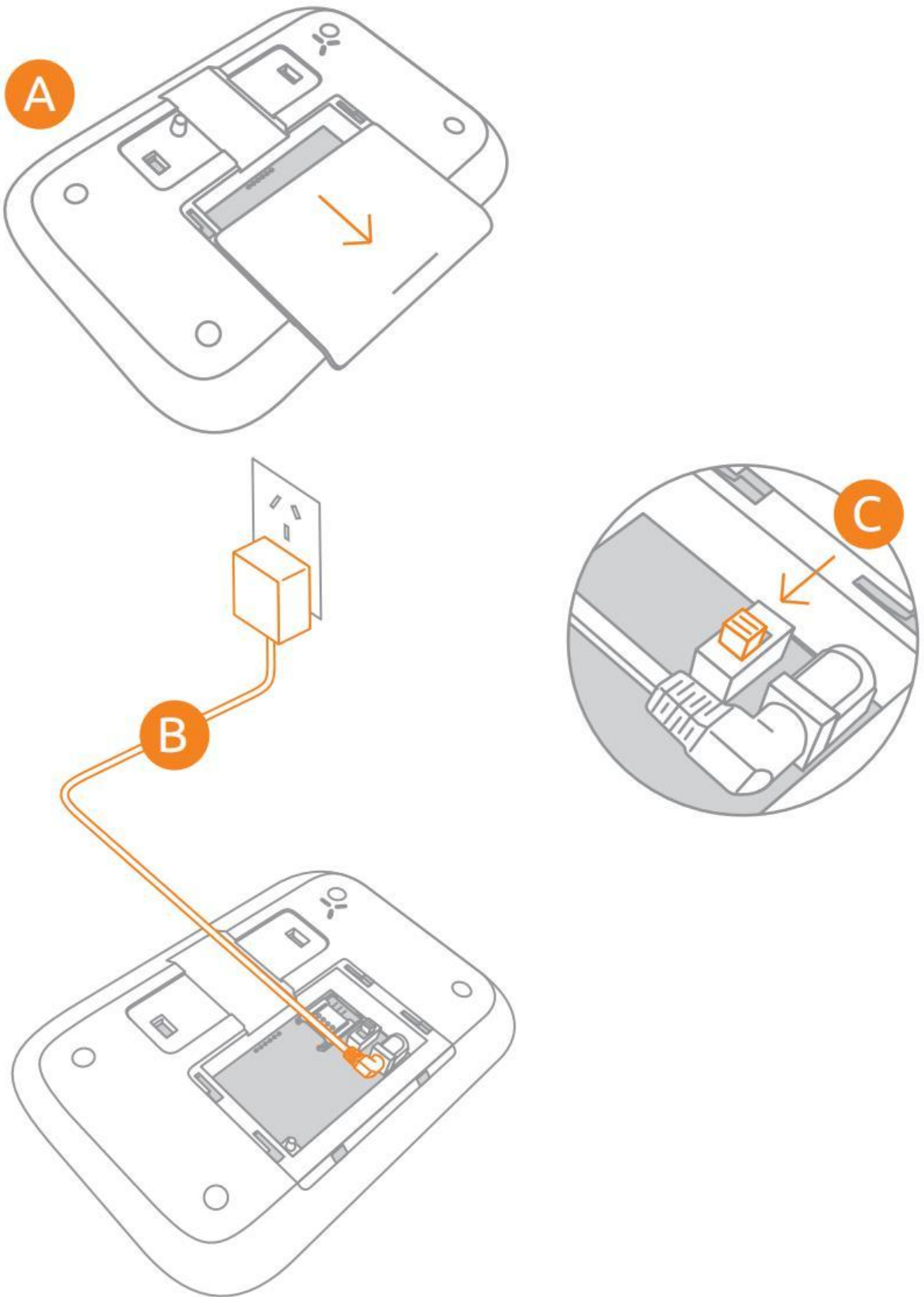

### Step 1:

- A. Open the battery bay cover.
- B. Insert power adapter's barrel plug to adapter socket.
- C. Slide the power switch to ON position.



Step2:The Red Light Flash(rapid blink)

- Red light rapid blink : Pairing mode to Connect WiFi.

# Install Free App

Download APP: scan the QR code below to download and install. Register and login: open the "MySmarth" APP to register and login according to the prompts.



## Customer Support

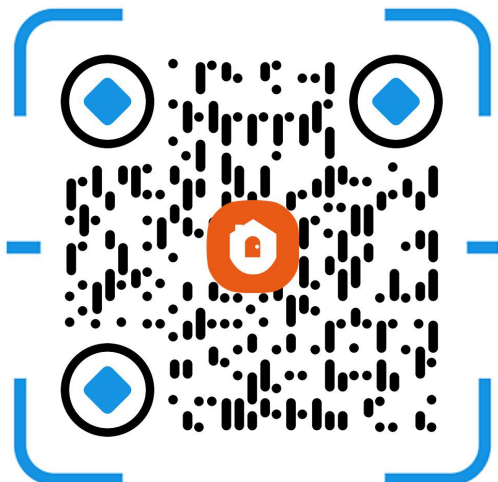

Two pairing modes are provided in the MySmartH app. The Wi-Fi Easy Connect (EZ) mode is the default mode, and the access point (AP) mode is the compatible mode. The user can tap the pairing mode drop-down list in the top-right corner of the page to switch between the pairing modes.

## Manually add Wi-Fi devices in EZ mode

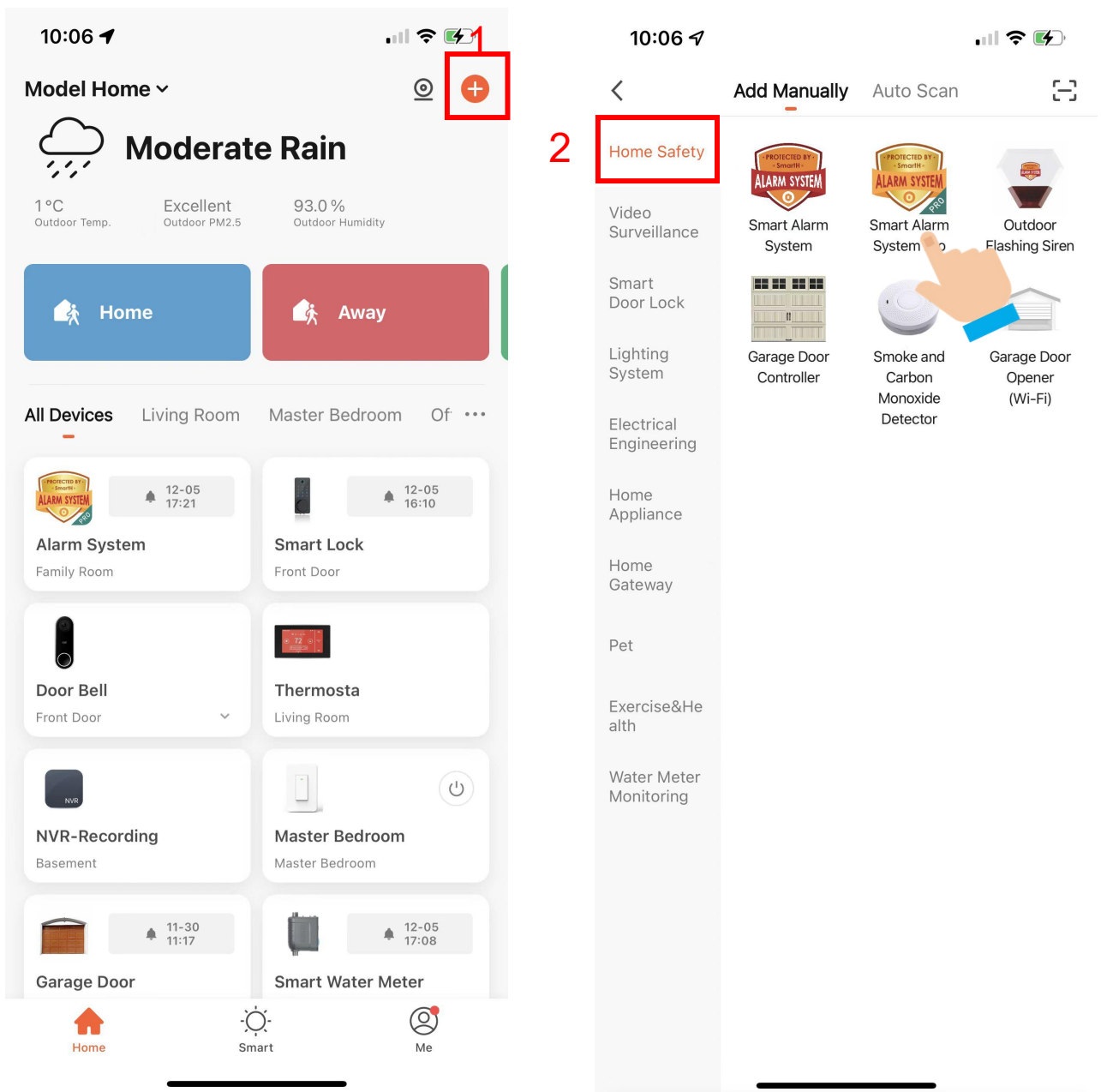

1. Open "MySmartH" APP, press the '+' in the upper right corner of the main screen;

2. Choose "Home Safety", click "Smart Alarm System".

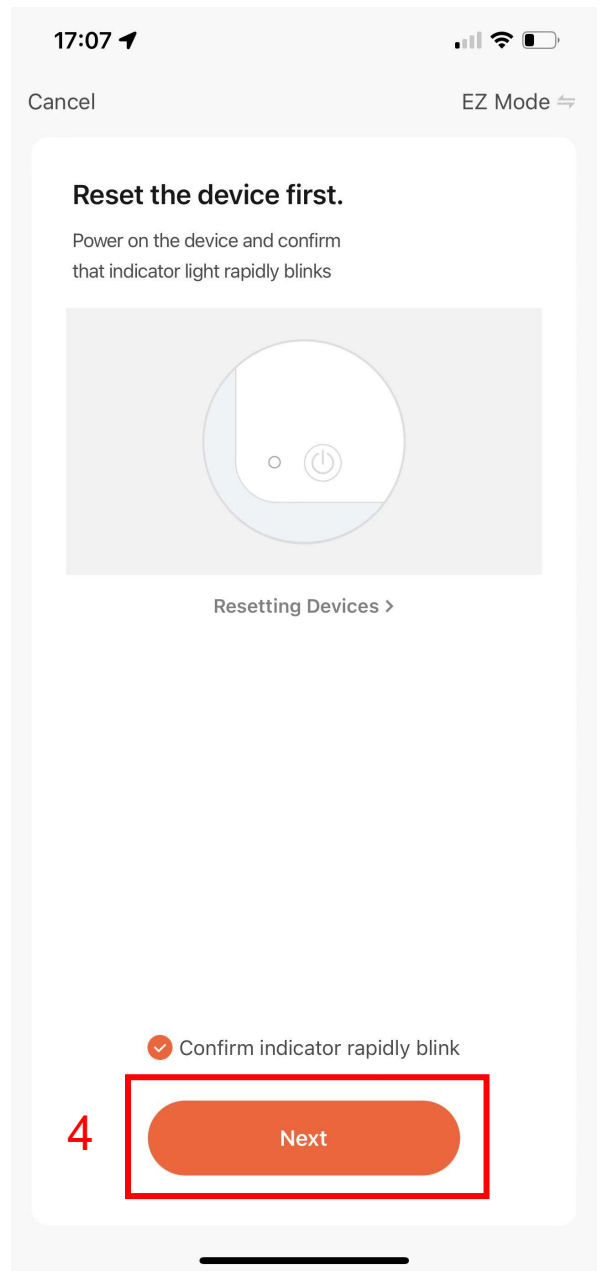
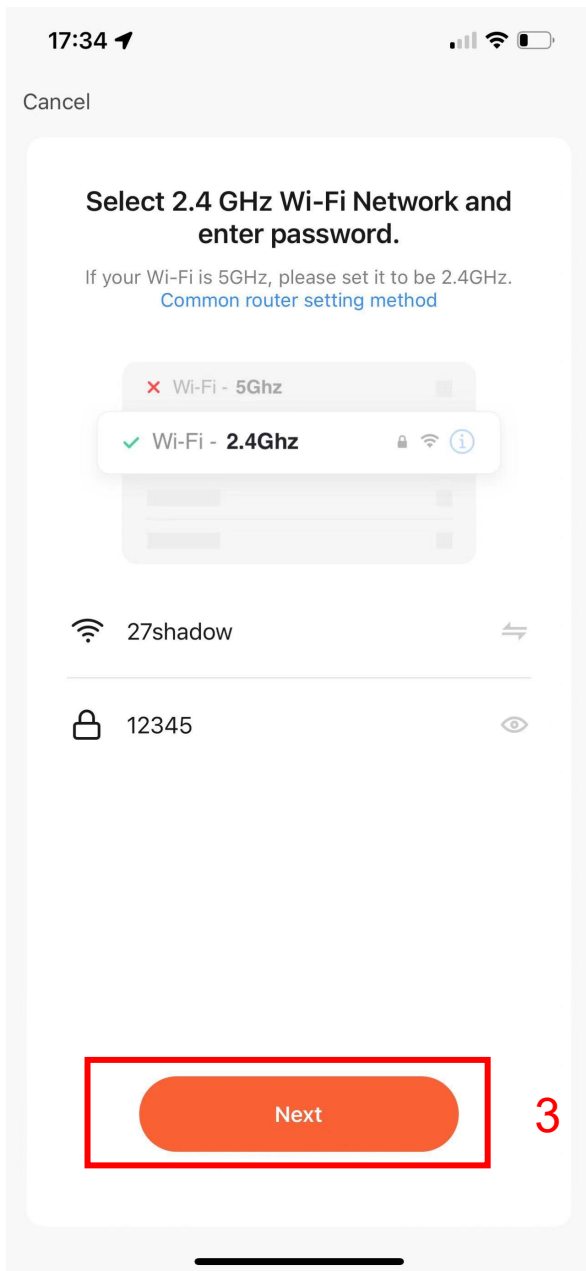

3. Choose WiFi and enter password and tap “Next”;

4. Confirm that the Red indicator light of the Smart Alarm System is flashing quickly and tap"Next";

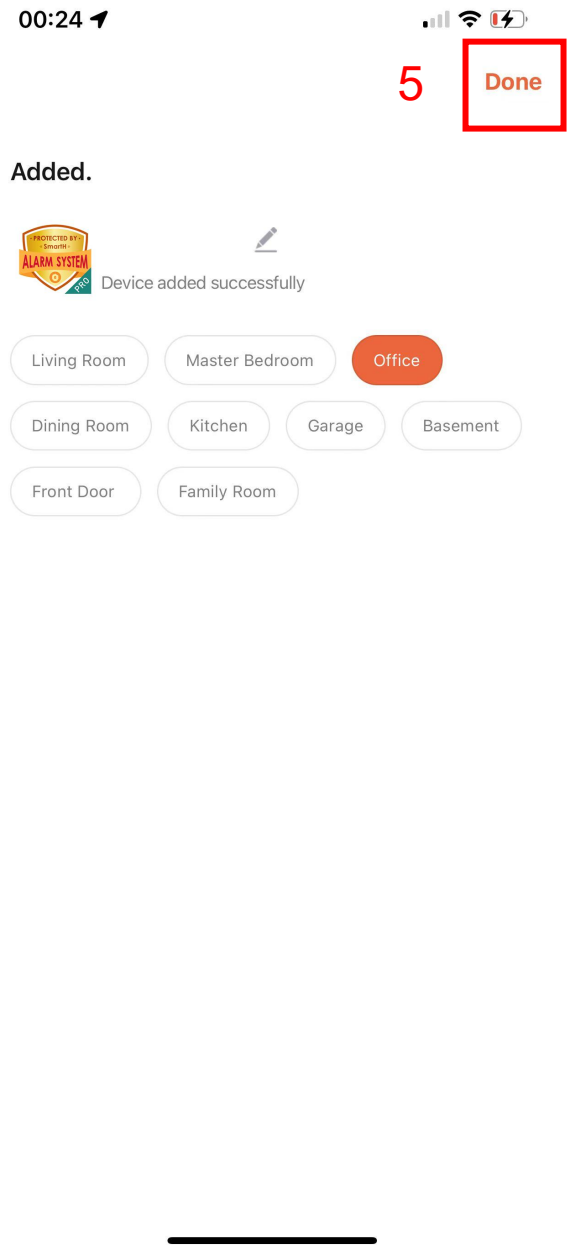
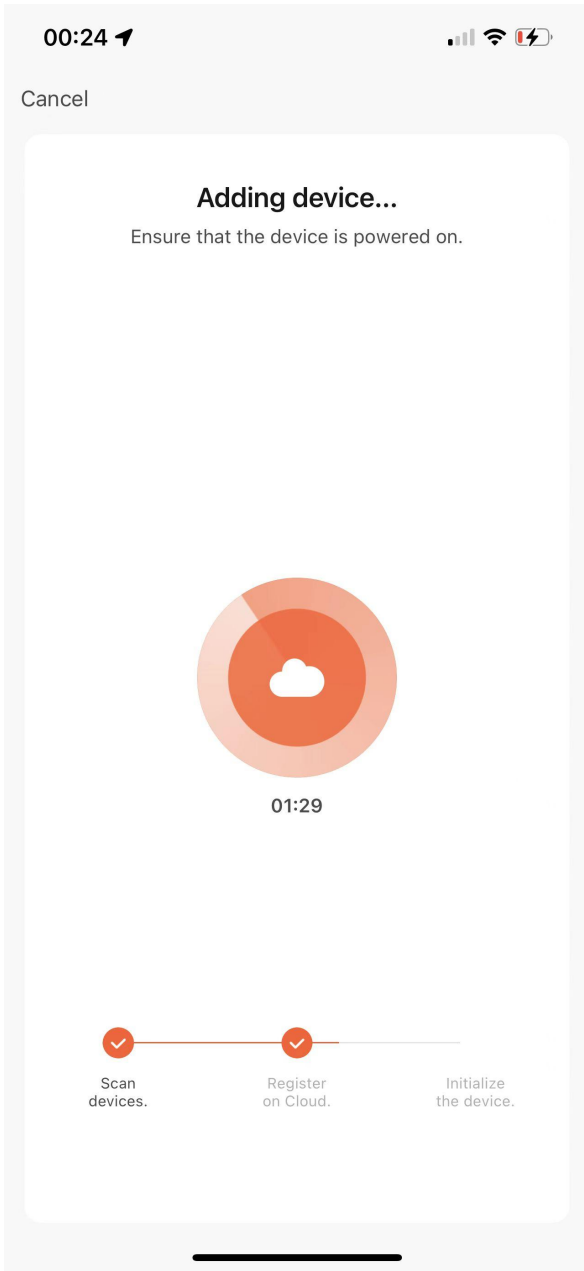

5. Tap "Done";

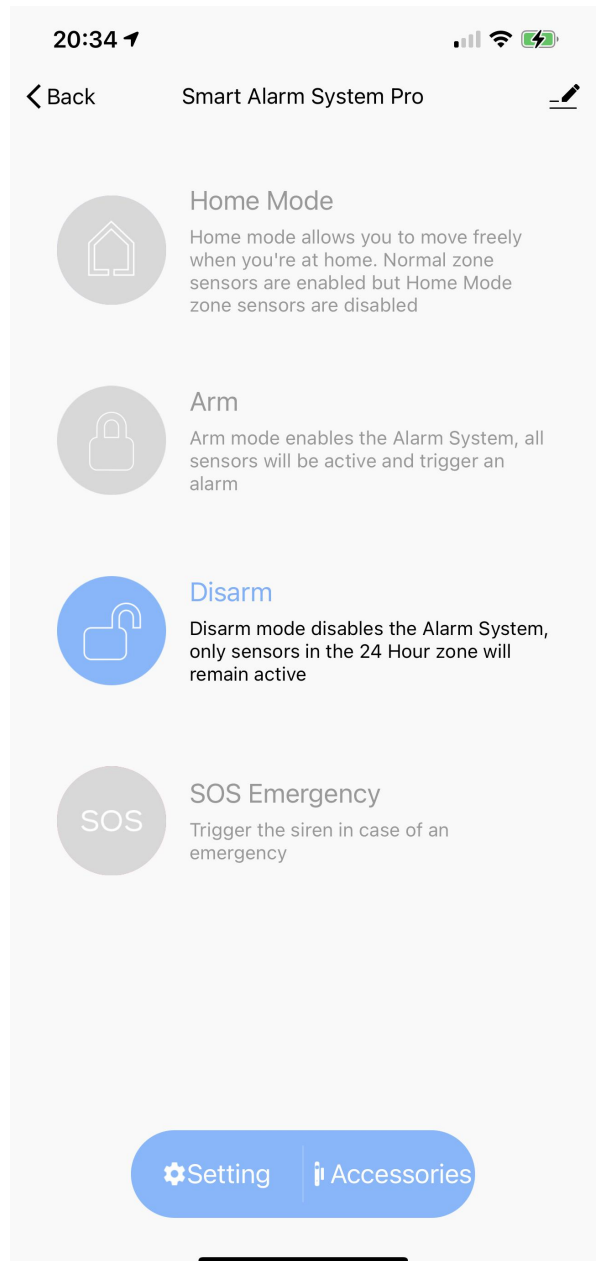
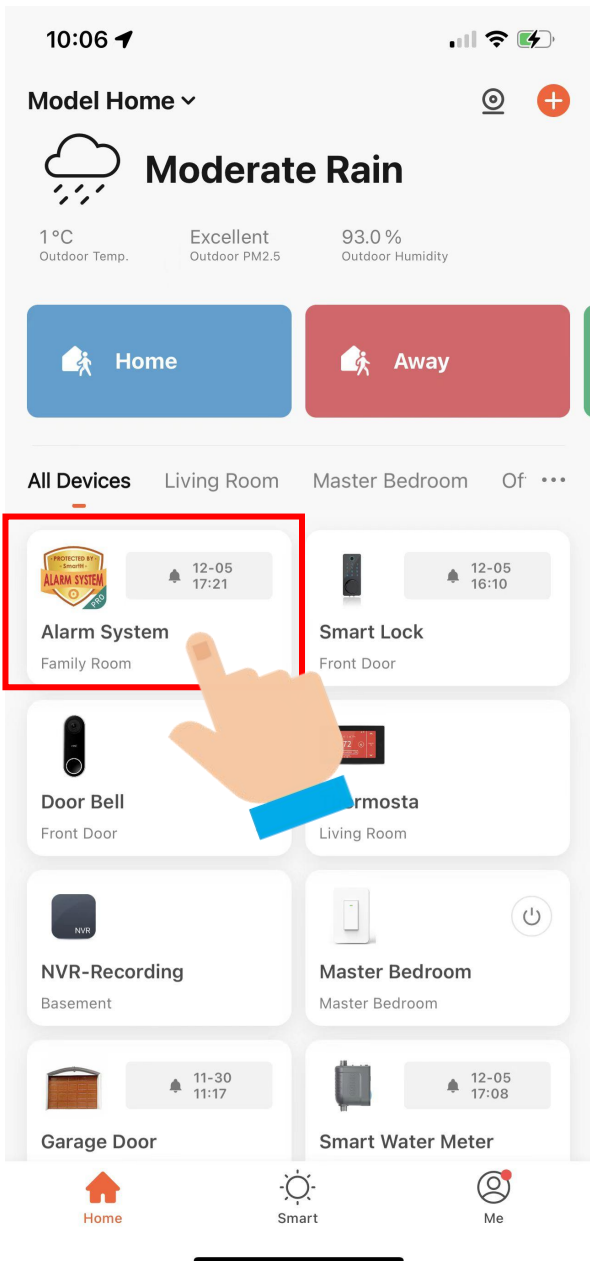

Now your Smart Alarm System is successfully added to MySmarth app.





# Manually add Wi-Fi devices in AP mode

**If the connection fails, please try AP mode**

If a dual-band network that supports both 2.4 GHz and 5 GHz bands is used, the AP mode can be used to add devices.

In AP mode, follow the instructions to enable the indicator to blink slowly, select Confirm the indicator is blinking slowly, and then tap Next.

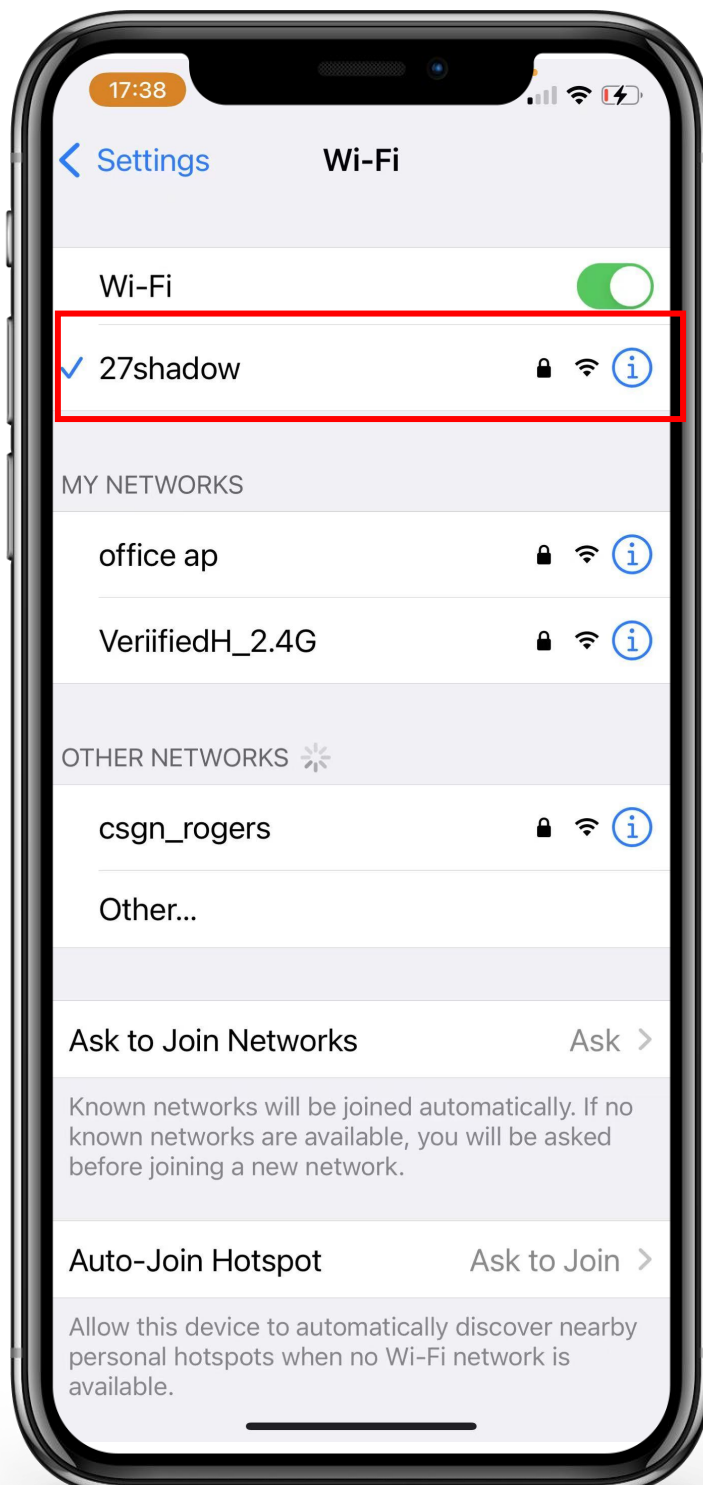

# Ready to work

## Manually add Wi-Fi devices in AP mode

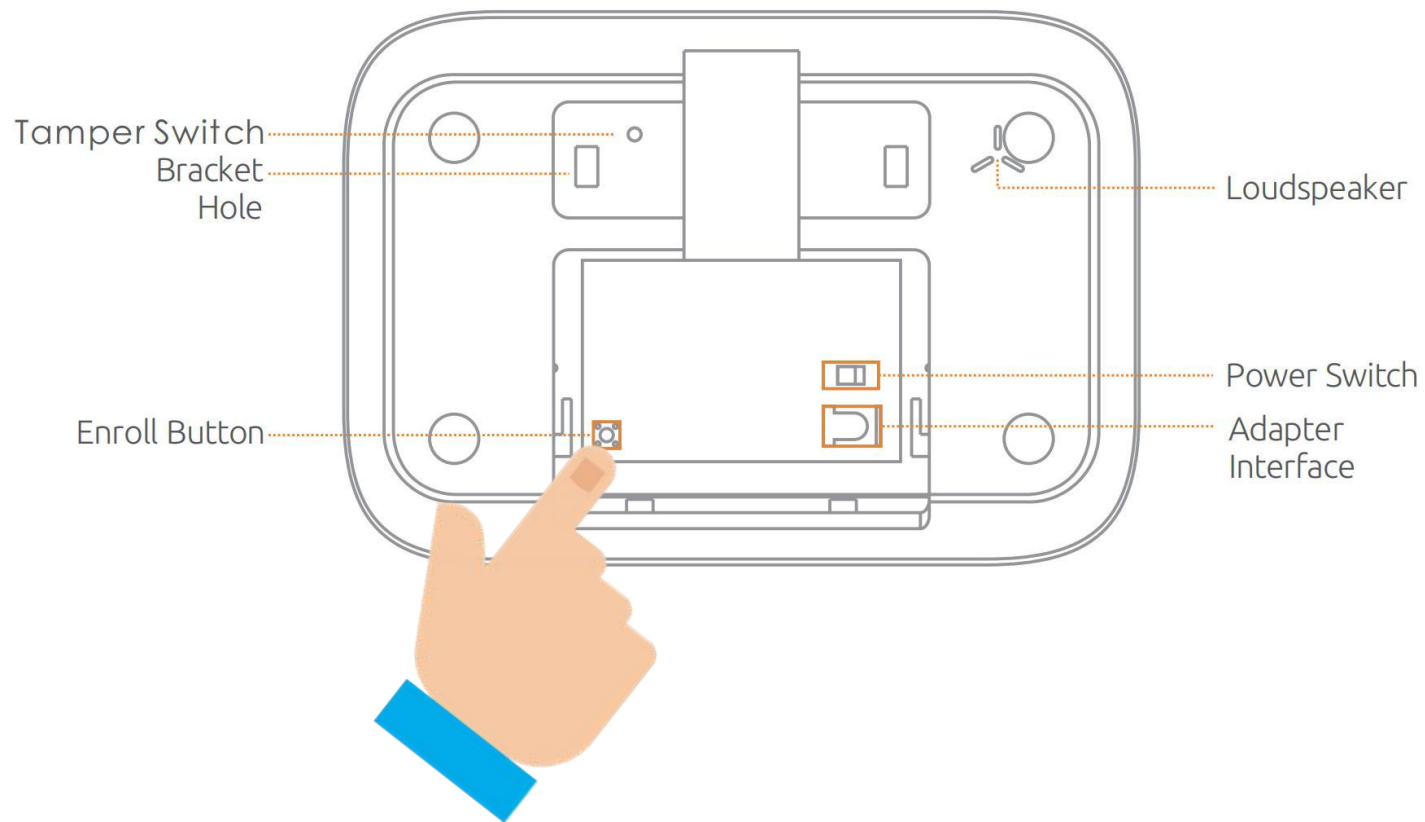

**Step1:** Let the Red Light Flash (blink slowly), If the indicator light of the smart alarm system is flashing fast, please continue to press and hold the Enroll button until the fast flashing turns to slow flashing.

Make sure the device's indicator light is slowly flashing (1 time every 2 seconds).

# Connect the Smart Plug to MySmarth App

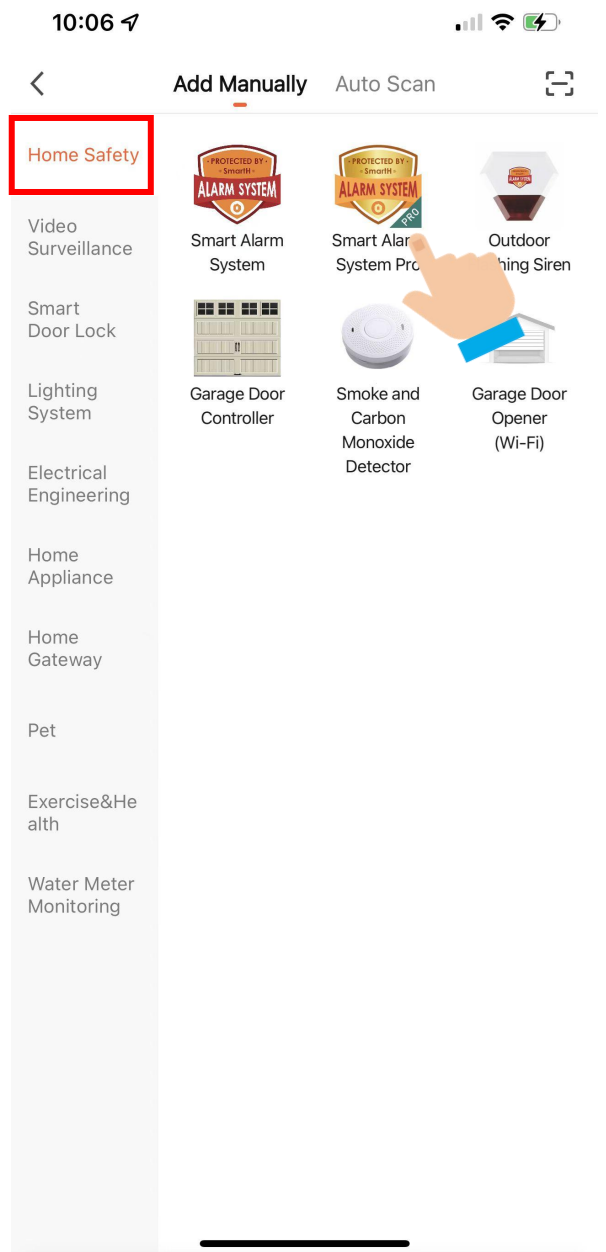
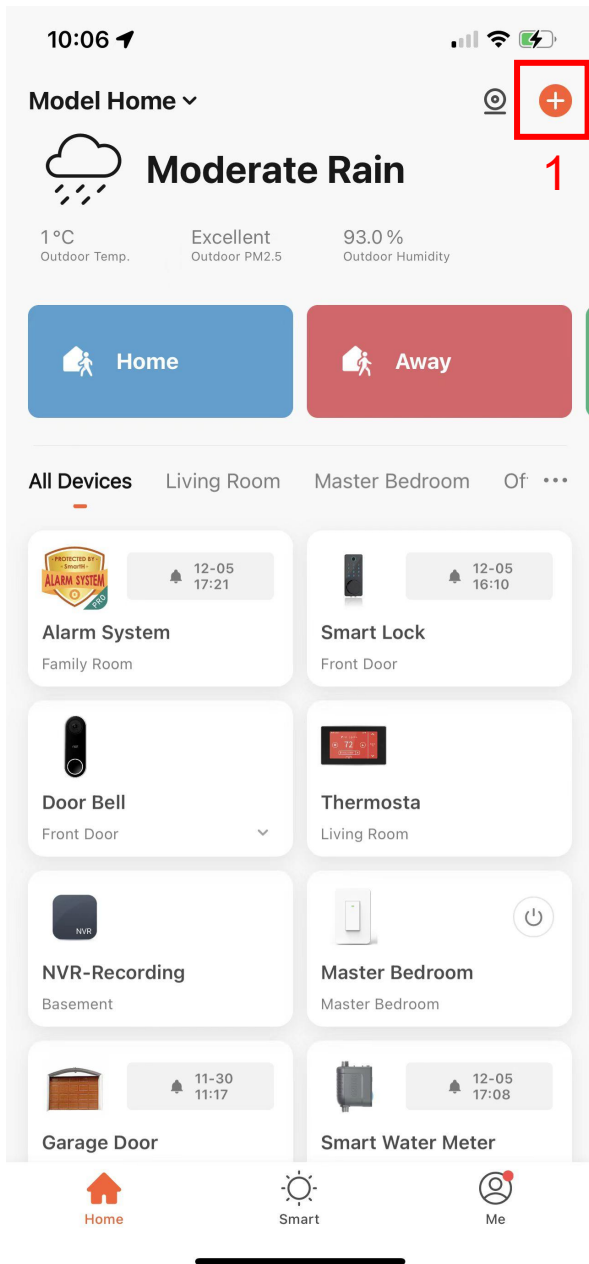

1. Open "MySmarthH" APP, press the '+' in the upper right corner of the main screen;

2. Choose "Home Safety", click "Smart Alarm System".

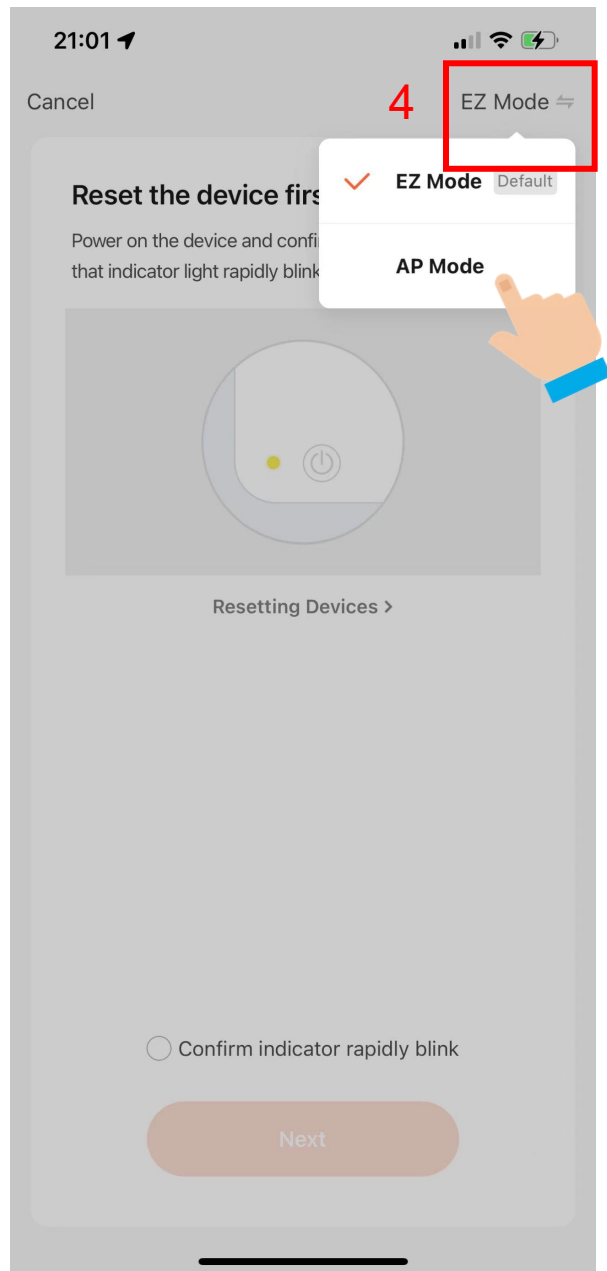
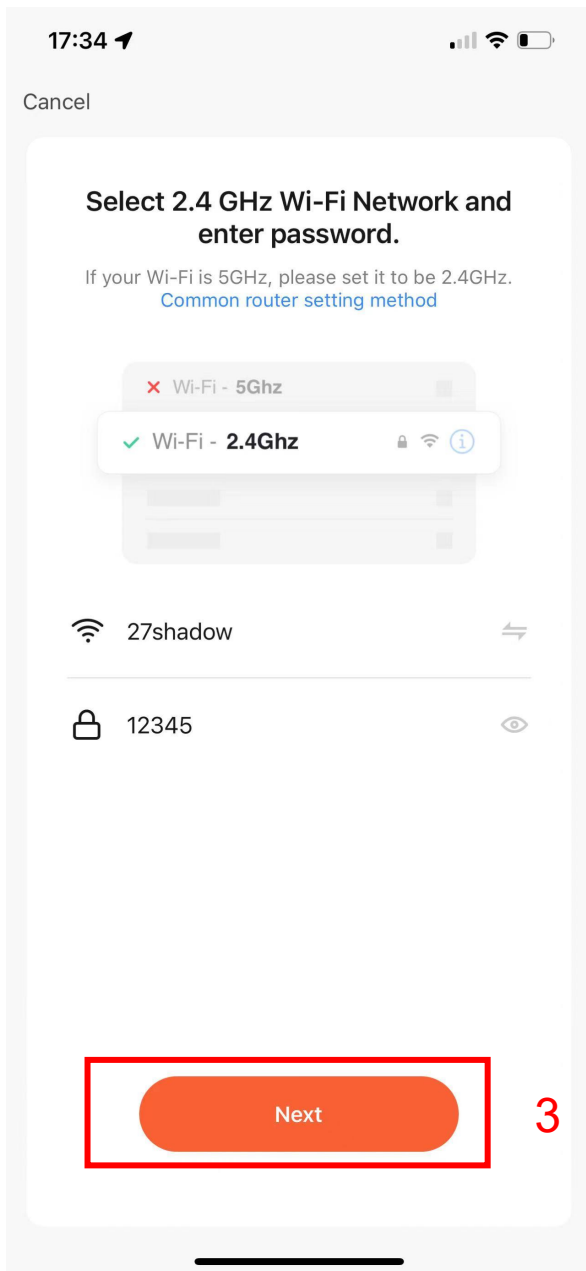

3. Choose WiFi and enter password and Tap “Next”;

4. Tap"AP Mode"in upper right screen;

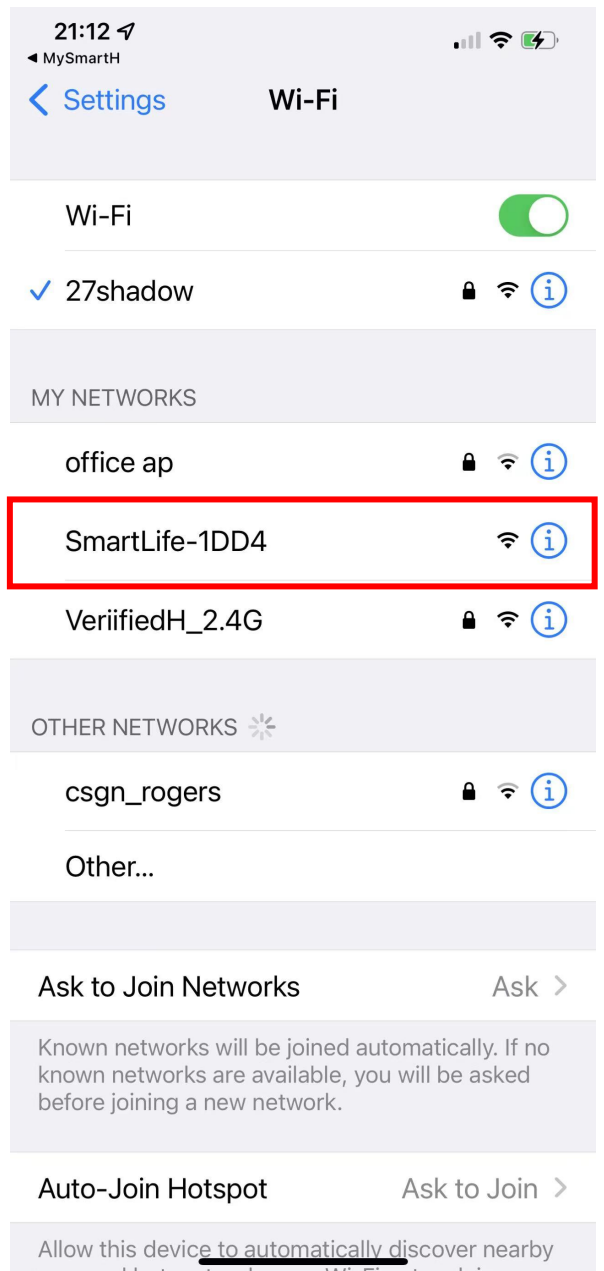
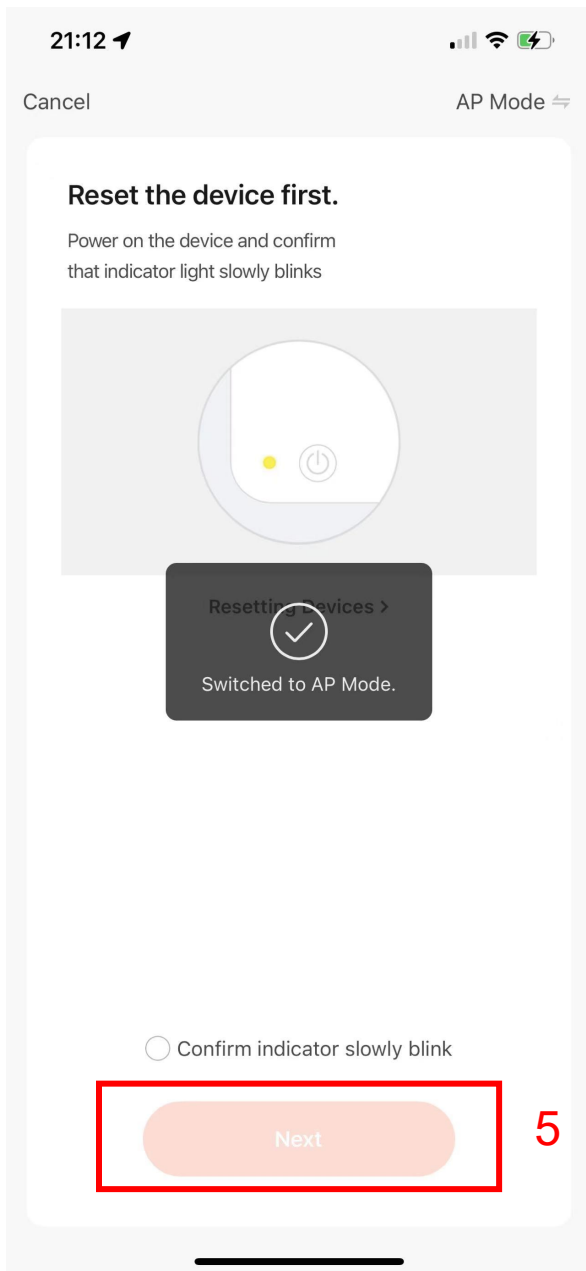

5. Tap "Next";

6. Click "SmartLife-1DD4";

In AP mode, on the Wi-Fi setting page of the mobile phone, find the Wi-Fi hotspot starting with SmartLife.

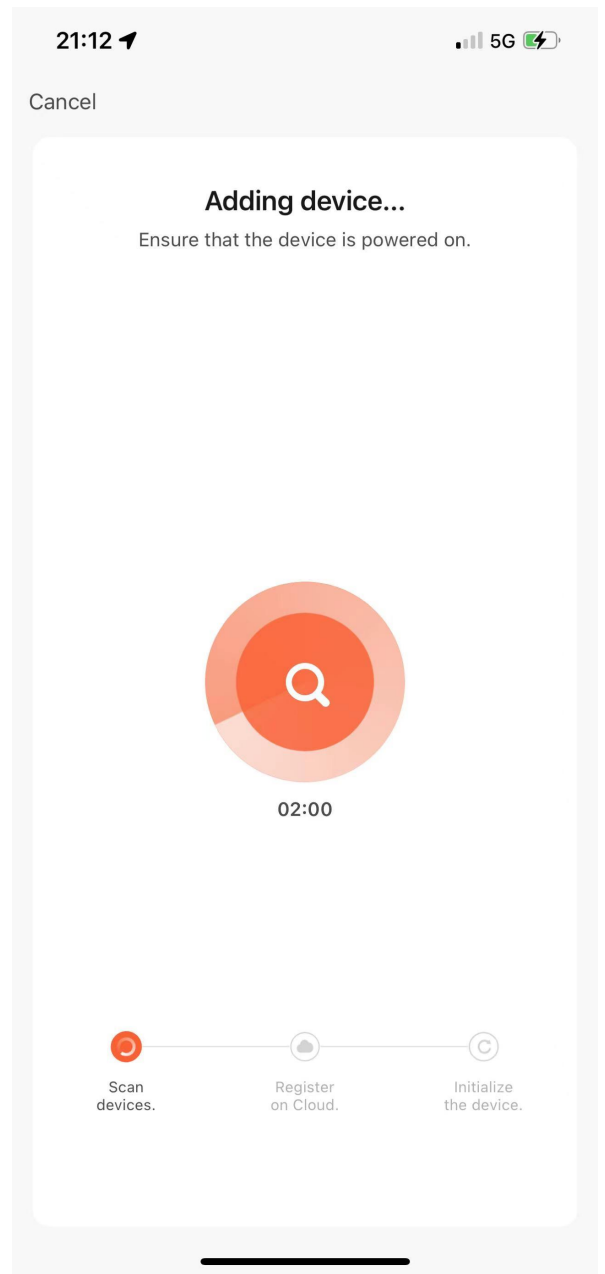
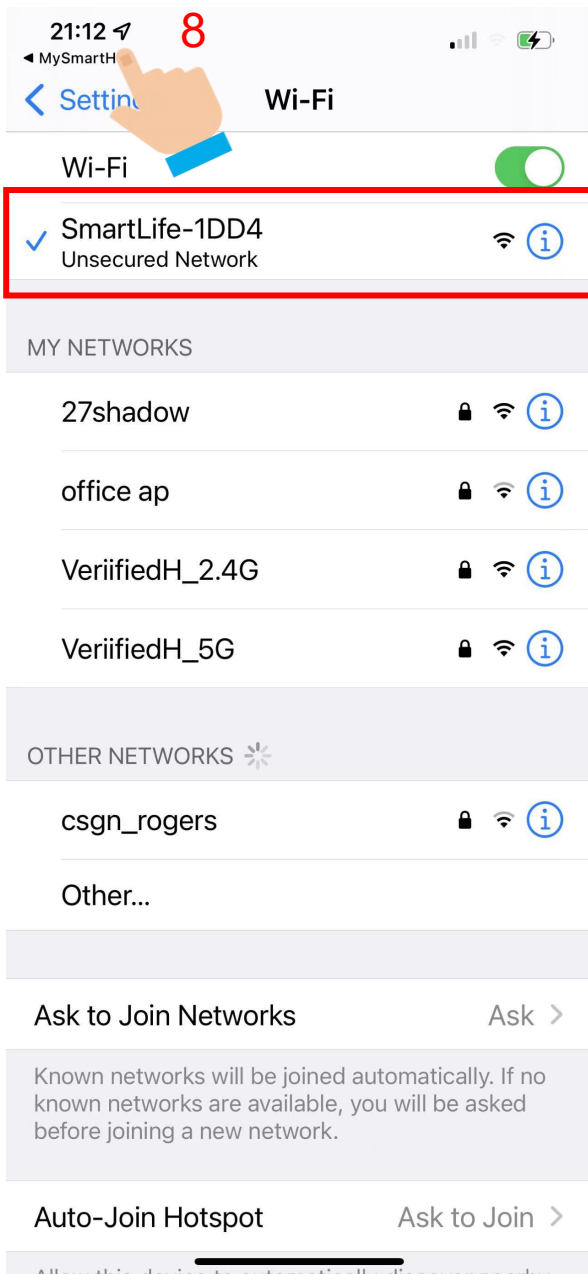

7. Tap the Wi-Fi hotspot to connect the mobile phone to it.

8. After a successful connection, go back to the app to start pairing.

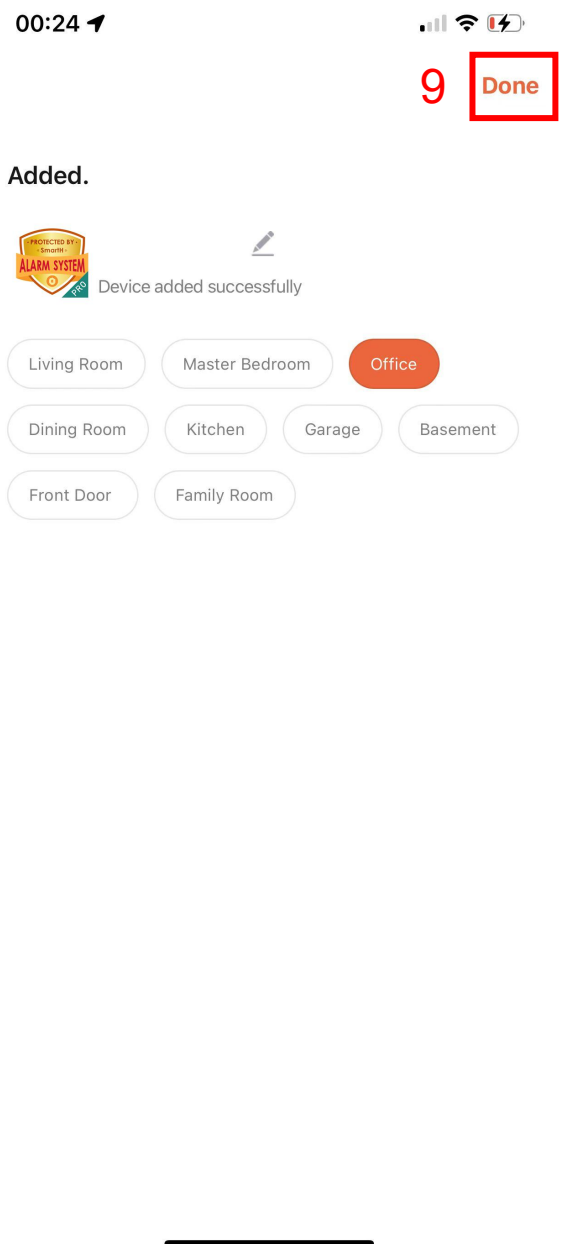
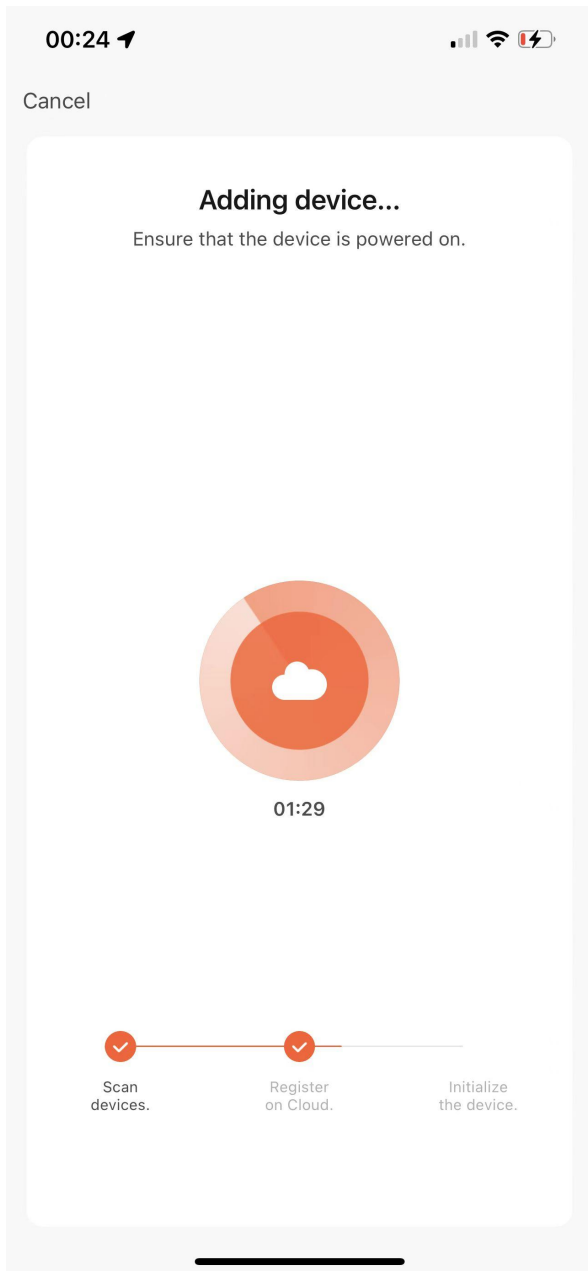

The device pairing page on the app appears again and the pairing process continues.

9. Tap “Done”

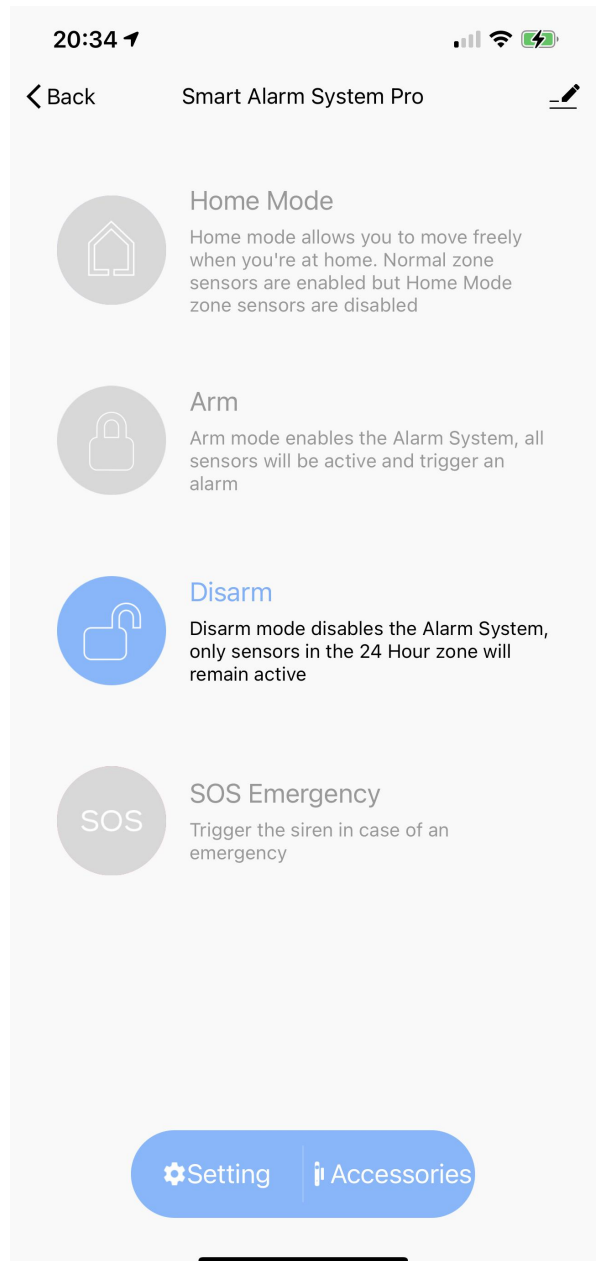
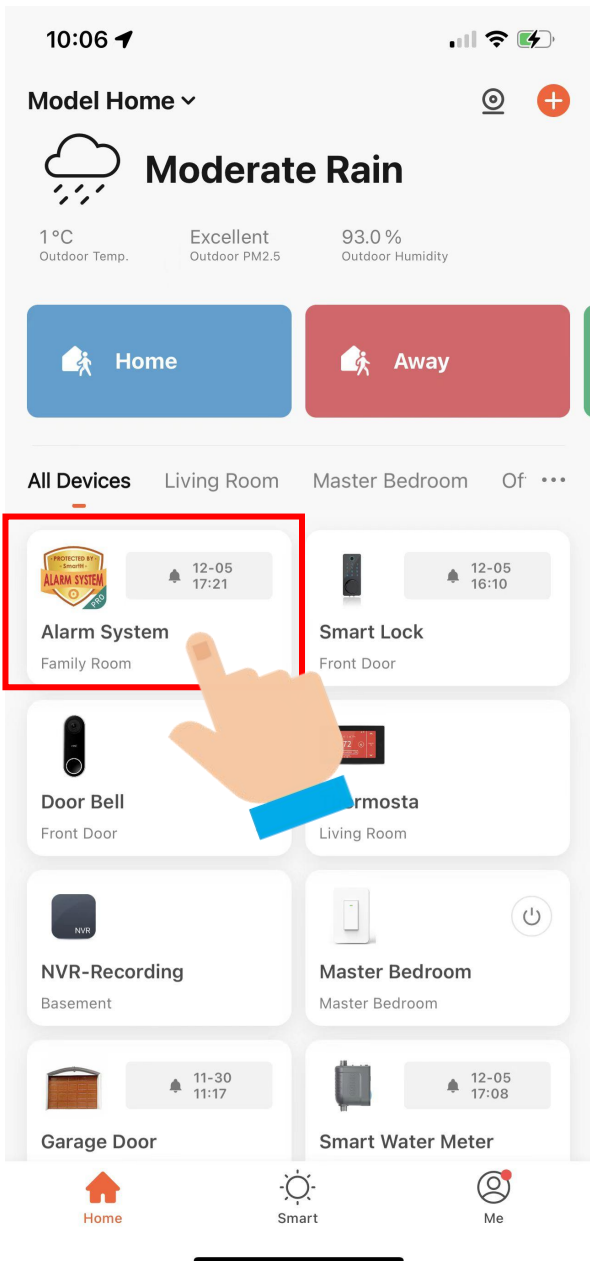

Now your Smart Alarm System is successfully added to MySmarth app.







# Accessories Management

Tap on "  Accessories " icon on the into accessories menu, you can customise the accessory name, select the zone type, and also delete the accessory from the app, if required.

## Accessories Enrollment & Zone

Accessories in the standard kit were enrolled by default.

More accessories can be paired in two ways.

You are able to pair up to 50 additional sensors, 10 remote controls or keypads to the alarm system. Sensors that are included with the alarm system are already enrolled with the control panel.

Press the enroll button .

Step 1,

Select the "  Accessories "

on the dashboard to enter the Accessories Menu, then tap on "  " icon.

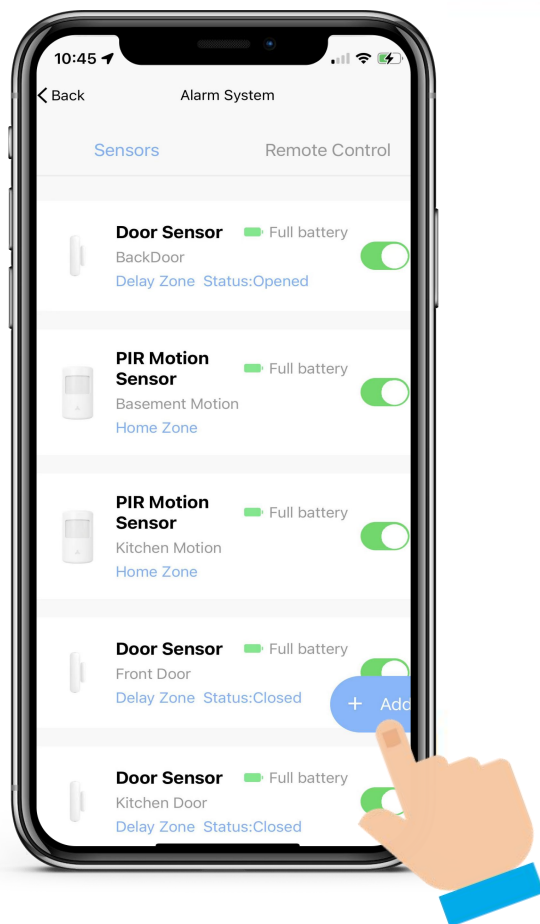

Step 2, Trigger the sensors one by one, press the enroll button again or press "  " icon on the app to exit the enrolling . The enrolled sensors will automatically appear in the Accessories menu in the app.

### How to trigger different accessories:



Press any button on the remote control.

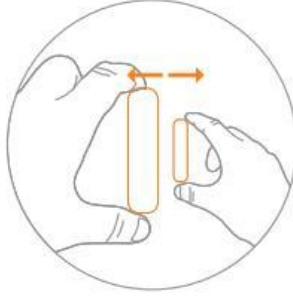

Move the transmitter away from the magnet



Press the black button on the rear of the motion sensor.

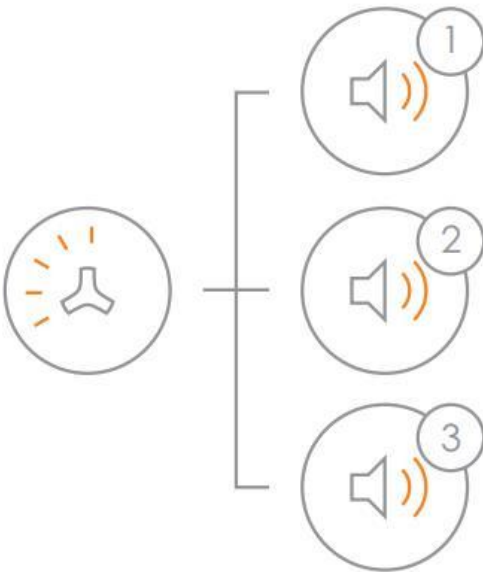
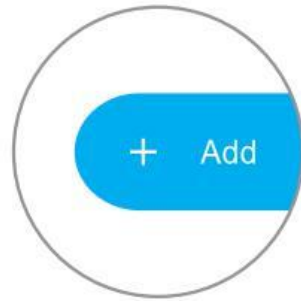
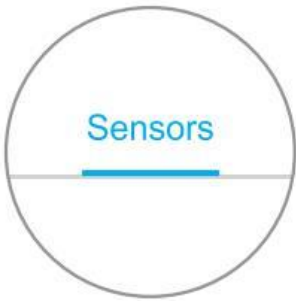

1 System beeps once, the LED light flashes once, the enrollment is successful.

2 If system beeps twice and the LED light flashes once, the accessories have been enrolled before.

3 If three beeps are heard and LED light flashes once, the storage is full.

**(Note! Please don't press tamper switch to enroll or enroll accessory in low battery status, It will remain in enrolling mode for 30 seconds. )**

## Delete Enrolled Wireless Accessories

Delete accessories via APP or Press the enroll button 7 times until one beep is heard, all enrolled wireless accessories will be deleted.

# Zone Setup

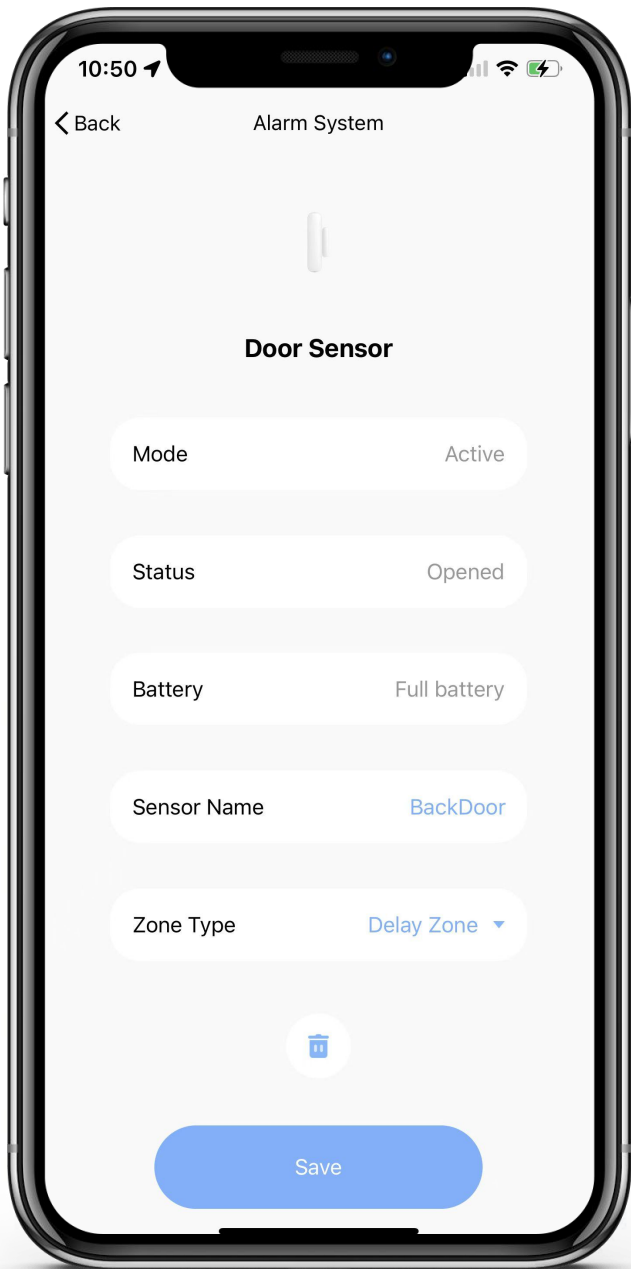

## Normal Zone

The alarm is activated immediately when triggered.



## Delay Zone

It allows a delay before entry or exit especially for sensors in single delay zone. But accessories in normal zone, home mode zone, and 24H zone will not be delayed.



## Stay Zone

Press "  " button, sensors in home mode zone are disabled then the users can move freely. While the sensors in normal zone will still activate an immediate alarm when triggered.



## 24 Hour Zone

No matter what state the alarm system is in, the accessories in 24 Hour zone are triggered, the control panel will get the signal and alarm immediately.

 :Full power,  :Low Battery



## Specifications

Product Name :	Smart Alarm System
Control Panel's Power Supply :	Input: AC 110~240V/50~60Hz Output: DC 12V/1000mA
Standby Current :	200 mA without power supply. 150 mA when power supply on.
Alarm Maximum Current	≥350mA
Internal Battery Backup :	Lithium Battery: 3.7V/900mAh
Internal siren :	105dB
Allowed Amount of Expandable Wireless Accessories	10pcs remote controls 50pcs wireless accessories
Operating Frequency:	2.400~2.4835GHz
Wi-Fi Standards:	802.11b/g/n
Radio Frequency	FHSS 433MHz
Housing Material	ABS plastic
Operation Condition:	Temperature: -20°C~55°C Humidity: ≤ 80%(non-condensing)
Size (L x W x H) :	180×126×26mm



## Specifications

Power Supply:	DC1.5V (AA Battery)
Standby Current:	≤25 μA
Transmit Current:	≤70mA
Wireless Transmit Distance:	≤100m (in open area)
Wireless RF Frequency:	FHSS 433MHz
Temperature/Humidity:	-10°C-55°C/≤80% (Non-condensing)
Detector Dimensions(L x W x H):	24.5 x 96.5 x 19.5 mm
Magnet Dimensions (L x W x H):	14 x 48 x 11 mm



## Specifications:

Power Supply:	DC 3V (AA 1.5V LR6 Battery x 2pcs)(EXCELL, GP)
Standby Current:	≤20 μA
Transmit Current:	≤30mA
Detection Area:	7-8m/110°
Wireless Transmit Distance:	≤80m (in open area)
Wireless RF Frequency:	FHSS 433MHz
Temperature/Humidity:	-10°C-55°C/≤80% (non-condensing)
Detector Dimensions (LxWxH):	90*52*36.5mm
Bracket Dimensions (LxWxH):	48*26*29mm



## Specifications:

Power Supply:	DC 3V (2pcs CR2032 button cell batteries)
Transmit Current:	≤25mA
Wireless Transmit Distance:	≤80m (in open area)
Transmitting Frequency:	FHSS 433MHz
Housing Material:	ABS plastic
Working Temperature:	-10°C-55°C
Humidity:	Up to 80% (non-condensing)
Dimension(L/W/H):	37x70x11.5mm



## Frequently Asked Questions

### 1. Is it possible to expand more accessories for this security system?

Yes, 50pcs sensors and 10 remote controls can be expanded according to users' need. Full range of accessories will be offered including PIR motion sensors, door sensors, vibration sensors, flood sensors, keypads, sirens, premiere protection beams & fences, and environmental sensors like smoke sensors.

### 2. What happens in case of alarm?

Wi-Fi alarm sends the push notification directly to your mobile apps. You can respond immediately via the apps, or using the remote control.

### 3. What internet connection do I need for Wi-Fi system?

All contemporary Wi-Fi standards on 2.4 GHz are supported. The Internet speed has effects on the system performance. A fast and well-functioning Internet connection is recommended for optimum performance.

### 4. Do I have to pay for the app?

All available My smartH Apps are free to download (App Store or Google Play). The complete functionality is free.

### 5. How to download the app for the security system?

Go to App Store or Google Play to download the application by entering the keyword of "My smartH".

### 6. Is My smartH app applied to all mobile phones?

For all smartphones with a recent version of an iOS or Android operating system, this app is available to download and use. For this functionality, depending on the system, a mobile connection or mobile Internet / Wi-Fi connection is necessary.

### 7. What's the maximum range between the control panel and accessories?

It's 100 meters in open area. The walls might shorten the distance, it's recommended to install the accessories at the right place, and move the panel to adjust a better signal receiving. If the house is too large, it's better to add a signal repeater to boost the coverage.

### 8. Will my alarm system work in the event of a power failure?

Yes. The system has rechargeable back-up batteries which can support it working for 6 hours. When the power is recovered, the battery will be recharged. Adapter wire cannot be cut to make sure enough power to the panel.

### 9. What will happen once power is off or internet is cut?

Once power is off or network is cut, android App will be off-line after waiting 20-30seconds, it will not reconnect, you need go back to the device list, but iOS will reconnect.

## PIR Motion Detector

### 1. Why PIR Motion Detector beeps without detecting intruders?

If PIR Motion Detector beeps, and LED indicator flashes continuously, the detector is in low battery. Please change the battery immediately.

### 2. Why PIR Motion detector does not detect movement?

- A. Please make sure the control panel is in arming status, not at stay (home) mode or disarming status.
- B. Please make sure the LED of PIR motion detector lights up when you walk in the detection area.

- C. Movement should cross the detection and within 8 meters range.
- D. The detector enters sleeping mode to save power after first detection. If there's no movement within 7 seconds, the detector goes back to the working state. If there's detection occurs within 7 seconds, the time detector goes back to working state will be added accordingly.
- E. Make sure the insider battery contact well or not.
- F. Check the board put well or not.
- G. If zone jumper is changed, please enroll the sensor to the system again.

### 3. If the PIR motion detector pet-immunity?

No. The PIR supplied in standard kit is normal PIR. If you have pets at home, please adjust the installing height to allow your pets to roam below the mounting height of the unit without causing alarms.

### 4. There's no one passerby the room, but the detector trigger the alarm

- A. Check if there's any pet at home, the PIR supplied in the standard kit is normal one, not pet-immune one.
- B. Please avoid mounting the P.I.R. motion detector at the place where rapid heat changes such as window, air conditioner, light, electric heater, refrigerator, oven, stove etc.
- C. Avoid strong sunlight.
- D. The installation height and range should be in the detection area.

## FCC STATEMENT

1. This device complies with Part 15 of the FCC Rules. Operation is subject to the following two conditions:  
(1) This device may not cause harmful interference, and (2) This device must accept any interference received, including interference that may cause undesired operation.
2. Changes or modifications not expressly approved by the party responsible for compliance could void the user's authority to operate the equipment.

## RF Exposure Information:

This equipment complies with FCC radiation exposure limits set forth for an uncontrolled environment. This equipment shall be installed and operated with minimum distance 20cm between the radiator & body.

This device complies with part 15 of the FCC rules. Operation is subject to the following two conditions:

- (1) this device may not cause harmful interference, and
- (2) this device must accept any interference received, including interference that may cause undesired operation.

**NOTE:** The manufacturer is not responsible for any radio or TV interference caused by unauthorized modifications to this equipment. Such modifications could void the user's authority to operate the equipment.

**NOTE:** This equipment has been tested and found to comply with the limits for a Class B digital device, pursuant to part 15 of the FCC Rules. These limits are designed to provide reasonable protection against harmful interference in a residential installation. This equipment generates uses and can radiate radio frequency energy and, if not installed and used in accordance with the instructions, may cause harmful interference to radio communications. However, there is no guarantee that interference will not occur in a particular installation. If this equipment does cause harmful interference to radio or television reception, which can be determined by turning the equipment off and on, the user is encouraged to try to correct the interference by one or more of the following measures:

- Reorient or relocate the receiving antenna.
- Increase the separation between the equipment and receiver.
- Connect the equipment into an outlet on a circuit different from that to which the receiver is connected.
- Consult the dealer or an experienced radio/TV technician for help

Changes or modifications to this unit not expressly approved by the party responsible for compliance could void the user's authority to operate the equipment.

This device is acting as slave and operating in the 2.4 GHz (2412 ~2462 MHz) band. Ad Hoc function is supported but not able to operate on non-US frequencies.