

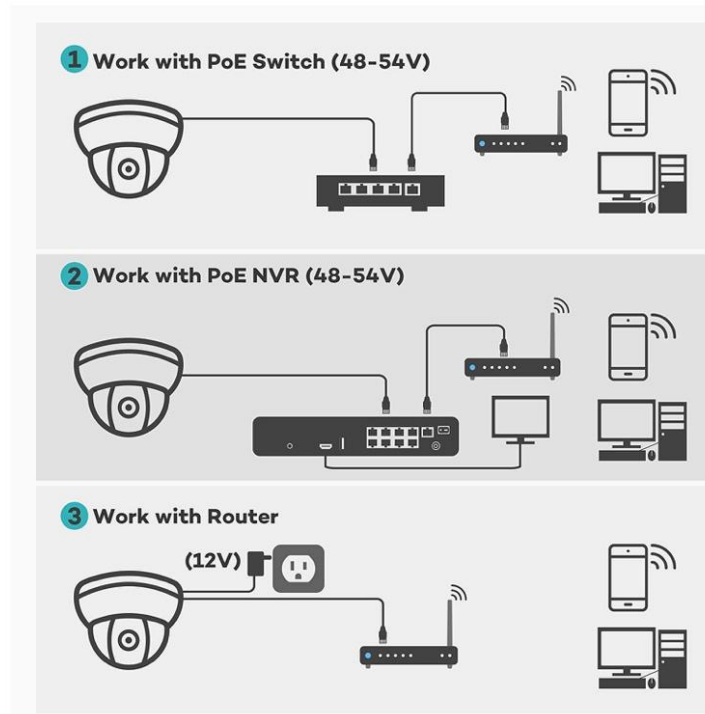

Three Ways To Connect

1. Work With Poe Switch
2. Work With Poe NVR
3. Work With Roter

The advertisement features the Smarth logo at the top left, with the tagline '- Home Automation -'. In the center is a white dome camera. To its left are three blue icons: '5MP', 'ONVIF', and 'SD Card HC/XC 64GB'. To its right are 'GET IT ON Google Play' and 'Download on the App Store' logos. Below the camera are two white boxes: 'works with Google Assistant' and 'WORKS WITH amazon alexa'. On the far right, a hand holds a smartphone displaying the Smarth app interface.



Install Free App

Download APP: scan the QR code below to download and install. Register and login: open the "MySmarth" APP to register and login according to the prompts.



Add The Device -AutoScan mode

Make sure Wi-Fi is available and connected to the Internet.

-Connect the camera to the power, then system startup completed.

-Open "MySmarth" APP, press the '+' in the upper right corner of the main screen;

-Click "Auto Scan" to add camera;

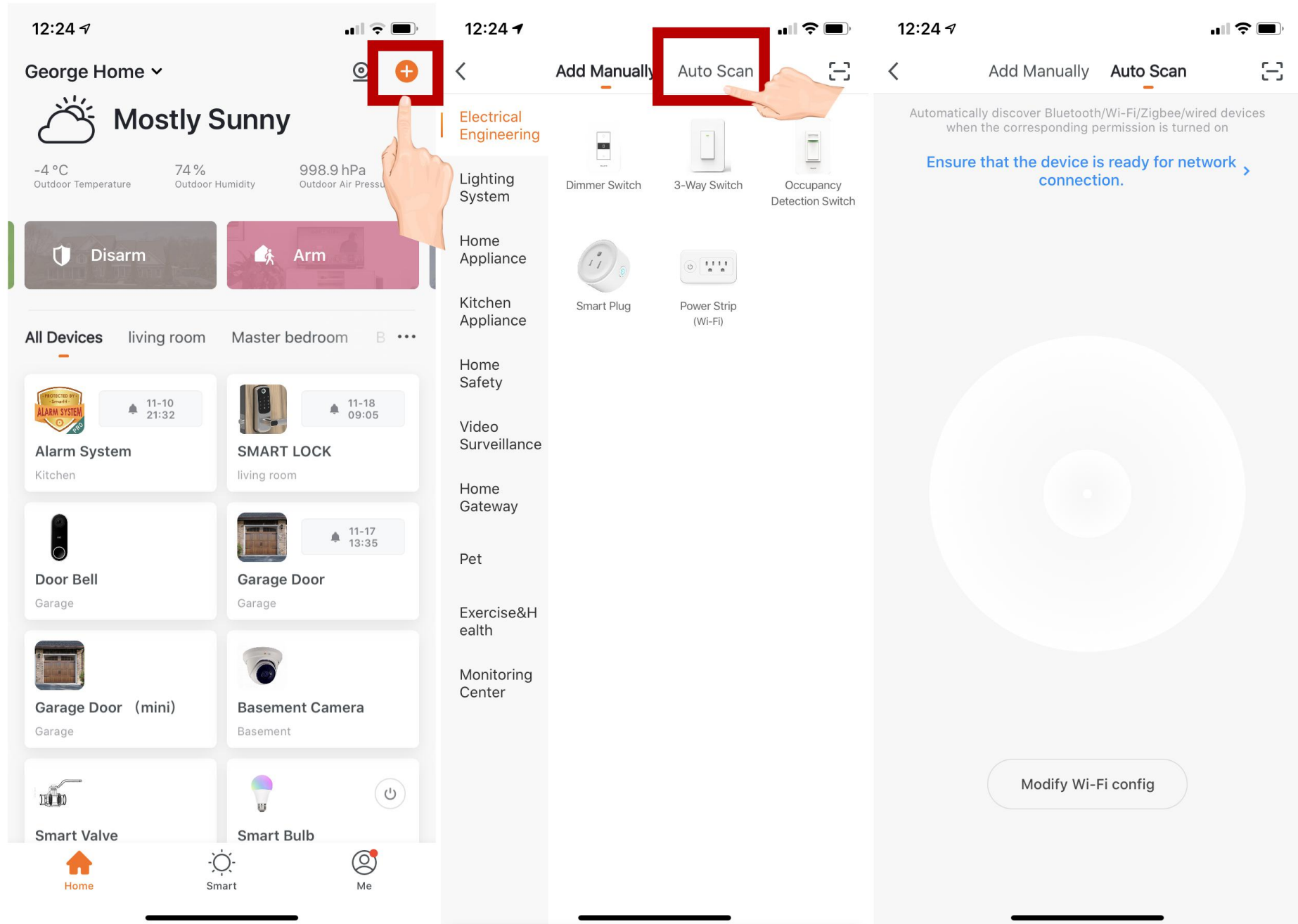

When the progress reaches 100%, connection completed, and click "Done";

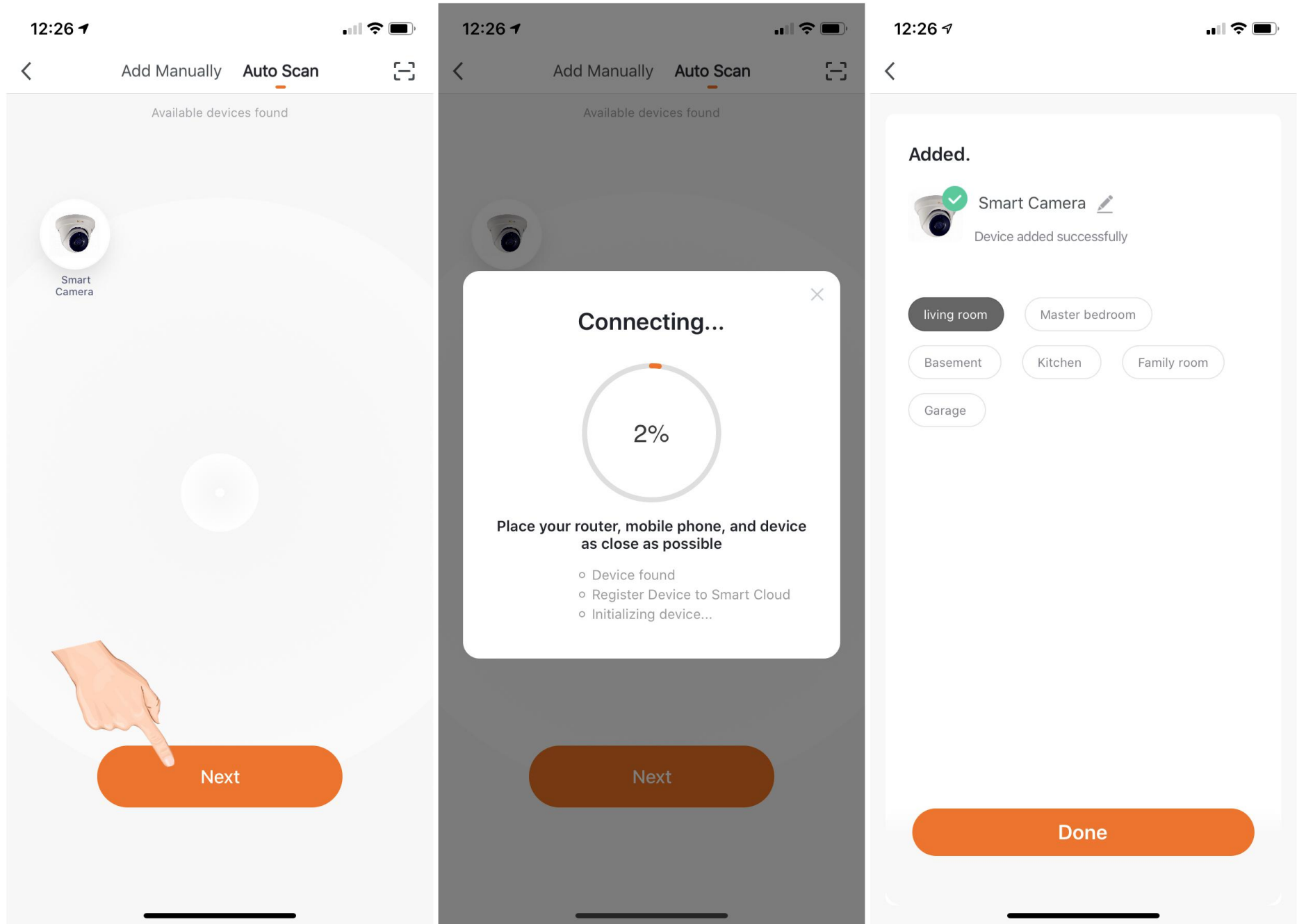

At this time, the connected device will appear on the APP home page . Then you can click directly to the device interface to see the monitoring situation

