



# Smart Lock Box

Installation and Operation Guide



## —Important Notes—

- Please follow the instructions in sequential order.
- Please read all the instructions before contacting customer support.
- You must use 3 AAA Alkaline Batteries, or 2 CR123A batteries (Using the Low Temperature Resistant Holder) .



## —What's in the Box—

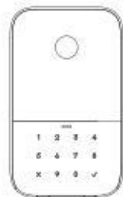

Smart Lock Box x1



Drill  
Template X1



Installation  
GuideX1



Self-Tapping Screw  
15mmX4

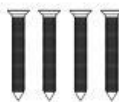

Expansion Bolt  
30mm X4

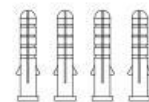

Expansion Screw  
30mmX4



Shackle x1  
(36mm\*36mm\*10mm)

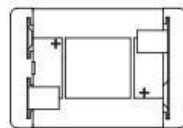

\*Low Temperature  
Resistant Battery Holder x1  
(50.5\*35\*18.mm )

*\*For the replacement of the low temperature resistant battery holder, please refer to 'Replacing the Battery Holder'.*



## —Lock Box Parts—

① Battery Cover Screw

② Battery Cover

③ Screw Driver Groove

④ Screw Hole

⑤ Shackle Screw

⑥ Shackle Hole

⑦ Shackle

⑧ Storage Space

⑨ Box Cover

⑩ Fingerprint Area

⑪ Touch Keypad

⑫ 3M Tape

⑬ Box Base

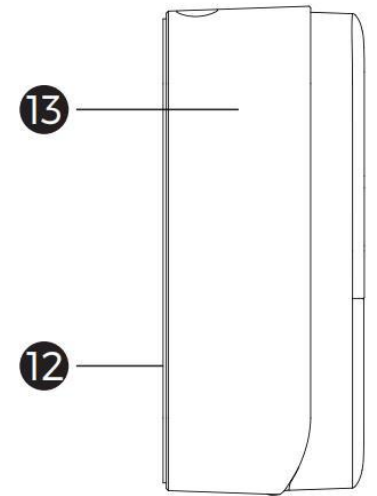
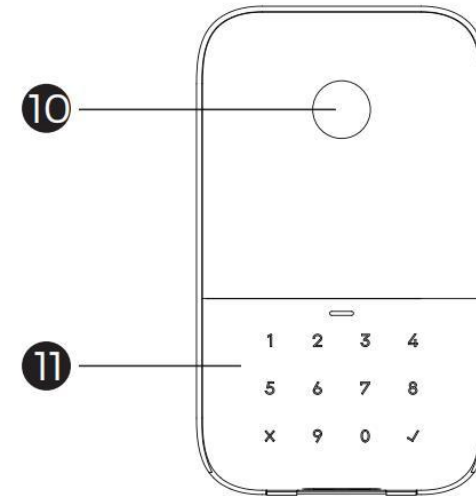
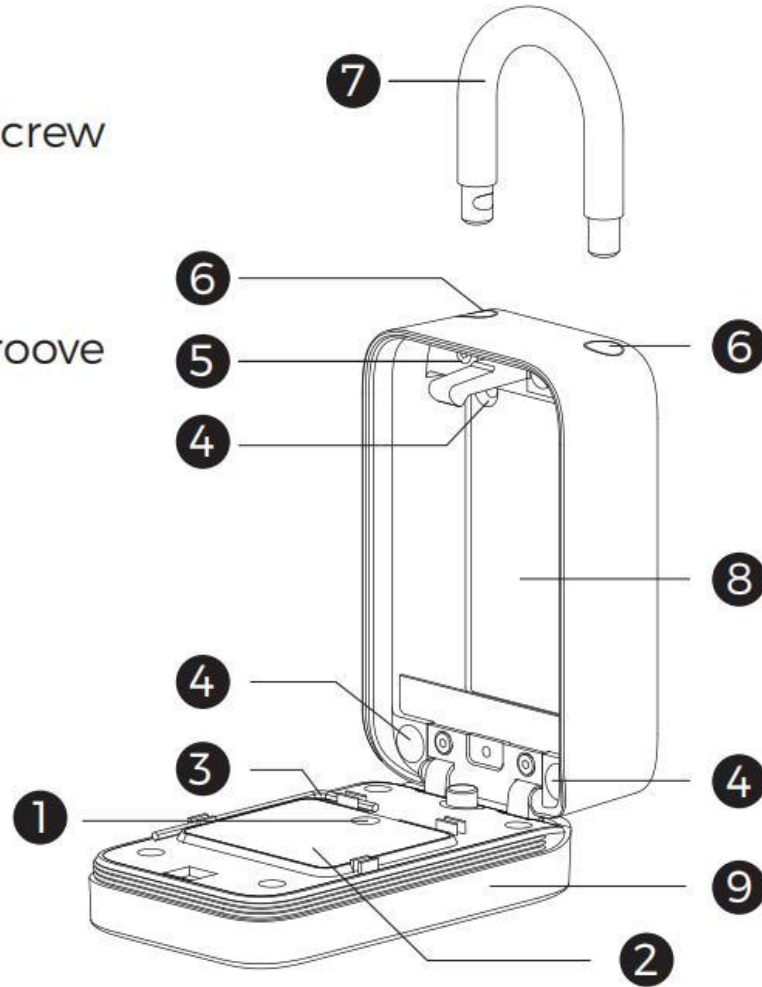

## —Technical Details—

**Style:**K2 (Password)

**Product Dimensions:** L123mm\*W73mm\*H50.6mm

**Shackle Dimensions:** 36mm\*36mm\*10mm

**Box Space:** L98mm\*W63mm\*H25mm

**Access Methods:** K2 (Password): Smart Phone, Password

**Storage Capacity:** K2 100 PCs of Passwords

**Power Supply :** 3 AAA Alkaline Batteries or 2 CR123A Batteris

**Battery Life:** Up to 12 Months (Unlock 10 times a Day)

**Box Material:** Aluminum Alloy

**Emergency Power Supply Interface:** Type-C

**Operation Temperature:**

3 x Alkaline AAA Batteries: -4 °F ~ 158 °F (-20°C to 70°C)

2 x CR123A Batteries: -40 °F ~ 158 °F(-40°Cto70°C)

# —Install the lock Box—

## 1.Installation Guide

### 1.1 Determine your Installation Type

SURFACE	INSTALLATION TYPE	DRILL BIT NEEDED
Cement Brick Concrete Stone	Expansion Bolt +Expansion Screw	Ø 6 drill bit
Wood	Self-tapping Screw	/
Glass	3M	/

*\*Concrete can be challenging for drilling. If you are not experienced with drilling into our particular type of concrete, you may want to consider a professional installation.*

*\*\*Depends on the subsurface. Test drill a very small pilot hole to determine the surface to which you are ultimately fastening. Hard subsurfaces may require a masonry drill bit.*

## 1.2 Wooden door/Self-tapping Screws

**Step 1.** Use the drill template to position 4 drilling points on the door.

**Step 2.** Open the lock box, align the drill holes with the screw holes on the box.

**Step 3.** Secure it with 4 self-tapping screws.

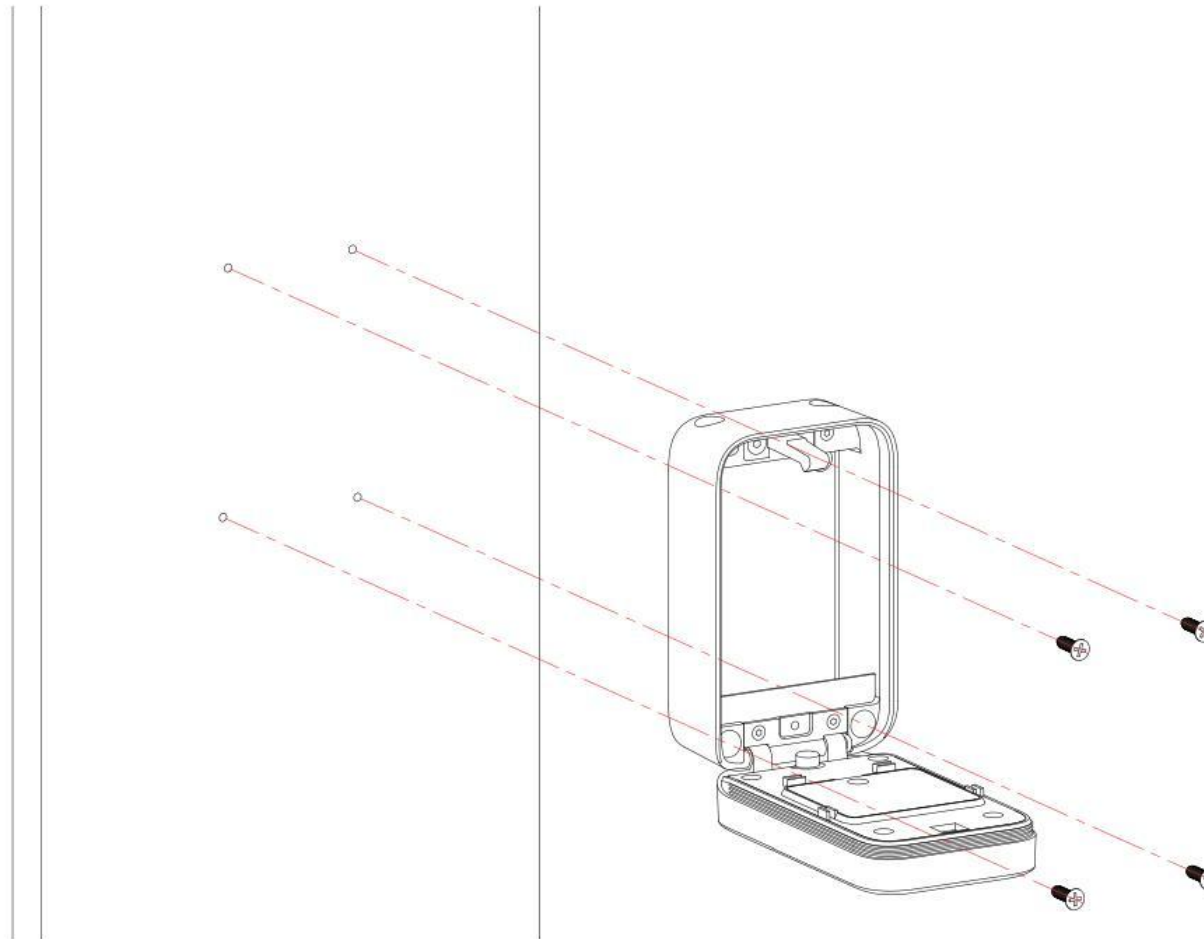

## 1.3 Cement, concrete, brick , stone/Expansion Screw

**Step 1.** Use the drill template to position 4 drilling points on the wall.

**Step 2.** Drill the marked holes with electric drill (30mm depth), insert the expansion bolts.

**Step 3.** Open the lock box, align the drilling holes and the screw holes on the box, insert the expansion screws into the expansion bolts.

**Step 4.** Tighten the screws.

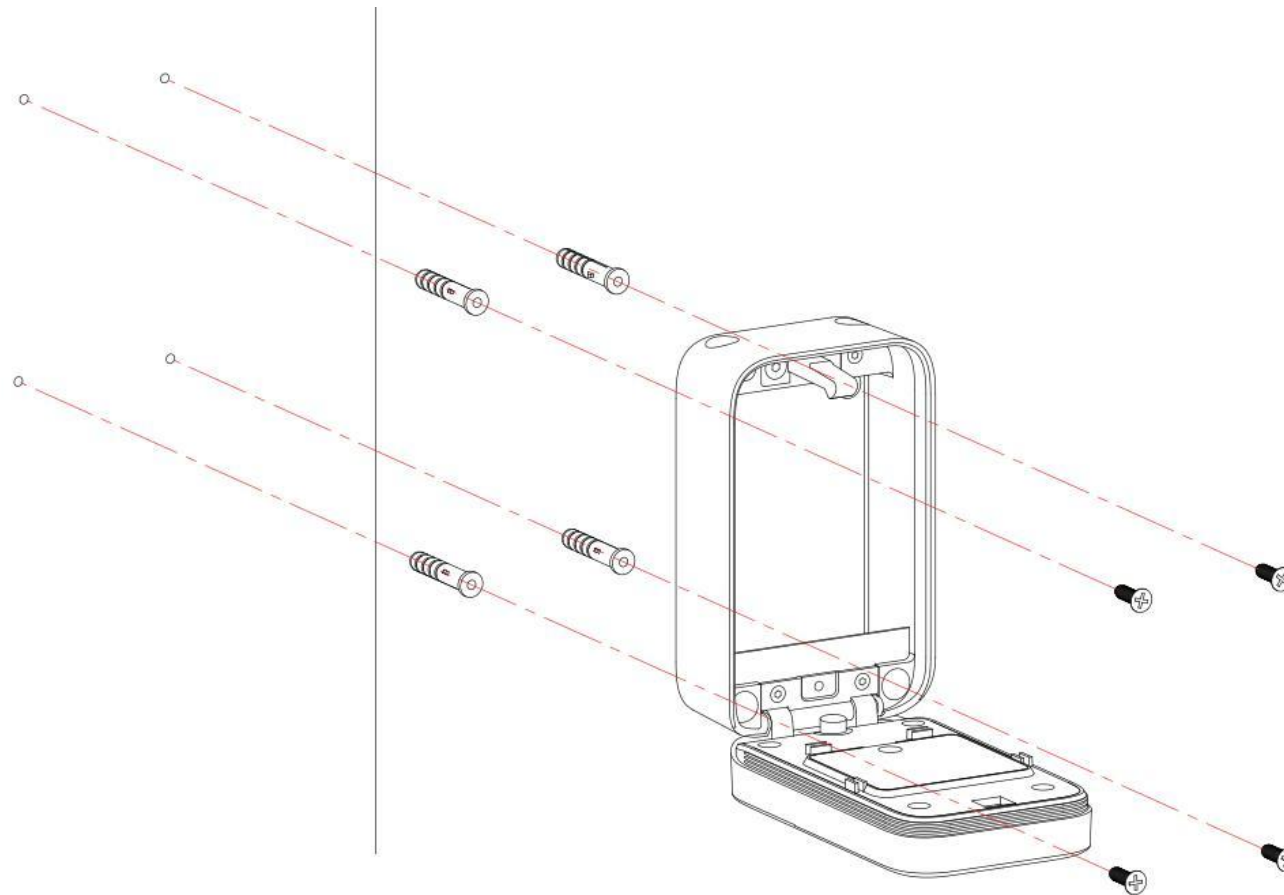



## 1.4 Handle/Shackle

**Step 1.** Open the lock box, take out the 2 screws used to fix the rubber plug (or shackle).

**Step 2.** Take out the 2 rubber plugs.

**Step 3.** Fix the shackle on the lock box, tighten it with the 2 screws you took out before.

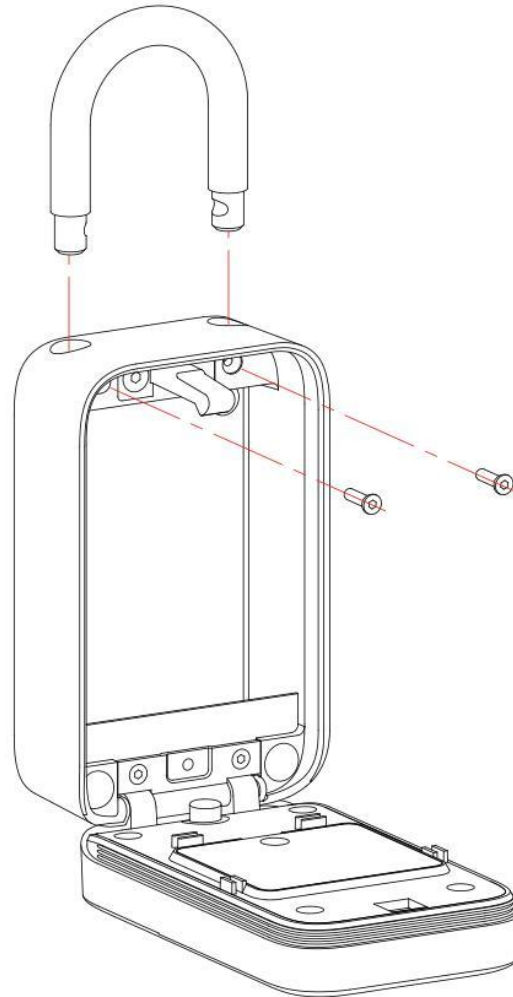

## 1.5 Stick

**Step 1.** Peel off the covering of the 3M tape on the back.

**Step 2.** Confirm the glass door/surface you would like to stick. (Keep it clean)

**Step 3.** Press the lock box into the surface,

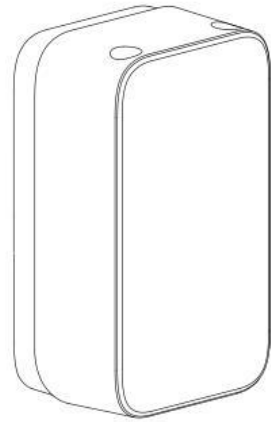

—Use the lock Box—

## Install Free App

Download APP: scan the QR code below to download and install. Register and login: open the "MySmarth" APP to register and login according to the prompts.

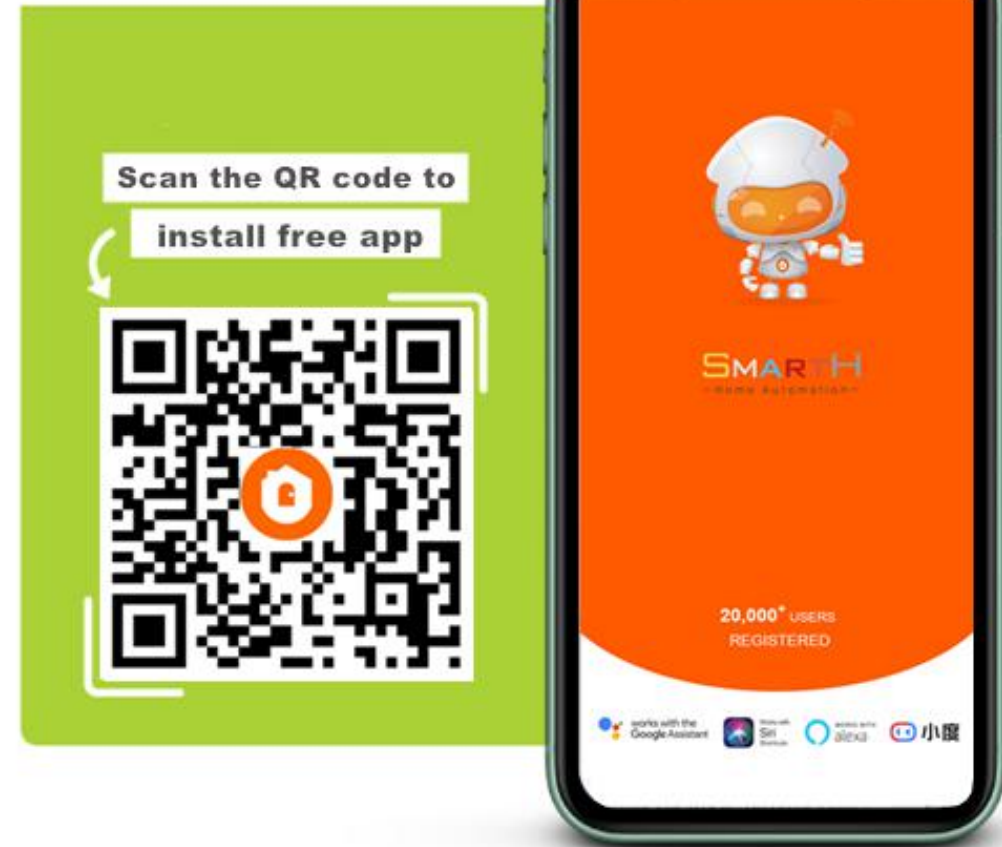

## 2. Match

PLEASE NOTE: Make sure the Bluetooth on your smart phone is on, and stay near the lock box (within 10 feet / 3 meters).

1. Open the APP and click the following

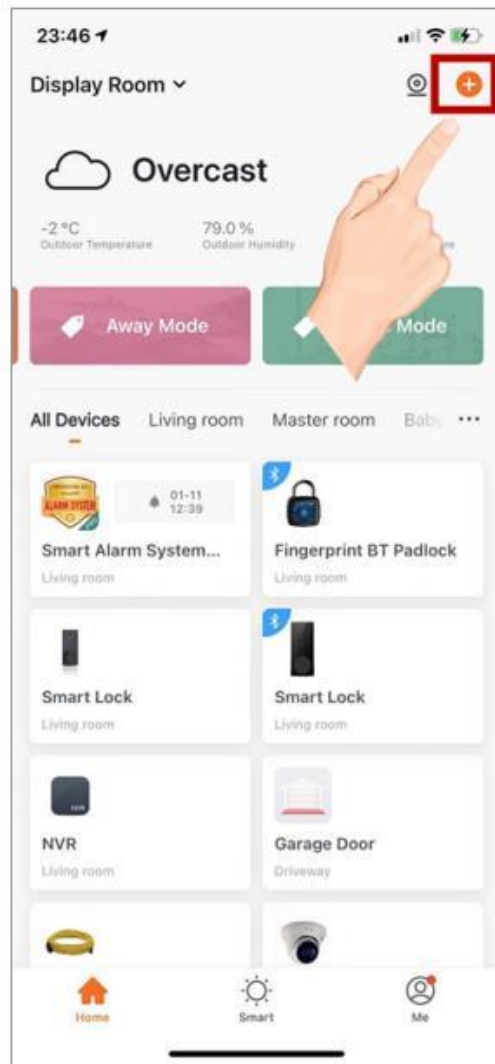

2. Press the fingerprint reader to call back the device. Press the button, Add new device.

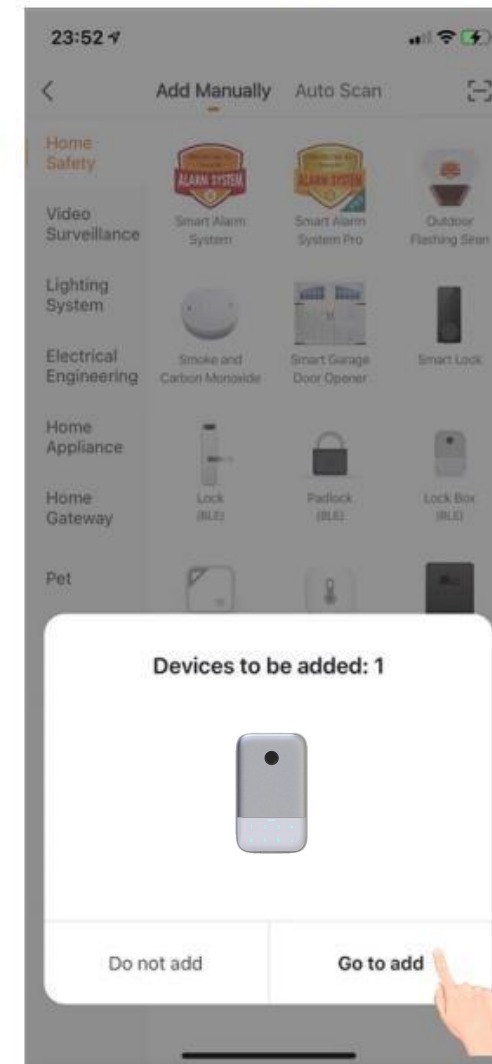



### 3. Choose

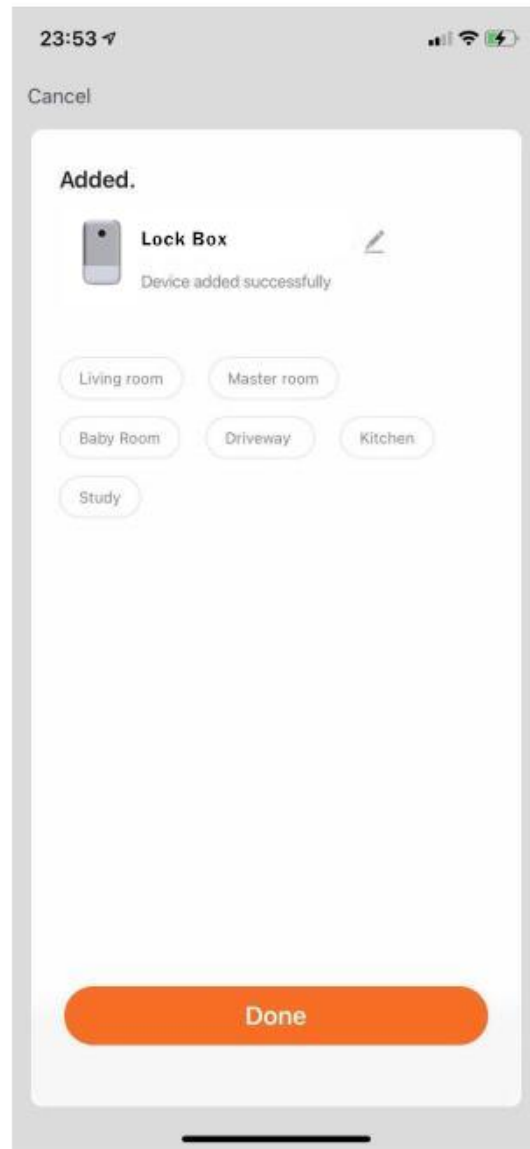

### 4. ICONS

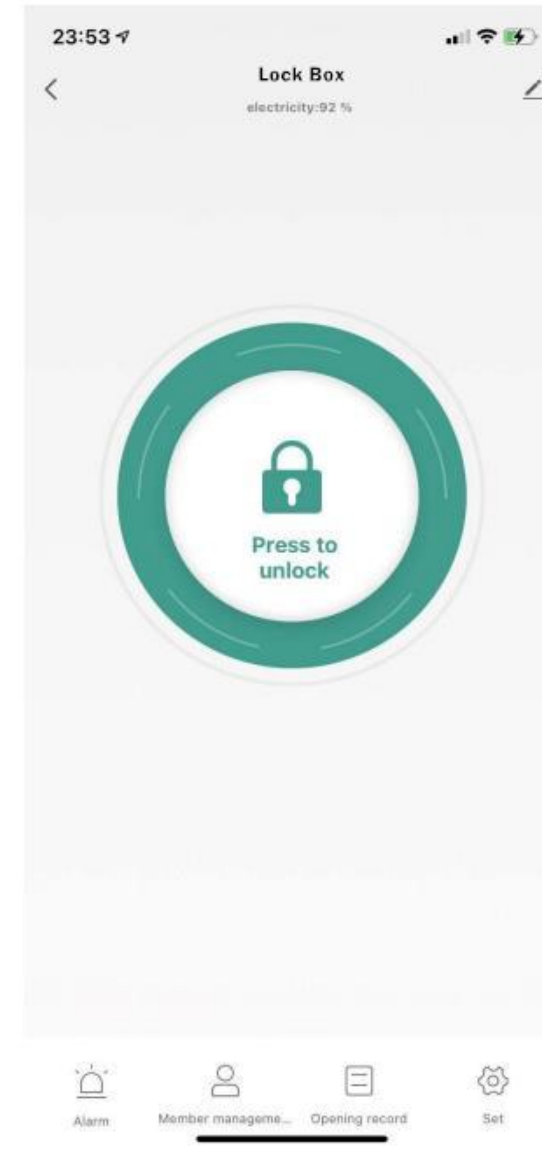
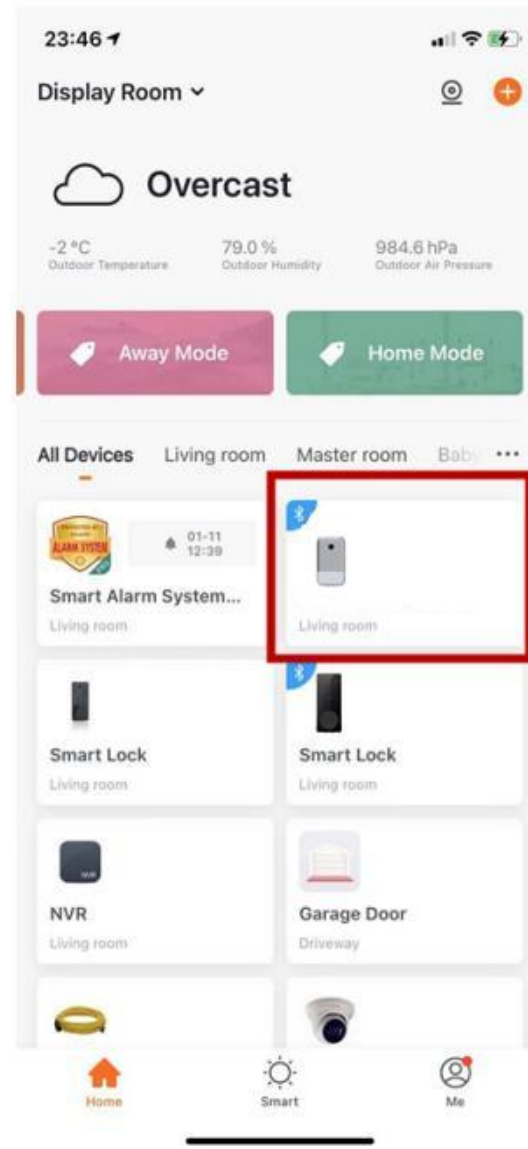

# Password Setting

Password Touch Board: 0-9, ×, √.

Permanent Password :6-10 numbers, valid until you delete.

**Step 1:** Select the device on the “**Home**” page and go to “**Set**” page.



**Step 2:** Tap “**Password Management**” on the top right-hand corner, and choose “**Add password**”.



**Step 3:** Select the user you would like to add permanent password, and set the password.

## **Time-code password:**

One-time password: 6-10 numbers, set the start and end time for one-time use.

Periodic password: 6-10 numbers, set a schedule time for routine visit.

## **Dynamic password:**

10 numbers, can be generated offline, valid within 5 minutes.

## **Anti-peep password:**

unlimited number + permanent password + up to 9 numbers.

# Smart Phone Unlock

## **Step 1**

Select the device on the “Home” page and click in.

## **Step2**

Tap “Click to Unlock” , and choose “ Confirm” to unlock.



# Lock Status

**Low battery status:** Yellow light blink 2 times.

**Operation Failed:** Red light blink 2 times, buzz 2 times.

**Error Lock:** Red light blink 5 times.

**Box Unclosed Alarm:** Buzz 5 times, 2 seconds at a time.

## —Replacing the Battery Holder—

Note: The factory default installation of the product is 3 AAA battery holders. If you want to use the product in a low temperature environment, please replace it with the low temperature resistant battery holder and use 2 CR123A batteries.

The specific operation for replacing the battery holder is as follows:

### **Step 1**

Open the battery cover and take out the batteries inside.

### **Step2**

Pull out the battery connector carefully.

### **Step 3**

Take out the original battery holder.

### **Step4**

Insert the connector of the low temperature resistant holder.

### **Step5**

Install the low temperature resistant holder.

(Please pay attention to the battery wiring harness when installing.)