

# Smart Lock

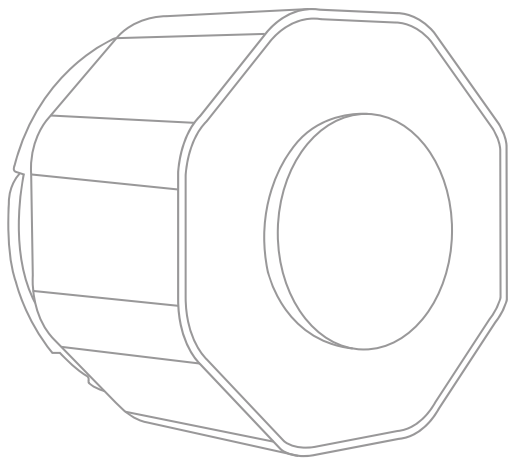

Installation Instruction

1. Buttons

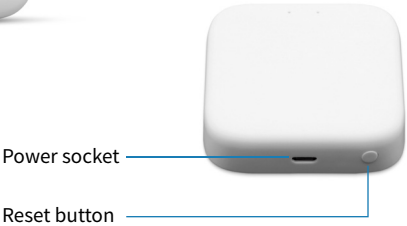
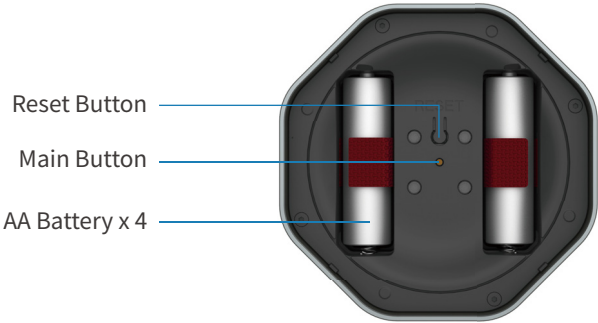
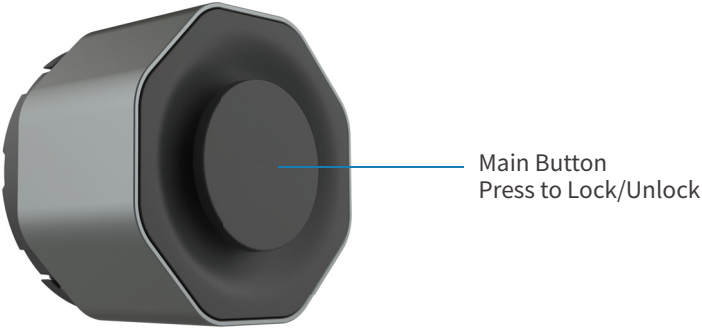

## 2. (1) In the box

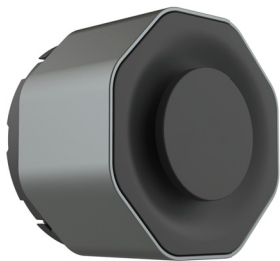

Smart Lock x 1



Lock Adapter x 4



AA Battery x 4



Wi-Fi Gateway x 1



Adhesive Strip x 1

## (2) Tools you will need



Phillips Screwdriver

### 3. Installation - Smart Lock

#### Installation Requirements:

To install your Smart Door lock, please make sure that your current deadbolt is a single-cylinder deadbolt. Double-cylinder, euro-cylinder, mortise, and low-profile single-cylinder deadbolts are not compatible.

**While installing or using the Smart Lock, please avoid turning the Smart Lock too fast or with too much force, or it may cause irreversible damage to the motor.**

#### (1) Fix the deadbolt in place

Use the adhesive strip in the box to fix the exterior (outdoor) part of the deadbolt, in order to prevent it from falling when the thumbturn is removed.



#### (2) Remove the thumbturn

Make sure that the deadbolt is in locked position. Unscrew both screws and remove the thumbturn from the deadbolt. Keep the screws handy for the next step. If there is an additional plate, remove it as well.

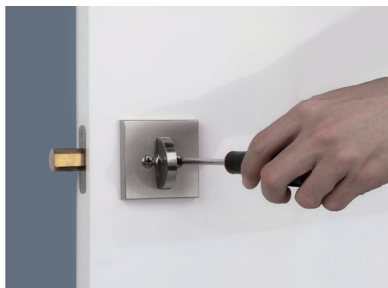

### (3) Remove the base plate

Open the latches to remove the base plate.

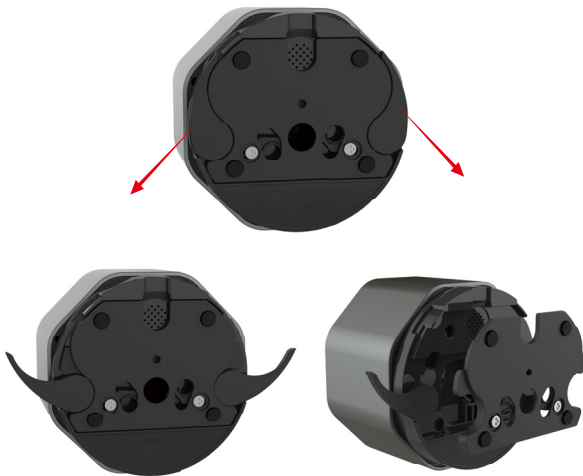

### (4) Place the base plate over the deadbolt

Insert the two screws into the screw holes from the front of the base plate. Match both screws to the screw holes on the deadbolt. Please make sure that the base plate's back side is against the door, i.e. the bottom part of the base plate should be flush with the door.



### (5) Mount the base plate

Adjust the base plate so that the tailpiece goes through its center hole. Tighten the screws to fix the base plate on the door. Please do not over-tighten the screws as it may damage the door.



### (6) Select the correct adapter

A. If the deadbolt has an arch-shaped tailpiece, please use the arch-shaped adapter.

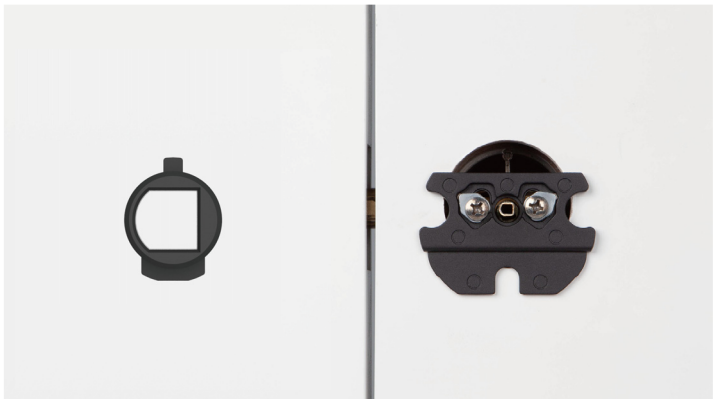

B. If the deadbolt has a thick, rectangular tailpiece that is upright or level while the door is locked, please use the shorter and thicker rectangular adapter.

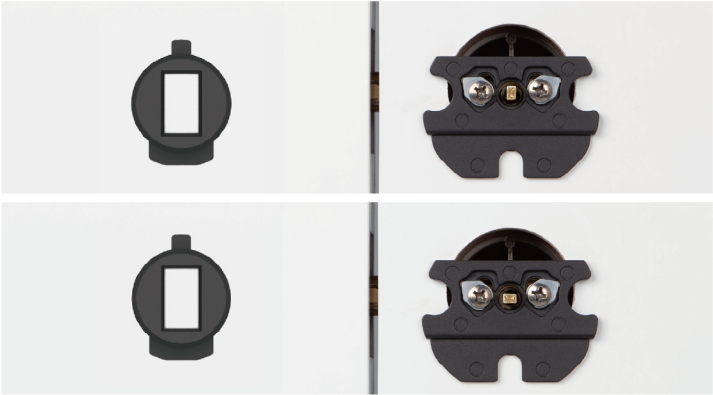

C. If the deadbolt has a thin tailpiece that is upright or level while the door is locked, please use the "+" shaped adapter.

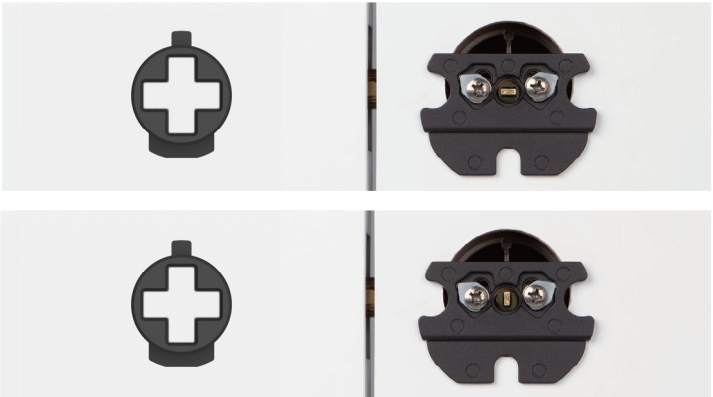

D. If the deadbolt has a thin tailpiece that is angled while the door is locked, please use the angled rectangular adapter.



Select the correct adapter based on your deadbolt's tailpiece. If the adapter fits the tailpiece but does not fit in smart lock's motor, flip the adapter and try again. Place the adapter in the motor.

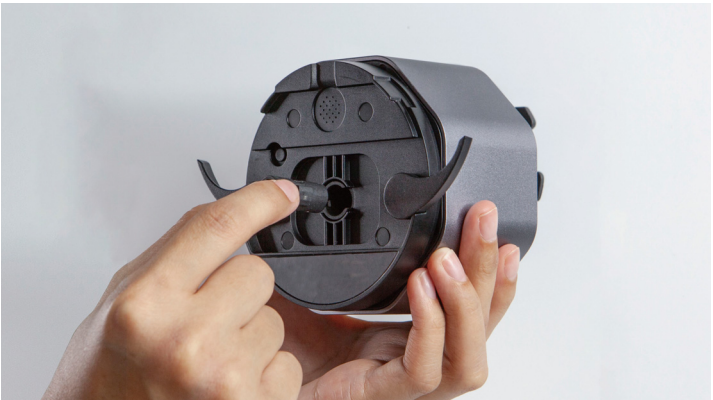



## (7) Check the deadbolt's locking direction

Looking out from inside of the door, if the bolt is at the left side of the door, then it locks counterclockwise; if the bolt is at the right side, then it locks clockwise.

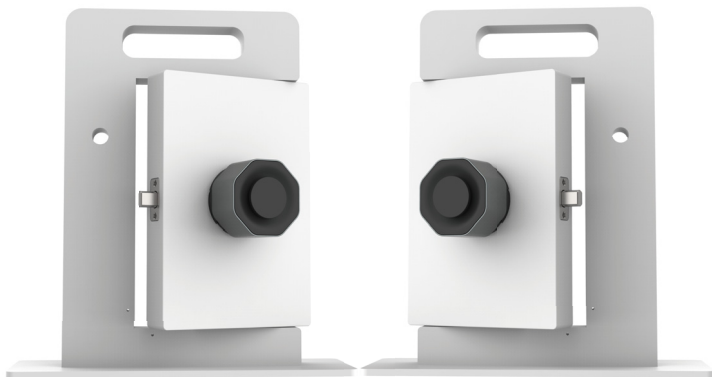

Counterclockwise

Clockwise

## (8) Turn Smart Lock to the locked position

If the deadbolt locks counterclockwise, gently turn Smart Lock counterclockwise till the end; if the deadbolt locks clockwise, gently turn Smart Lock clockwise till the end.

Note: Stop turning once you feel a strong friction turning further. Do not force-turn Smart Lock as it may cause severe damage to the motor.

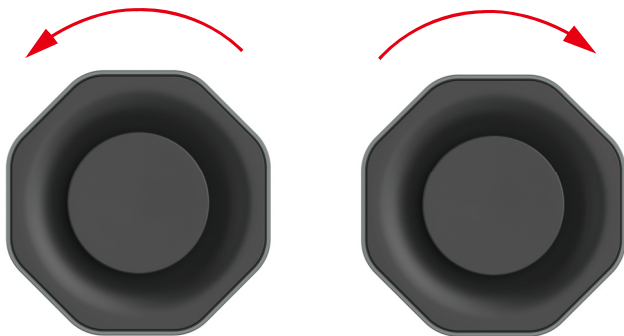

Counterclockwise

Clockwise

## (9) Install Smart Lock

Make sure that the door remains locked. Open both latches on the back of smart lock, and mount smart lock on the base plate. Make sure that the adapter fits on the tailpiece and there is no gap between the base plate and smart lock. If the adapter can't be placed on the tailpiece, turn the smart lock until the adapter can fit on the tailpiece. Finally, close the latches so that smart lock is secured on the base plate.



## (10) Power on Smart Lock

Take off Smart Lock's front cover, and insert 4 AA batteries into the battery slots. After that, you should see a white light flash once, indicating that Smart Lock is powered on. Then, place the front cover back.

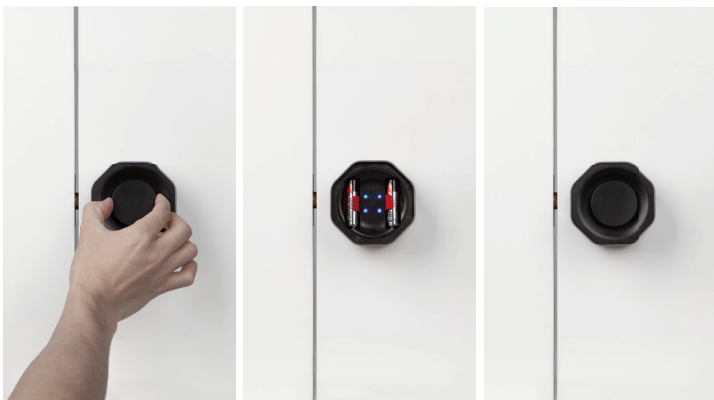

## (11) Set up smart lock in the APP

Follow the quick start guide below to add smart lock to your account.



### Quick Start Guide

1. Follow the installation instruction to install Smart Lock on your door.
2. Download the App from Google Play or App Store.
3. Log in to the app or create a new account.
4. Tap the "+" button at the top right corner of the home screen.
5. Select "Auto Scan" and follow the instructions on screen to complete the setup.
6. The app will redirect you to calibrate the Smart Lock on the first time you use the Smart Lock, or when the Smart Lock is reset and re-added in the app.

**Note:** To recalibrate the Smart Lock, go to Smart Lock's home screen "more and more" -> "Guide the operation" to start calibration.

## 4. Installation - Gateway

- (1) Tap the "+" button at the top right corner of the home screen.
- (2) Select "Auto Scan" and follow the instructions on screen to complete the setup.
- (3) Tap "Wireless Gateway (BLE)" (hereafter referred to as "Gateway") on the app's home screen
- (4) Tap "add device by list", and follow the instructions to add the Smart Lock.
- (5) Additional Gateway Indicator Information

Green: Bluetooth Status

- Blinking: waiting for pairing
- On: Connected
- Off: Not connected

Red: Wi-Fi Status

- On: Connected
- Blinking: waiting for connection
- Off: Wi-Fi configured, but unable to connect

To reset: long-press the button for 5s until you see the red light flash a few times.

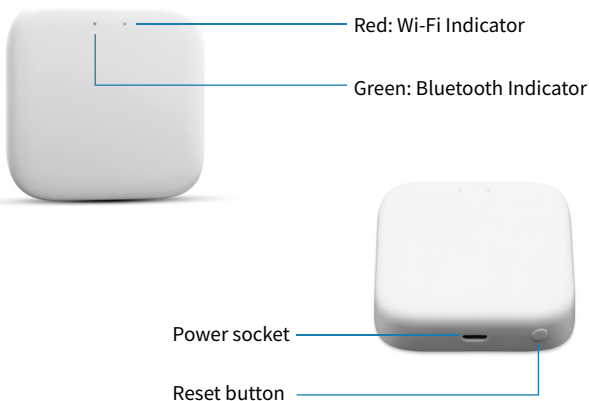

### (6) Application of Gateway

The Bluetooth gateway can connect the smart Door Lock to internet and enables internet-based features, including, Remote Unlock, Notifications, Guest Access.

