



TRANSWESTERN

REAL ESTATE
SERVICES

**CROSTOWN CIRCLE
BUILDING**
10200 - 224 CROSTOWN CIRCLE

SPACE AVAILABLE

CROSTOWN CIRCLE BUILDING

PROPERTY SUMMARY

- LOCATION:** 10200-10224 Crosstown Circle
Eden Prairie, MN 55344
- BUILDING SIZE:** 73,881 sf
- CONSTRUCTION:** Tilt up panel
- LOADING:** 5 dock doors | 2 w/ levelers
3 - 12' x 14' drive-in doors
- CLEAR HEIGHT:** 18' w/ LED lighting upgrades
- POWER:** 200 amps - 120/208 volt/bay
100 amps - 480 volt/bay
Additional 2,000+ amps of 480 volt
3 phase power available
- HIGHLIGHTS:** Office/manufacturing/warehouse facility
Located in the highly desirable Golden Triangle
Entire space painted, prepped and ready to go!
Local management + ownership

AVAILABILITY

- SUITE C:** 21,858 sf total
1st Floor: 18,327 sf warehouse
2nd Floor: 3,531 sf office + production/mezz
- ASKING RATES:** Negotiable
- CAM + TAXES:** \$4.39 psf 2024 est.

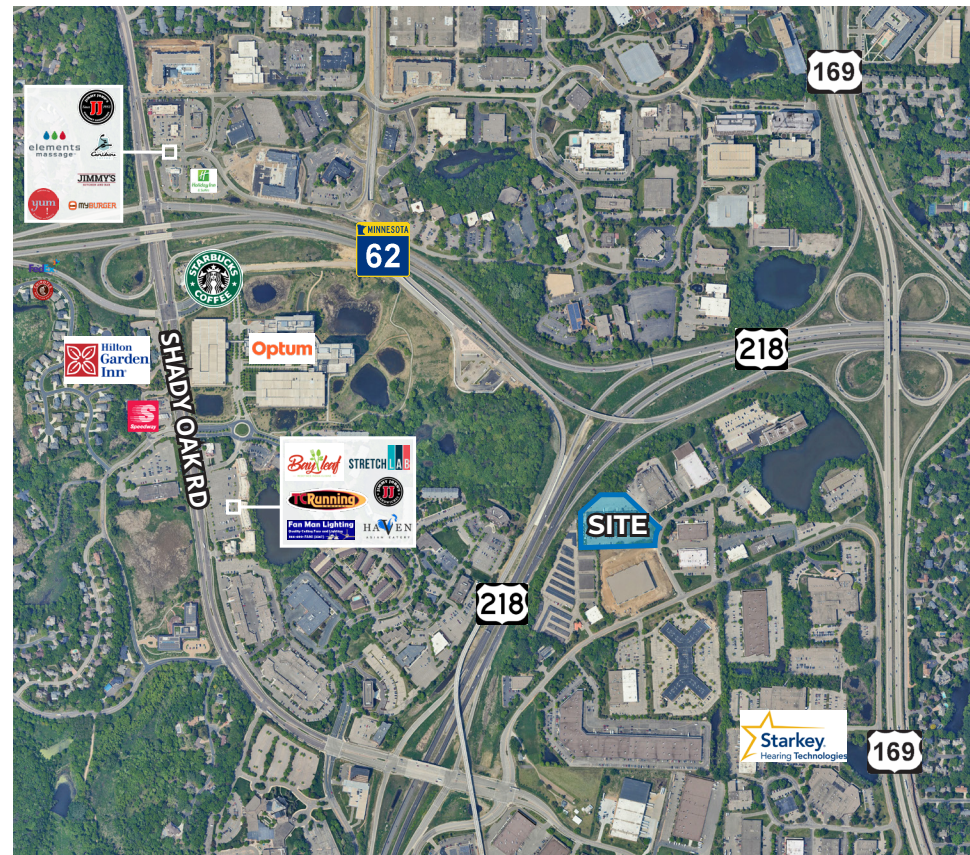

for information
CONTACT

Russ Crawford • 612 741 4800 • russ.crawford@transwestern.com
Patrick Crawford • 612 615 1244 • patrick.crawford@transwestern.com

TRANSWESTERN REAL ESTATE SERVICES

SITE PLAN

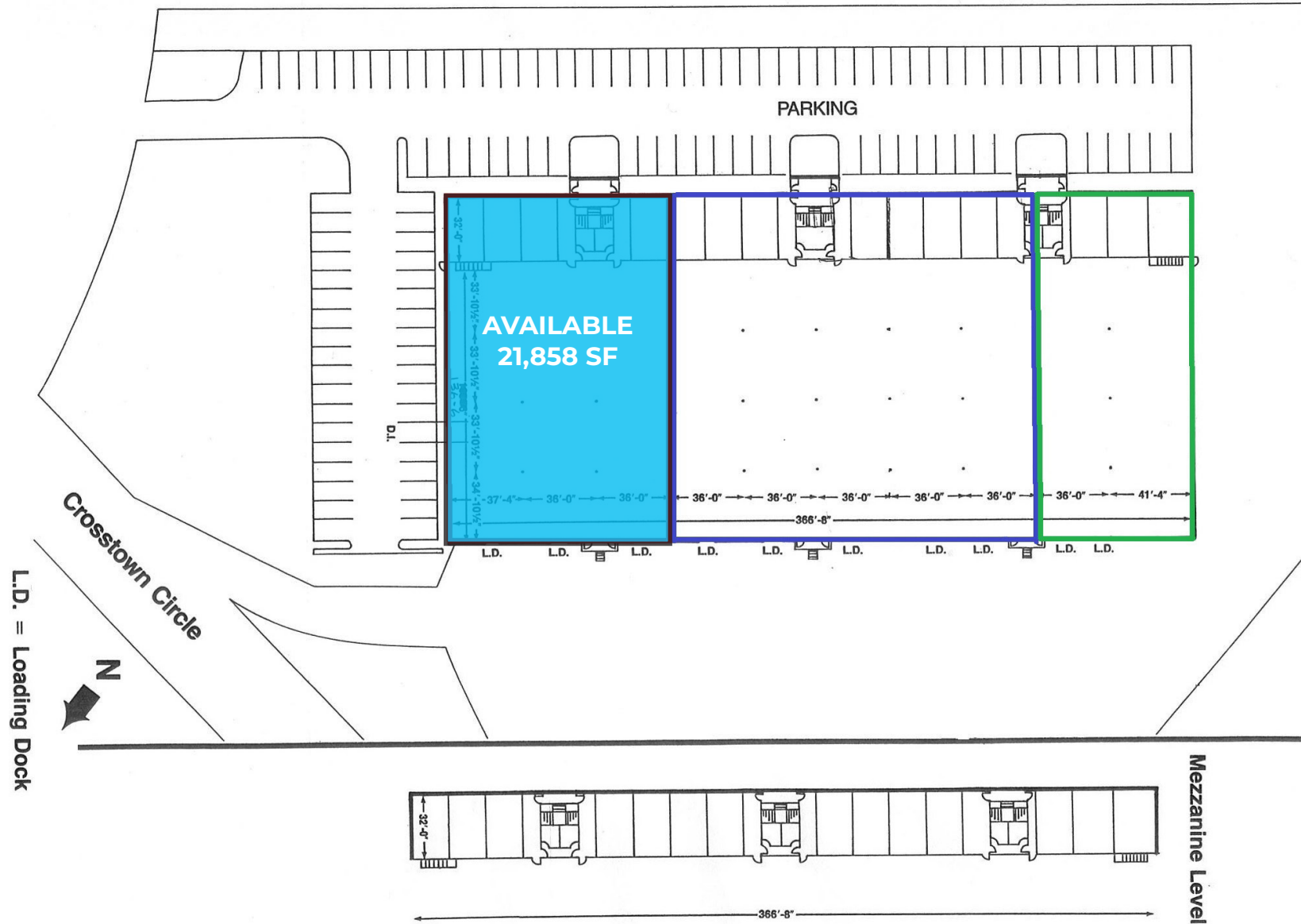

for information
CONTACT

Russ Crawford • 612 741 4800 • russ.crawford@transwestern.com
Patrick Crawford • 612 615 1244 • patrick.crawford@transwestern.com

TRANSWESTERN REAL ESTATE SERVICES

FLOOR PLAN

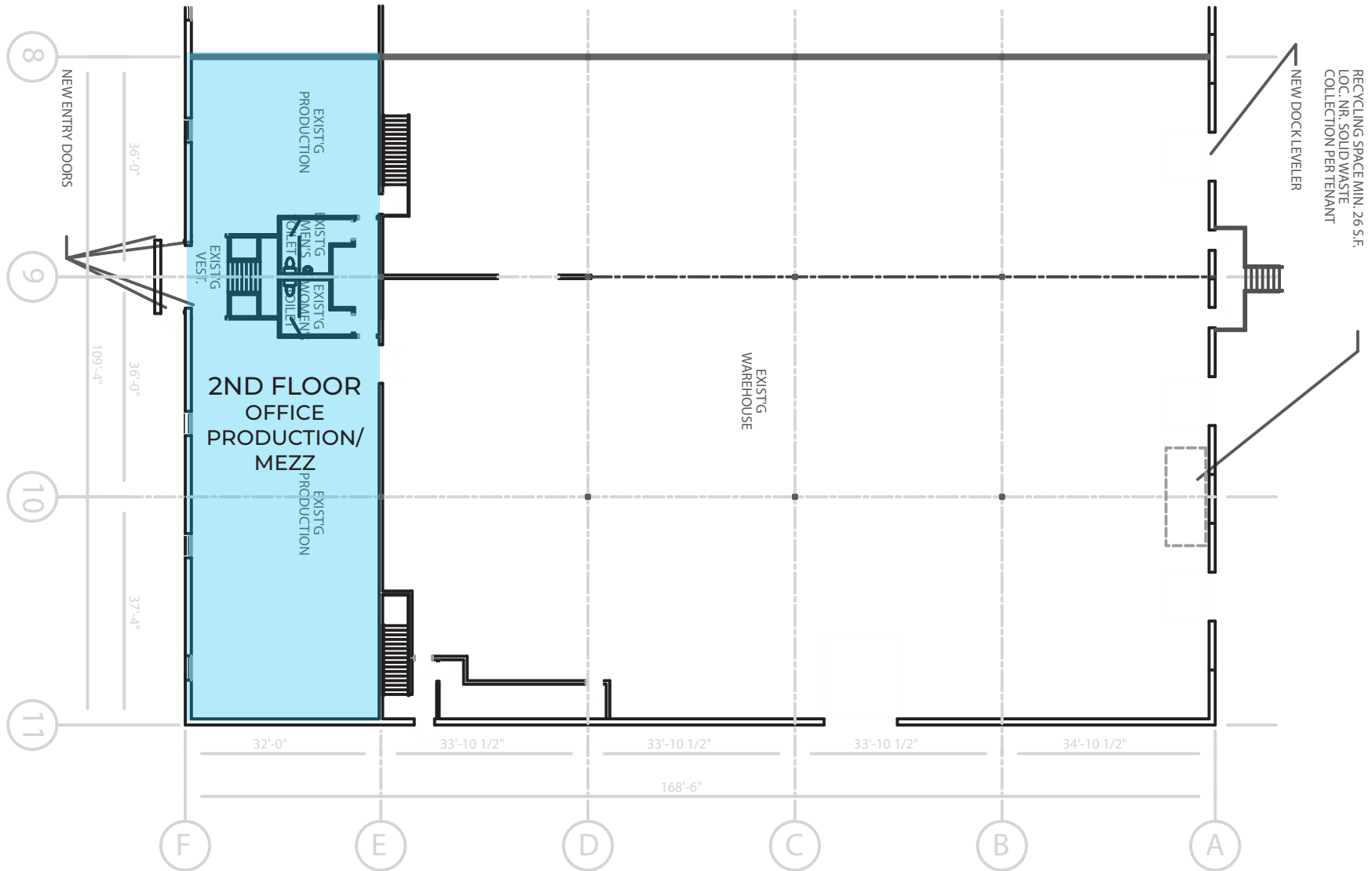

**for information
CONTACT**

Russ Crawford • 612 741 4800 • russ.crawford@transwestern.com
Patrick Crawford • 612 615 1244 • patrick.crawford@transwestern.com

TRANSWESTERN REAL ESTATE SERVICES