

# Cutting edge washing systems for catering establishments

Design, technology,  
functionality - the three  
key elements that allow  
Comenda to offer superior  
washing solutions to meet  
the latest hygiene  
requirements  
in the world of  
professional catering.

company profile



**COMENDA**  
the environmentally friendly brand



## The Italian parent company of an international group

As the parent company of the whole Ali Group, Comenda offers professional washing machines rigorously “**Made in Italy**” according to the highest quality standards.

The company has quickly established itself among the **industry leaders in Europe and the world**, producing and marketing **over 200 different solutions** ranging from small-sized cup and glass washers for bars to large, automated, continuous feed systems for restaurants, hospitals, canteens and inflight catering. Its great operational flexibility also allows Comenda to supply **tailor-made systems**, designed to meet individual space and operation requirements, without any limits on processing capacity.





# Comenda



## Nature-friendly evolution

Comenda has always operated with an **eco-conscious approach** based on the greatest respect for the environment. This has allowed the company to achieve outstanding results in reducing consumption. In fact, Comenda products have **extremely low running costs**, thanks to minimal use of water and detergent during the washing cycle and to low energy consumption, while maintaining hygienic efficiency. The machines are also designed to create **comfortable working environments**, thanks to technical solutions that reduce noise levels and heat emissions.



**1963**

Luciano Berti founds Comenda (a name based on the acronym of Costruzioni Meccaniche Industriali), a company specialised in the professional dishwasher industry.

**1970**

Comenda needs to expand its facilities: the new Cassina De' Pecchi site is built on a 20,000 square metre plot, including offices and a production plant that designs and builds new machines.

**1971**

Comenda France is born in Paris. Within two years, Comenda conquers the French market, which buys 30% of its production.

**1977**

With a commitment to respect the environment and save energy in its operations, the company creates the first prototype of a heat pump dishwasher.

# A history of innovation

A great adventure that began **in 1963** when **Luciano Berti** **decided to invest in the burgeoning sector of professional dishwashers**. A successful enterprise that also led to the establishment of the Ali Group, one of the world's leading foodservice equipment companies. **A long history based on innovation, built by many people** who, through their hard work and commitment, have contributed to creating a solid company which has quickly established itself worldwide.

**1992**

The company takes a further step forward in its policy to care for the environment by launching the ECO2 programme, based on saving energy and respecting the environment.

**2007**

Comenda reviews and improves its internal processes and achieves the ISO9001:2008 quality certification issued by the prestigious German TÜV.

**2011**

Comenda requests and is awarded the ISO14001:2004 environmental system management certification.

**2013**

The AC3 Multirinse dishwasher wins the SMART LABEL, a major award presented by Host Fiera Milano with POLI.design. The Multirinse® system receives the prestigious Grand Prix Sirha de l'Innovation 2013 in the "Materials & Concepts" category.

# Ten good reasons to choose us

The development of innovative solutions designed to improve the work of operators, ensuring a perfect balance between **cost containment and maximum efficiency**, has always been an essential part of Comenda's production activities. For this reason, **the company constantly invests in research** and can count on **highly skilled staff**. This integration of technology and know-how has proved to be a great competitive strength internationally for the past 50 years, and is the reason why many different professional catering establishments across the world continue to choose the Comenda brand.



MORE THAN FIFTY YEARS OF EXPERIENCE		.01
PRODUCTS MADE IN ITALY		.02
TECHNOLOGICAL INNOVATION		.03
ECO2: ENVIRONMENTALLY-FRIENDLY AND COST-EFFECTIVE OPERATION		.04
FULL RANGE OF PRODUCTS		.05
BESPOKE SOLUTIONS		.06
NATIONAL AND INTERNATIONAL CERTIFICATIONS		.07
ALL-ENCOMPASSING SERVICE		.08
ONGOING SUPPORT		.09
EASE OF USE		.10

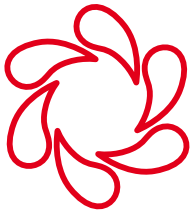

COMENDA

.01 |

# INNOVATIVE SINCE 1963

A long journey that began in 1963, marked by significant innovation milestones. Two in particular: in **1976** the first **heat pumps** were fitted, in **1987** the **first multiple rinsing systems were installed**. Many devices have been developed over time to reduce consumption - suffice to say that 30 years ago you would have needed 600 litres of water an hour to wash and rinse dishes, now all you need is 100. About 1/6 of the water, but also 1/6 of the detergent and 1/6 of the electricity.

# MAXIMUM QUALITY, AT ZERO KM

One of the key aspects of the company's policy has been its **choice of suppliers**: they are all **Italian companies** operating within a radius of a few hundred kms of the production plant in Milan.

This allows the company to make **zero km products** and ensure **better quality control** of the components installed in its machines.

Comenda dishwasher tanks, for example, are made using deep drawing technology: a **very high tech precision technology** that is the prerogative of only a few Italian companies in the world.

The Comenda philosophy is therefore a concrete expression of how the highest standards of quality can be offered by promoting local excellence.

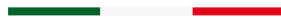





.03

# INNOVATION THAT LOVES THE ENVIRONMENT AND SAVES ENERGY

Comenda is always at the forefront of technological innovation and offers a series of devices designed to optimise energy consumption, ensuring maximum efficiency. **MULTIRINSE®** is a **patented rinsing technology** which dramatically reduces the use of water, detergent and electricity. **The exclusive PWS system allows consumption to be optimised and operation cycles to be customised.** **The CRC** is a steam condenser and heat recovery system that **cuts energy consumption by up to 35%.** **The patented PRS®** (Proportional Rinse System) and its advances, **the APRS®** (Automatic Proportional Rinse System) in turn ensure a **saving of up to 33%** to be achieved in the use of water, energy and chemicals.



LESS WATER,  
HIGHER PERFORMANCE



LESS ENERGY,  
HUGE SAVING



LESS CHEMICALS,  
GREENER WORLD



.04 |

# ECO2: ENVIRONMENT AND ECONOMY FOR DOUBLE THE PERFORMANCE

Based on its “green” philosophy, Comenda continues to devise solutions to ensure excellent performance, maximum hygiene and the best working conditions for operators, with a constant focus on protecting the environment and its resources.

**The ECO2 programme actively contributes to limiting consumption** by professional dishwashers, making **the energy saved available for the other equipment in the kitchen**. The “free the kilowatts” slogan is a common thread running through all the company’s ecofriendly range of products: technologically advanced and reliable solutions that can cut consumption by up to 50%, limiting waste and dramatically reducing operating costs.

[www.comendaeco2.eu](http://www.comendaeco2.eu)





Bars



Hospitals



Hotel



Canteens







Pâtisseries



Restaurants



Cafès

.05 |

# A PRODUCT FOR EVERY REQUIREMENT

Comenda offers solutions designed to enhance the **quality of hygiene in every sector: hotel, catering, healthcare, shipping, baking.** A wide range designed to meet the requirements of **bars, restaurants, hotels, canteens and hospitals,** fulfilling the highest standards of productivity, affordability of use, comfort and safety. Reliable machines that are perfect for washing glasses, dishes, trays and saucepans of all sizes; **front-loading, hood and rack conveyor dishwashers with all kinds of accessories** become the ideal partners of all catering professionals.

# TAILOR-MADE EFFICIENCY

**Modularity as a synonym of customisation.** The opportunity to create the best solution to satisfy customer requirements allows Comenda to offer versatile and customisable machines. Depending on available space, operational and managerial requirements, **each model can be adapted with tailor-made features**, without compromising on efficiency. There are multiple benefits to this: from improving the whole organisational process to significantly boosting productivity and substantially reducing costs to achieve otherwise unimaginable standards of quality.



The AC3 Multirinse dishwasher won the **SMART LABEL**, a major award presented by Host Fiera Milano with POLI.design.



The Multirinse® system received the prestigious **Grand Prix Sirha** de l'Innovation 2013 in the "Materials & Concepts" category.

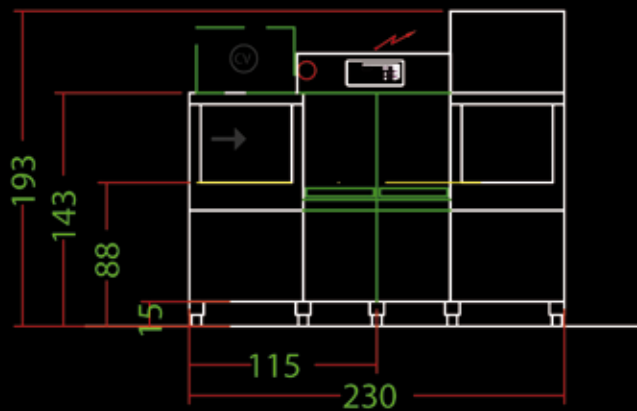
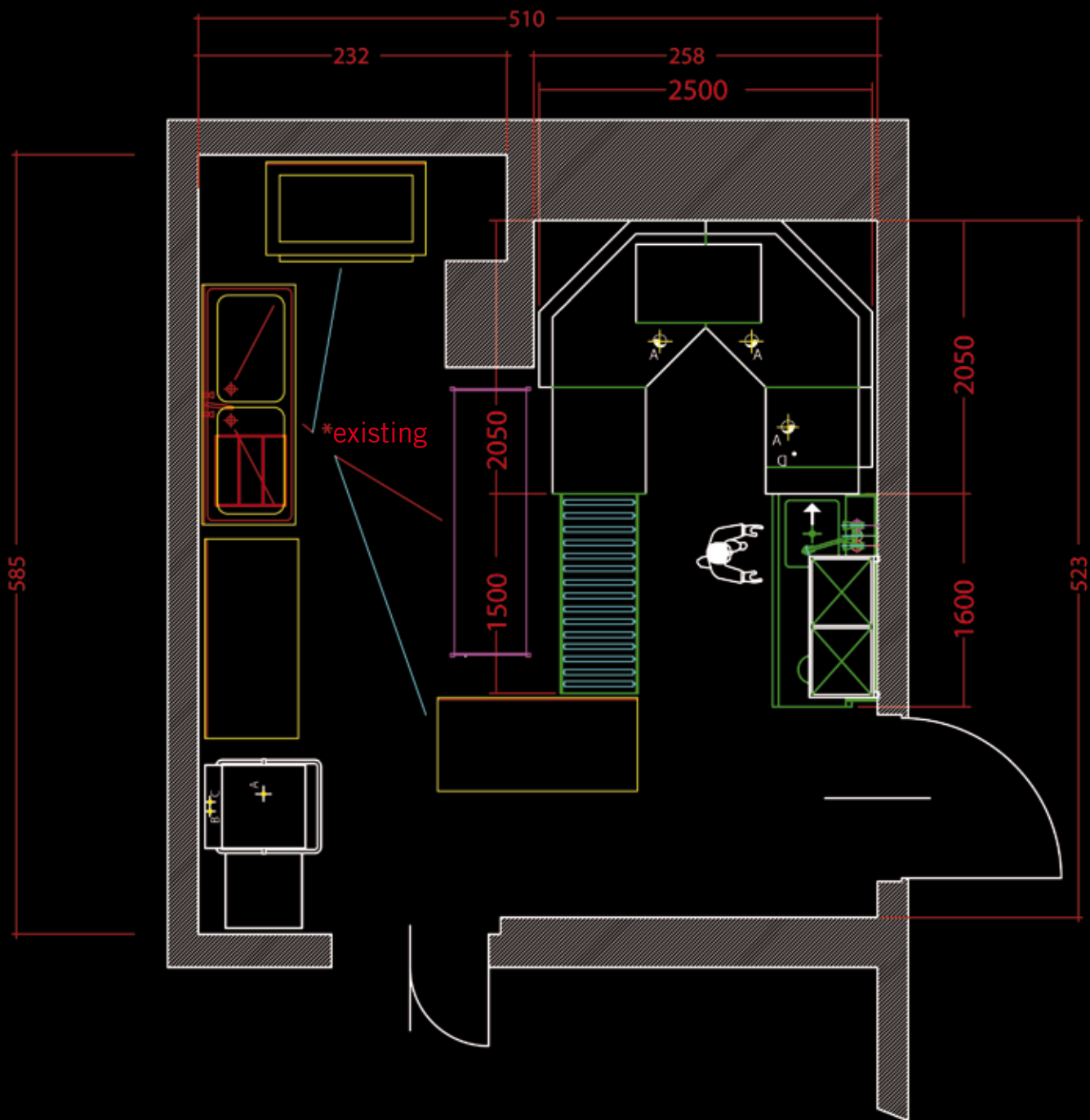



# A COMMITMENT DEMONSTRATED BY DISTINCTIVE VALUE

A global search for quality and environmental care: Comenda has achieved the **ISO 9001:2008 certification** and the **UNI EN ISO 14001:2004 environmental certification**, which have minimised its environmental impact in every aspect of production, from the supply of raw materials to manufacturing, from packaging materials to logistics. Further evidence of the ability to understand the market and interpret current trends and the changes taking place, asserting itself as a modern and dynamic organisation that can stand out from the competition. Comenda is also a **technical partner of FCSI Italia**, the international foodservice and hotel consultants association.



# ONLINE SUPPORT

Comenda offers a **website equipped with important tools** designed to offer a comprehensive pre-sales service. **Comenda Library**, for example, provides users with an **immediate and effective way of browsing through the 200 or more solutions offered** and selecting the most suitable washing system for their needs. The website also includes a **replacement part ordering section** where each registered customer can view and download pages showing perspective views, exploded diagrams and wiring, plumbing and installation diagrams, as well as access the instruction manual for all machines and send an order directly to the parts office in their own country.

[www.comenda-ali.it/library](http://www.comenda-ali.it/library)





# Go app!

.09

## SMARTER EVERY DAY WITH THE APP



With the **app designed to read the QR-codes** of its dishwashers, Comenda has introduced the latest technology into the world of professional washing. The app is a first in the industry and allows **product information to be obtained at all times, from wherever you are**. An important tool for both the end user, who can view the instruction manual, and specialised personnel, who can access technical material, interact with the support centre and submit orders.



# TECHNOLOGICAL DIALOGUE BETWEEN MAN AND MACHINE

Comenda dishwashers are **designed to make life easier for the user and simplify servicing**. Service engineers are supported by a **special card, which allows them to communicate remotely** with the equipment and ensures data can be downloaded, anomalies identified and operating parameters reset via a PC, a mobile phone, a USB peripheral or a memory card, in real time and from anywhere. **The user interfaces are particularly intuitive** - the most innovative are fitted with touch screen technology, which allows devices to be used instantly, while the LCD TFT backlit colour display provides bright, crisp and clear images in any lighting conditions.







COMENGA

COMENGA

[www.comenda.eu](http://www.comenda.eu)





COMENDA Ali S.p.A. Via Galileo Galilei, 8 - 20060 - Cassina de' Pecchi Milano - Italy  
T +39 02 95228.1 - F + 39 02 9521510 - sales@comenda.eu - www.comenda.eu

---

an Ali Group Company



The Spirit of Excellence