

Enlarge, Extract, Abstract!

Find picture/fabric (large print works well but others work well too!)

Create "viewfinder" – 2 pieces of paper cut into "L" shape.

These can be large or small – I just use copy paper. The viewfinder can slid together to form various size rectangles creating a "window" to view your picture/fabric.

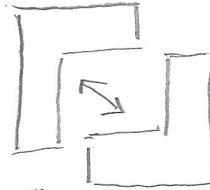

Slide your window around various parts of your picture/fabric until you find an interesting composition.

Using masking or blue painters tape, tape off that area so isolated it from the rest of the picture/fabric

Decide on a size to enlarge to. Cut freezer paper to that size (you may have to tape 2 pieces together depending how large you want to go) Look at your isolated/taped area. Using dull side of freezer paper draw and enlarge each area from your taped off area. You do not need to be perfect!

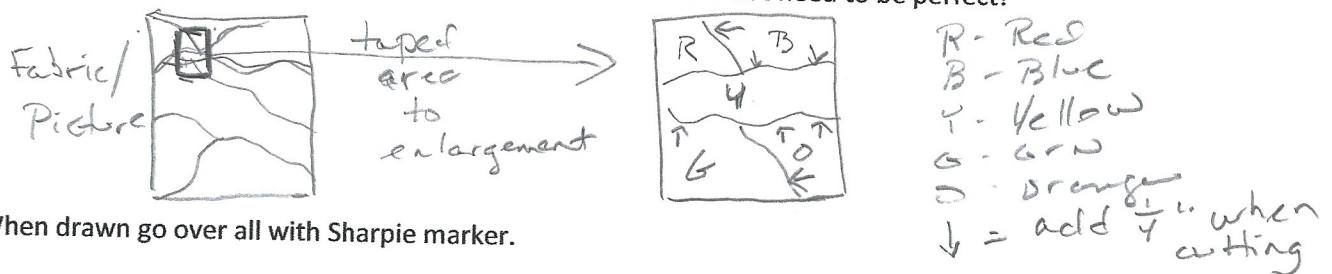

When drawn go over all with Sharpie marker.

Now the fun begins!!! Selecting the fabric for each piece of your abstract – my favorite part!!! Back/fuse each fabric (cut to size of pattern approx.) with Pellon Shir-Tailor.

On the master pattern indicate your color/fabric choice. Also decide which pieces need to go under an adjacent piece so you do not have (2) raw edges butting up to each other. Mark with arrows pointing toward cutting line to add $\frac{1}{4}$ " when cutting out patterns to underlap adjacent piece.

see above

Next trace each pattern piece onto dull side of freezer paper with all notes about color, arrows, etc. Iron each pattern piece to the respective fabric (including the $\frac{1}{4}$ " where you have indicated! As you cut each piece out place onto respective place on master pattern and pin (leave freezer paper on at this point) until covered.

Cut a piece of batting same size as master pattern.

Begin to take each piece to the batting and reconstruct based on master pattern – underlapping pieces where necessary and pinning as you go until covered and your abstract is created in your chosen fabrics.

Zig zag exposed edges paying attention to the order in which you sew your pieces so you can always cover previous edge with zig zag stitching. I use a 3.5 width and .5 length and I like 30 wt. thread (Sulky) but also use Mettler 50 wt. Choose a color that closely matches your fabric or you can use all black.....up to you which look you prefer.

When done zig-zagging quilt as desired. I usually use a simple curving line and enjoy using stitches from my sewing machine. I've also quilted quite densely. I like to use a pillow-case finish so I quilt through the top and batting then cover with backing right sides together and sew around edges and cut slit in back where sleeve will be and turn inside out and understitch as close to corners as possible. Or you can apply backing and quilt and finish with binding or facing.

Your abstract is now done!!!! Contact our website administrator to submit a picture of your finished work!!! I'd love to see your masterpiece!!!

Enjoy!