

POD Mounting Instructions

TOOLS

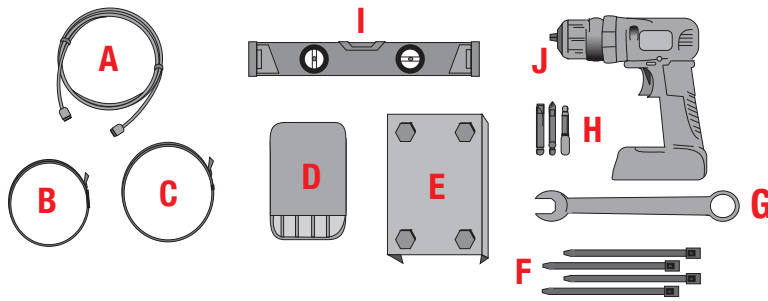

- A - Cat6 Cable
- B - 1x Strap
- C - 2x Strap
- D - WiFi Transmitter
- E - Bracket
- F - Zip Ties
- G - 9/16 Wrench
- H - 5/16 Bit
- I - Level
- J - Drill & Phillips Bit

**Not Included*

1. TEST POD IN OFFICE

Plug POD in while in office to test before going onsite.

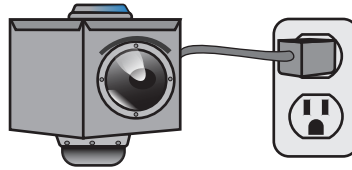

2. BUCKET TRUCK OR LIFT IS REQUIRED

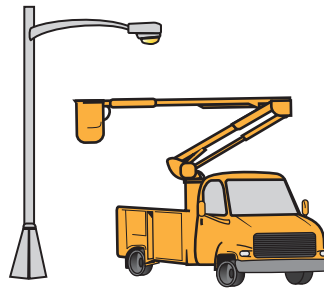

3. OPTIONAL: PHOTOCELL POWER ADAPTER

To ensure power cord can reach POD, do Step 3 before mounting.

Remove photocell from streetlight.

Plug photocell into photocell power adapter.

Plug photocell power adapter into streetlight.

Zip-tie cord onto arm of streetlight.

BEFORE MOUNTING: Make sure cord can reach desired POD location.

AFTER MOUNTING: plug other end into inlet.

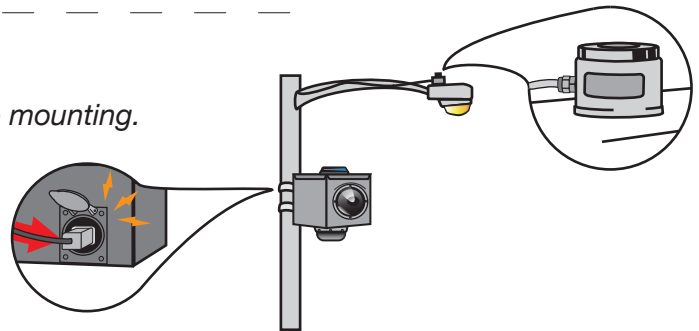

4. HOLD E-MOUNTING BRACKET ON POLE

Place (C)2xStraps around E and pole.

Tighten (C) with (H)5/16Bit.

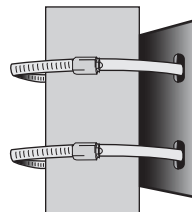

5. SLIDE POD KEYHOLES ONTO MOUNTING BRACKETS BOLTS

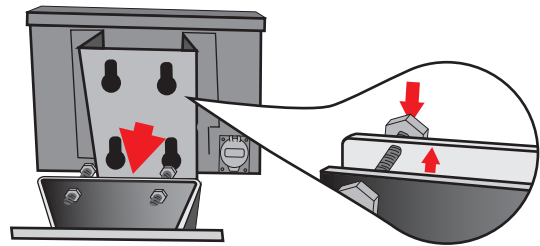

6. SECURE POD BY TIGHTENING BOLTS

Using (G)9/16Wrench

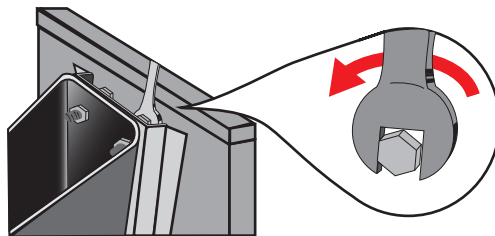

7. ATTACH A-CAT6 CABLE TO D-WIFI TRANSMITTER

Make sure cover plate is on & transmitter is right side up.

Attach WiFi to pole using (B)1xStrap.

Tighten (B) with (H).

Attach other end of (A) to RJ45 connection labeled -
-WiFi (closest to the power inlet)

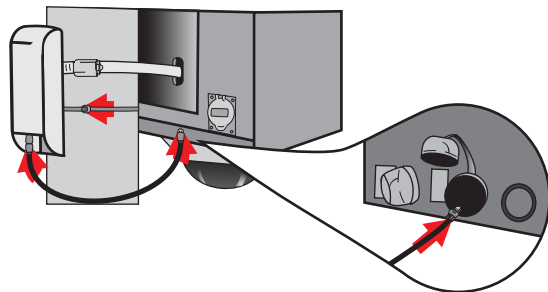

8. TURN STROBE LIGHT ON OR OFF USING ORANGE TOGGLE SWITCH

Underneath POD.

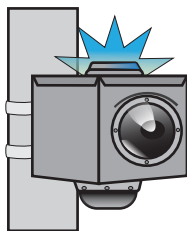

9. ADJUST STATIONARY CAMERA

Remove Dome and adjust stationary camera to
face desired location. (See Image Adjusting)

