

Expandable Container House

We self-develop the expandable container house , which is pre-assemble 95% before leaving the factory , fast and easy to assemble . And it can be moved frequently with the larger living area comparing with the flat pack container house .

Expandable Container House



20ft : Expanded Size : 6390*5850*2530 mm

Closed Size : 2250*5850*2530 mm

40ft : Expanded Size : 6390*11800*2530 mm

Closed Size : 2250*11800*2530 mm

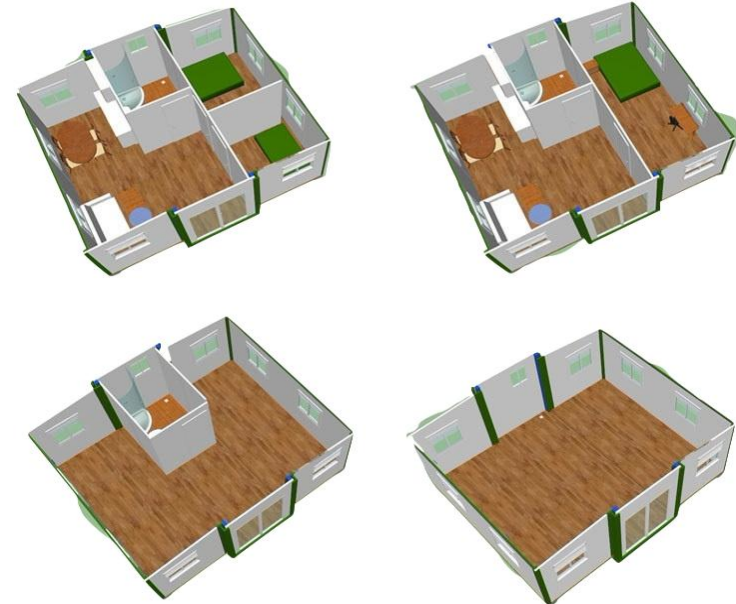

Detail Specification

Item	Expandable container house
Size	Overall size : 20ft: 6390*5850*2530 mm 40 ft : 6390*11800*2530 mm
Wall	50/75 mm EPS / Rockwool / PU sandwich panel
Roof	Keel : square tube pipe Insulation : 50 mm eps sandwich panel Drainage : water flows to the four corners
Floor	MGO board + PVC floor
Window	Double glazed PVC / Aluminium alloy windows with bathroom window
Door	Double glass sliding door , bathroom door , wood door etc
Load (KN/m2)	Base plate : 3.0 Roof panel : 1.5 wind force : 0.6
Heat transfer coefficient (W /m2 K)	Base plate : 0.46 Roof panel : 0.64 wind force : 0.47
Sound insulation (db)	Base plate : 30-35 Roof panel : 30-35 wind force : 20-25

Product Show

Material Diagram

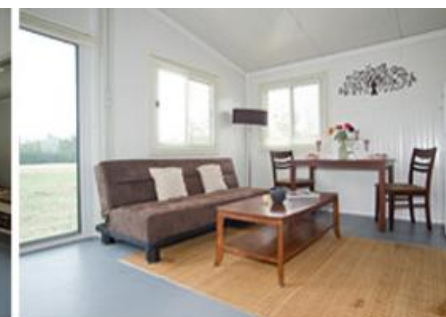

Steel Frame

It is welded by the black square tube and then painted with white color as standard
Optional Color is green , blue , black or as the RAL No.



Wall Panel / Roof Panel

Standard is 50 mm EPS sandwich panel , tongue-and-groove connection

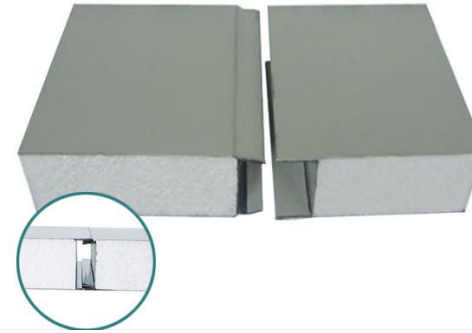

Optional panel : rockwool sandwich panel / PU sandwich panel



Door

Entry Door
Double Sliding door
1920*2260 mm



Bedroom Door
Wood door
800*2030 mm



Bathroom Door
Titanium magnesium alloy door
730*2030 mm



Optional Entry Door

Steel Door



Safety Door



Window

930*1110mm W*H

600*600 mm W*H
for bathroom



45-degree
cutting angle
for 4 corners



Window frame is
together with the
window

Standard is PVC double glazed windows

Optional : 1.window screen

2. Window frame Material : Aluminium alloy

Bathroom

Pre-assembled Shower Room , Toilet and wash basin with mirror



Kitchen



Standard is I shape 1500 mm long . L shape is custom-made as request size .
Optional table material is black marble , white quartz stone and stainless steel



Assemble

It will take half day by 3-4 skilled workers

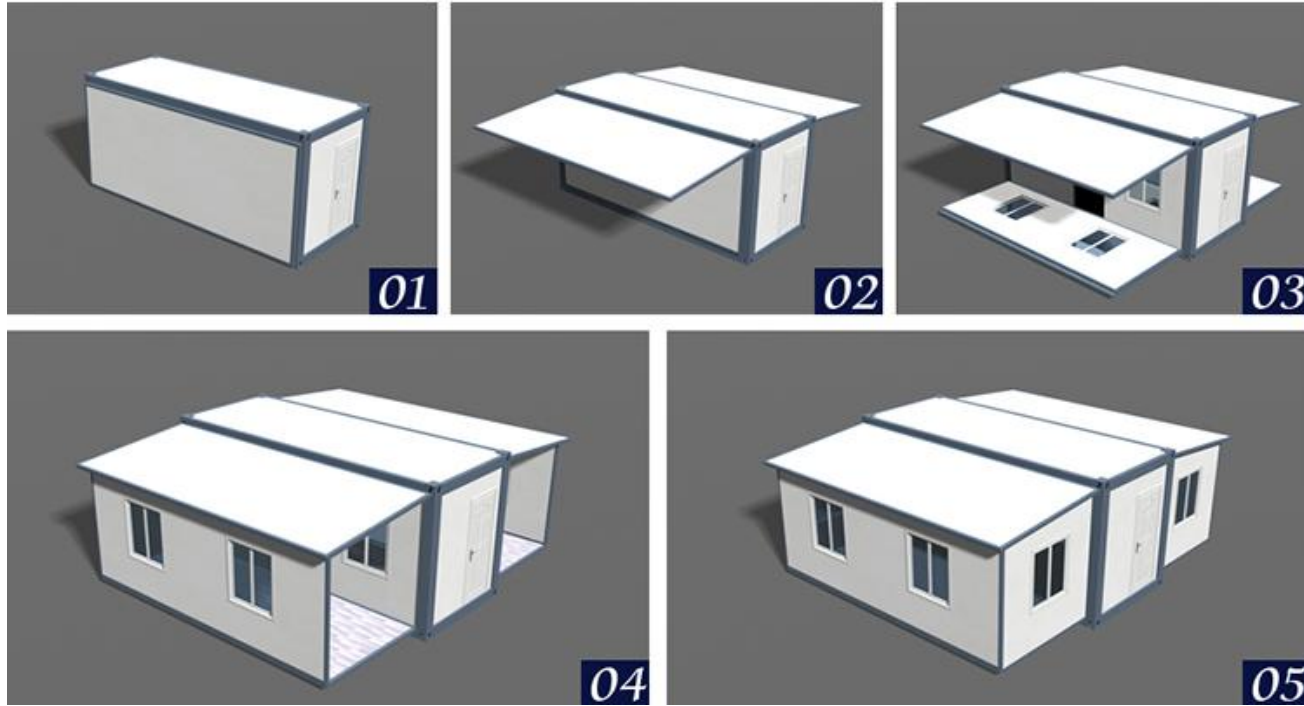

Finished



Flat Pack Container House

Flat Pack Container House

RAL 9016



Basic Information

Size : 1) 2400 *6000*2800 mm
2) 2200*5800*2800 mm

Standard container house is 1 open room with 1 door , 2 window with electrical system

Optional Color

RAL 5015, RAL 9016 or as RAL color NO.

RAL 5015



Structure System

Roof

Floor

Column

Wall

Window

Electrical

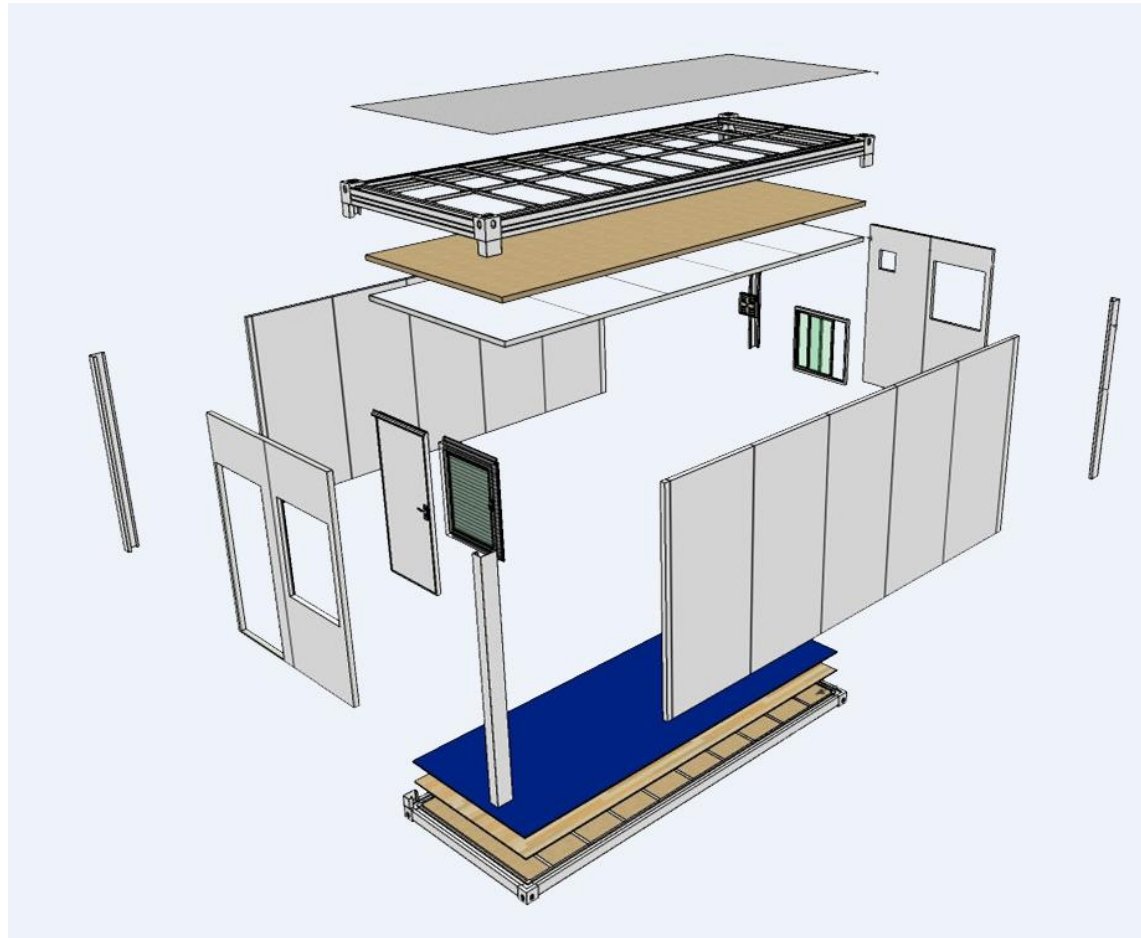

Detail Specification

Item	20ft Flat pack container house
Size	1) 2400*6000*2800 mm 2) 2200*5800*2800 mm
Steel frame	2.3/2.5 mm thick steel frame , white color or any RAL No.
Wall	50/75 mm EPS/ glass fiber /PU sandwich panel
Roof	0.5 mm color steel sheet roof cover 50 mm glass fiber with single side aluminum foil 0.3 mm Profiled steel plate ceiling
Floor	MGO board + PVC floor
Window	Double glazed PVC / Aluminium alloy windows
Door	Safety door / sandwich panel door or as request
Electrical	China / Australia / American Standard or as request

Roof

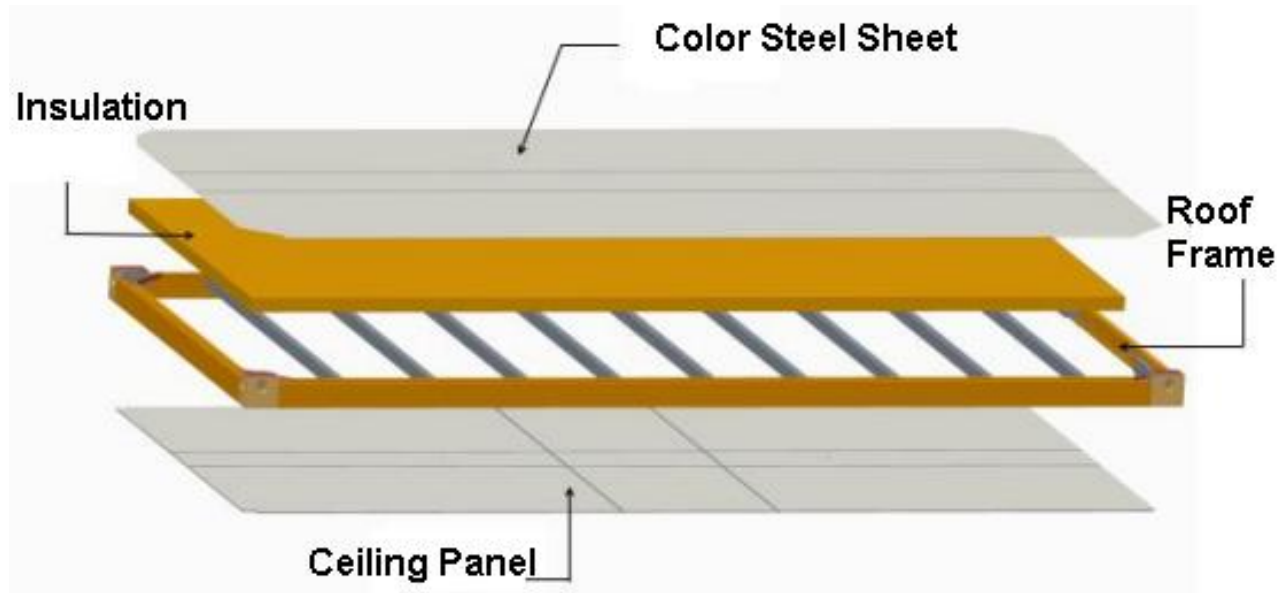

Top : 0.5 mm thickness galvanized steel plate, white grey
Insulation : 50 mm thickness with single side aluminum foil
Ceiling panel : 0.3 mm thick corrugated steel sheet
Steel frame : 2.3 /2.5 mm thick
Industrial sockets : mounted in the frame at the short side

Floor

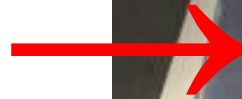

Floor : 15 mm MGO board + 1.6 mm PVC floor in blue color
Combustion performance : flame retardant

Column



2.3/2.5 mm hot rolled steel , formed by one time
By bolts connection , to make the roof , floor together

Wall Panel

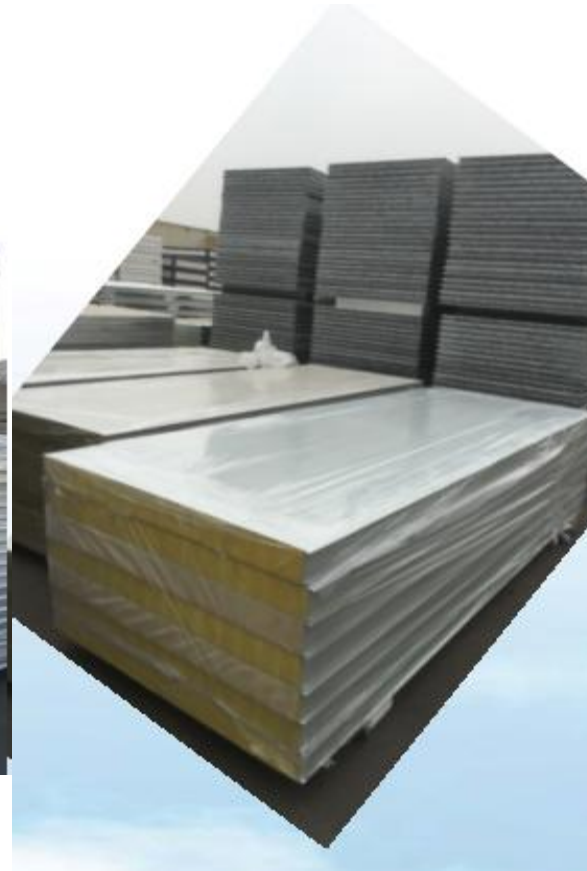

Wall panel

Thickness : 50 /75 mm thick

Optional : EPS sandwich panel , Rockwool sandwich panel ,
Glass fiber sandwich panel

Window & Door



UPVC double glazed windows ,optional for screens and rails



Hinged single steel door , standard size
800* 2035 mm or as request

Another optional : Sandwich panel door



Drainage System

**White color , PVC pipes ,
which is assembed in 4 corners**



Insert the pipe bottom into
rainwater pipe clamp



Place the U shape drainage channel
on the bulge of bottom structure and
make sure the drain hole outward



Joint the top with the
preformed pipe hole
of top container cast

Finished



Optional Layout

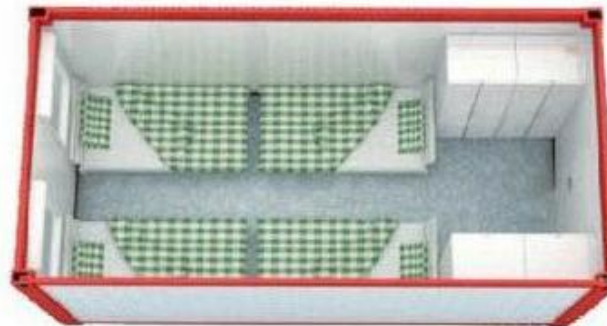
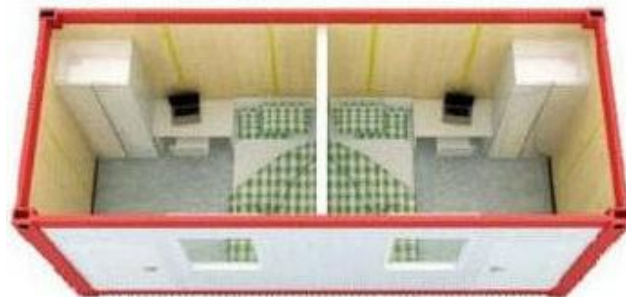
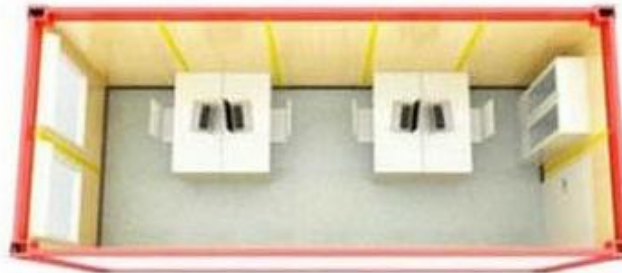
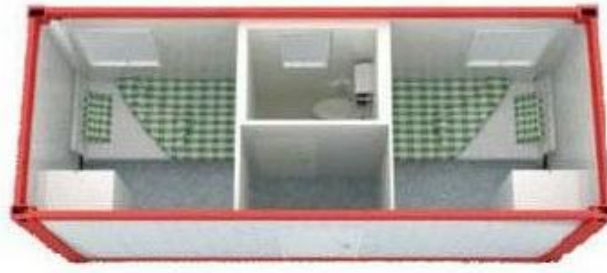
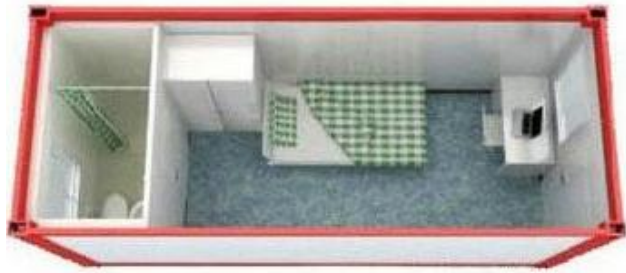

Transport

Flat pack packages is suitable to transport by truck and loading in the container to shipping by sea .
It save the transport cost

1. By truck
14 sets per truck
(17.5 meter long)



2. By Sea
8 sets /40 HQ
4 set / 20ft container



Transport

3. By sea

The material is packed well , then loading in the 40 HQ



Assemble

Easy and fast to assemble , It will take half day by 3-4 skilled workers each unit .



1. The column fixed on the chassis with screw in vertical space. As Figure 1 shown.



2. Connected the housetop of container house with the 4 columns slowly, fixed with screw, as the Figure 2 shown.



3. Adjust the chassis and the roof in the same horizontal level, then Tighten bolts, as the Figure 3 shown.

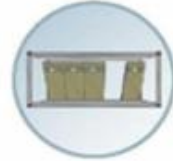

4. Installing the wall panel according to the item No. on the panel. The panel which with the socket, switch, should put the wires into the junction box firstly.



5. After finishing the installation of wall panel in one side, fixed them together with screw and binder plate, as the picture shown.



6. Installing the other walls with the same method of No.4 and No.5 points.



7. Here finishing the installation of container house, the complete container house as the Figure shown.



Projects

Hospital Use Container House



Foldable Container House

Features

Fast assemble

It will take 15 minutes by 3-4 skilled workers to assemble 1 unit

Green

Repeatedly to use , save cost and green to environment .
100% fire-proof and water resistance

Low transport cost

It can load 10 set in 40 HQ , 20 sets per truck .

Production

Standard design to produce and assemble, stable and durable , newest design



Detail Specifications

Item	Fodable Container House
External Size	5800*2500*2500 mm L*W*H
Internal Size	5650*2370*2350 mm L*W*H
Floor Frame	270*2.5 mm profiled steel
Roof Frame	170*2.5 mm profiled square tube
Corner Post	155*2.0 profiled square tube
Wall Panel	50 mm glass fiber sandwichpanel
Floor panel	15 mm fire-proof board
Window	Double glazed PVC window , 2 pcs per set
Door	Standard fire-proof door , 1 pcs per set
Electrical	Sockets , switches , LED lights , wires etc.

Product Show



Standard Packages
5800*2500*400 mm
L*W*H



Material Diagram



Optional Layout

Container house with no partition



Container house with one bedroom and bathroom



Container toilet

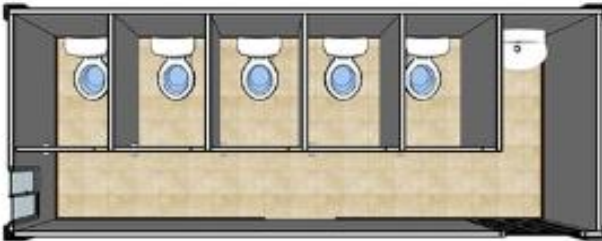

Container Shower room



Installation Method

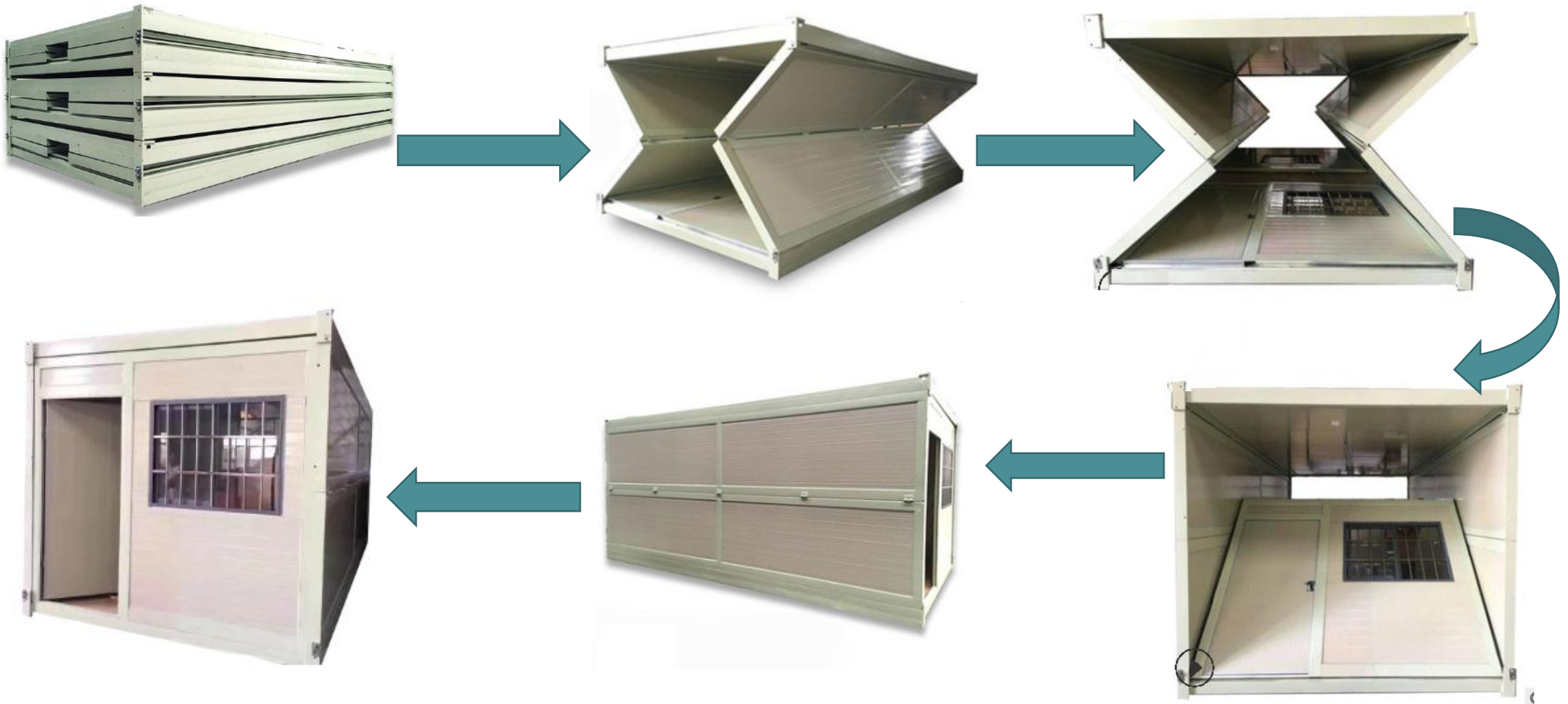

Loading

10 sets loading in 40 HC







Electrical



AS315
2 开 2 插 10A 单极
10A horizontal double
powerpoints



AS302
1 开双控
1 G 2 way switch



AS304
2 开双控
2 G 2 way switch



AS322-1
电视 + 网络插座
TV socket+ Data socket

Socket with
SAA certificate

1.5-2.5 m2 electrical wire
with SAA certificate
TPS flat / round wire

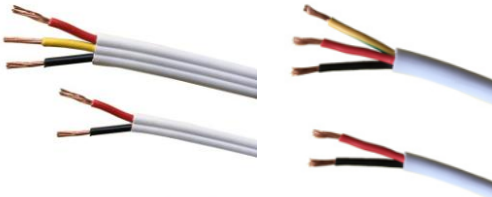

18w LED lamp



Industry socket/ plug 3P , 32A ,250V
Comply with AS/NZS 3100, AS/NZS3112, AS/NZS 3123

Switch box 4-6 ways

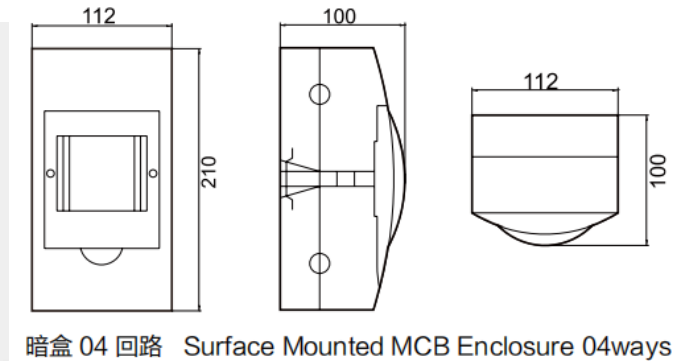

暗盒 04 回路 Surface Mounted MCB Enclosure 04ways