

29th ANNUAL JADE FESTIVAL BOOTH RENTAL CONTRACT

EVENT DATES: OCTOBER 10, 11 & 12, 2025

IMPORTANT: Complete this form and return to:

Matt Grzincic

2225 Yorkshire St.

Cambria, CA 93428 moonstonematt@gmail.com

Make your check payable to: SCCLT mailed to the above address

To reserve an assigned space, this form must be returned along with a description of all products which will be displayed, sold, and companies you represent. Please list your first (3) choices for booth space from the map on the back of this form on the space provided below.

BUSINESS NAME _____ BOOTH SPACE: _____
1 2 3

ADDRESS _____ PHONE _____

CITY _____ STATE _____ ZIP _____ EMAIL ADDRESS: _____

PERSON RESPONSIBLE FOR BOOTH (Please print full name legibly). _____

1. Please list all product lines (i.e. Lapidary, jewelry, sculpture, etc.) to be displayed & offered for sale

2. Did you apply for exhibit space in the last Jade Festival of 2024? Yes _____ No _____

This is the 29th Big Sur Jade Festival and we would appreciate a brief description, and or photos, of your products. The emphasis of the festival is Jade, stone and wood carvings, jewelry and related items. If you are a returning vendor of the last festival, photos and descriptions of your work will not be necessary.

There will be 44 full-size booths for a fee of \$500. Half spaces (6) cost \$300, generally larger than 5x5. Shared booth space for same price is ok. Booth sizes are approximately 10' x 10'. All booth fees benefit the South Coast Community Land Trust. Questions? Text Matt @ 805-903-3863 (preferred method) or call.

BOOTHS NOT SET UP BY FRIDAY NOON WILL BE CONSIDERED NULL & VOID WITHOUT A REFUND!

CANCELLATION & REFUND POLICY - please let Matt know ASAP!

Cancel before July 10: 90% Refund

Cancel by August 10: 75% Refund

Cancel by Sept. 10: 50% Refund.

Cancellations thereafter, refunds are dependent upon a replacement vendor.

IF YOU PLAN TO CAMP ON THE FIELD, THE FEE IS \$50 FOR THE WEEKEND. Please sign the form which follows.

We will have a drawing of prizes again this year. Your donation is greatly appreciated. Proceeds from the drawing are used to support SCCLT's Michael Handy Summer Education Grant, which benefits the children of the South Coast of Big Sur to do something "educational" during the summer.

I have read and understood this contract. I release the South Coast Community Land Trust (SCCLT) from any & all liability due to personal loss, injury or property damage, before, during, and after the Festival. I also understand that I am responsible for my own Sales Tax & a valid Resale number.

VENDOR SIGNATURE: _____ RECEIVED BY _____ DATE _____

MAP IS NOT TO SCALE!

HWY 1 (WEST)

5202 '11 ENHNC

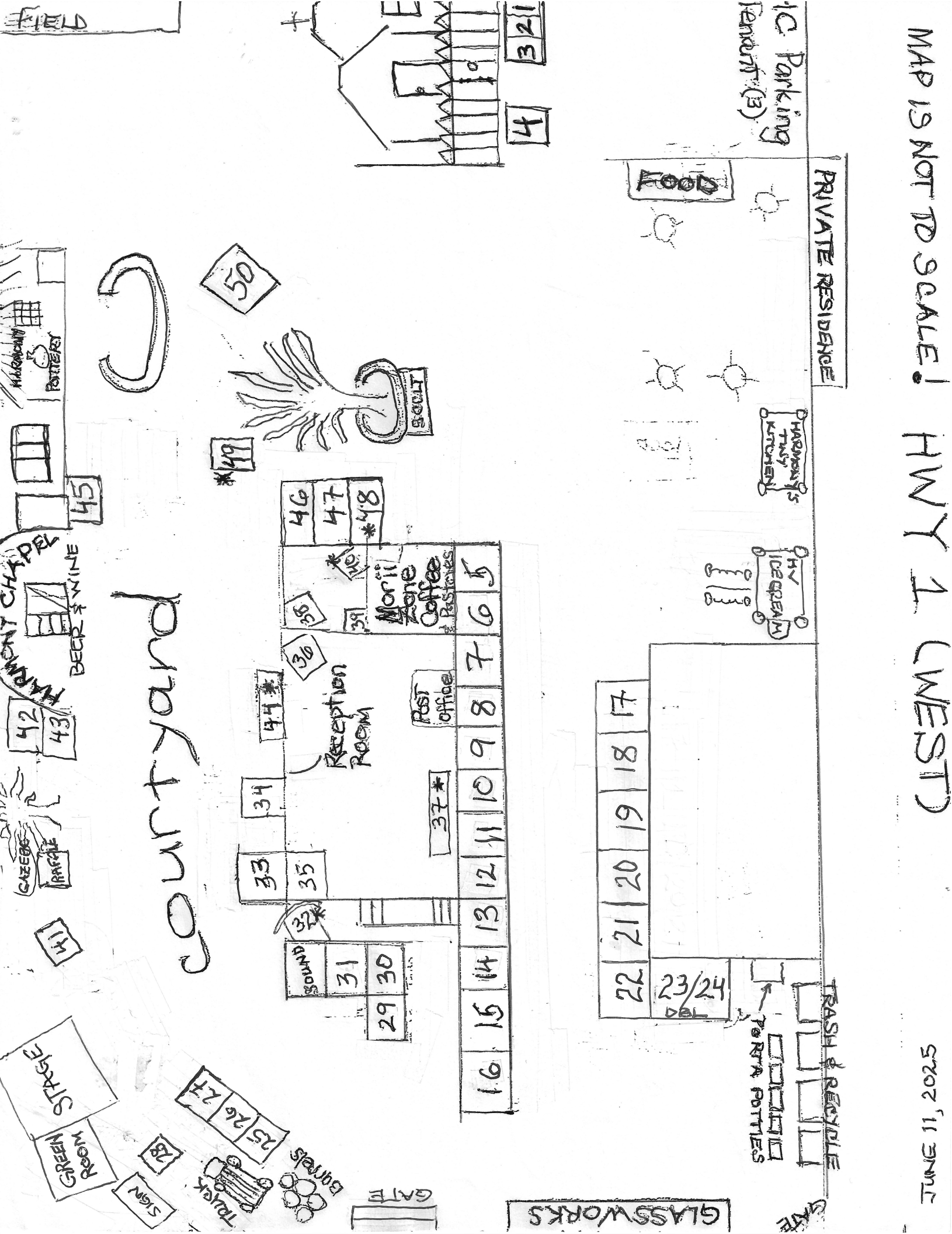

CAMPING

Camping is rustic, unreserved & mixed use (vehicles & tents sharing the area).

For a fee of \$50 for the entire weekend, camping is provided in the field shared with general parking. A porta-potty, wash-station & trash can will be provided. Water hook-ups & electricity are not available. Campers are expected to be self-contained.

Thursday, Oct 9, entry is permitted @ noon; checkout by Monday, Oct. 13 by noon.

A Camping/Vendor placard should be displayed on your dashboard. It can be obtained from the SCCLT booth. Make sure your camp is clear of any trash. Recycle & Trash bins are in the "town" by the porta-potties.

Pets: OK. Please keep them on a leash & pick up their poop. If you have a "barker" camp far away from other campers!

Quiet Time: Out of consideration for others, please observe quiet hours from 10 pm to 8 a.m.

Campfires/BBQs

Campfires are NOT allowed. Charcoal BBQs and wood BBQs are also prohibited.

Propane camping grills and stoves with a shutoff valve are permitted for cooking. Propane fire pits with a shutoff valve are permitted with a 5' cleared area all around, shovel & gallons of H2O nearby provided by you. Propane fire pits need to be lifted off the ground.

I have read and understood this contract. I release the South Coast Community Land Trust (SCCLT) & Robert Soto Trust from any & all liability due to personal loss, injury or property damage, before, during, and after the festival.

VENDOR SIGNATURE: _____

BOOTH #or NAME _____

RECEIVED BY _____ PAID _____ DATE _____